

NOTICE

This scan only represents the application as filed. The information contained herein meets the requirements of K.A.R. 5-3-1 or K.A.R. 5-5-1, and has been found acceptable for filing in the office of the Chief Engineer. The application should not be considered to be a complete application as per K.A.R. 5-3-1b or K.A.R. 5-5-2a.

THE STATE OF KANSAS



KANSAS DEPARTMENT OF AGRICULTURE
Jackie McClaskey, Secretary of Agriculture

DIVISION OF WATER RESOURCES
David W. Barfield, Chief Engineer

File Number 49793
This item to be completed by the Division of Water Resources.

WATER RESOURCES
RECEIVED

MAR 10 2017
12:59
KS DEPT OF AGRICULTURE

**APPLICATION FOR PERMIT TO
APPROPRIATE WATER FOR BENEFICIAL USE**
Filing Fee Must Accompany the Application
(Please refer to Fee Schedule attached to this application form.)

To the Chief Engineer of the Division of Water Resources, Kansas Department of Agriculture,
1320 Research Park Drive, Manhattan, KS 66502:

1. Name of Applicant (Please Print): CRAIG STEVEN
Address: 6111 W 29 N
City: WICHITA State KS Zip Code 67205
Telephone Number: (316) 9440730(H) 316-9900541(M)

2. The source of water is: surface water in _____
OR groundwater in ARKANSAS RIVER
(stream)
(drainage basin)

Certain streams in Kansas have minimum target flows established by law or may be subject to administration when water is released from storage for use by water assurance district members. If your application is subject to these regulations on the date we receive your application, you will be sent the appropriate form to complete and return to the Division of Water Resources.

3. The maximum quantity of water desired is 63 acre-feet OR _____ gallons per calendar year, to be diverted at a maximum rate of 350 gallons per minute OR _____ cubic feet per second.

Once your application has been assigned a priority, the requested maximum rate of diversion and maximum requested quantity of water under that priority number can **NOT** be increased. Please be certain your requested maximum rate of diversion and maximum quantity of water are appropriate and reasonable for your proposed project and are in agreement with the Division of Water Resources' requirements.

4. The water is intended to be appropriated for (Check use intended):
(a) Artificial Recharge (b) Irrigation (c) Recreational (d) Water Power
(e) Industrial (f) Municipal (g) Stockwatering (h) Sediment Control
(i) Domestic (j) Dewatering (k) Hydraulic Dredging (l) Fire Protection
(m) Thermal Exchange (n) Contamination Remediation

YOU **MUST** COMPLETE AND ATTACH ADDITIONAL DIVISION OF WATER RESOURCES FORM(S) PROVIDING INFORMATION TO SUBSTANTIATE YOUR REQUEST FOR THE AMOUNT OF WATER FOR THE INTENDED USE REFERENCED ABOVE.

For Office Use Only:							
F.O. <u>2</u>	GMD <u>2</u>	Meets K.A.R. 5-3-1 <u>(YES)</u> / NO	Use <u>DEE</u>	Source <u>(G) S</u> County <u>HV</u>	By <u>MM</u>	Date <u>3/14/17</u>	
Code <u>REG</u>	Fee \$ <u>200</u>	TR # _____	Receipt Date <u>3/10/17</u>	Check # <u>3279</u>			

3/14/2017 ULM

5. The location of the proposed wells, pump sites or other works for diversion of water is:

Note: For the application to be accepted, the point of diversion location must be described to at least a 10 acre tract, unless you specifically request a 60 day period of time in which to locate the site within a specifically described, minimal legal quarter section of land.

- (A) One in the NW quarter of the SW quarter of the NW quarter of Section 29, more particularly described as being near a point _____ feet North and _____ feet West of the Southeast corner of said section, in Township 24 South, Range 3 East/West (circle one), HARVEY County, Kansas.
- (B) One in the _____ quarter of the _____ quarter of the _____ quarter of Section _____, more particularly described as being near a point _____ feet North and _____ feet West of the Southeast corner of said section, in Township _____ South, Range _____ East/West (circle one), _____ County, Kansas.
- (C) One in the _____ quarter of the _____ quarter of the _____ quarter of Section _____, more particularly described as being near a point _____ feet North and _____ feet West of the Southeast corner of said section, in Township _____ South, Range _____ East/West (circle one), _____ County, Kansas.
- (D) One in the _____ quarter of the _____ quarter of the _____ quarter of Section _____, more particularly described as being near a point _____ feet North and _____ feet West of the Southeast corner of said section, in Township _____ South, Range _____ East/West (circle one), _____ County, Kansas.

If the source of supply is groundwater, a separate application shall be filed for each proposed well or battery of wells, except that a single application may include up to four wells within a circle with a quarter (1/4) mile radius in the same local source of supply which do not exceed a maximum diversion rate of 20 gallons per minute per well.

A battery of wells is defined as two or more wells connected to a common pump by a manifold; or not more than four wells in the same local source of supply within a 300 foot radius circle which are being operated by pumps not to exceed a total maximum diversion rate of 800 gallons per minute and which supply water to a common distribution system.

6. The owner of the point of diversion, if other than the applicant is (please print):

_____ (name, address and telephone number)

_____ (name, address and telephone number)

You must provide evidence of legal access to, or control of, the point of diversion from the landowner or the landowner's authorized representative. Provide a copy of a recorded deed, lease, easement or other document with this application. In lieu thereof, you may sign the following sworn statement:

I have legal access to, or control of, the point of diversion described in this application from the landowner or the landowner's authorized representative. I declare under penalty of perjury that the foregoing is true and correct.

Executed on MARCH 6, 2017.  Applicant's Signature

The applicant must provide the required information or signature irrespective of whether they are the landowner. Failure to complete this portion of the application will cause it to be unacceptable for filing and the application will be returned to the applicant.

7. The proposed project for diversion of water will consist of ONE WELL - ONE PUMP (number of wells, pumps or dams, etc.) and (was)(will be) completed (by) 2000 ? (Month/Day/Year - each was or will be completed)

8. The first actual application of water for the proposed beneficial use was or is estimated to be WATER RESOURCES RECEIVED ? 2000 (Mo/Day/Year)

MAR 10 2017

9. Will pesticide, fertilizer, or other foreign substance be injected into the water pumped from the diversion works?
 Yes No If "yes", a check valve shall be required.

All chemigation safety requirements must be met including a chemigation permit and reporting requirements.

10. If you are planning to impound water, please contact the Division of Water Resources for assistance, prior to submitting the application. Please attach a reservoir area capacity table and inform us of the total acres of surface drainage area above the reservoir.

Have you also made an application for a permit for construction of this dam and reservoir with the Division of Water Resources? Yes No

- If yes, show the Water Structures permit number here _____
- If no, explain here why a Water Structures permit is not required _____

11. The application must be supplemented by a U.S.G.S. topographic map, aerial photograph or a detailed plat showing the following information. On the topographic map, aerial photograph, or plat, identify the center of the section, the section lines or the section corners and show the appropriate section, township and range numbers. Also, please show the following information:

- (a) The location of the proposed point(s) of diversion (wells, stream-bank installations, dams, or other diversion works) should be plotted as described in Paragraph No. 5 of the application, showing the North-South distance and the East-West distance from a section line or southeast corner of section.
- (b) If the application is for groundwater, please show the location of any existing water wells of any kind within 1/2 mile of the proposed well or wells. Identify each existing well as to its use and furnish the name and mailing address of the property owner or owners. If there are no wells within 1/2 mile, please advise us.
- (c) If the application is for surface water, the names and addresses of the landowner(s) 1/2 mile downstream and 1/2 mile upstream from your property lines must be shown.
- (d) The location of the proposed place of use should be shown by crosshatching on the topographic map, aerial photograph or plat.
- (e) Show the location of the pipelines, canals, reservoirs or other facilities for conveying water from the point of diversion to the place of use.

A 7.5 minute U.S.G.S. topographic map may be obtained by providing the section, township and range numbers to: Kansas Geological Survey, 1930 Constant, Campus West, University of Kansas, Lawrence, Kansas 66047.

12. List any application, appropriation of water, water right, or vested right file number that covers the same diversion points or any of the same place of use described in this application. Also list any other recent modifications made to existing permits or water rights in conjunction with the filing of this application.

OVERLAP POINT OF DIVERSION AND PLACE
OF USE WITH WATER RIGHT FILE# 44717

WATER RESOURCES
RECEIVED

MAR 10 2017

KS DEPT OF AGRICULTURE

13. Furnish the following well information if the proposed appropriation is for the use of groundwater. If the well has not been completed, give information obtained from test holes, if available.

Information below is from: Test holes Well as completed Drillers log attached

Well location as shown in paragraph No.	(A)	(B)	(C)	(D)
Date Drilled	<u>2000?</u>			
Total depth of well	<u>90'</u>			
Depth to water bearing formation	<u>30' to 90'</u>			
Depth to static water level	<u>22'</u>			
Depth to bottom of pump intake pipe	<u>70'</u>			

14. The relationship of the applicant to the proposed place where the water will be used is that of OWNER
(owner, tenant, agent or otherwise)

15. The owner(s) of the property where the water is used, if other than the applicant, is (please print):

(name, address and telephone number)

(name, address and telephone number)

16. The undersigned states that the information set forth above is true to the best of his/her knowledge and that this application is submitted in good faith.

Dated at WICHITA, Kansas, this 8 day of MARCH, 2017
(month) (year)

(Applicant Signature)

By _____
(Agent or Officer Signature)

(Agent or Officer - Please Print)

Assisted by _____ ESII _____ Date: 10/7/2016
(office/title)

WATER RESOURCES RECEIVED

MAR 10 2017

Example Map

NEW APPLICATION

All wells of any kind within 1/2 mile of the requested point of diversion have been plotted

Signed: John C Doe
Date: 06/14/96

IRRIGATION WELL
Ken Daigneau
Rt 1, Ferris, KS 28123

R20E

DOMESTIC WELL
P.W. Herman
1513 Vine Street
Sydney, KS 28124

T13S

WELL REQUESTED
THIS APPLICATION

Scale: 1"=2,000'



- LEGEND**
- Place of Use
 - Proposed Well
 - DOM. Well
 - Other Well 15'
 - Section Corner

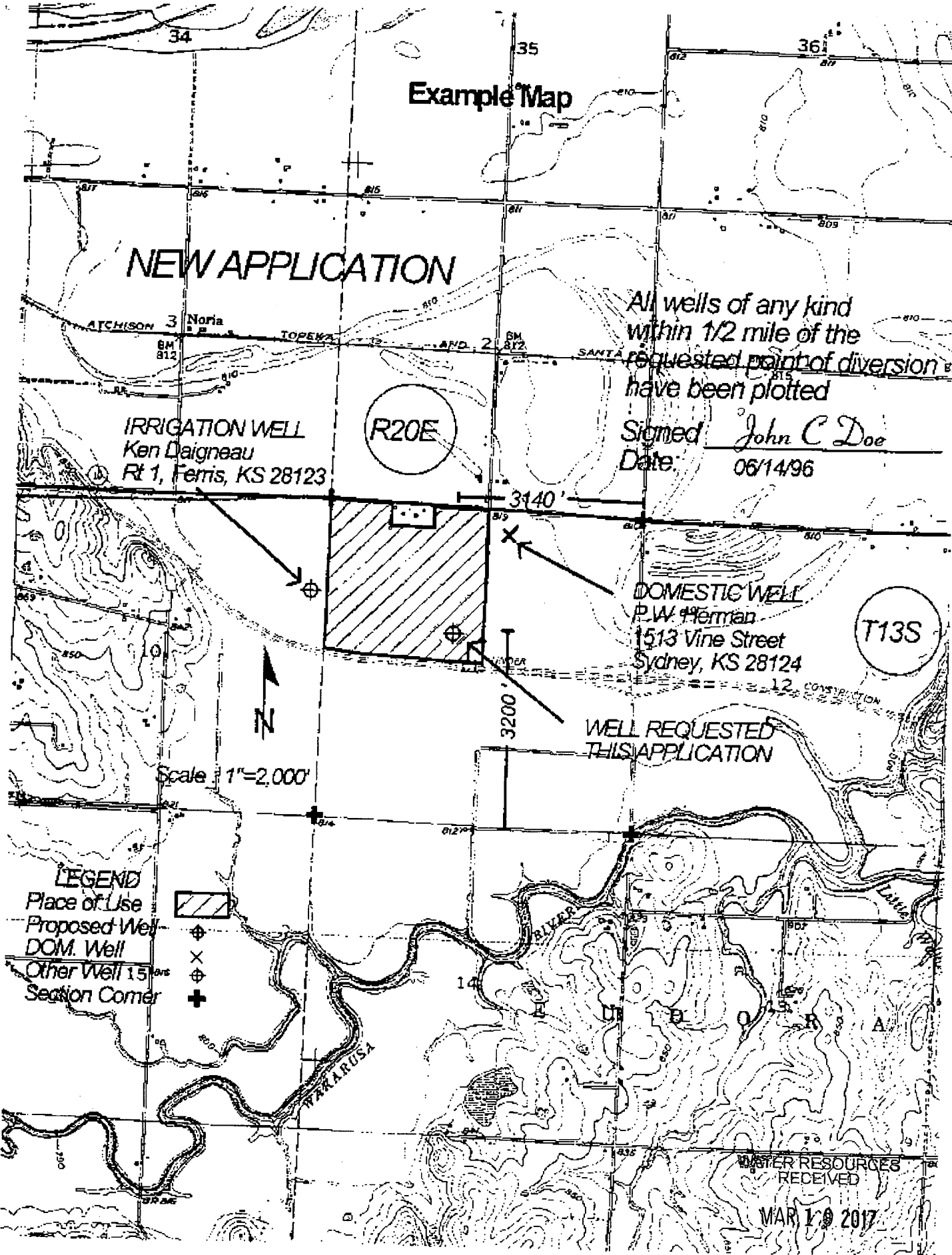

WATER RESOURCES
RECEIVED
MAR 10 2017

49793

3-6-17

(Date)

Kansas Department of Agriculture
Division of Water Resources
David W. Barfield, Chief Engineer
109 SW 9th Street, 2nd Floor
Topeka, Kansas 66612-1283

Re: Application File No. 44717

Minimum Desirable Streamflow

Dear Sir:

I understand that a Minimum Desirable Streamflow requirement has been established by the legislature for the source of supply to which the above referenced application applies.

I understand that diversion of water pursuant to this application will be subject to regulation any time Minimum Desirable Streamflow requirements are not being met.

I also understand that if this application is approved, there could be times, as determined by the Division of Water Resources, when I would not be allowed to divert water. I realize that this could affect the economics of my decision to appropriate water.

I am aware of the above factors, and with the knowledge thereof, request that the Division of Water Resources proceed with processing and approval, if possible, of the above referenced application.



Signature of Applicant

GRAIG STEVEN
(Print Applicant's Name)

State of Kansas)

County of Sedgwick)

) ss

I hereby certify that the foregoing instrument was signed in my presence and sworn to before me this 6th day of March, 2017.

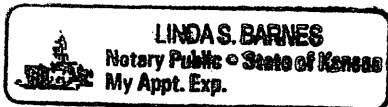
Notary Public

My Commission Expires: 9-23-2020

WATER RESOURCES
RECEIVED

MAR 10 2017

RECREATIONAL USE
SUPPLEMENTAL SHEET

File No. 44717

Name of Applicant (Please Print): CRAIG STEVEN

1. Please indicate type of recreational use (boating, fishing, swimming, etc.):
HUNTING

2. Please summarize how the water will be used and justify the quantity of water requested:
SEE ATTACHED

3. Please complete the following table showing estimated future water requirements:

ESTIMATED FUTURE WATER DIVERTED/STORED

NEXT 5 YEARS	WATER TO BE DIVERTED (ACRE-FEET OR GALLONS)
Year 1	<u>63 ACRE FEET</u>
Year 2	<u>'' '' ''</u>
Year 3	<u>'' '' ''</u>
Year 4	<u>'' '' ''</u>
Year 5	<u>'' '' ''</u>

Please attach any additional information, tables, or curves showing past, present and estimated future water requirements to substantiate the amount of water requested.

4. Please designate the legal description of the location where the water is to be used by providing the fractional part of the Section, Township and Range.

NORTHWEST QUARTER OF THE SOUTHWEST
QUARTER OF THE NORTHWEST QUARTER OF
SECTION 29, TOWNSHIP 24 SOUTH, RANGE 3 WEST
HARVEY COUNTY

You may attach any additional information you believe will assist in informing the Division of the WATER RESOURCES RECEIVED need for your request.

49793

My 4-acre duck pond does not hold water I am only allowed 21 acre feet of water a year and that is not adequate to get me through hunting season. I only pump water during October, November, December, and January for the duck hunting season. During these months, the farmers are not using water to irrigate their fields so I would like to request 63 acre feet of water to get me through the hunting season. The WRP developed the land to make it a wetland reserve but I can't keep enough water in the pond to attract the water fowl.

I would really appreciate you honoring my request.

If you have any questions, please call me at 316 990 0541.

WATER RESOURCES
RECEIVED

MAR 10 2017

KS DEPT OF AGRICULTURE



1320 Research Park Drive
Manhattan, Kansas 66502

Jackie McClaskey, Secretary

Phone: (785) 564-6700

Fax: (785) 564-6777

Email: ksag@kda.ks.gov

www.agriculture.ks.gov

Sam Brownback, Governor

March 10, 2017

CRAIG STEVEN
6111 W 29 N
WICHITA KS 67205

FILE COPY

RE: Application
File No. 49793

Dear Sir or Madam:

Your application for permit to appropriate water in 29-24S-03W in Harvey County, was received and has been assigned the file number noted above.

As a matter of record, the Division of Water Resources has on hand a large number of applications awaiting processing. Therefore to be fair to all concerned, and so that we can process those applications on hand in the order they were received, we intend to concentrate on the backlog of applications until the issue is resolved. Once review of your application has begun, we will contact you, if additional information is required.

In accordance with the provisions of the Kansas Water Appropriation Act, a portion of which is included below, the use of water as proposed prior to approval of the application is unlawful. Once approved, compliance with the terms, conditions and limitations of the permit is necessary. Conservation of the water resources of Kansas is required.

Section 82a-728 of the Kansas Water Appropriation Act, provides (a) except for the appropriation of water for the purpose of domestic use, . . . it shall be unlawful for any person to appropriate or threaten to appropriate water from any source without first applying for and obtaining a permit to appropriate water in accordance with the provisions of the Water Appropriation Act or for any person to violate any condition of a vested right, appropriation right or an approved application for a permit to appropriate water for beneficial use.

(b) (1) The violation of any provision of this section by any person is a class C misdemeanor . . .

A class C misdemeanor is punishable by a fine not to exceed \$500 and/or a term of confinement not to exceed one month in the county jail. Each day that the violation occurs constitutes a separate offense.

If you have any questions, please contact me at (785) 564-6645. If you wish to discuss a specific file, please have the file number ready so that we may help you more efficiently.

Sincerely,

Brent A Turney, P.G.
Change Application Unit Supervisor
Water Appropriation Program

BAT: dlw
pc: STAFFORD Field Office
GMD 2