

1320 Research Park Drive
Manhattan, Kansas 66502
(785) 564-6700



900 SW Jackson, Room 456
Topeka, Kansas 66612
(785) 296-3556

Jackie McClaskey, Secretary

Governor Sam Brownback

May 15, 2017

MERIDITH FAMILY PARTNERSHIP LP
475 N WEST ROAD
WELLINGTON KS 67152

WATER RESOURCES
RECEIVED

MAY 22 2017

Re: Pending Application, **KS DEPT OF AGRICULTURE**
File No. 49,815

Dear Sir or Madam:

The Division of Water Resources returned the above referenced application to you for additional information on April 11, 2017, and the current deadline for your response is June 5, 2017. The purpose of this letter is to provide a reminder that in order for you to retain your priority of filing, the original application and requested information needs to be returned to this office on or before **June 5, 2017**, or within any authorized extension of time thereof. According to law, default in refiling of the completed application and attachments within the time allowed shall constitute forfeiture of priority date and dismissal of the application.

If an extension of time is necessary to supply the requested information, please request the extension of time in writing before **June 5, 2017**. Provide information as to why the additional time is needed and how much additional time is requested. Please note that since there are instances when the Chief Engineer may deny your request for an extension of time, there is no guarantee that future requests for more time will be granted.

If you have any questions, please contact me at (785) 564-6631 or by email at alex.whitesell@ks.gov. If you wish to discuss a specific file, please have the file number ready so that I may help you more efficiently.

Sincerely,

A handwritten signature in black ink, appearing to read "Alex Whitesell".

Alex Whitesell
Environmental Scientist
Water Appropriation Program

pc:

IRRIGATION TEST WELL

#3
West of
River

Driller & Assistant: Logan AND Tucker Date: 3/20/17

CUSTOMER: Meredith Family Partnership 475 N. West Rd.

LOCATION: Wellington, KS 67152

- Screen 2-1/2"
- Holeplug
- Gas & Oil - W.T.
- 6" or 5" Liner if needed
- Casing 2-1/2"
- Quarters
- 3/4" Polyethylene
- Solvent & Glue
- Couplings, 2-1/2"
- Water
- 2-1/2" PVC Tee
- Water Sample Bottle
- End Caps, 2-1/2"
- Lime
- 5" & 6" Bits
- Inspection Sheet
- Gravel Pack
- Drilling Mud
- Packing

Depth:	Formation:	Well Information:
0-3'	top soil	Static Water Level: 10'
3-20'	sand fine	Est. production: 150-300 gpm
20-30'	sand medium	Casing size/depth: 2" 0-20'
30-34.5'	sand medium w/ 10% flat rocks	Screen size/depth: 2" 20'-35'
34.5-37'	shale grey	Slot size: .020
		Grouting depth:
		Number of bags: 2
		Nearest Contamination:
		Maintenance & Safety:
		Notes:

Directions:
 Latitude: 37.04653922 N decimal degrees (ex. 38.881796)
 Longitude: -97.49127875 W decimal degrees (ex. 95.373889)
 Datum: NAD27 NAD83 WGS84

WATER RESOURCES
RECEIVED
MAY 22 2017

Elevation: 1071 ft.

SW 1/4	NW 1/4	NE 1/4	SE 1/4
Sec. <u>30</u>	T <u>34</u>	R <u>2</u>	<u>W</u>
County <u>Sumner</u>			

- \$ 8⁰⁰ x 37 /ft. Well
- \$ 20⁰⁰ /Grout
- \$ N/A /Test Pumping
- \$ _____ /Water Sample
- \$ _____ /Mobilization/Travel
- \$ _____ /Discount

KS DEPT OF AGRICULTURE

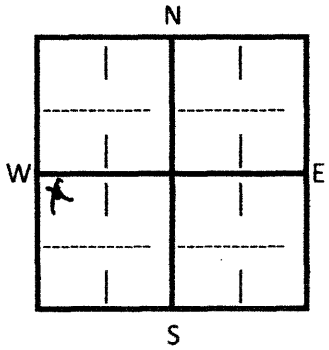

Contract Received: _____

Invoice #: 1496
 Date Mailed: 3-30-17
 Well Data: Access: _____
 Materials: Incent: N/A

THE STATE OF KANSAS



KANSAS DEPARTMENT OF AGRICULTURE

Jackie McClaskey, Secretary of Agriculture

DIVISION OF WATER RESOURCES

David W. Barfield, Chief Engineer

WATER RESOURCES RECEIVED

WATER RESOURCES RECEIVED

File Number 49815

This item to be completed by the Division of Water Resources.

MAR 31 2017

APR 05 2017

8:56

KS DEPT OF AGRICULTURE

APPLICATION FOR PERMIT TO APPROPRIATE WATER FOR BENEFICIAL USE

Filing Fee Must Accompany the Application (Please refer to Fee Schedule attached to this application form.)

UNACCEPTABLE FOR PRIORITY KS DEPT OF AGRICULTURE

WATER RESOURCES RECEIVED

To the Chief Engineer of the Division of Water Resources, Kansas Department of Agriculture, 1320 Research Park Drive, Manhattan, Kansas 66502:

MAY 22 2017

1. Name of Applicant (Please Print): MERIDITH FAMILY PARTNERESHIP, L.P. Address: 475 N. WEST ROAD City: WELLINGTON State: KS Zip Code: 67152 Telephone Number: (620) 326-2521

2. The source of water is: [] surface water in (stream) OR [x] groundwater in Chikaskia (drainage basin)

Certain streams in Kansas have minimum target flows established by law or may be subject to administration when water is released from storage for use by water assurance district members. If your application is subject to these regulations on the date we receive your application, you will be sent the appropriate form to complete and return to the Division of Water Resources.

3. The maximum quantity of water desired is 830 acre-feet OR gallons per calendar year, to be diverted at a maximum rate of 800 gallons per minute OR cubic feet per second.

Once your application has been assigned a priority, the requested maximum rate of diversion and maximum requested quantity of water under that priority number can NOT be increased. Please be certain your requested maximum rate of diversion and maximum quantity of water are appropriate and reasonable for your proposed project and are in agreement with the Division of Water Resources' requirements.

- 4. The water is intended to be appropriated for (Check use intended): (a) [] Artificial Recharge (b) [x] Irrigation (c) [] Recreational (d) [] Water Power (e) [] Industrial (f) [] Municipal (g) [] Stockwatering (h) [] Sediment Control (i) [] Domestic (j) [] Dewatering (k) [] Hydraulic Dredging (l) [] Fire Protection (m) [] Thermal Exchange (n) [] Contamination Remediation

YOU MUST COMPLETE AND ATTACH ADDITIONAL DIVISION OF WATER RESOURCES FORM(S) PROVIDING INFORMATION TO SUBSTANTIATE YOUR REQUEST FOR THE AMOUNT OF WATER FOR THE INTENDED USE REFERENCED ABOVE.

For Office Use Only: F.O. 1 GMD Meets K.A.R. 5-3-1 (YES/NO) Use IRR Source @/S County By Date 4/5/17 Code R&S Fee \$400 TR # Receipt Date 4/5/17 Check # 4528

SCANNED

4/16/2017 ULM

5. The location of the proposed wells, pump sites or other works for diversion of water is:

Note: For the application to be accepted, the point of diversion location must be described to at least a 10 acre tract, unless you specifically request a 60 day period of time in which to locate the site within a specifically described, minimal legal quarter section of land.

well 1 * (A) One in the N/W quarter of the NW quarter of the SW quarter of Section 36, more particularly described as being near a point 2031 feet North and 5251 feet West of the Southeast corner of said section, in Township 34 South, Range 2 East (West) (circle one), Sumner County, Kansas.

PLEASE ALLOW
30 DAYS

Well 2 (B) One in the NW quarter of the NW quarter of the SW quarter of Section 36, more particularly described as being near a point 2016 feet North and 5020 feet West of the Southeast corner of said section, in Township 34 South, Range 2W East (West) (circle one), SUMNER County, Kansas.

TO LOCATE

WELL 3 (C) One in the SW quarter of the NW quarter of the SW quarter of Section 36, more particularly described as being near a point 1533 feet North and 5261 feet West of the Southeast corner of said section, in Township 34 South, Range 2 East (West) (circle one), SUMNER County, Kansas.

WELL 4 (D) One in the SW quarter of the NW quarter of the SW quarter of Section 36, more particularly described as being near a point 1537 feet North and 4885 feet West of the Southeast corner of said section, in Township 34 South, Range 2 East (West) (circle one), SUMNER County, Kansas.

If the source of supply is groundwater, a separate application shall be filed for each proposed well or battery of wells, except that a single application may include up to four wells within a circle with a quarter (1/4) mile radius in the same local source of supply which do not exceed a maximum diversion rate of 20 gallons per minute per well.

A battery of wells is defined as two or more wells connected to a common pump by a manifold; or not more than four wells in the same local source of supply within a 300 foot radius circle which are being operated by pumps not to exceed a total maximum diversion rate of 800 gallons per minute and which supply water to a common distribution system.

6. The owner of the point of diversion, if other than the applicant is (please print):

(name, address and telephone number)

(name, address and telephone number)

You must provide evidence of legal access to, or control of, the point of diversion from the landowner or the landowner's authorized representative. Provide a copy of a recorded deed, lease, easement or other document with this application. In lieu thereof, you may sign the following sworn statement:

I have legal access to, or control of, the point of diversion described in this application from the landowner or the landowner's authorized representative. I declare under penalty of perjury that the foregoing is true and correct.

Executed on 3/29, 20 17. Kerry Bert Meredith
Applicant's Signature

The applicant must provide the required information or signature irrespective of whether they are the landowner. Failure to complete this portion of the application will cause it to be unacceptable for filing and the application will be returned to the applicant.

7. The proposed project for diversion of water will consist of 4 WELLS
(number of wells, pumps or dams, etc.)

and (was)(will be) completed (by) AS SOON AS POSSIBLE
(Month/Day/Year - each was or will be completed)

8. The first actual application of water for the proposed beneficial use was or is estimated to be 2017
(Mo/Day/Year)

* AW/DWR Per Email
WATER RESOURCES
RECEIVED

WATER RESOURCES
RECEIVED

WATER RESOURCES
RECEIVED

MAY 22 2017

APR 05 2017

UNACCEPTABLE FOR PRIORITY

KS DEPT OF AGRICULTURE

KS DEPT OF AGRICULTURE

KS DEPT OF AGRICULTURE

SCANNED

- 9. Will pesticide, fertilizer, or other foreign substance be injected into the water pumped from the diversion works?
 Yes No If "yes", a check valve shall be required.

All chemigation safety requirements must be met including a chemigation permit and reporting requirements.

- 10. If you are planning to impound water, please contact the Division of Water Resources for assistance, prior to submitting the application. Please attach a reservoir area capacity table and inform us of the total acres of surface drainage area above the reservoir.

Have you also made an application for a permit for construction of this dam and reservoir with the Division of Water Resources? Yes No

- If yes, show the Water Structures permit number here _____
- If no, explain here why a Water Structures permit is not required _____

- 11. The application must be supplemented by a U.S.G.S. topographic map, aerial photograph or a detailed plat showing the following information. On the topographic map, aerial photograph, or plat, identify the center of the section, the section lines or the section corners and show the appropriate section, township and range numbers. Also, please show the following information:

- (a) The location of the proposed point(s) of diversion (wells, stream-bank installations, dams, or other diversion works) should be plotted as described in Paragraph No. 5 of the application, showing the North-South distance and the East-West distance from a section line or southeast corner of section.
- (b) If the application is for groundwater, please show the location of any existing water wells of any kind within 1/2 mile of the proposed well or wells. Identify each existing well as to its use and furnish the name and mailing address of the property owner or owners. If there are no wells within 1/2 mile, please advise us.
- (c) If the application is for surface water, the names and addresses of the landowner(s) 1/2 mile downstream and 1/2 mile upstream from your property lines must be shown.
- (d) The location of the proposed place of use should be shown by crosshatching on the topographic map, aerial photograph or plat.
- (e) Show the location of the pipelines, canals, reservoirs or other facilities for conveying water from the point of diversion to the place of use.

A 7.5 minute U.S.G.S. topographic map may be obtained by providing the section, township and range numbers to: Kansas Geological Survey, 1930 Constant, Campus West, University of Kansas, Lawrence, Kansas 66047.

- 12. List any application, appropriation of water, water right, or vested right file number that covers the same diversion points or any of the same place of use described in this application. Also list any other recent modifications made to existing permits or water rights in conjunction with the filing of this application.

WATER RESOURCES RECEIVED

MAY 22 2017

KS DEPT OF AGRICULTURE

WATER RESOURCES RECEIVED

APR 05 2017

KS DEPT OF AGRICULTURE

WATER RESOURCES RECEIVED

UNACCEPTABLE PRIORITY

KS DEPT OF AGRICULTURE SCANNED

13. Furnish the following well information if the proposed appropriation is for the use of groundwater. If the well has not been completed, give information obtained from test holes, if available.

Information below is from: Test holes Well as completed Drillers log attached

Well location as shown in paragraph No.	(A)	(B)	(C)	(D)
Date Drilled	_____	_____	_____	_____
Total depth of well	_____	_____	_____	_____
Depth to water bearing formation	_____	_____	_____	_____
Depth to static water level	_____	_____	_____	_____
Depth to bottom of pump intake pipe	_____	_____	_____	_____

14. The relationship of the applicant to the proposed place where the water will be used is that of

OWNER
(owner, tenant, agent or otherwise)

15. The owner(s) of the property where the water is used, if other than the applicant, is (please print):

(name, address and telephone number)

(name, address and telephone number)

16. The undersigned states that the information set forth above is true to the best of his/her knowledge and that this application is submitted in good faith.

Dated at Wellyton, Kansas, this 29th day of MARCH, 2017.
(month) (year)

MERIDITH FAMILY PARTNERSHIP, L.P.
BY: MERIDITH MANAGEMENT COMPANY, L.C.
BY: Billy Bert Meridith
BILLY BERT MERIDITH, MEMBER-MANAGER
As Managing General Partner of
Meridith Family Partnership, L.P.

By _____
(Agent or Officer Signature)

(Agent or Officer - Please Print)

Assisted by Paul Miller Transition Director Date: 3-29-17
(office/title)

WATER RESOURCES RECEIVED
MAY 22 2017
KS DEPT OF AGRICULTURE

WATER RESOURCES RECEIVED
APR 05 2017
KS DEPT OF AGRICULTURE

WATER RESOURCES RECEIVED
UNACCEPTABLE PRIORITY
KS DEPT OF AGRICULTURE
SCANNED

49815

Property Detail Information

SUMNER COUNTY MISSOURI

Generated: 3/29/2017 4:27:10 PM

Report for Parcel No. 096-331-01-0-00-01-004.00-0 (Quick Ref. ID R17620)

Property Physical Characteristics

187 W 170TH ST S, Caldwell, KS 67022

Owner Information

GOBLE, RICHARD &
JOYCE - (P)

PO BOX 144
SOUTH HAVEN, KS 67140

Land Parcel Description

S01, T35, R02W, ACRES 4.2, BEG 1412'W & 70'S NE COR NW4, TH S370', E180', S292', W380', N662', E200' TO POB & LESS ROW (PARTS GOVT LTS 3-5)

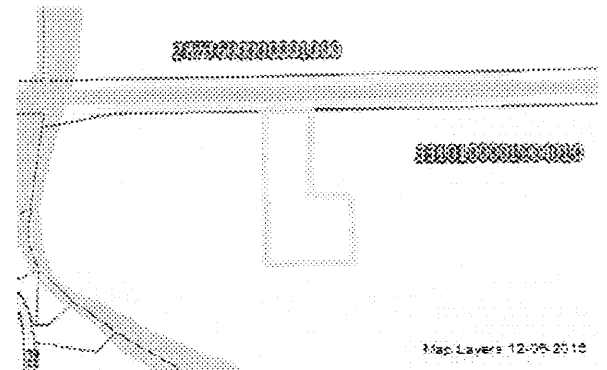

Property Details

Topography	Level - 1
Utilities	Well - 5 Septic - 6 Gas - 7
Access	Paved Road - 1
Fronting	Major Strip or CBD - 1
Location	Neighborhood or Spot - 6
Parking Type	On and Off Street - 3
Parking Quantity	Adequate - 2
Parking Proximity	On Site - 3
Covered Parking	Not Available
Uncovered Parking	Not Available

WATER RESOURCES
RECEIVED

MAY 22 2017

KS DEPT OF AGRICULTURE

WATER RESOURCES
RECEIVED

APR 05 2017

KS DEPT OF AGRICULTURE

WATER RESOURCES
RECEIVED
UNACCEPTABLE FOR PRIORITY
MAR 31 2017

KS DEPT OF AGRICULTURE

SCANNED

49815

A

Property Search Listing - Tax Year 2017

LCIS THOMSON REUTERS

1 of 1

SUMNER COUNTY KANSAS

Generated: 3/29/2017 4:08:14 PM

PARCEL ID	PARCEL TYPE	OWNER INFORMATION	PROPERTY (TAX) ADDRESS	MAILING ADDRESS	TOTAL TAXES
096-287-35-0-00-002.01-0	R309258	SPROUL, MIKE O;REV TR (P)	220 W 170TH ST S, Caldwell, KS 67022 Acres = 8.00 NeighborhoodCode = 603.0	PO BOX 781582 WICHITA, KS 67278	\$ 215,290 Total

WATER RESOURCES
RECEIVED

MAY 22 2017

KS DEPT OF AGRICULTURE

WATER RESOURCES
RECEIVED

APR 05 2017

KS DEPT OF AGRICULTURE

WATER RESOURCES
RECEIVED
UNACCEPTABLE FOR PRIORITY
MAR 31 2017

KS DEPT OF AGRICULTURE

SCANNED

**IRRIGATION USE
SUPPLEMENTAL SHEET**

File No. _____

Name of Applicant (Please Print) MERIDITH FAMILY PARTNERSHIP LP

1. Please supply the name and address of each landowner, the legal description of the lands to be irrigated, and designate the actual number of acres to be irrigated in each forty acre tract or fractional portion thereof:

Landowner of Record NAME: MERIDITH FAMILY PARTNERSHIP LP
 ADDRESS: 425 N WEST ROAD WELLINGTON KS 67152

S	T	R	NE¼				NW¼				SW¼				SE¼				TOTAL
			NE	NW	SW	SE	NE	NW	SW	SE	NE	NW	SW	SE	NE	NW	SW	SE	
36	34s	2w	40	40	40	40	40	40	40	40	40	40	40	40	40	40	40	40	640

Landowner of Record NAME: _____
 ADDRESS: _____

S	T	R	NE¼				NW¼				SW¼				SE¼				TOTAL
			NE	NW	SW	SE	NE	NW	SW	SE	NE	NW	SW	SE	NE	NW	SW	SE	

Landowner of Record NAME: _____
 ADDRESS: _____

S	T	R	NE¼				NW¼				SW¼				SE¼				TOTAL
			NE	NW	SW	SE	NE	NW	SW	SE	NE	NW	SW	SE	NE	NW	SW	SE	

WATER RESOURCES RECEIVED
 MAY 22 2017

KS DEPT OF AGRICULTURE

2. Please complete the following information for the description of the operation for the irrigation project. Attach supplemental sheets as needed.

a. Indicate the soils in the field(s) and their intake rates:

Soil Name	Percent of field (%)	Intake Rate (in/hr)	Irrigation Design Group
_____	_____	_____	_____
_____	_____	_____	_____
_____	_____	_____	_____
Total:	100 %	_____	_____

b. Estimate the average land slope in the field(s): 2 %

Estimate the maximum land slope in the field(s): 3 %

c. Type of irrigation system you propose to use (check one):

- Center pivot ___ Center pivot - LEPA ___ "Big gun" sprinkler
- ___ Gravity system (furrows) ___ Gravity system (borders) ___ Sideroll sprinkler

Other, please describe: _____

d. System design features:

i. Describe how you will control tailwater:

NO TAIL WATER

ii. For sprinkler systems:

(1) Estimate the operating pressure at the distribution system: 35 psi

(2) What is the sprinkler package design rate? _____ gpm

(3) What is the wetted diameter (twice the distance the sprinkler throws water) of a sprinkler on the outer 100 feet of the system? 65 feet

(4) Please include a copy of the sprinkler package design information.

WATER RESOURCES RECEIVED

e. Crop(s) you intend to irrigate. Please note any planned crop rotations:

Corn, Soybeans, wheat, Alfalfa and Cotton

MAY 22 2017

KS DEPT OF AGRICULTURE

f. Please describe how you will determine when to irrigate and how much water to apply (particularly important if you do not plan a full irrigation).

CROP REQUIREMENTS AND FIELD CONDITIONS

You may attach any additional information you believe will assist in informing the Division of the need for your request.

WATER RESOURCES RECEIVED

APR 05 2017

KS DEPT OF AGRICULTURE

WATER RESOURCES RECEIVED

UNACCEPTABLE PRIORITY

KS DEPT OF AGRICULTURE

Page 2 of 2

SCANNED

3/29/2017
(Date)

Kansas Department of Agriculture
Division of Water Resources
David W. Barfield, Chief Engineer
1320 Research Park Drive
Manhattan, Kansas 66502

Re: Application
File No. _____

Minimum Desirable Streamflow

Dear Sir:

I understand that a Minimum Desirable Streamflow requirement has been established by the legislature for the source of supply to which the above referenced application applies.

I understand that diversion of water pursuant to this application will be subject to regulation any time Minimum Desirable Streamflow requirements are not being met.

I also understand that if this application is approved, there could be times, as determined by the Division of Water Resources, when I would not be allowed to divert water. I realize that this could affect the economics of my decision to appropriate water.

I am aware of the above factors, and with the knowledge thereof, request that the Division of Water Resources proceed with processing and approval, if possible, of the above referenced application.

MERIDITH FAMILY PARTNERSHIP, L.P.
BY: MERIDITH MANAGEMENT COMPANY, L.C.
Billy Bert Meredith
BILLY BERT MERIDITH, MEMBER MANAGER
As Managing General Partner of
Meridith Family Partnership, L.P.

State of Kansas)
County of SUMNER) ss

(Print Applicant's Name)

I hereby certify that the foregoing instrument was signed in my presence and before me this 24 day of MARCH, 2017.

WATER RESOURCES RECEIVED

MAY 22 2017

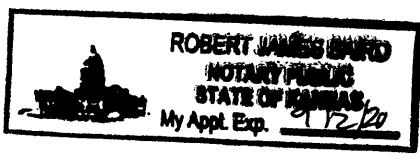

[Signature]
Notary Public
KS DEPT OF AGRICULTURE

My Commission Expires: 9/2/20

WATER RESOURCES RECEIVED

WATER RESOURCES RECEIVED

APR 05 2017

MAR 31 2017
UNACCEPTABLE FOR PRIORITY
KS DEPT OF AGRICULTURE

All wells of any kind within 1/2 mile of the
Requested Point of diversion have been plotted.

49815

DELORME

XMap® 8



MIKE SPROUL Rev TR
 PO BOX 781582
 WICHITA KS
 67278
 SEE FOLLOWING

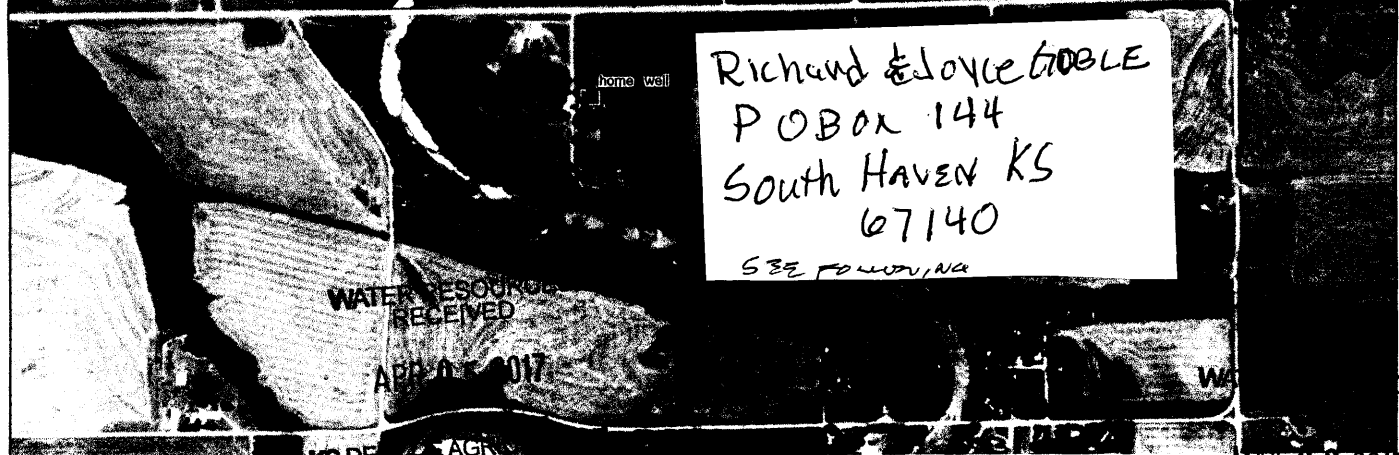

WATER RESOURCES
 RECEIVED
 APR 05 2017

Richard & Joyce Goble
 P O Box 144
 South Haven KS
 67140
 SEE FOLLOWING

Data use subject to license.
 © DeLorme. XMap® 8.
 www.delorme.com

PLANS OF USE
 Dom. Well X
 SECTION CORNER +

UNACCEPTABLE FOR PRIORITY
 MAR 31 2017

KS DEPT OF AGRICULTURE

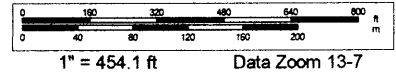

KS DEPT OF AGRICULTURE
 Scale 1: 44,400

MAY 22 2017

SCANNED

49815

**MINIMUM DESIRABLE STREAMFLOW FORM TO BE USED WHEN
APPLICABLE WHEN FILING AN APPLICATION FOR PERMIT
TO APPROPRIATE WATER FOR BENEFICIAL USE**

The Kansas Legislature has established minimum desirable streamflows for the streams listed below. If your proposed diversion of water is going to be from one of these watercourses or adjacent alluvial aquifers, please complete the back side of this page and submit it along with your application for permit to appropriate water.

- | | |
|---------------------------------|----------------------------|
| Arkansas River | Ninnescah River |
| Big Blue River | North Fork Ninnescah River |
| Chapman Creek | Rattlesnake Creek |
| Chikaskia River | Republican River |
| Cottonwood River | Saline River |
| Delaware River | Smoky Hill River |
| Little Arkansas River | Solomon River |
| Little Blue River | South Fork Ninnescah |
| Marais des Cygnes River | Spring River |
| Medicine Lodge River | Walnut River |
| Mill Creek (Wabaunsee Co. area) | Whitewater River |
| Neosho River | |

WATER RESOURCES
RECEIVED

MAY 22 2017

KS DEPT OF AGRICULTURE

WATER RESOURCES
RECEIVED

APR 05 2017

KS DEPT OF AGRICULTURE

WATER RESOURCES
RECEIVED

UNACCEPTABLE FOR PRIORITY
MAR 31 2017

KS DEPT OF AGRICULTURE

SCANNED

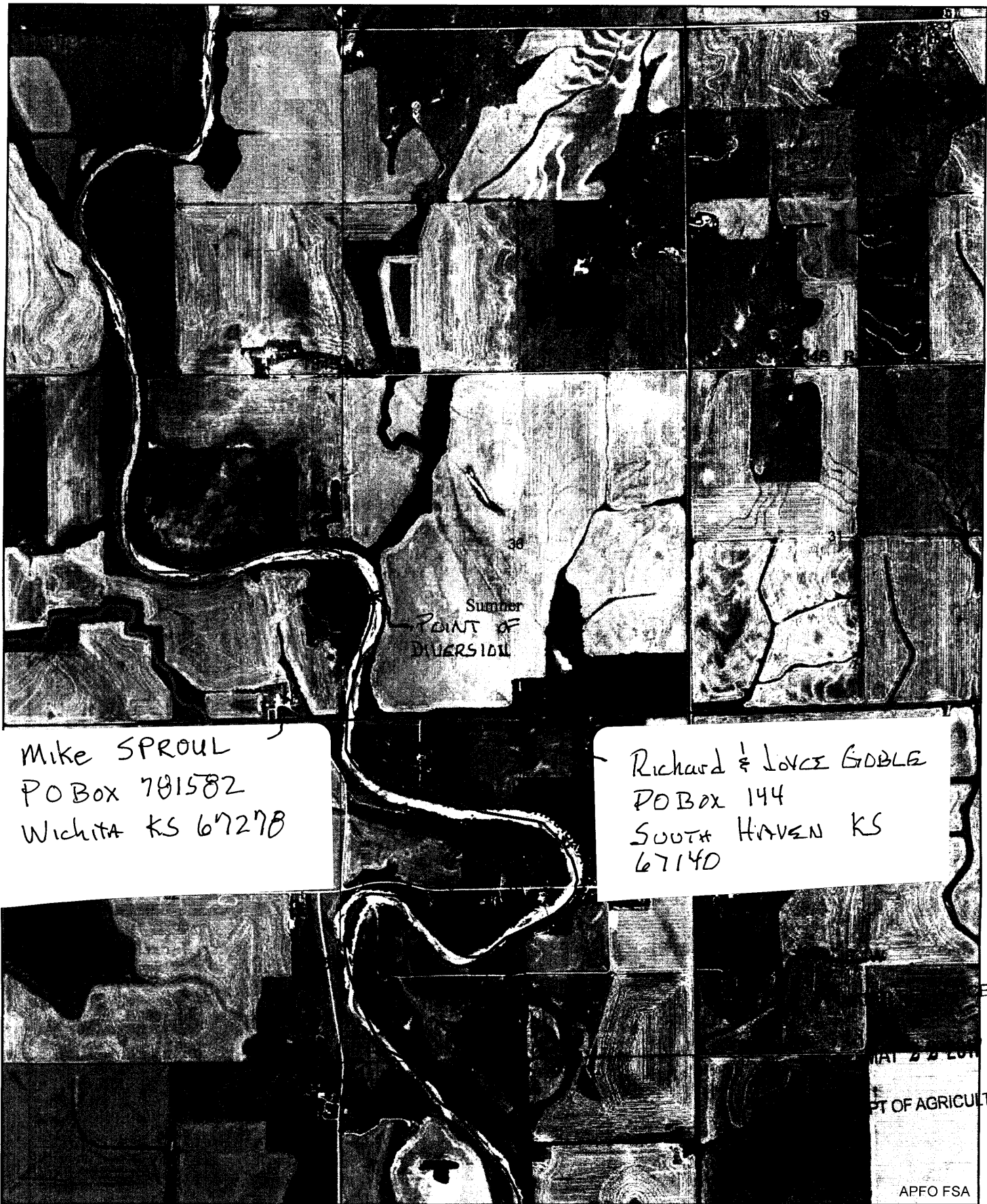

All wells of any kind within 1/2 mile of the requested point of diversion have been plotted.

Signature: Rise Meredith

ajw/dwr
Date: 4/11/2017

