

# CHECK SHEET Short Change

(To be completed and attached to each application)

File No. SG-01

Field Office No. 2

GMD No. \_\_\_\_\_

1. **Plugging agreement obtained for GMD?** Yes  No  Non Applicable
2. **Is Landowner correct as currently shown in WRIS?** Yes  No  **Address Change?** NO  
If applicable, list Place of Use Overlap File Nos. \_\_\_\_\_

3. **Is Water Use Correspondent correct as currently shown in WRIS?** Yes  No  **Address Change?** NO  
Name of Former WUC --- \_\_\_\_\_ Name of New WUC --- \_\_\_\_\_

4. a. **Point of diversion computer ID No(s).** 72 & 73 **for point(s) being changed.**
- b. **Show feet distances from the** SE **corner of the section for the new point(s) of diversion:**  
See Attached Supplemental Sheet

Action	PDIV ID	Geo Ctr?	Sec	Twp	Rng	'N	'W	County	Qualifiers
NO CHG	4292	NO							
NO CHG	18499	NO							
NO CHG	24693	NO							

- c. **If multiple points of diversion exist and rates and quantities are individually assigned, show:**
- | Old PDIV ID                              | Authorized Rate | Additional Rate | Authorized Quantity | Additional Quantity |
|--|-----------------|-----------------|---------------------|---------------------|
| <i>No Changes to Rates or Quantities</i> |                 |                 |                     |                     |
| _____                                    | _____ gpm       | _____ gpm       | _____ mgd           | _____ mgd           |
| _____                                    | _____ gpm       | _____ gpm       | _____ mgd           | _____ mgd           |
- d. **Name of Drainage Basin** Arkansas River **Is this correctly shown in WRIS?**  Yes  No
- e. **Formation Name & No.** MAIN STEM ALLUVIUM (113) **Special Use Area** --- \_\_\_\_\_

5. **Distances from the previous/original p/d:** \_\_\_\_\_ ' N / S \_\_\_\_\_ ' E / W

**6. WATER RIGHT ACTION TRAIL COMMENTS**

1/30/2017 Change Application Received (date accepted for priority)  
3 / 08 / 2017 Change Approved  
Notice and Proof by 12/31/2017  
\_\_\_\_\_/\_\_\_\_\_/\_\_\_\_\_ Completion Requirement Removed (Change No. C\_\_\_\_\_)

**7. METER ACTION TRAIL COMMENTS**

3 / 08 / 2017 DWR Meter Required by 12/31/2017  
\_\_\_\_\_/\_\_\_\_\_/\_\_\_\_\_ Anti-Reverse Meter Required by \_\_\_\_\_/\_\_\_\_\_/\_\_\_\_\_  
\_\_\_\_\_/\_\_\_\_\_/\_\_\_\_\_ Meter Seal Required by \_\_\_\_\_/\_\_\_\_\_/\_\_\_\_\_

8. Base Acres --- \_\_\_\_\_ Year --- \_\_\_\_\_ Minimum Reasonable Quantity --- \_\_\_\_\_

Date Created 1/30/17 by TJS  
Date Entered \_\_\_\_\_ by \_\_\_\_\_

**CHECK SHEET ATTACHMENT**

9. Changes to the place of use will be:

File Number SG-01

Action	Owner Person ID	Place Use ID #	Sec.	Twp.	Range	NE¼				NW¼				SW¼				SE¼				TOTAL ACRES	
						NE¼	NW¼	SW¼	SE¼	NE¼	NW¼	SW¼	SE¼	NE¼	NW¼	SW¼	SE¼	NE¼	NW¼	SW¼	SE¼		
NO CHG	19449					Acres Authorized																	
						New Acres																	
						Acres Authorized																	
						New Acres																	
						Acres Authorized																	
						New Acres																	
						Acres Authorized																	
						New Acres																	

Names and Address:

1. Person ID # <u>19449</u>  CITY OF WICHITA PUBLIC WORKS & UTILITIES-WTP 455 N MAIN ST 8TH FLOOR WICHITA KS 67202	2. Person ID # _____  _____ _____ _____ _____	3. Person ID # _____  _____ _____ _____ _____
---	--	--

**GENERAL INSTRUCTIONS**

1. Give to Applicant:
  - a. Original application/approval
  - b. Original receipt (one for each application)
  - c. Information packet containing:
    - Notice and Proof form
    - Water Meter Specifications
    - Acceptable Meter list
    - Water level measurement tube specifications.
    - Check Valve specifications
    - Pink Sheet - K.S.A. 82a-728 letter
    - Form stating to record in Register of Deeds Office (OPTIONAL AS NEEDED)

2. Send to headquarters:
  - a. Good, **scannable** copy of application and/or approval and this check sheet
  - b. Original check and copy of receipt
  - c. Test hole log
  - d. GMD recommendation, if any
  - e. Map or aerial photograph, if any
3. Send to KDHE: Letter (KDHE.LT) advising of location of abandoned well.

4. Date stamp received and approved.
5. Complete ownership and WUC change information.

ADDITIONAL PHOTOCOPIES

HQ \_\_\_\_\_  
 \_\_\_\_\_  
 \_\_\_\_\_  
 \_\_\_\_\_  
 \_\_\_\_\_  
 \_\_\_\_\_  
 \_\_\_\_\_  
 \_\_\_\_\_

CONDITIONS

1. Insert notice and proof date.
2. Type or print applicant's/owner's name on line.
3. Complete notary statement.

# CHECK SHEET Supplemental Page

(To be completed and attached to each application)

File No. SG-01

Field Office No. 2

GMD No. \_\_\_\_\_

4.a. Point of diversion computer ID No(s). 72 & 73 for point(s) being changed.

b. Show feet distances from the SE corner of the section for the new point(s) of diversion:

Action	PDIV ID	Geo Ctr?	Sec	Twp	Rng	'N	'W	County	Qualifiers
NO CHG	46190	NO							
NO CHG	60809	NO							
DEL	79100	NO	18	27S	1E	2200	5100	Sedgwick	NW NW SW
*ENT		NO	18	27S	1E	2489	5065	Sedgwick	NW NW SW
DEL	79101	NO	18	27S	1E	1200	4900	Sedgwick	NW SW SW
**ENT		NO	18	27S	1E	1736	4903	Sedgwick	SW NW SW
NO CHG	79102	NO							

c. If multiple points of diversion exist and rates and quantities are individually assigned, show:

Authorized Rate                  Additional Rate                  Authorized Quantity                  Additional Quantity

No Changes to Rates or Quantities

d. Name of Drainage Basin Arkansas River Is this correctly shown in WRIS?  Yes  No

e. Formation Name & No. MAIN STEM ALLUVIUM (113) Special Use Area ---

5. \* Distances from the previous p/d:                  136 ' N                  35 ' W

\*\* Distances from the previous p/d:                  162 ' N                  38 ' W

Submit completed application to:  
 Kansas Department of Agriculture  
 Division of Water Resources  
 Field Office for your area.  
 Call for address:

Topeka -- (785) 296-5733  
 Stafford -- (620) 234-5311  
 Stockton -- (785) 425-6787  
 Garden City -- (620) 276-2901  
<http://agriculture.ks.gov/dwr>

## DWR FIELD OFFICE APPLICATION FOR APPROVAL TO CHANGE THE PLACE OF USE AND/OR THE POINT OF DIVERSION WATER METER REQUIRED



STATE OF KANSAS

Filing Fee Must Accompany the Application, K.S.A. 82a-708b(b), as amended.  
 Fee Schedule is on the third page of this application form.

Paragraph Nos. 1, 2, 3 & 5 must be completed. Complete all other applicable portions. If change in point of diversion is greater than 100 feet, or if place of use will be changed, include a topographic map or detailed plat showing the authorized and proposed point(s) of diversion and/or place of use.

RECEIVED  
 9:47am  
 JAN 30 2017

File No. SG001

1. Application is hereby made for approval of the Chief Engineer to change the (check one or both):

Place of Use       Point of Diversion

Stafford Field Office  
 Division of Water Resources

under the water right which is the subject of this application in accordance with the conditions described below.

The source of supply is:       Groundwater       Surface water

2. Name and address of Applicant: City of Wichita, Public Works & Utilities

455 N Main St 8<sup>th</sup> Floor, Wichita KS 67202

Phone Number: (316)269-4675

Email address: ---

Name and address of Water Use Correspondent: City of Wichita, Public Works & Utilities

455 N Main St 8<sup>th</sup> Floor, Wichita KS 67202

Phone Number: (316)269-4675

Email address: ---

3. The presently authorized place of use is:

Owner of Land ---- NAME: City of Wichita

ADDRESS: \_\_\_\_\_

(If there is more than one landowner, attach supplemental sheets as necessary.)

Sec.	Twp.	Range	NE¼				NW¼				SW¼				SE¼				TOTAL ACRES
			NE¼	NW¼	SW¼	SE¼	NE¼	NW¼	SW¼	SE¼	NE¼	NW¼	SW¼	SE¼	NE¼	NW¼	SW¼	SE¼	

4. If this application is for a change in place of use, it is proposed that the place of use be changed to:

Owner of Land ---- NAME: No Change

ADDRESS: \_\_\_\_\_

(If there is more than one landowner, attach supplemental sheets as necessary.)

Sec.	Twp.	Range	NE¼				NW¼				SW¼				SE¼				TOTAL ACRES
			NE¼	NW¼	SW¼	SE¼	NE¼	NW¼	SW¼	SE¼	NE¼	NW¼	SW¼	SE¼	NE¼	NW¼	SW¼	SE¼	

For Office Use Only: Code \_\_\_\_\_ Fee \$ 100 TR # \_\_\_\_\_ Receipt Date \_\_\_\_\_ Check # VISA

5. **Presently authorized point of diversion: City Well S-1**

One in the \_\_\_\_\_ Quarter of the \_\_\_\_\_ Quarter of the \_\_\_\_\_ Quarter of Section 18, Township 27 South, Range 1 E, in Sedgwick County, Kansas, 700 feet North 3000 feet West of Southeast corner of section. Authorized Rate 1532 GPM Authorized Quantity 91.7 MGY Depth of well \_\_\_\_\_ (feet) (DWR use only: Computer ID No. 3 GPS \_\_\_\_\_ feet North \_\_\_\_\_ feet West)

This point will not be changed  This point will be changed as follows:

**Proposed point of diversion: (Complete only if change is requested)**

One in the \_\_\_\_\_ Quarter of the \_\_\_\_\_ Quarter of the \_\_\_\_\_ Quarter of Section \_\_\_\_\_, Township \_\_\_\_\_ South, Range \_\_\_\_\_ E, in Sedgwick County, Kansas, \_\_\_\_\_ feet North \_\_\_\_\_ feet West of Southeast corner of section. Proposed Rate \_\_\_\_\_ Proposed Quantity \_\_\_\_\_ Proposed well depth (feet) \_\_\_\_\_

This point is:  Additional Well  Geo Center List other water rights that will use this point 540

6. **Presently authorized point of diversion: City Well S-2**

One in the \_\_\_\_\_ Quarter of the \_\_\_\_\_ Quarter of the \_\_\_\_\_ Quarter of Section 18, Township 27 South, Range 1 E, in Sedgwick County, Kansas, 950 feet North 3450 feet West of Southeast corner of section. Authorized Rate 1920 GPM Authorized Quantity ~~82.2~~ MGY Depth of well \_\_\_\_\_ (feet) (DWR use only: Computer ID No. 4 GPS 84.2 MGY feet North \_\_\_\_\_ feet West)

This point will not be changed  This point will be changed as follows: SM 1/12/17

**Proposed point of diversion: (Complete only if change is requested)**

One in the \_\_\_\_\_ Quarter of the \_\_\_\_\_ Quarter of the \_\_\_\_\_ Quarter of Section \_\_\_\_\_, Township \_\_\_\_\_ South, Range \_\_\_\_\_ (E/W), in \_\_\_\_\_ County, Kansas, \_\_\_\_\_ feet North \_\_\_\_\_ feet West of Southeast corner of section. Proposed Rate \_\_\_\_\_ Proposed Quantity \_\_\_\_\_ Proposed well depth (feet) \_\_\_\_\_

This point is:  Additional Well  Geo Center List other water rights that will use this point 540

7. Why do you need a new point of diversion? \_\_\_\_\_  
Previous well not properly located

13a. If the proposed point of diversion will be relocated within 100 feet of the existing point of diversion, indicate its location on the diagram below in relation to the existing point of diversion. (PLEASE NOTE: The "X" in center of diagram below represents presently authorized point of diversion.)

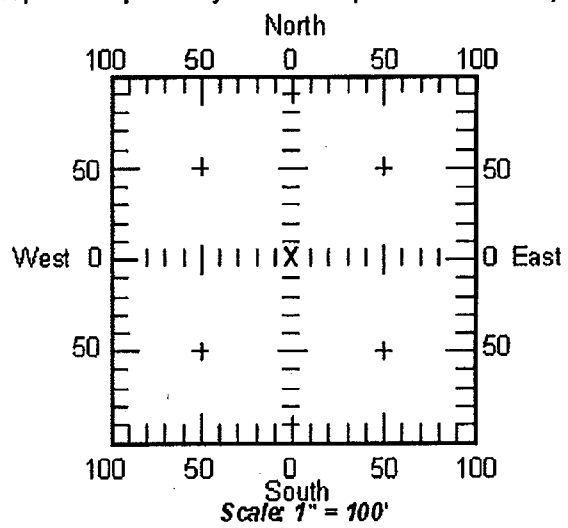

8. If a well, is the test hole log attached?  Yes  No

9. When do you propose to complete the new point of diversion?  
Already completed

10. If the point of diversion is a well:  
 (a) What are you going to do with the old well?  
NA  
 (b) When will this be done? NA

11. Groundwater Management District recommendation attached?  Yes  No

12. Assisted by TJS - SFFO

13b. If the proposed point of diversion will be relocated more than 100 feet but within 2640 feet from the existing point of diversion, attach a topographic map or aerial photograph. For groundwater sources, show all wells (including domestic) within one-half mile of the proposed point of diversion and the names and mailing addresses of the owners. For surface water sources, show the names and addresses of the landowner(s) one-half mile downstream and one-half mile upstream from your property lines.

14. If the proposed groundwater point of diversion is 300 or fewer feet from existing point of diversion, complete the following:
- (a) Does the undersigned represent all owners of the currently authorized place(s) of use identified in this application?  
 Yes     No    (If no, all owners must sign this application.)
  - (b) Will the ownership interest of any owner of the currently authorized place(s) of use identified in this application be adversely affected if this application is approved as requested?  
 Yes     No    (If yes, all owners must sign this application.)
  - (c) If this application is not approved expeditiously, will there be substantial damage to property, public health or safety?  
 Yes     No    (If no, all owners must sign this application.)

If the application proposes a surface water change in point of diversion, a groundwater change in point of diversion greater than 300 feet, or a change in place of use, the application must be signed by all owners of the currently authorized place of use, or their duly authorized agent (attach notarized statement authorizing representation).

I hereby verify, being first duly sworn upon my oath or affirmation and under penalty of perjury, that I am of lawful age and the owner, the spouse of the owner, or a duly authorized agent of the owner(s) to make this application on their behalf, in regard to the water right(s) to which this application pertains. I further verify that the statements contained in this application are true, correct and complete.

Dated at WICHITA, Kansas, this 12<sup>th</sup> day of January, 20 17.

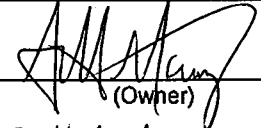
 (Owner)	(Spouse)
<u>Scott A Macey, Jr.</u> (Please Print)	(Please Print)
(Owner)	(Spouse)
(Please Print)	(Please Print)
(Owner)	(Spouse)
(Please Print)	(Please Print)

State of Kansas }  
 County of Sedgwick } SS

  
 CATHERINE M. WATKINS  
 NOTARY PUBLIC  
 STATE OF KANSAS  
 My Appt. Exp. 1-14-18

I hereby certify that the foregoing application was signed in my presence and sworn to before me this 12<sup>th</sup> day of January, 20 17.

  
 Notary Public

My Commission Expires 1-14-2018.

**ONLY COMPLETE APPLICATIONS WILL BE PROCESSED.** To be complete, all of the applicable portions of the application form must be completed with accurate information; maps, if necessary, must be included; signatures of all the appropriate owners' must be affixed to the application and notarized; and the appropriate fee must be paid.

**FEE SCHEDULE**

Each application to change the place of use or the point of diversion under this section shall be accompanied by the application fee set forth in the schedule below: Make checks payable to: **Kansas Department of Agriculture**

(1) Application to change a point of diversion 300 feet or less .....	\$100
(2) Application to change a point of diversion more than 300 feet .....	\$200
(3) Application to change the place of use .....	\$200

**RECEIVED**  
 File No. SG-001  
**JAN 30 2017**  
 Stafford Field Office  
 Division of Water Resources

**SUMMARY ORDER APPROVING APPLICATION FOR CHANGE AND IMPOSING CONDITIONS**

This Summary Order is issued under authority of K.S.A. 82a-708b, as amended, and K.A.R. 5-14-3 and other applicable provisions of the *Kansas Water Appropriation Law, K.S.A. 82a-701 et. seq.*, and rules and regulations promulgated thereunder, K.A.R. 5-1-1 *et. seq.* With the exception of those conditions expressly contained herein, this Summary Order does not change the terms, conditions and limitations of File No. SG-001, ID 72.

1. A change application was received on 1/30/17 requesting that the place of use and / or point of diversion authorized under the above-referenced file number be changed as described in the application.
2. On and after the effective date of this summary order, the authorized place(s) of use shall be located substantially as shown on the topographic map accompanying the application to change the place of use.  Applicable  Not Applicable
3. The change in point of diversion shall not impair existing rights and shall be limited to the same source or sources of water as previously authorized. The point of diversion authorized by this summary order shall be located within a 50 foot radius of the authorized point(s) of diversion.  Applicable  Not Applicable
4. The point(s) of diversion authorized herein shall not actually be located more than 191 feet from the previously authorized point(s) of diversion.  Applicable  Not Applicable
5. As required by K.A.R. 5-3-5d, if the works for diversion is a well with a diversion rate of 100 gallons per minute or more, a tube or other device suitable for making water level measurements shall be installed, operated and maintained in accordance with K.A.R. 5-6-13.  Applicable  Not Applicable
6. The owner of the authorized place(s) of use shall properly install an acceptable water flow meter on or before **December 31, 2017**, or before the first use of water, whichever occurs first. The water flow meter shall be installed, operated and maintained in accordance with K.A.R. 5-1-4 through 5-1-12. As required by K.S.A. 82a-732, as amended, and K.A.R. 5-3-5e, the owner shall maintain records and report the reading of the water flow meter and the total quantity of water diverted annually to the Chief Engineer by March 1 following the end of each calendar year.  Applicable  Not Applicable
7. Installation of the works for diversion of water shall be completed on or before **December 31, 2017**, or within any authorized extension of time. By March 1, 2018 the applicant shall notify the Chief Engineer that construction of the works for diversion has been completed, on the form provided by the Chief Engineer, as required by K.A.R. 5-8-4e.  Applicable  Not Applicable
8. The completed well log shall be submitted with the required notice.  Applicable  Not Applicable
9. All diversion works into which any type of chemical or other foreign substance will be injected into the water shall be equipped with an in-line, automatic, quick-closing check valve capable of preventing pollution of the source of the water supply. The check valve(s) shall be installed, operated and maintained in accordance with K.A.R. 5-3-5c.  Applicable  Not Applicable
10. Additional Conditions are attached.  Yes  No
11. In accordance with K.S.A. 82a-708a, as amended, and K.A.R. 5-5-14, all of the owners of the authorized place(s) of use of water appropriated under the above-referenced file number are responsible for compliance with its terms, conditions and limitations, as amended and/or supplemented by this Summary Order, and with applicable provisions of the *Kansas Water Appropriation Law* and the *Rules and Regulations* promulgated thereunder. Failure to comply with these provisions may result in civil penalties pursuant to K.S.A. 82a-737, as amended, and/or the suspension or revocation and dismissal of the water or appropriation right or any other enforcement actions authorized by law.

**Administrative Appeal and Effective Date of Order**

You have the right to a hearing in accordance with K.A.R. 5-14-3 before this Summary Order becomes final action of the Kansas Department of Agriculture. Any request for a hearing must be filed with the Chief Engineer, Division of Water Resources, Kansas Department of Agriculture, 1320 Research Park Drive, Topeka, Kansas 66502, within 15 days after the date shown on the Certificate of Service attached hereto. If a hearing is not requested in accordance with K.A.R. 5-14-3, this Summary Order will become effective on the 15<sup>th</sup> day after the date shown on the Certificate of Service.

*For Use by Register of Deeds*

FOR OFFICE USE ONLY  
**APPLICATION APPROVED AND  
 SUMMARY ORDER ISSUED**

By: Jeff Lanterman  
 \_\_\_\_\_  
 Duly Authorized Designee of the Chief Engineer  
 (Print Name): Jeff Lanterman  
 \_\_\_\_\_  
 Division of Water Resources - Kansas Department of Agriculture  
 Date of Issuance: 3/7/2017  
 \_\_\_\_\_  
 State of Kansas )  
 County of Stafford ) SS  
 Acknowledged before me on 3/7/2017  
 by Jeff Lanterman  
 Signature: Michaela Kirmir  
 \_\_\_\_\_  
 Notary Public

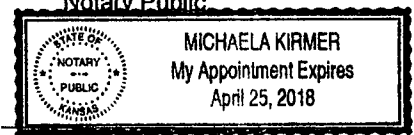

My commission expires: \_\_\_\_\_

(Notary Seal)

RECEIVED

JAN 30 2017

**SUMMARY ORDER APPROVING APPLICATION FOR CHANGE AND IMPOSING CONDITIONS**

This Summary Order is issued under authority of K.S.A. 82a-708b, as amended, and K.A.R. 5-14-3 and other applicable provisions of the *Kansas Water Appropriation Law, K.S.A. 82a-701 et. seq.*, and rules and regulations promulgated thereunder, K.A.R. 5-1-1 *et. seq.* With the exception of those conditions expressly contained herein, this Summary Order does not change the terms, conditions and limitations of File No. SG-001, ID 73.

1. A change application was received on 1/30/17 requesting that the place of use and / or point of diversion authorized under the above-referenced file number be changed as described in the application.
2. On and after the effective date of this summary order, the authorized place(s) of use shall be located substantially as shown on the topographic map accompanying the application to change the place of use.  Applicable  Not Applicable
3. The change in point of diversion shall not impair existing rights and shall be limited to the same source or sources of water as previously authorized. The point of diversion authorized by this summary order shall be located within a 50 foot radius of the authorized point(s) of diversion.  Applicable  Not Applicable
4. The point(s) of diversion authorized herein shall not actually be located more than 217 feet from the previously authorized point(s) of diversion.  Applicable  Not Applicable
5. As required by K.A.R. 5-3-5d, if the works for diversion is a well with a diversion rate of 100 gallons per minute or more, a tube or other device suitable for making water level measurements shall be installed, operated and maintained in accordance with K.A.R. 5-6-13.  Applicable  Not Applicable
6. The owner of the authorized place(s) of use shall properly install an acceptable water flow meter on or before **December 31, 2017**, or before the first use of water, whichever occurs first. The water flow meter shall be installed, operated and maintained in accordance with K.A.R. 5-1-4 through 5-1-12. As required by K.S.A. 82a-732, as amended, and K.A.R. 5-3-5e, the owner shall maintain records and report the reading of the water flow meter and the total quantity of water diverted annually to the Chief Engineer by March 1 following the end of each calendar year.  Applicable  Not Applicable
7. Installation of the works for diversion of water shall be completed on or before **December 31, 2017**, or within any authorized extension of time. By **March 1, 2018** the applicant shall notify the Chief Engineer that construction of the works for diversion has been completed, on the form provided by the Chief Engineer, as required by K.A.R. 5-8-4e.  Applicable  Not Applicable
8. The completed well log shall be submitted with the required notice.  Applicable  Not Applicable
9. All diversion works into which any type of chemical or other foreign substance will be injected into the water shall be equipped with an in-line, automatic, quick-closing check valve capable of preventing pollution of the source of the water supply. The check valve(s) shall be installed, operated and maintained in accordance with K.A.R. 5-3-5c.  Applicable  Not Applicable
10. Additional Conditions are attached.  Yes  No
11. In accordance with K.S.A. 82a-708a, as amended, and K.A.R. 5-5-14, all of the owners of the authorized place(s) of use of water appropriated under the above-referenced file number are responsible for compliance with its terms, conditions and limitations, as amended and/or supplemented by this Summary Order, and with applicable provisions of the *Kansas Water Appropriation Law* and the *Rules and Regulations* promulgated thereunder. Failure to comply with these provisions may result in civil penalties pursuant to K.S.A. 82a-737, as amended, and/or the suspension or revocation and dismissal of the water or appropriation right or any other enforcement actions authorized by law.

**Administrative Appeal and Effective Date of Order**

You have the right to a hearing in accordance with K.A.R. 5-14-3 before this Summary Order becomes final action of the Kansas Department of Agriculture. Any request for a hearing must be filed with the Chief Engineer, Division of Water Resources, Kansas Department of Agriculture, 1320 Research Park Drive, Topeka, Kansas 66502, within 15 days after the date shown on the Certificate of Service attached hereto. If a hearing is not requested in accordance with K.A.R. 5-14-3, this Summary Order will become effective on the 15<sup>th</sup> day after the date shown on the Certificate of Service.

*For Use by Register of Deeds*

FOR OFFICE USE ONLY  
**APPLICATION APPROVED AND  
 SUMMARY ORDER ISSUED**

By: Jeff Lanterman  
 Only Authorized Designee of the Chief Engineer  
 (Print Name): Jeff Lanterman  
 Division of Water Resources - Kansas Department of Agriculture  
 Date of Issuance: 3/7/2017  
 State of Kansas )  
 County of Stafford ) SS  
 Acknowledged before me on 3/7/2017  
 by Jeff Lanterman  
 Signature: Michaela Kirmer  
 Notary Public

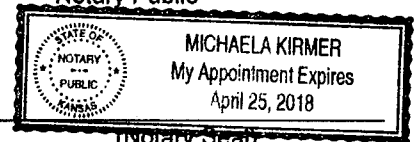

My commission expires: \_\_\_\_\_

RECEIVED

JAN 30 2017 Page 5

File No. SG-001



APPLICATION FOR APPROVAL TO CHANGE  
THE PLACE OF USE AND/OR POINT OF DIVERSION  
SUPPLEMENTAL SHEET  
FILE NO. SG-001

**Presently authorized point of diversion: City Well S-3**

One in the \_\_\_\_\_ Quarter of the \_\_\_\_\_ Quarter of the \_\_\_\_\_ Quarter  
of Section 18, Township 27 South, Range 1 E,  
in Sedgwick County, Kansas, 850 feet North 4000 feet West of Southeast corner of section.  
Authorized Rate 1965 GPM Authorized Quantity 91.1 MGY Depth of well \_\_\_\_\_ (feet)  
(DWR use only: Computer ID No. 5 GPS \_\_\_\_\_ feet North \_\_\_\_\_ feet West)  
 This point will not be changed  This point will be changed as follows:  No redrill, point better described with GPS as follows:

**Proposed point of diversion: (Complete only if change is requested)**

One in the \_\_\_\_\_ Quarter of the \_\_\_\_\_ Quarter of the \_\_\_\_\_ Quarter  
of Section \_\_\_\_\_, Township \_\_\_\_\_ South, Range \_\_\_\_\_ (E/W),  
in \_\_\_\_\_ County, Kansas, \_\_\_\_\_ feet North \_\_\_\_\_ feet West of Southeast corner of section.  
Proposed Rate \_\_\_\_\_ Proposed Quantity \_\_\_\_\_ Proposed well depth (feet) \_\_\_\_\_  
This point is:  Additional Well  Geo Center List other water rights that will use this point 540

**Presently authorized point of diversion: City Well N-4**

One in the \_\_\_\_\_ Quarter of the \_\_\_\_\_ Quarter of the \_\_\_\_\_ Quarter  
of Section 18, Township 27 South, Range 1 E,  
in Sedgwick County, Kansas, 3900 feet North 2800 feet West of Southeast corner of section.  
Authorized Rate 1100 GPM Authorized Quantity 37.5 MGY Depth of well \_\_\_\_\_ (feet)  
(DWR use only: Computer ID No. 8 GPS \_\_\_\_\_ feet North \_\_\_\_\_ feet West)  
 This point will not be changed  This point will be changed as follows:  No redrill, point better described with GPS as follows:

**Proposed point of diversion: (Complete only if change is requested)**

One in the \_\_\_\_\_ Quarter of the \_\_\_\_\_ Quarter of the \_\_\_\_\_ Quarter  
of Section \_\_\_\_\_, Township \_\_\_\_\_ South, Range \_\_\_\_\_ (E/W),  
in \_\_\_\_\_ County, Kansas, \_\_\_\_\_ feet North \_\_\_\_\_ feet West of Southeast corner of section.  
Proposed Rate \_\_\_\_\_ Proposed Quantity \_\_\_\_\_ Proposed well depth (feet) \_\_\_\_\_  
This point is:  Additional Well  Geo Center List other water rights that will use this point \_\_\_\_\_

**Presently authorized point of diversion: City Well S-6**

One in the \_\_\_\_\_ Quarter of the \_\_\_\_\_ Quarter of the \_\_\_\_\_ Quarter  
of Section 18, Township 27 South, Range 1 E,  
in Sedgwick County, Kansas, 3080 feet North 4870 feet West of Southeast corner of section.  
Authorized Rate 1593 GPM Authorized Quantity 67.5 MGY Depth of well \_\_\_\_\_ (feet)  
(DWR use only: Computer ID No. 57 GPS \_\_\_\_\_ feet North \_\_\_\_\_ feet West)  
 This point will not be changed  This point will be changed as follows:  No redrill, point better described with GPS as follows:

**Proposed point of diversion: (Complete only if change is requested)**

One in the \_\_\_\_\_ Quarter of the \_\_\_\_\_ Quarter of the \_\_\_\_\_ Quarter  
of Section \_\_\_\_\_, Township \_\_\_\_\_ South, Range \_\_\_\_\_ (E/W),  
in \_\_\_\_\_ County, Kansas, \_\_\_\_\_ feet North \_\_\_\_\_ feet West of Southeast corner of section.  
Proposed Rate \_\_\_\_\_ Proposed Quantity \_\_\_\_\_ Proposed well depth (feet) \_\_\_\_\_  
This point is:  Additional Well  Geo Center List other water rights that will use this point \_\_\_\_\_

JAN 30 2017

**Presently authorized point of diversion: City Well S-7**

One in the NW Quarter of the NW Quarter of the SW Quarter  
of Section 18, Township 27 South, Range 1 E,  
in Sedgwick County, Kansas, 2200 feet North 5100 feet West of Southeast corner of section.  
Authorized Rate 1611 GPM Authorized Quantity 32.0 MGY Depth of well \_\_\_\_\_ (feet)  
(DWR use only: Computer ID No. 72 GPS 2353 feet North 5030 feet West) (100 ft South Change included)  
 This point will not be changed  This point will be changed as follows:  No redrill, point better described with GPS as follows:

**Proposed point of diversion: (Complete only if change is requested)**

One in the NW Quarter of the NW Quarter of the SW Quarter  
of Section 18, Township 27 South, Range 1 E,  
in Sedgwick County, Kansas, 2489 feet North 5065 feet West of Southeast corner of section.  
Proposed Rate 1611 GPM Proposed Quantity 32.0 MGY Proposed well depth (feet) 52  
This point is:  Additional Well  Geo Center List other water rights that will use this point None

APPLICATION FOR APPROVAL TO CHANGE  
THE PLACE OF USE AND/OR POINT OF DIVERSION  
SUPPLEMENTAL SHEET  
FILE NO. SG-001

**Presently authorized point of diversion: City Well S-5**

One in the NW Quarter of the SW Quarter of the SW Quarter of Section 18, Township 27 South, Range 1 E, in Sedgwick County, Kansas, 1200 feet North 4900 feet West of Southeast corner of section.  
 Authorized Rate 1621 GPM Authorized Quantity 51.2 MGY Depth of well --- (feet)  
 (DWR use only: Computer ID No. 73 GPS 1574 feet North 4865 feet West) (100 ft South Change Included)  
 This point will not be changed  This point will be changed as follows:  No redrill, point better described with GPS as follows:

**Proposed point of diversion: (Complete only if change is requested)**

One in the SW Quarter of the NW Quarter of the SW Quarter of Section 18, Township 27 South, Range 1 E, in Sedgwick County, Kansas, 1736 feet North 4903 feet West of Southeast corner of section.  
 Proposed Rate 1621 GPM Proposed Quantity 51.2 MGY Proposed well depth (feet) 58  
 This point is:  Additional Well  Geo Center List other water rights that will use this point \_\_\_\_\_

**Presently authorized point of diversion: City Well S-4** *SM 1/2/17*

One in the NE Quarter of the SW Quarter of the SW Quarter of Section 18, Township (DID) 27 South, Range 1 E, in Sedgwick County, Kansas, 1400 feet North 4460 feet West of Southeast corner of section.  
 Authorized Rate 1259 GPM Authorized Quantity 79.8 MGY Depth of well \_\_\_\_\_ (feet)  
 (DWR use only: Computer ID No. 74 GPS \_\_\_\_\_ feet North \_\_\_\_\_ feet West)  
 This point will not be changed  This point will be changed as follows:  No redrill, point better described with GPS as follows:

**Proposed point of diversion: (Complete only if change is requested)**

One in the \_\_\_\_\_ Quarter of the \_\_\_\_\_ Quarter of the \_\_\_\_\_ Quarter of Section \_\_\_\_\_, Township \_\_\_\_\_ South, Range \_\_\_\_\_ (E/W), in \_\_\_\_\_ County, Kansas, \_\_\_\_\_ feet North \_\_\_\_\_ feet West of Southeast corner of section.  
 Proposed Rate \_\_\_\_\_ Proposed Quantity \_\_\_\_\_ Proposed well depth (feet) \_\_\_\_\_  
 This point is:  Additional Well  Geo Center List other water rights that will use this point \_\_\_\_\_

**Presently authorized point of diversion:**

One in the \_\_\_\_\_ Quarter of the \_\_\_\_\_ Quarter of the \_\_\_\_\_ Quarter of Section \_\_\_\_\_, Township \_\_\_\_\_ South, Range \_\_\_\_\_ (E/W), in \_\_\_\_\_ County, Kansas, \_\_\_\_\_ feet North \_\_\_\_\_ feet West of Southeast corner of section.  
 Authorized Rate \_\_\_\_\_ Authorized Quantity \_\_\_\_\_ Depth of well \_\_\_\_\_ (feet)  
 (DWR use only: Computer ID No. \_\_\_\_\_ GPS \_\_\_\_\_ feet North \_\_\_\_\_ feet West)  
 This point will not be changed  This point will be changed as follows:  No redrill, point better described with GPS as follows:

**Proposed point of diversion: (Complete only if change is requested)**

One in the \_\_\_\_\_ Quarter of the \_\_\_\_\_ Quarter of the \_\_\_\_\_ Quarter of Section \_\_\_\_\_, Township \_\_\_\_\_ South, Range \_\_\_\_\_ (E/W), in \_\_\_\_\_ County, Kansas, \_\_\_\_\_ feet North \_\_\_\_\_ feet West of Southeast corner of section.  
 Proposed Rate \_\_\_\_\_ Proposed Quantity \_\_\_\_\_ Proposed well depth (feet) \_\_\_\_\_  
 This point is:  Additional Well  Geo Center List other water rights that will use this point \_\_\_\_\_

**Presently authorized point of diversion:**

One in the \_\_\_\_\_ Quarter of the \_\_\_\_\_ Quarter of the \_\_\_\_\_ Quarter of Section \_\_\_\_\_, Township \_\_\_\_\_ South, Range \_\_\_\_\_ (E/W), in \_\_\_\_\_ County, Kansas, \_\_\_\_\_ feet North \_\_\_\_\_ feet West of Southeast corner of section.  
 Authorized Rate \_\_\_\_\_ Authorized Quantity \_\_\_\_\_ Depth of well \_\_\_\_\_ (feet)  
 (DWR use only: Computer ID No. \_\_\_\_\_ GPS \_\_\_\_\_ feet North \_\_\_\_\_ feet West)  
 This point will not be changed  This point will be changed as follows:  No redrill, point better described with GPS as follows:

**Proposed point of diversion: (Complete only if change is requested)**

One in the \_\_\_\_\_ Quarter of the \_\_\_\_\_ Quarter of the \_\_\_\_\_ Quarter of Section \_\_\_\_\_, Township \_\_\_\_\_ South, Range \_\_\_\_\_ (E/W), in \_\_\_\_\_ County, Kansas, \_\_\_\_\_ feet North \_\_\_\_\_ feet West of Southeast corner of section.  
 Proposed Rate \_\_\_\_\_ Proposed Quantity \_\_\_\_\_ Proposed well depth (feet) \_\_\_\_\_  
 This point is:  Additional Well  Geo Center List other water rights that will use this point \_\_\_\_\_

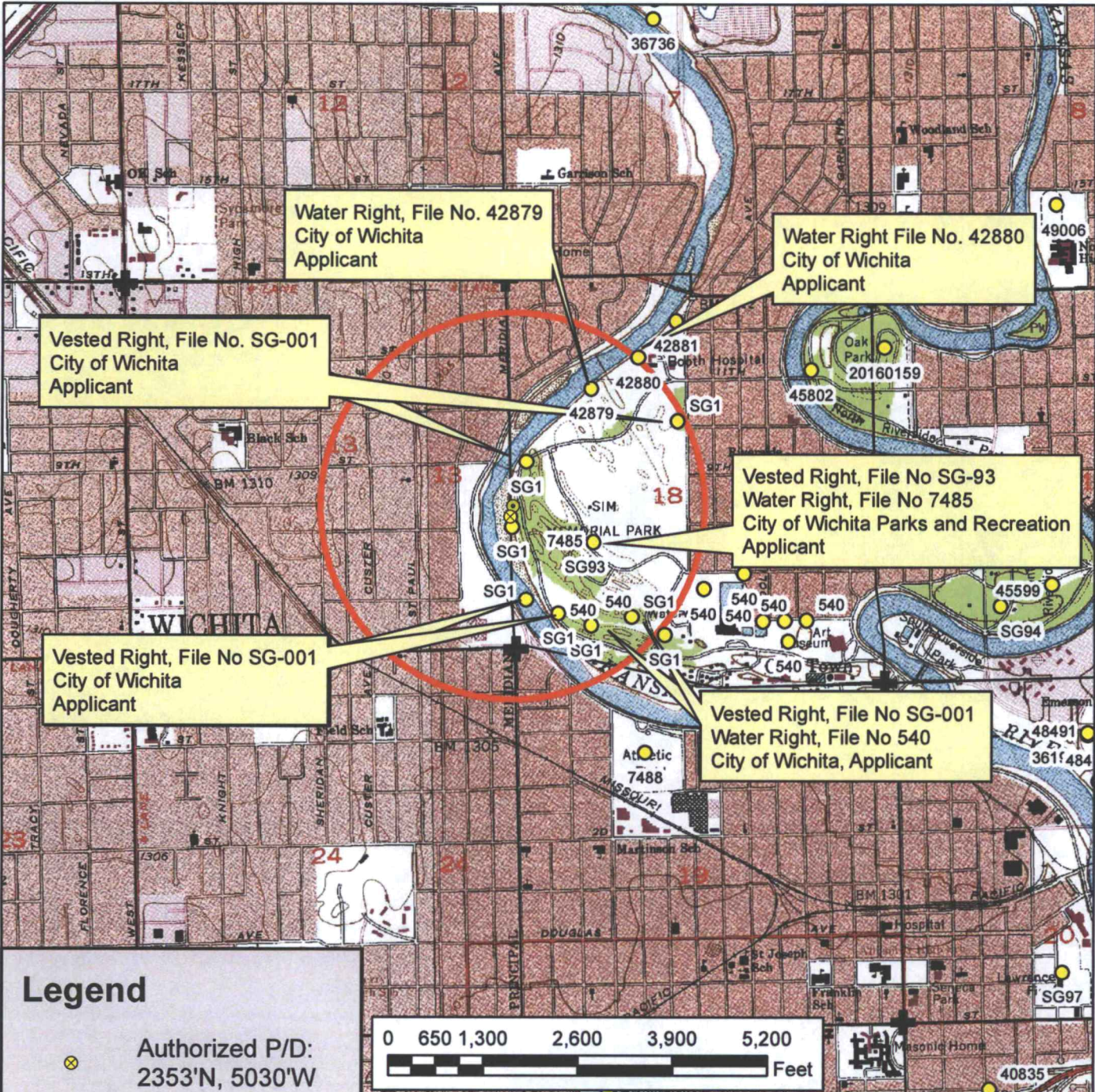

Water Right, File No. 42879  
City of Wichita  
Applicant

Water Right File No. 42880  
City of Wichita  
Applicant

Vested Right, File No. SG-001  
City of Wichita  
Applicant

Vested Right, File No SG-93  
Water Right, File No 7485  
City of Wichita Parks and Recreation  
Applicant

Vested Right, File No SG-001  
City of Wichita  
Applicant

Vested Right, File No SG-001  
Water Right, File No 540  
City of Wichita, Applicant

**Legend**

- ⊗ Authorized P/D:  
2353'N, 5030'W
- ⊙ Proposed P/D:  
2489'N, 5065'W
- Water Appropriations
- ★ Domestic Well
- ▭ Section Line
- ⊕ Section Corner
- ◻ 1/2 Mile Circle

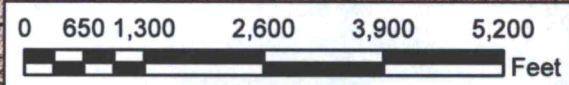

**Vested Right, SG-001 ID 72, City Well S-7**  
Change in Point of Diversion Map  
18-27S-1E // Sedgwick County

To the best of my knowledge, all permitted wells within 1/2 mile of the proposed point of diversion have been shown on this map. There are likely multiple domestic wells within 1/2 mile of the proposed point. This is a short move change under 300', it seems unnecessary to physically note and label all nearby domestic wells since nearby notification will not be sent.

Signature *[Handwritten Signature]* 1/12/17

JAN 30 2017



**Legend**

- ⊗ Authorized P/D: 2353'N, 5030'W
- ⊙ Proposed P/D: 2489'N, 5065'W
- Water Appropriations
- ★ Domestic Well
- ▭ Section Line
- ⊕ Section Corner
- 1/2 Mile Circle

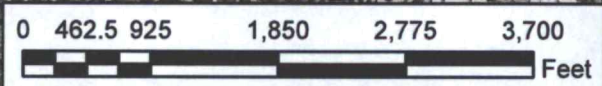

**Vested Right, SG-001 ID 72, City Well S-7**  
 Change in Point of Diversion Map  
 18-27S-1E // Sedgwick County



To the best of my knowledge, all permitted wells within 1/2 mile of the proposed point of diversion have been shown on this map. There are likely multiple domestic wells within 1/2 mile of the proposed point. This is a short move change under 300', it seems unnecessary to physically note and label all nearby domestic wells since nearby notification will not be sent.

RECEIVED

JAN 30 2017

Signature *[Handwritten Signature]* 1/2/17

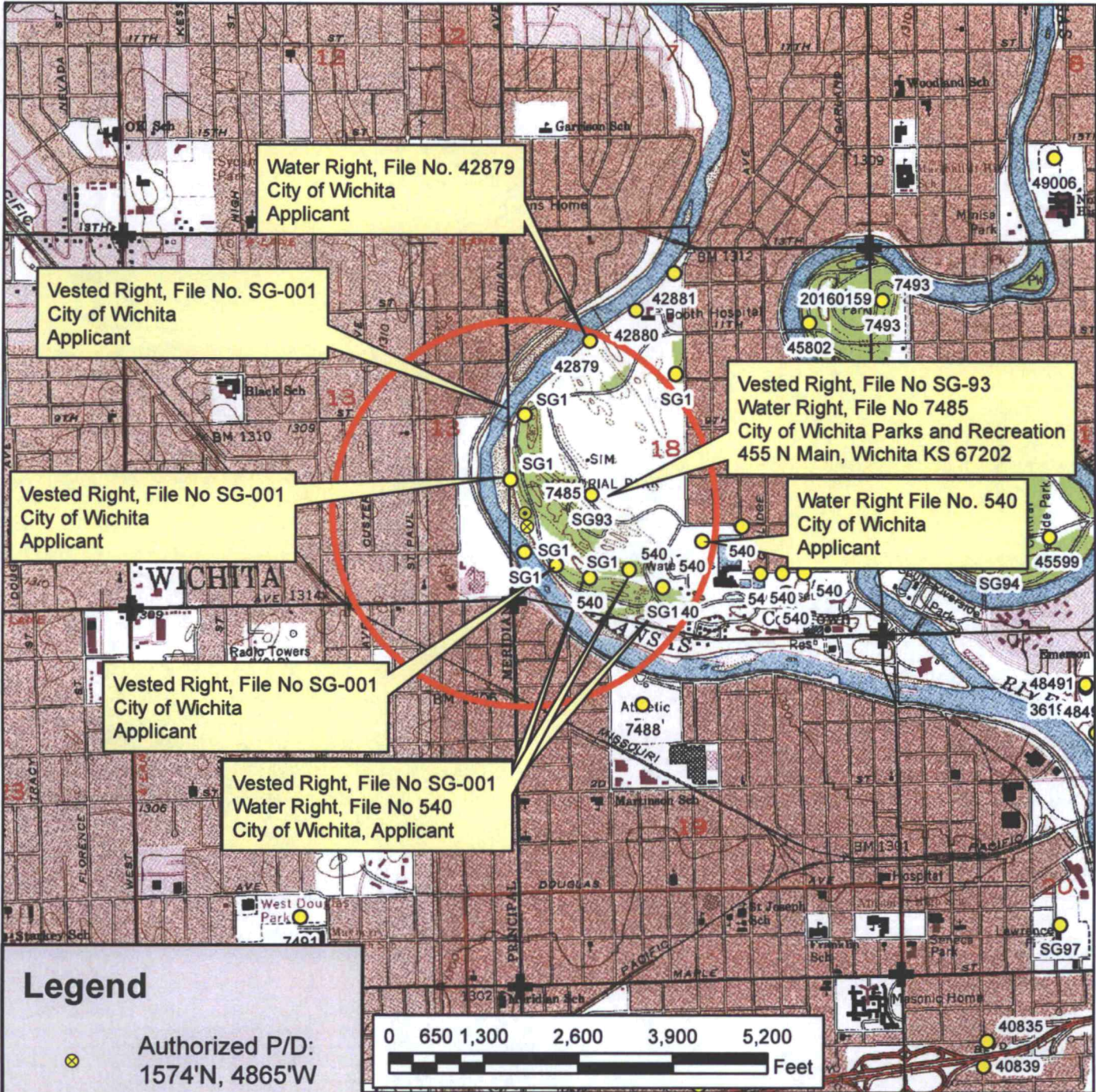

**Legend**

- ⊗ Authorized P/D:  
1574'N, 4865'W
- Proposed P/D:  
1736'N, 4903'W
- Water Appropriations
- ★ Domestic Well
- ▭ Section Line
- ⊕ Section Corner
- 1/2 Mile Circle

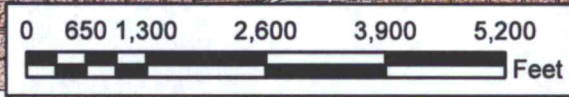

**Vested Right, SG-001 ID 73, City Well S-5**  
 Change in Point of Diversion Map  
 18-27S-1E // Sedgwick County

To the best of my knowledge, all permitted wells within 1/2 mile of the proposed point of diversion have been shown on this map. There are likely multiple domestic wells within 1/2 mile of the proposed point. This is a short move change under 300', it seems unnecessary to physically note and label all nearby domestic wells since nearby notification will not be sent.

Signature *[Handwritten Signature]* 1/12/17

JAN 30 2017



**Legend**

- ⊗ Authorized P/D:  
1574'N, 4865'W
- ⊙ Proposed P/D:  
1736'N, 4903'W
- Water Appropriations
- ★ Domestic Well
- ▭ Section Line
- ⊕ Section Corner
- 1/2 Mile Circle

**Vested Right, SG-001 ID 73, City Well S-5**  
**Change in Point of Diversion Map**  
 18-27S-1E // Sedgwick County

To the best of my knowledge, all permitted wells within 1/2 mile of the proposed point of diversion have been shown on this map. There are likely multiple domestic wells within 1/2 mile of the proposed point. This is a short move change under 300', it seems unnecessary to physically note and label all nearby domestic wells since nearby notification will not be sent.



Signature *[Handwritten Signature]* 1/12/17

10/14/16 TJS-SFFO  
 Stafford Field Office  
 Division of Water Resources  
 RECEIVED  
 JAN 30 2017

## CERTIFICATE OF SERVICE

On this **8 March 2017**, I hereby certify that the attached Change in Point of Diversion, File No. SG 01 & 42880 dated March 8, 2017 was mailed to the following:

City of Wichita  
Public Works & Utilities  
455 N Main St 8<sup>th</sup> Floor  
Wichita KS 67202

pc: Water Rights Section

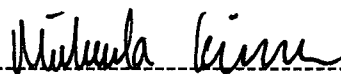

-----  
Staff