

Kansas Department of Agriculture
 Division of Water Resources
CHANGE: P/D WORKSHEET

1. File Number: 18,611	2. Status Change Date:	3. Change Num: 1	4. Field Office: 02	5. GMD: 05
----------------------------------	------------------------	----------------------------	-------------------------------	----------------------

6. Status: <input checked="" type="checkbox"/> Approved <input type="checkbox"/> Denied by DWR/GMD <input type="checkbox"/> Dismiss by Request/Failure to Return	7. Filing Date of Change: 2/1/18
--	--

8a. Applicant(s) Person ID _____ New to system <input type="checkbox"/> Add Seq# _____ --	8c. Landowner(s) Person ID _____ New to system <input type="checkbox"/> Add Seq# _____ --
---	---

8b. Landowner(s) Person ID <u>?</u> _____ New to system <input checked="" type="checkbox"/> Add Seq# <u>1</u> _____ NEW OWNER -----> CINDY GRANT 320 RUSH AVE LARNED, KS 67550	8d. WUC Person ID <u>?</u> _____ New to system <input checked="" type="checkbox"/> Add Seq# <u>1</u> _____ CINDY GRANT 320 RUSH AVE LARNED, KS 67550
--	---

9. Documents and Enclosure(s): <input checked="" type="checkbox"/> DWR Meter(s) Date to Comply: <u>12/31/18</u> <input checked="" type="checkbox"/> N & P Date to Comply: <u>12/31/18</u>	
<input type="checkbox"/> Anti-Reverse Meter <input type="checkbox"/> Meter Seal <input checked="" type="checkbox"/> Check Valve <input checked="" type="checkbox"/> N & P Form <input checked="" type="checkbox"/> Water Tube <input checked="" type="checkbox"/> Driller Copy <input checked="" type="checkbox"/> H & E Letter	
<input type="checkbox"/> Conservation Plan Date Required: <u>12/31/18</u> Date Approved: <u>2/1/18</u> Date to Comply: <u>12/31/18</u>	

10. Use Made of Water From: -- _____	To: -- _____
---	--------------

	Date Prepared: 2/1/18	By: CRC
	Date Entered:	By:

Submit completed application to:
 Kansas Department of Agriculture
 Division of Water Resources
 Field Office for your area.

Call for address:

Topeka -- (785) 296-5733
 Stafford -- (620) 234-5311
 Stockton -- (785) 425-6787
 Garden City -- (620) 276-2901
<http://agriculture.ks.gov/dwr>

DWR FIELD OFFICE APPLICATION FOR APPROVAL TO CHANGE THE PLACE OF USE AND/OR THE POINT OF DIVERSION **WATER METER REQUIRED**



STATE OF KANSAS

Filing Fee Must Accompany the Application, K.S.A. 82a-708b(b), as amended.
 Fee Schedule is on the third page of this application form.

Paragraph Nos. 1, 2, 3 & 5 must be completed. Complete all other applicable portions. If change in point of diversion is greater than 100 feet, or if place of use will be changed, include a topographic map or detailed plat showing the authorized and proposed point(s) of diversion and/or place of use.

RECEIVED
 10:55am
 FEB 01 2018

File No. 18,611

Stafford Field Office
 Division of Water Resources

1. Application is hereby made for approval of the Chief Engineer to change the (check one or both):

Place of Use Point of Diversion

under the water right which is the subject of this application in accordance with the conditions described below.

The source of supply is: Groundwater Surface water

2. Name and address of Applicant: Cindy Grant
320 Rush Ave, Larned, KS 67550

Phone Number: (620)285-9033 Email address: _____

Name and address of Water Use Correspondent: Cindy Grant
320 Rush Ave, Larned, KS 67550

Phone Number: (620)285-9033 Email address: _____

3. The presently authorized place of use is:
 Owner of Land ---- NAME: Cindy Grant

ADDRESS: 320 Rush Ave, Larned, KS 67550

(If there is more than one landowner, attach supplemental sheets as necessary.)

Sec.	Twp.	Range	NE¼				NW¼				SW¼				SE¼				TOTAL ACRES
			NE¼	NW¼	SW¼	SE¼	NE¼	NW¼	SW¼	SE¼	NE¼	NW¼	SW¼	SE¼	NE¼	NW¼	SW¼	SE¼	
16	22S	15W					40	40	40	40									160

4. If this application is for a change in place of use, it is proposed that the place of use be changed to:
 Owner of Land ---- NAME: NO CHANGE

ADDRESS: NO CHANGE

(If there is more than one landowner, attach supplemental sheets as necessary.)

Sec.	Twp.	Range	NE¼				NW¼				SW¼				SE¼				TOTAL ACRES
			NE¼	NW¼	SW¼	SE¼	NE¼	NW¼	SW¼	SE¼	NE¼	NW¼	SW¼	SE¼	NE¼	NW¼	SW¼	SE¼	

For Office Use Only: Code _____ Fee \$ 100 - TR # _____ Receipt Date _____ Check # 7253

5. **Presently authorized point of diversion:**

One in the -- Quarter of the NC Quarter of the NW Quarter of Section 16 , Township 22 South, Range 15 (W), in Pawnee County, Kansas, 3,960 feet North 3,960 feet West of Southeast corner of section. Authorized Rate 1420 GPM Authorized Quantity 225 acre-feet Depth of well 84 (feet)
(DWR use only: Computer ID No. 1 GPS -- feet North -- feet West)

This point will not be changed This point will be changed as follows: No change, point better described with GPS as follows:

Proposed point of diversion: (Complete only if change is requested or if existing point is better described by GPS)

One in the -- Quarter of the NC Quarter of the NW Quarter of Section 16 , Township 22 South, Range 15 (W), in Pawnee County, Kansas, 3,960 feet North 3,987 feet West of Southeast corner of section. Proposed Rate no change Proposed Quantity no change Proposed well depth (feet) 100 .
 This point is: Additional Well Geo Center List other water rights that will use this point none .

6. **Presently authorized point of diversion:**

One in the Quarter of the Quarter of the Quarter of Section , Township South, Range (E/W), in County, Kansas, feet North feet West of Southeast corner of section. Authorized Rate Authorized Quantity Depth of well (feet)
(DWR use only: Computer ID No. GPS feet North feet West)

This point will not be changed This point will be changed as follows: No change, point better described with GPS as follows:

Proposed point of diversion: (Complete only if change is requested or if existing point is better described by GPS)

One in the Quarter of the Quarter of the Quarter of Section , Township South, Range (E/W), in County, Kansas, feet North feet West of Southeast corner of section. Proposed Rate Proposed Quantity Proposed well depth (feet) .
 This point is: Additional Well Geo Center List other water rights that will use this point .

7. The changes herein are desired for the following reasons? (please be specific) Well is old and pulling a lot of rust,

doing a re-drill now to avoid a failure mid-season.

13a. If the proposed point of diversion will be relocated within 100 feet of the existing point of diversion, indicate its location on the diagram below in relation to the existing point of diversion. (PLEASE NOTE: The "X" in center of diagram below represents presently authorized point of diversion.)

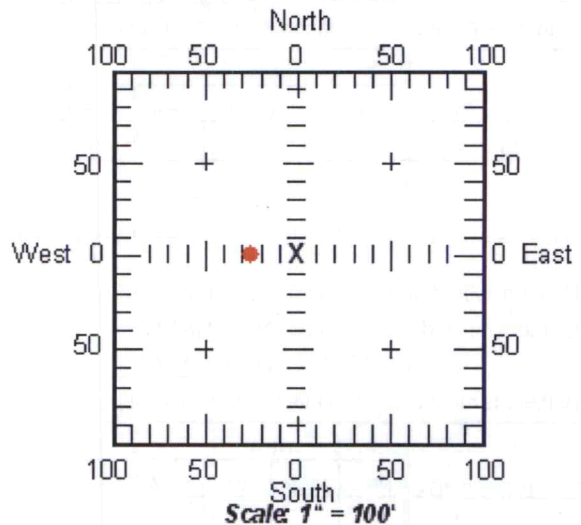

8. If a well, is the test hole log attached? Yes No

9. The change(s) (was)(will be) completed by? as soon as possible

10. If the point of diversion is a well:
 (a) What are you going to do with the old well?
keep for domestic stock use

(b) When will this be done? when new well is complete

11. Groundwater Management District recommendation attached? Yes No

12. Assisted by CRC-SFFO

13b. If the proposed point of diversion will be relocated more than 100 feet but within 1320 feet from the existing point of diversion, attach a topographic map or aerial photograph. For groundwater sources, show all wells (including domestic) within one-half mile of the proposed point of diversion and the names and mailing addresses of the owners. For surface water sources, show the names and addresses of the landowner(s) one-half mile downstream and one-half mile upstream from your property lines.

RECEIVED

FEB 01 2018

14. If the proposed groundwater point of diversion is 300 or fewer feet from existing point of diversion, complete the following:

- (a) Does the undersigned represent all owners of the currently authorized place(s) of use identified in this application?
 Yes No (If no, all owners must sign this application.)
- (b) Will the ownership interest of any owner of the currently authorized place(s) of use identified in this application be adversely affected if this application is approved as requested?
 Yes No (If yes, all owners must sign this application.)
- (c) If this application is not approved expeditiously, will there be substantial damage to property, public health or safety?
 Yes No (If no, all owners must sign this application.)

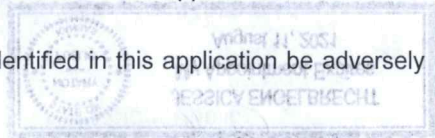

If the application proposes a surface water change in point of diversion, a groundwater change in point of diversion greater than 300 feet, or a change in place of use, the application must be signed by all owners of the currently authorized place of use, or their duly authorized agent (attach notarized statement authorizing representation).

I hereby verify, being first duly sworn upon my oath or affirmation and under penalty of perjury, that I am of lawful age and the owner, the spouse of the owner, or a duly authorized agent of the owner(s) to make this application on their behalf, in regards to the water right(s) to which this application pertains. I further verify that the statements contained in this application are true, correct and complete.

Dated at Stafford, Kansas, this 1st day of February, 2018.

<u>Cindy Grant</u> (Owner)	_____	(Spouse)
<u>Cindy Grant</u> (Please Print)	_____	(Please Print)
_____	_____	(Spouse)
_____	_____	(Please Print)
_____	_____	(Spouse)
_____	_____	(Please Print)
_____	_____	(Spouse)
_____	_____	(Please Print)

State of Kansas }
County of Stafford } SS

I hereby certify that the foregoing application was signed in my presence and sworn to before me this 1st day of February, 2018



Jessica Engelbrecht
Notary Public

My Commission Expires _____

ONLY COMPLETE APPLICATIONS WILL BE PROCESSED. To be complete, all of the applicable portions of the application form must be completed with accurate information; maps, if necessary, must be included; signatures of all the appropriate owners' must be affixed to the application and notarized; and the appropriate fee must be paid.

FEE SCHEDULE

- Each application to change the place of use or the point of diversion under this section shall be accompanied by the application fee set forth in the schedule below: Make checks payable to: **Kansas Department of Agriculture**
- (1) Application to change a point of diversion 300 feet or less \$100
 - (2) Application to change a point of diversion more than 300 feet \$200
 - (3) Application to change the place of use \$200

RECEIVED

FEB 01 2018

SUMMARY ORDER APPROVING APPLICATION FOR CHANGE AND IMPOSING CONDITIONS

This Summary Order is issued under authority of K.S.A. 82a-708b, as amended, and K.A.R. 5-5-1, et seq. and other applicable provisions of the *Kansas Water Appropriation Law, K.S.A. 82a-701 et. seq.*, and rules and regulations promulgated thereunder, With the exception of those conditions expressly contained herein, this Summary Order does not change the terms, conditions and limitations of File No. 18,611

1. A change application was received on February 1st, 2018 requesting that the place of use and / or point of diversion authorized under the above-referenced file number be changed as described in the application.
2. On and after the effective date of this summary order, the authorized place(s) of use shall be located substantially as shown on the topographic map accompanying the application to change the place of use. Applicable Not Applicable
3. The change in point of diversion shall not impair existing rights and shall be limited to the same source or sources of water as previously authorized. The point of diversion authorized by this summary order shall be located within a 50 foot radius of the authorized point(s) of diversion. Applicable Not Applicable
4. The point(s) of diversion authorized herein shall not actually be located more than 77 feet from the previously authorized point(s) of diversion. Applicable Not Applicable
5. As required by K.A.R. 5-3-5d, if the works for diversion is a well with a diversion rate of 100 gallons per minute or more, a tube or other device suitable for making water level measurements shall be installed, operated and maintained in accordance with K.A.R. 5-6-13. Applicable Not Applicable
6. **The owner of the authorized place(s) of use shall properly install an acceptable water flow meter on or before December 31, 2018,** or before the first use of water, whichever occurs first. The water flow meter shall be installed, operated and maintained in accordance with K.A.R. 5-1-4 through 5-1-12. As required by K.S.A. 82a-732, as amended, and K.A.R. 5-3-5e, the owner shall maintain records and report the reading of the water flow meter and the total quantity of water diverted annually to the Chief Engineer by March 1 following the end of each calendar year. Applicable Not Applicable
7. **Installation of the works for diversion of water shall be completed on or before December 31, 2018,** or within any authorized extension of time. By March 1, 2019 the applicant shall notify the Chief Engineer that construction of the works for diversion has been completed, on the form provided by the Chief Engineer, as required by K.A.R. 5-8-4e. Applicable Not Applicable
8. **The completed well log shall be submitted with the required notice.** Applicable Not Applicable
9. All diversion works into which any type of chemical or other foreign substance will be injected into the water shall be equipped with an in-line, automatic, quick-closing check valve capable of preventing pollution of the source of the water supply. The check valve(s) shall be installed, operated and maintained in accordance with K.A.R. 5-3-5c. Applicable Not Applicable
10. Additional Conditions are attached. Yes No
11. In accordance with K.S.A. 82a-708a, as amended, and K.A.R. 5-5-14, all of the owners of the authorized place(s) of use of water appropriated under the above-referenced file number are responsible for compliance with its terms, conditions and limitations, as amended and/or supplemented by this Summary Order, and with applicable provisions of the *Kansas Water Appropriation Law* and the *Rules and Regulations* promulgated thereunder. Failure to comply with these provisions may result in civil penalties pursuant to K.S.A. 82a-737, as amended, and/or the suspension or revocation and dismissal of the water or appropriation right or any other enforcement actions authorized by law.

Administrative Appeal and Effective Date of Order

If you are aggrieved by this order, pursuant to K.S.A. 82a-1901, you may request an evidentiary hearing before the Chief Engineer or request administrative review by the Secretary of Agriculture. A request for hearing by the Chief Engineer must be filed within 15 days of service of this Order and a request for administrative review by the Secretary must be filed within 30 days pursuant to K.S.A. 77-531. Any request for administrative review must state a basis for review pursuant to K.S.A. 77-527. File any request with **Kansas Department of Agriculture, Legal Division, 1320 Research Park Drive, Manhattan, KS 66502.** Failure to timely request a hearing or review may preclude review under the Kansas Judicial Review Act.

For Use by Register of Deeds

FOR OFFICE USE ONLY
**APPLICATION APPROVED AND
SUMMARY ORDER ISSUED**

By: Cameron R. Couart
Duly Authorized Designee of the Chief Engineer

(Print Name): Cameron R. Couart
Division of Water Resources - Kansas Department of Agriculture

Date of Issuance: 2/1/18

State of Kansas)

County of Stafford) SS

Acknowledged before me on 2/1/18
by Cameron Couart

Signature: Jessica Engelbrecht



My commission expires: _____ (Notary Seal)

RECEIVED

FEB 01 2018

CERTIFICATE OF SERVICE

On this **1st** day of **February, 2018**, I hereby certify that the attached Change in Point of Diversion for Water Right, File No. **18611**, dated **February 1, 2018** was hand delivered to the following:

Cindy Grant



Staff

Property Detail Information



Generated: 1/29/2018 2:18:39 PM

Report for Parcel No. 073-125-16-0-00-00-002.00-0 (Quick Ref. ID R4464)

Property Physical (Situs) Address	
00000 CO RD, Larned, KS 67550	
Owner(s)	Owner Mailing Address
GRANT, CINDY - (P)	320 RUSH AVE LARNED, KS 67550

Tract (Legal) Description
S16, T22, R15, ACRES 156.5, NW4 LESS ROW

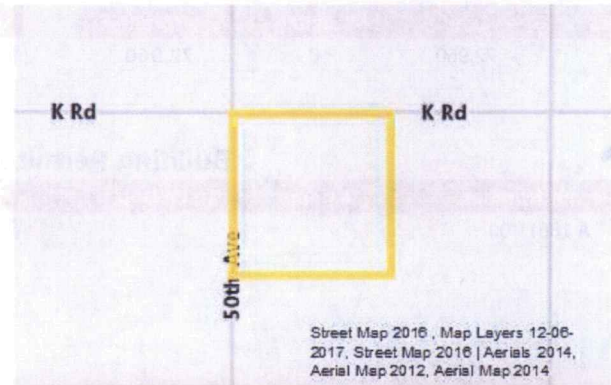

Property Factors	
Topography	Level - 1
Utilities	Well - 5
Access	Semi Improved Road - 2
Fronting	Secondary Street - 3
Location	Neighborhood or Spot - 6
Parking Type	On and Off Street - 3
Parking Quantity	Adequate - 2
Parking Proximity	On Site - 3
Covered Parking	Not Available
Uncovered Parking	Not Available

Land-Based Classification	
Function	Farming / ranch land (no improvements)
Activity	Farming, plowing, tilling, harvesting, or related activities
Ownership	Private-fee simple
Site	Dev Site - crops, grazing etc - no structures

General Property Information	
Property Class	Agricultural Use - A
Living Units	Not Available
Zoning	Not Available
Neighborhood	401
Tax Unit Group	070

Property Detail Information

LGIS v5  THOMSON REUTERS

2 of 2

 **PAWNEE** County, Kansas

Generated: 1/29/2018 2:18:39 PM

Appraisal Information

Tax Year 2017

Class	Land	Building	Total
A	72,960	0	72,960

Tax Year 2016

Class	Land	Building	Total
A	63,050	0	63,050

Building Permit Information

Permit Number	Amount	Issue Date	Description
A 18611 00			Water Right - Irrigation