

Kansas Department of Agriculture
 Division of Water Resources
CHANGE: P/U WORKSHEET

1. File Number: 44768	2. Status Change Date:	3. Change Num: 2	4. Field Office: 02	5. GMD: 02
---------------------------------	------------------------	----------------------------	-------------------------------	----------------------

6. Status: <input checked="" type="checkbox"/> Approved <input type="checkbox"/> Denied by DWR/GMD <input type="checkbox"/> Dismiss by Request/Failure to Return	7. Filing Date of Change: 3/9/18
--	--

8a. Applicant(s) New to system <input type="checkbox"/>	Person ID _____ Add Seq# _____	8c. Landowner(s) New to system <input checked="" type="checkbox"/>	Person ID <u>?</u> Add Seq# <u>1</u>
OMAR L & ELSIE MILLER TRUST 1208 MAPLEWOOD RD HARRISON AR 72601			

8b. Landowner(s) New to system <input type="checkbox"/>	Person ID <u>65980</u> Add Seq# <u>1</u>	8d. WUC New to system <input type="checkbox"/>	Person ID <u>65980</u> Add Seq# <u>1</u>
SALT CREEK LAND LLC 6400 W ILLINOIS AVE HUTCHINSON KS 67501-9137			

9. Documents and Enclosure(s): DWR Meter(s) Date to Comply: 12/31/18 N & P Date to Comply: _____

Anti-Reverse Meter Meter Seal Check Valve N & P Form Water Tube Driller Copy H & E Letter

Conservation Plan Date Required: _____ Date Approved: _____ Date to Comply: _____

10. Use Made of Water From: _____ To: _____

	Date Prepared: 4/3/18	By: TJS
	Date Entered:	By:

File No. **44768** 11. County: **RENO** Basin: **Arkansas River** Stream: --- Formation Code: --- Special Use: ---

12. Points of Diversion Rate and Quantity
 CHK MOD PDIV S T R ID 'N 'W Comment (AKA Line) Authorized Additional
 DEL Qualifier Rate Quantity Rate Quantity
 ENT S T R ID 'N 'W Comment (AKA Line) gpm/cfs af/mgy gpm/cfs af/mgy Overlap PD Files

CHK 79470 3 None

13. Storage: Rate _____ NF Quantity _____ ac/ft Additional Rate _____ NF Additional Quantity _____ ac/ft

14. Limitation: _____ af/yr at _____ gpm (_____ cfs) when combined with file number(s) _____
 Limitation: _____ af/yr at _____ gpm (_____ cfs) when combined with file number(s) _____

15. 5YR Allocation: Allocation Type _____ Start Year _____ 5 YR Amount _____ Amount Unit _____ Base Acres _____ Comment _____

16. Place of Use

CHK MOD DEL ENT	PUSE	S	T	R	ID	NE¼				NW¼				SW¼				SE¼				Total	Owner	Chg?	Overlap Files
						NE ¼	NW ¼	SW ¼	SE ¼	NE ¼	NW ¼	SW ¼	SE ¼	NE ¼	NW ¼	SW ¼	SE ¼	NE ¼	NW ¼	SW ¼	SE ¼				
MOD	54390	36	23S	7W	1									33.5	13.3	4	10.5					61.3	8b.	No	None
ENT	_____	36	23S	7W	__												2.5					2.5	8c.	No	None

Base Acres: **58** Year: **2012** Minimum Reasonable Quantity: **1.12 AF/acre**

Comments: **New owner to system (8c.)**

Submit completed application to:
 Kansas Department of Agriculture
 Division of Water Resources
 Field Office for your area.
 Call for address:

Topeka -- (785) 296-5733
 Stafford -- (620) 234-5311
 Stockton -- (785) 425-6787
 Garden City -- (620) 276-2901
<http://agriculture.ks.gov/dwr>

DWR FIELD OFFICE APPLICATION FOR APPROVAL TO CHANGE THE PLACE OF USE AND/OR THE POINT OF DIVERSION WATER METER REQUIRED



STATE OF KANSAS

Filing Fee Must Accompany the Application, K.S.A. 82a-708b(b), as amended.
 Fee Schedule is on the third page of this application form.

Paragraph Nos. 1, 2, 3 & 5 must be completed. Complete all other applicable portions. If change in point of diversion is greater than 100 feet, or if place of use will be changed, include a topographic map or detailed plat showing the authorized and proposed point(s) of diversion and/or place of use.

RECEIVED
 9:45am
 MAR 09 2018

File No. 44768

1. Application is hereby made for approval of the Chief Engineer to change the (check one or both):

Place of Use Point of Diversion

under the water right which is the subject of this application in accordance with the conditions described below.

The source of supply is: Groundwater Surface water

Stafford Field Office
 Division of Water Resources

2. Name and address of Applicant: Salt Creek Land, LLC

6400 W Illinois Ave, Hutchinson KS 67501-9137

Phone Number: (620)727-6936

Email address: orville@millerdairy.com

Name and address of Water Use Correspondent: Salt Creek Land, LLC

6400 W Illinois Ave, Hutchinson KS 67501-9137

Phone Number: (620)727-6936

Email address: orville@millerdairy.com

3. The presently authorized place of use is:

Owner of Land ---- NAME: Salt Creek Land, LLC

ADDRESS: 6400 W Illinois Ave, Hutchinson KS 67501-9137

(If there is more than one landowner, attach supplemental sheets as necessary.)

Sec.	Twp.	Range	NE¼				NW¼				SW¼				SE¼				TOTAL ACRES
			NE¼	NW¼	SW¼	SE¼	NE¼	NW¼	SW¼	SE¼	NE¼	NW¼	SW¼	SE¼	NE¼	NW¼	SW¼	SE¼	
36	23	7W									40	18							58

4. If this application is for a change in place of use, it is proposed that the place of use be changed to:

Owner of Land ---- NAME: *Salt Creek Land, LLC // **Omar L & Elsie Miller Trust

ADDRESS: 6400 W Illinois Ave, Hutchinson KS 67501-9137 // 1208 Maplewood Rd, Harrison AR 72601

(If there is more than one landowner, attach supplemental sheets as necessary.)

Sec.	Twp.	Range	NE¼				NW¼				SW¼				SE¼				TOTAL ACRES
			NE¼	NW¼	SW¼	SE¼	NE¼	NW¼	SW¼	SE¼	NE¼	NW¼	SW¼	SE¼	NE¼	NW¼	SW¼	SE¼	
*36	23	7W									33.5	13.3	4	10.5					61.3
**36	23	7W												2.5					2.5
																Total	63.8		

For Office Use Only: Code _____ Fee <u>\$200</u> TR # _____ Receipt Date _____ Check # <u>14859</u>
--

5. **Presently authorized point of diversion:**
 One in the NW Quarter of the NE Quarter of the SW Quarter of Section 36, Township 23 South, Range 7 W, in Reno County, Kansas, 1,991 feet North 3,677 feet West of Southeast corner of section. Authorized Rate 300 gpm Authorized Quantity 81.2 AF Depth of well 135 (feet)
(DWR use only: Computer ID No. 3 GPS 1,991 feet North 3,677 feet West)
 This point will not be changed This point will be changed as follows: No change, point better described with GPS as follows:
Proposed point of diversion: (Complete only if change is requested or if existing point is better described by GPS)
 One in the _____ Quarter of the _____ Quarter of the _____ Quarter of Section _____, Township _____ South, Range _____ (EW), in _____ County, Kansas, _____ feet North _____ feet West of Southeast corner of section. Proposed Rate _____ Proposed Quantity _____ Proposed well depth (feet) _____.
 This point is: Additional Well Geo Center List other water rights that will use this point _____.

6. **Presently authorized point of diversion:**
 One in the _____ Quarter of the _____ Quarter of the _____ Quarter of Section _____, Township _____ South, Range _____ (EW), in _____ County, Kansas, _____ feet North _____ feet West of Southeast corner of section. Authorized Rate _____ Authorized Quantity _____ Depth of well _____ (feet)
(DWR use only: Computer ID No. _____ GPS _____ feet North _____ feet West)
 This point will not be changed This point will be changed as follows: No change, point better described with GPS as follows:
Proposed point of diversion: (Complete only if change is requested or if existing point is better described by GPS)
 One in the _____ Quarter of the _____ Quarter of the _____ Quarter of Section _____, Township _____ South, Range _____ (EW), in _____ County, Kansas, _____ feet North _____ feet West of Southeast corner of section. Proposed Rate _____ Proposed Quantity _____ Proposed well depth (feet) _____.
 This point is: Additional Well Geo Center List other water rights that will use this point _____.

7. The changes herein are desired for the following reasons?
 (please be specific) Modify authorized acres to allow
center pivot system to sweep a full circle instead of a
windshield wiper set-up

8. If a well, is the test hole log attached? Yes No

9. The change(s) (was)(will be) completed by?
Spring 2018

10. If the point of diversion is a well:
 (a) What are you going to do with the old well?
N/A
 (b) When will this be done? N/A

11. Groundwater Management District recommendation attached? Yes No 4/2/2018*

12. Assisted by EKF // SFFO

*TSS - SFFO

13a. If the proposed point of diversion will be relocated within 100 feet of the existing point of diversion, indicate its location on the diagram below in relation to the existing point of diversion. (PLEASE NOTE: The "X" in center of diagram below represents presently authorized point of diversion.)

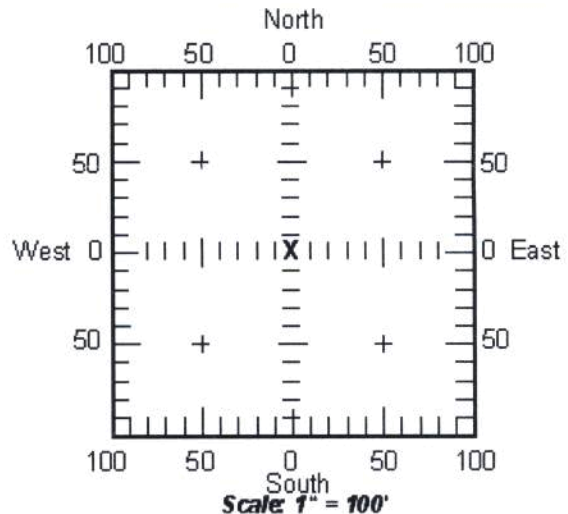

13b. If the proposed point of diversion will be relocated more than 100 feet but within 1320 feet from the existing point of diversion, attach a topographic map or aerial photograph. For groundwater sources, show all wells (including domestic) within one-half mile of the proposed point of diversion and the names and mailing addresses of the owners. For surface water sources, show the names and addresses of the landowner(s) one-half mile downstream and one-half mile upstream from your property lines.

RECEIVED

MAR 09 2018

Stafford Field Office

14. If the proposed groundwater point of diversion is 300 or fewer feet from existing point of diversion, complete the following:
- (a) Does the undersigned represent all owners of the currently authorized place(s) of use identified in this application?
 Yes No (If no, all owners must sign this application.)
 - (b) Will the ownership interest of any owner of the currently authorized place(s) of use identified in this application be adversely affected if this application is approved as requested?
 Yes No (If yes, all owners must sign this application.)
 - (c) If this application is not approved expeditiously, will there be substantial damage to property, public health or safety?
 Yes No (If no, all owners must sign this application.)

If the application proposes a surface water change in point of diversion, a groundwater change in point of diversion greater than 300 feet, or a change in place of use, the application must be signed by all owners of the currently authorized place of use, or their duly authorized agent (attach notarized statement authorizing representation).

I hereby verify, being first duly sworn upon my oath or affirmation and under penalty of perjury, that I am of lawful age and the owner, the spouse of the owner, or a duly authorized agent of the owner(s) to make this application on their behalf, in regards to the water right(s) to which this application pertains. I further verify that the statements contained in this application are true, correct and complete.

Dated at Hutchinson, Kansas, this 7th day of March, 2018.

Orville Miller

 (Owner)
Orville Miller

 (Please Print)

 (Owner)

 (Please Print)

 (Owner)

 (Please Print)

 (Spouse)

 (Please Print)

 (Spouse)

 (Please Print)

 (Spouse)

 (Please Print)

State of Kansas }
 County of Renov } SS

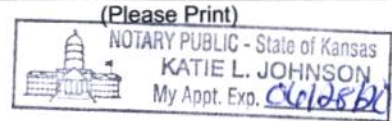

I hereby certify that the foregoing application was signed in my presence and sworn to before me this 7th day of March, 2018.

Katie L. Johnson

 Notary Public

My Commission Expires 06/28/20

ONLY COMPLETE APPLICATIONS WILL BE PROCESSED. To be complete, all of the applicable portions of the application form must be completed with accurate information; maps, if necessary, must be included; signatures of all the appropriate owners' must be affixed to the application and notarized; and the appropriate fee must be paid.

FEE SCHEDULE

- Each application to change the place of use or the point of diversion under this section shall be accompanied by the application fee set forth in the schedule below: Make checks payable to: **Kansas Department of Agriculture**
- (1) Application to change a point of diversion 300 feet or less \$100
 - (2) Application to change a point of diversion more than 300 feet \$200
 - (3) Application to change the place of use \$200

RECEIVED

MAR 09 2018

Stafford Field Office

SUMMARY ORDER APPROVING APPLICATION FOR CHANGE AND IMPOSING CONDITIONS

This Summary Order is issued under authority of K.S.A. 82a-708b, as amended, and K.A.R. 5-5-1, et seq. and other applicable provisions of the *Kansas Water Appropriation Law, K.S.A. 82a-701 et. seq.*, and rules and regulations promulgated thereunder. With the exception of those conditions expressly contained herein, this Summary Order does not change the terms, conditions and limitations of File No. 44768.

- 1. A change application was received on 3/9/2018 requesting that the place of use and / or point of diversion authorized under the above-referenced file number be changed as described in the application.
- 2. On and after the effective date of this summary order, the authorized place(s) of use shall be located substantially as shown on the topographic map accompanying the application to change the place of use. Applicable Not Applicable
- 3. The change in point of diversion shall not impair existing rights and shall be limited to the same source or sources of water as previously authorized. The point of diversion authorized by this summary order shall be located within a _____ foot radius of the authorized point(s) of diversion. Applicable Not Applicable
- 4. The point(s) of diversion authorized herein shall not actually be located more than _____ feet from the previously authorized point(s) of diversion. Applicable Not Applicable
- 5. As required by K.A.R. 5-3-5d, if the works for diversion is a well with a diversion rate of 100 gallons per minute or more, a tube or other device suitable for making water level measurements shall be installed, operated and maintained in accordance with K.A.R. 5-6-13. Applicable Not Applicable
- 6. The owner of the authorized place(s) of use shall properly install an acceptable water flow meter on or before **December 31, 2018**, or before the first use of water, whichever occurs first. The water flow meter shall be installed, operated and maintained in accordance with K.A.R. 5-1-4 through 5-1-12. As required by K.S.A. 82a-732, as amended, and K.A.R. 5-3-5e, the owner shall maintain records and report the reading of the water flow meter and the total quantity of water diverted annually to the Chief Engineer by March 1 following the end of each calendar year. Applicable Not Applicable
- 7. Installation of the works for diversion of water shall be completed on or before **December 31, 20**_____, or within any authorized extension of time. By March 1, 20____ the applicant shall notify the Chief Engineer that construction of the works for diversion has been completed, on the form provided by the Chief Engineer, as required by K.A.R. 5-8-4e. Applicable Not Applicable
- 8. The completed well log shall be submitted with the required notice. Applicable Not Applicable
- 9. All diversion works into which any type of chemical or other foreign substance will be injected into the water shall be equipped with an in-line, automatic, quick-closing check valve capable of preventing pollution of the source of the water supply. The check valve(s) shall be installed, operated and maintained in accordance with K.A.R. 5-3-5c. Applicable Not Applicable
- 10. Additional Conditions are attached. Yes No
- 11. In accordance with K.S.A. 82a-708a, as amended, and K.A.R. 5-5-14, all of the owners of the authorized place(s) of use of water appropriated under the above-referenced file number are responsible for compliance with its terms, conditions and limitations, as amended and/or supplemented by this Summary Order, and with applicable provisions of the *Kansas Water Appropriation Law* and the *Rules and Regulations* promulgated thereunder. Failure to comply with these provisions may result in civil penalties pursuant to K.S.A. 82a-737, as amended, and/or the suspension or revocation and dismissal of the water or appropriation right or any other enforcement actions authorized by law.

Administrative Appeal and Effective Date of Order

If you are aggrieved by this order, pursuant to K.S.A. 82a-1901, you may request an evidentiary hearing before the Chief Engineer or request administrative review by the Secretary of Agriculture. A request for hearing by the Chief Engineer must be filed within **15 days** of service of this Order and a request for administrative review by the Secretary must be filed within **30 days** pursuant to K.S.A. 77-531. Any request for administrative review must state a basis for review pursuant to K.S.A. 77-527. File any request with **Kansas Department of Agriculture, Legal Division, 1320 Research Park Drive, Manhattan, KS 66502**. Failure to timely request a hearing or review may preclude review under the Kansas Judicial Review Act.

For Use by Register of Deeds

FOR OFFICE USE ONLY
**APPLICATION APPROVED AND
SUMMARY ORDER ISSUED**

By: Jeff Lanterman
Duly Authorized Designee of the Chief Engineer

(Print Name): Jeff Lanterman
Division of Water Resources - Kansas Department of Agriculture

Date of Issuance: 4/5/2018

State of Kansas)
County of Stafford) SS

Acknowledged before me on 4/5/2018
by Jeff Lanterman

Signature: Jessica Engelbrecht
Notary Public

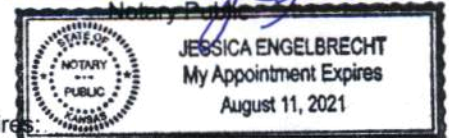

My commission expires: _____
(Notary Seal)

RECEIVED

MAR 09 2018

Stafford Field Office

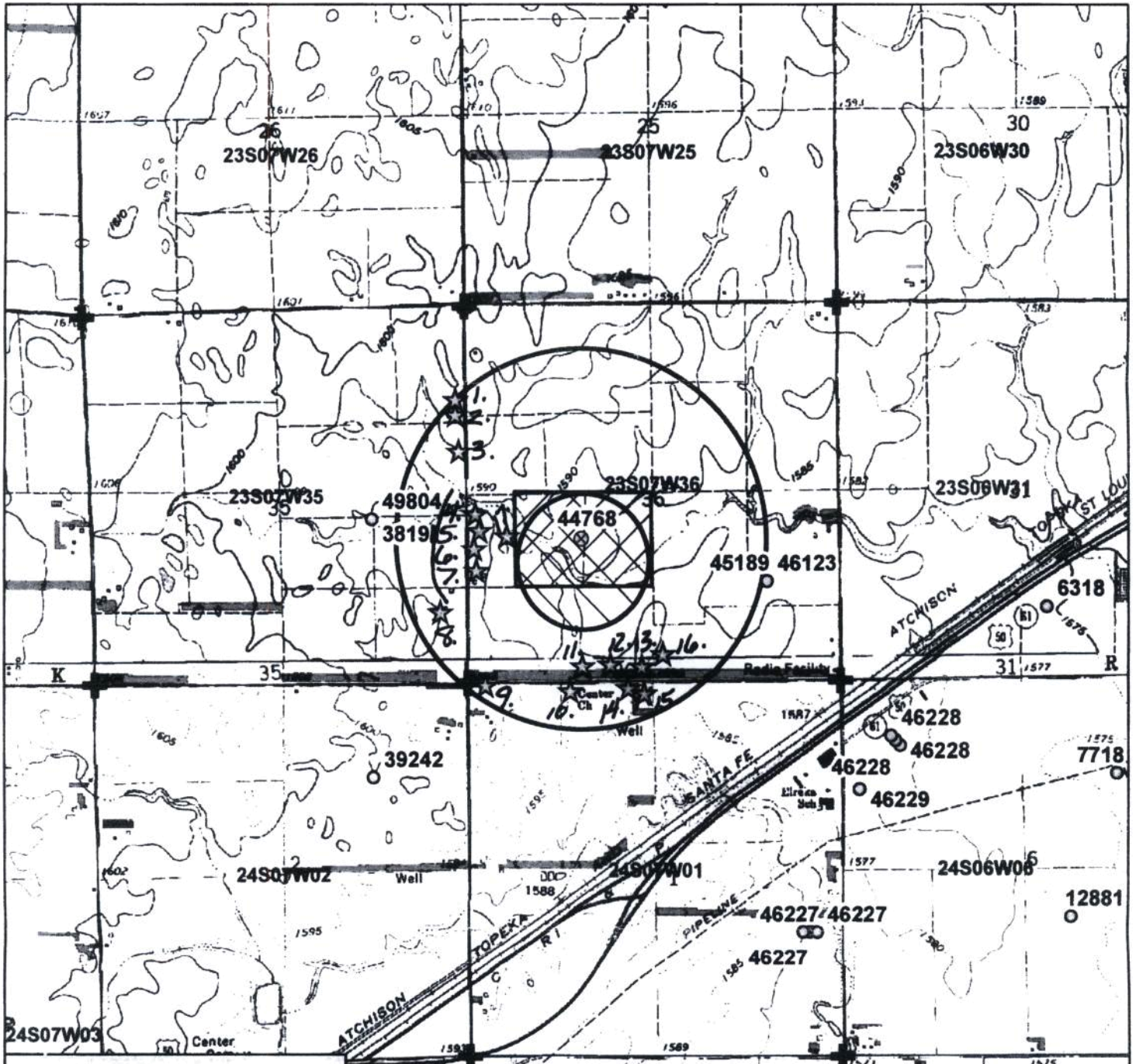

Legend

- ⊗ Actual Point of Diversion
- Water Appropriations
- ☆ Domestic Well
- ⊕ Section Corner
- ▭ Section Line
- Half Mile Circle
- ▨ Authorized Place of Use
- ▨ Proposed Place of Use

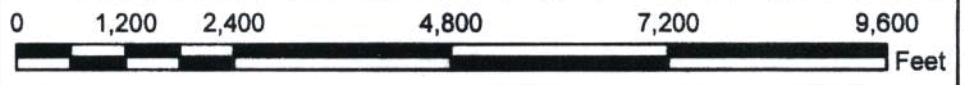

Water Right, File No. 44768
Change in Place of Use Application Map
36-23S-7W // Reno County

To the best of my knowledge, all of the domestic wells within 1/2 mile of the proposed point of diversion have been shown.

RECEIVED

MAR 09 2018

Phillip Miller
 Signature



File No. 44768 Change Application
Near-by Domestic Well Owners

1. YODER, NATHAN L & TRESA A & TONYA R
3611 S HERREN RD
HUTCHINSON, KS 67501
2. NISLY, GLENN E
112 RIVER PARK DR
MIDDLEBURY, IN 46540
3. NISLY, ELMER & CORA C REV TRUST
3711 S HERREN RD
HUTCHINSON, KS 67501
4. MILLER, GLENN LEON & ANN
4014 S HERREN RD
HUTCHINSON, KS 67501-8845
5. GRABER, RICHARD S & WILMA
4104 S HERREN RD
HUTCHINSON, KS 67501-9177
6. GRABER, RICHARD S & WILMA
4104 S HERREN RD
HUTCHINSON, KS 67501-9177
7. GRABER, RICHARD S & WILMA
4104 S HERREN RD
HUTCHINSON, KS 67501-9177
8. NISLY, JULIAN E TRUST & BERTHA J TRUST
4311 S HERREN RD
HUTCHINSON, KS 67501
9. NISLY, ELLEN & SHIRLEY; MORRIS, SHAWNA;
MILLER, SHARON L & SHERYL ETAL
7905 W MORGAN AVE
HUTCHINSON KS 67501-9737
10. CENTER AMISH MENNONITE CHURCH
C/O MILLER, KEITH
7611 W MORGAN AVE
HUTCHINSON, KS 67501
11. GRAVES, FONDA
7610 W MORGAN AVE
HUTCHINSON, KS 67501
12. NISLY, HARVEY D
7412 W MORGAN AVE
HUTCHINSON, KS 67501-9061
13. MILLER, MARLIN D & TRUDY D TRUSTS
7305 W MORGAN AVE
HUTCHINSON, KS 67501
14. MILLER, BRETT D & TRACI
7411 W MORGAN AVE
HUTCHINSON, KS 67501
15. MILLER, MARLIN D & TRUDY D TRUSTS
7305 W MORGAN AVE
HUTCHINSON, KS 67501
16. KAUFFMAN, KENNETH L & SHARON R
7116 W MORGAN AVE
HUTCHINSON, KS 67501
17. PRAIRIE RENTAL PROPERTIES LLC
4104 S HERREN RD
HUTCHINSON, KS 67501-9177

RECEIVED

MAR 09 2018

St. Clair Field Office

STATE OF KANSAS

DEPARTMENT OF AGRICULTURE
DIVISION OF WATER RESOURCES
STAFFORD FIELD OFFICE
300 S. MAIN STREET
STAFFORD, KS 67578-1521



PHONE: (620) 234-5311
FAX: (620) 234-6900
www.agriculture.ks.gov

GOVERNOR JEFF COLYER, M.D.
JACKIE McCLASKEY, SECRETARY OF AGRICULTURE

April 6, 2018

Salt Creek Land, LLC
6400 W Illinois Ave
Hutchinson KS 67501-9137

Re: Water Right, File No(s). 44768

Dear Water Right Owner:

Enclosed is the order executed by the Chief Engineer, Division of Water Resources, Kansas Department of Agriculture, approving the application for change under the above referenced file number(s).

Your attention is directed to the enclosures and to the terms, conditions and limitations specified in this approval for change. An acceptable water flow meter must be installed on your well before any water is applied as authorized under this change approval. A copy of the approved list of Certified Water Flowmeters as well as the regulations regarding the installation of flowmeters, measurement tubes and check valves can be found at <http://agriculture.ks.gov/divisions-programs/dwr/water-appropriation/water-flowmeters>. If you do not have access to the internet, please contact this office and we will send you a paper copy of the referenced information.

Since this order modifies the original document referred to above, it should be recorded with the Register of Deeds as other instruments affecting real estate.

Should you have any questions, please feel free to contact this office. If you wish to refer to a specific file, please reference it when you contact us.

Sincerely,

A handwritten signature in black ink, appearing to read "Jeff Lanterman".

Jeff Lanterman
Water Commissioner

Enclosures

pc: Water Rights Section
Groundwater Management District No. 2

CERTIFICATE OF SERVICE

On this **6th** day of **April, 2018**, I hereby certify that the attached Change in Place of Use for Water Right, File No. **44768**, dated **April 5, 2018** was mailed via Certified U.S. mail to the following:

Salt Creek Land, LLC
6400 W Illinois Ave
Hutchinson KS 67501-9137

A copy of the letter was sent to the following:

GMD 2



Staff



KANSAS DEPARTMENT OF AGRICULTURE

Division of Water Resources

Stafford Field Office

MEMORANDUM

TO: File

DATE: 3/16/2018

FROM: Tyler Saryerwinnie

RE: File No. 44768

This is a memorandum regarding surrounding well owner notification on irrigation field office PU changes and pertains to decisions made during the Water Commissioner meeting which took place on 11/16/2016 with directive from Lane Letourneau, Program Manager.

This is applicable to field office changes to increase the place of use by 10 acres or 10% (whichever is less) or a change in place of use to create a complete overlap in which no new acres are being irrigated.

During that meeting it was determined that no surrounding well owner notification will be sent under this type of Place of Use change. All well rates and quantities will remain unchanged and the referenced change will not cause impairment or impact surrounding well owners.

The change in place of use filed on 3/9/2018 for the above referenced file meets this criteria and surrounding well owners will not be notified.

Saryerwinnie, Tyler [KDA]

From: Saryerwinnie, Tyler [KDA]
Sent: Wednesday, March 21, 2018 8:48 AM
To: 'Rebecca Wilson'
Cc: Conant, Cameron [KDA]
Subject: Recommendation Request - File No. 44768
Attachments: 44768.Cover Letter.pdf; 44768.Change App.pdf

Rebecca,

I have attached a cover letter and a copy of one (1) place of use application for GMD review and recommendation. Please provide the GMD recommendation by no later than April 10, 2018.

Please let me know if you have any questions or concerns.

Tyler

Tyler Saryerwinnie, Environmental Scientist
Kansas Department of Agriculture
Division of Water Resources
Stafford Field Office
Phone: (620)234-5311

STATE OF KANSAS

DEPARTMENT OF AGRICULTURE
DIVISION OF WATER RESOURCES
STAFFORD FIELD OFFICE
300 S. MAIN STREET
STAFFORD, KS 67578-1521



PHONE: (620) 234-5311
FAX: (620) 234-6900
www.agriculture.ks.gov

GOVERNOR JEFF COLYER, M.D.
JACKIE McCLASKEY, SECRETARY OF AGRICULTURE

March 21, 2018

Tim Boese
Equus Beds – GMD No. 2
313 Spruce Street
Halstead, KS 67056

RE: Place of Use Change Application, File No(s). 44,768

Dear Mr. Boese,

We are enclosing a copy of the application, as referenced above, for your review and recommendation. At this time the application appears to be in proper form.

This office will delay any further action on this file for a period of 15 business days from the date of this letter to allow you time to submit your recommendation concerning the application. Please submit your recommendation within the allotted time, or any authorized extension of time thereof.

If you have any questions, please feel free to contact the office.

Sincerely,

Tyler Saryerwinnie
Environmental Scientist
Stafford Field Office
tyler.saryerwinnie@ks.gov

Enclosure

Saryerwinnie, Tyler [KDA]

From: Rebecca Wilson <rwilson@gmd2.org>
Sent: Monday, April 02, 2018 4:20 PM
To: Saryerwinnie, Tyler [KDA]
Subject: 44768 PU Change App Approval Letter
Attachments: 44768 PU Change App Approval Letter 4-02-18.pdf

Good afternoon!

Attached you will find the Place of Use Change Application Approval Letter from Manager Tim Boese for #44768.

Please let me know if you have any difficulties opening the attachment.

Thanks!

Rebecca Wilson

Rebecca Wilson
Administrative Assistant
Equus Beds GMD2
313 Spruce Street
Halstead, KS 67056
316-835-2224
316-835-2225 Fax
rwilson@gmd2.org
www.gmd2.org

JEFF WINTER, PRESIDENT
VIN KISSICK, VICE PRESIDENT
ALAN BURGHART, SECRETARY
MIKE MCGINN, TREASURER
TIM BOESE, MANAGER
THOMAS A. ADRIAN, ATTORNEY



DIRECTORS:
DAVID BOGNER
JOE PAJOR
DALE SCHMIDT
BOB SEILER
DAVID STROBERG

EQUUS BEDS GROUNDWATER MANAGEMENT DISTRICT NO. 2

313 SPRUCE STREET • HALSTEAD, KANSAS 67056-1925 • PHONE (316) 835-2224 • FAX (316) 835-2225 • equusbeds@gmd2.org • www.gmd2.org

March 30, 2018

Chief Engineer, Division of Water Resources
Attn: Tyler Saryerwinnie
300 S. Main St.
Stafford, Kansas 67578

Re: Place of Use Change Application, File No. 44768 – Salt Creek Land LLC

Mr. Saryerwinnie:

The Equus Beds Groundwater Management District No. 2 reviewed the referenced change in place of use application on March 30, 2018, using the District's Revised Management Program (effective May 1, 1995) and Rules and Regulations K.A.R. 5-22-1 through 5-22-17.

The change application proposes to increase the place of use 5.8 acres from 58 acres to 63.8 acres. The proposed place of use results in a water to land ratio of 1.27 acre-feet per acre.

The District's review found that the change application complies with the Revised Aquifer Management program approved by the Chief Engineer and with the District's Rules and Regulations K.A.R. 5-22-1 through 5-22-17. Based upon the review, the application is recommended for approval by the Equus Beds Groundwater Management District No. 2.

A District decision may be appealed to the District Board of Directors by submitting a written petition to the District office within 30 days from date of this notification, pursuant to K.A.R. 5-22-12. Please contact the District should you have any questions regarding the review or recommendation.

Sincerely,
EQUUS BEDS GROUNDWATER
MANAGEMENT DISTRICT NO. 2

Tim Boese
Manager
TDB/STF

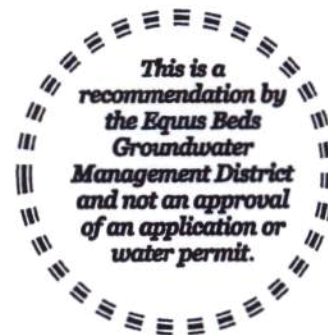

RECEIVED

pc: Salt Creek Land LLC, Applicant and Landowner
Omar L & Elise Miller Trust, Landowner

APR 02 2018

Stafford Field Office
DIVISION OF WATER RESOURCES

**EQUUS BEDS GROUNDWATER MANAGEMENT DISTRICT NO. 2
FINAL APPLICATION REVIEW CHECKLIST**

1) Application No. 44768 Date filed: 3/09/18
 2) Applicant: Salt Creek Land, LLC County: Reno
 3) Proposed maximum quantity: 81.2 acre-feet/year Rate: 300 GPM
 4) Proposed Use: Irrigation
 5) P/D location: NW NE SW 36-23S-7W Geo Center: North 1991 ft, West 3677 ft
 6) Number and type of points of diversion listed on the application 1 Well

7) Meter required K.A.R. 5-22-4a or K.A.R. 5-22-8? Yes No, Why _____
 8) Meets change app requirements K.A.R. 5-22-8? Yes No N/A
 9) Overlapping PU File No. 0
 10) Overlapping PD File No. 0
 11) Authorized Acres 58 Acres
 12) Base Acres 58 Acres

13) Meets Max Reasonable Quantity K.A.R. 5-22-14? Yes No N/A
 (a) Irrigation max quantity: 1.27 acre-feet / acre
 (b) Stockwater max quantity: _____ GPD _____ unit
 (c) Industry max quantity: _____ Acre
 Industry standard: _____
 14) Reasonable rate for intended use? Yes No N/A
 15) Depth to water: 38 ft bls at observation well: Service Contract Well

16) Date reviewed: 3/30/2018
 17) Reviewed by: S. Flaherty Title: Hydrogeologist *Review 4-2-18*
 18) District recommendation: Approve Deny Other, see comment

19) Comments and Calculations:

Review complete for an application to change the place of use submitted by Salt Creek Land LLC.
 Water Right No 44768 has 58 base acres and the applicant proposes to increase the place of use 5.8 ACRES (10%) to a 63.8 acre circle pivot
 Item 13(a): 81.2 AF / 63.8 acres = 1.27 AF/A
 All land owners signed change app. Oatney sold to Salt Creek Land LLC in Jan of 2018 Deed is in file.
 Recommend Approval, Complies with K.A.R. 5-22-1 through 5-22-17

RECEIVED
 APR 02 2018
 Stafford Field Office
 DIVISION OF WATER RESOURCES

KANSAS DEPARTMENT OF AGRICULTURE
Division of Water Resources

M E M O R A N D U M

TO: Files

DATE: April 3, 2018

FROM: Tyler Saryerwinnie

RE: Water Appropriation, File No. 48291

I called Bob Fairchild on April 3, 2018 regarding a map signature which was required for an application to change the place of use under the above referenced file. During our conversation, Mr. Fairchild mentioned that he had installed the required straightening vanes and wanted to know how to proceed regarding the compliance deadline. I told Mr. Fairchild that I would make a note of this in the file and that compliance would be checked on site at a later time.