

Kansas Department of Agriculture  
 Division of Water Resources  
**CHANGE: P/D WORKSHEET**

1. File Number: <b>48352</b>	2. Status Change Date:	3. Change Num: <b>1</b>	4. Field Office: <b>02</b>	5. GMD: <b>02</b>
---------------------------------	------------------------	----------------------------	-------------------------------	----------------------

6. Status: <input checked="" type="checkbox"/> Approved <input type="checkbox"/> Denied by DWR/GMD <input type="checkbox"/> Dismiss by Request/Failure to Return	7. Filing Date of Change: <b>2/8/18</b>
--	--

8a. Applicant(s) New to system <input type="checkbox"/>	Person ID _____ Add Seq# _____	8c. Landowner(s) New to system <input type="checkbox"/>	Person ID _____ Add Seq# _____
--	-----------------------------------	--	-----------------------------------

8b. Landowner(s) New to system <input type="checkbox"/>	Person ID <b>65379</b> Add Seq# <b>1</b>	8d. WUC New to system <input type="checkbox"/>	Person ID <b>61364</b> Add Seq# <b>2</b>
<b>FULL BUCK MOON FARMS LLC</b> <b>PO BOX 6428</b> <b>WESTLAKE VILLAGE CA 91359-6428</b>		<b>FARMERS NATIONAL CO</b> <b>CHRIS OSTMEYER</b> <b>PO BOX 40</b> <b>KECHI KS 67067</b>	

9. Documents and Enclosure(s):  DWR Meter(s) Date to Comply: **12/31/2018**     N & P Date to Comply: \_\_\_\_\_

Anti-Reverse Meter     Meter Seal     Check Valve     N & P Form     Water Tube     Driller Copy     H & E Letter

Conservation Plan    Date Required: \_\_\_\_\_    Date Approved: **3/20/18**    Date to Comply: \_\_\_\_\_

10. Use Made of Water    From: \_\_\_\_\_    To: \_\_\_\_\_

Date Prepared: **3/16/18**    By: **TJS**  
 Date Entered: \_\_\_\_\_    By: \_\_\_\_\_

File No. **48352**      11. County: **RENO**    Basin: **Arkansas River**      Stream: ---      Formation Code: **190**      Special Use: **None**

12. Points of Diversion										Rate and Quantity				Overlap PD Files		
CHK	MOD	DEL	ENT	PDIV	Qualifier	S	T	R	ID	'N	'W	Comment (AKA Line)	Rate gpm/cfs		Quantity af/mgy	Rate gpm/cfs

<b>CHK</b>	<b>80820</b>								<b>20</b>								<b>None</b>
------------	--------------	--	--	--	--	--	--	--	-----------	--	--	--	--	--	--	--	-------------

13. Storage: Rate \_\_\_\_\_ NF    Quantity \_\_\_\_\_ ac/ft    Additional Rate \_\_\_\_\_ NF    Additional Quantity \_\_\_\_\_ ac/ft

14. Limitation: \_\_\_\_\_ af/yr at \_\_\_\_\_ gpm ( \_\_\_\_\_ cfs) when combined with file number(s) \_\_\_\_\_  
 Limitation: \_\_\_\_\_ af/yr at \_\_\_\_\_ gpm ( \_\_\_\_\_ cfs) when combined with file number(s) \_\_\_\_\_

15. 5YR Allocation: Allocation Type \_\_\_\_\_ Start Year \_\_\_\_\_ 5 YR Amount \_\_\_\_\_ Amount Unit \_\_\_\_\_ Base Acres \_\_\_\_\_ Comment \_\_\_\_\_

16. Place of Use										NE¼				NW¼				SW¼				SE¼				Total	Owner	Chg?	Overlap Files
CHK	MOD	DEL	ENT	PUSE	S	T	R	ID		NE ¼	NW ¼	SW ¼	SE ¼	NE ¼	NW ¼	SW ¼	SE ¼	NE ¼	NW ¼	SW ¼	SE ¼	NE ¼	NW ¼	SW ¼	SE ¼				

<b>MOD</b>	<b>59353</b>	<b>32</b>	<b>22S</b>	<b>6W</b>	<b>13</b>									<b>23.5</b>											<b>29.5</b>				<b>98</b>	<b>8b.</b>	<b>No</b>	<b>None</b>
------------	--------------	-----------	------------	-----------	-----------	--	--	--	--	--	--	--	--	-------------	--	--	--	--	--	--	--	--	--	--	-------------	--	--	--	-----------	------------	-----------	-------------

Base Acres: **96**    Year: **Permit**    Minimum Reasonable Quantity: **1.12 AF/acre**

Comments: **Please send originals to the owner (Lucinda) and copies to the WUC (Chris Ostmeyer)**

Submit completed application to:  
 Kansas Department of Agriculture  
 Division of Water Resources  
 Field Office for your area.  
 Call for address:

Topeka -- (785) 296-5733  
 Stafford -- (620) 234-5311  
 Stockton -- (785) 425-6787  
 Garden City -- (620) 276-2901  
<http://agriculture.ks.gov/dwr>

**DWR FIELD OFFICE  
 APPLICATION FOR APPROVAL  
 TO CHANGE THE PLACE OF  
 USE AND/OR THE  
 POINT OF DIVERSION  
 WATER METER REQUIRED**



**STATE OF KANSAS**

**Filing Fee Must Accompany the Application, K.S.A. 82a-708b(b), as amended.  
 Fee Schedule is on the third page of this application form.**

**Paragraph Nos. 1, 2, 3 & 5 must be completed. Complete all other applicable portions.** If change in point of diversion is greater than 100 feet, or if place of use will be changed, include a topographic map or detailed plat showing the authorized and proposed point(s) of diversion and/or place of use.

**RECEIVED**  
 8:57am  
**FEB 08 2018**

File No. 48352

Stafford Field Office  
 Division of Water Resources

1. Application is hereby made for approval of the Chief Engineer to change the (check one or both):
- Place of Use                       Point of Diversion
- under the water right which is the subject of this application in accordance with the conditions described below.
- The source of supply is:                       Groundwater                       Surface water

2. Name and address of Applicant: Farmers National Co  
Chris Ostmeyer, PO Box 40, Kechi KS 67067  
 Phone Number: (316)788-4240                      Email address: costmeyer@farmersnational.com
- Name and address of Water Use Correspondent: Farmers National Co  
Chris Ostmeyer, PO Box 40, Kechi KS 67067  
 Phone Number: (316)788-4240                      Email address: costmeyer@farmersnational.com

3. The presently authorized place of use is:  
 Owner of Land ---- NAME: Full Buck Moon Farms LLC  
 ADDRESS: PO Box 6428, Westlake Village CA 91359-6428  
 (If there is more than one landowner, attach supplemental sheets as necessary.)

Sec.	Twp.	Range	NE¼				NW¼				SW¼				SE¼				TOTAL ACRES				
			NE¼	NW¼	SW¼	SE¼	NE¼	NW¼	SW¼	SE¼	NE¼	NW¼	SW¼	SE¼	NE¼	NW¼	SW¼	SE¼					
32	22	6W									22				27				21	26			96

4. If this application is for a change in place of use, it is proposed that the place of use be changed to:  
 Owner of Land ---- NAME: Full Buck Moon Farms LLC  
 ADDRESS: PO Box 6428, Westlake Village CA 91359-6428  
 (If there is more than one landowner, attach supplemental sheets as necessary.)

Sec.	Twp.	Range	NE¼				NW¼				SW¼				SE¼				TOTAL ACRES				
			NE¼	NW¼	SW¼	SE¼	NE¼	NW¼	SW¼	SE¼	NE¼	NW¼	SW¼	SE¼	NE¼	NW¼	SW¼	SE¼					
32	22	6W									23.5				29.5				20	25			98

**For Office Use Only: Code \_\_\_\_\_ Fee \$ 300 - TR # \_\_\_\_\_ Receipt Date \_\_\_\_\_ Check # 440878**



5. **Presently authorized point of diversion:**  
 One in the NE Quarter of the SE Quarter of the SW Quarter of Section 32, Township 22 South, Range 6 W, in Reno County, Kansas, 1,270 feet North 2,660 feet West of Southeast corner of section. Authorized Rate 1,000 gpm Authorized Quantity 134.4 AF Depth of well 54 (feet)  
**(DWR use only: Computer ID No. 20 GPS 1,264 feet North 2,740 feet West)**  
 This point will not be changed  This point will be changed as follows:  No change, point better described with GPS as follows:  
**Proposed point of diversion: (Complete only if change is requested or if existing point is better described by GPS)**  
 One in the \_\_\_\_\_ Quarter of the \_\_\_\_\_ Quarter of the \_\_\_\_\_ Quarter of Section \_\_\_\_\_, Township \_\_\_\_\_ South, Range \_\_\_\_\_ (E/W), in \_\_\_\_\_ County, Kansas, \_\_\_\_\_ feet North \_\_\_\_\_ feet West of Southeast corner of section. Proposed Rate \_\_\_\_\_ Proposed Quantity \_\_\_\_\_ Proposed well depth (feet) \_\_\_\_\_  
 This point is:  Additional Well  Geo Center List other water rights that will use this point none

6. **Presently authorized point of diversion:**  
 One in the \_\_\_\_\_ Quarter of the \_\_\_\_\_ Quarter of the \_\_\_\_\_ Quarter of Section \_\_\_\_\_, Township \_\_\_\_\_ South, Range \_\_\_\_\_ (E/W), in \_\_\_\_\_ County, Kansas, \_\_\_\_\_ feet North \_\_\_\_\_ feet West of Southeast corner of section. Authorized Rate \_\_\_\_\_ Authorized Quantity \_\_\_\_\_ Depth of well \_\_\_\_\_ (feet)  
**(DWR use only: Computer ID No. \_\_\_\_\_ GPS \_\_\_\_\_ feet North \_\_\_\_\_ feet West)**  
 This point will not be changed  This point will be changed as follows:  No change, point better described with GPS as follows:  
**Proposed point of diversion: (Complete only if change is requested or if existing point is better described by GPS)**  
 One in the \_\_\_\_\_ Quarter of the \_\_\_\_\_ Quarter of the \_\_\_\_\_ Quarter of Section \_\_\_\_\_, Township \_\_\_\_\_ South, Range \_\_\_\_\_ (E/W), in \_\_\_\_\_ County, Kansas, \_\_\_\_\_ feet North \_\_\_\_\_ feet West of Southeast corner of section. Proposed Rate \_\_\_\_\_ Proposed Quantity \_\_\_\_\_ Proposed well depth (feet) \_\_\_\_\_  
 This point is:  Additional Well  Geo Center List other water rights that will use this point \_\_\_\_\_

7. The changes herein are desired for the following reasons?  
 (please be specific) Modify the authorized place of use  
to include more acres under installed center pivot system

13a. If the proposed point of diversion will be relocated within 100 feet of the existing point of diversion, indicate its location on the diagram below in relation to the existing point of diversion. (PLEASE NOTE: The "X" in center of diagram below represents presently authorized point of diversion.)

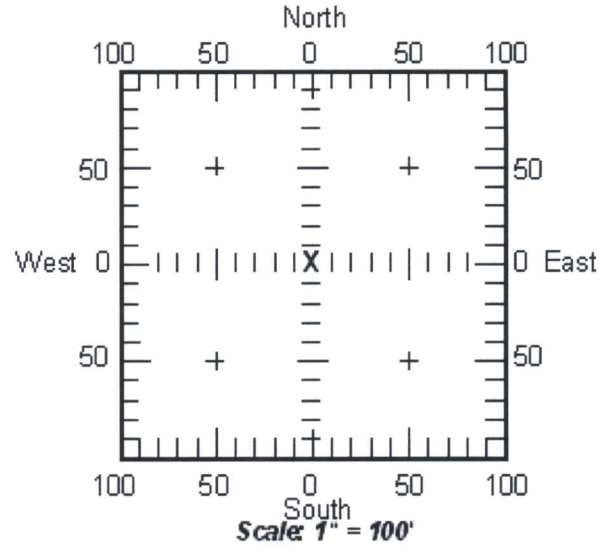

8. If a well, is the test hole log attached?  Yes  No
9. The change(s) (was)(will be) completed by?  
upon approval of change
10. If the point of diversion is a well:  
 (a) What are you going to do with the old well?  
N/A  
 (b) When will this be done? N/A

11. Groundwater Management District recommendation attached?  Yes  No 3/12/18 TJS-SFFO

12. Assisted by EKF // SFFO

13b. If the proposed point of diversion will be relocated more than 100 feet but within 1320 feet from the existing point of diversion, attach a topographic map or aerial photograph. For groundwater sources, show all wells (including domestic) within one-half mile of the proposed point of diversion and the names and mailing addresses of the owners. For surface water sources, show the names and addresses of the landowner(s) one-half mile downstream and one-half mile upstream from your property lines.

RECEIVED

FEB 08 2018

14. If the proposed groundwater point of diversion is 300 or fewer feet from existing point of diversion, complete the following:
- (a) Does the undersigned represent all owners of the currently authorized place(s) of use identified in this application?  
 Yes     No    (If no, all owners must sign this application.)
  - (b) Will the ownership interest of any owner of the currently authorized place(s) of use identified in this application be adversely affected if this application is approved as requested?  
 Yes     No    (If yes, all owners must sign this application.)
  - (c) If this application is not approved expeditiously, will there be substantial damage to property, public health or safety?  
 Yes     No    (If no, all owners must sign this application.)

If the application proposes a surface water change in point of diversion, a groundwater change in point of diversion greater than 300 feet, or a change in place of use, the application must be signed by all owners of the currently authorized place of use, or their duly authorized agent (attach notarized statement authorizing representation).

**I hereby verify, being first duly sworn upon my oath or affirmation and under penalty of perjury, that I am of lawful age and the owner, the spouse of the owner, or a duly authorized agent of the owner(s) to make this application on their behalf, in regards to the water right(s) to which this application pertains. I further verify that the statements contained in this application are true, correct and complete.**

Dated at Hutchinson, Kansas, this 19<sup>th</sup> day of January, 2018.

<p><u>Lucinda Piligian</u> (Owner)</p> <p><u>LUCINDA PILIGIAN</u> (Please Print)</p> <p>_____ (Owner)</p> <p>_____ (Please Print)</p> <p>_____ (Owner)</p> <p>_____ (Please Print)</p>	<p>_____ (Spouse)</p> <p>_____ (Please Print)</p> <p>_____ (Spouse)</p> <p>_____ (Please Print)</p> <p>_____ (Spouse)</p> <p>_____ (Please Print)</p>
--	---

State of Kansas }  
 County of Reno } SS

I hereby certify that the foregoing application was signed in my presence and sworn to before me this 19<sup>th</sup> day of January, 2018.

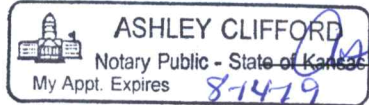
  
Ashley Clifford  
 Notary Public

My Commission Expires 8-14-19

**ONLY COMPLETE APPLICATIONS WILL BE PROCESSED.** To be complete, all of the applicable portions of the application form must be completed with accurate information; maps, if necessary, must be included; signatures of all the appropriate owners' must be affixed to the application and notarized; and the appropriate fee must be paid.

**FEE SCHEDULE**

Each application to change the place of use or the point of diversion under this section shall be accompanied by the application fee set forth in the schedule below: Make checks payable to: **Kansas Department of Agriculture**

(1) Application to change a point of diversion 300 feet or less .....	\$100
(2) Application to change a point of diversion more than 300 feet .....	\$200
(3) Application to change the place of use .....	\$200

RECEIVED

FEB 08 2018

DWR 1-121 (Revised 07/10/2017)  
 Stafford Field Office



**SUMMARY ORDER APPROVING APPLICATION FOR CHANGE AND IMPOSING CONDITIONS**

This Summary Order is issued under authority of K.S.A. 82a-708b, as amended, and K.A.R. 5-5-1, *et seq.* and other applicable provisions of the *Kansas Water Appropriation Law, K.S.A. 82a-701 et seq.*, and rules and regulations promulgated thereunder. With the exception of those conditions expressly contained herein, this Summary Order does not change the terms, conditions and limitations of File No. 48352.

1. A change application was received on 2/8/2018 requesting that the place of use and / or point of diversion authorized under the above-referenced file number be changed as described in the application.
2. On and after the effective date of this summary order, the authorized place(s) of use shall be located substantially as shown on the topographic map accompanying the application to change the place of use.  Applicable  Not Applicable
3. The change in point of diversion shall not impair existing rights and shall be limited to the same source or sources of water as previously authorized. The point of diversion authorized by this summary order shall be located within a \_\_\_\_\_ foot radius of the authorized point(s) of diversion.  Applicable  Not Applicable
4. The point(s) of diversion authorized herein shall not actually be located more than \_\_\_\_\_ feet from the previously authorized point(s) of diversion.  Applicable  Not Applicable
5. As required by K.A.R. 5-3-5d, if the works for diversion is a well with a diversion rate of 100 gallons per minute or more, a tube or other device suitable for making water level measurements shall be installed, operated and maintained in accordance with K.A.R. 5-6-13.  Applicable  Not Applicable
6. **The owner of the authorized place(s) of use shall properly install an acceptable water flow meter on or before December 31, 2018**, or before the first use of water, whichever occurs first. The water flow meter shall be installed, operated and maintained in accordance with K.A.R. 5-1-4 through 5-1-12. As required by K.S.A. 82a-732, as amended, and K.A.R. 5-3-5e, the owner shall maintain records and report the reading of the water flow meter and the total quantity of water diverted annually to the Chief Engineer by March 1 following the end of each calendar year.  
 Applicable  Not Applicable
7. **Installation of the works for diversion of water shall be completed on or before December 31, 20**\_\_\_\_\_, or within any authorized extension of time. By March 1, 20\_\_\_\_\_ the applicant shall notify the Chief Engineer that construction of the works for diversion has been completed, on the form provided by the Chief Engineer, as required by K.A.R. 5-8-4e.  
 Applicable  Not Applicable
8. **The completed well log shall be submitted with the required notice.**  Applicable  Not Applicable
9. All diversion works into which any type of chemical or other foreign substance will be injected into the water shall be equipped with an in-line, automatic, quick-closing check valve capable of preventing pollution of the source of the water supply. The check valve(s) shall be installed, operated and maintained in accordance with K.A.R. 5-3-5c.  Applicable  Not Applicable
10. Additional Conditions are attached.  Yes  No
11. In accordance with K.S.A. 82a-708a, as amended, and K.A.R. 5-5-14, all of the owners of the authorized place(s) of use of water appropriated under the above-referenced file number are responsible for compliance with its terms, conditions and limitations, as amended and/or supplemented by this Summary Order, and with applicable provisions of the *Kansas Water Appropriation Law* and the *Rules and Regulations* promulgated thereunder. Failure to comply with these provisions may result in civil penalties pursuant to K.S.A. 82a-737, as amended, and/or the suspension or revocation and dismissal of the water or appropriation right or any other enforcement actions authorized by law.

**Administrative Appeal and Effective Date of Order**

If you are aggrieved by this order, pursuant to K.S.A. 82a-1901, you may request an evidentiary hearing before the Chief Engineer or request administrative review by the Secretary of Agriculture. A request for hearing by the Chief Engineer must be filed within **15 days** of service of this Order and a request for administrative review by the Secretary must be filed within **30 days** pursuant to K.S.A. 77-531. Any request for administrative review must state a basis for review pursuant to K.S.A. 77-527. File any request with **Kansas Department of Agriculture, Legal Division, 1320 Research Park Drive, Manhattan, KS 66502**. Failure to timely request a hearing or review may preclude review under the Kansas Judicial Review Act.

*For Use by Register of Deeds*

FOR OFFICE USE ONLY  
**APPLICATION APPROVED AND SUMMARY ORDER ISSUED**

By: Cameron R. Conant  
Duly Authorized Designee of the Chief Engineer

(Print Name): Cameron R. Conant  
Division of Water Resources - Kansas Department of Agriculture

Date of Issuance: 3/20/18

State of Kansas )  
County of Stafford ) SS

Acknowledged before me on 3/20/2018  
by Cameron Conant

Signature: Jessica Engelbrecht  
Notary Public

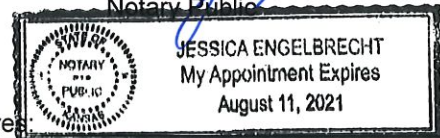

My commission expires: \_\_\_\_\_

(Notary Seal)

File No. 48352

RECEIVED

FEB 08 2018

DWR 1-121 (Revised 07/10/2017)



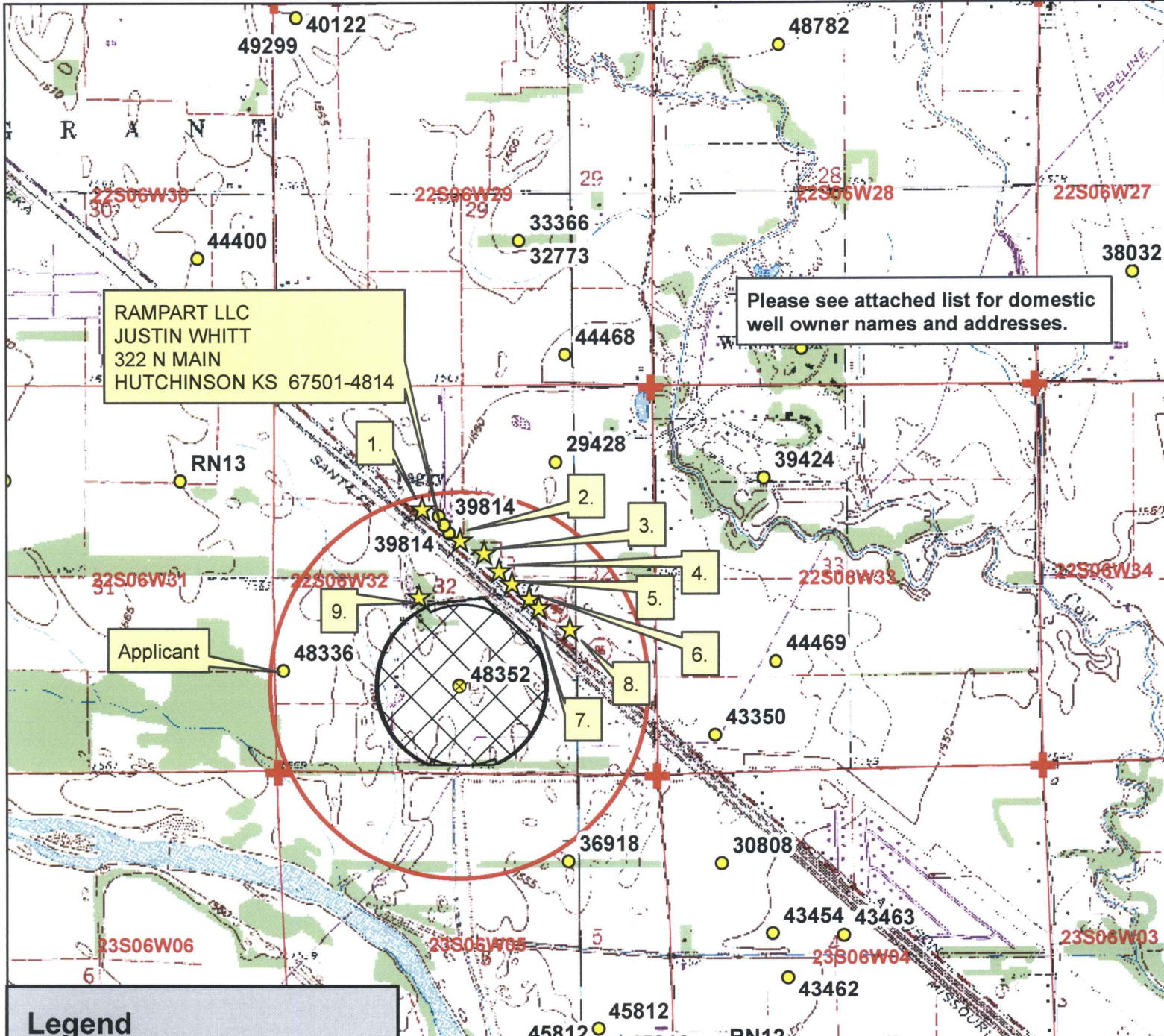

RAMPART LLC  
JUSTIN WHITT  
322 N MAIN  
HUTCHINSON KS 67501-4814

Please see attached list for domestic well owner names and addresses.

Applicant

**Legend**

- Water Appropriations
- ⊗ Authorized Point of Diversion
- ★ Domestic Well
- ⊕ Section Corner
- ▭ Section Line
- Half Mile Circle

**Place of Use**

- ▨ Authorized
- ▨ Proposed

RECEIVED

FEB 08 2018

Stafford Field Office

**Water Appropriation, File No. 48352**

Change in Place of Use Application Map  
32-22S-6W // Reno County

To the best of my knowledge, all wells within 1/2 mile of the authorized point of diversion have been shown.



File No. 48352 Change Application  
Near-by Domestic Well Owners

1. SCHUEREN, COURTNEY A  
4812 W NICKERSON BLVD  
HUTCHINSON, KS 67502
2. GILL, RONALD T  
14116 W 82ND AVE  
NICKERSON, KS 67561
3. ADKINS, TROY & SUSAN  
4614 W NICKERSON BLVD  
HUTCHINSON, KS 67502
4. SCOTT, JOHN M  
4900 W NICKERSON BLVD  
HUTCHINSON, KS 67502
5. DUGGER, FRED D & DIANE K SANDERS  
4510 W NICKERSON BLVD  
HUTCHINSON, KS 67502
6. HENDERSHOT, BEVERLY J  
4502 W NICKERSON BLVD  
HUTCHINSON, KS 67502-9512
7. MOORE, JERRY ALLEN & MARGARET B  
4414 W NICKERSON BLVD  
HUTCHINSON, KS 67502-9528
8. CHAPPELL, DARRELL D  
4312 NICKERSON BLVD  
HUTCHINSON, KS 67502
9. Applicant

RECEIVED

FEB 08 2018



**Saryerwinnie, Tyler [KDA]**

---

**From:** Fitch, Elizabeth [KDA]  
**Sent:** Tuesday, February 13, 2018 8:21 AM  
**To:** Saryerwinnie, Tyler [KDA]  
**Subject:** FW: Signed Maps  
**Attachments:** CCE02092018\_0001.pdf

Change maps.

*Elizabeth*

**From:** [COstmeyer@farmersnational.com](mailto:COstmeyer@farmersnational.com) [mailto:COstmeyer@farmersnational.com]  
**Sent:** Friday, February 9, 2018 11:31 AM  
**To:** Fitch, Elizabeth [KDA] <[Elizabeth.Fitch@ks.gov](mailto:Elizabeth.Fitch@ks.gov)>  
**Subject:** Signed Maps

Let me know if you need anything else.

Thanks,

Chris Ostmeyer  
Farm Manager and Real Estate Sales  
P.O. Box 40  
Kechi, KS 67067  
Cell: 785-672-8672  
Office: 316-788-4240  
Fax: 316-788-4935  
<http://www.farmersnational.com>

\*\*\*\*\*

This email and any files transmitted with it are confidential and intended solely for the use of the individual or entity to whom they are addressed. If you have received this email in error please notify the system manager. Please note that any views or opinions presented in this email are solely those of the author and do not necessarily represent those of the Farmers National Company. Finally, the recipient should check this email and any attachments for the presence of viruses. Farmers National Company accepts no liability for any damage caused by any virus transmitted by this email..

\*\*\*\*\*

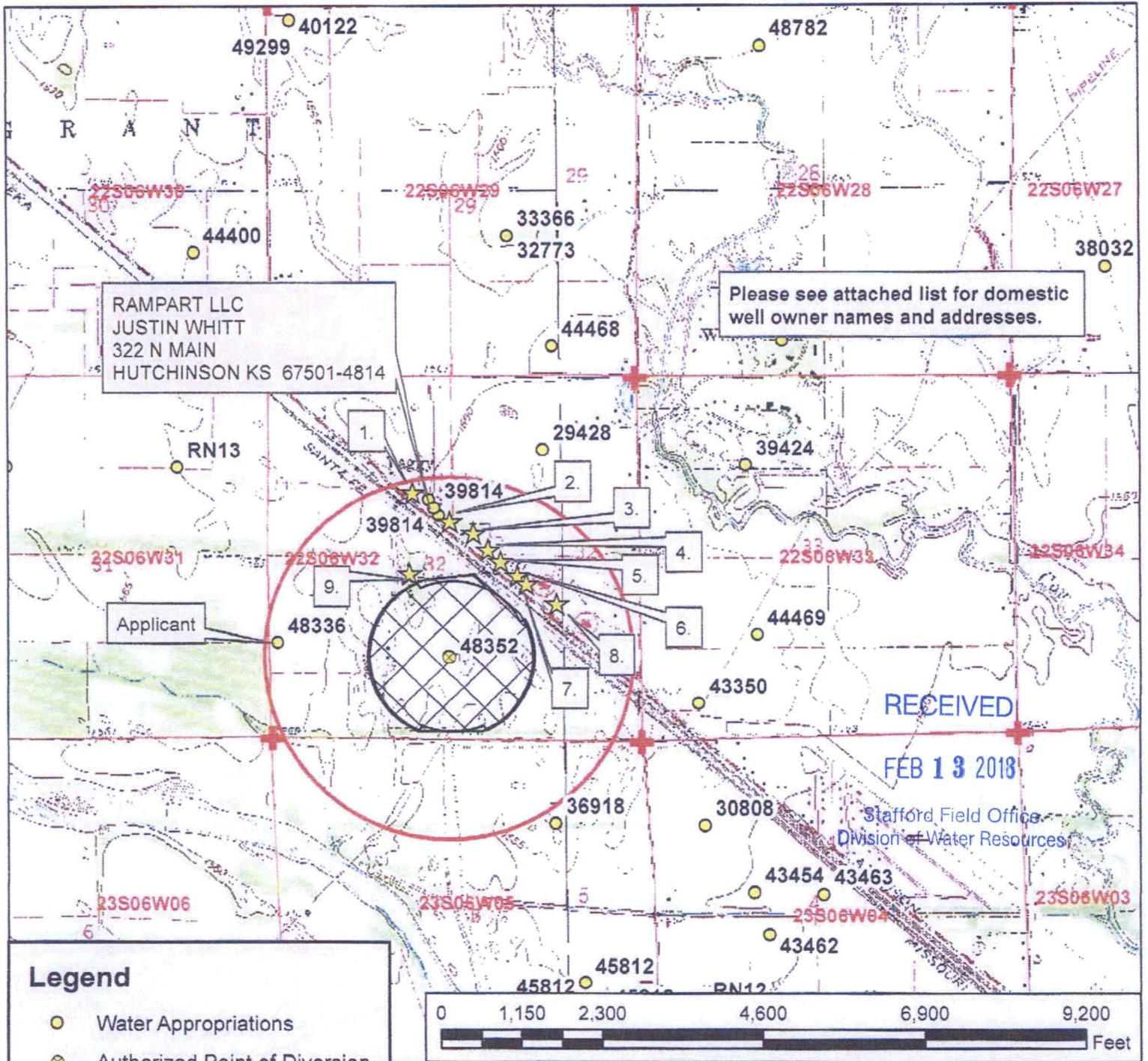

RAMPART LLC  
 JUSTIN WHITT  
 322 N MAIN  
 HUTCHINSON KS 67501-4814

Please see attached list for domestic well owner names and addresses.

Applicant

RECEIVED  
 FEB 13 2018

Stafford Field Office  
 Division of Water Resources

**Legend**

- Water Appropriations
- ⊗ Authorized Point of Diversion
- ★ Domestic Well
- ⊕ Section Corner
- Section Line
- Half Mile Circle

**Place of Use**

- ▨ Authorized
- ▨ Proposed

**Water Appropriation, File No. 48352**

Change in Place of Use Application Map  
 32-22S-6W // Reno County

To the best of my knowledge, all wells within 1/2 mile of the authorized point of diversion have been shown.

by *[Signature]* for FWC Agent  
 Signature



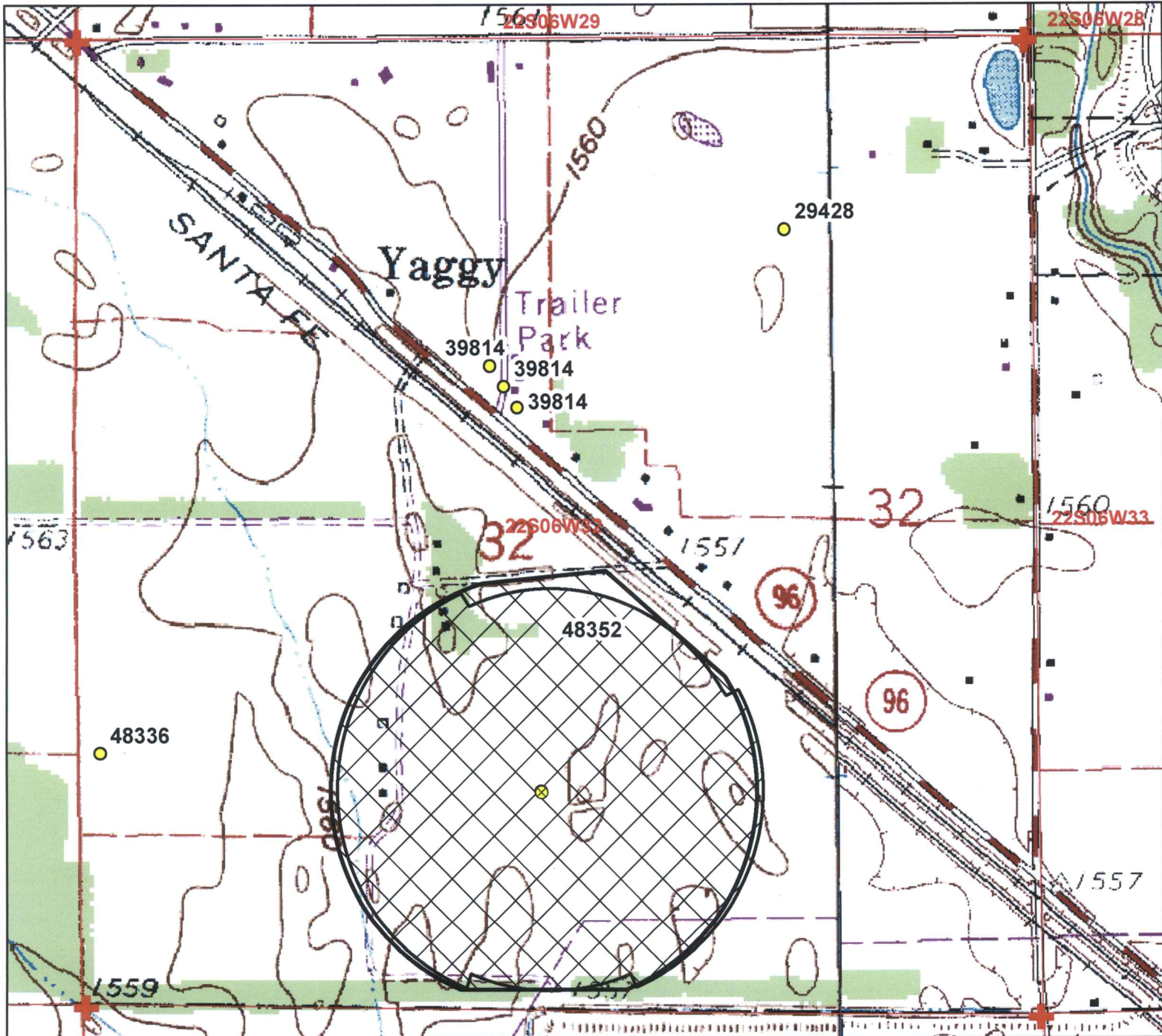

**Legend**

- Water Appropriations
- ⊗ Authorized Point of Diversion
- ⊕ Section Corner
- ▭ Section Line

**Place of Use**

- ▨ Authorized
- ▩ Proposed

RECEIVED  
 FEB 08 2018  
 Stafford Field Office

**Water Appropriation, File No. 48352**  
 Change in Place of Use Application Zoomed In Map  
 32-22S-6W // Reno County



# STATE OF KANSAS

DEPARTMENT OF AGRICULTURE  
DIVISION OF WATER RESOURCES  
STAFFORD FIELD OFFICE  
300 S. MAIN STREET  
STAFFORD, KS 67578-1521



PHONE: (620) 234-5311  
FAX: (620) 234-6900  
www.agriculture.ks.gov

GOVERNOR JEFF COLYER, M.D.  
JACKIE McCLASKEY, SECRETARY OF AGRICULTURE

March 20, 2018

Full Buck Moon Farms LLC  
PO Box 6428  
Westlake Village CA 91359-6427

Re: Water Right, File No(s). 48352

Dear Water Right Owner:

Enclosed is the order executed by the Chief Engineer, Division of Water Resources, Kansas Department of Agriculture, approving the application for change under the above referenced file number(s).

Your attention is directed to the enclosures and to the terms, conditions and limitations specified in this approval for change. An acceptable water flow meter must be installed on your well before any water is applied as authorized under this change approval. A copy of the approved list of Certified Water Flowmeters as well as the regulations regarding the installation of flowmeters, measurement tubes and check valves can be found at <http://agriculture.ks.gov/divisions-programs/dwr/water-appropriation/water-flowmeters>. If you do not have access to the internet, please contact this office and we will send you a paper copy of the referenced information.

Since this order modifies the original document referred to above, it should be recorded with the Register of Deeds as other instruments affecting real estate.

This order requires that a notice and completion of works form be submitted once the diversion works are completed, including a properly installed flowmeter. This form is available at the referenced website.

Any abandoned well must be plugged in accordance with the requirements of Article 30 of the Rules and Regulations as adopted by the Kansas Department of Health and Environment.

Should you have any questions, please feel free to contact this office. If you wish to refer to a specific file, please reference it when you contact us.

Sincerely,

Jeff Lanterman  
Water Commissioner

Enclosures

pc: Water Rights Section  
Groundwater Management District No. 2  
Farmers National Co - Chris Ostmeier



## CERTIFICATE OF SERVICE

On this **20th** day of **March, 2018**, I hereby certify that the attached Change in Point of Diversion for Water Right, File No. **48352**, dated **March 20, 2018** was mailed via Certified U.S. mail to the following:

Full Buck Moon Farms LLC  
PO Box 6428  
Westlake Village CA 91359-6427

A copy of the letter was sent to the following:

GMD 5  
Farmers National Co - Chris Ostmeyer



Staff



# KANSAS DEPARTMENT OF AGRICULTURE

Division of Water Resources

Stafford Field Office

## MEMORANDUM

---

**TO:** File

**DATE:** 2/14/2018

**FROM:** Tyler Saryerwinnie

**RE:** File No. 48352

This is a memorandum regarding surrounding well owner notification on irrigation field office PU changes and pertains to decisions made during the Water Commissioner meeting which took place on 11/16/2016 with directive from Lane Letourneau, Program Manager.

This is applicable to field office changes to increase the place of use by 10 acres or 10% (whichever is less) or a change in place of use to create a complete overlap in which no new acres are being irrigated.

During that meeting it was determined that no surrounding well owner notification will be sent under this type of Place of Use change. All well rates and quantities will remain unchanged and the referenced change will not cause impairment or impact surrounding well owners.

The change in place of use filed on 2/08/2018 for the above referenced file meets this criteria and surrounding well owners will not be notified.



## Saryerwinnie, Tyler [KDA]

---

**From:** Saryerwinnie, Tyler [KDA]  
**Sent:** Wednesday, February 14, 2018 10:34 AM  
**To:** 'Rebecca Wilson'  
**Cc:** Conant, Cameron [KDA]  
**Subject:** Recommendation Request - File No. 48352  
**Attachments:** 48352.Cover Letter.pdf; 48352.Change App.pdf

Rebecca,

I have attached a cover letter and a copy of one (1) place of use application for GMD review and recommendation. Please provide the GMD recommendation by no later March 6, 2018.

Please let me know if you have any questions or concerns.

Thank you,  
Tyler

**Tyler Saryerwinnie**, Environmental Scientist  
Kansas Department of Agriculture  
Division of Water Resources  
Stafford Field Office  
Phone: (620)234-5311

1320 Research Park Drive  
Manhattan, Kansas 66502  
785-564-6700



900 SW Jackson, Room 456  
Topeka, Kansas 66612  
785-296-3556

Secretary Jackie McClaskey

Governor Jeff Colyer, M.D.

February 14, 2018

Tim Boese  
Equus Beds – GMD No. 2  
313 Spruce Street  
Halstead, KS 67056

RE: Place of Use Change Application, File No(s). 48,352

Dear Mr. Boese,

We are enclosing a copy of the application, as referenced above, for your review and recommendation. At this time the application appears to be in proper form.

This office will delay any further action on this file for a period of 15 business days from the date of this letter to allow you time to submit your recommendation concerning the application. Please submit your recommendation within the allotted time, or any authorized extension of time thereof.

If you have any questions, please feel free to contact the office.

Sincerely,

A handwritten signature in blue ink, appearing to read "Tyler Saryerwinnie".

Tyler Saryerwinnie  
Environmental Scientist  
Stafford Field Office  
tyler.saryerwinnie@ks.gov

Enclosure



## Saryerwinnie, Tyler [KDA]

---

**From:** Rebecca Wilson <rwilson@gmd2.org>  
**Sent:** Friday, March 09, 2018 3:52 PM  
**To:** Saryerwinnie, Tyler [KDA]  
**Subject:** RE: Recommendation Request - File No. 48352

**Follow Up Flag:** Follow up  
**Flag Status:** Completed

Good afternoon!

We would like to request an extension to complete the review of this file. Please advise.

Thanks!

*Rebecca Wilson*

Rebecca Wilson  
Administrative Assistant  
Equus Beds GMD2  
313 Spruce Street  
Halstead, KS 67056  
316-835-2224  
316-835-2225 Fax  
[rwilson@gmd2.org](mailto:rwilson@gmd2.org)  
[www.gmd2.org](http://www.gmd2.org)

---

**From:** Saryerwinnie, Tyler [KDA] [<mailto:Tyler.Saryerwinnie@ks.gov>]  
**Sent:** Wednesday, March 07, 2018 10:59 AM  
**To:** Rebecca Wilson  
**Cc:** Conant, Cameron [KDA]  
**Subject:** RE: Recommendation Request - File No. 48352

Rebecca,

I am wanting to check on the status of this recommendation request. Please let me know if you need anything regarding these applications.

Thank you,  
Tyler Saryerwinnie

---

**From:** Saryerwinnie, Tyler [KDA]  
**Sent:** Wednesday, February 14, 2018 10:34 AM  
**To:** 'Rebecca Wilson'  
**Cc:** Conant, Cameron [KDA]  
**Subject:** Recommendation Request - File No. 48352

Rebecca,

I have attached a cover letter and a copy of one (1) place of use application for GMD review and recommendation. Please provide the GMD recommendation by no later March 6, 2018.

Please let me know if you have any questions or concerns.

Thank you,  
Tyler

**Tyler Saryerwinnie**, Environmental Scientist  
Kansas Department of Agriculture  
Division of Water Resources  
Stafford Field Office  
Phone: (620)234-5311



## Saryerwinnie, Tyler [KDA]

---

**From:** Rebecca Wilson <[rwilson@gmd2.org](mailto:rwilson@gmd2.org)>  
**Sent:** Monday, March 12, 2018 4:51 PM  
**To:** Saryerwinnie, Tyler [KDA]  
**Subject:** 48336 48352 PU Change App Approval Letters  
**Attachments:** 48336 PU Change App Approval Letter 3-12-18.pdf; 48352 PU Change App Approval Letter 3-12-18.pdf

**Follow Up Flag:** Follow up  
**Flag Status:** Completed

Good afternoon!

Attached you will find the Change Application Approval Letter from Manager Tim Boese for #48336 and #48352.

Please let me know if you have any difficulties opening the attachments.

Thanks!

*Rebecca Wilson*

Rebecca Wilson  
Administrative Assistant  
Equus Beds GMD2  
313 Spruce Street  
Halstead, KS 67056  
316-835-2224  
316-835-2225 Fax  
[rwilson@gmd2.org](mailto:rwilson@gmd2.org)  
[www.gmd2.org](http://www.gmd2.org)

JEFF WINTER, PRESIDENT  
VIN KISSICK, VICE PRESIDENT  
ALAN BURGHART, SECRETARY  
MIKE MCGINN, TREASURER  
TIM BOESE, MANAGER  
THOMAS A. ADRIAN, ATTORNEY



DIRECTORS:  
DAVID BOGNER  
JOE PAJOR  
DALE SCHMIDT  
BOB SEILER  
DAVID STROBERG

## EQUUS BEDS GROUNDWATER MANAGEMENT DISTRICT NO. 2

313 SPRUCE STREET • HALSTEAD, KANSAS 67056-1925 • PHONE (316) 835-2224 • FAX (316) 835-2225 • equusbeds@gmd2.org • www.gmd2.org

March 12, 2018

Chief Engineer, Division of Water Resources  
Attn: Tyler Saryerwinnie  
300 S. Main St.  
Stafford, Kansas 67578

Re: Place of Use Change Application, File No. 48352 – Full Buck Moon Farm LLC

Dear Mr. Saryerwinnie:

The Equus Beds Groundwater Management District No. 2 reviewed the referenced change in place of use application on March 12, 2018, using the District's Revised Management Program (effective May 1, 1995) and Rules and Regulations K.A.R. 5-22-1 through 5-22-17.

The change application proposes to increase the place of use 2 acres from 96 acres to 98 acres. The proposed place of use results in a water to land ratio of 1.37 acre-feet per acre.

The District's review found that the change application complies with the Revised Aquifer Management program approved by the Chief Engineer and with the District's Rules and Regulations K.A.R. 5-22-1 through 5-22-17. Based upon the review, the application is recommended for approval by the Equus Beds Groundwater Management District No. 2.

A District decision may be appealed to the District Board of Directors by submitting a written petition to the District office within 30 days from date of this notification, pursuant to K.A.R. 5-22-12. Please contact the District should you have any questions regarding the review or recommendation.

Sincerely,  
EQUUS BEDS GROUNDWATER  
MANAGEMENT DISTRICT NO. 2

Tim Boese  
Manager  
TDB/STF

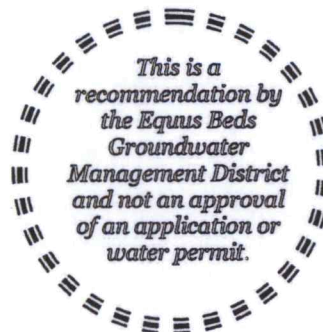

pc: Full Buck Moon Farm LLC, Landowner  
Chris Ostmeier, Farmers National Co., Applicant

RECEIVED

MAR 12 2018

Stafford Field Office  
Division of Water Resources