

Kansas Department of Agriculture
 Division of Water Resources
CHANGE: P/U WORKSHEET

1. File Number: 49257	2. Status Change Date:	3. Change Num: 1	4. Field Office: 02	5. GMD:
---------------------------------	------------------------	----------------------------	-------------------------------	---------

6. Status: <input checked="" type="checkbox"/> Approved <input type="checkbox"/> Denied by DWR/GMD <input type="checkbox"/> Dismiss by Request/Failure to Return	7. Filing Date of Change: 2/20/18
--	---

8a. Applicant(s) New to system <input type="checkbox"/>	Person ID _____ Add Seq# _____	8c. Landowner(s) New to system <input type="checkbox"/>	Person ID 60837 Add Seq# 1
DAVID E & JOI D LAWLESS 532 N OLIVER RD BELLE PLAINE KS 67013			

8b. Landowner(s) New to system <input type="checkbox"/>	Person ID 67082 Add Seq# 1	8d. WUC New to system <input type="checkbox"/>	Person ID _____ Add Seq# _____
MARK E & KARLA LAWLESS PO BOX 515 BELLE PLAINE KS 67013			

9. Documents and Enclosure(s): DWR Meter(s) Date to Comply: **12/31/18** N & P Date to Comply: _____

Anti-Reverse Meter Meter Seal Check Valve N & P Form Water Tube Driller Copy H & E Letter

Conservation Plan Date Required: _____ Date Approved: **3/2/18** Date to Comply: _____

10. Use Made of Water From: _____ To: _____

Date Prepared: **2/27/18** By: **TJS**

Date Entered: _____ By: _____

12. Points of Diversion											Rate and Quantity					
CHK	MOD	DEL	PDIV	Qualifier	S	T	R	ID	'N	'W	Comment (AKA Line)	Authorized		Additional		Overlap PD Files
ENT												Rate gpm/cfs	Quantity af/mgy	Rate gpm/cfs	Quantity af/mgy	
CHK	83932							1								None

13. Storage: Rate _____ NF Quantity _____ ac/ft Additional Rate _____ NF Additional Quantity _____ ac/ft

14. Limitation: _____ af/yr at _____ gpm (_____ cfs) when combined with file number(s) _____
 Limitation: _____ af/yr at _____ gpm (_____ cfs) when combined with file number(s) _____

15. 5YR Allocation: Allocation Type _____ Start Year _____ 5 YR Amount _____ Amount Unit _____ Base Acres _____ Comment _____

16. Place of Use										NE¼				NW¼				SW¼				SE¼				Total	Owner	Chg?	Overlap Files
CHK	MOD	DEL	ENT	PUSE	S	T	R	ID		NE ¼	NW ¼	SW ¼	SE ¼	NE ¼	NW ¼	SW ¼	SE ¼	NE ¼	NW ¼	SW ¼	SE ¼	NE ¼	NW ¼	SW ¼	SE ¼				
MOD	67082	23	31S	1E	2													6	4.5	9.8	5.7	26				8b. & 8c.	Yes	None	
ENT	67083	26	31S	1E	2							15	1				33	14							63	8b. & 8c.	Yes	None	

Base Acres: **89** Year: **Permit** Minimum Reasonable Quantity: **1.01 AF/acre**

Comments: **Doug Schenn indicated in email/in person that structures was contacted on this app & nothing was needed. I assume this also applied to southern pivot & potential crossings. CRE*
** Funny looking North pivot is odd on the west side so as not to include a different landowner.* **3/2/18**

Submit completed application to:
 Kansas Department of Agriculture
 Division of Water Resources
 Field Office for your area.
 Call for address:

Topeka -- (785) 296-5733
 Stafford -- (620) 234-5311
 Stockton -- (785) 425-6787
 Garden City -- (620) 276-2901
<http://agriculture.ks.gov/dwr>

DWR FIELD OFFICE APPLICATION FOR APPROVAL TO CHANGE THE PLACE OF USE AND/OR THE POINT OF DIVERSION **WATER METER REQUIRED**



STATE OF KANSAS

Filing Fee Must Accompany the Application, K.S.A. 82a-708b(b), as amended.
 Fee Schedule is on the third page of this application form.

Paragraph Nos. 1, 2, 3 & 5 must be completed. Complete all other applicable portions. If change in point of diversion is greater than 100 feet, or if place of use will be changed, include a topographic map or detailed plat showing the authorized and proposed point(s) of diversion and/or place of use.

RECEIVED
 10:40am
 FEB 20 2018

File No. 49257

1. Application is hereby made for approval of the Chief Engineer to change the (check one or both):

Place of Use Point of Diversion

under the water right which is the subject of this application in accordance with the conditions described below.

The source of supply is: Groundwater Surface water

Stafford Field Office
 Division of Water Resources

2. Name and address of Applicant: Mark Lawless

PO Box 515, Belle Plaine KS 67013

Phone Number: (316)617-3126

Email address: marklawless@sktc.net

Name and address of Water Use Correspondent: Mark E & Karla Lawless

PO Box 515, Belle Plaine KS 67013

Phone Number: (316)617-3126

Email address: marklawless@sktc.net

3. The presently authorized place of use is:

Owner of Land — NAME: Mark E & Karla Lawless // David E & Joi D Lawless

ADDRESS: PO Box 515, Belle Plaine KS 67013// 532 Oliver Rd, Belle Plaine KS 67013

(If there is more than one landowner, attach supplemental sheets as necessary.)

Sec.	Twp.	Range	NE¼				NW¼				SW¼				SE¼				TOTAL ACRES				
			NE¼	NW¼	SW¼	SE¼	NE¼	NW¼	SW¼	SE¼	NE¼	NW¼	SW¼	SE¼	NE¼	NW¼	SW¼	SE¼					
23	31S	1E																	3	14	6	3	26
26	31S	1E			15	1								33					14				63

4. If this application is for a change in place of use, it is proposed that the place of use be changed to:

Owner of Land — NAME: Mark E & Karla Lawless // David E & Joi D Lawless

ADDRESS: PO Box 515, Belle Plaine KS 67013// 532 Oliver Rd, Belle Plaine KS 67013

(If there is more than one landowner, attach supplemental sheets as necessary.)

Sec.	Twp.	Range	NE¼				NW¼				SW¼				SE¼				TOTAL ACRES				
			NE¼	NW¼	SW¼	SE¼	NE¼	NW¼	SW¼	SE¼	NE¼	NW¼	SW¼	SE¼	NE¼	NW¼	SW¼	SE¼					
23	31S	1E																	6	4.5	9.8	5.7	26
26	31S	1E			15	1								33					14				63

For Office Use Only: Code _____ Fee \$ 200 - TR # _____ Receipt Date _____ Check # 8741



WATER METER REQUIRED
POINT OF DISPOSITION
USE AND THE
TOWNSHIP OF THE PLACE OF
REPLICATION OF THE
WORK FURTHER OFFICE

Department of Health and Human Services
 Division of Environmental Health
 100 North 17th Street
 Philadelphia, PA 19103
 (215) 861-4000

For information on the requirements for water meters, please contact the Division of Environmental Health at (215) 861-4000.

RECEIVED
 (215) 861-4000
 DEPT. OF HEALTH & HUMAN SERVICES

The following information is provided for your information. It is not intended to constitute an offer of insurance or any other financial product. Please contact your insurance agent for more information.

The information provided is for informational purposes only and does not constitute an offer of insurance or any other financial product.

The information provided is for informational purposes only and does not constitute an offer of insurance or any other financial product.

The information provided is for informational purposes only and does not constitute an offer of insurance or any other financial product.

The information provided is for informational purposes only and does not constitute an offer of insurance or any other financial product.

The information provided is for informational purposes only and does not constitute an offer of insurance or any other financial product.

The information provided is for informational purposes only and does not constitute an offer of insurance or any other financial product.

The information provided is for informational purposes only and does not constitute an offer of insurance or any other financial product.

The information provided is for informational purposes only and does not constitute an offer of insurance or any other financial product.

The information provided is for informational purposes only and does not constitute an offer of insurance or any other financial product.

The information provided is for informational purposes only and does not constitute an offer of insurance or any other financial product.

The information provided is for informational purposes only and does not constitute an offer of insurance or any other financial product.

The information provided is for informational purposes only and does not constitute an offer of insurance or any other financial product.

The information provided is for informational purposes only and does not constitute an offer of insurance or any other financial product.

FOR INFORMATION ONLY: This information is provided for informational purposes only and does not constitute an offer of insurance or any other financial product.

5. **Presently authorized point of diversion:**
 One in the SW Quarter of the NE Quarter of the SE Quarter
 of Section 23, Township 31 South, Range 1 E,
 in Sumner County, Kansas, 1558 feet North 856 feet West of Southeast corner of section.
 Authorized Rate No Change Authorized Quantity No Change Depth of well — (feet)
(DWR use only: Computer ID No. 1 GPS 1326 feet North 872 feet West)
 This point will not be changed This point will be changed as follows: No change, point better described with GPS as follows:
Proposed point of diversion: (Complete only if change is requested or if existing point is better described by GPS)
 One in the _____ Quarter of the _____ Quarter of the _____ Quarter
 of Section _____, Township _____ South, Range _____ (E/W),
 in _____ County, Kansas, _____ feet North _____ feet West of Southeast corner of section.
 Proposed Rate _____ Proposed Quantity _____ Proposed well depth (feet) _____
 This point is: Additional Well Geo Center List other water rights that will use this point None

6. **Presently authorized point of diversion:**
 One in the _____ Quarter of the _____ Quarter of the _____ Quarter
 of Section _____, Township _____ South, Range _____ (E/W),
 in _____ County, Kansas, _____ feet North _____ feet West of Southeast corner of section.
 Authorized Rate _____ Authorized Quantity _____ Depth of well _____ (feet)
(DWR use only: Computer ID No. _____ GPS _____ feet North _____ feet West)
 This point will not be changed This point will be changed as follows: No change, point better described with GPS as follows:
Proposed point of diversion: (Complete only if change is requested or if existing point is better described by GPS)
 One in the _____ Quarter of the _____ Quarter of the _____ Quarter
 of Section _____, Township _____ South, Range _____ (E/W),
 in _____ County, Kansas, _____ feet North _____ feet West of Southeast corner of section.
 Proposed Rate _____ Proposed Quantity _____ Proposed well depth (feet) _____
 This point is: Additional Well Geo Center List other water rights that will use this point _____

7. The changes herein are desired for the following reasons?
 (please be specific) To accommodate a new location for
the pivot system in Section 23.

13a. If the proposed point of diversion will be relocated within 100 feet of the existing point of diversion, indicate its location on the diagram below in relation to the existing point of diversion. (PLEASE NOTE: The "X" in center of diagram below represents presently authorized point of diversion.)

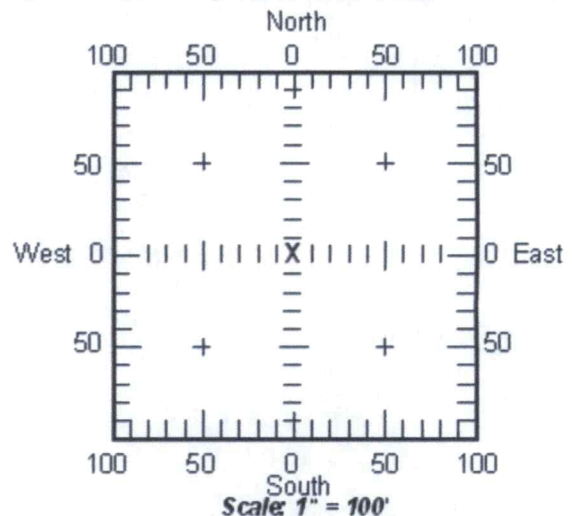

8. If a well, is the test hole log attached? Yes No

9. The change(s) (was)(will be) completed by?
ASAP

10. If the point of diversion is a well:
 (a) What are you going to do with the old well?
NA

(b) When will this be done? NA

11. Groundwater Management District recommendation attached? Yes No

12. Assisted by TJS - SFFO

13b. If the proposed point of diversion will be relocated more than 100 feet but within 1320 feet from the existing point of diversion, attach a topographic map or aerial photograph. For groundwater sources, show all wells (including domestic) within one-half mile of the proposed point of diversion and the names and mailing addresses of the owners. For surface water sources, show the names and addresses of the landowner(s) one-half mile downstream and one-half mile upstream from your property lines.

RECEIVED
 DWR 1-121 (Revised 07/10/2017)

FEB 20 2018

14. If the proposed groundwater point of diversion is 300 or fewer feet from existing point of diversion, complete the following:

- (a) Does the undersigned represent all owners of the currently authorized place(s) of use identified in this application?
 Yes No (If no, all owners must sign this application.)
- (b) Will the ownership interest of any owner of the currently authorized place(s) of use identified in this application be adversely affected if this application is approved as requested?
 Yes No (If yes, all owners must sign this application.)
- (c) If this application is not approved expeditiously, will there be substantial damage to property, public health or safety?
 Yes No (If no, all owners must sign this application.)

If the application proposes a surface water change in point of diversion, a groundwater change in point of diversion greater than 300 feet, or a change in place of use, the application must be signed by all owners of the currently authorized place of use, or their duly authorized agent (attach notarized statement authorizing representation).

I hereby verify, being first duly sworn upon my oath or affirmation and under penalty of perjury, that I am of lawful age and the owner, the spouse of the owner, or a duly authorized agent of the owner(s) to make this application on their behalf, in regards to the water right(s) to which this application pertains. I further verify that the statements contained in this application are true, correct and complete.

Dated at Belle Plaine, Kansas, this 17 day of February, 2018.

Paul Lawless
 (Owner)

MANIC LAWLESS
 (Please Print)

David Lawless
 (Owner)

DAVID E Lawless
 (Please Print)

 (Owner)

 (Please Print)

Karla J. Lawless
 (Spouse)

Karla J. Lawless
 (Please Print)

Joi Lawless
 (Spouse)

Joi Lawless
 (Please Print)

 (Spouse)

 (Please Print)

State of Kansas }
 County of Sumner } SS

I hereby certify that the foregoing application was signed in my presence and sworn to before me this 17th day of February, 2018.



Susan R Peterson
 Notary Public

My Commission Expires 6/2/2020

ONLY COMPLETE APPLICATIONS WILL BE PROCESSED. To be complete, all of the applicable portions of the application form must be completed with accurate information; maps, if necessary, must be included; signatures of all the appropriate owners' must be affixed to the application and notarized; and the appropriate fee must be paid.

FEE SCHEDULE

Each application to change the place of use or the point of diversion under this section shall be accompanied by the application fee set forth in the schedule below: Make checks payable to: **Kansas Department of Agriculture**

- (1) Application to change a point of diversion 300 feet or less \$100
- (2) Application to change a point of diversion more than 300 feet \$200
- (3) Application to change the place of use \$200

RECEIVED
 DWR 1-121 (Revised 07/10/2017)

FEB 20 2018

SUMMARY ORDER APPROVING APPLICATION FOR CHANGE AND IMPOSING CONDITIONS

This Summary Order is issued under authority of K.S.A. 82a-708b, as amended, and K.A.R. 5-5-1, *et seq.* and other applicable provisions of the *Kansas Water Appropriation Law, K.S.A. 82a-701 et seq.*, and rules and regulations promulgated thereunder, With the exception of those conditions expressly contained herein, this Summary Order does not change the terms, conditions and limitations of File No. 49257.

1. A change application was received on 2/20/2018 requesting that the place of use and / or point of diversion authorized under the above-referenced file number be changed as described in the application.
2. On and after the effective date of this summary order, the authorized place(s) of use shall be located substantially as shown on the topographic map accompanying the application to change the place of use. Applicable Not Applicable
3. The change in point of diversion shall not impair existing rights and shall be limited to the same source or sources of water as previously authorized. The point of diversion authorized by this summary order shall be located within a _____ foot radius of the authorized point(s) of diversion. Applicable Not Applicable
4. The point(s) of diversion authorized herein shall not actually be located more than _____ feet from the previously authorized point(s) of diversion. Applicable Not Applicable
5. As required by K.A.R. 5-3-5d, if the works for diversion is a well with a diversion rate of 100 gallons per minute or more, a tube or other device suitable for making water level measurements shall be installed, operated and maintained in accordance with K.A.R. 5-6-13. Applicable Not Applicable
6. **The owner of the authorized place(s) of use shall properly install an acceptable water flow meter on or before December 31, 2018,** or before the first use of water, whichever occurs first. The water flow meter shall be installed, operated and maintained in accordance with K.A.R. 5-1-4 through 5-1-12. As required by K.S.A. 82a-732, as amended, and K.A.R. 5-3-5e, the owner shall maintain records and report the reading of the water flow meter and the total quantity of water diverted annually to the Chief Engineer by March 1 following the end of each calendar year.
 Applicable Not Applicable
7. **Installation of the works for diversion of water shall be completed on or before December 31, 20**_____, or within any authorized extension of time. By March 1, 20____ the applicant shall notify the Chief Engineer that construction of the works for diversion has been completed, on the form provided by the Chief Engineer, as required by K.A.R. 5-8-4e.
 Applicable Not Applicable
8. **The completed well log shall be submitted with the required notice.** Applicable Not Applicable
9. All diversion works into which any type of chemical or other foreign substance will be injected into the water shall be equipped with an in-line, automatic, quick-closing check valve capable of preventing pollution of the source of the water supply. The check valve(s) shall be installed, operated and maintained in accordance with K.A.R. 5-3-5c. Applicable Not Applicable
10. Additional Conditions are attached. Yes No
11. In accordance with K.S.A. 82a-708a, as amended, and K.A.R. 5-5-14, all of the owners of the authorized place(s) of use of water appropriated under the above-referenced file number are responsible for compliance with its terms, conditions and limitations, as amended and/or supplemented by this Summary Order, and with applicable provisions of the *Kansas Water Appropriation Law* and the *Rules and Regulations* promulgated thereunder. Failure to comply with these provisions may result in civil penalties pursuant to K.S.A. 82a-737, as amended, and/or the suspension or revocation and dismissal of the water or appropriation right or any other enforcement actions authorized by law.

Administrative Appeal and Effective Date of Order

If you are aggrieved by this order, pursuant to K.S.A. 82a-1901, you may request an evidentiary hearing before the Chief Engineer or request administrative review by the Secretary of Agriculture. A request for hearing by the Chief Engineer must be filed within **15 days** of service of this Order and a request for administrative review by the Secretary must be filed within **30 days** pursuant to K.S.A. 77-531. Any request for administrative review must state a basis for review pursuant to K.S.A. 77-527. File any request with **Kansas Department of Agriculture, Legal Division, 1320 Research Park Drive, Manhattan, KS 66502**. Failure to timely request a hearing or review may preclude review under the Kansas Judicial Review Act.

For Use by Register of Deeds

FOR OFFICE USE ONLY
**APPLICATION APPROVED AND
SUMMARY ORDER ISSUED**

By: Cameron P. Conant
Duly Authorized Designee of the Chief Engineer
(Print Name): Cameron P. Conant
Division of Water Resources - Kansas Department of Agriculture
Date of Issuance: 3/2/18
State of Kansas)
County of Stafford) SS
Acknowledged before me on 3/02/18
by Cameron Conant
Signature: Jessica Engelbrecht



My commission expires _____

(Notary Seal)

File No. 49257

RECEIVED

DWR 1-121 (Revised 07/10/2017)

FEB 20 2018

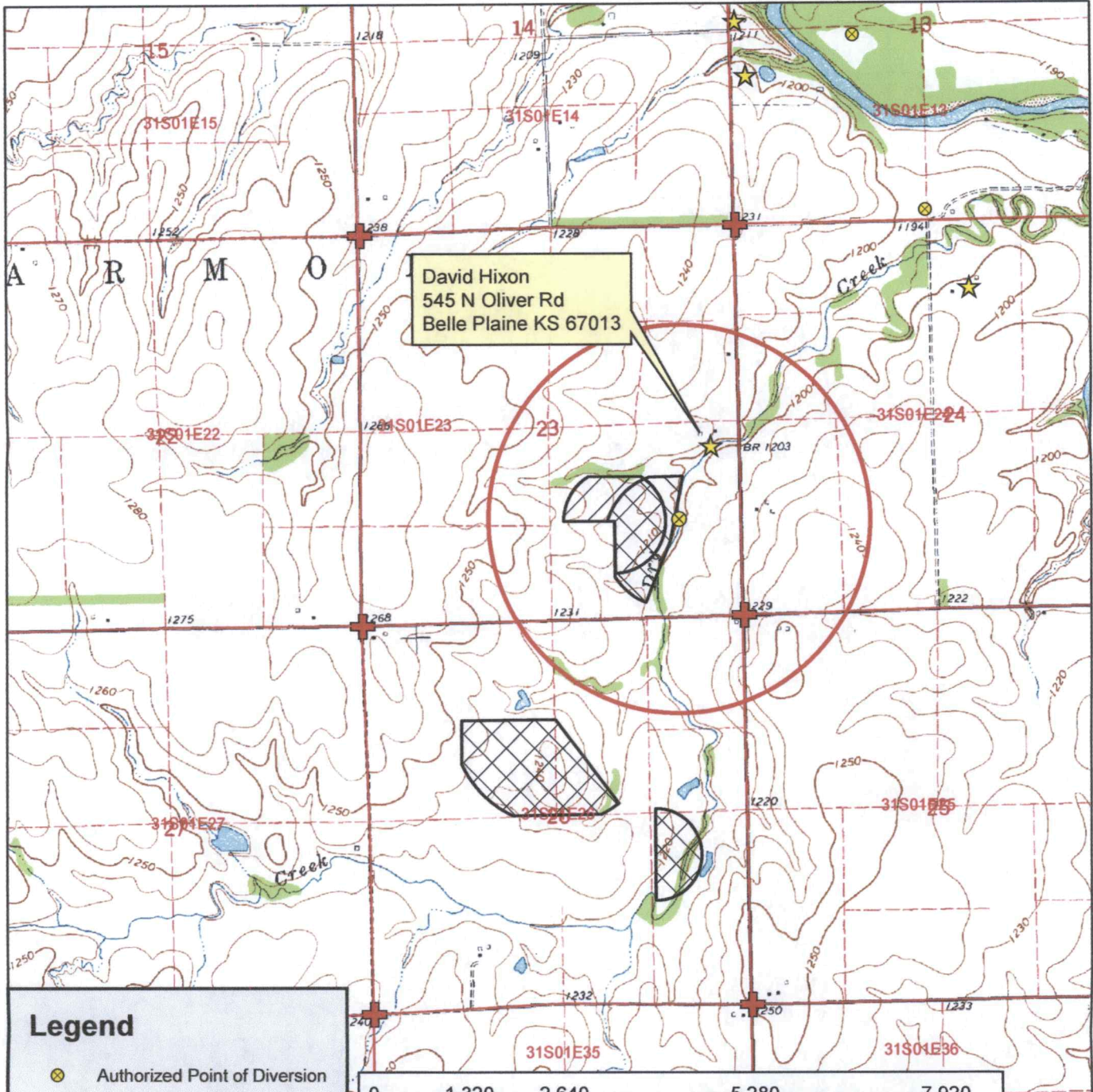

David Hixon
545 N Oliver Rd
Belle Plaine KS 67013

Legend

- ⊗ Authorized Point of Diversion
- Water Appropriations
- ⬜ 1/2 Mile Buffer
- ★ Diversion Site
- ⬜ Section Line
- ⊕ Section Corner
- Place of Use**
- ▨ Authorized
- ▩ Proposed

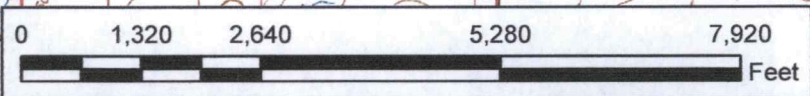

Water Appropriation, File No. 49,257
Change in Place of Use, Application Map
23/26-31S-01E // Sumner County



To the best of my knowledge, all water wells or diversion sites using the same source of supply within 1/2 mile of the authorized point of diversion have been plotted on the application map.

RECEIVED

FEB 20 2018

Paul S. [Signature]

Signature

2/6/2018 TJS-SFFO 1:24,000 scale



Legend

- ⊗ Authorized Point of Diversion
- Water Appropriations
- ★ Diversion Site
- Section Line
- ⊕ Section Corner

Place of Use

- ▨ Authorized
- ▩ Proposed

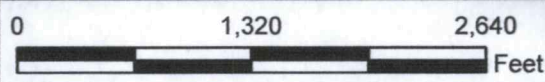

Water Appropriation, File No. 49,257

Change in Place of Use, Aerial Map
23/26-31S-01E // Sumner County



RECEIVED

FEB 20 2018

2/6/2018 TJS-SFFO



Stafford Field Office
300 S. Main Street
Stafford, Kansas 67578-1521

Jackie McClaskey, Secretary
David W. Barfield, Chief Engineer
Jeff Lanterman, Water Commissioner

Phone: 620-234-5311
Fax: 620-234-6900
www.agriculture.ks.gov
Governor Jeff Colyer, M.D.

March 2, 2018

Mark Lawless
PO Box 515
Belle Plaine KS 67013

Re: Water Right, File No(s). 49257

Dear Water Right Owner:

Enclosed is the order executed by the Chief Engineer, Division of Water Resources, Kansas Department of Agriculture, approving the application for change under the above referenced file number(s).

Your attention is directed to the enclosures and to the terms, conditions and limitations specified in this approval for change. An acceptable water flow meter must be installed on your well before any water is applied as authorized under this change approval. A copy of the approved list of Certified Water Flowmeters as well as the regulations regarding the installation of flowmeters, measurement tubes and check valves can be found at <http://agriculture.ks.gov/divisions-programs/dwr/water-appropriation/water-flowmeters>. If you do not have access to the internet, please contact this office and we will send you a paper copy of the referenced information.

Since this order modifies the original document referred to above, it should be recorded with the Register of Deeds as other instruments affecting real estate.

Should you have any questions, please feel free to contact this office. If you wish to refer to a specific file, please reference it when you contact us.

Sincerely,

Jeff Lanterman
Water Commissioner

Enclosures
pc: Water Rights Section

CERTIFICATE OF SERVICE

On this **2nd** day of **March, 2018**, I hereby certify that the attached Change in Place of Use for Water Right, File No. **49257**, dated **March 2, 2018** was mailed via Certified U.S. mail to the following:

Mark Lawless
PO Box 515
Belle Plaine KS 67013



Staff



KANSAS DEPARTMENT OF AGRICULTURE

Division of Water Resources

Stafford Field Office

MEMORANDUM

TO: File

DATE: 2/27/2018

FROM: Tyler Saryerwinnie

RE: File No. 49257

This is a memorandum regarding surrounding well owner notification on irrigation field office PU changes and pertains to decisions made during the Water Commissioner meeting which took place on 11/16/2016 with directive from Lane Letourneau, Program Manager.

This is applicable to field office changes to increase the place of use by 10 acres or 10% (whichever is less) or a change in place of use to create a complete overlap in which no new acres are being irrigated.

During that meeting it was determined that no surrounding well owner notification will be sent under this type of Place of Use change. All well rates and quantities will remain unchanged and the referenced change will not cause impairment or impact surrounding well owners.

The change in place of use filed on 2/20/2018 for the above referenced file meets this criteria and surrounding well owners will not be notified.