

# NOTICE

This scan only represents the application as filed. The information contained herein meets the requirements of K.A.R. 5-3-1 or K.A.R. 5-5-1, and has been found acceptable for filing in the office of the Chief Engineer. The application should not be considered to be a complete application as per K.A.R. 5-3-1b or K.A.R. 5-5-2a.

THE STATE OF KANSAS



KANSAS DEPARTMENT OF AGRICULTURE  
Jackie McClaskey, Secretary of Agriculture

DIVISION OF WATER RESOURCES  
David W. Barfield, Chief Engineer

Water Resources  
Received

File Number 50073  
This item to be completed by the Division of Water Resources.

JUN 28 2018  
2:03  
KS Dept Of Agriculture

APPLICATION FOR PERMIT TO  
APPROPRIATE WATER FOR BENEFICIAL USE

Filing Fee Must Accompany the Application  
(Please refer to Fee Schedule attached to this application form.)

To the Chief Engineer of the Division of Water Resources, Kansas Department of Agriculture,  
1320 Research Park Drive, Manhattan, KS 66502:

1. Name of Applicant (Please Print): Steve Albers  
Address: 15140 SW 70<sup>th</sup> Street  
City: Cunningham State KS Zip Code 67035  
Telephone Number: (620) 532-9489

2. The source of water is:  surface water in \_\_\_\_\_ (stream)  
OR  groundwater in S. F. Ninescah River (S.C. DUA: SNI 25) (drainage basin)

Certain streams in Kansas have minimum target flows established by law or may be subject to administration when water is released from storage for use by water assurance district members. If your application is subject to these regulations on the date we receive your application, you will be sent the appropriate form to complete and return to the Division of Water Resources.

3. The maximum quantity of water desired is 2.8 acre-feet OR \_\_\_\_\_ gallons per calendar year, to be diverted at a maximum rate of Nat. Evap gallons per minute OR \_\_\_\_\_ cubic feet per second.

Once your application has been assigned a priority, the requested maximum rate of diversion and maximum requested quantity of water under that priority number can **NOT** be increased. Please be certain your requested maximum rate of diversion and maximum quantity of water are appropriate and reasonable for your proposed project and are in agreement with the Division of Water Resources' requirements.

4. The water is intended to be appropriated for (Check use intended):  
(a)  Artificial Recharge (b)  Irrigation (c)  Recreational (d)  Water Power  
(e)  Industrial (f)  Municipal (g)  Stockwatering (h)  Sediment Control  
(i)  Domestic (j)  Dewatering (k)  Hydraulic Dredging (l)  Fire Protection  
(m)  Thermal Exchange (n)  Contamination Remediation

YOU **MUST** COMPLETE AND ATTACH ADDITIONAL DIVISION OF WATER RESOURCES FORM(S) PROVIDING INFORMATION TO SUBSTANTIATE YOUR REQUEST FOR THE AMOUNT OF WATER FOR THE INTENDED USE REFERENCED ABOVE.

For Office Use Only:		F.O. <u>2</u> <u>GMD</u> Meets K.A.R. 5-3-1 (YES/NO) Use <u>REC</u> Source <u>G/S</u> County <u>KM</u> By <u>AW</u> Date <u>6/28/18</u>	
Code <u>REG</u>	Fee \$ <u>300</u>	TR # _____	Receipt Date <u>6/29/18</u> Check # <u>16306</u>

7/6/18 DAW

5. The location of the proposed wells, pump sites or other works for diversion of water is:

**Note:** For the application to be accepted, the point of diversion location must be described to at least a 10 acre tract, unless you specifically request a 60 day period of time in which to locate the site within a specifically described, minimal legal quarter section of land.

(A) One in the SW quarter of the SW quarter of the SW quarter of Section 21, more particularly described as being near a point 122 feet North and 4473 feet West of the Southeast corner of said section, in Township 28 South, Range 10 West, Kingman County, Kansas.

(B) One in the \_\_\_\_\_ quarter of the \_\_\_\_\_ quarter of the \_\_\_\_\_ quarter of Section \_\_\_\_\_, more particularly described as being near a point \_\_\_\_\_ feet North and \_\_\_\_\_ feet West of the Southeast corner of said section, in Township \_\_\_\_\_ South, Range \_\_\_\_\_ East/West (circle one), \_\_\_\_\_ County, Kansas.

(C) One in the \_\_\_\_\_ quarter of the \_\_\_\_\_ quarter of the \_\_\_\_\_ quarter of Section \_\_\_\_\_, more particularly described as being near a point \_\_\_\_\_ feet North and \_\_\_\_\_ feet West of the Southeast corner of said section, in Township \_\_\_\_\_ South, Range \_\_\_\_\_ East/West (circle one), \_\_\_\_\_ County, Kansas.

(D) One in the \_\_\_\_\_ quarter of the \_\_\_\_\_ quarter of the \_\_\_\_\_ quarter of Section \_\_\_\_\_, more particularly described as being near a point \_\_\_\_\_ feet North and \_\_\_\_\_ feet West of the Southeast corner of said section, in Township \_\_\_\_\_ South, Range \_\_\_\_\_ East/West (circle one), \_\_\_\_\_ County, Kansas.

If the source of supply is groundwater, a separate application shall be filed for each proposed well or battery of wells, except that a single application may include up to four wells within a circle with a quarter (1/4) mile radius in the same local source of supply which do not exceed a maximum diversion rate of 20 gallons per minute per well.

A battery of wells is defined as two or more wells connected to a common pump by a manifold; or not more than four wells in the same local source of supply within a 300 foot radius circle which are being operated by pumps not to exceed a total maximum diversion rate of 800 gallons per minute and which supply water to a common distribution system.

6. The owner of the point of diversion, if other than the applicant is (please print):

Same as applicant  
(name, address and telephone number)  
\_\_\_\_\_  
(name, address and telephone number)

You must provide evidence of legal access to, or control of, the point of diversion from the landowner or the landowner's authorized representative. Provide a copy of a recorded deed, lease, easement or other document with this application. In lieu thereof, you may sign the following sworn statement:

I have legal access to, or control of, the point of diversion described in this application from the landowner or the landowner's authorized representative. I declare under penalty of perjury that the foregoing is true and correct.

Executed on 6-26, 2018. Steve Alben  
Applicant's Signature

The applicant must provide the required information or signature irrespective of whether they are the landowner. Failure to complete this portion of the application will cause it to be unacceptable for filing and the application will be returned to the applicant.

7. The proposed project for diversion of water will consist of Geo-Center of 1 groundwater pit  
(number of wells, pumps or dams, etc.)  
and was completed (by) 2013  
(Month/Day/Year - each was or will be completed)

8. The first actual application of water for the proposed beneficial use was or is estimated to be In use  
(Mo/Day/Year)

- 9. Will pesticide, fertilizer, or other foreign substance be injected into the water pumped from the diversion works?  
 Yes    No   If "yes", a check valve shall be required.

All chemigation safety requirements must be met including a chemigation permit and reporting requirements.

- 10. If you are planning to impound water, please contact the Division of Water Resources for assistance, prior to submitting the application. Please attach a reservoir area capacity table and inform us of the total acres of surface drainage area above the reservoir.

Have you also made an application for a permit for construction of this dam and reservoir with the Division of Water Resources?    Yes    No

- If yes, show the Water Structures permit number here \_\_\_\_\_
- If no, explain here why a Water Structures permit is not required \_\_\_\_\_

- 11. The application must be supplemented by a U.S.G.S. topographic map, aerial photograph or a detailed plat showing the following information. On the topographic map, aerial photograph, or plat, identify the center of the section, the section lines or the section corners and show the appropriate section, township and range numbers. Also, please show the following information:

- (a) The location of the proposed point(s) of diversion (wells, stream-bank installations, dams, or other diversion works) should be plotted as described in Paragraph No. 5 of the application, showing the North-South distance and the East-West distance from a section line or southeast corner of section.
- (b) If the application is for groundwater, please show the location of any existing water wells of any kind within 1/2 mile of the proposed well or wells. Identify each existing well as to its use and furnish the name and mailing address of the property owner or owners. If there are no wells within 1/2 mile, please advise us.
- (c) If the application is for surface water, the names and addresses of the landowner(s) 1/2 mile downstream and 1/2 mile upstream from your property lines must be shown.
- (d) The location of the proposed place of use should be shown by crosshatching on the topographic map, aerial photograph or plat.
- (e) Show the location of the pipelines, canals, reservoirs or other facilities for conveying water from the point of diversion to the place of use.

A 7.5 minute U.S.G.S. topographic map may be obtained by providing the section, township and range numbers to: Kansas Geological Survey, 1930 Constant, Campus West, University of Kansas, Lawrence, Kansas 66047.

- 12. List any application, appropriation of water, water right, or vested right file number that covers the same diversion points or any of the same place of use described in this application. Also list any other recent modifications made to existing permits or water rights in conjunction with the filing of this application.

Illegal groundwater pit which was constructed at some point in 2013.

Applying for small use exemption under K.A.R. 5-3-16a as DUA SNI:25 is currently fully appropriated and considered closed.

There is a second groundwater pit next to this one which a separate application has been filed to cover.

**Water Resources  
Received**

**JUN 28 2018**

13. Furnish the following well information if the proposed appropriation is for the use of groundwater. If the well has not been completed, give information obtained from test holes, if available.

Information below is from:  Test holes  Well as completed  Drillers log attached

Well location as shown in paragraph No.	(A)	(B)	(C)	(D)
Date Drilled	_____	_____	_____	_____
Total depth of well	_____	_____	_____	_____
Depth to water bearing formation	_____	_____	_____	_____
Depth to static water level	_____	_____	_____	_____
Depth to bottom of pump intake pipe	_____	_____	_____	_____

14. The relationship of the applicant to the proposed place where the water will be used is that of

Owner  
(owner, tenant, agent or otherwise)

15. The owner(s) of the property where the water is used, if other than the applicant, is (please print):

Same as Applicant  
(name, address and telephone number)

\_\_\_\_\_  
(name, address and telephone number)

16. The undersigned states that the information set forth above is true to the best of his/her knowledge and that this application is submitted in good faith.

Dated at 6-26-18, Kansas, this 26 day of June, 2018  
(month) (year)

Steve Alban  
(Applicant Signature)

By Same  
(Agent or Officer Signature)

\_\_\_\_\_  
(Agent or Officer - Please Print)

Assisted by \_\_\_\_\_ ESII \_\_\_\_\_ Date: 6/22/2018  
(office/title)

2018 JUN 26 10:50 AM  
RECEIVED  
WATER RESOURCES  
DIVISION  
KANSAS DEPARTMENT OF REVENUE

## FEE SCHEDULE

1. The fee for an application for a permit to appropriate water for beneficial use, except for domestic use, shall be (see paragraph No. 2 below if requesting storage):

ACRE-FEET	FEE
0-100	\$200.00
101-320	\$300.00
More than 320	\$300.00 plus \$20.00 for each additional 100 acre-feet or any part thereof.

2. The fee for an application in which storage is requested, except for domestic use, shall be:

ACRE-FEET	FEE
0-250	\$200.00
More than 250	\$200.00 plus \$20.00 for each additional 250 acre-feet of storage or any part thereof.

Note: If an application requests both direct use *and* storage, the fee charged shall be as determined under No. 1 or No. 2 above, whichever is greater, but not both fees.

3. The fee for an application for a permit to appropriate water for water power or dewatering purposes shall be \$100.00 plus \$200.00 for each 100 cubic feet per second, or part thereof, of the diversion rate requested.

Note: The applicant shall notify the Chief Engineer and pay the statutorily required field inspection fee of \$400.00 when construction of the works for diversion has been completed, except that for applications filed on or after July 1, 2009, for works constructed for sediment control use and for evaporation from a groundwater pit for industrial use shall be accompanied by a field inspection fee of \$200.00.

### MAKE CHECKS PAYABLE TO THE KANSAS DEPARTMENT OF AGRICULTURE

#### ATTENTION

A Water Conservation Plan may be required per K.S.A. 82a-733. A statement that your application for permit to appropriate water may be subject to the minimum desirable streamflow requirements per K.S.A. 82a-703a, b, and c may also be required from you. After the Division of Water Resources has had the opportunity to review your application, you will be notified whether or not you will need to submit a Water Conservation Plan. You also may be required to install a water flow meter or water stage measuring device on your diversion works prior to diverting water. There may be other special conditions or Groundwater Management District regulations that you will need to comply with if this application is approved.

#### CONVERSION FACTORS

1 acre-foot equals 325,851 gallons

1 million gallons equal 3.07 acre-feet

**Water Resources  
Received**

**JUN 28 2018**

**KS Dept Of Agriculture**

**RECREATIONAL USE  
SUPPLEMENTAL SHEET**

File No. 50073

Name of Applicant (Please Print): Steve Albers

1. Please indicate type of recreational use (boating, fishing, swimming, etc.): fishing, swimming

Covering evaporation losses from groundwater pit.

2. Please summarize how the water will be used and justify the quantity of water requested: \_\_\_\_\_

Potential Net Evaporation T28S R10W: 29"

Surface Acres: 1.16 Acres

Yearly Use: (1.16 acres x 29")/12" = 2.8AF

3. Please complete the following table showing estimated future water requirements:

<b>ESTIMATED FUTURE WATER DIVERTED/STORED</b>	
<b>NEXT 5 YEARS</b>	<b>WATER TO BE DIVERTED (ACRE-FEET OR GALLONS)</b>
Year 1	2.8AF
Year 2	2.8AF
Year 3	2.8AF
Year 4	2.8AF
Year 5	2.8AF

Please attach any additional information, tables, or curves showing past, present and estimated future water requirements to substantiate the amount of water requested.

4. Please designate the legal description of the location where the water is to be used by providing the fractional part of the Section, Township and Range.

1.16 Acre groundwater pit in SW1/4 SW1/4 of Sec. 21, Township 28S Range 10W, Kingman County.

Second groundwater pit next to this one.

**Water Resources  
Received**

You may attach any additional information you believe will assist in informing the \_\_\_\_\_ need for your request.

**JUN 28 2010**  
**KS Dept Of Agriculture**

\_\_\_\_\_  
(Date)

Kansas Department of Agriculture  
Division of Water Resources  
David W. Barfield, Chief Engineer  
109 SW 9<sup>th</sup> Street, 2nd Floor  
Topeka, Kansas 66612-1283

Re: Application  
File No. 50073

Minimum Desirable Streamflow

Dear Sir:

I understand that a Minimum Desirable Streamflow requirement has been established by the legislature for the source of supply to which the above referenced application applies.

I understand that diversion of water pursuant to this application will be subject to regulation any time Minimum Desirable Streamflow requirements are not being met.

I also understand that if this application is approved, there could be times, as determined by the Division of Water Resources, when I would not be allowed to divert water. I realize that this could affect the economics of my decision to appropriate water.

I am aware of the above factors, and with the knowledge thereof, request that the Division of Water Resources proceed with processing and approval, if possible, of the above referenced application.

Steve Albers  
Signature of Applicant

State of Kansas )  
County of Kingman ) ss

Steve Albers  
(Print Applicant's Name)

I hereby certify that the foregoing instrument was signed in my presence and sworn to before me this 26 day of June, 2018.

Patricia Hensley  
Notary Public

My Commission Expires: 11/17/2021



Water Resources  
Received

JUN 28 2018

KS Dept Of Agriculture



**MINIMUM DESIRABLE STREAMFLOW FORM TO BE USED WHEN  
APPLICABLE WHEN FILING AN APPLICATION FOR PERMIT  
TO APPROPRIATE WATER FOR BENEFICIAL USE**

The Kansas Legislature has established minimum desirable streamflows for the streams listed below. If your proposed diversion of water is going to be from one of these watercourses or adjacent alluvial aquifers, please complete the back side of this page and submit it along with your application for permit to appropriate water.

Arkansas River  
Big Blue River  
Chapman Creek  
Chikaskia River  
Cottonwood River  
Delaware River  
Little Arkansas River  
Little Blue River  
Marais des Cygnes River  
Medicine Lodge River  
Mill Creek (Wabaunsee Co. area)  
Neosho River

Ninnescah River  
North Fork Ninnescah River  
Rattlesnake Creek  
Republican River  
Saline River  
Smoky Hill River  
Solomon River  
South Fork Ninnescah  
Spring River  
Walnut River  
Whitewater River

# STATE OF KANSAS

DEPARTMENT OF AGRICULTURE  
1320 RESEARCH PARK DRIVE  
MANHATTAN, KS 66502  
PHONE: (785) 564-6700  
FAX: (785) 564-6777



900 SW JACKSON, ROOM 456  
TOPEKA, KS 66612  
PHONE: (785) 296-3556  
www.agriculture.ks.gov

GOVERNOR JEFF COLYER, M.D.  
JACKIE McCLASKEY, SECRETARY OF AGRICULTURE

July 3, 2018

STEVE ALBERS  
15140 SW 70TH ST  
CUNNINGHAM KS 67035

RE: Application  
File No. 50073

Dear Sir or Madam:

Your application for permit to appropriate water in 21-28S-10W in Kingman County, was received and has been assigned the file number noted above.

As a matter of record, the Division of Water Resources has on hand a large number of applications awaiting processing. Therefore to be fair to all concerned, and so that we can process those applications on hand in the order they were received, we intend to concentrate on the backlog of applications until the issue is resolved. Once review of your application has begun, we will contact you, if additional information is required.

In accordance with the provisions of the Kansas Water Appropriation Act, a portion of which is included below, the use of water as proposed prior to approval of the application is unlawful. Once approved, compliance with the terms, conditions and limitations of the permit is necessary. Conservation of the water resources of Kansas is required.

**Section 82a-728 of the Kansas Water Appropriation Act, provides (a) except for the appropriation of water for the purpose of domestic use, . . . it shall be unlawful for any person to appropriate or threaten to appropriate water from any source without first applying for and obtaining a permit to appropriate water in accordance with the provisions of the Water Appropriation Act or for any person to violate any condition of a vested right, appropriation right or an approved application for a permit to appropriate water for beneficial use.**

**(b) (1) The violation of any provision of this section by any person is a class C misdemeanor . . .**

**A class C misdemeanor is punishable by a fine not to exceed \$500 and/or a term of confinement not to exceed one month in the county jail. Each day that the violation occurs constitutes a separate offense.**

If you have any questions, please contact me at (785) 564-6637. If you wish to discuss a specific file, please have the file number ready so that we may help you more efficiently.

Sincerely,

A handwritten signature in black ink that reads "Kristen A. Baum".

Kristen A. Baum  
New Applications Unit Supervisor  
Water Appropriation Program

BAT: dlw  
pc: STAFFORD Field Office  
GMD

50073

File No.

47828

28S10W21

Proposed Geo-Center:  
122'N & 4473'W

1/2 Mile Nearby Wells

1 inch = 1,000 feet



I declare that all water wells or diversion sites using the same source of supply and within 1/2 mile of the proposed point of diversion have been plotted on the application map.

Water Resources  
Received

-  Proposed PD
-  Proposed Place of Use
-  Domestic Wells
-  Water Rights
-  SFFOsec\_corners

 Steve Alban

Signature

6-25-18

Date

JUN 28 2018

Created By: Matt Meier  
F.O. 2



KS Dept Of Agriculture



File No.

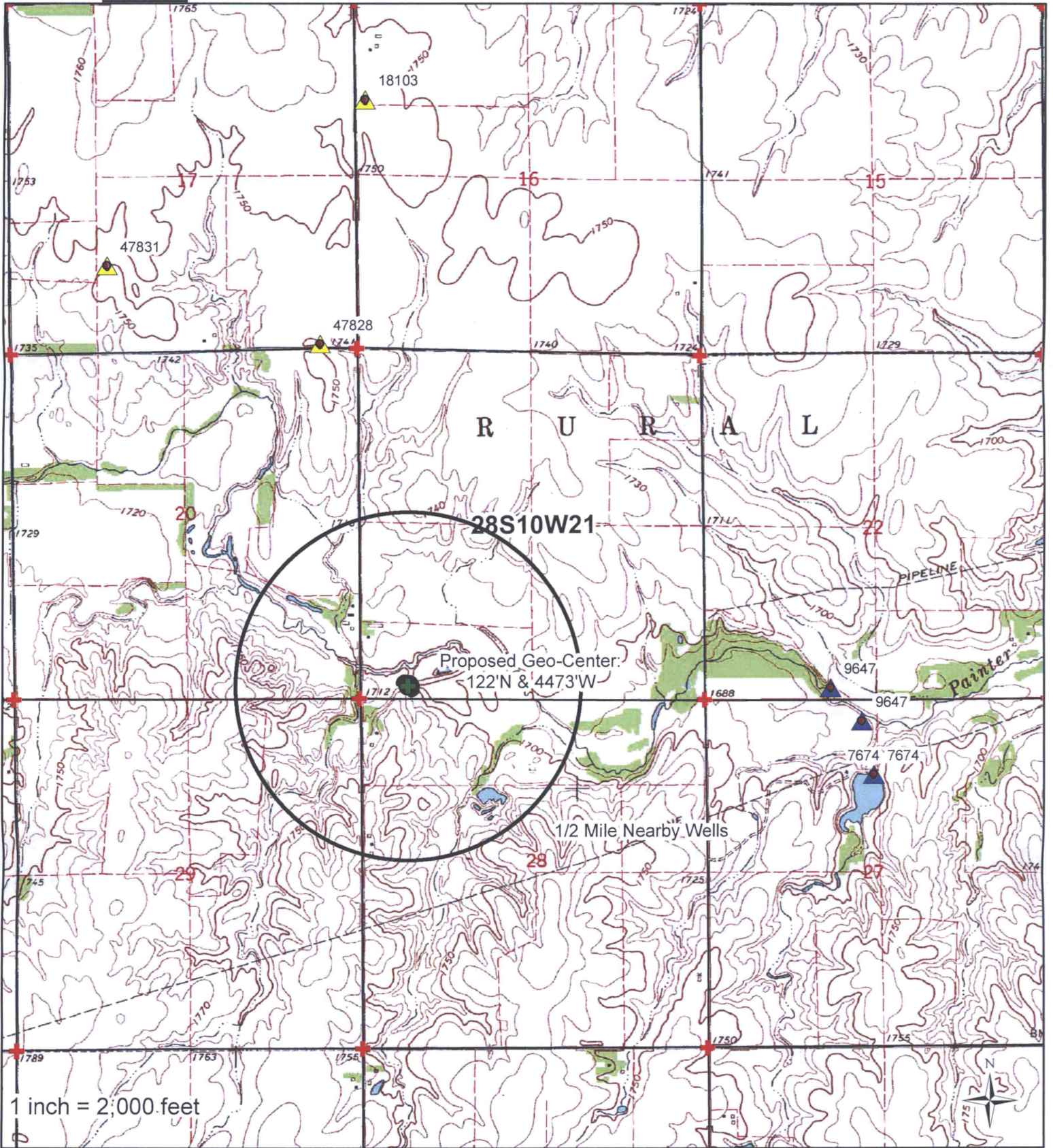

I declare that all water wells or diversion sites using the same source of supply and within 1/2 mile of the proposed point of diversion have been plotted on the application.

-  ProposedPD
-  ProposedPlaceOfUse
-  Domestic Wells
-  Water Rights
-  SFFOsec\_corners

Signature \_\_\_\_\_ Date \_\_\_\_\_  
 0 800 1,600 3,200 4,800 6,400

Water Resources  
Received

JUN 28 2018

Created By: Matt Meier  
F.O. 2  
Date: 6/22/2018

KS Dept Of Agriculture