

NOTICE

This scan only represents the application as filed. The information contained herein meets the requirements of K.A.R. 5-3-1 or K.A.R. 5-5-1, and has been found acceptable for filing in the office of the Chief Engineer. The application should not be considered to be a complete application as per K.A.R. 5-3-1b or K.A.R. 5-5-2a.



KANSAS DEPARTMENT OF AGRICULTURE
Jackie McClaskey, Secretary of Agriculture

DIVISION OF WATER RESOURCES
David W. Barfield, Chief Engineer

File Number 50082
This item to be completed by the Division of Water Resources.

Water Resources
Received
JUL 02 2018
1:04
KS Dept Of Agriculture

**APPLICATION FOR PERMIT TO
APPROPRIATE WATER FOR BENEFICIAL USE**
Filing Fee Must Accompany the Application
(Please refer to Fee Schedule attached to this application form.)

To the Chief Engineer of the Division of Water Resources, Kansas Department of Agriculture,
1320 Research Park Drive, Manhattan, Kansas 66502:

1. Name of Applicant (Please Print): Knight Feedlot, Inc.
Address: 1768 Avenue J
City: Lyons State KS Zip Code 67554
Telephone Number: (620) 257-5106

2. The source of water is: surface water in _____ (stream)
OR groundwater in Cow Creek (drainage basin)

Certain streams in Kansas have minimum target flows established by law or may be subject to administration when water is released from storage for use by water assurance district members. If your application is subject to these regulations on the date we receive your application, you will be sent the appropriate form to complete and return to the Division of Water Resources.

3. The maximum quantity of water desired is 50 acre-feet OR _____ gallons per calendar year, to be diverted at a maximum rate of 30 gallons per minute OR _____ cubic feet per second.

Once your application has been assigned a priority, the requested maximum rate of diversion and maximum requested quantity of water under that priority number can **NOT** be increased. Please be certain your requested maximum rate of diversion and maximum quantity of water are appropriate and reasonable for your proposed project and are in agreement with the Division of Water Resources' requirements.

4. The water is intended to be appropriated for (Check use intended):
- | | | | |
|--|--|---|---|
| (a) <input type="checkbox"/> Artificial Recharge | (b) <input type="checkbox"/> Irrigation | (c) <input type="checkbox"/> Recreational | (d) <input type="checkbox"/> Water Power |
| (e) <input type="checkbox"/> Industrial | (f) <input type="checkbox"/> Municipal | (g) <input checked="" type="checkbox"/> Stockwatering | (h) <input type="checkbox"/> Sediment Control |
| (i) <input type="checkbox"/> Domestic | (j) <input type="checkbox"/> Dewatering | (k) <input type="checkbox"/> Hydraulic Dredging | (l) <input type="checkbox"/> Fire Protection |
| (m) <input type="checkbox"/> Thermal Exchange | (n) <input type="checkbox"/> Contamination Remediation | | |

YOU **MUST** COMPLETE AND ATTACH ADDITIONAL DIVISION OF WATER RESOURCES FORM(S) PROVIDING INFORMATION TO SUBSTANTIATE YOUR REQUEST FOR THE AMOUNT OF WATER FOR THE INTENDED USE REFERENCED ABOVE.

For Office Use Only:
F.O. 2 GMD Meets K.A.R. 5-3-1 (YES / NO) Use STK Source G/S County RC By AW Date 7/2/18
Code 159 Fee \$ 200 TR # _____ Receipt Date 7/2/18 Check # 5913

7/6/18 DAW

5. The location of the proposed wells, pump sites or other works for diversion of water is:

Note: For the application to be accepted, the point of diversion location must be described to at least a 10 acre tract, unless you specifically request a 60 day period of time in which to locate the site within a specifically described, minimal legal quarter section of land.

(A) One in the SW quarter of the SW quarter of the NW quarter of Section 24, more particularly described as being near a point 2765 feet North and 4640 feet West of the Southeast corner of said section, in Township 19 South, Range 8 East/West (circle one), Rice County, Kansas.

(B) One in the _____ quarter of the _____ quarter of the _____ quarter of Section _____, more particularly described as being near a point _____ feet North and _____ feet West of the Southeast corner of said section, in Township _____ South, Range _____ East/West (circle one), _____ County, Kansas.

(C) One in the _____ quarter of the _____ quarter of the _____ quarter of Section _____, more particularly described as being near a point _____ feet North and _____ feet West of the Southeast corner of said section, in Township _____ South, Range _____ East/West (circle one), _____ County, Kansas.

(D) One in the _____ quarter of the _____ quarter of the _____ quarter of Section _____, more particularly described as being near a point _____ feet North and _____ feet West of the Southeast corner of said section, in Township _____ South, Range _____ East/West (circle one), _____ County, Kansas.

If the source of supply is groundwater, a separate application shall be filed for each proposed well or battery of wells, except that a single application may include up to four wells within a circle with a quarter (1/4) mile radius in the same local source of supply which do not exceed a maximum diversion rate of 20 gallons per minute per well.

A battery of wells is defined as two or more wells connected to a common pump by a manifold; or not more than four wells in the same local source of supply within a 300 foot radius circle which are being operated by pumps not to exceed a total maximum diversion rate of 800 gallons per minute and which supply water to a common distribution system.

6. The owner of the point of diversion, if other than the applicant is (please print):

Knight Farms, Inc., 1768 Avenue J, Lyons, KS 67554 620-257-5106

(name, address and telephone number)

(name, address and telephone number)

You must provide evidence of legal access to, or control of, the point of diversion from the landowner or the landowner's authorized representative. Provide a copy of a recorded deed, lease, easement or other document with this application. In lieu thereof, you may sign the following sworn statement:

I have legal access to, or control of, the point of diversion described in this application from the landowner or the landowner's authorized representative. I declare under penalty of perjury that the foregoing is true and correct.

Executed on June 26, 2018. [Signature]

Applicant's Signature

The applicant must provide the required information or signature irrespective of whether they are the landowner. Failure to complete this portion of the application will cause it to be unacceptable for filing and the application will be returned to the applicant.

7. The proposed project for diversion of water will consist of one well
(number of wells, pumps or dams, etc.)

and (was)(will be) completed (by) 10/1/2018
(Month/Day/Year - each was or will be completed)

8. The first actual application of water for the proposed beneficial use was or is estimated to be 11/1/2018
(Mo/Day/Year)

9. Will pesticide, fertilizer, or other foreign substance be injected into the water pumped from the diversion works?
 Yes No If "yes", a check valve shall be required.

All chemigation safety requirements must be met including a chemigation permit and reporting requirements.

10. If you are planning to impound water, please contact the Division of Water Resources for assistance, prior to submitting the application. Please attach a reservoir area capacity table and inform us of the total acres of surface drainage area above the reservoir.

Have you also made an application for a permit for construction of this dam and reservoir with the Division of Water Resources? Yes No

- If yes, show the Water Structures permit number here _____
- If no, explain here why a Water Structures permit is not required _____

11. The application must be supplemented by a U.S.G.S. topographic map, aerial photograph or a detailed plat showing the following information. On the topographic map, aerial photograph, or plat, identify the center of the section, the section lines or the section corners and show the appropriate section, township and range numbers. Also, please show the following information:

- (a) The location of the proposed point(s) of diversion (wells, stream-bank installations, dams, or other diversion works) should be plotted as described in Paragraph No. 5 of the application, showing the North-South distance and the East-West distance from a section line or southeast corner of section.
- (b) If the application is for groundwater, please show the location of any existing water wells of any kind within 1/2 mile of the proposed well or wells. Identify each existing well as to its use and furnish the name and mailing address of the property owner or owners. If there are no wells within 1/2 mile, please advise us.
- (c) If the application is for surface water, the names and addresses of the landowner(s) 1/2 mile downstream and 1/2 mile upstream from your property lines must be shown.
- (d) The location of the proposed place of use should be shown by crosshatching on the topographic map, aerial photograph or plat.
- (e) Show the location of the pipelines, canals, reservoirs or other facilities for conveying water from the point of diversion to the place of use.

A 7.5 minute U.S.G.S. topographic map may be obtained by providing the section, township and range numbers to: Kansas Geological Survey, 1930 Constant, Campus West, University of Kansas, Lawrence, Kansas 66047.

12. List any application, appropriation of water, water right, or vested right file number that covers the same diversion points or any of the same place of use described in this application. Also list any other recent modifications made to existing permits or water rights in conjunction with the filing of this application.

Water Right File Nos. A 47276, A 47277, A 34290, A 38175 and A 38177

Water Resources
Received

JUL 02 2018

KS Dept Of Agriculture

13. Furnish the following well information if the proposed appropriation is for the use of groundwater. If the well has not been completed, give information obtained from test holes, if available.

Information below is from: Test holes Well as completed Drillers log attached

Well location as shown in paragraph No.	(A)	(B)	(C)	(D)
Date Drilled	6/4/2018	_____	_____	_____
Total depth of well	130 feet	_____	_____	_____
Depth to water bearing formation	40 feet	_____	_____	_____
Depth to static water level	23.5 feet	_____	_____	_____
Depth to bottom of pump intake pipe	Not Installed	_____	_____	_____

14. The relationship of the applicant to the proposed place where the water will be used is that of

Owner
(owner, tenant, agent or otherwise)

15. The owner(s) of the property where the water is used, if other than the applicant, is (please print):

(name, address and telephone number)

(name, address and telephone number)

16. The undersigned states that the information set forth above is true to the best of his/her knowledge and that this application is submitted in good faith.

Dated at Lyons, KS, Kansas, this 26 day of June, 2018.
(month) (year)



(Applicant Signature)

By _____
(Agent or Officer Signature)

(Agent or Officer - Please Print)

Assisted by _____ Date: _____
(office/title)

2018
06/04
130
40
23.5
Not Installed

50082

FEE SCHEDULE

1. The fee for an application for a permit to appropriate water for beneficial use, except for domestic use, shall be (see paragraph No. 2 below if requesting storage):

ACRE-FEET	FEE
0-100	\$200.00
101-320	\$300.00
More than 320	\$300.00 plus \$20.00 for each additional 100 acre-feet or any part thereof.

2. The fee for an application in which storage is requested, except for domestic use, shall be:

ACRE-FEET	FEE
0-250	\$200.00
More than 250	\$200.00 plus \$20.00 for each additional 250 acre-feet of storage or any part thereof.

Note: If an application requests both direct use *and* storage, the fee charged shall be as determined under No. 1 or No. 2 above, whichever is greater, but not both fees.

3. The fee for an application for a permit to appropriate water for water power or dewatering purposes shall be \$100.00 plus \$200.00 for each 100 cubic feet per second, or part thereof, of the diversion rate requested.

Note: The applicant shall notify the Chief Engineer and pay the statutorily required field inspection fee of \$400.00 when construction of the works for diversion has been completed, except that for applications filed on or after July 1, 2009, for works constructed for sediment control use and for evaporation from a groundwater pit for industrial use shall be accompanied by a field inspection fee of \$200.00.

MAKE CHECKS PAYABLE TO THE KANSAS DEPARTMENT OF AGRICULTURE

ATTENTION

A Water Conservation Plan may be required per K.S.A. 82a-733. A statement that your application for permit to appropriate water may be subject to the minimum desirable streamflow requirements per K.S.A. 82a-703a, b, and c may also be required from you. After the Division of Water Resources has had the opportunity to review your application, you will be notified whether or not you will need to submit a Water Conservation Plan. You also may be required to install a water flow meter or water stage measuring device on your diversion works prior to diverting water. There may be other special conditions or Groundwater Management District regulations that you will need to comply with if this application is approved.

CONVERSION FACTORS

- 1 acre-foot equals 325,851 gallons
- 1 million gallons equal 3.07 acre-feet

Water Resources
Received

JUL 02 2018

KS Dept Of Agriculture

STOCKWATER USE SUPPLEMENTAL SHEET

File No. _____

Name of Applicant (Please Print): Knight Feedlot, Inc.

1. Please indicate type of livestock (cattle, hogs, etc.): Cattle (greater than 700 pounds)

2. Please complete the following table showing past and present water requirements:

PAST NUMBER OF HEAD AND WATER DIVERTED, IF APPLICABLE

LAST 5 YEARS	NUMBER OF HEAD	WATER DIVERTED (GALLONS)	GALLONS PER HEAD PER DAY
5 years ago	8,575	42,340,150	12.92
Last year	11,875	50,847,140	11.75
Present Year	13,442	22,041,410	10.90

3. Please complete the following table showing estimated future water requirements:

ESTIMATED FUTURE NUMBER OF HEAD AND WATER DIVERTED

NEXT 5 YEARS	NUMBER OF HEAD	WATER TO BE DIVERTED (GALLONS)	GALLONS PER HEAD PER DAY
Year 1	30,000	114,975,000	10.5
Year 2	30,000	114,975,000	10.5
Year 3	30,000	114,975,000	10.5
Year 4	30,000	114,975,000	10.5
Year 5	30,000	114,975,000	10.5

Please attach any additional information, tables, or curves showing past, present and estimated future water requirements to substantiate the amount of water requested.

4. Please designate the legal description of the location where the water is to be used. Show in the space provided below the Section (S), Township (T), and Range (R), and the number of acres in each forty acre tract or fractional portion thereof.

S	T	R	NE¼				NW¼				SW¼				SE¼				TOTAL
			NE	NW	SW	SE	NE	NW	SW	SE	NE	NW	SW	SE	NE	NW	SW	SE	
23	19	8W	40	40	40	40	40	40	40	40	40	40	40	40	40	40	40	640	

5. Show quantities of water used and all associated water uses at the feedlot such as water used in feed mills, cooling of animals, washing, flushing of wastes, etc.:

DRINKING

30,000 head of Cattle x 10.5 gallons/head (avg.) x 365 days = 114,975,000 gallons

_____ head of _____ x _____ gallons/head (avg.) x _____ days = _____ gallons

_____ head of _____ x _____ gallons/head (avg.) x _____ days = _____ gallons

COOLING

_____ gallons/hour x _____ hour/day x _____ days = _____ gallons

SANITATION

_____ g.p.m. x 60 min/hr x _____ hr/wk x _____ wks/yr = _____ gallons

OTHER USE (Explain) _____ = _____ gallons

TOTAL ----- 114,975,000 gallons

6. Show location of present and future location of confinement pens on your attached maps or photographs.

7. Total feed bunk space for cattle or livestock is 30,000 linear feet.

8. Total size of stock pens for confinement area of cattle, hogs, etc. is 7,500,000 square feet.

You may attach any additional information you believe will assist in informing the Division of Water Resources of the need for your request.

KLA ENVIRONMENTAL SERVICES, INC.

PROJECT: KNIGHT FEEDLOT, INC.

LOCATION: SECTION 23 T19S R8W. RICE COUNTY, KS

BY: KLS
DATE: 6/14/2018

CHECKED BY: _____
DATE: _____

WATER RIGHT SUMMARY

WATER RIGHT FILE NO.	TEST HOLE ID	BENEFICIAL USE	AUTHORIZED QUANTITY (AC-FT)	NET QUANTITY (AC-FT)	AUTHORIZED OR REQUESTED RATE (GPM)	Longitude	Latitude	P/D DIST. FROM SE SECTION CORNER			QUALIFIERS		
								SEC-TWP-RGE	NORTH	WEST			
A 34290 00		STK	9.207	9.207	40	-98.17095	38.39067	23-19S-8W	5067 FT	1867 FT	NE	NW	NE
A 34290 00		STK				-98.17092589	38.39066854	23-19S-8W					
A 34290 00		STK				-98.17085	38.39083	23-19S-8W					
A 38175 00		STK	47.261	47.261	20	-98.17741	38.39106	23-19S-8W	5202 FT	3721 FT	NW	NE	NW
A 38177 00		STK	49.593	49.593	40	-98.17092589	38.39066854	23-19S-8W	5067 FT	1867 FT	NE	NW	NE
A 38177 00		STK				-98.17095	38.39067	23-19S-8W					
A 38177 00		STK				-98.17085	38.39083	23-19S-8W					
A 47276 00		STK	96.780	0	60	-98.16912821	38.39475584	14-19S-8W	1260 FT	1360 FT	NE	SW	SE
A 47277 00		STK	64.520	0	40	-98.16875837	38.39182047	14-19S-8W	191 FT	1254 FT	SW	SE	SE
	23-TH-2-18	STK		50	30	-98.1723	38.3770	23-19S-8W	82 FT	2147 FT	SW	SW	SE
	23-TH-5-18	STK		50	30	-98.1656	38.3770	23-19S-8W	82 FT	229 FT	SE	SE	SE
	23-TH-6-18	STK		50	30	-98.1696	38.3769	23-19S-8W	46 FT	1374 FT	SE	SW	SE
	24-TH-1-18	STK		50	30	-98.1646	38.3843	24-19S-8W	2765 FT	5241 FT	SW	SW	NW
	24-TH-2-18	STK		50	30	-98.1625	38.3843	24-19S-8W	2765 FT	4640 FT	SW	SW	NW

356.06 Acre-Feet
116,010,000 Gallons

Livestock water needs calculator

Input		Calculated			
Head of Beef Cattle	Gal/Head/Day	Gallons/Day	GPM	Ac-Feet/Yr	Gallons/Yr
30,000	10:50	315,000	219	353	114,975,000

Water Resources
 Received
 JUL 02 2018
 KS Dept Of Agriculture

50082

KLA ENVIRONMENTAL SERVICES, INC.

PROJECT: KNIGHT FEEDLOT, INC.

LOCATION: SECTION 23, T19S R8W, RICE COUNTY, KS

BY: JLW
DATE: 6/14/2018

CHECKED BY: KLS
DATE: 6/15/2018

WATER USE DATA FROM PCP RECORDS

KNIGHT FEEDLOT WATER USAGE 2015 TO 2017

2014	Days	Water Use By Month	Water Purchased	Average # of Cattle	Gal/Head/Day	2015	Days	Water Use By Month	Water Purchased	Average # of Cattle	Gal/Head/Day	2016	Days	Water Use By Month	Water Purchased	Average # of Cattle	Gal/Head/Day
January	31	0	539,000	7,262	2.39	January	31	4,112,030		13,862	9.57	January	31		3,400,000	12,156	9.02
February	28	0	1,496,000	6,664	8.02	February	28	3,163,530	691,000	11,700	11.77	February	28	1,599,460	1,606,000	12,819	8.93
March	31	0	875,000	7,392	3.82	March	31	4,379,740	998,890	10,414	16.66	March	31	768,840	3,101,000	14,372	8.69
April	30	0	1,115,000	6,868	5.41	April	30	1,737,880	1,249,110	11,439	8.70	April	30	850,500	2,560,000	14,730	7.72
May	31	0	95,000	6,969	0.44	May	31	1,487,060		10,696	4.48	May	31	696,610	3,220,000	12,696	9.95
June	30	0	25,000	9,251	0.09	June	30	310,720	3,417,000	10,730	11.58	June	30	826,770	2,430,000	11,985	9.06
July	31	14,155,710	61,000	8,453	54.25	July	31	559,730	3,358,000	9,826	12.86	July	31	772,640	1,890,000	7,893	10.88
August	31	1,363,260	44,000	9,120	4.98	August	31	175,000	4,414,000	11,052	13.39	August	31	999,470	1,860,000	10,196	9.05
September	30	1,174,070	27,000	12,322	3.25	September	30	331,070	3,485,000	11,156	11.40	September	30	845,985	1,010,600	11,470	5.40
October	31	2,023,170	33,000	13,520	4.91	October	31	5,000	4,744,000	12,518	12.24	October	31	1,709,365	501,800	12,775	5.58
November	30	1,711,130	113,000	14,601	4.16	November	30	545,800	2,773,000	13,237	8.36	November	30	3,181,800	200,000	13,396	8.41
December	31	2,655,500	332,000	14,510	6.64	December	31	645,850	328,000	13,015	2.41	December	31	6,184,630	104,600	13,568	14.95
TOTAL	365	23,082,840	4,755,000	9,744	7.83	TOTAL	365	17,453,410	25,458,000	11,637	10.10	TOTAL	365	18,436,070	21,884,000	12,338	8.95

2017	Days	Water Use By Month	Water Purchased	Average # of Cattle	Gal/Head/Day	2018	Water Use By Month	Water Purchased	Average # of Cattle	Gal/Head/Day
January	31	2,326,420	1,371,000	12,697	9.39	January	3,903,540	462,000	12,746	11.05
February	28	3,350,850	1,202,000	10,842	15.00	February	3,639,660	843,000	13,124	12.20
March	31	4,378,190	1,483,000	14,191	13.32	March	4,430,410	686,000	13,984	11.80
April	30	4,036,150	521,000	14,087	10.78	April	2,652,980	204,000	14,068	6.77
May	31	2,740,090	367,000	13,765	7.28	May	4,674,820	545,000	13,287	12.67
June	30	4,390,570	1,859,000	12,496	16.67					
July	31	3,555,450	807,000	10,598	13.28					
August	31	2,860,010	306,000	9,011	11.33					
September	30	3,419,240	238,000	8,687	14.03					
October	31	3,057,790	100,000	9,985	10.20					
November	30	4,043,710	123,000	12,955	10.72					
December	31	4,099,670	212,000	12,971	10.72					
TOTAL	365	42,258,140	8,589,000	11,857	11.75	TOTAL	19,301,410	2,740,000	13,442	10.90

KLA ENVIRONMENTAL SERVICES, INC.

PROJECT: KNIGHT FEEDLOT, INC.

LOCATION: SECTION 23 T19S R8W, RICE COUNTY, KS

BY: JLW
DATE: 6/14/2018

CHECKED BY: KLS
DATE: 6/15/2018

Average Gal/Head/Day 2014 to 2017	
January	7.59
February	10.93
March	10.62
April	8.15
May	5.54
June	9.35
July	22.82
August	9.69
September	8.52
October	8.23
November	7.91
December	8.68
TOTAL	9.66

Annual Water Use Report

Water Right	2013*	2014	2015	2016	2017	Average
34290	2,430,270	2,773,330	1,709,370	4,735,250	6,450,090	3,619,662
34290	4,723,270	2,898,320	855,290	580,870	2,736,110	2,358,772
38175	1,998,610	9,161,790	0	707,350	843,640	2,542,278
47276	25,191,700	3,863,500	9,751,300	6,564,500	30,510,200	15,176,240
47277	6,070,300	4,385,900	5,191,600	5,848,100	1,718,100	4,642,800
Total	40,414,150	23,082,840	17,507,560	18,436,070	42,258,140	28,339,752
Water Purcha	365 1,926,000	4,755,000	25,458,000	21,884,000	8,589,000	12,522,400
Average Head	8.575	9.744	11.637	12.338	11.857	10.830
Gal/Head/Day	12.92	7.83	10.12	8.95	11.75	10.31

*Monthly well readings not available in 2013

Water Resources
 Received
 JUL 02 2018
 KS Dept Of Agriculture

50082

1700 E. IRON AVE. • SALINA, KS 67401
T 785.823.0097 F 913.273.1493



1303 YUCCA ST. • SCOTT CITY, KS 67871
WWW.KLAENVIRO.COM

June 29, 2018

Mr. David Barfield, P.E.
Chief Engineer
Division of Water Resources
Kansas Department of Agriculture
1320 Research Park Drive
Manhattan, KS 66502

Water Resources
Received

JUL 02 2018

KS Dept Of Agriculture

Subject: Knight Feedlot, Inc. - Applications for New Appropriations of Water for Beneficial Use

Dear Mr. Barfield:

Five applications to appropriate water for stock watering use and Check No. 5913 for \$1,000.00 are enclosed for your consideration. These applications are submitted on behalf of the applicant, Knight Feedlot, Inc. KLA Environmental Services, Inc. assisted with the preparation of this application.

Knight Feedlot, Inc. is a permitted confined beef cattle feeding facility. The current permitted capacity is 20,000 head of beef cattle. The average number of cattle on feed over the past 5 years was 10,830 head of beef cattle and the existing water supply was marginally sufficient. The facility purchases water from the City of Lyons, Kansas to supplement the existing water supplies. An expansion to 30,000 head is planned. Additional sources of stock water are needed to support this capacity and the project is contingent upon acquiring additional water rights that will provide a sufficient and stable water supply.

We determined that the areas in the vicinity of the proposed wells are not within a groundwater management district and not closed to new appropriations. Preliminary discussions with Division of Water Resources staff (Elizabeth Fitch) indicated that as much as 250 acre-feet (AF) may be available for new appropriations within the vicinity of this facility. These applications request new appropriations from this source of water.

We acknowledge the requirements for a ½-mile well spacing limitation for wells placed in confined aquifers and request guidance from your agency. To the best of our knowledge, there are no other wells that rely on the Dakota aquifer in the immediate vicinity of these applications and the authorized wells owned by Knight Feedlot, Inc. The likelihood of impairment of non-owned neighboring wells is minimal. We therefore request a waiver of the applicable provisions of K.A.R. 5-4-4 as it pertains to these applications and File Nos. 34,290, 38,175, 38,177, 47,276, and 47,277.

Water Resources
Received

JUL 02 2018

KS Dept Of Agriculture

The quantity requested in the application is based on the maximum reasonable quantity of water indicated in K.A.R. 5-3-22 and the total capacity resulting from the proposed expansion:

$$(30,000 \text{ head of beef cattle}) \times (10.5 \text{ gallons/head/day}) \times (365 \text{ days/year}) = 115 \text{ million gallons/yr.} \\ = 353 \text{ AF/yr.}$$

The requested quantity for each well was rounded up to 50 AF/yr. each. The maximum reasonable request is the difference between the maximum reasonable quantity and the existing authorized quantity. The existing authorized quantity of all pertinent water rights appears to be subject to an overall limitation of 106.1 AF. Therefore, the maximum quantity requested in this application is:

$$356.1 \text{ AF/yr.} - 106.1 \text{ AF/yr.} = 250.0 \text{ AF/yr.}$$

An authorized rate of 50 AF/yr. is requested for each of the five wells. A rate of 30 gallons per minute is also requested for each well. This rate is sufficient to produce the requested quantity in a reasonable period of time.

We plotted all known active wells on the maps enclosed with the application. Location coordinates listed in WRIS reports were used in the application and on the maps where required.

We searched the *Water Well Completion Records (WWC5) Database* operated by the Kansas Geological Survey and found no evidence of domestic wells within ½ mile of the wells associated with this application.

Please contact me if you have any questions concerning the enclosed application or the associated supporting documentation. Thank you for your consideration of this matter.

Respectfully,



Kevin L. Shamburg, P.E.
785-820-6087 (cell)
kshamburg@klaenviro.com

Enclosures

cc/enc: Luke Knight, Knight Feedlot, Inc.

Water Resources
Received

JUL 02 2018

KS Dept Of Agriculture

STATE OF KANSAS

DEPARTMENT OF AGRICULTURE
1320 RESEARCH PARK DRIVE
MANHATTAN, KS 66502
PHONE: (785) 564-6700
FAX: (785) 564-6777



900 SW JACKSON, ROOM 456
TOPEKA, KS 66612
PHONE: (785) 296-3556
www.agriculture.ks.gov

GOVERNOR JEFF COLYER, M.D.
JACKIE McCLASKEY, SECRETARY OF AGRICULTURE

July 5, 2018

KNIGHT FEEDLOT, INC
1768 AVENUE J
LYONS KS 67554

RE: Application
File No. 50082

Dear Sir or Madam:

Your application for permit to appropriate water in 24-19S-8W in Rice County, was received and has been assigned the file number noted above.

As a matter of record, the Division of Water Resources has on hand a large number of applications awaiting processing. Therefore to be fair to all concerned, and so that we can process those applications on hand in the order they were received, we intend to concentrate on the backlog of applications until the issue is resolved. Once review of your application has begun, we will contact you, if additional information is required.

In accordance with the provisions of the Kansas Water Appropriation Act, a portion of which is included below, the use of water as proposed prior to approval of the application is unlawful. Once approved, compliance with the terms, conditions and limitations of the permit is necessary. Conservation of the water resources of Kansas is required.

Section 82a-728 of the Kansas Water Appropriation Act, provides (a) except for the appropriation of water for the purpose of domestic use, . . . it shall be unlawful for any person to appropriate or threaten to appropriate water from any source without first applying for and obtaining a permit to appropriate water in accordance with the provisions of the Water Appropriation Act or for any person to violate any condition of a vested right, appropriation right or an approved application for a permit to appropriate water for beneficial use.

(b) (1) The violation of any provision of this section by any person is a class C misdemeanor . . .

A class C misdemeanor is punishable by a fine not to exceed \$500 and/or a term of confinement not to exceed one month in the county jail. Each day that the violation occurs constitutes a separate offense.

If you have any questions, please contact me at (785) 564-6637. If you wish to discuss a specific file, please have the file number ready so that we may help you more efficiently.

Sincerely,

Kristen A. Baum
New Applications Unit Supervisor
Water Appropriation Program

BAT: dlw
pc: STAFFORD Field Office
GMD



LEGEND

- POINT OF DIVERSION (STK)
- POINT OF DIVERSION (STK NEW)
- ▨ FEEDYARD EXPANSION AREA



T19S

R8W

RATE & QUANTITY MAP

DRAWN	DLB	DATE	6/18
CHECKED	KLS	DATE	6/18
APPROVED	KLS	DATE	6/18

KNIGHT FEEDLOT, INC.
WATER RIGHTS
SECTION 23 T19S R8W
RICE COUNTY, KANSAS

1700 E. HIGHWAY 10
SCOTT CITY, MISSOURI 64785
(781) 623-9887

1303 MUCCA STREET
SCOTT CITY, KANSAS 67271
(620) 877-2000



CAD FILE NAME:
WATER RIGHTS.dwg

SHEET NO. 1 OF 2

escc



KS Dept Of Agriculture
 Water Resources
 Received
 JUL 02 2018

FEEDYARD EXPANSION

LEGEND

- POINT OF DIVERSION (STK)
- POINT OF DIVERSION (STK NEW)
- FEEDYARD EXPANSION AREA
- PROPOSED PLACE OF USE



T19S

R8W

DRAWN	DLB	DATE	6/18
CHECKED	KLS	DATE	6/18
APPROVED	KLS	DATE	6/18

KNIGHT FEEDLOT, INC.
 WATER RIGHTS
 SECTION 23 T19S R8W
 RICE COUNTY, KANSAS

1700 E. ION
 SALINA, KANSAS 67401
 (785) 825-0087
 1303 NUCCA STREET
 SCOTT CITY, KANSAS 67871
 (603) 872-2000



CAD FILE NAME:
 WATER RIGHTS.dwg
 SHEET NO. 1 OF 2

PLACE OF USE MAP

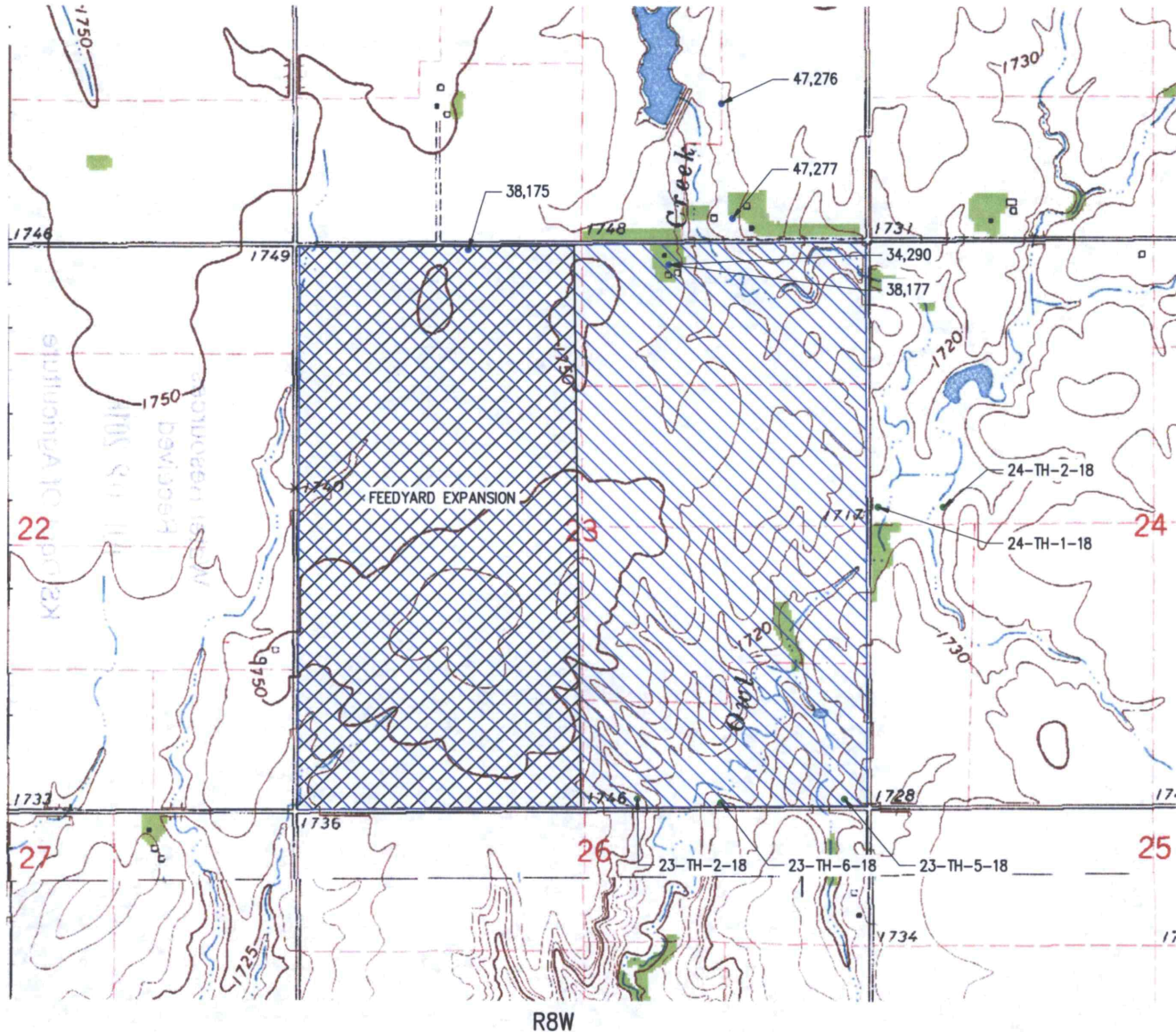
50853



LEGEND

- POINT OF DIVERSION (STK)
- POINT OF DIVERSION (STK NEW)
-  FEEDYARD EXPANSION AREA
-  PROPOSED PLACE OF USE

DRAWN	DLB	DATE	6/18
CHECKED	KLS	DATE	6/18
APPROVED	KLS	DATE	6/18

KNIGHT FEEDLOT, INC.
 WATER RIGHTS
 SECTION 23 T19S R8W
 RICE COUNTY, KANSAS

1700 E IRON
 SALINA, KANSAS 67401
 (785) 823-0887
 1300 WYCHA STREET
 SCOTT CITY, KANSAS 67071
 (888) 872-2300



CAD FILE NAME:
 WATER RIGHTS.dwg

SHEET NO. 2 OF 2

PLACE OF USE MAP