

NOTICE

This scan only represents the application as filed. The information contained herein meets the requirements of K.A.R. 5-3-1 or K.A.R. 5-5-1, and has been found acceptable for filing in the office of the Chief Engineer. The application should not be considered to be a complete application as per K.A.R. 5-3-1b or K.A.R. 5-5-2a.

THE STATE OF KANSAS



KANSAS DEPARTMENT OF AGRICULTURE
Jackie McClaskey, Secretary of Agriculture

DIVISION OF WATER RESOURCES
David W. Barfield, Chief Engineer

WATER RESOURCES
RECEIVED

File Number 50129
This item to be completed by the Division of Water Resources.

Water Resources
Received

SEP 10 2018

APPLICATION FOR PERMIT TO
APPROPRIATE WATER FOR BENEFICIAL USE

SEP 10 2018

3:05
KS DEPT OF AGRICULTURE

Filing Fee Must Accompany the Application
(Please refer to Fee Schedule attached to this application for UNACCEPTABLE PRIORITY)

To the Chief Engineer of the Division of Water Resources, Kansas Department of Agriculture,
1320 Research Park Drive, Manhattan, Kansas 66502:

1. Name of Applicant (Please Print): ROBERT D HAY TRUST
Address: 9171 S. WEST STREET
City: HAYSVILLE State KS Zip Code 67060
Telephone Number: (316) 734-8277

2. The source of water is: surface water in _____ (stream)
OR groundwater in NINNESCAH RIVER (drainage basin)

Certain streams in Kansas have minimum target flows established by law or may be subject to administration when water is released from storage for use by water assurance district members. If your application is subject to these regulations on the date we receive your application, you will be sent the appropriate form to complete and return to the Division of Water Resources.

3. The maximum quantity of water desired is 107.5 acre-feet OR _____ gallons per calendar year, to be diverted at a maximum rate of 500 gallons per minute OR _____ cubic feet per second.

Once your application has been assigned a priority, the requested maximum rate of diversion and maximum requested quantity of water under that priority number can **NOT** be increased. Please be certain your requested maximum rate of diversion and maximum quantity of water are appropriate and reasonable for your proposed project and are in agreement with the Division of Water Resources' requirements.

4. The water is intended to be appropriated for (Check use intended):
(a) Artificial Recharge (b) Irrigation (c) Recreational (d) Water Power
(e) Industrial (f) Municipal (g) Stockwatering (h) Sediment Control
(i) Domestic (j) Dewatering (k) Hydraulic Dredging (l) Fire Protection
(m) Thermal Exchange (n) Contamination Remediation

YOU **MUST** COMPLETE AND ATTACH ADDITIONAL DIVISION OF WATER RESOURCES FORM(S) PROVIDING INFORMATION TO SUBSTANTIATE YOUR REQUEST FOR THE AMOUNT OF WATER FOR THE INTENDED USE REFERENCED ABOVE.

For Office Use Only:
F.O. 2 GMD 0 Meets K.A.R. 5-3-1 (YES / NO) Use IRR Source G/S County SG By DW Date 9/11/18
Code 102 Fee \$ 300 TR # _____ Receipt Date 9/10/18 Check # 17365

9/17/2018 CM

LOCATION TO Be PROVIDED WHEN DRILLING IS Complete

File No. 50129

5. The location of the proposed wells, pump sites or other works for diversion of water is:

Note: For the application to be accepted, the point of diversion location must be described to at least a 10 acre tract, unless you specifically request a 60 day period of time in which to locate the site within a specifically described, minimal legal quarter section of land.

- (A) One in the ___ quarter of the ___ quarter of the SW quarter of Section 35, more particularly described as being near a point ___ feet North and ___ feet West of the Southeast corner of said section, in Township 29 South, Range 2 East (West (circle one)), SEDGWICK County, Kansas.
- (B) One in the ___ quarter of the ___ quarter of the ___ quarter of Section ___, more particularly described as being near a point ___ feet North and ___ feet West of the Southeast corner of said section, in Township ___ South, Range ___ East/West (circle one), _____ County, Kansas.
- (C) One in the ___ quarter of the ___ quarter of the ___ quarter of Section ___, more particularly described as being near a point ___ feet North and ___ feet West of the Southeast corner of said section, in Township ___ South, Range ___ East/West (circle one), _____ County, Kansas.
- (D) One in the ___ quarter of the ___ quarter of the ___ quarter of Section ___, more particularly described as being near a point ___ feet North and ___ feet West of the Southeast corner of said section, in Township ___ South, Range ___ East/West (circle one), _____ County, Kansas.

If the source of supply is groundwater, a separate application shall be filed for each proposed well or battery of wells, except that a single application may include up to four wells within a circle with a quarter (1/4) mile radius in the same local source of supply which do not exceed a maximum diversion rate of 20 gallons per minute per well.

A battery of wells is defined as two or more wells connected to a common pump by a manifold; or not more than four wells in the same local source of supply within a 300 foot radius circle which are being operated by pumps not to exceed a total maximum diversion rate of 800 gallons per minute and which supply water to a common distribution system.

6. The owner of the point of diversion, if other than the applicant is (please print):

 (name, address and telephone number)

 (name, address and telephone number)

You must provide evidence of legal access to, or control of, the point of diversion from the landowner or the landowner's authorized representative. Provide a copy of a recorded deed, lease, easement or other document with this application. In lieu thereof, you may sign the following sworn statement:

I have legal access to, or control of, the point of diversion described in this application from the landowner or the landowner's authorized representative. I declare under penalty of perjury that the foregoing is true and correct.

Executed on _____, 20____. _____
 Applicant's Signature

The applicant must provide the required information or signature irrespective of whether they are the landowner. Failure to complete this portion of the application will cause it to be unacceptable for filing and the application will be returned to the applicant.

7. The proposed project for diversion of water will consist of 4 _____
 (number of wells, pumps or dams, etc.)
 and (was) (will be) completed (by) JAN 31 2019 _____
 (Month/Day/Year - each was or will be completed)

8. The first actual application of water for the proposed beneficial use was or is estimated to be APR 30 2019
 (Mo/Day/Year)

Water Resources
 Received

SEP 10 2018

KS Dept Of Agriculture



50129

KANSAS DEPARTMENT OF AGRICULTURE
Jackie McClaskey, Secretary of Agriculture

DIVISION OF WATER RESOURCES
David W. Barfield, Chief Engineer

**SWORN STATEMENT
PURSUANT TO K.S.A. 82a-709**

You must provide evidence of legal access to, or control of, the point of diversion from the landowner or the landowner's authorized representative. Provide a copy of a recorded deed, lease, easement or other document with this application. In lieu thereof, you may sign the following sworn statement:

I have legal access to, or control of, the point of diversion described in this application from the landowner or the landowner's authorized representative. I declare under penalty of perjury that the foregoing is true and correct.

Executed on 9-10, 2018 Robert O Hay
Applicant's Signature

The applicant must provide the required information or signature irrespective of whether they are the landowner. Failure to complete this portion of the application will cause it to be unacceptable for filing and the application will be returned to the applicant.

- 9. Will pesticide, fertilizer, or other foreign substance be injected into the water pumped from the diversion works?
 Yes No If "yes", a check valve shall be required.

All chemigation safety requirements must be met including a chemigation permit and reporting requirements.

- 10. If you are planning to impound water, please contact the Division of Water Resources for assistance, prior to submitting the application. Please attach a reservoir area capacity table and inform us of the total acres of surface drainage area above the reservoir.

Have you also made an application for a permit for construction of this dam and reservoir with the Division of Water Resources? Yes No

If yes, show the Water Structures permit number here _____

If no, explain here why a Water Structures permit is not required _____

- 11. The application must be supplemented by a U.S.G.S. topographic map, aerial photograph or a detailed plat showing the following information. On the topographic map, aerial photograph, or plat, identify the center of the section, the section lines or the section corners and show the appropriate section, township and range numbers. Also, please show the following information:

(a) The location of the proposed point(s) of diversion (wells, stream-bank installations, dams, or other diversion works) should be plotted as described in Paragraph No. 5 of the application, showing the North-South distance and the East-West distance from a section line or southeast corner of section.

(b) If the application is for groundwater, please show the location of any existing water wells of any kind within 1/2 mile of the proposed well or wells. Identify each existing well as to its use and furnish the name and mailing address of the property owner or owners. If there are no wells within 1/2 mile, please advise us.

(c) If the application is for surface water, the names and addresses of the landowner(s) 1/2 mile downstream and 1/2 mile upstream from your property lines must be shown.

(d) The location of the proposed place of use should be shown by crosshatching on the topographic map, aerial photograph or plat.

(e) Show the location of the pipelines, canals, reservoirs or other facilities for conveying water from the point of diversion to the place of use.

A 7.5 minute U.S.G.S. topographic map may be obtained by providing the section, township and range numbers to: Kansas Geological Survey, 1930 Constant, Campus West, University of Kansas, Lawrence, Kansas 66047.

- 12. List any application, appropriation of water, water right, or vested right file number that covers the same diversion points or any of the same place of use described in this application. Also list any other recent modifications made to existing permits or water rights in conjunction with the filing of this application.

NONE

Water Resources
Received

SEP 10 2018

DRILL LOGS TO BE PROVIDED

File No. 50129

13. Furnish the following well information if the proposed appropriation is for the use of groundwater. If the well has not been completed, give information obtained from test holes, if available.

Information below is from: Test holes Well as completed Drillers log attached

Well location as shown in paragraph No.	(A)	(B)	(C)	(D)
Date Drilled	_____	_____	_____	_____
Total depth of well	_____	_____	_____	_____
Depth to water bearing formation	_____	_____	_____	_____
Depth to static water level	_____	_____	_____	_____
Depth to bottom of pump intake pipe	_____	_____	_____	_____

14. The relationship of the applicant to the proposed place where the water will be used is that of owner
(owner, tenant, agent or otherwise)

15. The owner(s) of the property where the water is used, if other than the applicant, is (please print):

(name, address and telephone number)

(name, address and telephone number)

16. The undersigned states that the information set forth above is true to the best of his/her knowledge and that this application is submitted in good faith.

Dated at Haysville, Kansas, this 7th day of September, 2018.
(month) (year)

Robert D Hay
(Applicant Signature)

By _____
(Agent or Officer Signature)

(Agent or Officer - Please Print)

Assisted by BRAD VINCENT GROUND WATER ASSOCIATES Date: 5 SEPT 2018
(office/title)

Water Resources
Received

SEP 10 2018

KS Dept Of Agriculture

**IRRIGATION USE
SUPPLEMENTAL SHEET**

File No. 50129

Name of Applicant (Please Print): ROBERT D. HAY TRUST

1. Please supply the name and address of each landowner, the legal description of the lands to be irrigated, and designate the actual number of acres to be irrigated in each forty acre tract or fractional portion thereof:

Landowner of Record NAME: ROBERT D. HAY TRUST
ADDRESS: 9171 S. WEST STREET

S	T	R	NE¼				NW¼				SW¼				SE¼				TOTAL
			NE	NW	SW	SE	NE	NW	SW	SE	NE	NW	SW	SE	NE	NW	SW	SE	
35	29	2W																	77.9

Landowner of Record NAME: _____
ADDRESS: _____

S	T	R	NE¼				NW¼				SW¼				SE¼				TOTAL
			NE	NW	SW	SE	NE	NW	SW	SE	NE	NW	SW	SE	NE	NW	SW	SE	

Landowner of Record NAME: _____
ADDRESS: _____

S	T	R	NE¼				NW¼				SW¼				SE¼				TOTAL
			NE	NW	SW	SE	NE	NW	SW	SE	NE	NW	SW	SE	NE	NW	SW	SE	

2. Please complete the following information for the description of the operation for the irrigation project. Attach supplemental sheets as needed.

a. Indicate the soils in the field(s) and their intake rates:

Soil Name	Percent of field (%)	Intake Rate (in/hr)	Irrigation Design Group
Bethany silt loam	23.5%		
Elginco silty loam	36.2%		
Goessel silty clay	3%		
Tabler silty clay	34.1%		
Total:	100%		

b. Estimate the average land slope in the field(s):

1 %

Estimate the maximum land slope in the field(s):

1 %

c. Type of irrigation system you propose to use (check one):

- Center pivot
- Gravity system (furrows)
- Center pivot - LEPA
- Gravity system (borders)
- "Big gun" sprinkler
- Sideroll sprinkler

Other, please describe: _____

d. System design features:

i. Describe how you will control tailwater:

ii. For sprinkler systems:

- (1) Estimate the operating pressure at the distribution system: _____ psi: *To be determined*
- (2) What is the sprinkler package design rate? _____ gpm *To be determined*
- (3) What is the wetted diameter (twice the distance the sprinkler throws water) of a sprinkler on the outer 100 feet of the system? _____ feet *To be determined*
- (4) Please include a copy of the sprinkler package design information. *To be determined*

e. Crop(s) you intend to irrigate. Please note any planned crop rotations:

wheat - corn - soybeans

f. Please describe how you will determine when to irrigate and how much water to apply (particularly important if you do not plan a full irrigation).

crop consultant

You may attach any additional information you believe will assist in informing the Division of the need for your request.

Water Resources Received

SEP 10 2018

STATE OF KANSAS

DEPARTMENT OF AGRICULTURE
1320 RESEARCH PARK DRIVE
MANHATTAN, KS 66502
PHONE: (785) 564-6700
FAX: (785) 564-6777



900 SW JACKSON, ROOM 456
TOPEKA, KS 66612
PHONE: (785) 296-3556
www.agriculture.ks.gov

GOVERNOR JEFF COLYER, M.D.
JACKIE McCLASKEY, SECRETARY OF AGRICULTURE

9/13/2018

ROBERT D HAY, TRUST
9171 S WEST STREET
HAYSVILLE, KS 67060

RE: Application, File No. **50129**

Dear Sir or Madam:

The Division of Water Resources (Division) has received your application for a permit to appropriate water for beneficial use. Your application has been assigned the file number referenced above. Please be aware that the Division may have a large number of pending applications on hand at times and makes every attempt to process them in the order in which they are received. You will be contacted if additional information is required.

Please note, this letter only acknowledges receipt of your application and does not guarantee approval. In accordance with the provisions of the Kansas Water Appropriation Act, the use of water as proposed prior to approval of the application is unlawful.

Additional information about the process may be found on our website at agriculture.ks.gov/divisions-programs/dwr. If you have any other questions, please contact our office at 785-564-6640 or your local Stafford Field Office at 620-234-5311. If you call, please reference the file number so we can help you more efficiently.

Sincerely,

Kristen A. Baum
New Application Unit Supervisor
Division of Water Resources

DOMESTIC
WELLS / RESIDENCES WITHIN 1/4 MILE

HayRobertSec35T29S R2W

5 Sept 2018

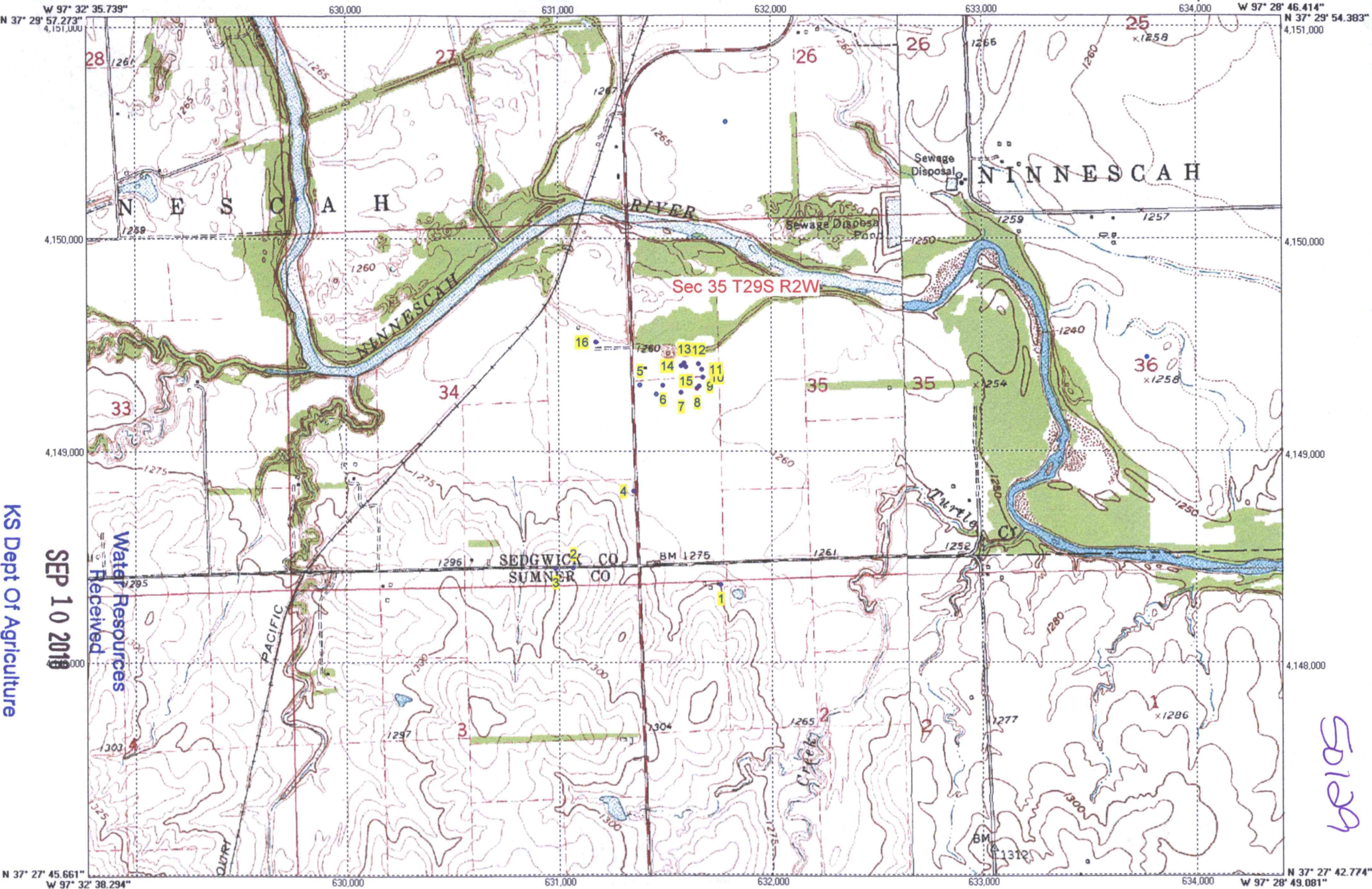

KS Dept Of Agriculture

SEP 10 2018

Water Resources
Received

50129

1927 North American Datum; 1,000-meter UTM grid zone 14
Generated by BigTopo (www.igage.com)
Map compiled from USGS Quads: Millerton; KS Zyba; KS

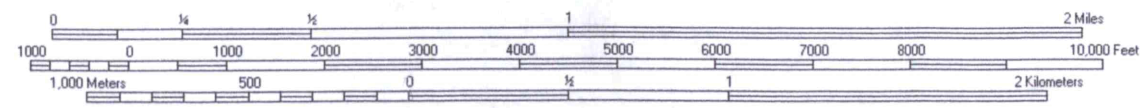

Robert D. Hay

50129

5 Sept 2018

Wells/Residences within ½ mile of the west ½ of the SW ¼ Section 35 T29S R2W

1	269 W. 119 th Street, Clearwater, Ks 67026	Blumenshine, Gale A. & Mary
2	15614 W. 119 th Street South, Clearwater, Ks 67026	Tjaden, Keith R & Jamie S
3	15660 W. 119 th Street South, Clearwater, Ks 67026	Berntsen, Donald W & Tamara M
4	11819 S. 151 st W, Clearwater, Ks 67026	Frischenmeyer, Pauline k & Sherri Gage
5	11560 S. 151 st W, Clearwater, Ks 67026	Koon, Greg A
6 (S)	15001 W. Deer Trail Circle, Clearwater, Ks 67026	Woolery, William L & Diedra H
6 (N)	14930 W. Deer Trail Circle, Clearwater, Ks 67026	Hecker, Joshua A & Kristi L
7	14914 W. Deer Trail Circle, Clearwater, Ks 67026	Christensen, Brian J
8	14900 W. Deer Trail Circle, Clearwater, Ks 67026	Joslin, Randy R & Lisa K
9	14801 W. Deer Trail Circle, Clearwater, Ks 67026	Perry, Alan & Shawna
10	14811 W. Deer Trail Circle, Clearwater, Ks 67026	Bond, Brent L & Gretchen E
11	14814 W. Deer Trail Circle, Clearwater, Ks 67026	Brockman, Sharla L
12	14819 W. Deer Trail Circle, Clearwater, Ks 67026	Burris, Lowell K
13	14829 W. Deer Trail Circle, Clearwater, Ks 67026	Chapa, Felix F & Jacklyn K
14	14847 W. Deer Trail Circle, Clearwater, Ks 67026	Bennett, Charles S & Gay L
15	14830 W. Deer Trail Circle, Clearwater, Ks 67026	Walsh, Michael B & Alyssa Lea
16 (E)	11512 S 151 st Street W, Clearwater, Ks 67026	Mc Coy, Charles L- ETUX
16 (W)	11459 S 151 st Street W, Clearwater, Ks 67026	Blumenshine, Richard A - ETUX

Water Resources
Received

SEP 10 2018

KS Dept Of Agriculture

PLACE OF Use

HayRobertSec35T29S R2W

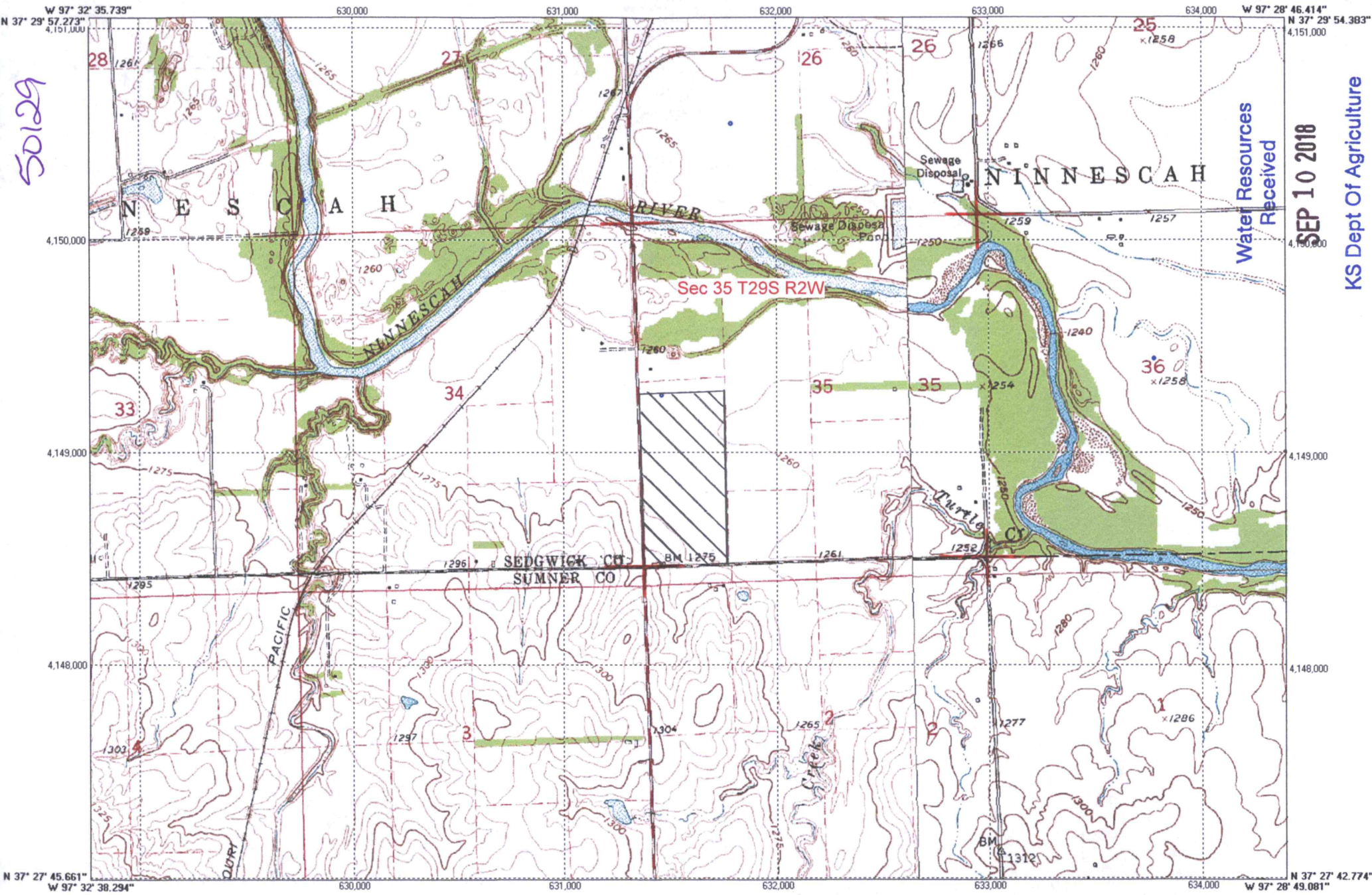

50129

Water Resources Received

SEP 10 2018

KS Dept Of Agriculture

1927 North American Datum; 1,000-meter UTM grid zone 14
Generated by BigTopo (www.igage.com)
Map compiled from USGS Quads: Millerton, KS Zyba, KS

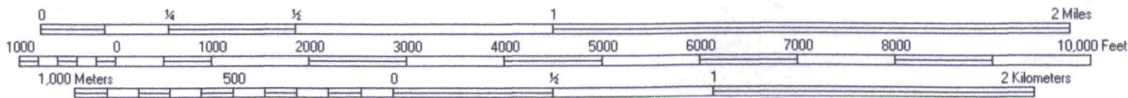

Robert D. Hay

SW 1/4 Sec 35 T29S R2W

PLACE OF USE

Legend

 37 28.535' N, 97 30.578' W

E Deer Trail Cir

S 151st St W

Water Resources
Received
SEP 10 2018
KS Dept Of Agriculture

S 135th Street South

 37 28.535' N, 97 30.578' W

West 119th St S
Google Earth

© 2018 Google

2000 ft

