

Kansas Department of Agriculture
 Division of Water Resources
CHANGE: P/U WORKSHEET

1. File Number: 46944	2. Status Change Date:	3. Change Num: 42*	4. Field Office: 02	5. GMD: 05
---------------------------------	------------------------	------------------------------	-------------------------------	----------------------

6. Status: <input checked="" type="checkbox"/> Approved <input type="checkbox"/> Denied by DWR/GMD <input type="checkbox"/> Dismiss by Request/Failure to Return	7. Filing Date of Change: 8/30/19
--	---

8a. Applicant(s) New to system <input type="checkbox"/> Person ID _____ Add Seq# _____	8c. Landowner(s) New to system <input type="checkbox"/> Person ID _____ Add Seq# _____
---	---

8b. Landowner(s) New to system <input type="checkbox"/> Person ID 7744 Add Seq# 1 HIRT FARMS INC ATTN: VERNON HIRT PRES 100082 SE 40TH AVE SAWYER, KS 67134-9560	8d. WUC New to system <input type="checkbox"/> Person ID 7744 Add Seq# 1 NO CHANGE
---	---

9. Documents and Enclosure(s): DWR Meter(s) Date to Comply: **12/31/19** N & P Date to Comply: _____

Anti-Reverse Meter
 Meter Seal
 Check Valve
 N & P Form
 Water Tube
 Driller Copy
 H & E Letter

Conservation Plan
 Date Required: _____
 Date Approved: **9/19/19**
 Date to Comply: _____

10. Use Made of Water From: _____ To: _____

Date Prepared: **9/18/19** By: **TJS**
 Date Entered: _____ By: _____

* TJS - SFFO

File No. **46944** 11. County: **PRATT** Basin: **Medicine Lodge River** Stream: --- Formation Code: **100** Special Use: ---

12. Points of Diversion										Rate and Quantity				
CHK										Authorized		Additional		
MOD										Rate	Quantity	Rate	Quantity	Overlap PD Files
DEL	PDIV	Qualifier	S	T	R	ID	'N	'W	Comment (AKA Line)	gpm/cfs	af/mgy	gpm/cfs	af/mgy	

MOD	76028	NE SW SE	15	29S	15W	2	1241*	1971*		No change to rate or quantity			None	
-----	-------	----------	----	-----	-----	---	-------	-------	--	-------------------------------	--	--	------	--

13. Storage: Rate _____ NF Quantity _____ ac/ft Additional Rate _____ NF Additional Quantity _____ ac/ft

14. Limitation: _____ af/yr at _____ gpm (_____ cfs) when combined with file number(s) _____
 Limitation: _____ af/yr at _____ gpm (_____ cfs) when combined with file number(s) _____

15. 5YR Allocation: Allocation Type _____ Start Year _____ 5 YR Amount _____ Amount Unit _____ Base Acres _____ Comment _____

16. Place of Use																		Total	Owner	Chg?	Overlap Files												
CHK										NE¼				NW¼				SW¼				SE¼											
MOD										NE	NW	SW	SE	NE	NW	SW	SE	NE	NW	SW	SE	NE	NW	SW	SE								
DEL	PUSE	S	T	R	ID	NE	NW	SW	SE	NE	NW	SW	SE	NE	NW	SW	SE	NE	NW	SW	SE												
MOD	59292	15	29S	15W	1									3.5								5.6								12	8b.	No	None

Base Acres: **11** Year: **Permit** Minimum Reasonable Quantity: **1.24 AF/acre (PR Co)**
 Comments: ***No change to pd, only modifying footages based on GPS data.**

Submit completed application to:
 Kansas Department of Agriculture
 Division of Water Resources
 Field Office for your area.
 Call for address:

Topeka -- (785) 296-5733
 Stafford -- (620) 234-5311
 Stockton -- (785) 425-6787
 Garden City -- (620) 276-2901
<http://agriculture.ks.gov/dwr>

DWR FIELD OFFICE APPLICATION FOR APPROVAL TO CHANGE THE PLACE OF USE AND/OR THE POINT OF DIVERSION



STATE OF KANSAS

WATER METER REQUIRED

Filing Fee Must Accompany the Application, K.S.A. 82a-708b(b), as amended.
 Fee Schedule is on the third page of this application form.

Paragraph Nos. 1, 2, 3 & 5 must be completed. Complete all other applicable portions. If change in point of diversion is greater than 100 feet, or if place of use will be changed, include a topographic map or detailed plat showing the authorized and proposed point(s) of diversion and/or place of use.

RECEIVED
 1:20 PM
 AUG 30 2019

File No. 46944

1. Application is hereby made for approval of the Chief Engineer to change the (check one or both):

Place of Use Point of Diversion

Stafford Field Office
 Division of Water Resources

under the water right which is the subject of this application in accordance with the conditions described below.

The source of supply is: Groundwater Surface water

2. Name and address of Applicant: Vernon Hirt
100082 SE 40th Ave, Sawyer KS 67134-9560
 Phone Number: (620)770-0553 Email address: vdhirt@yahoo.com
 Name and address of Water Use Correspondent: Hirt Farms Inc, Vernon Hirt Pres
100082 SE 40th Ave, Sawyer KS 67134-9560
 Phone Number: (620)770-0553 Email address: vdhirt@yahoo.com

3. The presently authorized place of use is:
 Owner of Land --- NAME: Hirt Farms Inc, Vernon Hirt Pres
 ADDRESS: 100082 SE 40th Ave, Sawyer KS 67134-9560
 (If there is more than one landowner, attach supplemental sheets as necessary.)

Sec.	Twp.	Range	NE¼				NW¼				SW¼				SE¼				TOTAL ACRES
			NE¼	NW¼	SW¼	SE¼	NE¼	NW¼	SW¼	SE¼	NE¼	NW¼	SW¼	SE¼	NE¼	NW¼	SW¼	SE¼	
15	29S	15W									2.5					4	4.5		11

4. If this application is for a change in place of use, it is proposed that the place of use be changed to:
 Owner of Land --- NAME: Hirt Farms Inc, Vernon Hirt Pres
 ADDRESS: 100082 SE 40th Ave, Sawyer KS 67134-9560
 (If there is more than one landowner, attach supplemental sheets as necessary.)

Sec.	Twp.	Range	NE¼				NW¼				SW¼				SE¼				TOTAL ACRES
			NE¼	NW¼	SW¼	SE¼	NE¼	NW¼	SW¼	SE¼	NE¼	NW¼	SW¼	SE¼	NE¼	NW¼	SW¼	SE¼	
15	29S	15W									3.5			5.6		2.7	0.2		12

For Office Use Only: Code _____ Fee \$ 200- TR # _____ Receipt Date _____ Check # 1489

5. **Presently authorized point of diversion:**
 One in the NE Quarter of the SW Quarter of the SE Quarter
 of Section 15, Township 29 South, Range 15 W,
 in Pratt County, Kansas, 1254 feet North 1966 feet West of Southeast corner of section.
 Authorized Rate 200 GPM Authorized Quantity 15 AF Depth of well 100 (feet)
(DWR use only: Computer ID No. 2 GPS 1241 feet North 1971 feet West)
 This point will not be changed This point will be changed as follows: No change, point better described with GPS as follows:
Proposed point of diversion: (Complete only if change is requested or if existing point is better described by GPS)
 One in the NE Quarter of the SW Quarter of the SE Quarter
 of Section 15, Township 29 South, Range 15 W,
 in Pratt County, Kansas, 1241 feet North 1971 feet West of Southeast corner of section.
 Proposed Rate No Change Proposed Quantity No Change Proposed well depth (feet) NA
 This point is: Additional Well Geo Center List other water rights that will use this point None

6. **Presently authorized point of diversion:**
 One in the _____ Quarter of the _____ Quarter of the _____ Quarter
 of Section _____, Township _____ South, Range _____ (E/W),
 in _____ County, Kansas, _____ feet North _____ feet West of Southeast corner of section.
 Authorized Rate _____ Authorized Quantity _____ Depth of well _____ (feet)
(DWR use only: Computer ID No. _____ GPS _____ feet North _____ feet West)
 This point will not be changed This point will be changed as follows: No change, point better described with GPS as follows:
Proposed point of diversion: (Complete only if change is requested or if existing point is better described by GPS)
 One in the _____ Quarter of the _____ Quarter of the _____ Quarter
 of Section _____, Township _____ South, Range _____ (E/W),
 in _____ County, Kansas, _____ feet North _____ feet West of Southeast corner of section.
 Proposed Rate _____ Proposed Quantity _____ Proposed well depth (feet) _____
 This point is: Additional Well Geo Center List other water rights that will use this point _____

7. The changes herein are desired for the following reasons?
 (please be specific) Modifying place of use to accommodate
a new pivot configuration. Do the old oil well located
in first place of use

8. If a well, is the test hole log attached? Yes No

9. The change(s) (was)(will be) completed by?
ASAP

10. If the point of diversion is a well:
 (a) What are you going to do with the old well?
NA
 (b) When will this be done? NA

11. Groundwater Management District recommendation
 attached? Yes No 9/17/2019 TJS-SFFO

12. Assisted by TJS - SFFO

13a. If the proposed point of diversion will be relocated more than
 300 feet but within 2,640 feet of the existing point of diversion,
 attach a topographic map or aerial photograph. For
 groundwater sources, show all wells (including domestic) within
 one-half mile of the proposed point of diversion and the names
 and mailing addresses of the owners. For surface water
 sources, show the names and addresses of the landowner(s)
 one-half mile downstream and one-half mile upstream from
 your property lines

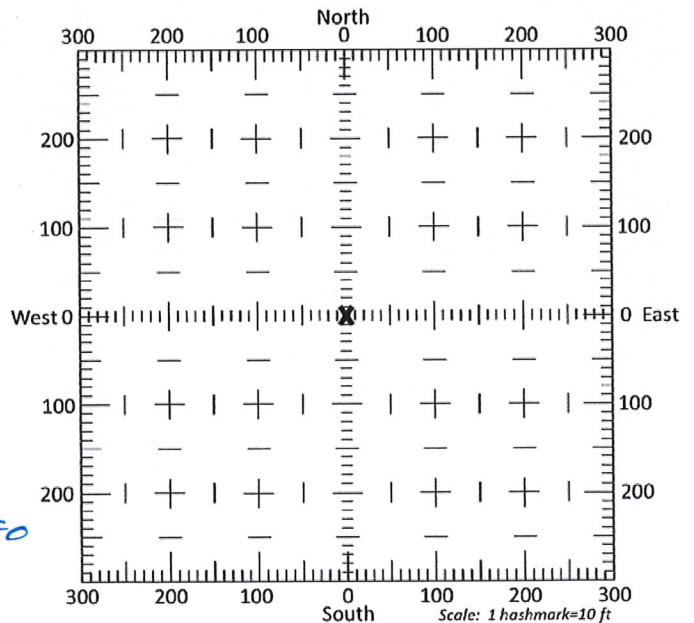

13b. If the proposed point of diversion will be relocated within 300
 feet of the existing point of diversion, indicate its location on
 the diagram shown above in relation to the existing point of
 diversion. (PLEASE NOTE: The "X" in center of diagram
 above represents the presently authorized point of
 diversion.)
 RECEIVED
 AUG 30 2019

Stafford Field Office
 Division of Water Resources

14. If the proposed groundwater point of diversion is 300 or fewer feet from the existing point of diversion, complete the following:
- (a) Does the undersigned represent all owners of the currently authorized place(s) of use identified in this application?
 Yes No (If no, all owners must sign this application.)
 - (b) Will the ownership interest of any owner of the currently authorized place(s) of use identified in this application be adversely affected if this application is approved as requested?
 Yes No (If yes, all owners must sign this application.)
 - (c) If this application is not approved expeditiously, will there be substantial damage to property, public health or safety?
 Yes No (If no, all owners must sign this application.)

If the application proposes a surface water change in point of diversion, a groundwater change in point of diversion greater than 300 feet, or a change in place of use, the application must be signed by all owners of the currently authorized place of use, or their duly authorized agent (attach notarized statement authorizing representation).

I hereby verify, being first duly sworn upon my oath or affirmation and under penalty of perjury, that I am of lawful age and the owner, the spouse of the owner, or a duly authorized agent of the owner(s) to make this application on their behalf, in regards to the water right(s) to which this application pertains. I further verify that the statements contained in this application are true, correct and complete.

Dated at Savage, Kan., Kansas, this 30 day of Aug, 2019.

Verona Hunt

 (Owner)

Donna Hunt

 (Spouse)

 (Please Print)

 (Please Print)

 (Owner)

 (Spouse)

 (Please Print)

 (Please Print)

 (Owner)

 (Spouse)

 (Please Print)

 (Please Print)

State of Kansas }
 County of Pratt } SS

I hereby certify that the foregoing application was signed in my presence and sworn to before me this 30 day of August, 2019.

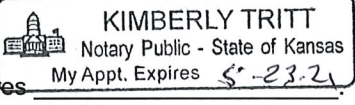
 KIMBERLY TRITT
 Notary Public - State of Kansas
 My Appt. Expires 5-23-21

K Tritt

 Notary Public

My Commission Expires _____

ONLY COMPLETE APPLICATIONS WILL BE PROCESSED. To be complete, all of the applicable portions of the application form must be completed with accurate information; maps, if necessary, must be included; signatures of all the appropriate owners' must be affixed to the application and notarized; and the appropriate fee must be paid.

FEE SCHEDULE

Each application to change the place of use or the point of diversion under this section shall be accompanied by the application fee set forth in the schedule below: Make checks payable to: **Kansas Department of Agriculture**

(1) Application to change a point of diversion 300 feet or less	\$100
(2) Application to change a point of diversion more than 300 feet	\$200
(3) Application to change the place of use	\$200

RECEIVED

AUG 30 2019

SUMMARY ORDER APPROVING APPLICATION FOR CHANGE AND IMPOSING CONDITIONS

This Summary Order is issued under authority of K.S.A. 82a-708b, as amended, and K.A.R. 5-5-1, *et seq.* and other applicable provisions of the *Kansas Water Appropriation Law, K.S.A. 82a-701 et. seq.*, and rules and regulations promulgated thereunder, With the exception of those conditions expressly contained herein, this Summary Order does not change the terms, conditions and limitations of File No. 46944.

1. A change application was received on August 30 2019 requesting that the place of use and / or point of diversion authorized under the above-referenced file number be changed as described in the application.
2. On and after the effective date of this summary order, the authorized place(s) of use shall be located substantially as shown on the topographic map accompanying the application to change the place of use. Applicable Not Applicable
3. The change in point of diversion shall not impair existing rights and shall be limited to the same source or sources of water as previously authorized. The point of diversion authorized by this summary order shall be located within a _____ foot radius of the authorized point(s) of diversion. Applicable Not Applicable
4. The point(s) of diversion described herein is administratively corrected to be more accurately described using the Global Positioning System (GPS), as described in the application. Applicable Not Applicable
5. The point(s) of diversion authorized herein shall not actually be located more than _____ feet from the previously authorized point(s) of diversion. Applicable Not Applicable
6. As required by K.A.R. 5-3-5d, if the works for diversion is a well with a diversion rate of 100 gallons per minute or more, a tube or other device suitable for making water level measurements shall be installed, operated and maintained in accordance with K.A.R. 5-6-13. Applicable Not Applicable
7. **The owner of the authorized place(s) of use shall properly install an acceptable water flow meter on or before December 31, 2019**, or before the first use of water, whichever occurs first. The water flow meter shall be installed, operated and maintained in accordance with K.A.R. 5-1-4 through 5-1-12. As required by K.S.A. 82a-732, as amended, and K.A.R. 5-3-5e, the owner shall maintain records and report the reading of the water flow meter and the total quantity of water diverted annually to the Chief Engineer by March 1 following the end of each calendar year.
 Applicable Not Applicable
8. **Installation of the works for diversion of water shall be completed on or before December 31, 20____**, or within any authorized extension of time. By March 1, 20____ the applicant shall notify the Chief Engineer that construction of the works for diversion has been completed, on the form provided by the Chief Engineer, as required by K.A.R. 5-8-4e.
 Applicable Not Applicable
9. **The completed well log shall be submitted with the required notice.** Applicable Not Applicable
10. All diversion works into which any type of chemical or other foreign substance will be injected into the water shall be equipped with an in-line, automatic, quick-closing check valve capable of preventing pollution of the source of the water supply. The check valve(s) shall be installed, operated and maintained in accordance with K.A.R. 5-3-5c. Applicable Not Applicable
11. Additional Conditions are attached. Yes No
12. In accordance with K.S.A. 82a-708a, as amended, and K.A.R. 5-5-14, all of the owners of the authorized place(s) of use of water appropriated under the above-referenced file number are responsible for compliance with its terms, conditions and limitations, as amended and/or supplemented by this Summary Order, and with applicable provisions of the *Kansas Water Appropriation Law* and the *Rules and Regulations* promulgated thereunder. Failure to comply with these provisions may result in civil penalties pursuant to K.S.A. 82a-737, as amended, and/or the suspension or revocation and dismissal of the water or appropriation right or any other enforcement actions authorized by law.

Administrative Appeal and Effective Date of Order

If you are aggrieved by this order, pursuant to K.S.A. 82a-1901, you may request an evidentiary hearing before the Chief Engineer or request administrative review by the Secretary of Agriculture. A request for hearing by the Chief Engineer must be filed within **15 days** of service of this Order and a request for administrative review by the Secretary must be filed within **30 days** pursuant to K.S.A. 77-531. Any request for administrative review must state a basis for review pursuant to K.S.A. 77-527. File any request with **Kansas Department of Agriculture, Legal Division, 1320 Research Park Drive, Manhattan, KS 66502**. Failure to timely request a hearing or review may preclude review under the Kansas Judicial Review Act.

For Use by Register of Deeds

RECEIVED

AUG 30 2019

Stafford Field Office
Division of Water Resources

FOR OFFICE USE ONLY
**APPLICATION APPROVED AND
SUMMARY ORDER ISSUED**

By: Cameron R. Conant
Duly Authorized Designee of the Chief Engineer

(Print Name): Cameron R. Conant
Division of Water Resources - Kansas Department of Agriculture

Date of Issuance: September 19, 2019

State of Kansas _____)

County of Stafford) SS

Acknowledged before me on 09/19/19

by Cameron Conant

Signature: Jessica Engelbrecht

My commission expires _____

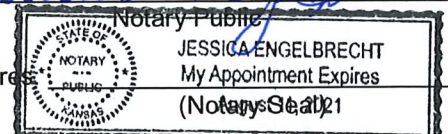

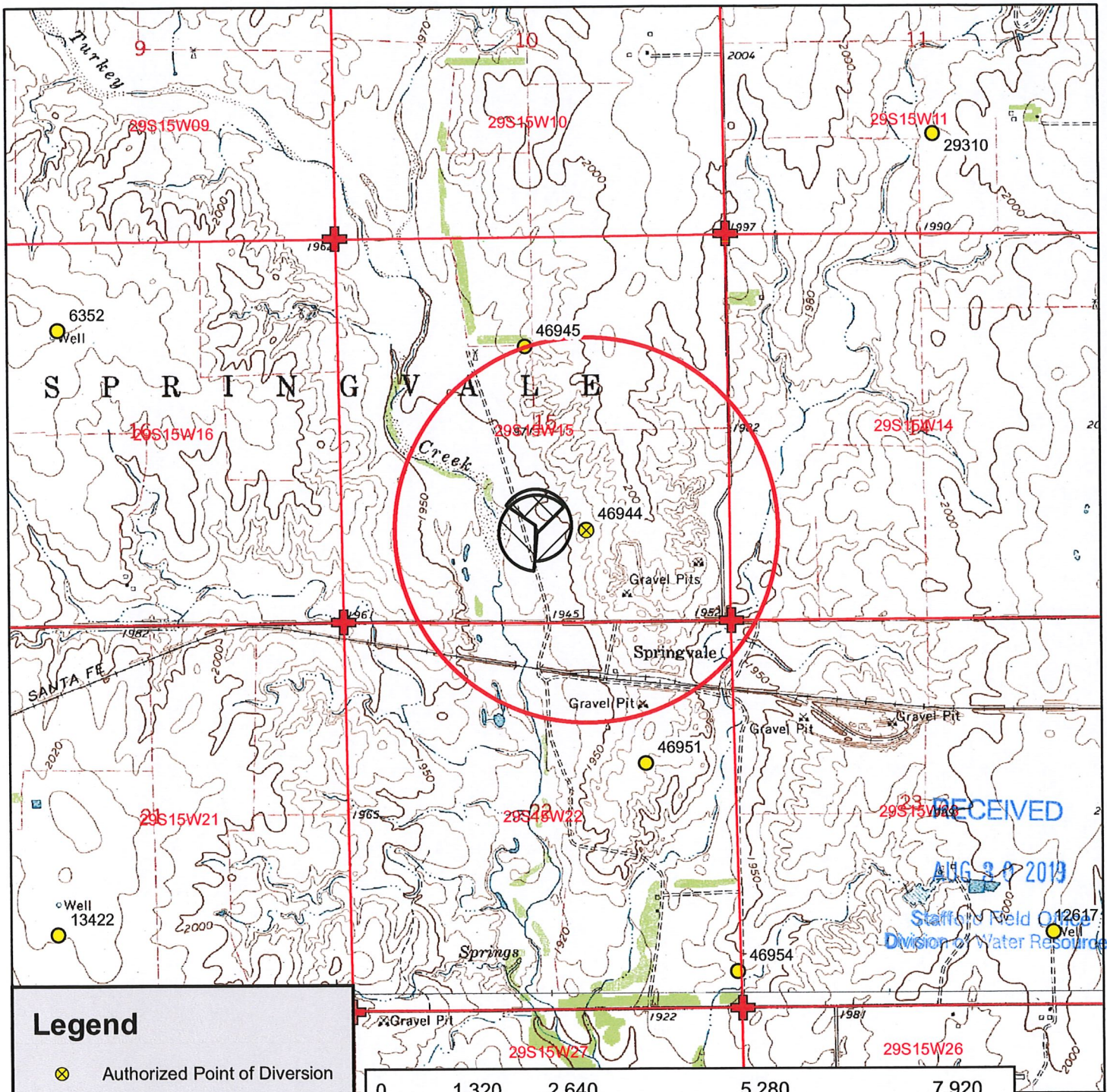

Legend

- Authorized Point of Diversion
- Water Appropriations
- 1/2 Mile Buffer
- Domestic Well
- Section Line
- Section Corner
- Place of Use**
- Authorized
- Proposed



Water Appropriation, File No. 46,944
 Change in Place of Use, Application Map
 15-29S-15W // Pratt County







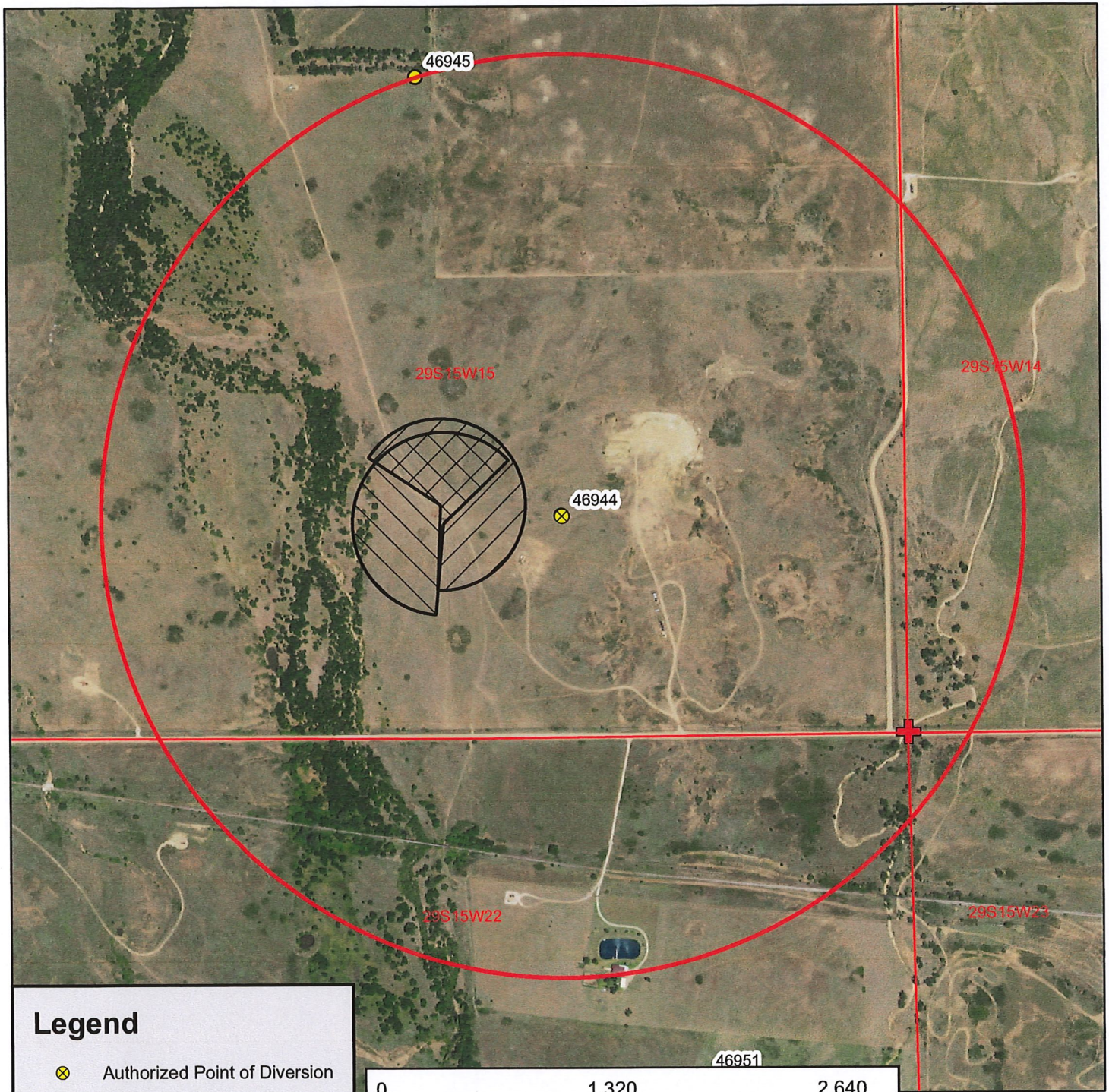

To the best of my knowledge, all water wells including domestic, within 1/2 mile of the authorized point of diversion have been shown.

Vernon Hill



Signature



Legend

-  Authorized Point of Diversion
-  Water Appropriations
-  1/2 Mile Buffer
-  Domestic Well
-  Section Line
-  Section Corner

Place of Use

-  Authorized
-  Proposed

Water Appropriation, File No. 46,944

Change in Place of Use, Aerial Map
 15-29S-15W // Pratt County

RECEIVED

AUG 30 2019

Stafford Field Office
 Division of Water Resources



Stafford Field Office
300 S. Main Street
Stafford, KS 67578-1521



Phone: 620-234-5311
Fax: 620-234-6900
www.agriculture.ks.gov

Mike Beam, Secretary

Laura Kelly, Governor

September 20, 2019

Hirt Farms Inc
Attn: Vernon Hirt Pres
100082 SE 40th Ave
Sawyer KS 67134-9560

Re: Water Right, File No(s). 46944

Dear Water Right Owner:

Enclosed is an order executed by the Chief Engineer, Division of Water Resources, Kansas Department of Agriculture, approving the application for change under the referenced file number(s).

Your attention is directed to the enclosures and to the terms, conditions and limitations specified in this approval for change. An acceptable water flow meter must be installed on your well before any water is applied as authorized under this change approval. A copy of the approved list of Certified Water Flowmeters as well as <http://agriculture.ks.gov/divisions-programs/dwr/water-appropriation/water-flowmeters>. If you do not have access to the internet, please contact this office and we will send you a paper copy of the referenced information.

Since this order modifies the original document referred to above, it should be recorded with the Register of Deeds as other instruments affecting real estate.

Should you have any questions, please feel free to contact this office. If you wish to refer to a specific file, please reference it when you contact us.

Sincerely,

A handwritten signature in black ink, appearing to read "Jeff Lanterman".

Jeff Lanterman
Water Commissioner

Enclosures

pc: Water Rights Section
Groundwater Management District No. 5

CERTIFICATE OF SERVICE

On this **20th** day of **September, 2019**, I hereby certify that the attached Change in Place of Use for Water Right, File No. **46944**, dated **September 19, 2019** was mailed via Certified U.S. mail to the following:

Hirt Farms Inc
Attn: Vernon Hirt Pres
100082 SE 40th Ave
Sawyer KS 67134-9560

A copy of the letter was sent to the following:

GMD 5



Staff



KANSAS DEPARTMENT OF AGRICULTURE

Division of Water Resources

Stafford Field Office

MEMORANDUM

TO: File

DATE: 9/3/2019

FROM: Tyler Saryerwinnie

RE: File No. 46,944

This is a memorandum regarding surrounding well owner notification on irrigation field office PU changes and pertains to decisions made during the Water Commissioner meeting which took place on 11/16/2016 with directive from Lane Letourneau Program Manager.

This is applicable to field office changes to increase the place of use by 10 acres or 10% (whichever is less) or a change in place of use to create a complete overlap in which no new acres are being irrigated.

During that meeting it was determined that no surrounding well owner notification will be sent under this type of Place of Use change. All well rates and quantities will remain unchanged and the referenced change will not cause impairment or impact surrounding well owners.

The change in place of use filed on **8/30/2019** for the above referenced file meets this criteria and surrounding well owners will not be notified.

Saryerwinnie, Tyler [KDA]

From: Saryerwinnie, Tyler [KDA]
Sent: Tuesday, September 03, 2019 11:19 AM
To: Orrin Feril (oferil@gmd5.org)
Cc: Conant, Cameron [KDA]
Subject: GMD Recommendation Request - File Nos. 46944 & 46945
Attachments: 46944.Change App Packet.pdf; 46945.Change App Packet.pdf

Orrin,

I have attached copies of two (2) place of use change applications for GMD recommendation. Please provide the GMD recommendation by no later than September 23, 2019.

Please let me know if you are needing anything else, or have any questions.

Thank you,
Tyler

Tyler Saryerwinnie, Environmental Scientist
Kansas Department of Agriculture
Division of Water Resources
Stafford Field Office
Phone: (620)234-5311

Stafford Field Office
300 S. Main Street
Stafford, KS 67578-1521



Phone: 620-234-5311
Fax: 620-234-6900
www.agriculture.ks.gov

Mike Beam, Secretary

Laura Kelly, Governor

September 3, 2019

Orrin Feril
Big Bend – GMD No. 5
125 S Main St.
Stafford, KS 67578

RE: Place of Use Change Application, File No. 46,944

Dear Mr. Feril,

We are enclosing a copy of the application, as referenced above, for your review and recommendation. At this time the application appears to be in proper form.

This office will delay any further action on this file for a period of 15 business days from the date of this letter to allow you time to submit your recommendation concerning the application. Please submit your recommendation within the allotted time, or any authorized extension of time thereof.

If you have any questions, please feel free to contact the office.

Sincerely,

A handwritten signature in blue ink, appearing to read "Tyler Saryerwinnie".

Tyler Saryerwinnie
Environmental Scientist
Stafford Field Office
tyler.saryerwinnie@ks.gov

Enclosure

Saryerwinnie, Tyler [KDA]

From: Orrin Feril <oferil@gmd5.org>
Sent: Tuesday, September 17, 2019 12:49 PM
To: Saryerwinnie, Tyler [KDA]
Subject: Application for Change, Water Right, File No. 46944
Attachments: 46944 2019-09-17 Rec.pdf

EXTERNAL: This email originated from outside of the organization. Do not click any links or open any attachments unless you trust the sender and know the content is safe.

Tyler,
I'm attaching the recommendation requested by your office in a letter dated September 03, 2019. Please let me know if you have any questions.

Thank you for your consideration in this matter,

Orrin

--

Orrin Feril

Manager

Big Bend GMD#5

Email: oferil@gmd5.org

Phone: (620) 234-5352

Mobile: (620) 388-0172

Fax: (620) 234-5718

www.gmd5.org

Facebook/Twitter: @BigBendGMD5

Darrell Wood - Edwards (Pres.)
Fred Grunder - Pratt (V Pres.)
John Janssen - Kiowa (Treas.)
Jerry Cullop - Rice (Sec.)
Justin Gatz - Reno
Marlyn Spare - Stafford
Phil Martin - Barton
Kerry Froetschner - Pawnee
Tom Taylor - At-Large



Orrin Feril, Manager
125 South Main Street
Stafford, Kansas 67578
ph: (620) 234-5352
fx: (620) 234-5718
gmd5@gmd5.org
www.gmd5.org

September 17, 2019

Tyler Saryerwinnie
Division of Water Resources
Kansas Department of Agriculture
300 S. Main Street
Stafford, Kansas 67578-1342

RE: Water Right File No. 46,944
Change in the Place of Use

Dear Mr. Saryerwinnie,

Big Bend Groundwater Management District #5 has reviewed the above referenced application. The applicant is requesting to modify the place of use accommodate the current center pivot system. Based on the information received in the office, the application appears to be consistent with K.A.R. 5-25-20(b) and is recommended for approval.

The application to change is subject to the District's well equipment regulation K.A.R. 5-25-5 for a required flow meter.

Please feel free to give me a call if you have any questions.

Sincerely,

Orrin Feril
Manager

RECEIVED

SEP 17 2019

Stafford Field Office
Division of Water Resources