

NOTICE

This scan only represents the application as filed. The information contained herein meets the requirements of K.A.R. 5-3-1 or K.A.R. 5-5-1, and has been found acceptable for filing in the office of the Chief Engineer. The application should not be considered to be a complete application as per K.A.R. 5-3-1b or K.A.R. 5-5-2a.

Kansas Department of Agriculture
 Division of Water Resources
CHANGE: P/D WORKSHEET

1. File Number: 14607	2. Status Change Date:	3. Change Num: C2	4. Field Office: 02	5. GMD:
---------------------------------	------------------------	-----------------------------	-------------------------------	---------

6. Status: <input checked="" type="checkbox"/> Approved <input type="checkbox"/> Denied by DWR/GMD <input type="checkbox"/> Dismiss by Request/Failure to Return	7. Filing Date of Change: 1/7/20
------------------------------------------------------------------------------------------------------------------------------------------------------------------	--------------------------------------------

8a. Applicant(s) Person ID _____
 New to system Add Seq# _____

8c. Landowner(s) Person ID _____
 New to system Add Seq# _____

8b. Landowner(s) Person ID **64959**
 New to system Add Seq# **1**

**KANSAS FARMS LLC
 ATTN: FARMERS NAT CO KEN SPRINGER
 FARM #17553
 8918 W 21ST N STE 200
 WICHITA, KS 67205-1880**

8d. WUC Person ID **58050**
 New to system Add Seq# **1**

**FARMERS NATIONAL COMPANY
 ATTN: CHRIS OSTEMEYER
 PO BOX 40
 KECHI, KS 67067**

9. Documents and Enclosure(s): DWR Meter(s) Date to Comply: 12/31/20 N & P Date to Comply: 12/31/20

Anti-Reverse Meter Meter Seal Check Valve N & P Form Water Tube Driller Copy H & E Letter

Conservation Plan Date Required: _____ Date Approved: 2/17/20 Date to Comply: _____

10. Use Made of Water From: _____ To: _____

Date Prepared: **2/13/20** By: **TJS**
 Date Entered: _____ By: _____

SCANNED

File No. **14607** 11. County: **SEDGWICK** Basin: **Arkansas River** Stream: --- Formation Code: **100 (Quaternary System)** Special Use: ---

12. Points of Diversion										Rate and Quantity							
CHK	MOD	DEL	ENT	PDIV	Qualifier	S	T	R	ID	'N	'W	Comment (AKA Line)	Rate gpm/cfs	Quantity af/mgy	Rate gpm/cfs	Quantity af/mgy	Overlap PD Files
MOD	21162	SW SW SW			26 29S 1E				6	554	5574		No change to rate or quantity		None		
DEL	34725								7						None		
ENT	71383	NC SW			26 29S 1E				11	1370	4109		No change to rate or quantity		34603		

13. Storage: Rate _____ NF Quantity _____ ac/ft Additional Rate _____ NF Additional Quantity _____ ac/ft

14. Limitation: _____ af/yr at _____ gpm (_____ cfs) when combined with file number(s) _____
 Limitation: _____ af/yr at _____ gpm (_____ cfs) when combined with file number(s) _____

15. 5YR Allocation: Allocation Type _____ Start Year _____ 5 YR Amount _____ Amount Unit _____ Base Acres _____ Comment _____

16. Place of Use										NE¼								NW¼				SW¼				SE¼				Total	Owner	Chg?	Overlap Files
CHK	MOD	DEL	ENT	PUSE	S	T	R	ID		NE ¼	NW ¼	SW ¼	SE ¼	NE ¼	NW ¼	SW ¼	SE ¼	NE ¼	NW ¼	SW ¼	SE ¼	NE ¼	NW ¼	SW ¼	SE ¼								
CHK	36519							5																				8b.	No	34603			

Base Acres: --- Year: --- Minimum Reasonable Quantity: ---
 Comments: **Only modifying Pdiv 21162 to better describe footages using GPS values.**

Submit completed application to:
 Kansas Department of Agriculture
 Division of Water Resources
 Field Office for your area.
 Call for address:

Topeka -- (785) 296-5733
 Stafford -- (620) 234-5311
 Stockton -- (785) 425-6787
 Garden City -- (620) 276-2901
<http://agriculture.ks.gov/dwr>

DWR FIELD OFFICE APPLICATION FOR APPROVAL TO CHANGE THE PLACE OF USE AND/OR THE POINT OF DIVERSION WATER METER REQUIRED



STATE OF KANSAS

Filing Fee Must Accompany the Application, K.S.A. 82a-708b(b), as amended.
 Fee Schedule is on the third page of this application form.

Paragraph Nos. 1, 2, 3 & 5 must be completed. Complete all other applicable portions. If change in point of diversion is greater than 100 feet, or if place of use will be changed, include a topographic map or detailed plot showing the authorized and proposed point(s) of diversion and/or place of use.

File No. 14607

RECEIVED
 8:35
 JAN 07 2020

RECEIVED
 UDC Acceptable for
 Priority
 Stafford Field Office
 DIVISION OF WATER RESOURCES

1. Application is hereby made for approval of the Chief Engineer to change the (check one or both):
 Place of Use Point of Diversion

under the water right which is the subject of this application in accordance with the conditions described below.
 The source of supply is: Groundwater Surface water

2. Name and address of Applicant: Chris Ostmeyer, Farmers National Company
PO Box 40, Kechi KS 67067
 Phone Number: (316)788-4240 Email address: COstmeyer@farmersnational.com
 Name and address of Water Use Correspondent: Farmers National Company, Chris Ostmeyer
PO Box 40, Kechi KS 67067
 Phone Number: (316)788-4240 Email address: COstmeyer@farmersnational.com

3. The presently authorized place of use is:
 Owner of Land --- NAME: Kansas Farms LLC
 ADDRESS: Farmers Nat Co Ken Springer Farm #17553, 8918 W 21st St N, Ste 200, Wichita KS 67205-1880
 (If there is more than one landowner, attach supplemental sheets as necessary.)

Sec.	Twp.	Range	NE¼				NW¼				SW¼				SE¼				TOTAL ACRES
			NE¼	NW¼	SW¼	SE¼	NE¼	NW¼	SW¼	SE¼	NE¼	NW¼	SW¼	SE¼	NE¼	NW¼	SW¼	SE¼	
26	29S	1E									39	40	40	39					158

4. If this application is for a change in place of use, it is proposed that the place of use be changed to:
 Owner of Land --- NAME: No Change
 ADDRESS: _____
 (If there is more than one landowner, attach supplemental sheets as necessary.)

Sec.	Twp.	Range	NE¼				NW¼				SW¼				SE¼				TOTAL ACRES
			NE¼	NW¼	SW¼	SE¼	NE¼	NW¼	SW¼	SE¼	NE¼	NW¼	SW¼	SE¼	NE¼	NW¼	SW¼	SE¼	

For Office Use Only: Code _____ Fee \$ _____ TR # _____ Receipt Date _____ Check # _____

5. **Presently authorized point of diversion:**
 One in the SW Quarter of the SW Quarter of the SW Quarter of Section 26, Township 29 South, Range 1 E, in Sedgwick County, Kansas, 600 feet North 5220 feet West of Southeast corner of section.
 Authorized Rate 765 GPM Authorized Quantity 65 AF Depth of well _____ (feet)
(DWR use only: Computer ID No. 6 GPS 554 feet North 5574 feet West)
 This point will not be changed This point will be changed as follows: No change, point better described with GPS as follows:
Proposed point of diversion: (Complete only if change is requested or if existing point is better described by GPS)
 One in the SW Quarter of the SW Quarter of the SW Quarter of Section 26, Township 29 South, Range 1 E, in Sedgwick County, Kansas, 554 feet North 5574 feet West of Southeast corner of section.
 Proposed Rate No Change Proposed Quantity No Change Proposed well depth (feet) NA
 This point is: Additional Well Geo Center List other water rights that will use this point None

6. **Presently authorized point of diversion:**
 One in the _____ Quarter of the _____ Quarter of the CV NW SW Quarter of Section 26, Township 29 South, Range 1 E, in Sedgwick County, Kansas, 1910 feet North 5260 feet West of Southeast corner of section.
 Authorized Rate 1150 GPM Authorized Quantity 102 AF Depth of well 52 (feet)
(DWR use only: Computer ID No. 7 GPS 1872 feet North 5571 feet West)
 This point will not be changed This point will be changed as follows: No change, point better described with GPS as follows:
Proposed point of diversion: (Complete only if change is requested or if existing point is better described by GPS)
 One in the _____ Quarter of the _____ Quarter of the NC SW Quarter of Section 26, Township 29 South, Range 1 E, in Sedgwick County, Kansas, 1370 feet North 4109 feet West of Southeast corner of section.
 Proposed Rate No Change Proposed Quantity No Change Proposed well depth (feet) 50 (existing well)
 This point is: Additional Well Geo Center List other water rights that will use this point 34603

7. The changes herein are desired for the following reasons?
 (please be specific) Moving the "North" pd to overlap the existing well that is currently authorized by File No. 34603.

8. If a well, is the test hole log attached? Yes No
 9. The change(s) (was)(will be) completed by?
Unnn Anrrval

10. If the point of diversion is a well:
 (a) What are you going to do with the old well?
Cap it at this time will not plug or use.
 (b) When will this be done? _____

11. Groundwater Management District recommendation attached? Yes No

12. Assisted by TJS - SFFO

13a. If the proposed point of diversion will be relocated more than 300 feet but within 2,640 feet of the existing point of diversion, attach a topographic map or aerial photograph. For groundwater sources, show all wells (including domestic) within one-half mile of the proposed point of diversion and the names and mailing addresses of the owners. For surface water sources, show the names and addresses of the landowner(s) one-half mile downstream and one-half mile upstream from your property lines

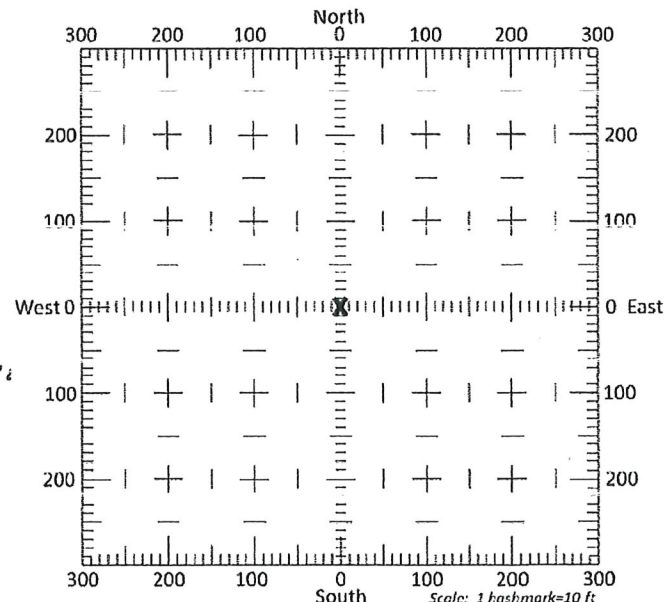

13b. If the proposed point of diversion will be relocated within 300 feet of the existing point of diversion, indicate its location on the diagram shown above in relation to the existing point of diversion. (PLEASE NOTE: The "X" in center of diagram above represents the presently authorized point of diversion.)

RECEIVED
 JAN 07 2020

14. If the proposed groundwater point of diversion is 300 or fewer feet from the existing point of diversion, complete the following:
- (a) Does the undersigned represent all owners of the currently authorized place(s) of use identified in this application?
 Yes No (If no, all owners must sign this application.)
 - (b) Will the ownership interest of any owner of the currently authorized place(s) of use identified in this application be adversely affected if this application is approved as requested?
 Yes No (If yes, all owners must sign this application.)
 - (c) If this application is not approved expeditiously, will there be substantial damage to property, public health or safety?
 Yes No (If no, all owners must sign this application.)

If the application proposes a surface water change in point of diversion, a groundwater change in point of diversion greater than 300 feet, or a change in place of use, the application must be signed by all owners of the currently authorized place of use, or their duly authorized agent (attach notarized statement authorizing representation).

I hereby verify, being first duly sworn upon my oath or affirmation and under penalty of perjury, that I am of lawful age and the owner, the spouse of the owner, or a duly authorized agent of the owner(s) to make this application on their behalf, in regards to the water right(s) to which this application pertains. I further verify that the statements contained in this application are true, correct and complete.

Dated at Andover, Kansas, this 20th day of November, 2019.

<u>Kansas Farms LLC by [Signature] for</u> (Owner)	_____ (Spouse)
<u>Farmers National Co. Agent</u> (Please Print)	_____ (Please Print)
_____ (Owner)	_____ (Spouse)
_____ (Please Print)	_____ (Please Print)
_____ (Owner)	_____ (Spouse)
_____ (Please Print)	_____ (Please Print)

State of Kansas
 County of Sedgwick } SS

I hereby certify that the foregoing application was signed in my presence and sworn to before me this 20 day of Nov, 2019.



Tammy Hamman
 Notary Public - State of Kansas
 My Appt. Expires 6/30/20

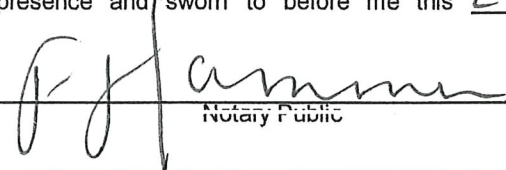

 Notary Public

My Commission Expires _____.

ONLY COMPLETE APPLICATIONS WILL BE PROCESSED. To be complete, all of the applicable portions of the application form must be completed with accurate information; maps, if necessary, must be included; signatures of all the appropriate owners' must be affixed to the application and notarized; and the appropriate fee must be paid.

FEE SCHEDULE

Each application to change the place of use or the point of diversion under this section shall be accompanied by the application fee set forth in the schedule below: Make checks payable to: **Kansas Department of Agriculture**

(1) Application to change a point of diversion 300 feet or less	\$100
(2) Application to change a point of diversion more than 300 feet	\$200
(3) Application to change the place of use	\$200

RECEIVED
 JAN 07 2020

RECEIVED
 Unacceptable for
 Priority
 DEC 30 2019

SCANNED

SUMMARY ORDER APPROVING APPLICATION FOR CHANGE AND IMPOSING CONDITIONS

This Summary Order is issued under authority of K.S.A. 82a-708b, as amended, and K.A.R. 5-5-1, *et seq.* and other applicable provisions of the *Kansas Water Appropriation Law, K.S.A. 82a-701 et seq.*, and rules and regulations promulgated thereunder, With the exception of those conditions expressly contained herein, this Summary Order does not change the terms, conditions and limitations of File No. 14607.

1. A change application was received on Jan. 7, 2020 requesting that the place of use and / or point of diversion authorized under the above-referenced file number be changed as described in the application.
2. On and after the effective date of this summary order, the authorized place(s) of use shall be located substantially as shown on the topographic map accompanying the application to change the place of use. Applicable Not Applicable
3. The change in point of diversion shall not impair existing rights and shall be limited to the same source or sources of water as previously authorized. The point of diversion authorized by this summary order shall be located within a 300 foot radius of the authorized point(s) of diversion. Applicable Not Applicable
4. The point(s) of diversion described herein is administratively corrected to be more accurately described using the Global Positioning System (GPS), as described in the application. Applicable Not Applicable
5. The point(s) of diversion authorized herein shall not actually be located more than 1846 feet from the previously authorized point(s) of diversion. Applicable Not Applicable
6. As required by K.A.R. 5-3-5d, if the works for diversion is a well with a diversion rate of 100 gallons per minute or more, a tube or other device suitable for making water level measurements shall be installed, operated and maintained in accordance with K.A.R. 5-6-13. Applicable Not Applicable
7. **The owner of the authorized place(s) of use shall properly install an acceptable water flow meter on or before December 31, 2020** or before the first use of water, whichever occurs first. The water flow meter shall be installed, operated and maintained in accordance with K.A.R. 5-1-4 through 5-1-12. As required by K.S.A. 82a-732, as amended, and K.A.R. 5-3-5e, the owner shall maintain records and report the reading of the water flow meter and the total quantity of water diverted annually to the Chief Engineer by March 1 following the end of each calendar year. Applicable Not Applicable
8. **Installation of the works for diversion of water shall be completed on or before December 31, 2020**,* or within any authorized extension of time. By March 1, 2021, the applicant shall notify the Chief Engineer that construction of the works for diversion has been completed, on the form provided by the Chief Engineer, as required by K.A.R. 5-8-4e. Applicable Not Applicable
9. **The completed well log shall be submitted with the required notice.** Applicable Not Applicable
10. All diversion works into which any type of chemical or other foreign substance will be injected into the water shall be equipped with an in-line, automatic, quick-closing check valve capable of preventing pollution of the source of the water supply. The check valve(s) shall be installed, operated and maintained in accordance with K.A.R. 5-3-5c. Applicable Not Applicable
11. Additional Conditions are attached. Yes No
12. In accordance with K.S.A. 82a-709a, as amended, and K.A.R. 5-5-14, all of the owners of the authorized place(s) of use of water appropriated under the above-referenced file number are responsible for compliance with its terms, conditions and limitations, as amended and/or supplemented by this Summary Order, and with applicable provisions of the *Kansas Water Appropriation Law* and the *Rules and Regulations* promulgated thereunder. Failure to comply with these provisions may result in civil penalties pursuant to K.S.A. 82a-737, as amended, and/or the suspension or revocation and dismissal of the water or appropriation right or any other enforcement actions authorized by law.

Administrative Appeal and Effective Date of Order

If you are aggrieved by this order, pursuant to K.S.A. 82a-1901, you may request an evidentiary hearing before the Chief Engineer or request administrative review by the Secretary of Agriculture. A request for hearing by the Chief Engineer must be filed within **15 days** of service of this Order and a request for administrative review by the Secretary must be filed within **30 days** pursuant to K.S.A. 77-531. Any request for administrative review must state a basis for review pursuant to K.S.A. 77-527. File any request with **Kansas Department of Agriculture, Legal Division, 1320 Research Park Drive, Manhattan, KS 66502**. Failure to timely request a hearing or review may preclude review under the Kansas Judicial Review Act.

For Use by Register of Deeds
RECEIVED

JAN 07 2020

Stafford Field Office
Division of Water Resources

RECEIVED
Unacceptable for
DE Priority 19

Stafford Field Office
DIVISION OF WATER RESOURCES

FOR OFFICE USE ONLY
**APPLICATION APPROVED AND
SUMMARY ORDER ISSUED**

By: Cameron R. Conant
Duly Authorized Designee of the Chief Engineer
(Print Name): Cameron R. Conant
Division of Water Resources - Kansas Department of Agriculture
Date of issuance: February 17, 2020
State of Kansas)
County of Stafford) SS
Acknowledged before me on February 17, 2020
by Faith Curtis
Signature: Faith Curtis
Notary Public

My commission expires:

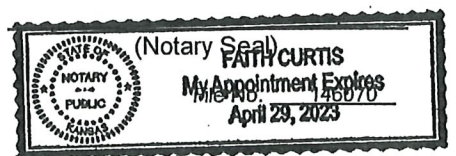

SCANNED

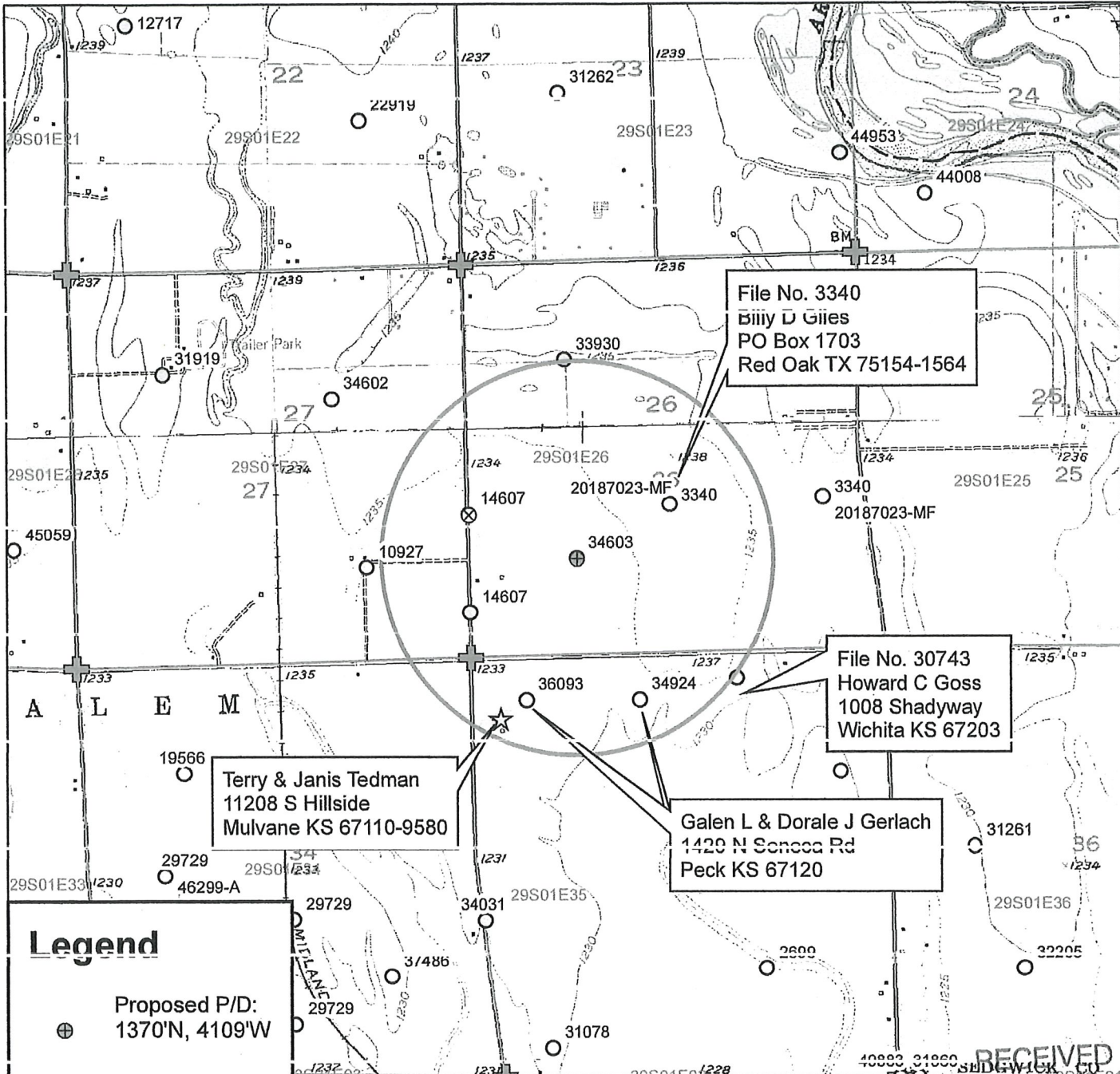

File No. 3340
 Billy D Giles
 PO Box 1703
 Red Oak TX 75154-1564

File No. 30743
 Howard C Goss
 1008 Shadyway
 Wichita KS 67203

Terry & Janis Tedman
 11208 S Hillside
 Mulvane KS 67110-9580

Galen L & Dorale J Gerlach
 1420 N Seneca Rd
 Peck KS 67120

Legend

- ⊕ Proposed P/D:
1370'N, 4109'W
- ⊗ Authorized P/D:
1872'N, 5571'W
- Water Appropriations
- ⊕ Section Corner
- ▭ Section Line
- ☆ Domestic Well
- ◻ 1/2 Mile Buffer



Water Right, File No. 14607
 Change in Point of Diversion Application Map
 26-29S-1E // Sedgwick County

To the best of my knowledge, all water wells including domestic, within 1/2 mile of the proposed point of diversion have been shown.

Kansas Farms LLC by Sr Farmers National Co Agent

Signature

3/1/2019 TJS-SFFO 1:24,000 scale

RECEIVED
 SEDGWICK CO
 JAN 07 2020
 Stanford Field Office
 Division of Water Resources
 RECEIVED
 Unacceptable for
 DEC 30 2019
 Priority
 Stanford Field Office
 DIVISION OF WATER RESOURCE

SCANNED



Stafford Field Office
300 S. Main Street
Stafford, Kansas 67578-1521

phone: (620) 234-5311
fax: (620) 234-6900
www.ksda.gov/dwr

Dale A. Rodman, Secretary
David W. Barfield, Chief Engineer
Jeff Lanterman, Water Commissioner

Sam Brownback, Governor

February 18, 2020

Chris Ostmeyer
Farmers National Company
PO Box 40
Kechi, KS 67067

Re: Water Right, File No(s). 14607

Dear Water Right Owner:

Enclosed is the order executed by the Chief Engineer, Division of Water Resources, Kansas Department of Agriculture, approving the application for change under the above referenced file number(s).

Your attention is directed to the enclosures and to the terms, conditions and limitations specified in this approval for change. An acceptable water flow meter must be installed on your well before any water is applied as authorized under this change approval. A copy of the approved list of Certified Water Flowmeters as well as the regulations regarding the installation of flowmeters, measurement tubes and check valves can be found at www.ksda.gov/includes/document_center/dwr/Forms/ApprovalPack.pdf. If you do not have access to the internet, please contact this office and we will send you a paper copy of the referenced information.

Since this order modifies the original document referred to above, it should be recorded with the Register of Deeds as other instruments affecting real estate.

Any abandoned well must be plugged in accordance with the requirements of Article 30 of the Rules and Regulations as adopted by the Kansas Department of Health and Environment.

Should you have any questions, please feel free to contact this office. If you wish to refer to a specific file, please reference it when you contact us.

Sincerely,

Jeff Lanterman
Water Commissioner

Enclosures

pc: Water Rights Section

SCANNED

CERTIFICATE OF SERVICE

On this **18 February 2020**, I hereby certify that the attached Change in Point of Diversion, File No. 14607 dated February 17th, 2020 was mailed to the following:

Chris Ostmeyer
Farmers National Company
PO Box 40
Kechi, KS 67067

pc: Water Rights Section

Faith Curtis

Staff

SCANNED

Saryerwinnie, Tyler [KDA]

From: Saryerwinnie, Tyler [KDA]
Sent: Monday, December 30, 2019 11:27 AM
To: COstmeyer@farmersnational.com
Subject: RE: Kansas Farms LLC

Mr. Ostmeyer,

On December 30, 2019, an application for approval to change the point of diversion under Water Right, File No. 14,607 was received in our office. The application was not accompanied with any type of fee and is, therefore, not acceptable for priority at this time.

As we discussed on the phone, we can hold the signed application until the fee is returned to the Stafford Field Office:

Kansas Department of Agriculture
Division of Water Resources – Stafford Field Office
300 S Main St
Stafford KS 67578

The fee for filing the application is \$200 and can be paid by a check made out to the Kansas Department of Agriculture for the total amount. If you have any questions, please let me know.

Tyler Saryerwinnie, Environmental Scientist

From: COstmeyer@farmersnational.com [mailto:COstmeyer@farmersnational.com]
Sent: Thursday, December 26, 2019 2:46 PM
To: Saryerwinnie, Tyler [KDA] <Tyler.Saryerwinnie@ks.gov>
Subject: Kansas Farms LLC

EXTERNAL: This email originated from outside of the organization. Do not click any links or open any attachments unless you trust the sender and know the content is safe.

Tyler,

I'm finally sending in the documents to for the change on Kansas Farms LLC water right 14607

I'll get them in the mail tomorrow. Just thought I would let you know I'm sending them.

Thanks,

Chris Ostmeyer
Farm Manager and Real Estate Sales
P.O. Box 40
Kechi, KS 67067
Cell: 785-672-8672
Office: 316-788-4240
Fax: 316-788-4935
<http://www.farmersnational.com>

SCANNED

This email and any files transmitted with it are confidential and intended solely for the use of the individual or entity to whom they are addressed. If you have received this email in error please notify the system manager. Please note that any views or opinions presented in this email are solely those of the author and do not necessarily represent those of the Farmers National Company. Finally, the recipient should check this email and any attachments for the presence of viruses. Farmers National Company accepts no liability for any damage caused by any virus transmitted by this email..
