

NOTICE

This scan only represents the application as filed. The information contained herein meets the requirements of K.A.R. 5-3-1 or K.A.R. 5-5-1, and has been found acceptable for filing in the office of the Chief Engineer. The application should not be considered to be a complete application as per K.A.R. 5-3-1b or K.A.R. 5-5-2a.

Submit To: CHIEF ENGINEER
Division of Water Resources
Kansas Department of Agriculture
1320 Research Park Drive
Manhattan, Kansas 66502
http://agriculture.ks.gov/dwr

**APPLICATION FOR APPROVAL TO
CHANGE THE PLACE OF USE, THE
POINT OF DIVERSION OR THE USE
MADE OF THE WATER UNDER AN
EXISTING WATER RIGHT**



State of Kansas

Filing Fee Must Accompany the Application
(Please refer to Fee Schedule on signature page of application form.)

Paragraph Nos. 1, 2, 3, 4 & 8 must be completed. Complete all other applicable portions. A topographic map or detailed plat showing the authorized and proposed points(s) of diversion and /or place of use must accompany this application.

Water Resources
Received

MAR 04 2020
10:57

KS Dept Of Agriculture

1. Application is hereby made for approval of the Chief Engineer to change the

- Place of Use
 Point of Diversion
 Use Made of Water

(Check one or more)

File No. 44661

2. Name of applicant: Cornejo & Sons LLC

Address: 2060 E Tulsa, PO Box 16204

City, State and Zip: Wichita KS 67216

Phone Number: (316)303-6733 E-mail address: _____

What is your relationship to the water right; owner tenant agent other? If other, please explain. _____

Name of water use correspondent: Cornejo & Sons LLC

Address: 2060 E Tulsa, PO Box 16204

City, State and Zip: Wichita KS 67216

Phone Number: (316) 303-6733 E-mail address: _____

3. The change(s) proposed herein are desired for the following reasons (please be specific): To modify the authorized place of use and geographic center of the sand and gravel pit.

The change(s) will be completed by _____ (Date)

For Office Use Only:						
F.O. <u>2</u>	GMD <u>-</u>	Meets K.A.R. 5-5-1 (YES/NO) <u>(YES)</u>	Use <u>IND</u>	Source <u>G/S</u>	County <u>CL</u>	By <u>KSN</u> Date <u>3/4/20</u>
Code <u>CLT, CPU</u>	Fee \$ <u>300</u>	TR # _____	Receipt Date <u>3/4/20</u>	Check # <u>2058324</u>		

3/17/2020
LMoody

4. The presently authorized place of use is:

Owner of Land — NAME: Cornejo & Sons LLC

ADDRESS: 2060 E Tulsa, PO Box 16204, Wichita KS 67216

Sec.	Twp.	Range	NE¼				NW¼				SW¼				SE¼				TOTAL ACRES
			NE¼	NW¼	SW¼	SE¼	NE¼	NW¼	SW¼	SE¼	NE¼	NW¼	SW¼	SE¼	NE¼	NW¼	SW¼	SE¼	
6	32	3E	A sand and gravel pit with a maximum size of 215 acres																

List any other water rights that cover this place of use. 41346 (incomplete overlap)

Owner of Land — NAME: _____

ADDRESS: _____

Sec.	Twp.	Range	NE¼				NW¼				SW¼				SE¼				TOTAL ACRES
			NE¼	NW¼	SW¼	SE¼	NE¼	NW¼	SW¼	SE¼	NE¼	NW¼	SW¼	SE¼	NE¼	NW¼	SW¼	SE¼	

List any other water rights that cover this place of use. _____

(If there are more than two landowners, attach additional sheets as necessary.)

Water Resources
Received

MAR 04 2020

5. It is proposed that the place of use be changed to:

Owner of Land — NAME: Cornejo & Sons LLC

ADDRESS: 2060 E Tulsa, PO Box 16204, Wichita KS 67216

KS Dept Of Agriculture

Sec.	Twp.	Range	NE¼				NW¼				SW¼				SE¼				TOTAL ACRES
			NE¼	NW¼	SW¼	SE¼	NE¼	NW¼	SW¼	SE¼	NE¼	NW¼	SW¼	SE¼	NE¼	NW¼	SW¼	SE¼	
6	32	3E	A sand and gravel pit with a maximum size of 215 acres located in the West Half and the West Half of the East Half																

List any other water rights that cover this place of use. 41346 (incomplete overlap)

Owner of Land — NAME: _____

ADDRESS: _____

Sec.	Twp.	Range	NE¼				NW¼				SW¼				SE¼				TOTAL ACRES
			NE¼	NW¼	SW¼	SE¼	NE¼	NW¼	SW¼	SE¼	NE¼	NW¼	SW¼	SE¼	NE¼	NW¼	SW¼	SE¼	

List any other water rights that cover this place of use. _____

IF MORE SPACE IS NEEDED, ATTACH ADDITIONAL SHEETS AS NECESSARY

- 6. The presently authorized point(s) of diversion is one geographic center of a groundwater pit
(Provide description and number of points)
- 7. The proposed point(s) of diversion is one geographic center of a groundwater pit
(Provide description and number of points)

List all presently authorized point(s) of diversion:

8. **Presently authorized point of diversion:**
 One in the SE Quarter of the SE Quarter of the NW Quarter of Section 6, Township 32 South, Range 3 E, in Cowley County, Kansas, 2,900 feet North 2,800 feet West of Southeast corner of section.
 Authorized Rate natural evaporation Authorized Quantity 315 AF
 (DWR use only: Computer ID No. 5 GPS N/A feet North N/A feet West)
 This point will not be changed This point will be changed as follows:
Proposed point of diversion: (Complete only if change is requested):
 One in the SE Quarter of the SE Quarter of the NW Quarter of Section 6, Township 32 South, Range 3 E, in Cowley County, Kansas, 3,055 feet North 2,992 feet West of Southeast corner of section.
 Proposed Rate no change Proposed Quantity no change
 This point is: Additional Well Geo Center List other water rights that will use this point none

9. **Presently authorized point of diversion:**
 One in the _____ Quarter of the _____ Quarter of the _____ Quarter of Section _____, Township _____ South, Range _____ (E/W), in _____ County, Kansas, _____ feet North _____ feet West of Southeast corner of section.
 Authorized Rate _____ Authorized Quantity _____
 (DWR use only: Computer ID No. _____ GPS _____ feet North _____ feet West)
 This point will not be changed This point will be changed as follows:
Proposed point of diversion: (Complete only if change is requested)
 One in the _____ Quarter of the _____ Quarter of the _____ Quarter of Section _____, Township _____ South, Range _____ (E/W), in _____ County, Kansas, _____ feet North _____ feet West of Southeast corner of section.
 Proposed Rate _____ Proposed Quantity _____
 This point is: Additional Well Geo Center List other water rights that will use this point _____

10. **Presently authorized point of diversion:**
 One in the _____ Quarter of the _____ Quarter of the _____ Quarter of Section _____, Township _____ South, Range _____ (E/W), in _____ County, Kansas, _____ feet North _____ feet West of Southeast corner of section.
 Authorized Rate _____ Authorized Quantity _____
 (DWR use only: Computer ID No. _____ GPS _____ feet North _____ feet West)
 This point will not be changed This point will be changed as follows:
Proposed point of diversion: (Complete only if change is requested)
 One in the _____ Quarter of the _____ Quarter of the _____ Quarter of Section _____, Township _____ South, Range _____ (E/W), in _____ County, Kansas, _____ feet North _____ feet West of Southeast corner of section.
 Proposed Rate _____ Proposed Quantity _____
 This point is: Additional Well Geo Center List other water rights that will use this point _____

- 11. Describe the current condition of and future plans for any point(s) of diversion which will no longer be used. N/A

12. The presently authorized use of water is for Industrial purposes.
It is proposed that the use be changed to no change purposes.

13. If changing the place of use and/or use made of water, describe how the consumptive use will not be increased.
The place of use will be changed, but no increase in the permitted surface acres is proposed. The file is still in the
perfection period.

(Please show any calculations here.)

14. It is requested that the maximum annual quantity of water be reduced to N/A (acre-feet or million gallons).

15. It is requested that the maximum rate of diversion of water be reduced to N/A gallons per minute (--- c.f.s.).

16. The application must include either a topographic map or detailed plat. A U.S. Geological Survey Topographic Map, scale 1:24,000, is available through the Kansas Geological Survey, 1930 Constant Avenue, University of Kansas, Lawrence, Kansas 66047-3726 (www.usgs.gov). The map should show the location of the presently authorized point(s) of diversion. Distances North and West of the Southeast corner of the section must be shown. The presently authorized place of use should also be shown. Identify the center of the section, the section lines and the section corners and show the appropriate section, township, and range numbers on the map. In addition the following information must also be shown on the map.

- a. If a change in the location of the point(s) of diversion is proposed, show:
 - 1) The location of the proposed point(s) of diversion. Distances North and West of the Southeast corner of the section must be shown. Please be certain that the information shown on the map agrees with the information shown in Paragraph Nos. 9, 10 and 11 of the application.
 - 2) If the source of supply is groundwater, please show the location of existing water wells of any kind, including domestic wells, within 1/2 mile of the proposed well or wells. Identify each well as to its use and furnish name and mailing address of the property owner or owners. If there are no wells within 1/2 mile, please indicate so on the map.
 - 3) If the source of supply is surface water, the names and mailing addresses of all landowner(s) 1/2 mile downstream and 1/2 mile upstream from your property lines must be shown.
- b. If a change in the place of use is desired, show the proposed place of use by crosshatching on the map. Please be certain that the information shown on the map agrees with the information shown in Paragraph No. 5 of the application.

17. Attach documentation to show the change(s) proposed herein will not impair existing water rights and relates to the same local source of supply as to which the water right relates. This information may include statements, plats, geology reports, well logs, test hole logs, and other information as necessary information to show the above. Additional comments may be made below.

18. If the proposed change(s) does not meet all applicable rules and regulations of the Kansas Water Appropriation Act, please identify the rules and regulations for which you request a waiver. State the reason why a waiver is needed and why the request should be granted. Attach documentation showing that granting the request will not impair existing water rights and will not prejudicially and unreasonably affect the public interest.

No waivers are anticipated

Water Resources
Received

MAR 04 2020

KS Dept Of Agriculture

IF MORE SPACE IS NEEDED, ATTACH ADDITIONAL SHEETS AS NECESSARY

Any use of water that is not as authorized by the water right or permit to authorize water before the chief engineer approves this application is a violation of the Kansas Water Appropriation Act for which criminal or civil penalties may be assessed. Such violation is a class C misdemeanor, punishable by a fine not to exceed \$500 and/or a term of confinement not to exceed one month in the county jail. K.S.A. 82a-728(b). Civil penalties shall be not less than \$100 nor more than \$1,000 per violation. In the case of a continuing violation, each day such violation continues may be deemed a separate violation. In addition to these penalties the water right may be modified or suspended. K.S.A. 82a-737, as amended.

The application must be signed by all owners of the place of use authorized under the water right and his or her spouse, if married. Please indicate if there is no spouse. If land is being purchased under contract, the seller must sign as landowner until such time as the contract is completed.

In the event that all applicants cannot appear before one notary public, they may as necessary sign separate copies of the application before any notary public conveniently available to them. All copies signed in this manner shall be considered to be valid parts of the application.

If the request is signed on behalf of any Owner by someone with legal authority to do so (for example, an agent, one who has power of attorney, or an executor, executrix, conservator), it will be necessary to attach proper documents showing such authority.

I declare that I am an owner of the currently authorized place of use as identified herein, or that I represent all such owners and am authorized to make this application on their behalf, and declare further that the statements contained herein are true, correct, and complete. By filing this application I authorize the chief engineer to permanently reduce the quantity of water and/or rate of diversion as specified in sections 14 and 15 of this application.

Dated at Wichita, Kansas, this 28th day of February, 20 20

<u>Debbie Y King</u> (Owner)	_____	(Spouse)
<u>Debbie Y King</u> (Please Print)	_____	(Please Print)
_____	_____	(Spouse)
_____	_____	(Please Print)
_____	_____	(Spouse)
_____	_____	(Please Print)

State of Kansas }
County of Sedgwick } SS

I hereby certify that the foregoing application was signed in my presence and sworn to before me this 28th day of February, 20 20



Kristina L Brown
Notary Public

My Commission Expires _____

FEE SCHEDULE

Each application to change the place of use, the point of diversion or the use made of the water under this section shall be accompanied by the application fee set forth in the schedule below:

- (1) Application to change a point of diversion 300 feet or less \$100
- (2) Application to change a point of diversion more than 300 feet \$200
- (3) Application to change the place of use \$200
- (4) Application to change the use made of the water \$300

Make check payable to Kansas Department of Agriculture.

Water Resources
Received

MAR 04 2020

KS Dept Of Agriculture

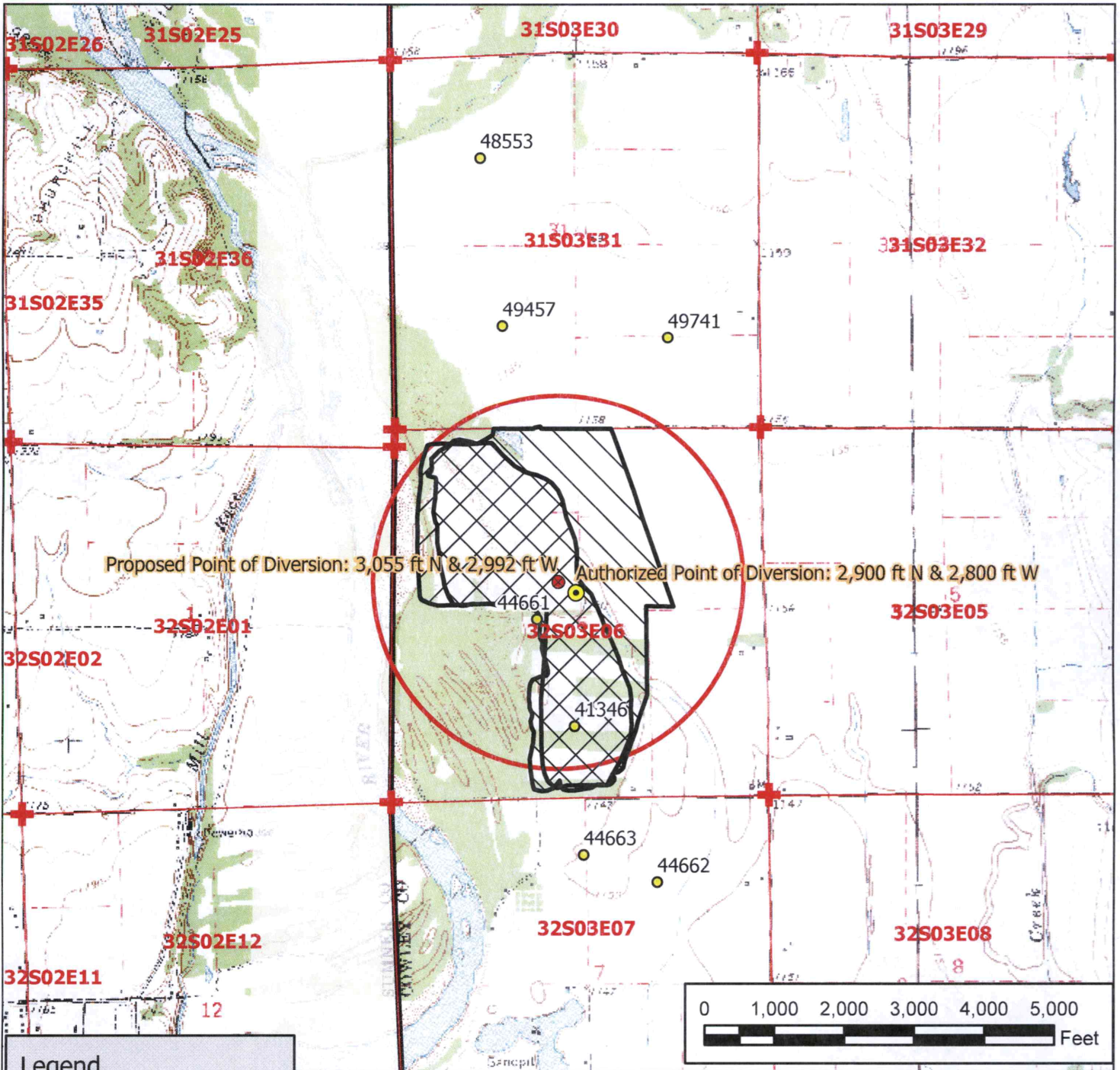

Legend

- Water Appropriation
- Proposed Point of Diversion
- Authorized Point of Diversion
- ★ Domestic Well
- ⊕ Section Corner
- Section Line
- Half Mile Circle
- County Line

Place of Use

- ▨ Authorized
- ▭ Proposed

Water Resources
Received
MAR 04 2020
KS Dept Of Agriculture

Water Appropriation, File No. 44661

Change in Place of Use Application Map

6-32-3E // Cowley County

To the best of my knowledge, all points of diversion within one-half mile of the proposed geographic center of the groundwater pit have been shown.

Signature / Date

2/19/2020 EKF/SFFO 1:24,000 scale

Mike Beam, Secretary

Laura Kelly, Governor

CORNEJO & SONS LLC
2060 E TULSA
PO BOX 16204
WICHITA KS 67216

March 5, 2020

RE: File Nos. **44,661 & 49741**

Dear Sir or Madam:

Applications for approval of the Chief Engineer to change the following condition or conditions of the file numbers referred to above have been received:

- place of use
- point of diversion
- use made of water

As a matter of record, the Division of Water Resources has on hand a large number of applications awaiting processing. Therefore, to be fair to all concerned, and so that we can process those applications on hand in the order they were received, we intend to concentrate on the backlog of applications until the issue is resolved. You will be contacted regarding this application as soon as it has been examined.

In accordance with the provisions of the Kansas Water Appropriation Act, a portion of which is included below, the use of water prior to approval of the application is unlawful. You should not proceed and divert water as indicated by your plans in your application for a change for this file until you receive approval for this change from the Chief Engineer. Once approved, compliance with the terms, conditions and limitations of the permit is necessary. Conservation of the water resources of Kansas is required.

Section 82a-728 of the Kansas Water Appropriation Act, provides (a) except for the appropriation of water for the purpose of domestic use, . . . it shall be unlawful for any person to appropriate or threaten to appropriate water from any source without first applying for and obtaining a permit to appropriate water in accordance with the provisions of the Water Appropriation Act or for any person to violate any condition of a vested right, appropriation right or an approved application for a permit to appropriate water for beneficial use.

(b) (1) The violation of any provision of this section by any person is a class C misdemeanor...

A class C misdemeanor is punishable by a fine not to exceed \$500 and/or a term of confinement not to exceed one month in the county jail. Each day that the violation occurs constitutes a separate offense.

If you have any questions, please contact me at (785) 564-6627. If you wish to discuss a specific file, please have the file number ready so that we may help you more efficiently.

Sincerely,



Kristen A. Baum
New Applications Unit Supervisor
Water Appropriation Program

KAB: kjn