

NOTICE

This scan only represents the application as filed. The information contained herein meets the requirements of K.A.R. 5-3-1 or K.A.R. 5-5-1, and has been found acceptable for filing in the office of the Chief Engineer. The application should not be considered to be a complete application as per K.A.R. 5-3-1b or K.A.R. 5-5-2a.



KANSAS DEPARTMENT OF AGRICULTURE
Mike Beam, Secretary of Agriculture

DIVISION OF WATER RESOURCES
David W. Barfield, Chief Engineer

File Number 50347
This item to be completed by the Division of Water Resources.

APPLICATION FOR PERMIT TO APPROPRIATE WATER FOR BENEFICIAL USE

Filing Fee Must Accompany the Application
(Please refer to Fee Schedule attached to this application form.)

To the Chief Engineer of the Division of Water Resources, Kansas Department of Agriculture,
1320 Research Park Drive, Manhattan, Kansas 66502:

1. Name of Applicant (Please Print): Shon Meschberger
Address: 288 NE 90th Avenue
City: Stafford State KS Zip Code 67578
Telephone Number: (620) 546-5068

2. The source of water is: surface water in -- (stream)
OR groundwater in North Fork Ninnescah (drainage basin)

Certain streams in Kansas have minimum target flows established by law or may be subject to administration when water is released from storage for use by water assurance district members. If your application is subject to these regulations on the date we receive your application, you will be sent the appropriate form to complete and return to the Division of Water Resources.

3. The maximum quantity of water desired is 15 acre-feet OR -- gallons per calendar year,
to be diverted at a maximum rate of 400 gallons per minute OR -- cubic feet per second.

Once your application has been assigned a priority, the requested maximum rate of diversion and maximum requested quantity of water under that priority number can **NOT** be increased. Please be certain your requested maximum rate of diversion and maximum quantity of water are appropriate and reasonable for your proposed project and are in agreement with the Division of Water Resources' requirements.

4. The water is intended to be appropriated for (Check use intended):
(a) Artificial Recharge (b) Irrigation (c) Recreational (d) Water Power
(e) Industrial (f) Municipal (g) Stockwatering (h) Sediment Control
(i) Domestic (j) Dewatering (k) Hydraulic Dredging (l) Fire Protection
(m) Thermal Exchange (n) Contamination Remediation

YOU **MUST** COMPLETE AND ATTACH ADDITIONAL DIVISION OF WATER RESOURCES FORM(S) PROVIDING INFORMATION TO SUBSTANTIATE YOUR REQUEST FOR THE AMOUNT OF WATER FOR THE INTENDED USE REFERENCED ABOVE.

For Office Use Only:
F.O. 2 GMD 5 Meets K.A.R. 5-3-1 (YES/NO) Use IRR Source GS County SF By KJN Date 2/18/20
Code REG Fee \$ 200 TR # _____ Receipt Date 2/18/20 Check # 4046

2/24/2020
LMoody

5. The location of the proposed wells, pump sites or other works for diversion of water from _____
REQUEST 60 DAYS TO LOCATE WELL SITE

Note: For the application to be accepted, the point of diversion location must be on a 40-acre tract, unless you specifically request a 60 day period of time in a specifically described, minimal legal quarter section of land.

Placeholder 1320 ft. N
3960 ft. W
NE SW 1/4 Sect. 7
T24S, R11W, Stafford,
County

(A) One in the _____ quarter of the _____ quarter of the SW quarter of Section _____, more particularly described as being near a point _____ feet North and _____ feet West of the Southeast corner of said section, in Township 24 South, Range 11 West, Stafford County, Kansas.

(B) One in the __ quarter of the __ quarter of the __ quarter of Section __, more particularly described as being near a point __ feet North and __ feet West of the Southeast corner of said section, in Township __ South, Range __ East/West (circle one), __ County, Kansas.

(C) One in the __ quarter of the __ quarter of the __ quarter of Section __, more particularly described as being near a point __ feet North and __ feet West of the Southeast corner of said section, in Township __ South, Range __ East/West (circle one), __ County, Kansas.

(D) One in the __ quarter of the __ quarter of the __ quarter of Section __, more particularly described as being near a point __ feet North and __ feet West of the Southeast corner of said section, in Township __ South, Range __ East/West (circle one), __ County, Kansas.

If the source of supply is groundwater, a separate application shall be filed for each proposed well or battery of wells, except that a single application may include up to four wells within a circle with a quarter (1/4) mile radius in the same local source of supply which do not exceed a maximum diversion rate of 20 gallons per minute per well.

A battery of wells is defined as two or more wells connected to a common pump by a manifold; or not more than four wells in the same local source of supply within a 300 foot radius circle which are being operated by pumps not to exceed a total maximum diversion rate of 800 gallons per minute and which supply water to a common distribution system.

6. The owner of the point of diversion, if other than the applicant is (please print):
The Meschberger Trust, 288 NE 90th Avenue, Stafford, KS 67578, (620) 234-5666
(name, address and telephone number)

(name, address and telephone number)

You must provide evidence of legal access to, or control of, the point of diversion from the landowner or the landowner's authorized representative. Provide a copy of a recorded deed, lease, easement or other document with this application. In lieu thereof, you may sign the following sworn statement:

I have legal access to, or control of, the point of diversion described in this application from the landowner or the landowner's authorized representative. I declare under penalty of perjury that the foregoing is true and correct.

Executed on 02-12, 2020. _____
Applicant's Signature

The applicant must provide the required information or signature irrespective of whether they are the landowner. Failure to complete this portion of the application will cause it to be unacceptable for filing and the application will be returned to the applicant.

7. The proposed project for diversion of water will consist of one well, one pump, one motor
(number of wells, pumps or dams, etc.)
and will be completed (by) 12/31/2020 depending on when application is approved
(Month/Day/Year - each was or will be completed)

8. The first actual application of water for the proposed beneficial use was or is estimated to be 12/31/20
(Mo/Day/Year)

Water Resources
Received
FEB 18 2020
KS Dept Of Agriculture

- 9. Will pesticide, fertilizer, or other foreign substance be injected into the water pumped from the diversion works?
 Yes No If "yes", a check valve shall be required.

All chemigation safety requirements must be met including a chemigation permit and reporting requirements.

- 10. If you are planning to impound water, please contact the Division of Water Resources for assistance, prior to submitting the application. Please attach a reservoir area capacity table and inform us of the total acres of surface drainage area above the reservoir.

Have you also made an application for a permit for construction of this dam and reservoir with the Division of Water Resources? Yes No

- If yes, show the Water Structures permit number here N/A
- If no, explain here why a Water Structures permit is not required --
--
--

- 11. The application must be supplemented by a U.S.G.S. topographic map, aerial photograph or a detailed plat showing the following information. On the topographic map, aerial photograph, or plat, identify the center of the section, the section lines or the section corners and show the appropriate section, township and range numbers. Also, please show the following information:

- (a) The location of the proposed point(s) of diversion (wells, stream-bank installations, dams, or other diversion works) should be plotted as described in Paragraph No. 5 of the application, showing the North-South distance and the East-West distance from a section line or southeast corner of section.
- (b) If the application is for groundwater, please show the location of any existing water wells of any kind within 1/2 mile of the proposed well or wells. Identify each existing well as to its use and furnish the name and mailing address of the property owner or owners. If there are no wells within 1/2 mile, please advise us.
- (c) If the application is for surface water, the names and addresses of the landowner(s) 1/2 mile downstream and 1/2 mile upstream from your property lines must be shown.
- (d) The location of the proposed place of use should be shown by crosshatching on the topographic map, aerial photograph or plat.
- (e) Show the location of the pipelines, canals, reservoirs or other facilities for conveying water from the point of diversion to the place of use.

A 7.5 minute U.S.G.S. topographic map may be obtained by providing the section, township and range numbers to: Kansas Geological Survey, 1930 Constant, Campus West, University of Kansas, Lawrence, Kansas 66047.

- 12. List any application, appropriation of water, water right, or vested right file number that covers the same diversion points or any of the same place of use described in this application. Also list any other recent modifications made to existing permits or water rights in conjunction with the filing of this application.

There are no existing water rights and no overlaps.

Water Resources
Received

FEB 18 2020

13. Furnish the following well information if the proposed appropriation is for the use of groundwater. If the well has not been completed, give information obtained from test holes, if available.

Information below is from: Test holes Well as completed Drillers log attached

Well location as shown in paragraph No.	(A)	(B)	(C)	(D)
Date Drilled	1/26/06	(A is shop well log)		
Total depth of well	60			
Depth to water bearing formation	23			
Depth to static water level	22			
Depth to bottom of pump intake pipe	n/a			

14. The relationship of the applicant to the proposed place where the water will be used is that of tenant and heir.
(owner, tenant, agent or otherwise)

15. The owner(s) of the property where the water is used, if other than the applicant, is (please print):
The Meschberger Trust, 288 NE 90th Avenue, Stafford, KS 67578, (620) 234-5666
(name, address and telephone number)
Shon and Shane Meschberger, 288 NE 90th Avenue, Stafford 67578, (620) 546-5068
(name, address and telephone number)

16. The undersigned states that the information set forth above is true to the best of his/her knowledge and that this application is submitted in good faith.

Dated at Stafford, Kansas, this 10th day of February, 2020.
(month) (year)



(Applicant Signature)

By _____
(Agent or Officer Signature)
Shon Meschberger

(Agent or Officer - Please Print)

Water Resources
Received
FEB 18 2020
KS Dept Of Agriculture

FEE SCHEDULE

1. The fee for an application for a permit to appropriate water for beneficial use, except for domestic use, shall be (see paragraph No. 2 below if requesting storage):

ACRE-FEET	FEE
0-100	\$200.00
101-320	\$300.00
More than 320	\$300.00 plus \$20.00 for each additional 100 acre-feet or any part thereof.

2. The fee for an application in which storage is requested, except for domestic use, shall be:

ACRE-FEET	FEE
0-250	\$200.00
More than 250	\$200.00 plus \$20.00 for each additional 250 acre-feet of storage or any part thereof.

Note: If an application requests both direct use *and* storage, the fee charged shall be as determined under No. 1 or No. 2 above, whichever is greater, but not both fees.

3. The fee for an application for a permit to appropriate water for water power or dewatering purposes shall be \$100.00 plus \$200.00 for each 100 cubic feet per second, or part thereof, of the diversion rate requested.

Note: The applicant shall notify the Chief Engineer and pay the statutorily required field inspection fee of \$400.00 when construction of the works for diversion has been completed, except that for applications filed on or after July 1, 2009, for works constructed for sediment control use and for evaporation from a groundwater pit for industrial use shall be accompanied by a field inspection fee of \$200.00.

MAKE CHECKS PAYABLE TO THE KANSAS DEPARTMENT OF AGRICULTURE

ATTENTION

A Water Conservation Plan may be required per K.S.A. 82a-733. A statement that your application for permit to appropriate water may be subject to the minimum desirable streamflow requirements per K.S.A. 82a-703a, b, and c may also be required from you. After the Division of Water Resources has had the opportunity to review your application, you will be notified whether or not you will need to submit a Water Conservation Plan. You also may be required to install a water flow meter or water stage measuring device on your diversion works prior to diverting water. There may be other special conditions or Groundwater Management District regulations that you will need to comply with if this application is approved.

CONVERSION FACTORS

1 acre-foot equals 325,851 gallons

1 million gallons equal 3.07 acre-feet



Water Resources
Received

FEB 18 2020

KS Dept Of Agriculture

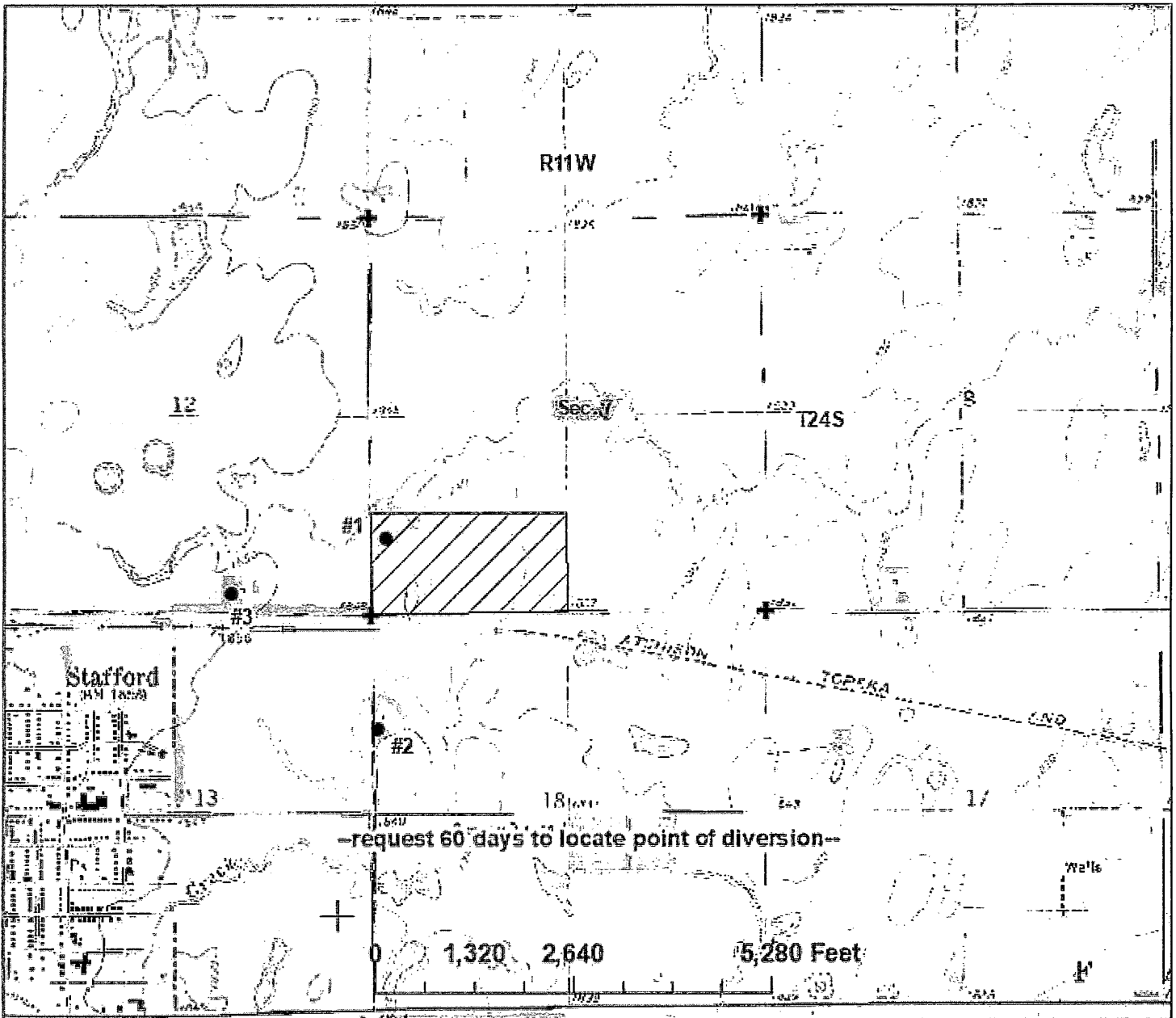
Application Map, No.
SW¼ of Section 7-24S-11W in Stafford County



<p>X proposed point of diversion (N & W)</p>	 ½ mile circle around PD
 currently proposed place of use covering 80 acres, we will reduce to a reasonable acreage as needed	<p>#1-domestic well-Shon & Shane Meschberger</p> <p>#2-domestic well-Merlyn & Diana Hearn 74 NE 90th Avenue Stafford, KS 67578</p> <p>#3-domestic well-Nina Morrison Scholz 15525 Fisher Island DR Austin, TX 78717-3833</p>
<p>● wells within ½ mile of proposed well</p>	
<p>⊕ section corners</p>	



Water Resources
 Received
FEB 18 2020

By signing below I agree that all wells, including domestic wells, within ½ mile of the proposed well have been and will be shown on this map.

X Shon Miller 02-12-2020

signature date

KS Dept Of Agriculture

1 inch = 2,000 feet

map created on 2/12/20 scale 1:24,000

Application Map, No.
SW $\frac{1}{4}$ of Section 7-24S-11W in Stafford County

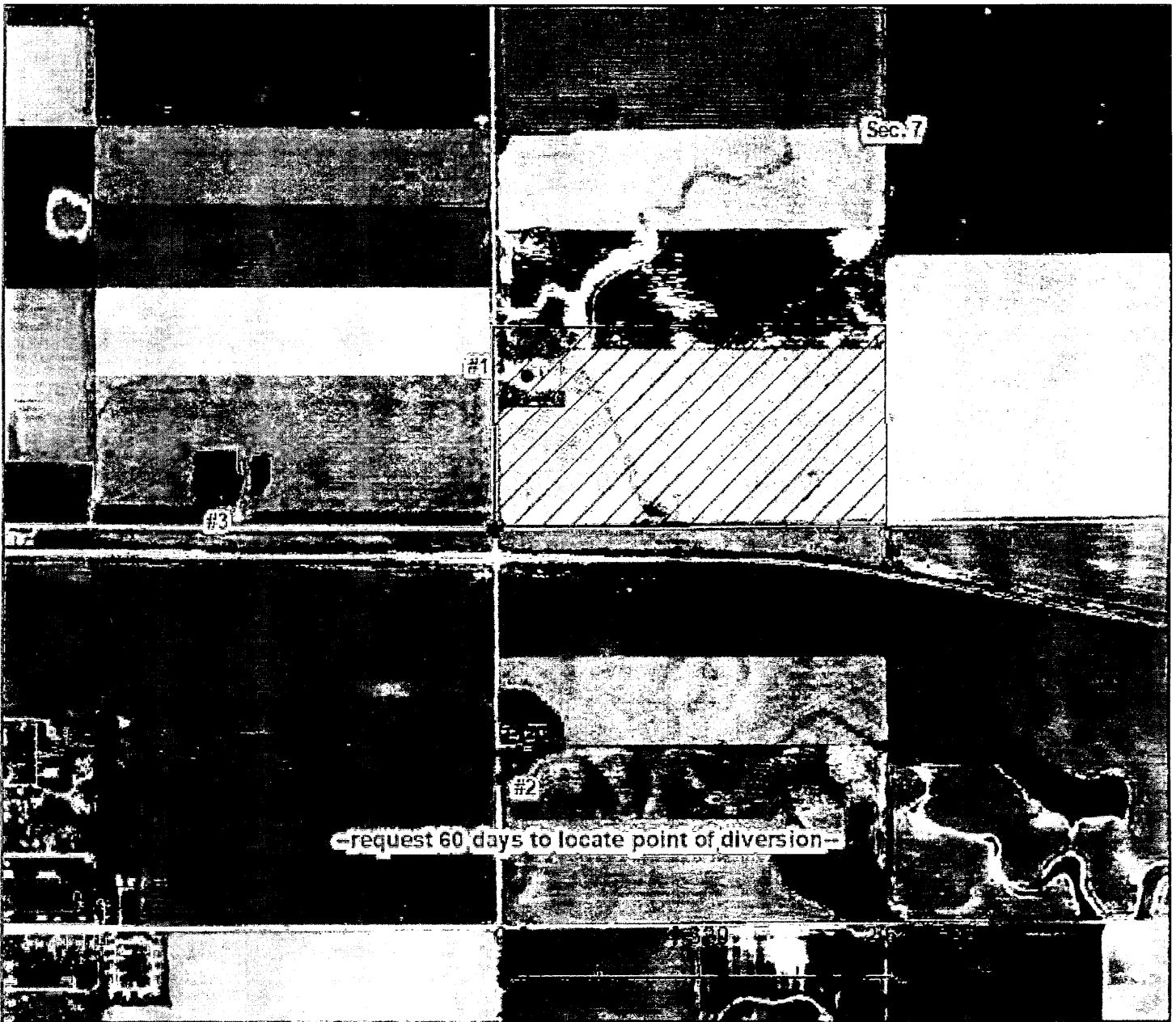

<p>X proposed point of diversion (_____ N & _____ W)</p> <p> currently proposed place of use covering 80 acres, we will reduce to a reasonable acreage as needed</p> <p>● wells within 1/2 mile of proposed well</p> <p>+ section corners</p>	<p> 1/2 mile circle around PD</p> <p>#1-domestic well-Shon & Shane Meschberger</p> <p>#2-domestic well-Merlyn & Diana Hearn 74 NE 90th Avenue Stafford, KS 67578</p> <p>#3-domestic well-Nina Morrison Scholey 15525 Fisher Island DR Austin, TX 78717-3833</p>
---	---

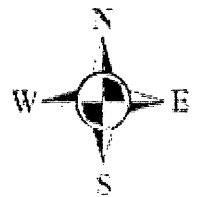

Water Resources
Received

FEB 18 2020

By signing below I agree that all wells, including domestic wells, within 1/2 mile of the proposed well have been and will be shown on this map.

X _____
signature date **02-12-2020**

KS Dept Of Agriculture

1 inch = 1,000 feet

map created on 2/12/20 scale 1:12,000

IRRIGATION USE SUPPLEMENTAL SHEET

File No. _____

Name of Applicant (Please Print): Shon Meschberger

1. Please supply the name and address of each landowner, the legal description of the lands to be irrigated, and designate the actual number of acres to be irrigated in each forty acre tract or fractional portion thereof:

Landowner of Record NAME: Shon and Shane Meschberger

ADDRESS: 288 NE 90th Avenue, Stafford, KS 67578

S	T	R	NE¼				NW¼				SW¼				SE¼				TOTAL
			NE	NW	SW	SE	NE	NW	SW	SE	NE	NW	SW	SE	NE	NW	SW	SE	
7	24S	11W											9.7						9.7

Landowner of Record NAME: The Meschberger Trust

ADDRESS: 288 NE 90th Avenue, Stafford, KS 67578

S	T	R	NE¼				NW¼				SW¼				SE¼				TOTAL
			NE	NW	SW	SE	NE	NW	SW	SE	NE	NW	SW	SE	NE	NW	SW	SE	
7	24S	11W										30.3	40						70.3

Landowner of Record NAME: --

ADDRESS: --

S	T	R	NE¼				NW¼				SW¼				SE¼				TOTAL
			NE	NW	SW	SE	NE	NW	SW	SE	NE	NW	SW	SE	NE	NW	SW	SE	

Water Resources
Received

FEB 18 2020

2. Please complete the following information for the description of the operation for the irrigation project. Attach supplemental sheets as needed.

a. Indicate the soils in the field(s) and their intake rates:

Soil Name	Percent of field (%)	Intake Rate (in/hr)	Irrigation Design Group
_____	_____	_____	_____
_____	_____	_____	_____
_____	_____	_____	_____
_____	_____	_____	_____
Total:	100 %		

b. Estimate the average land slope in the field(s): _____ %

Estimate the maximum land slope in the field(s): _____ %

c. Type of irrigation system you propose to use (check one):

- Center pivot _____ Center pivot - LEPA _____ "Big gun" sprinkler
 Gravity system (furrows) _____ Gravity system (borders) _____ Sideroll sprinkler

Other, please describe: surface drip (system type will ultimately depend on crop which is not finalized yet).

d. System design features:

i. Describe how you will control tailwater: N/A

ii. For sprinkler systems:

(1) Estimate the operating pressure at the distribution system: n/a _____ psi

(2) What is the sprinkler package design rate? n/a _____ gpm

(3) What is the wetted diameter (twice the distance the sprinkler throws water) of a sprinkler on the outer 100 feet of the system? n/a _____ feet

(4) Please include a copy of the sprinkler package design information.

e. Crop(s) you intend to irrigate. Please note any planned crop rotations:

Industrial hemp is our first priority. If that does not work out, we would look into other non-traditional crops as well as normal row crops.

f. Please describe how you will determine when to irrigate and how much water to apply (particularly important if you do not plan a full irrigation).

We will irrigate based on crop consultant recommendations.

You may attach any additional information you believe will assist in informing the Division of the need for your request.

February 10, 2020
(Date)

Kansas Department of Agriculture
Division of Water Resources
David W. Barfield, Chief Engineer
1320 Research Park Drive
Manhattan, Kansas 66502

Re: Application
File No. _____

Minimum Desirable Streamflow

Dear Sir:

I understand that a Minimum Desirable Streamflow requirement has been established by the legislature for the source of supply to which the above referenced application applies.

I understand that diversion of water pursuant to this application will be subject to regulation any time Minimum Desirable Streamflow requirements are not being met.

I also understand that if this application is approved, there could be times, as determined by the Division of Water Resources, when I would not be allowed to divert water. I realize that this could affect the economics of my decision to appropriate water.

I am aware of the above factors, and with the knowledge thereof, request that the Division of Water Resources proceed with processing and approval, if possible, of the above referenced application.

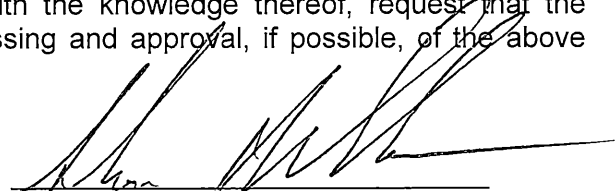

Signature of Applicant

State of Kansas)
County of Stafford) ss

Shon Meschberger
(Print Applicant's Name)

I hereby certify that the foregoing instrument was signed in my presence and sworn to before me this 10th day of February, 2020.



Notary Public

My Commission Expires:

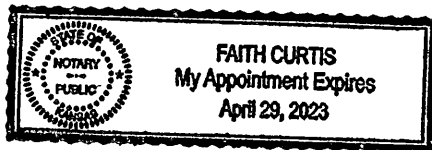

Water Resources
Received

FEB 18 2020

KS Dept Of Agriculture

**MINIMUM DESIRABLE STREAMFLOW FORM TO BE USED WHEN
APPLICABLE WHEN FILING AN APPLICATION FOR PERMIT
TO APPROPRIATE WATER FOR BENEFICIAL USE**

The Kansas Legislature has established minimum desirable streamflows for the streams listed below. If your proposed diversion of water is going to be from one of these watercourses or adjacent alluvial aquifers, please complete the back side of this page and submit it along with your application for permit to appropriate water.

Arkansas River
Big Blue River
Chapman Creek
Chikaskia River
Cottonwood River
Delaware River
Little Arkansas River
Little Blue River
Marais des Cygnes River
Medicine Lodge River
Mill Creek (Wabaunsee Co. area)
Neosho River

Ninnescah River
North Fork Ninnescah River
Rattlesnake Creek
Republican River
Saline River
Smoky Hill River
Solomon River
South Fork Ninnescah
Spring River
Walnut River
Whitewater River

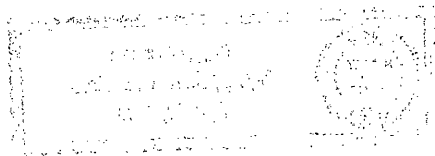

LOCATION OF WATER WELL: County: Stafford Fraction: W 1/4 SW 1/4 SW 1/4 Section Number: 7 Township Number: T 24 S Range Number: R 11 E 01

Distance and direction from nearest town or city street address of well if located within city?
1/4 East 1/4 North Fr Stafford, East side of Road

WATER WELL OWNER: Shane Meshberger
 IR#, St. Address, Box #: Rt 3 Box 58 Stafford KS
 City, State, ZIP Code: Stafford KS
 Board of Agriculture, Division of Water Resources
 Application Number: SW 3164

LOCATE WELL'S LOCATION WITH AN "X" IN SECTION BOX:

N			
-NW-			-NE-
W			E
-SW-			-SE-
S			

DEPTH OF COMPLETED WELL: 60 ft. ELEVATION: _____ ft.
 Depth(s) Groundwater Encountered: 1 ft. 2 _____ ft. 3 _____ ft.
 WELL'S STATIC WATER LEVEL: 22 ft. below land surface measured on mo/day/yr 1-26-06
 Pump test data: Well water was _____ ft. after _____ hours pumping _____ gpm
 Est. Yield _____ gpm: Well water was _____ ft. after _____ hours pumping _____ gpm
 WELL WATER TO BE USED AS:
 1 Domestic 3 Feedlot 6 Oil field water supply 9 Dewatering 12 Other (Specify below)
 2 Irrigation 4 Industrial 7 Domestic (lawn & garden) 10 Monitoring well _____
 Was a chemical/bacteriological sample submitted to Department? Yes _____ No X; If yes, mo/day/yr sample was submitted _____
 Water Well Disinfected? Yes X No _____

TYPE OF BLANK CASING USED:
 1 Steel 3 RMP (SR) 5 Wrought iron 8 Concrete tile CASING JOINTS: Glued X Clamped _____
 2 PVC 4 ABS 6 Asbestos-Cement 9 Other (specify below) Welded _____
 5 Fiberglass Threaded _____
 Blank casing diameter: 5 to 60 ft., Dia _____ in. to _____ ft., Dia _____ in. to _____ ft.
 Casing height above land surface: 12 in., weight 160 lbs./ft. Wall thickness or gauge No. _____
 TYPE OF SCREEN OR PERFORATION MATERIAL:
 1 Steel 3 Stainless Steel 5 Fiberglass 8 RMP (SR) 10 Asbestos-Cement
 2 Brass 4 Galvanized Steel 6 Concrete tile 9 ABS 12 None used (open hole)

SCREEN OR PERFORATION OPENINGS ARE:
 1 Continuous slot 3 Mill slot 5 Gauzed wrapped 8 Saw cut 11 None (open hole)
 2 Louvered shutter 4 Key punched 6 Wire wrapped 9 Drilled holes
 7 Torch cut 10 Other (specify) _____ ft.
 SCREEN-PERFORATED INTERVALS: From 50 ft. to 30 ft., From _____ ft. to _____ ft.
 GRAVEL PACK INTERVALS: From 60 ft. to 24 ft., From _____ ft. to _____ ft.

GROUT MATERIAL: 24 1 Neat cement 0 2 Cement grout X 3 Bentonite 4 Other _____
 Grout Intervals: From 24 ft. to 0 ft., From _____ ft. to _____ ft.
 What is the nearest source of possible contamination:
 1 Septic tank 4 Lateral lines 7 Pit privy 10 Livestock pens 14 Abandoned water well
 2 Sewer lines 5 Cess pool 8 Sewage lagoon 11 Fuel storage 15 Oil well/Gas well
 3 Watertight sewer lines 6 Seepage pit 9 Feedyard 12 Fertilizer storage 16 Other (specify below)
Nothing on location
 Direction from well? _____ How many feet? _____

FROM	TO	LITHOLOGIC LOG	FROM	TO	PLUGGING INTERVALS
0	12	Blk Top Soil			
12	23	Top Clay			
23	44	Fine Sand Tan			
44	51	Coarse Sand			Water Resources Received
51	53	Coarse Gravel + small rocks			FEB 18 2020
53	60	Clay/Gray			KS Dept Of Agriculture

CONTRACTOR'S OR LANDOWNER'S CERTIFICATION: This water well was X constructed, (2) reconstructed, or (3) plugged under my jurisdiction and was completed on (mo/day/year) 1-26-06 and this record is true to the best of my knowledge and belief. Kansas Water Well Contractor's Licence No. 6672 This Water Well Record was completed on (mo/day/yr) 1-26-06 under the business name of Crowd's Waterwell by (signature) [Signature]

1320 Research Park Drive
Manhattan, KS 66502
785-564-6700
www. agriculture.ks.gov



900 SW Jackson, Room 456
Topeka, KS 66612
785-296-3556

Mike Beam, Secretary

Laura Kelly, Governor

February 19, 2020

SHON MESCHBERGER
288 NE 90TH AVENUE
STAFFORD KS 67578

RE: Application, File No. **50347**

Dear Mr. Meschberger:

The Division of Water Resources (Division) has received your application for a permit to appropriate water for beneficial use. Your application has been assigned the file number referenced above. Please be aware that the Division may have a large number of pending applications on hand at times and makes every attempt to process them in the order in which they are received. You will be contacted if additional information is required.

Please note, this letter only acknowledges receipt of your application and does not guarantee approval. In accordance with the provisions of the Kansas Water Appropriation Act, the use of water as proposed prior to approval of the application is unlawful.

Additional information about the process may be found on our website at agriculture.ks.gov/divisions-programs/dwr. If you have any other questions, please contact our office at 785-564-6640 or your local Stafford Field Office at 620-234-5311. If you call, please reference the file number so we can help you more efficiently.

Sincerely,

A handwritten signature in black ink that reads "Kristen A. Baum". The signature is written in a cursive, flowing style.

Kristen A. Baum
New Applications Unit Supervisor
Water Appropriation Program

DATA ENTRY SYSTEM ID NUMBER SHEET

FILE NUMBER 50347

APPLICANT PERSON ID & SEQ #	PDIV ID	BATTERY ID
<u>67178</u>	<u>87951</u>	

LANDOWNER PERSON ID & SEQ #	PUSE ID
<u>67178</u>	<u>69858</u>
<u>67179</u>	<u>69859</u>

WATER USE CORRESPONDENT PERSON ID & SEQ #
<u>67178</u>