

NOTICE

This scan only represents the application as filed. The information contained herein meets the requirements of K.A.R. 5-3-1 or K.A.R. 5-5-1, and has been found acceptable for filing in the office of the Chief Engineer. The application should not be considered to be a complete application as per K.A.R. 5-3-1b or K.A.R. 5-5-2a.

Submit To: CHIEF ENGINEER
 Division of Water Resources
 Kansas Department of Agriculture
 1320 Research Park Drive
 Manhattan, Kansas 66502
 http://agriculture.ks.gov/dwr

APPLICATION FOR TERM PERMIT Water Resources
 Received
 GROUNDWATER
 SURFACE WATER
 (check one)



KS Dept Of Agriculture
 State of Kansas

20219046

STATUTORY FILING FEE MUST ACCOMPANY THIS APPLICATION
 (Make check payable to the Kansas Department of Agriculture)

1. Applicant: (Please print or type)
 Name Bob Bergkamp Construction Co., Inc.
 Street 3709 S. West Street
 City and State Wichita KS
 Zip Code 67217 Telephone No. (316) 522-3471
 E-Mail Address rthome@bergkampconstruction.com
 Social Security I.D. No. _____
 and/or Taxpayer I.D. No. 48-0796660

2. Location of Point of Diversion:
 Sec. 24, Twp. 22S, Rng. 07W,
Reno County, Kansas.
 Distance from Southeast Corner of Section:
785 feet North from Southeast Corner
525 feet West from Southeast Corner
 NOTE: If point of diversion is not site specific (i.e. groundwater pit) show the approximate geographic center.

3. Water Use Data:
 Proposed Max. Pumping Rate (gpm) 4,000
 Amount Requested (acre-feet) 1,047
 per calendar year. *Calculation is on separate sheet.
 Depth of Well (feet) Groundwater Pit
 Date (completed) (will be completed) June 23, 2023
 Drainage Basin Cow Creek
 Name of Stream NA

4. Water is to be used for (briefly describe proposed use and explain the rate and quantity requested):
K14 Highway – Hydraulic dredging for fill material

5. Location of place of use:
S24 T22S R07W 785N 525W

6. Period of use:
 Commencing date: June 1, 2021
 Ending Date: June 23, 2023 Also enter on Item 12

If off-stream pit, check here X.
 Will pit floor intersect water table? Yes No

7. Location of the proposed point of diversion and those of other water users within 1/2 mile shall be indicated on the diagram to the lower-left, scale 1 inch = 2,000 feet. If surface water, indicate on the diagram the course of the stream, and its name. List other D.W.R. permit numbers that cover the requested point(s) of diversion or place of use here:
See attached quadrangle map

FEE SCHEDULE

- The filing fee for an application is based on the maximum amount of water use proposed within a year. Except for storage, the fee is:

Acre-feet	Fee
0-100	\$200.00
101-320	\$300.00
More than 320	\$300.00

 plus \$20 for each additional 100 acre-feet or any part thereof.
- The fee for an application in which storage is requested, is:

Acre-feet	Fee
0-250	\$200.00
More than 250	\$200.00

 plus \$20.00 for each additional 250 acre-feet of storage or any part thereof.

NOTE: If an application requests both direct use and storage, the fee charged shall be as determined under No. 1 or No. 2 above, whichever is greater, but not both fees.

- A request for an extension of time to extend the term of a term permit shall be accompanied by a fee of \$100.00.
- There is a separate application form for domestic use. Do not use this form for domestic use.

CONVERSION FACTORS

1 acre-foot equals 325,851 gallons
 1 million gallons equal 3.07 acre-feet

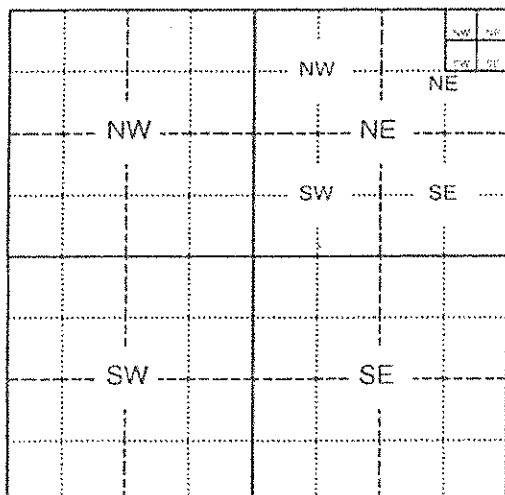

Assisted by KJN/HQ/DWR

For Office Use Only **2**
 F.O. 2 GMD 2 Meets K.A.R. 5-3-1 (YES / NO) Use HYD Source G/S County RN By BMM Date 5/18/21
 Code TR3 Fee \$ 160 TR # PY00026252 Receipt Date _____ Check # _____

8. For groundwater use, list below all wells within 1/2 mile of the proposed well, and plot locations upon the diagram on reverse side. If additional space is needed, attach a map.

Other wells –

Well A Owner(s): See quadrangle mp
Address: _____

Well B Owner(s): _____
Address: _____

9. For surface water use, list below the names and addresses of all landowners from a point 1/2 mile upstream to a point 1/2 mile downstream of the tract of land upon which the point of diversion is located. If additional space is needed, attach sheet.

Tract A Owner(s): _____
Address: _____

Tract B Owner(s): _____
Address: _____

10. The owner of the point of diversion, if other than the applicant is (please print):

Richard J Schuller 5907 N Dean Rd, Nickerson KS 67561 620-921-5822
(name, address and telephone number)

You must provide evidence of legal access to, or control of, the point of diversion from the landowner or the landowner's authorized representative. Provide a copy of a recorded deed, lease, easement or other document with this application. In lieu thereof, you may sign the following sworn statement:

I have legal access to, or control of, the point of diversion described in this application from the landowner or the landowner's authorized representative. I declare under penalty of perjury that the foregoing is true and correct.

Executed on 5/18, 2021. Rick Thome
Applicant's Signature

The applicant must provide the required information or signature irrespective of whether they are the landowner. Failure to complete this portion of the application will cause it to be unacceptable for filing and the application will be returned to the applicant.

11. The applicant states that the information set hereon is true and accurate to the best of his/her knowledge.

12. The applicant agrees to waive any right to a hearing on the matter of abandonment of this appropriation right and further agrees that this appropriation right may be dismissed and terminated upon completion of the proposed project, said dismissal date to be on June 23, 2023 or within any extension of time authorized by the Chief Engineer, Division of Water Resources, Kansas Department of Agriculture.

13. The applicant agrees to provide water to nearby water users, at no charge to said users, should their rights to use water become impaired by the project proposed by this application.

14. Water use contact person (in event emergency contact is needed):

Name: Loren Schroeder Telephone No. (316) 213-2311
Rick Thome 5/18/2021
Signature of Applicant or Authorized Representative Date

Applicant's Name Printed

Rick Thome - Agent
Title

DO NOT WRITE BELOW THIS LINE

CONDITIONS OF APPROVAL:

The applicant shall maintain accurate and complete records from which the quantity of water diverted during each calendar year may be readily determined. Accurate and complete records shall be furnished to the Chief Engineer by March 1 following the end of each calendar year. Failure to file the annual water use report by the due date, shall cause the applicant to be subject to a civil penalty.

The use of water herein authorized shall not be made so as to impair any use under existing water rights nor prejudicially and unreasonably affect the public interest.

The Chief Engineer specifically retains jurisdiction in this matter with authority to make such reasonable reductions in the approved rate of diversion and quantity authorized, and such changes in other terms, conditions, and limitation set forth in this approval and permit to proceed as may be deemed to be in the public interest.

5/18/2021

Water Resources
Received

KS Dept Of Agriculture

KDOT K14

TERM PERMIT CALCULATIONS FOR HYDRAULIC EXCAVATION

PUMPING RATE PER HOUR

SAND AT 30% = 13,527 CUBIC FEET

WATER AT 70% = 31,563 CUBIC FEET

GALLONS OF WATER PER HOUR AT = 236,723 GALLONS

GALLONS OF WATER PER MINUTE = $236,723/60 = 3,946$ GPM

COUNTY - LEGALS	CUBIC YARDS PUMPED	HOURS PUMPING AT 350 CY/HOUR	GALLONS WATER PUMPED AT 4,000 GPM	ACRE FEET AT 325,851 G/AF
RENO COUNTY - 24 ACRES S24 T22S R07W 785N 525W	497,369	1,421	341,053,029	1,046.65

5/18/2021

Water Resources
Received

KS Dept Of Agriculture

NEW APPLICATION
STATE OF KANSAS

YAGGY
KANSAS
7.5 MINUTE S

1" = 2,000'

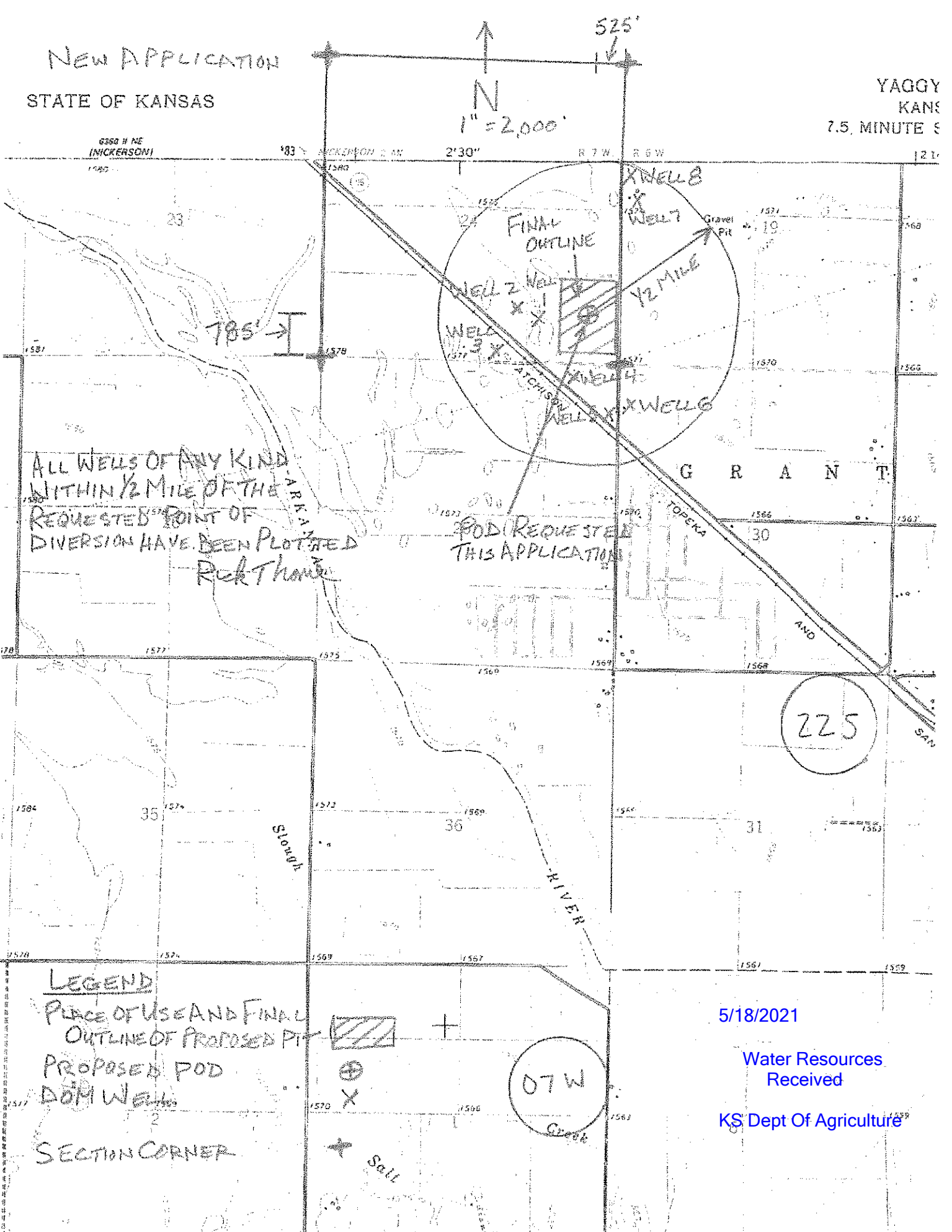

ALL WELLS OF ANY KIND
WITHIN 1/2 MILE OF THE
REQUESTED POINT OF
DIVERSION HAVE BEEN PLOTTED
Rock Thorne

POD REQUESTED
THIS APPLICATION

LEGEND

- PLACE OF USE AND FINAL OUTLINE OF PROPOSED PIT
- PROPOSED POD
- DOM WELL
- SECTION CORNER

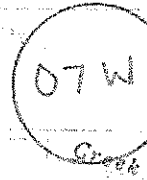
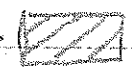

5/18/2021

Water Resources
Received

KS Dept Of Agriculture