

NOTICE

This scan only represents the application as filed. The information contained herein meets the requirements of K.A.R. 5-3-1 or K.A.R. 5-5-1, and has been found acceptable for filing in the office of the Chief Engineer. The application should not be considered to be a complete application as per K.A.R. 5-3-1b or K.A.R. 5-5-2a.

WATER RESOURCES RECEIVED

Submit To: CHIEF ENGINEER
 Division of Water Resources
 Kansas Department of Agriculture
 1320 Research Park Drive
 Manhattan, Kansas 66502
<http://agriculture.ks.gov/dwr>

APPLICATION FOR TERM PERMIT

- GROUNDWATER
- SURFACE WATER (check one)

JUN 21 2021
 9:35
 KS DEPT OF AGRICULTURE



State of Kansas

STATUTORY FILING FEE MUST ACCOMPANY THIS APPLICATION
 (Make check payable to the Kansas Department of Agriculture)

1. Applicant: (Please print or type)
 Name Barber County RWD 3
 Street 14873 NW River Rd
 City and State Lake City KS
 Zip Code 67071-9006 Telephone No. (620) 247-6413
 E-Mail Address _____
 Social Security I.D. No. _____
 and/or Taxpayer I.D. No. _____

2. Location of Point of Diversion:
 Sec. 3, Twp. 30, Rng. 14, W,
Barber County, Kansas.
 Distance from Southeast Corner of Section:
1,641 feet North from Southeast Corner
3,185 feet West from Southeast Corner

NOTE: If point of diversion is not site specific (i.e. groundwater pit) show the approximate geographic center.

3. Water Use Data:
 Proposed Max. Pumping Rate (gpm) 50
 Amount Requested (acre-feet) 6.1 (2,000,000 gal)
 per calendar year
 Depth of Well (feet) 102
 Date (completed) (will be completed) 1980
 Drainage Basin Medicine Lodge River
 Name of Stream N/A

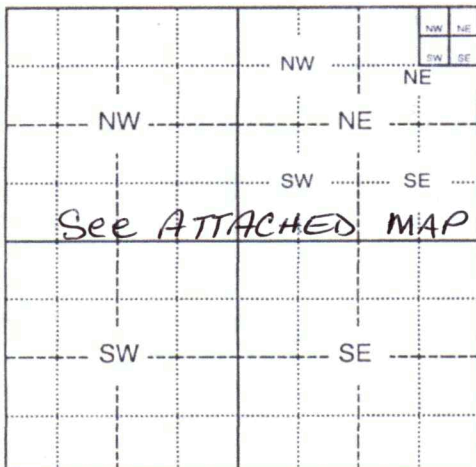

4. Water is to be used for (briefly describe proposed use and explain the rate and quantity requested):
Additional quantity to help cover extra water use from system leaks and the Feb. 2021 deep freeze

5. Location of place of use:
Barber Co RWD3 and immediate vicinity and Barber Co RWD1 and immediate vicinity

6. Period of use:
 Commencing date: 1/1/2021
 Ending Date: 12/31/2021 Also enter on Item 12

If off-stream pit, check here
 Will pit floor intersect water table? Yes No

7. Location of the proposed point of diversion and those of other water users within 1/2 mile shall be indicated on the diagram to the lower-left, scale 1 inch = 2,000 feet. If surface water, indicate on the diagram the course of the stream, and its name. List other D.W.R. permit numbers that cover the requested point(s) of diversion or place of use here:
Water Right, File No. 32612

FEE SCHEDULE

- The filing fee for an application is based on the maximum amount of water use proposed within a year. Except for storage, the fee is:

Acre-feet	Fee
0-100	\$200.00
101-320	\$300.00
More than 320	\$300.00

 plus \$20 for each additional 100 acre-feet or any part thereof.
- The fee for an application in which storage is requested, is:

Acre-feet	Fee
0-250	\$200.00
More than 250	\$200.00

 plus \$20.00 for each additional 250 acre-feet of storage or any part thereof.

NOTE: If an application requests both direct use and storage, the fee charged shall be as determined under No. 1 or No. 2 above, whichever is greater, but not both fees.

- A request for an extension of time to extend the term of a term permit shall be accompanied by a fee of \$100.00.
- There is a separate application form for domestic use. Do not use this form for domestic use.

CONVERSION FACTORS

1 acre-foot equals 325,851 gallons
 1 million gallons equal 3.07 acre-feet

Assisted by EKF/SFFO

For Office Use Only:		MUN		BA		BMM		6/21/21	
F.O. Code	<u>2 GMD TRP</u>	Meets K.A.R. 5-3-1 (YES/NO)	Use	Source	<u>G/S</u>	County	<u>BA</u>	By	<u>TRP</u>
Fee	<u>\$200</u>	TR #		Receipt Date	<u>6/21/21</u>	Check #	<u>4489</u>		

WATER RESOURCES
RECEIVED

JUN 21 2021

KS DEPT OF AGRICULTURE

8. For groundwater use, list below all wells within 1/2 mile of the proposed well, and plot locations upon the diagram on reverse side. If additional space is needed, attach a map.

Other wells -

Well A Owner(s): Jason Howell
Address: 80210 NE 80th St, Preston KS 67583

Well B Owner(s): _____
Address: _____

9. For surface water use, list below the names and addresses of all landowners from a point 1/2 mile upstream to a point 1/2 mile downstream of the tract of land upon which the point of diversion is located. If additional space is needed, attach sheet.

Tract A Owner(s): _____
Address: _____

Tract B Owner(s): _____
Address: _____

10. The owner of the point of diversion, if other than the applicant is (please print):

Applicant
(name, address and telephone number)

You must provide evidence of legal access to, or control of, the point of diversion from the landowner or the landowner's authorized representative. Provide a copy of a recorded deed, lease, easement or other document with this application. In lieu thereof, you may sign the following sworn statement:

I have legal access to, or control of, the point of diversion described in this application from the landowner or the landowner's authorized representative. I declare under penalty of perjury that the foregoing is true and correct.

Executed on 6-16, 2021.

Pat Belen
Applicant's Signature

The applicant must provide the required information or signature irrespective of whether they are the landowner. Failure to complete this portion of the application will cause it to be unacceptable for filing and the application will be returned to the applicant.

11. The applicant states that the information set hereon is true and accurate to the best of his/her knowledge.
12. The applicant agrees to waive any right to a hearing on the matter of abandonment of this appropriation right and further agrees that this appropriation right may be dismissed and terminated upon completion of the proposed project, said dismissal date to be on December 31, 2021 or within any extension of time authorized by the Chief Engineer, Division of Water Resources, Kansas Department of Agriculture.
13. The applicant agrees to provide water to nearby water users, at no charge to said users, should their rights to use water become impaired by the project proposed by this application.
14. Water use contact person (in event emergency contact is needed):

Name: Joan Jacobs, RWD 3 Bookkeeper Telephone No. (620) 247-6413

Signature of Applicant

or

Pat Belen
Authorized Representative

6-16-21
Date

Applicant's Name Printed

Chairman of RWD 3 Board
Title

DO NOT WRITE BELOW THIS LINE

CONDITIONS OF APPROVAL:

The applicant shall maintain accurate and complete records from which the quantity of water diverted during each calendar year may be readily determined. Accurate and complete records shall be furnished to the Chief Engineer by March 1 following the end of each calendar year. Failure to file the annual water use report by the due date, shall cause the applicant to be subject to a civil penalty.

The use of water herein authorized shall not be made so as to impair any use under existing water rights nor prejudicially and unreasonably affect the public interest.

The Chief Engineer specifically retains jurisdiction in this matter with authority to make such reasonable reductions in the approved rate of diversion and quantity authorized, and such changes in other terms, conditions, and limitation set forth in this approval and permit to proceed as may be deemed to be in the public interest.

JUN 21 2021

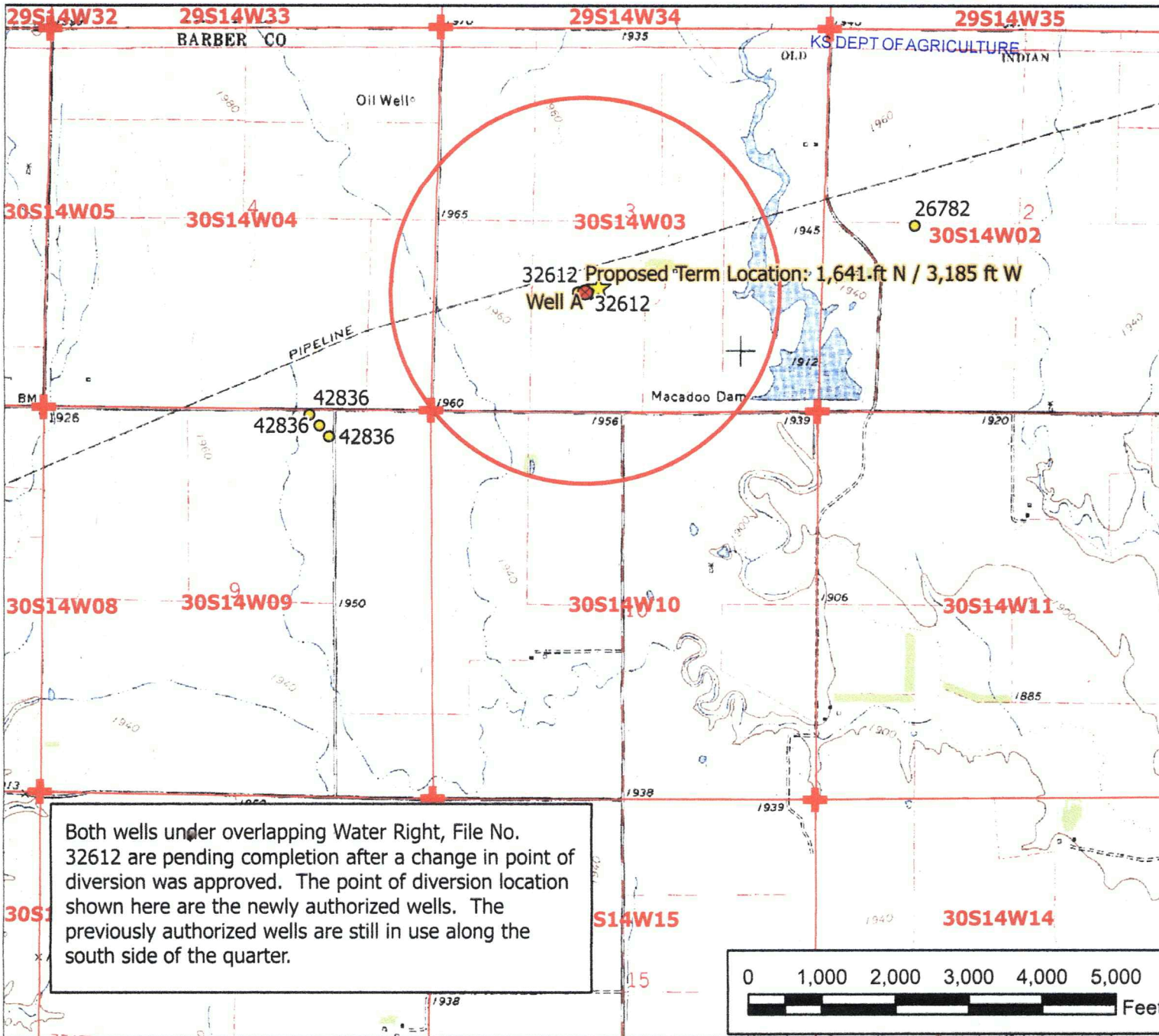

Both wells under overlapping Water Right, File No. 32612 are pending completion after a change in point of diversion was approved. The point of diversion location shown here are the newly authorized wells. The previously authorized wells are still in use along the south side of the quarter.

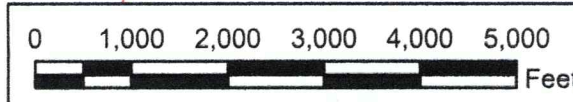

Legend

- Water Appropriation
- Proposed Point of Diversion
- ⊙ Authorized Point of Diversion
- ★ Domestic Well
- ⊕ Section Corner
- ▭ Section Line
- Half Mile Circle

Term Permit, File No. _____

**Application for Permit Map
3-30-14W // Barber County**

To the best of my knowledge, all wells within one-half mile of the proposed points of diversion have been shown.

Pat Bede
Signature / Date

6-16-21
6/4/2021 EKF/SFFO 1:24,000 scale

