

Submit completed application to:  
 Kansas Department of Agriculture  
 Division of Water Resources  
 Field Office for your area.

Call for address:

Topeka -- (785) 296-5733  
 Stafford -- (620) 234-5311  
 Stockton -- (785) 425-6787  
 Garden City -- (620) 276-2901  
<http://agriculture.ks.gov/dwr>

# DWR FIELD OFFICE APPLICATION FOR APPROVAL TO CHANGE THE PLACE OF USE AND/OR THE POINT OF DIVERSION WATER METER REQUIRED



STATE OF KANSAS

**Filing Fee Must Accompany the Application, K.S.A. 82a-708b(b), as amended.**  
 Fee Schedule is on the third page of this application form.

**Paragraph Nos. 1, 2, 3 & 5 must be completed. Complete all other applicable portions.** If change in point of diversion is greater than 100 feet, or if place of use will be changed, include a topographic map or detailed plat showing the authorized and proposed point(s) of diversion and/or place of use.

File No. 20241

RECEIVED  
 11:00  
 AUG 09 2021  
 Stafford Field Office  
 DIVISION OF WATER RESOURCES

1. Application is hereby made for approval of the Chief Engineer to change the (check one or both):

Place of Use       Point of Diversion

under the water right which is the subject of this application in accordance with the conditions described below.

The source of supply is:       Groundwater       Surface water

2. Name and address of Applicant: ROBERT D. HAY REV TRUST  
9171 S. West STREET, HAYSVILLE KS 67060  
 Phone Number: (316) 734-8277      Email address: HAYFARMS@GMAIL.COM  
 Name and address of Water Use Correspondent: ROBERT HAY  
9171 S. West STREET, HAYSVILLE KS 67060  
 Phone Number: (316) 734-8277      Email address: HAYFARMS@GMAIL.COM

3. The presently authorized place of use is: \*Isadore's Agronomics of Kansas LLC  
 Owner of Land --- NAME: ROBERT D. HAY REV TRUST  
 ADDRESS: 9171 S. West STREET, HAYSVILLE KS 67060  
 (If there is more than one landowner, attach supplemental sheets as necessary.)

Sec.	Twp.	Range	NE¼				NW¼				SW¼				SE¼				TOTAL ACRES
			NE¼	NW¼	SW¼	SE¼	NE¼	NW¼	SW¼	SE¼	NE¼	NW¼	SW¼	SE¼	NE¼	NW¼	SW¼	SE¼	
13	29S	1W									34.5	34.5	34.5	34.5					138

4. If this application is for a change in place of use, it is proposed that the place of use be changed to:  
 Owner of Land --- NAME: ROBERT D. HAY REV TRUST \*Isadore's Agronomics of Kansas LLC  
 ADDRESS: 9171 S. West STREET, HAYSVILLE KS 67060  
 (If there is more than one landowner, attach supplemental sheets as necessary.)

Sec.	Twp.	Range	NE¼				NW¼				SW¼				SE¼				TOTAL ACRES
			NE¼	NW¼	SW¼	SE¼	NE¼	NW¼	SW¼	SE¼	NE¼	NW¼	SW¼	SE¼	NE¼	NW¼	SW¼	SE¼	
13	29S	1W									20	20	36	36	36	36	36	36	148
											38	37	35	36	**				146**

\*Per SG Co. Parcel search & call with Bob Hay on 8/18/21.      EX# /DWR 9/1/21

For Office Use Only: Code <u>CRU</u>	Fee \$ <u>200</u>	TR # _____	Receipt Date _____	Check # <u>017047</u>
--------------------------------------	-------------------	------------	--------------------	-----------------------

\*\*Per email/revised map received 11/12/2021      EX# /DWR

5. **Presently authorized point of diversion:**  
 One in the SW Quarter of the NW Quarter of the NC SW Quarter of Section 13, Township 29 South, Range 1 (E/W) in Sedgwick County, Kansas, 1320 feet North 4030 feet West of Southeast corner of section. Authorized Rate 600 gpm Authorized Quantity 77 AF Depth of well \_\_\_\_\_ (feet)  
**(DWR use only: Computer ID No. 01 GPS 1273 feet North 4,016 feet West)**  
 This point will not be changed  This point will be changed as follows:  No change, point better described with GPS as follows:  
**Proposed point of diversion: (Complete only if change is requested or if existing point is better described by GPS)**  
 One in the NE Quarter of the SW Quarter of the SW Quarter of Section 13, Township 29 South, Range 1 (E/W) in Sedgwick County, Kansas, 1273 feet North 4,016 feet West of Southeast corner of section. Proposed Rate No Change Proposed Quantity No Change Proposed well depth (feet) N/A  
 This point is:  Additional Well  Geo Center List other water rights that will use this point 28942

PerFile EXT/DWR 9/1/2021

6. **Presently authorized point of diversion:**  
 One in the \_\_\_\_\_ Quarter of the \_\_\_\_\_ Quarter of the \_\_\_\_\_ Quarter of Section \_\_\_\_\_, Township \_\_\_\_\_ South, Range \_\_\_\_\_ (E/W), in \_\_\_\_\_ County, Kansas, \_\_\_\_\_ feet North \_\_\_\_\_ feet West of Southeast corner of section. Authorized Rate \_\_\_\_\_ Authorized Quantity \_\_\_\_\_ Depth of well \_\_\_\_\_ (feet)  
**(DWR use only: Computer ID No. \_\_\_\_\_ GPS \_\_\_\_\_ feet North \_\_\_\_\_ feet West)**  
 This point will not be changed  This point will be changed as follows:  No change, point better described with GPS as follows:  
**Proposed point of diversion: (Complete only if change is requested or if existing point is better described by GPS)**  
 One in the \_\_\_\_\_ Quarter of the \_\_\_\_\_ Quarter of the \_\_\_\_\_ Quarter of Section \_\_\_\_\_, Township \_\_\_\_\_ South, Range \_\_\_\_\_ (E/W), in \_\_\_\_\_ County, Kansas, \_\_\_\_\_ feet North \_\_\_\_\_ feet West of Southeast corner of section. Proposed Rate \_\_\_\_\_ Proposed Quantity \_\_\_\_\_ Proposed well depth (feet) \_\_\_\_\_  
 This point is:  Additional Well  Geo Center List other water rights that will use this point \_\_\_\_\_

7. The changes herein are desired for the following reasons?  
 (please be specific) INSTALL CORNER SYSTEM

8. If a well, is the test hole log attached?  Yes  No NA

9. The change(s) (was)(will be) completed by?  
SEPT 30, 2021

10. If the point of diversion is a well:  
 (a) What are you going to do with the old well?  
NA  
 (b) When will this be done? \_\_\_\_\_

11. Groundwater Management District recommendation attached?  
 Yes  No

12. Assisted by BRAD VINCENT GROUND WATER ASSO.

13a. If the proposed point of diversion will be relocated more than 300 feet but within 2,640 feet of the existing point of diversion, attach a topographic map or aerial photograph. For groundwater sources, show all wells (including domestic) within one-half mile of the proposed point of diversion and the names and mailing addresses of the owners. For surface water sources, show the names and addresses of the landowner(s) one-half mile downstream and one-half mile upstream from your property lines

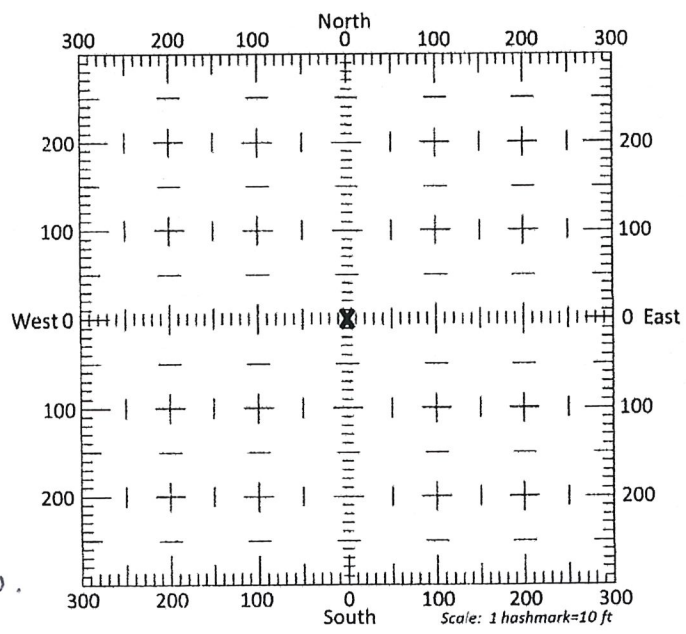

13b. If the proposed point of diversion will be relocated within 300 feet of the existing point of diversion, indicate its location on the diagram shown above in relation to the existing point of diversion. **(PLEASE NOTE: The "X" in center of diagram above represents the presently authorized point of diversion.)**

RECEIVED

AUG 09 2021

File No. 20241

14. If the proposed groundwater point of diversion is 300 or fewer feet from the existing point of diversion, complete the following:

- (a) Does the undersigned represent all owners of the currently authorized place(s) of use identified in this application?  
 Yes     No    (If no, all owners must sign this application.)
- NA (b) Will the ownership interest of any owner of the currently authorized place(s) of use identified in this application be adversely affected if this application is approved as requested?  
 Yes     No    (If yes, all owners must sign this application.)
- (c) If this application is not approved expeditiously, will there be substantial damage to property, public health or safety?  
 Yes     No    (If no, all owners must sign this application.)

If the application proposes a surface water change in point of diversion, a groundwater change in point of diversion greater than 300 feet, or a change in place of use, the application must be signed by all owners of the currently authorized place of use, or their duly authorized agent (attach notarized statement authorizing representation).

I hereby verify, being first duly sworn upon my oath or affirmation and under penalty of perjury, that I am of lawful age and the owner, the spouse of the owner, or a duly authorized agent of the owner(s) to make this application on their behalf, in regards to the water right(s) to which this application pertains. I further verify that the statements contained in this application are true, correct and complete.

Dated at Haysville, Kansas, this 5<sup>th</sup> day of August, 2021.

Robert D Hay  
(Owner)

Janet M. Hay  
(Spouse)

\_\_\_\_\_  
(Please Print)

\_\_\_\_\_  
(Please Print)

\_\_\_\_\_  
(Owner)

\_\_\_\_\_  
(Spouse)

\_\_\_\_\_  
(Please Print)

\_\_\_\_\_  
(Please Print)

\_\_\_\_\_  
(Owner)

\_\_\_\_\_  
(Spouse)

\_\_\_\_\_  
(Please Print)

\_\_\_\_\_  
(Please Print)

State of Kansas }  
County of Sedgewick } SS

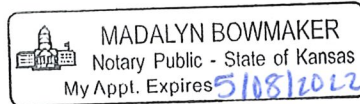

I hereby certify that the foregoing application was signed in my presence and sworn to before me this 5<sup>th</sup> day of August, 2021.

Madalyn Bowmaker  
Notary Public

My Commission Expires 5/18/2022.

**ONLY COMPLETE APPLICATIONS WILL BE PROCESSED.** To be complete, all of the applicable portions of the application form must be completed with accurate information; maps, if necessary, must be included; signatures of all the appropriate owners' must be affixed to the application and notarized; and the appropriate fee must be paid.

**FEE SCHEDULE**

Each application to change the place of use or the point of diversion under this section shall be accompanied by the application fee set forth in the schedule below: Make checks payable to: **Kansas Department of Agriculture**

- (1) Application to change a point of diversion 300 feet or less ..... \$100
- (2) Application to change a point of diversion more than 300 feet ..... \$200
- (3) Application to change the place of use ..... \$200

RECEIVED  
AUG 09 2021  
Stafford Field Office  
DIVISION OF WATER RESOURCES  
File No. 20241



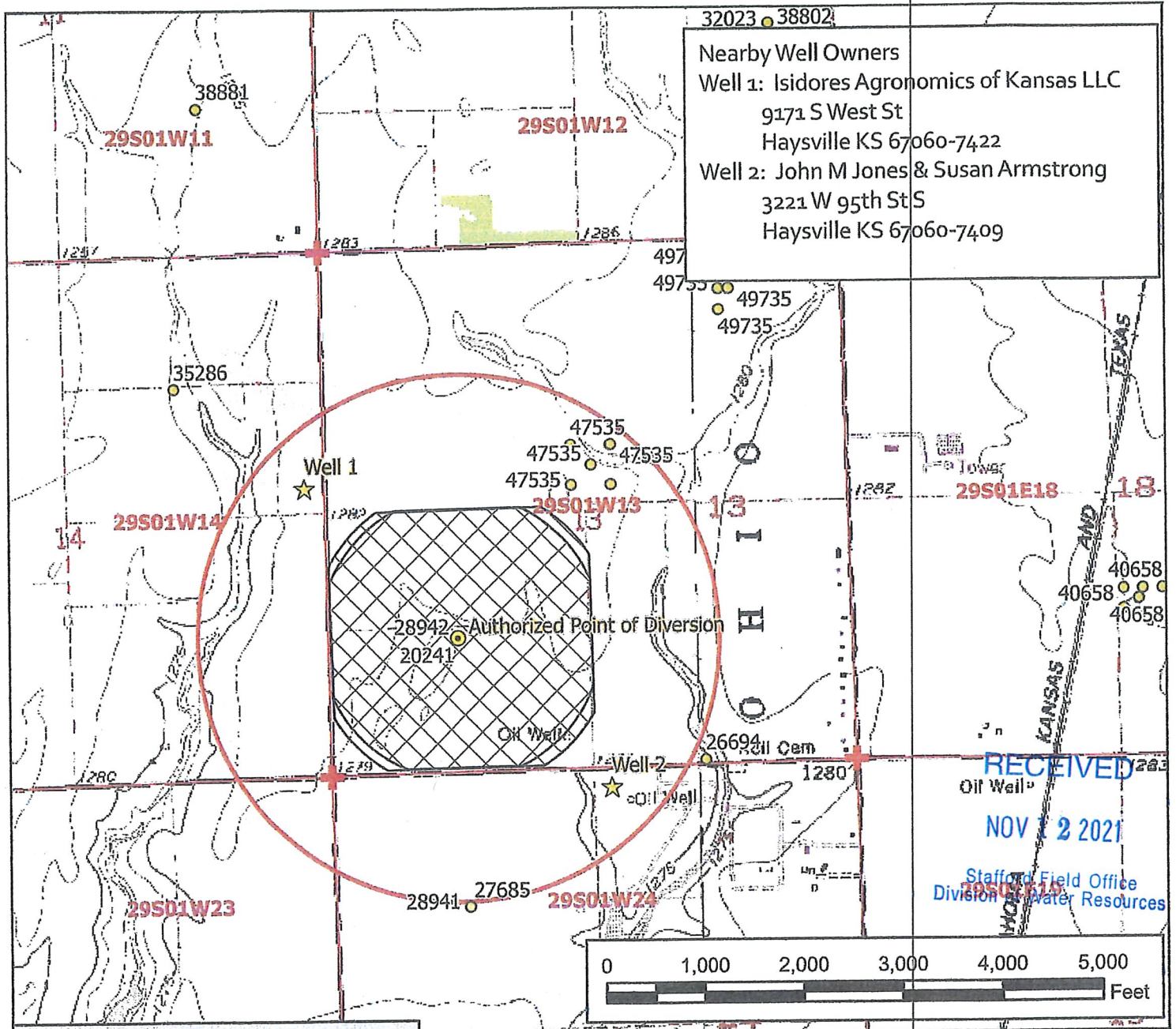

Nearby Well Owners  
 Well 1: Isidores Agronomics of Kansas LLC  
 9171 S West St  
 Haysville KS 67060-7422  
 Well 2: John M Jones & Susan Armstrong  
 3221 W 95th St S  
 Haysville KS 67060-7409

RECEIVED  
 NOV 12 2021  
 Staff Office Field Office  
 Division of Water Resources

**Legend**

- Water Appropriation
- Proposed Point of Diversion
- Authorized Point of Diversion
- ★ Domestic Well
- Section Line
- Half Mile Circle
- ▨ Authorized Place of Use
- ▨ Proposed Place of Use

**Water Right, File Nos. 20241 & 28942**

**Revised Change Application Map  
 13-29S-1W // Sedgwick County**

To the best of my knowledge, all wells within one-half mile of the authorized point of diversion have been shown.

*Robert D Hay POA*

Signature / Date 11/5/2021 EKF/SFFO 1:17,500 scale

