

Kansas Department of Agriculture
 Division of Water Resources
CHANGE: P/U WORKSHEET

1. File Number: 47829	2. Status Change Date:	3. Change Num: 1	4. Field Office: 02	5. GMD:
---------------------------------	------------------------	----------------------------	-------------------------------	---------

6. Status: <input checked="" type="checkbox"/> Approved <input type="checkbox"/> Denied by DWR/GMD <input type="checkbox"/> Dismiss by Request/Failure to Return <i>8/5/21</i>	7. Filing Date of Change: 8/5/21
---	--

8a. Applicant(s) <input type="checkbox"/> New to system <input type="checkbox"/> Person ID <u>58672</u> Add Seq# <u>1</u> BRIAN STAUFFER 20918 W PRETTY PRAIRIE RD ARLINGTON, KS 67514	8c. Landowner(s) <input type="checkbox"/> New to system <input type="checkbox"/> Person ID _____ Add Seq# _____
--	---

8b. Landowner(s) <input type="checkbox"/> New to system <input type="checkbox"/> Person ID <u>58672</u> Add Seq# <u>1</u> BRIAN STAUFFER 20918 W PRETTY PRAIRIE RD ARLINGTON, KS 67514	8d. WUC <input type="checkbox"/> New to system <input type="checkbox"/> Person ID <u>58672</u> Add Seq# <u>1</u> BRIAN STAUFFER 20918 W PRETTY PRAIRIE RD ARLINGTON, KS 67514
--	---

9. Documents and Enclosure(s): DWR Meter(s) Date to Comply: **12/31/21** N & P Date to Comply: _____

Anti-Reverse Meter Meter Seal Check Valve N & P Form Water Tube Driller Copy H & E Letter

Conservation Plan Date Required: _____ Date Approved: _____ Date to Comply: _____

10. Use Made of Water From: _____ To: _____

Date Prepared: **8/5/21** By: **CRC**
 Date Entered: _____ By: _____

RECEIVED

AUG 05 2021

File No. **47829** 11. County: **KINGMAN** Basin: **SF NINNESCAH** Stream: **N/A** Formation Code: **100 Quaternary (red beds)** Special Use: **none**

12. Points of Diversion										Rate and Quantity							
CHK	MOD	DEL	ENT	PDIV	Qualifier	S	T	R	ID	'N	'W	Comment (AKA Line)	Rate gpm	Quantity af	Rate gpm	Quantity af	Overlap PD Files
MOD	78832				NW SE SW	32	28S	9W	2	1186	3780	GEO CTR	800	182	800	182	NONE
MOD	79798				NW SE SW	32	28S	9W	5	1267	3971	BATT 1 OF 3 WELLS					NONE
MOD	79800				NW SE SW	32	28S	9W	6	1289	3681	BATT 2 OF 3 WELLS					NONE
MOD	79801				NW SE SW	32	28S	9W	7	1001	3687	BATT 3 OF 3 WELLS					NONE

13. Storage: Rate _____ NF Quantity _____ ac/ft Additional Rate _____ NF Additional Quantity _____ ac/ft

14. Limitation: _____ af/yr at _____ gpm (_____ cfs) when combined with file number(s) _____
 Limitation: _____ af/yr at _____ gpm (_____ cfs) when combined with file number(s) _____

15. 5YR Allocation: Allocation Type _____ Start Year _____ 5 YR Amount _____ Amount Unit _____ Base Acres _____ Comment _____

16. Place of Use										NE¼								NW¼				SW¼				SE¼				Total	Owner	Chg?	Overlap Files
CHK	MOD	DEL	ENT	PUSE	S	T	R	ID		NE ¼	NW ¼	SW ¼	SE ¼	NE ¼	NW ¼	SW ¼	SE ¼	NE ¼	NW ¼	SW ¼	SE ¼	NE ¼	NW ¼	SW ¼	SE ¼								
MOD	62139				32	28S	9W	02								1.5	1.5	35.5	34.5	32	33					138	See 8b.	NO	NONE				

Base Acres: **still in PP** Year: **ongoing** Minimum Reasonable Quantity: **--**
 Comments: **Note there are no wells being re-drilled, but please modify well locations based on #4 on summary order page.**

Submit completed application to:
 Kansas Department of Agriculture
 Division of Water Resources
 Field Office for your area.

Call for address:
 Topeka -- (785) 296-5733
 Stafford -- (620) 234-5311
 Stockton -- (785) 425-6787
 Garden City -- (620) 276-2901
<http://agriculture.ks.gov/dwr>

DWR FIELD OFFICE APPLICATION FOR APPROVAL TO CHANGE THE PLACE OF USE AND/OR THE POINT OF DIVERSION



STATE OF KANSAS

WATER METER REQUIRED

Filing Fee Must Accompany the Application, K.S.A. 82a-708b(b), as amended.
 Fee Schedule is on the third page of this application form.

Paragraph Nos. 1, 2, 3 & 5 must be completed. Complete all other applicable portions. If change in point of diversion is greater than 100 feet, or if place of use will be changed, include a topographic map or detailed plat showing the authorized and proposed point(s) of diversion and/or place of use.

RECEIVED
 9:48am
 AUG 05 2021

File No. 47829

1. Application is hereby made for approval of the Chief Engineer to change the (check one or both):

Place of Use Point of Diversion

Stafford Field Office
 Division of Water Resources

under the water right which is the subject of this application in accordance with the conditions described below.

The source of supply is: Groundwater Surface water

2. Name and address of Applicant: Brian Stauffer

20918 W Pretty Prairie Rd, Arlington KS 67514

Phone Number: (620)596-2535

Email address: _____

Name and address of Water Use Correspondent: Brian Stauffer

20918 W Pretty Prairie Rd, Arlington KS 67514

Phone Number: (620)596-2535

Email address: _____

3. The presently authorized place of use is:

Owner of Land ---- NAME: Brian Stauffer

ADDRESS: 20918 W Pretty Prairie Rd, Arlington KS 67514

(If there is more than one landowner, attach supplemental sheets as necessary.)

Sec.	Twp.	Range	NE¼				NW¼				SW¼				SE¼				TOTAL ACRES	
			NE¼	NW¼	SW¼	SE¼	NE¼	NW¼	SW¼	SE¼	NE¼	NW¼	SW¼	SE¼	NE¼	NW¼	SW¼	SE¼		
32	28S	9W									32.5	32.5	32.5	32.5					130	

4. If this application is for a change in place of use, it is proposed that the place of use be changed to:

Owner of Land ---- NAME: Brian Stauffer

ADDRESS: 20918 W Pretty Prairie Rd, Arlington KS 67514

(If there is more than one landowner, attach supplemental sheets as necessary.)

Sec.	Twp.	Range	NE¼				NW¼				SW¼				SE¼				TOTAL ACRES	
			NE¼	NW¼	SW¼	SE¼	NE¼	NW¼	SW¼	SE¼	NE¼	NW¼	SW¼	SE¼	NE¼	NW¼	SW¼	SE¼		
32	28S	9W							1.5	1.5	35.5	34.5	32	33					138	

For Office Use Only: Code GPU Fee \$ 200.00 TR # _____ Receipt Date _____ Check # 3028

5. **Presently authorized point of diversion: A Battery of three (3) Wells**
 One in the NW Quarter of the SE Quarter of the SW Quarter of Section 32, Township 28 South, Range 9 W, in Kingman County, Kansas, 1,206 feet North 3,747 feet West of Southeast corner of section. Authorized Rate 800 gpm Authorized Quantity 182 AF Depth of well N/A (feet)
(DWR use only: Computer ID No. 02 GPS 1,186 feet North 3,780 feet West)
 This point will not be changed This point will be changed as follows: No change, point better described with GPS as follows:
Proposed point of diversion: (Complete only if change is requested or if existing point is better described by GPS)
 One in the NW Quarter of the SE Quarter of the SW Quarter of Section 32, Township 28 South, Range 9 W, in Kingman County, Kansas, 1,186 feet North 3,780 feet West of Southeast corner of section. Proposed Rate no change Proposed Quantity no change Proposed well depth (feet) N/A.
 This point is: Additional Well Geo Center List other water rights that will use this point None

6. **Presently authorized point of diversion:**
 One in the _____ Quarter of the _____ Quarter of the _____ Quarter of Section _____, Township _____ South, Range _____ (E/W), in _____ County, Kansas, _____ feet North _____ feet West of Southeast corner of section. Authorized Rate _____ Authorized Quantity _____ Depth of well _____ (feet)
(DWR use only: Computer ID No. _____ GPS _____ feet North _____ feet West)
 This point will not be changed This point will be changed as follows: No change, point better described with GPS as follows:
Proposed point of diversion: (Complete only if change is requested or if existing point is better described by GPS)
 One in the _____ Quarter of the _____ Quarter of the _____ Quarter of Section _____, Township _____ South, Range _____ (E/W), in _____ County, Kansas, _____ feet North _____ feet West of Southeast corner of section. Proposed Rate _____ Proposed Quantity _____ Proposed well depth (feet) _____.
 This point is: Additional Well Geo Center List other water rights that will use this point _____

7. The changes herein are desired for the following reasons?
 (please be specific) Modify the place of use to include unauthorized acres being irrigated.

8. If a well, is the test hole log attached? Yes No

9. The change(s) (was)(will be) completed by?
upon approval of change application

10. If the point of diversion is a well:
 (a) What are you going to do with the old well?
N/A
 (b) When will this be done? N/A

11. Groundwater Management District recommendation attached?
 Yes No

12. Assisted by EKF/SFFO

13a. If the proposed point of diversion will be relocated more than 300 feet but within 2,640 feet of the existing point of diversion, attach a topographic map or aerial photograph. For groundwater sources, show all wells (including domestic) within one-half mile of the proposed point of diversion and the names and mailing addresses of the owners. For surface water sources, show the names and addresses of the landowner(s) one-half mile downstream and one-half mile upstream from your property lines

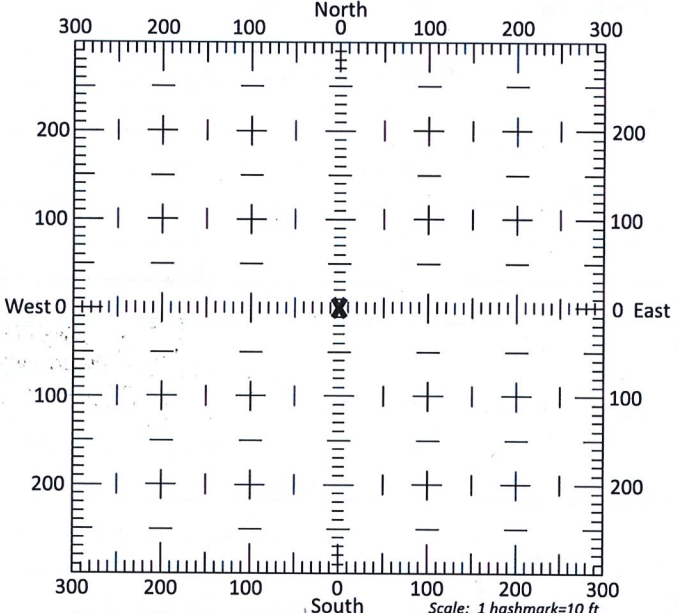

13b. If the proposed point of diversion will be relocated within 300 feet of the existing point of diversion, indicate its location on the diagram shown above in relation to the existing point of diversion. (PLEASE NOTE: The "X" in center of diagram above represents the presently authorized point of diversion.)

RECEIVED

AUG 05 2021

14. If the proposed groundwater point of diversion is 300 or fewer feet from the existing point of diversion, complete the following:

- (a) Does the undersigned represent all owners of the currently authorized place(s) of use identified in this application?
 Yes No (If no, all owners must sign this application.)
- (b) Will the ownership interest of any owner of the currently authorized place(s) of use identified in this application be adversely affected if this application is approved as requested?
 Yes No (If yes, all owners must sign this application.)
- (c) If this application is not approved expeditiously, will there be substantial damage to property, public health or safety?
 Yes No (If no, all owners must sign this application.)

If the application proposes a surface water change in point of diversion, a groundwater change in point of diversion greater than 300 feet, or a change in place of use, the application must be signed by all owners of the currently authorized place of use, or their duly authorized agent (attach notarized statement authorizing representation).

I hereby verify, being first duly sworn upon my oath or affirmation and under penalty of perjury, that I am of lawful age and the owner, the spouse of the owner, or a duly authorized agent of the owner(s) to make this application on their behalf, in regards to the water right(s) to which this application pertains. I further verify that the statements contained in this application are true, correct and complete.

Dated at _____, Kansas, this 3 day of August, 20 21.

<i>Brian Stauffer</i>	
(Owner)	(Spouse)
Brian Stauffer	
(Please Print)	(Please Print)
(Owner)	(Spouse)
(Please Print)	(Please Print)
(Owner)	(Spouse)
(Please Print)	(Please Print)

State of Kansas }
County of Reno } SS

I hereby certify that the foregoing application was signed in my presence and sworn to before me this 3 day of August, 20 21.

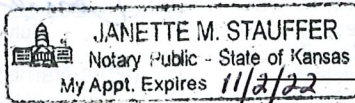

Janette M. Stauffer
Notary Public

My Commission Expires 11/2/22

ONLY COMPLETE APPLICATIONS WILL BE PROCESSED. To be complete, all of the applicable portions of the application form must be completed with accurate information; maps, if necessary, must be included; signatures of all the appropriate owners' must be affixed to the application and notarized; and the appropriate fee must be paid.

FEE SCHEDULE

Each application to change the place of use or the point of diversion under this section shall be accompanied by the application fee set forth in the schedule below: Make checks payable to: **Kansas Department of Agriculture**

- (1) Application to change a point of diversion 300 feet or less \$100
- (2) Application to change a point of diversion more than 300 feet \$200
- (3) Application to change the place of use \$200

RECEIVED

AUG 05 2021

Stafford Field Office
Division of Water Resources

File No. 47829

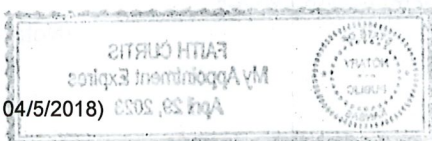

SUMMARY ORDER APPROVING APPLICATION FOR CHANGE AND IMPOSING CONDITIONS

This Summary Order is issued under authority of K.S.A. 82a-708b, as amended, and K.A.R. 5-5-1, *et seq.* and other applicable provisions of the *Kansas Water Appropriation Law, K.S.A. 82a-701 et. seq.*, and rules and regulations promulgated thereunder, With the exception of those conditions expressly contained herein, this Summary Order does not change the terms, conditions and limitations of File No. 47829.

1. A change application was received on August 5, 2021 requesting that the place of use and / or point of diversion authorized under the above-referenced file number be changed as described in the application.
2. On and after the effective date of this summary order, the authorized place(s) of use shall be located substantially as shown on the topographic map accompanying the application to change the place of use. Applicable Not Applicable
3. The change in point of diversion shall not impair existing rights and shall be limited to the same source or sources of water as previously authorized. The point of diversion authorized by this summary order shall be located within a _____ foot radius of the authorized point(s) of diversion. Applicable Not Applicable
4. The point(s) of diversion described herein is administratively corrected to be more accurately described using the Global Positioning System (GPS), as described in the application. Applicable Not Applicable
5. The point(s) of diversion authorized herein shall not actually be located more than _____ feet from the previously authorized point(s) of diversion. Applicable Not Applicable
6. As required by K.A.R. 5-3-5d, if the works for diversion is a well with a diversion rate of 100 gallons per minute or more, a tube or other device suitable for making water level measurements shall be installed, operated and maintained in accordance with K.A.R. 5-6-13. Applicable Not Applicable
7. **The owner of the authorized place(s) of use shall properly install an acceptable water flow meter on or before December 31, 2021**, or before the first use of water, whichever occurs first. The water flow meter shall be installed, operated and maintained in accordance with K.A.R. 5-1-4 through 5-1-12. As required by K.S.A. 82a-732, as amended, and K.A.R. 5-3-5e, the owner shall maintain records and report the reading of the water flow meter and the total quantity of water diverted annually to the Chief Engineer by March 1 following the end of each calendar year. Applicable Not Applicable
8. **Installation of the works for diversion of water shall be completed on or before December 31, 20____**, or within any authorized extension of time. By March 1, 20____ the applicant shall notify the Chief Engineer that construction of the works for diversion has been completed, on the form provided by the Chief Engineer, as required by K.A.R. 5-8-4e. Applicable Not Applicable
9. **The completed well log shall be submitted with the required notice.** Applicable Not Applicable
10. All diversion works into which any type of chemical or other foreign substance will be injected into the water shall be equipped with an in-line, automatic, quick-closing check valve capable of preventing pollution of the source of the water supply. The check valve(s) shall be installed, operated and maintained in accordance with K.A.R. 5-3-5c. Applicable Not Applicable
11. Additional Conditions are attached. Yes No
12. In accordance with K.S.A. 82a-708a, as amended, and K.A.R. 5-5-14, all of the owners of the authorized place(s) of use of water appropriated under the above-referenced file number are responsible for compliance with its terms, conditions and limitations, as amended and/or supplemented by this Summary Order, and with applicable provisions of the *Kansas Water Appropriation Law* and the *Rules and Regulations* promulgated thereunder. Failure to comply with these provisions may result in civil penalties pursuant to K.S.A. 82a-737, as amended, and/or the suspension or revocation and dismissal of the water or appropriation right or any other enforcement actions authorized by law.

Administrative Appeal and Effective Date of Order

If you are aggrieved by this order, pursuant to K.S.A. 82a-1901, you may request an evidentiary hearing before the Chief Engineer or request administrative review by the Secretary of Agriculture. A request for hearing by the Chief Engineer must be filed within **15 days** of service of this Order and a request for administrative review by the Secretary must be filed within **30 days** pursuant to K.S.A. 77-531. Any request for administrative review must state a basis for review pursuant to K.S.A. 77-527. File any request with **Kansas Department of Agriculture, Legal Division, 1320 Research Park Drive, Manhattan, KS 66502**. Failure to timely request a hearing or review may preclude review under the Kansas Judicial Review Act.

For Use by Register of Deeds

FOR OFFICE USE ONLY
APPLICATION APPROVED AND SUMMARY ORDER ISSUED

By: Cameron R. Conant
Duly Authorized Designee of the Chief Engineer
(Print Name): Cameron R. Conant
Division of Water Resources - Kansas Department of Agriculture
Date of Issuance: August 5, 2021
State of Kansas)
County of Stafford) SS
Acknowledged before me on 8/5/2021
by Faith Curtis
Signature: Faith Curtis
Notary Public

My commission expires: _____



RECEIVED

AUG 05 2021

Stafford Field Office
Division of Water Resources

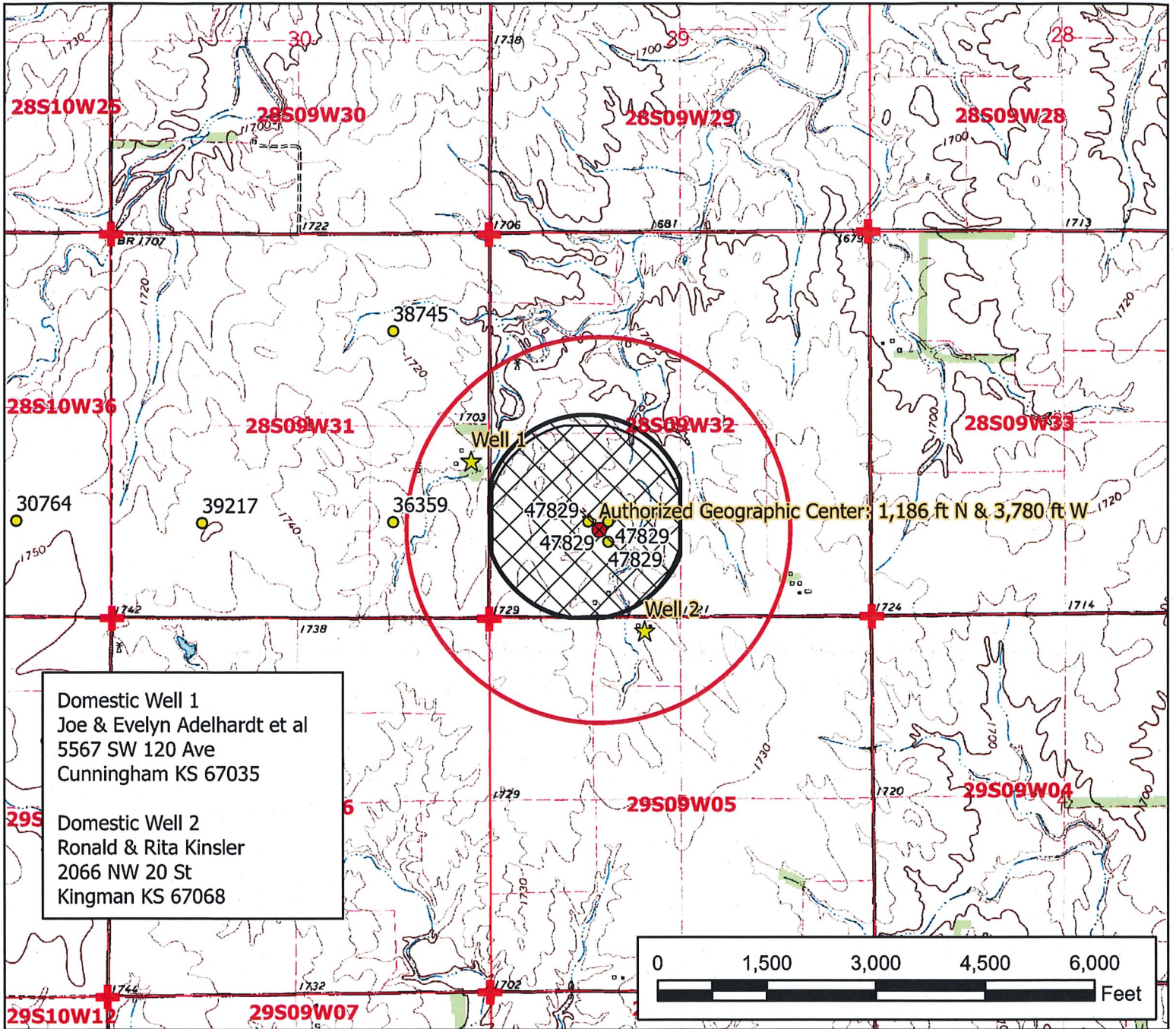

Domestic Well 1
 Joe & Evelyn Adelhardt et al
 5567 SW 120 Ave
 Cunningham KS 67035

Domestic Well 2
 Ronald & Rita Kinsler
 2066 NW 20 St
 Kingman KS 67068

- Legend**
- Water Appropriation
 - ⊗ Authorized Geographic Center
 - ★ Domestic Well
 - ⊕ Section Corner
 - Section Line
 - Half Mile Circle
 - ▨ Authorized Place of Use
 - ▧ Proposed Place of Use

Water Appropriation, File No. 47829

Application to Change the Place of Use Map 32-28-9W //Kingman County

To the best of my knowledge, all wells within one-half mile of the authorized point of diversion have been shown.

RECEIVED
 AUG 05 2021

Stafford Field Office
 Division of Water Resources



Steve Stouffer
 Signature / Date 8-3-21

7/21/2021 EKF/SFFO 1:24,000 scale

Stafford Field Office
300 S. Main Street
Stafford, KS 67578-1521



Phone: 620-234-5311
Fax: 620-234-6900
www.agriculture.ks.gov

Mike Beam, Secretary

Laura Kelly, Governor

August 5, 2021

Brian Stauffer
20918 W Pretty Prairie Rd
Arlington, KS 67514

Re: Water Right, File No(s). 47829

Dear Water Right Owner:

Enclosed is the order executed by the Chief Engineer, Division of Water Resources, Kansas Department of Agriculture, approving the application for change under the above referenced file number(s).

Your attention is directed to the enclosures and to the terms, conditions and limitations specified in this approval for change. An acceptable water flow meter must be installed on your well before any water is applied as authorized under this change approval. A copy of the approved list of Certified Water Flowmeters as well as the regulations regarding the installation of flowmeters, measurement tubes and check valves can be found at www.ksda.gov/includes/document_center/dwr/Forms/ApprovalPack.pdf. If you do not have access to the internet, please contact this office and we will send you a paper copy of the referenced information.

Since this order modifies the original document referred to above, it should be recorded with the Register of Deeds as other instruments affecting real estate.

Should you have any questions, please feel free to contact this office. If you wish to refer to a specific file, please reference it when you contact us.

Sincerely,

A handwritten signature in black ink that reads "Jeff Lanterman".

Jeff Lanterman
Water Commissioner

Enclosures

pc: Water Rights Section
Groundwater Management District No.

CERTIFICATE OF SERVICE

On this **5 August 2021**, I hereby certify that the attached Change in Place of Use, File No. 47829 dated 8/5/2021 was mailed to the following:

Brian Stauffer
20918 W Pretty Prairie Rd
Arlington, KS 67514

pc: Water Rights Section



Staff



KANSAS DEPARTMENT OF AGRICULTURE

Division of Water Resources

Stafford Field Office

MEMORANDUM

TO: File

DATE: 8/5/2021

FROM: Cameron R. Conant

RE: File No. 47829

This is a memorandum regarding surrounding well owner notification on irrigation field office PU changes and pertains to decisions made during the Water Commissioner meeting which took place on 11/16/2016. With directive from Lane Letourneau Program Manager.

This is applicable to field office changes to increase the place of use by 10 acres or 10% (whichever is less) or a change in place of use to create a complete overlap in which no new acres are being irrigated.

During that meeting it was determined that no surrounding well owner notification will be sent under this type of Place of Use change. All well rates and quantities will remain unchanged and the referenced change will not cause impairment or impact surrounding well owners.

The change in place of use filed on 8/5/2021 for the above referenced file meets this criteria and surrounding well owners will not be notified.