

Submit completed application to:
 Kansas Department of Agriculture
 Division of Water Resources
 Field Office for your area.
 Call for address:
 Topeka -- (785) 296-5733
 Stafford -- (620) 234-5311
 Stockton -- (785) 425-6787
 Garden City -- (620) 276-2901
<http://agriculture.ks.gov/dwr>

DWR FIELD OFFICE APPLICATION FOR APPROVAL TO CHANGE THE PLACE OF USE AND/OR THE POINT OF DIVERSION WATER METER REQUIRED



STATE OF KANSAS

Filing Fee Must Accompany the Application, K.S.A. 82a-708b(b), as amended.
 Fee Schedule is on the third page of this application form.

Paragraph Nos. 1, 2, 3 & 5 must be completed. Complete all other applicable portions. If change in point of diversion is greater than 100 feet, or if place of use will be changed, include a topographic map or detailed plat showing the authorized and proposed point(s) of diversion and/or place of use.

 File No. 17508

RECEIVED
 1:30 PM
 MAY 26 2022

Stafford Field Office
 DIVISION OF WATER RESOURCES

1. Application is hereby made for approval of the Chief Engineer to change the (check one or both):

Place of Use Point of Diversion

under the water right which is the subject of this application in accordance with the conditions described below.

The source of supply is: Groundwater Surface water

2. Name and address of Applicant: Shirley Price * John G. Price, Jr. and Shirley J. Price Revocable Trust
2965 I RD, Rozel, KS 67574-7413
 Phone Number: (620)923-5140 *SP Email address: tawelsch@cox.net
 Name and address of Water Use Correspondent: *John G & Shirley J Price Rev Trust, Attn: John Jr & Shirley TTEE
Attn: John Jr & Shirley TTEE, 2965 I RD, Rozel, KS 67574-7413
 Phone Number: (620)923-5140 Email address: tawelsch@cox.net

3. The presently authorized place of use is: *SP
 Owner of Land ---- NAME: John G & Shirley J Price Rev Trust, Attn: John Jr & Shirley TTEE
 ADDRESS: Attn: John Jr & Shirley TTEE, 2965 I RD, Rozel, KS 67574-7413
 (If there is more than one landowner, attach supplemental sheets as necessary.)

Sec.	Twp.	Range	NE¼				NW¼				SW¼				SE¼				TOTAL ACRES
			NE¼	NW¼	SW¼	SE¼	NE¼	NW¼	SW¼	SE¼	NE¼	NW¼	SW¼	SE¼	NE¼	NW¼	SW¼	SE¼	
19	22S	19W									40			38			30	29	137

4. If this application is for a change in place of use, it is proposed that the place of use be changed to:
 Owner of Land ---- NAME: NO CHANGE
 ADDRESS: NO CHANGE
 (If there is more than one landowner, attach supplemental sheets as necessary.)

Sec.	Twp.	Range	NE¼				NW¼				SW¼				SE¼				TOTAL ACRES
			NE¼	NW¼	SW¼	SE¼	NE¼	NW¼	SW¼	SE¼	NE¼	NW¼	SW¼	SE¼	NE¼	NW¼	SW¼	SE¼	

For Office Use Only: Code CLT Fee \$ 100 TR # _____ Receipt Date _____ Check # 5354

5. **Presently authorized point of diversion:**
 One in the -- Quarter of the -- Quarter of the Lot 4 Quarter
 of Section 19 , Township 22 South, Range 19 (W),
 in Pawnee County, Kansas, 340 feet North 4100 feet West of Southeast corner of section.
 Authorized Rate 935 GPM Authorized Quantity 150 acre-feet Depth of well ~220 (feet)
(DWR use only: Computer ID No. 4 GPS 378 feet North 4129 feet West)
 This point will not be changed This point will be changed as follows: No change, point better described with GPS as follows:
Proposed point of diversion: (Complete only if change is requested or if existing point is better described by GPS)
 One in the -- Quarter of the -- Quarter of the Lot 4 Quarter
 of Section 19 , Township 22 South, Range 19 (W),
 in Pawnee County, Kansas, 358 feet North 4129 feet West of Southeast corner of section.
 Proposed Rate no chang Proposed Quantity no change Proposed well depth (feet) ~220 .
 This point is: Additional Well Geo Center List other water rights that will use this point none .

6. **Presently authorized point of diversion:**
 One in the Quarter of the Quarter of the Quarter
 of Section , Township South, Range (E/W),
 in County, Kansas, feet North feet West of Southeast corner of section.
 Authorized Rate Authorized Quantity Depth of well (feet)
(DWR use only: Computer ID No. GPS feet North feet West)
 This point will not be changed This point will be changed as follows: No change, point better described with GPS as follows:
Proposed point of diversion: (Complete only if change is requested or if existing point is better described by GPS)
 One in the Quarter of the Quarter of the Quarter
 of Section , Township South, Range (E/W),
 in County, Kansas, feet North feet West of Southeast corner of section.
 Proposed Rate Proposed Quantity Proposed well depth (feet) .
 This point is: Additional Well Geo Center List other water rights that will use this point .

7. The changes herein are desired for the following reasons?
 (please be specific) The old well has lost production and
needs to be replaced.

8. If a well, is the test hole log attached? Yes No

9. The change(s) (was)(will be) completed by?
as soon as possible

10. If the point of diversion is a well:
 (a) What are you going to do with the old well?
plug it

(b) When will this be done? when the new well is complete

11. Groundwater Management District recommendation attached?
 Yes No

12. Assisted by CRC-SFFO

13a. If the proposed point of diversion will be relocated more than 300
feet but within 2,640 feet of the existing point of diversion, attach
 a topographic map or aerial photograph. For groundwater
 sources, show all wells (including domestic) within one-half mile
 of the proposed point of diversion and the names and mailing
 addresses of the owners. For surface water sources, show the
 names and addresses of the landowner(s) one-half mile
 downstream and one-half mile upstream from your property
 lines

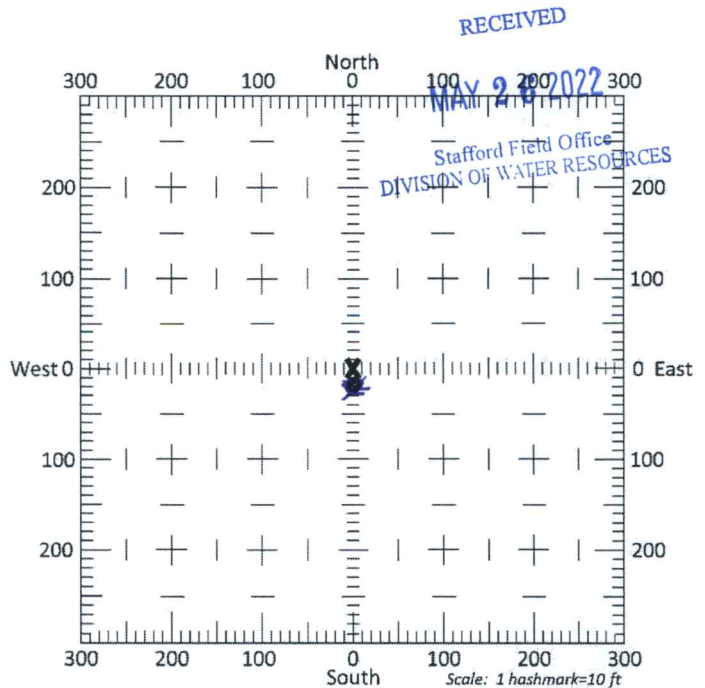

13b. If the proposed point of diversion will be relocated within 300 feet
 of the existing point of diversion, indicate its location on the
 diagram shown above in relation to the existing point of
 diversion. **(PLEASE NOTE: The "X" in center of diagram
 above represents the presently authorized point of
 diversion.)**

14. If the proposed groundwater point of diversion is 300 or fewer feet from the existing point of diversion, complete the following:

- (a) Does the undersigned represent all owners of the currently authorized place(s) of use identified in this application?
 Yes No (If no, all owners must sign this application.)
- (b) Will the ownership interest of any owner of the currently authorized place(s) of use identified in this application be adversely affected if this application is approved as requested?
 Yes No (If yes, all owners must sign this application.)
- (c) If this application is not approved expeditiously, will there be substantial damage to property, public health or safety?
 Yes No (If no, all owners must sign this application.)

If the application proposes a surface water change in point of diversion, a groundwater change in point of diversion greater than 300 feet, or a change in place of use, the application must be signed by all owners of the currently authorized place of use, or their duly authorized agent (attach notarized statement authorizing representation).

I hereby verify, being first duly sworn upon my oath or affirmation and under penalty of perjury, that I am of lawful age and the owner, the spouse of the owner, or a duly authorized agent of the owner(s) to make this application on their behalf, in regards to the water right(s) to which this application pertains. I further verify that the statements contained in this application are true, correct and complete.

Dated at Hays, Kansas, this 26th day of May, 2022.

<u>Shirley J. Price</u> (Owner)	_____	(Spouse)
<u>Shirley J. Price</u> (Please Print)	_____	(Please Print)
_____	_____	(Spouse)
(Owner)	_____	(Please Print)
(Please Print)	_____	(Spouse)
(Owner)	_____	(Please Print)
(Please Print)	_____	(Spouse)
(Owner)	_____	(Please Print)

State of Kansas }
County of Ellis } SS

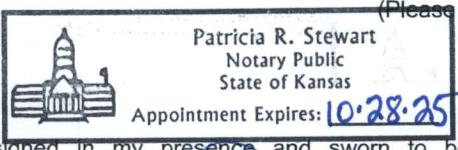

I hereby certify that the foregoing application was signed in my presence and sworn to before me this 26th day of May, 2022.

Patricia R Stewart
Notary Public

My Commission Expires 10.28-2025

ONLY COMPLETE APPLICATIONS WILL BE PROCESSED. To be complete, all of the applicable portions of the application form must be completed with accurate information; maps, if necessary, must be included; signatures of all the appropriate owners' must be affixed to the application and notarized; and the appropriate fee must be paid.

FEE SCHEDULE

Each application to change the place of use or the point of diversion under this section shall be accompanied by the application fee set forth in the schedule below: Make checks payable to: **Kansas Department of Agriculture**

- (1) Application to change a point of diversion 300 feet or less \$100
- (2) Application to change a point of diversion more than 300 feet \$200
- (3) Application to change the place of use \$200

RECEIVED
MAY 26 2022
Stafford Field Office
DIVISION OF WATER RESOURCES

SUMMARY ORDER APPROVING APPLICATION FOR CHANGE AND IMPOSING CONDITIONS

This Summary Order is issued under authority of K.S.A. 82a-708b, as amended, and K.A.R. 5-5-1, *et seq.* and other applicable provisions of the *Kansas Water Appropriation Law, K.S.A. 82a-701 et. seq.*, and rules and regulations promulgated thereunder, With the exception of those conditions expressly contained herein, this Summary Order does not change the terms, conditions and limitations of File No. 17508

1. A change application was received on May 26, 2022 requesting that the place of use and / or point of diversion authorized under the above-referenced file number be changed as described in the application.
2. On and after the effective date of this summary order, the authorized place(s) of use shall be located substantially as shown on the topographic map accompanying the application to change the place of use. Applicable Not Applicable
3. The change in point of diversion shall not impair existing rights and shall be limited to the same source or sources of water as previously authorized. The point of diversion authorized by this summary order shall be located within a 50 foot radius of the authorized point(s) of diversion. Applicable Not Applicable
4. The point(s) of diversion described herein is administratively corrected to be more accurately described using the Global Positioning System (GPS), as described in the application. Applicable Not Applicable
5. The point(s) of diversion authorized herein shall not actually be located more than 70 feet from the previously authorized point(s) of diversion. Applicable Not Applicable
6. As required by K.A.R. 5-3-5d, if the works for diversion is a well with a diversion rate of 100 gallons per minute or more, a tube or other device suitable for making water level measurements shall be installed, operated and maintained in accordance with K.A.R. 5-6-13. Applicable Not Applicable
7. **The owner of the authorized place(s) of use shall properly install an acceptable water flow meter on or before December 31, 2022**, or before the first use of water, whichever occurs first. The water flow meter shall be installed, operated and maintained in accordance with K.A.R. 5-1-4 through 5-1-12. As required by K.S.A. 82a-732, as amended, and K.A.R. 5-3-5e, the owner shall maintain records and report the reading of the water flow meter and the total quantity of water diverted annually to the Chief Engineer by March 1 following the end of each calendar year. Applicable Not Applicable
8. **Installation of the works for diversion of water shall be completed on or before December 31, 2022**, or within any authorized extension of time. By March 1, 2023 the applicant shall notify the Chief Engineer that construction of the works for diversion has been completed, on the form provided by the Chief Engineer, as required by K.A.R. 5-8-4e. Applicable Not Applicable
9. **The completed well log shall be submitted with the required notice.** Applicable Not Applicable
10. All diversion works into which any type of chemical or other foreign substance will be injected into the water shall be equipped with an in-line, automatic, quick-closing check valve capable of preventing pollution of the source of the water supply. The check valve(s) shall be installed, operated and maintained in accordance with K.A.R. 5-3-5c. Applicable Not Applicable
11. Additional Conditions are attached. Yes No
12. In accordance with K.S.A. 82a-708a, as amended, and K.A.R. 5-5-14, all of the owners of the authorized place(s) of use of water appropriated under the above-referenced file number are responsible for compliance with its terms, conditions and limitations, as amended and/or supplemented by this Summary Order, and with applicable provisions of the *Kansas Water Appropriation Law* and the *Rules and Regulations* promulgated thereunder. Failure to comply with these provisions may result in civil penalties pursuant to K.S.A. 82a-737, as amended, and/or the suspension or revocation and dismissal of the water or appropriation right or any other enforcement actions authorized by law.

Administrative Appeal and Effective Date of Order

If you are aggrieved by this order, pursuant to K.S.A. 82a-1901, you may request an evidentiary hearing before the Chief Engineer or request administrative review by the Secretary of Agriculture. A request for hearing by the Chief Engineer must be filed within **15 days** of service of this Order and a request for administrative review by the Secretary must be filed within **30 days** pursuant to K.S.A. 77-531. Any request for administrative review must state a basis for review pursuant to K.S.A. 77-527. File any request with **Kansas Department of Agriculture, Legal Division, 1320 Research Park Drive, Manhattan, KS 66502**. Failure to timely request a hearing or review may preclude review under the Kansas Judicial Review Act.

For Use by Register of Deeds

FOR OFFICE USE ONLY
APPLICATION APPROVED AND SUMMARY ORDER ISSUED

By: Cameron R. Grant

 Duly Authorized Designee of the Chief Engineer
 (Print Name): Cameron R. Grant

 Division of Water Resources - Kansas Department of Agriculture

Date of Issuance: May 26, 2022

State of Kansas)

County of Stafford) SS

Acknowledged before me on May 26th 2022
 by Cameron Grant

Signature: Chelsi Snodgrass

 Notary Public

My commission expires: May 13, 2024

 (Notary Seal)

