

NOTICE

This scan only represents the application as filed. The information contained herein meets the requirements of K.A.R. 5-3-1 or K.A.R. 5-5-1, and has been found acceptable for filing in the office of the Chief Engineer. The application should not be considered to be a complete application as per K.A.R. 5-3-1b or K.A.R. 5-5-2a.



THE STATE OF KANSAS

WATER RESOURCES RECEIVED

AUG 15 2022 1:57

KS DEPT OF AGRICULTURE

KANSAS DEPARTMENT OF AGRICULTURE Mike Beam, Secretary of Agriculture

DIVISION OF WATER RESOURCES Earl D. Lewis Jr., Chief Engineer

50844

File Number This item to be completed by the Division of Water Resources.

APPLICATION FOR PERMIT TO APPROPRIATE WATER FOR BENEFICIAL USE

Filing Fee Must Accompany the Application (Please refer to Fee Schedule attached to this application form.)

To the Chief Engineer of the Division of Water Resources, Kansas Department of Agriculture, 1320 Research Park Drive, Manhattan, Kansas 66502:

1. Name of Applicant (Please Print): William Lehman Address: 373 26th Rd City: Little River State KS Zip Code 67457 Telephone Number: (316) 214-4607

2. The source of water is: [X] surface water in Unnamed Trib Horse Creek (Little Arkansas) (stream) OR [] groundwater in (drainage basin)

Certain streams in Kansas have minimum target flows established by law or may be subject administration when water is released from storage for use by water assurance district members. If your application is subject to these regulations on the date we receive your application, you will be sent the appropriate form to complete and return to the Division of Water Resources.

3. The maximum quantity of water desired is 47.09 acre-feet OR gallons per calendar year, to be diverted at a maximum rate of NF gallons per minute OR cubic feet per second.

Once your application has been assigned a priority, the requested maximum rate of diversion and maximum requested quantity of water under that priority number can NOT be increased. Please be certain your requested maximum rate of diversion and maximum quantity of water are appropriate and reasonable for your proposed project and are in agreement with the Division of Water Resources' requirements.

4. The water is intended to be appropriated for (Check use intended): (a) [] Artificial Recharge (b) [] Irrigation (c) [X] Recreational (d) [] Water Power (e) [] Industrial (f) [] Municipal (g) [] Stockwatering (h) [] Sediment Control (i) [] Domestic (j) [] Dewatering (k) [] Hydraulic Dredging (l) [] Fire Protection (m) [] Thermal Exchange (n) [] Contamination Remediation

8/24/2022 LMoody

YOU MUST COMPLETE AND ATTACH ADDITIONAL DIVISION OF WATER RESOURCES FORM(S) PROVIDING INFORMATION TO SUBSTANTIATE YOUR REQUEST FOR THE AMOUNT OF WATER FOR THE INTENDED USE REFERENCED ABOVE.

For Office Use Only: F.O. 2 GMD Meets K.A.R. 5-3-1 (YES/NO) Use REC Source G/S County RC By BMM Date 8/15/22 Code REG Fee \$ 200 TR # Receipt Date 8/15/22 Check # 3481

5. The location of the proposed wells, pump sites or other works for diversion of water is:

Note: For the application to be accepted, the point of diversion location must be described to at least a 10 acre tract, unless you specifically request a 60 day period of time in which to locate the site within a specifically described, minimal legal quarter section of land.

(A) One in the NE quarter of the SW quarter of the SE quarter of Section 18, more particularly described as being near a point 689 feet North and 1587 feet West of the Southeast corner of said section, in Township 18 South, Range 6 West, Rice County, Kansas.

(B) One in the _____ quarter of the _____ quarter of the _____ quarter of Section _____, more particularly described as being near a point _____ feet North and _____ feet West of the Southeast corner of said section, in Township _____ South, Range _____, _____ County, Kansas.

(C) One in the _____ quarter of the _____ quarter of the _____ quarter of Section _____, more particularly described as being near a point _____ feet North and _____ feet West of the Southeast corner of said section, in Township _____ South, Range _____, _____ County, Kansas.

(D) One in the _____ quarter of the _____ quarter of the _____ quarter of Section _____, more particularly described as being near a point _____ feet North and _____ feet West of the Southeast corner of said section, in Township _____ South, Range _____, _____ County, Kansas.

If the source of supply is groundwater, a separate application shall be filed for each proposed well or battery of wells, except that a single application may include up to four wells within a circle with a quarter (1/4) mile radius in the same local source of supply which do not exceed a maximum diversion rate of 20 gallons per minute per well.

A battery of wells is defined as two or more wells connected to a common pump by a manifold; or not more than four wells in the same local source of supply within a 300 foot radius circle which are being operated by pumps not to exceed a total maximum diversion rate of 800 gallons per minute and which supply water to a common distribution system.

6. The owner of the point of diversion, if other than the applicant is (please print):

(name, address and telephone number)

(name, address and telephone number)

You must provide evidence of legal access to, or control of, the point of diversion from the landowner or the landowner's authorized representative. Provide a copy of a recorded deed, lease, easement or other document with this application. In lieu thereof, you may sign the following sworn statement:

I have legal access to, or control of, the point of diversion described in this application from the landowner or the landowner's authorized representative. I declare under penalty of perjury that the foregoing is true and correct.

Executed on August 12, 2022 
Applicant's Signature

The applicant must provide the required information or signature irrespective of whether they are the landowner. Failure to complete this portion of the application will cause it to be unacceptable for filing and the application will be returned to the applicant.

7. The proposed project for diversion of water will consist of 1 pond, 1 dam
(number of wells, pumps or dams, etc.)
and was completed 2013
(Month/Day/Year - each was or will be completed)

8. The first actual application of water for the proposed beneficial use was or is estimated to be 2013
(Mo/Day/Year)

WATER RESOURCES RECEIVED
AUG 15 2022
KS DEPT OF AGRICULTURE

9. Will pesticide, fertilizer, or other foreign substance be injected into the water pumped from the diversion works?
 Yes No If "yes", a check valve shall be required.

All chemigation safety requirements must be met including a chemigation permit and reporting requirements.

10. If you are planning to impound water, please contact the Division of Water Resources for assistance, prior to submitting the application. Please attach a reservoir area capacity table and inform us of the total acres of surface drainage area above the reservoir.

Have you also made an application for a permit for construction of this dam and reservoir with the Division of Water Resources? Yes No

- If yes, show the Water Structures permit number here LRC-0056
- If no, explain here why a Water Structures permit is not required _____

11. The application must be supplemented by a U.S.G.S. topographic map, aerial photograph or a detailed plat showing the following information. On the topographic map, aerial photograph, or plat, identify the center of the section, the section lines or the section corners and show the appropriate section, township and range numbers. Also, please show the following information:

- (a) The location of the proposed point(s) of diversion (wells, stream-bank installations, dams, or other diversion works) should be plotted as described in Paragraph No. 5 of the application, showing the North-South distance and the East-West distance from a section line or southeast corner of section.
- (b) If the application is for groundwater, please show the location of any existing water wells of any kind within ½ mile of the proposed well or wells. Identify each existing well as to its use and furnish the name and mailing address of the property owner or owners. If there are no wells within ½ mile, please advise us.
- (c) If the application is for surface water, the names and addresses of the landowner(s) ½ mile downstream and ½ mile upstream from your property lines must be shown.
- (d) The location of the proposed place of use should be shown by crosshatching on the topographic map, aerial photograph or plat.
- (e) Show the location of the pipelines, canals, reservoirs or other facilities for conveying water from the point of diversion to the place of use.

A 7.5 minute U.S.G.S. topographic map may be obtained by providing the section, township and range numbers to: Kansas Geological Survey, 1930 Constant, Campus West, University of Kansas, Lawrence, Kansas 66047.

12. List any application, appropriation of water, water right, or vested right file number that covers the same diversion points or any of the same place of use described in this application. Also list any other recent modifications made to existing permits or water rights in conjunction with the filing of this application.

WATER RESOURCES
RECEIVED

AUG 15 2022

KS DIVISION OF WATER RESOURCES

13. Furnish the following well information if the proposed appropriation is for the use of groundwater. If the well has not been completed, give information obtained from test holes, if available.

Information below is from: Test holes Well as completed Drillers log attached

Well location as shown in paragraph No.	(A)	(B)	(C)	(D)
Date Drilled	_____	_____	_____	_____
Total depth of well	_____	_____	_____	_____
Depth to water bearing formation	_____	_____	_____	_____
Depth to static water level	_____	_____	_____	_____
Depth to bottom of pump intake pipe	_____	_____	_____	_____

14. The relationship of the applicant to the proposed place where the water will be used is that of Owner
(owner, tenant, agent or otherwise)

15. The owner(s) of the property where the water is used, if other than the applicant, is (please print):

(name, address and telephone number)

(name, address and telephone number)

16. The undersigned states that the information set forth above is true to the best of his/her knowledge and that this application is submitted in good faith.

Dated at _____, Kansas, this 12 day of August, 2022.
(month) (year)

(Applicant Signature)

By _____
(Agent or Officer Signature)

William Lehman
(Print Name)

Assisted by JNE _____ SFFO/ESII _____ Date: 06/27/2022
(office/title)

WATER RESOURCES
RECEIVED

AUG 15 2022

FEE SCHEDULE

1. The fee for an application for a permit to appropriate water for beneficial use, except for domestic use, shall be (see paragraph No. 2 below if requesting storage):

ACRE-FEET	FEE
0-100	\$200.00
101-320	\$300.00
More than 320	\$300.00 plus \$20.00 for each additional 100 acre-feet or any part thereof.

2. The fee for an application in which storage is requested, except for domestic use, shall be:

ACRE-FEET	FEE
0-250	\$200.00
More than 250	\$200.00 plus \$20.00 for each additional 250 acre-feet of storage or any part thereof.

Note: If an application requests both direct use *and* storage, the fee charged shall be as determined under No. 1 or No. 2 above, whichever is greater, but not both fees.

3. The fee for an application for a permit to appropriate water for water power or dewatering purposes shall be \$100.00 plus \$200.00 for each 100 cubic feet per second, or part thereof, of the diversion rate requested.

Note: The applicant shall notify the Chief Engineer and pay the statutorily required field inspection fee of \$400.00 when construction of the works for diversion has been completed, except that for applications filed on or after July 1, 2009, for works constructed for sediment control use and for evaporation from a groundwater pit for industrial use shall be accompanied by a field inspection fee of \$200.00.

MAKE CHECKS PAYABLE TO THE KANSAS DEPARTMENT OF AGRICULTURE

ATTENTION

A Water Conservation Plan may be required per K.S.A. 82a-733. A statement that your application for permit to appropriate water may be subject to the minimum desirable streamflow requirements per K.S.A. 82a-703a, b, and c may also be required from you. After the Division of Water Resources has had the opportunity to review your application, you will be notified whether or not you will need to submit a Water Conservation Plan. You also may be required to install a water flow meter or water stage measuring device on your diversion works prior to diverting water. There may be other special conditions or Groundwater Management District regulations that you will need to comply with if this application is approved.

CONVERSION FACTORS

1 acre-foot equals 325,851 gallons

1 million gallons equal 3.07 acre-feet

WATER RESOURCES
RECEIVED

AUG 15 2022

KS DEPT OF AGRICULTURE

RECREATIONAL USE SUPPLEMENTAL SHEET

File No. _____

Name of Applicant (Please Print): William Lehman

1. Please indicate type of recreational use (boating, fishing, swimming, etc.): Swimming, Fishing, Hunting, and Aesthetic Purposes.

2. Please summarize how the water will be used and justify the quantity of water requested: _____

Capacity per EBH on 6.4 acres of pond = 34.29 AF (capacity table attached)

Evap Calculation 6.4 acres x 24"(Pot Net Evap) / 12 = 12.8 AF x 3 years 38.4 AF indirect use

Maximum Reasonable Calculation: (A) = N/A + (B) 34.29 AF + (C) 12.8 AF = 47.09 AF

3. Please complete the following table showing estimated future water requirements:

ESTIMATED FUTURE WATER DIVERTED/STORED	
NEXT 5 YEARS	WATER TO BE DIVERTED (ACRE-FEET OR GALLONS)
Year 1	47.09 AF
Year 2	47.09 AF
Year 3	47.09 AF
Year 4	47.09 AF
Year 5	47.09 AF

Please attach any additional information, tables, or curves showing past, present and estimated future water requirements to substantiate the amount of water requested. (see attached runoff calculation sheet with drainage area map and capacity table for the pond.)

4. Please designate the legal description of the location where the water is to be used by providing the fractional part of the Section, Township and Range.

Pond located in Southwest Quarter of Section 18, Township 18 South, Range 6 West in Rice County, Kansas.

You may attach any additional information you believe will assist in informing the Division of the need for your request.

WATER RESOURCES
RECEIVED
AUG 15 2022

(Date)

Kansas Department of Agriculture
Division of Water Resources
David W. Barfield, Chief Engineer
1320 Research Park Drive
Manhattan, Kansas 66502

Re: Application
File No. _____

Minimum Desirable Streamflow

Dear Sir:

I understand that a Minimum Desirable Streamflow requirement has been established by the legislature for the source of supply to which the above referenced application applies.

I understand that diversion of water pursuant to this application will be subject to regulation any time Minimum Desirable Streamflow requirements are not being met.

I also understand that if this application is approved, there could be times, as determined by the Division of Water Resources, when I would not be allowed to divert water. I realize that this could affect the economics of my decision to appropriate water.

I am aware of the above factors, and with the knowledge thereof, request that the Division of Water Resources proceed with processing and approval, if possible, of the above referenced application.

Signature of Applicant

State of Kansas)
County of Rice) ss

William Lehman
(Print Applicant's Name)

I hereby certify that the foregoing instrument was signed in my presence and sworn to before me this 12th day of August, 20 22.



Notary Public

My Commission Expires: 10/22/25

WATER RESOURCES
RECEIVED

AUG 15 2022

KS DEPT OF AGRICULTURE

**MINIMUM DESIRABLE STREAMFLOW FORM TO BE USED WHEN
APPLICABLE WHEN FILING AN APPLICATION FOR PERMIT
TO APPROPRIATE WATER FOR BENEFICIAL USE**

The Kansas Legislature has established minimum desirable streamflows for the streams listed below. If your proposed diversion of water is going to be from one of these watercourses or adjacent alluvial aquifers, please complete the back side of this page and submit it along with your application for permit to appropriate water.

Arkansas River
Big Blue River
Chapman Creek
Chikaskia River
Cottonwood River
Delaware River
Little Arkansas River
Little Blue River
Marais des Cygnes River
Medicine Lodge River
Mill Creek (Wabaunsee Co. area)
Neosho River

Ninnescah River
North Fork Ninnescah River
Rattlesnake Creek
Republican River
Saline River
Smoky Hill River
Solomon River
South Fork Ninnescah
Spring River
Walnut River
Whitewater River

WATER RESOURCES
RECEIVED

AUG 15 2022

KS DEPT OF AGRICULTURE



Legend

- Water Appropriation
- Proposed Point of Diversion
- ⊕ Section Corner
- ▭ Section Line
- ▭ Proposed Place of Use

Application, File No. _____
 18-18-6W // Rice County

WATER RESOURCES RECEIVED

To the best of my knowledge, all points of diversion within one-half mile of the proposed point of diversion have been shown.

[Signature] 8-12-22

Signature / Date 06/27/2022 JNE/SFFO 1:12,000 scale

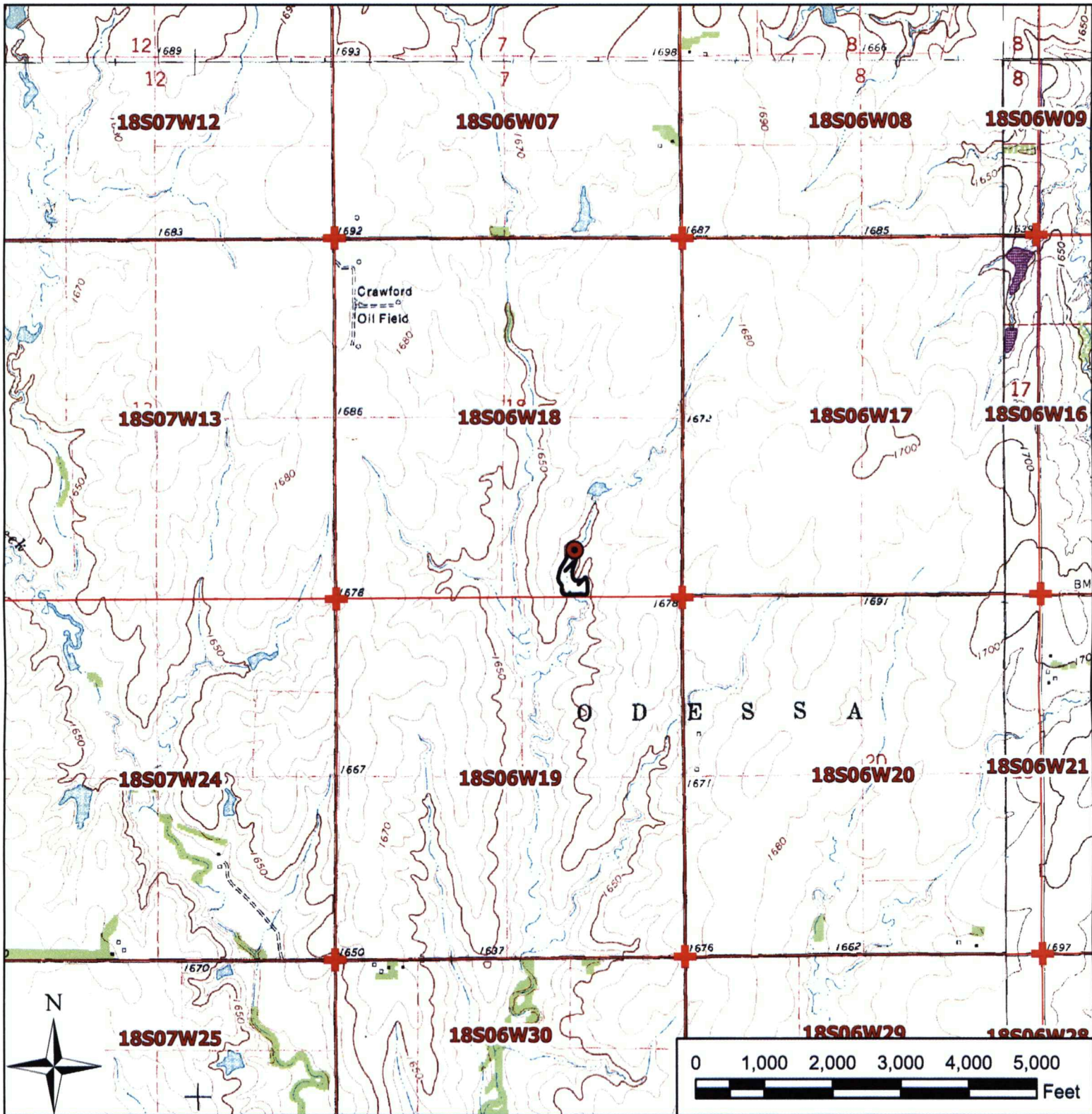

Legend

- Water Appropriation
- Proposed Point of Diversion
- ⊕ Section Corner
- ▭ Section Line
- ▭ Proposed Place of Use

Application, File No. _____
 18-18-6W // Rice County

To the best of my knowledge, all points of diversion within one-half mile of the proposed point of diversion have been shown.

[Signature] 8-12-22

Signature / Date 06/27/2022 JNE/SFFO 1:24,000 scale

WATER RESOURCES RECEIVED
 AUG 16 2022
 KS DEPT OF AGRICULTURE

William Lehman

Region ID: KS

Workspace ID: KS20220627165823967000

Clicked Point (Latitude, Longitude): 38.48005, -98.02234

Time: 2022-06-27 11:58:42 -0500

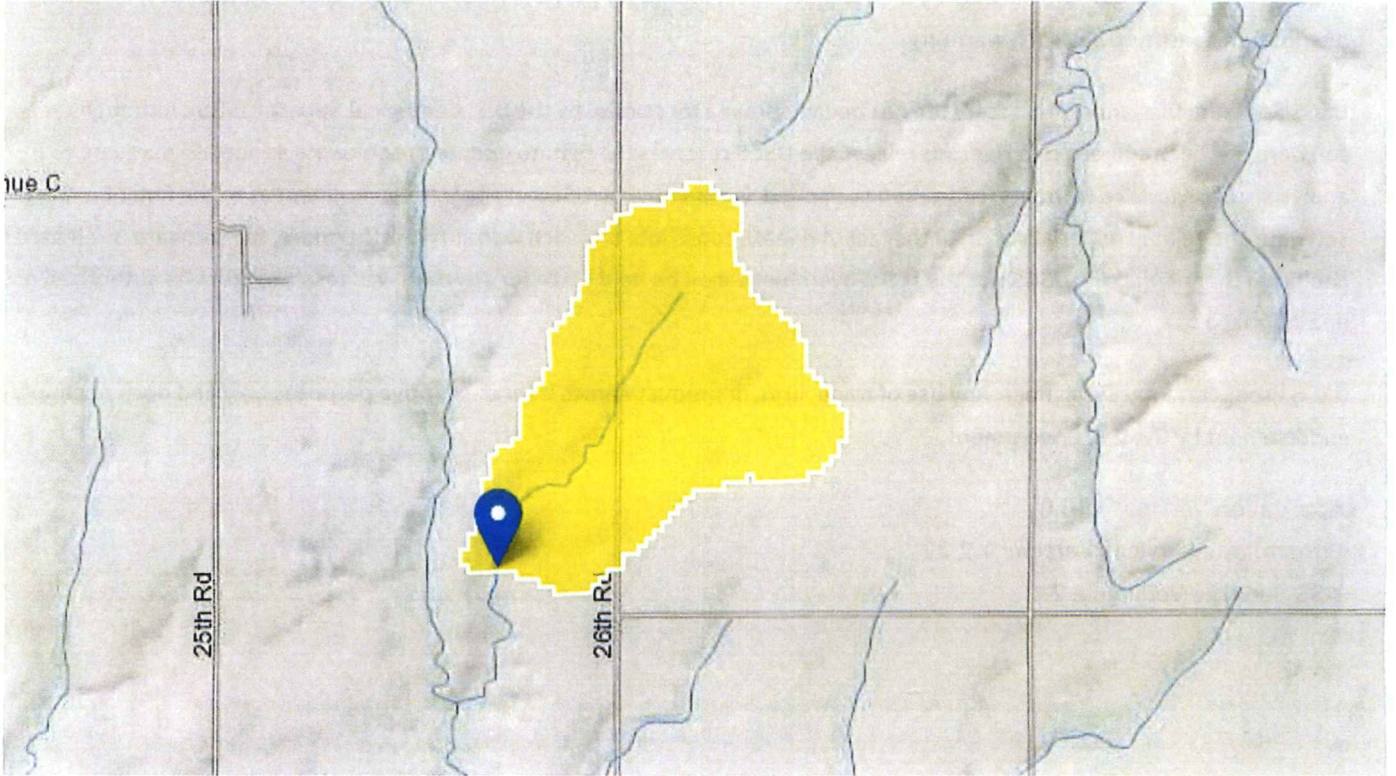

Pond 18-18-6W Drainage Area 342

Collapse All

➤ Basin Characteristics

Parameter Code	Parameter Description	Value	Unit
CONTDA	Area that contributes flow to a point on a stream	0.49	square miles
PRECPRIS10	Basin average mean annual precipitation for 1981 to 2010 from PRISM	28.8	inches

WATER RESOURCES RECEIVED

AUG 15 2022

KS DEPT OF AGRICULTURE

William Lehman

Region ID: KS
Workspace ID: KS20220627165823967000
Clicked Point (Latitude, Longitude): 38.48005, -98.02234
Time: 2022-06-27 11:58:42 -0500

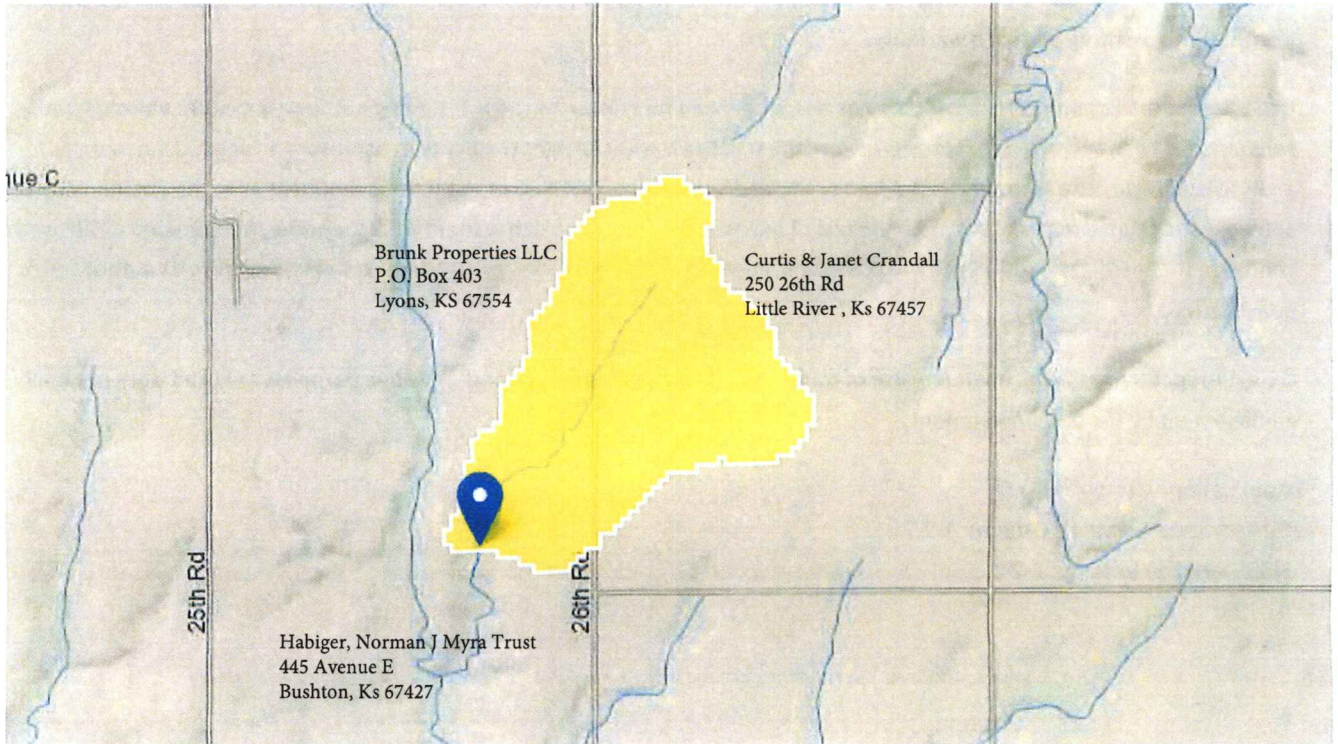

Pond 18-18-6W Drainage Area 342

+ Collapse All

➤ Basin Characteristics

Parameter Code	Parameter Description	Value	Unit
CONTDA	Area that contributes flow to a point on a stream	0.49	square miles
PRECPRIS10	Basin average mean annual precipitation for 1981 to 2010 from PRISM	28.8	inches

WATER RESOURCES RECEIVED

AUG 15 2022

INPUTS

Target Section Definition	
Section	18
Township	18
Range	6
Range Direction	W
Target Point Coordinates (NAD27 or NAD83)	
Target Longitude	-98.022490
Target Latitude	38.480326

Load Data and Compute

Instructions

1. Enter values for section, township, range and range direction.
2. Enter **NAD27** or **NAD83** longitude and latitude of target point.
3. Click "Load Data and Compute" button.
4. Use feet distances corresponding to datum of target point.

William Lehman Pond

Loaded Section Data

From LEOBASE using **NAD83**

Corner	Corner Latitudes	Corner Longitudes
SW	38.47840342	-98.03483024
NW	38.49302045	-98.03484516
NE	38.49299028	-98.01690034
SE	38.47843343	-98.01694661
Degrees Longitude per Foot		3.49332193E-06
Degrees Latitude per Foot		2.74586142E-06

Target Point Distances from Corners using NAD83

Corner	Feet North(+)/South(-)	Feet East(-)/West(+)
SW	700	-3533
NW	-4623	-3537
NE	-4612	1600
SE	689	1587

Loaded Section Data

From LEOBASE using **NAD27**

Corner	Corner Latitudes	Corner Longitudes
SW	38.47839400	-98.03450000
NW	38.49301100	-98.03451500
NE	38.49298100	-98.01657100
SE	38.47842400	-98.01661700
Degrees Longitude per Foot		3.49332147E-06
Degrees Latitude per Foot		2.74598553E-06

Target Point Distances from Corners using NAD27

Corner	Feet North(+)/South(-)	Feet East(-)/West(+)
SW	704	-3438
NW	-4619	-3442
NE	-4608	1694
SE	693	1681

WATER RESOURCES
RECEIVED

AUG 15 2022

KS DEPT OF AGRICULTURE

1640	2+30	3+00	4+00	5+00	6+00	7+00	8+00
1685							
1680							
1655							
1650							
1645							
1640							

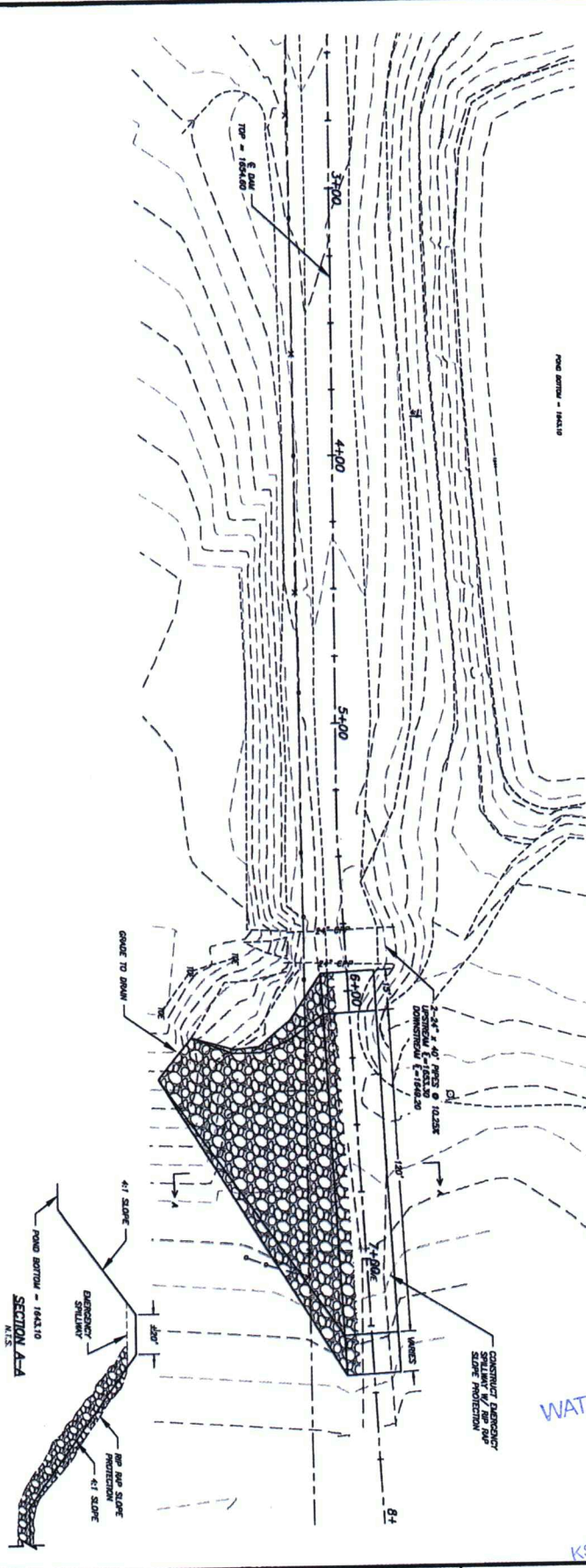

WATER RESOURCES RECEIVED
 AUG 15 2022
 KS DEPT OF AGRICULTURE

Date	Description

WILL LEHMAN POND
 IN
 RICE COUNTY, KANSAS
 FOR
 WILL LEHMAN



DATA ENTRY SYSTEM ID NUMBER SHEET

50844

FILE NUMBER _____

APPLICANT

PDIV ID

BATTERY ID

PERSON ID & SEQ #

89754

68558

LANDOWNER

PUSE ID

PERSON ID & SEQ #

70987

68558

WATER USE CORRESPONDENT

PERSON ID & SEQ #

68558

1320 Research Park Drive
Manhattan, KS 66502
785-564-6700
www. agriculture.ks.gov



900 SW Jackson, Room 456
Topeka, KS 66612
785-296-3556

Mike Beam, Secretary

Laura Kelly, Governor

August 29, 2022

WILLIAM LEHMAN
373 26TH RD
LITTLE RIVER KS 67457

RE: Application, File No(s). **50844**

Dear Sir or Madam:

The Division of Water Resources (Division) has received your application(s) for a permit to appropriate water for beneficial use. Your application(s) has been assigned the file number(s) referenced above. Please be aware that the Division may have a large number of pending applications on hand at times and makes every attempt to process them in the order in which they are received. You will be contacted if additional information is required.

Please note, this letter only acknowledges receipt of your application(s) and does not guarantee approval. In accordance with the provisions of the Kansas Water Appropriation Act, the use of water as proposed prior to approval of the application(s) is unlawful.

Additional information about the process may be found on our website at agriculture.ks.gov/divisions-programs/dwr. If you have any other questions, please contact our office at 785-564-6640 or your local Stafford Field Office at 620-234-5311. *Stafford Field Office at 620-234-5311*. If you call, please reference the file number so we can help you more efficiently.

Sincerely,

A handwritten signature in black ink that reads "Kris Neuhauser". The signature is written in a cursive style with a long horizontal flourish at the end.

Kris Neuhauser
New Applications Lead
Water Appropriation Program