

Submit To: CHIEF ENGINEER  
Division of Water Resources  
Kansas Department of Agriculture  
1320 Research Park Drive  
Manhattan, Kansas 66502  
http://agriculture.ks.gov/dwr

**APPLICATION FOR APPROVAL TO  
CHANGE THE PLACE OF USE, THE  
POINT OF DIVERSION OR THE USE  
MADE OF THE WATER UNDER AN  
EXISTING WATER RIGHT**



WATER RESOURCES  
RECEIVED  
State of Kansas

MAR 04 2024  
13:17

KS Dept. of Agriculture

**Filing Fee Must Accompany the Application**  
(Please refer to Fee Schedule on signature page of application form.)

**Paragraph Nos. 1, 2, 3, 4 & 8 must be completed. Complete all other applicable portions.** A topographic map or detailed plat showing the authorized and proposed points(s) of diversion and /or place of use must accompany this application.

1. Application is hereby made for approval of the Chief Engineer to change the

Place of Use

(Check one or more)  Point of Diversion

Use Made of Water

File No. 13,010

2. Name of applicant: Mark J Jr Lamon

Address: 1223 W 8<sup>th</sup> Frontage RD

City, State and Zip: Larned, KS 67550-3322

Phone Number: (830)931-4624 E-mail address: joeylamon@yahoo.com

What is your relationship to the water right;  owner  tenant  agent  other? If other, please explain. \_\_\_\_\_

-The Lamon's are partial owners of the p/u. The Susan J Ltimore Living Rev Trust owns about 40 acres of the p/u.

Name of water use correspondent: Mark J Jr & Ashley F Lamon

Address: 1223 W 8<sup>th</sup> Frontage RD

City, State and Zip: Larned, KS 67550-3322

Phone Number: (830) 931-4624 E-mail address: joeylamon@yahoo.com

3. The change(s) proposed herein are desired for the following reasons (please be specific): \_\_\_\_\_

We are proposing to do a "paper" change to move the rate and quantity authorized by this file to the existing well that is authorized by File No. 19990. Doing this is more in line with how the wells currently produce and would help us irrigate this piece of land more effectively.

The change(s) will be completed by as soon as approved since this is a "paper" change and no new wells are being drilled.  
(Date)

For Office Use Only:															
F.O. Code	<u>2</u>	GMD	<u>5</u>	Meets K.A.R. 5-5-1	<input checked="" type="checkbox"/> YES <input type="checkbox"/> NO	Use	<u>IRR</u>	Source	<input checked="" type="checkbox"/> G <input type="checkbox"/> S	County	<u>PN</u>	By	<u>ALB</u>	Date	<u>3/4/24</u>
Code	<u>CLT</u>	Fee \$	<u>200</u>	TR #		Receipt Date	<u>3-4-24</u>	Check #	<u>1092</u>						

3/5/2024  
KAnderson

MAR 04 2024

4. The presently authorized place of use is:

Owner of Land — NAME: Mark J Jr & Ashley F Lamon

ADDRESS: 1223 W 8<sup>th</sup> Frontage RD, Larned, KS 67550-3322

KS Dept of Agriculture

Sec.	Twp.	Range	NE¼				NW¼				SW¼				SE¼				TOTAL ACRES		
			NE¼	NW¼	SW¼	SE¼	NE¼	NW¼	SW¼	SE¼	NE¼	NW¼	SW¼	SE¼	NE¼	NW¼	SW¼	SE¼			
33	21S	18W			37	40											40	39	37	36	229

List any other water rights that cover this place of use. PN17, 4935, 19990

Owner of Land — NAME: Susan J Latimore Living Rev Trust

ADDRESS: 1379 220<sup>th</sup> Ave, Larned, KS 67550

Sec.	Twp.	Range	NE¼				NW¼				SW¼				SE¼				TOTAL ACRES		
			NE¼	NW¼	SW¼	SE¼	NE¼	NW¼	SW¼	SE¼	NE¼	NW¼	SW¼	SE¼	NE¼	NW¼	SW¼	SE¼			
33	21S	18W	18	22																	40

List any other water rights that cover this place of use. PN17, 4935, 19990

(If there are more than two landowners, attach additional sheets as necessary.)

5. It is proposed that the place of use be changed to:

Owner of Land — NAME: NO CHANGE

ADDRESS: NO CHANGE

Sec.	Twp.	Range	NE¼				NW¼				SW¼				SE¼				TOTAL ACRES		
			NE¼	NW¼	SW¼	SE¼	NE¼	NW¼	SW¼	SE¼	NE¼	NW¼	SW¼	SE¼	NE¼	NW¼	SW¼	SE¼			

List any other water rights that cover this place of use. ---

Owner of Land — NAME: NO CHANGE

ADDRESS: NO CHANGE

Sec.	Twp.	Range	NE¼				NW¼				SW¼				SE¼				TOTAL ACRES		
			NE¼	NW¼	SW¼	SE¼	NE¼	NW¼	SW¼	SE¼	NE¼	NW¼	SW¼	SE¼	NE¼	NW¼	SW¼	SE¼			

List any other water rights that cover this place of use. ---

**IF MORE SPACE IS NEEDED, ATTACH ADDITIONAL SHEETS AS NECESSARY**

- 6. The presently authorized point(s) of diversion is one well, one pump  
(Provide description and number of points)
- 7. The proposed point(s) of diversion is one well, one pump, moving to existing well authorized by File No. 19990  
(Provide description and number of points)

**List all presently authorized point(s) of diversion:**

8. **Presently authorized point of diversion:**  
 One in the NW Quarter of the SW Quarter of the NE Quarter of Section 33, Township 21 South, Range 18 (W), in Pawnee County, Kansas, 3410 feet North 2290 feet West of Southeast corner of section.  
 Authorized Rate 295 GPM (limited) Authorized Quantity 103 AF (limited)  
 (DWR use only: Computer ID No. 11 GPS n/a feet North n/a feet West)  
 This point will not be changed  This point will be changed as follows:  
**Proposed point of diversion: (Complete only if change is requested)**  
 One in the SW Quarter of the SW Quarter of the SE Quarter of Section 33, Township 21 South, Range 18 (W), in Pawnee County, Kansas, 655 feet North 2620 feet West of Southeast corner of section.  
 Proposed Rate 295 GPM (limited) Proposed Quantity 103 AF (limited)  
 This point is:  Additional Well  Geo Center List other water rights that will use this point 19990

9. **Presently authorized point of diversion:**  
 One in the \_\_\_\_\_ Quarter of the \_\_\_\_\_ Quarter of the \_\_\_\_\_ Quarter of Section \_\_\_\_\_, Township \_\_\_\_\_ South, Range \_\_\_\_\_ (E/W), in \_\_\_\_\_ County, Kansas, \_\_\_\_\_ feet North \_\_\_\_\_ feet West of Southeast corner of section.  
 Authorized Rate \_\_\_\_\_ Authorized Quantity \_\_\_\_\_  
 (DWR use only: Computer ID No. \_\_\_\_\_ GPS \_\_\_\_\_ feet North \_\_\_\_\_ feet West)  
 This point will not be changed  This point will be changed as follows:  
**Proposed point of diversion: (Complete only if change is requested)**  
 One in the \_\_\_\_\_ Quarter of the \_\_\_\_\_ Quarter of the \_\_\_\_\_ Quarter of Section \_\_\_\_\_, Township \_\_\_\_\_ South, Range \_\_\_\_\_ (E/W), in \_\_\_\_\_ County, Kansas, \_\_\_\_\_ feet North \_\_\_\_\_ feet West of Southeast corner of section.  
 Proposed Rate \_\_\_\_\_ Proposed Quantity \_\_\_\_\_  
 This point is:  Additional Well  Geo Center List other water rights that will use this point \_\_\_\_\_

WATER RESOURCES RECEIVED  
 MAR 04 2024  
 KS Dept. of Agriculture

10. **Presently authorized point of diversion:**  
 One in the \_\_\_\_\_ Quarter of the \_\_\_\_\_ Quarter of the \_\_\_\_\_ Quarter of Section \_\_\_\_\_, Township \_\_\_\_\_ South, Range \_\_\_\_\_ (E/W), in \_\_\_\_\_ County, Kansas, \_\_\_\_\_ feet North \_\_\_\_\_ feet West of Southeast corner of section.  
 Authorized Rate \_\_\_\_\_ Authorized Quantity \_\_\_\_\_  
 (DWR use only: Computer ID No. \_\_\_\_\_ GPS \_\_\_\_\_ feet North \_\_\_\_\_ feet West)  
 This point will not be changed  This point will be changed as follows:  
**Proposed point of diversion: (Complete only if change is requested)**  
 One in the \_\_\_\_\_ Quarter of the \_\_\_\_\_ Quarter of the \_\_\_\_\_ Quarter of Section \_\_\_\_\_, Township \_\_\_\_\_ South, Range \_\_\_\_\_ (E/W), in \_\_\_\_\_ County, Kansas, \_\_\_\_\_ feet North \_\_\_\_\_ feet West of Southeast corner of section.  
 Proposed Rate \_\_\_\_\_ Proposed Quantity \_\_\_\_\_  
 This point is:  Additional Well  Geo Center List other water rights that will use this point \_\_\_\_\_

- 11. Describe the current condition of and future plans for any point(s) of diversion which will no longer be used. \_\_\_\_\_  
 The old well will be kept for domestic stock use.

**IF MORE SPACE IS NEEDED, ATTACH ADDITIONAL SHEETS AS NECESSARY**

12. The presently authorized use of water is for Irrigation purposes.

It is proposed that the use be changed to NO CHANGE purposes.

13. If changing the place of use and/or use made of water, describe how the consumptive use will not be increased.

We are not changing the place of use or use made of water.

---

---

---

---

(Please show any calculations here.)

14. It is requested that the maximum annual quantity of water be reduced to NO CHANGE (acre-feet or million gallons).

15. It is requested that the maximum rate of diversion of water be reduced to NO CHANGE gallons per minute (c.f.s.).

16. The application must include either a topographic map or detailed plat. A U.S. Geological Survey Topographic Map, scale 1:24,000, is available through the Kansas Geological Survey, 1930 Constant Avenue, University of Kansas, Lawrence, Kansas 66047-3726 ([www.usgs.gov](http://www.usgs.gov)). The map should show the location of the presently authorized point(s) of diversion. Distances North and West of the Southeast corner of the section must be shown. The presently authorized place of use should also be shown. Identify the center of the section, the section lines and the section corners and show the appropriate section, township, and range numbers on the map. In addition the following information must also be shown on the map.

a. If a change in the location of the point(s) of diversion is proposed, show:

- 1) The location of the proposed point(s) of diversion. Distances North and West of the Southeast corner of the section must be shown. Please be certain that the information shown on the map agrees with the information shown in Paragraph Nos. 9, 10 and 11 of the application.
- 2) If the source of supply is groundwater, please show the location of existing water wells of any kind, including domestic wells, within 1/2 mile of the proposed well or wells. Identify each well as to its use and furnish name and mailing address of the property owner or owners. If there are no wells within 1/2 mile, please indicate so on the map.
- 3) If the source of supply is surface water, the names and mailing addresses of all landowner(s) 1/2 mile downstream and 1/2 mile upstream from your property lines must be shown.

b. If a change in the place of use is desired, show the proposed place of use by crosshatching on the map. Please be certain that the information shown on the map agrees with the information shown in Paragraph No. 5 of the application.

17. Attach documentation to show the change(s) proposed herein will not impair existing water rights and relates to the same local source of supply as to which the water right relates. This information may include statements, plats, geology reports, well logs, test hole logs, and other information as necessary information to show the above. Additional comments may be made below.

Well log for File No 13010 and File No 19990 are attached. Both logs seem to show an upper quaternary source as well as a Dakota source. Even though the current well for 13010 is shallow at only 70' deep it does indicate it was sourced in the Dakota as well as the uppers sands, which is the same as the well authorized by File No 19990 that this file is proposing to move to.

18. If the proposed change(s) does not meet all applicable rules and regulations of the Kansas Water Appropriation Act, please identify the rules and regulations for which you request a waiver. State the reason why a waiver is needed and why the request should be granted. Attach documentation showing that granting the request will not impair existing water rights and will not prejudicially and unreasonably affect the public interest.

This application will need a waiver of K.A.R. 5-25-2a.(a) as the two wells are about 2780' apart or about 140' further than the regulation allows. This change seeks to move water away from Pawnee River, the current well is ~100' from the river and the proposed well location is ~2800' away from the river. The nearest well from this new location is over 1/2 mile away.

**IF MORE SPACE IS NEEDED, ATTACH ADDITIONAL SHEETS AS NECESSARY**

MAR 04 2024

KS Dept. of Agriculture

Any use of water that is not as authorized by the water right or permit to authorize water before the chief engineer approves this application is a violation of the Kansas Water Appropriation Act for which criminal or civil penalties may be assessed. Such violation is a class C misdemeanor, punishable by a fine not to exceed \$500 and/or a term of confinement not to exceed one month in the county jail. K.S.A. 82a-728(b). Civil penalties shall be not less than \$100 nor more than \$1,000 per violation. In the case of a continuing violation, each day such violation continues may be deemed a separate violation. In addition to these penalties the water right may be modified or suspended. K.S.A. 82a-737, as amended.

The application must be signed by all owners of the place of use authorized under the water right and his or her spouse, if married. Please indicate if there is no spouse. If land is being purchased under contract, the seller must sign as landowner until such time as the contract is completed.

In the event that all applicants cannot appear before one notary public, they may as necessary sign separate copies of the application before any notary public conveniently available to them. All copies signed in this manner shall be considered to be valid parts of the application.

If the request is signed on behalf of any Owner by someone with legal authority to do so (for example, an agent, one who has power of attorney, or an executor, executrix, conservator), it will be necessary to attach proper documents showing such authority.

I declare that I am an owner of the currently authorized place of use as identified herein, or that I represent all such owners and am authorized to make this application on their behalf, and declare further that the statements contained herein are true, correct, and complete. By filing this application I authorize the chief engineer to permanently reduce the quantity of water and/or rate of diversion as specified in sections 14 and 15 of this application.

Dated at February 23 Lawrence, KS, Kansas, this 23 day of February, 20 24.

<u>Susan Catimore</u> (Owner)	_____	(Spouse)
<u>Susan Catimore</u> (Please Print)	_____	(Please Print)
_____	_____	(Spouse)
_____	_____	(Please Print)
_____	_____	(Spouse)
_____	_____	(Please Print)

State of Kansas )  
County of Pawnee ) SS

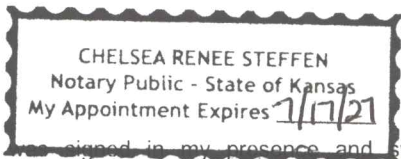

I hereby certify that the foregoing application was signed in my presence and sworn to before me this 23rd day of February, 20 24.

Chelsea Steffen  
Notary Public

My Commission Expires 7/17/27.

**FEE SCHEDULE**





Each application to change the place of use, the point of diversion or the use made of the water under this section shall be accompanied by the application fee set forth in the schedule below:

- (1) Application to change a point of diversion 300 feet or less . . . . . \$100
- (2) Application to change a point of diversion more than 300 feet . . . . . \$200
- (3) Application to change the place of use . . . . . \$200
- (4) Application to change the use made of the water . . . . . \$300

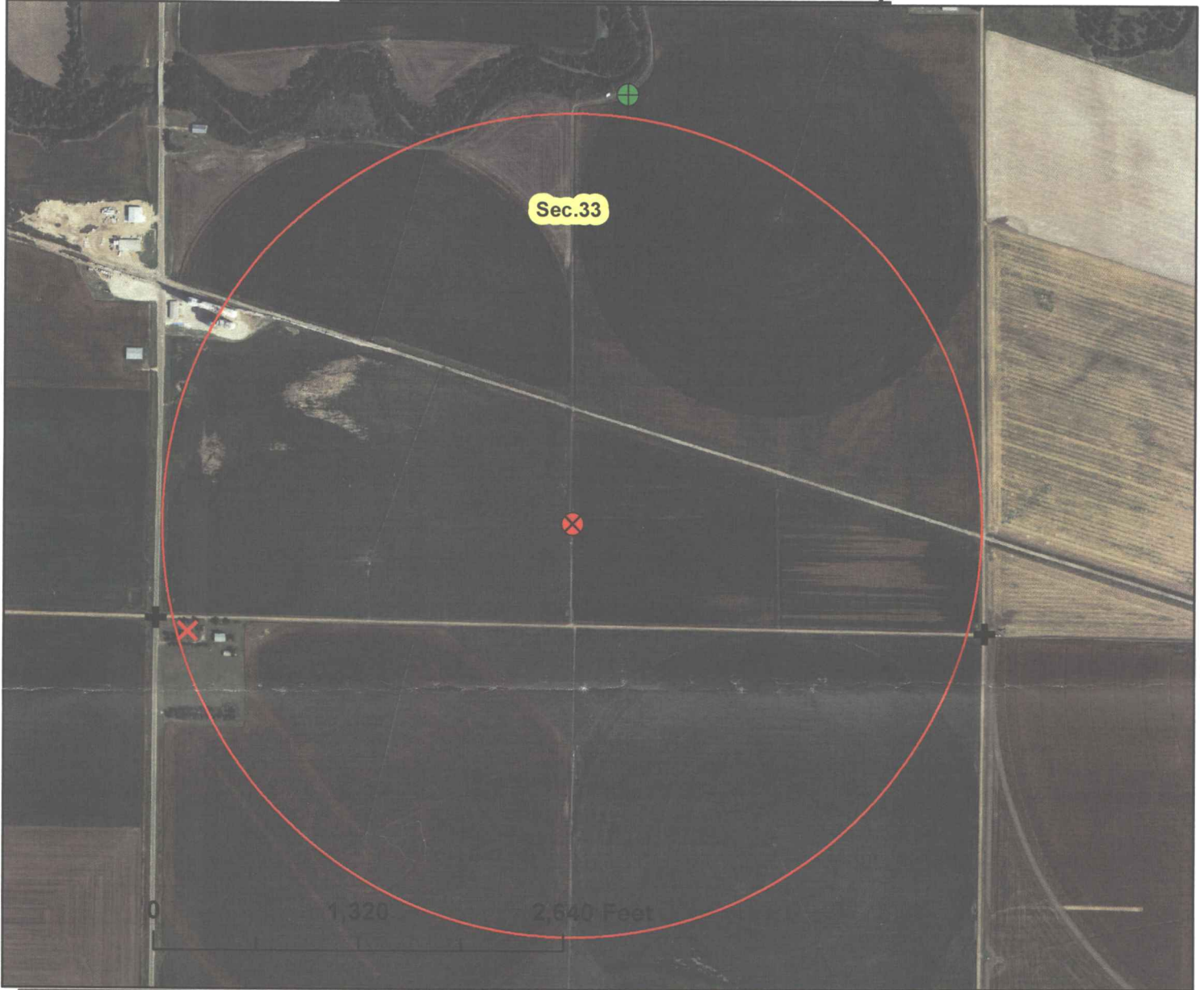
Make check payable to **Kansas Department of Agriculture**

**Change Application Map**  
**File No. 13010**  
**Section 33-21S-18W in Pawnee County**



-  current well located 3410'N & 2290'W (File No. 13010)
-  proposed well located 655'N & 2620'W (existing File No. 19990)
-  1/2 mile circle around proposed point
-  nearby domestic wells
-  section corners

**NEARBY WELLS:**  
no permitted wells.

**domestic well:**  
**Philip H & Rebecca A Martin**  
1294 US 183 HWY Larned, KS 67550-5358

WATER RESOURCES  
RECEIVED

MAR 04 2024

KS Dept. of Agriculture



*By signing I agree that all wells within 1/2 mile of the authorized point of diversion are shown on the map.*

 2-21-24

signature

date

1 inch = 1,000 feet

map created on 2/20/24 scale 1:12,000

**WATER WELL RECORD Form WWC-5**

Division of Water Resources App. No.

19,990

Well ID

Original Record  Correction  Change in Well Use

**1 LOCATION OF WATER WELL:**  
 County: Pawnee      Fraction: ¼ SW ¼ SW ¼ SE ¼      Section Number: 33      Township Number: T 21 S      Range Number: R 18  E  W

**2 WELL OWNER:** Last Name: Leonard A. Finger Trust #1      First:      Street or Rural Address where well is located (if unknown, distance and direction from nearest town or intersection): If at owner's address, check here:   
 Business: Leonard A. Finger Trust #1      Address: 612 W 12th Street      1/4 East of Sanford  
 Address:      City: Larned      State: KS      ZIP: 67550

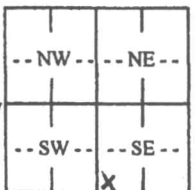
**3 LOCATE WELL WITH "X" IN SECTION BOX:**  
 N  
  
 W      E  
 S  
 1 mile

**4 DEPTH OF COMPLETED WELL:** .....175..... ft.  
 Depth(s) Groundwater Encountered: 1) ..... ft.  
 2) ..... ft. 3) ..... ft., or 4)  Dry Well  
**WELL'S STATIC WATER LEVEL:** .....31..... ft.  
 below land surface, measured on (mo-day-yr) .....7-27-18.....  
 above land surface, measured on (mo-day-yr).....  
 Pump test data: Well water was ..... ft.  
 after..... hours pumping ..... gpm  
 Well water was ..... ft.  
 after..... hours pumping ..... gpm  
 Estimated Yield: ..... gpm  
 Bore Hole Diameter: .....30..... in. to .....175..... ft. and  
 ..... in. to ..... ft.

**5 Latitude:** .....(decimal degrees)  
**Longitude:** .....(decimal degrees)  
**Horizontal Datum:**  WGS 84  NAD 83  NAD 27  
**Source for Latitude/Longitude:**  
 GPS (unit make/model: .....)  
 (WAAS enabled?  Yes  No)  
 Land Survey  Topographic Map  
 Online Mapper: .....

**6 Elevation:** .....ft.  Ground Level  TOC  
**Source:**  Land Survey  GPS  Topographic Map  
 Other .....

**7 WELL WATER TO BE USED AS:**

1. Domestic: <input type="checkbox"/> Household <input type="checkbox"/> Lawn & Garden <input type="checkbox"/> Livestock	2. <input checked="" type="checkbox"/> Irrigation 3. <input type="checkbox"/> Feedlot 4. <input type="checkbox"/> Industrial	5. <input type="checkbox"/> Public Water Supply: well ID .....	6. <input type="checkbox"/> Dewatering: how many wells? .....	7. <input type="checkbox"/> Aquifer Recharge: well ID .....	8. <input type="checkbox"/> Monitoring: well ID .....	9. Environmental Remediation: well ID .....	10. <input type="checkbox"/> Oil Field Water Supply: lease .....	11. Test Hole: well ID .....	12. Geothermal: how many bores? .....	13. <input type="checkbox"/> Other (specify): .....
--	--	--	---	---	---	---	--	------------------------------	---------------------------------------	---

Was a chemical/bacteriological sample submitted to KDHE?  Yes  No      If yes, date sample was submitted: .....

**8 TYPE OF CASING USED:**  Steel  PVC  Other ..... CASING JOINTS:  Glued  Clamped  Welded  Threaded  
 Casing diameter .....16..... in. to .....175..... ft., Diameter ..... in. to ..... ft., Diameter ..... in. to ..... ft.  
 Casing height above land surface .....18..... in. Weight .....Sch.40..... lbs./ft. Wall thickness or gauge No. ....  
**TYPE OF SCREEN OR PERFORATION MATERIAL:**  
 Steel  Stainless Steel  Fiberglass  PVC  Other (Specify) .....  
 Brass  Galvanized Steel  Concrete tile  None used (open hole)  
**SCREEN OR PERFORATION OPENINGS ARE:**  
 Continuous Slot  Mill Slot  Gauze Wrapped  Torch Cut  Drilled Holes  Other (Specify) .....  
 Louvered Shutter  Key Punched  Wire Wrapped  Saw Cut  None (Open Hole)  
**SCREEN-PERFORATED INTERVALS:** From .....175..... ft. to .....92..... ft., From ..... ft. to ..... ft., From ..... ft. to ..... ft.  
**GRAVEL PACK INTERVALS:** From .....175..... ft. to .....20..... ft., From ..... ft. to ..... ft., From ..... ft. to ..... ft.

**9 GROUT MATERIAL:**  Neat cement  Cement grout  Bentonite  Other .....  
 Grout Intervals: From ..... ft. to ..... ft., From .....20..... ft. to .....0..... ft., From ..... ft. to ..... ft.  
**Nearest source of possible contamination:**  
 Septic Tank  Lateral Lines  Pit Privy  Livestock Pens  Insecticide Storage  
 Sewer Lines  Cess Pool  Sewage Lagoon  Fuel Storage  Abandoned Water Well  
 Watertight Sewer Lines  Seepage Pit  Feedyard  Fertilizer Storage  Oil Well/Gas Well  
 Other (Specify) None .....  
 Direction from well? ..... Distance from well? ..... ft.

10 FROM	TO	LITHOLOGIC LOG	FROM	TO	LITHO. LOG (cont.) or PLUGGING INTERVALS
0	3	Top soil	107	124	Gray shale w/ sandstone streaks
3	25	Tan clay	124	170	Soft sandstone w/ hard streaks & light clay
25	41	Small grwavel w/ clay	170	175	Sandrock w/ clay
41	45	Tan clay			
45	61	Fine sand & small gravel w/ clay			
61	82	Tan clay			
82	98	Small gravel & fine sand w/ clay			
98	99	Cemented sand			
99	107	Med gr gravel w/ clay streaks			

Notes: KS Dept. of Agriculture  
 MAR 04 2024

**11 CONTRACTOR'S OR LANDOWNER'S CERTIFICATION:** This water well was  constructed,  reconstructed, or  plugged under my jurisdiction and was completed on (mo-day-year) ...8-16-18... and this record is true to the best of my knowledge and belief.  
 Kansas Water Well Contractor's License No. ...134... This Water Well Record was completed on (mo-day-year) ...9-17-18...  
 under the business name of ...Rosenkrantz, Bemis, Ent Inc... Signature .....Chara Alabi.....

LOCATION OF WATER WELL: County: <b>Pawnee</b>	Fraction <b>SE 1/4 NW 1/4 NE 1/4</b>	Section Number <b>33</b>	Township Number <b>T 21 S</b>	Range Number <b>R 18 E</b>
--	---	-----------------------------	----------------------------------	-------------------------------

Distance and direction from nearest town or city street address of well if located within city?

Approximately 1/2 mile north and 1/2 mile east of Sanfor, Ks.

WATER WELL OWNER: Leonard Finger

Fik No. 13010

*OFFSET - POINTS OF DIMENSION*

#, St. Address, Box #: Route 3

Board of Agriculture, Division of Water Resources

City, State, ZIP Code: Larned, Ks. 67550

Application Number:

LOCATE WELL'S LOCATION WITHIN "X" IN SECTION BOX:

4 DEPTH OF COMPLETED WELL: 70 ft. ELEVATION: unknown

Depth(s) Groundwater Encountered 1. 44 ft. 2. 68 ft. 3. \_\_\_\_\_ ft.

WELL'S STATIC WATER LEVEL 28 ft. below land surface measured on mo/day/yr \_\_\_\_\_

Pump test data: Well water was not ch'd ft. after \_\_\_\_\_ hours pumping \_\_\_\_\_ gpm

Est. Yield unknown gpm: Well water was \_\_\_\_\_ ft. after \_\_\_\_\_ hours pumping \_\_\_\_\_ gpm

Bore Hole Diameter: 24 in. to 70 ft., and \_\_\_\_\_ in. to \_\_\_\_\_ ft.

WELL WATER TO BE USED AS: 5 Public water supply 8 Air conditioning 11 Injection well

1 Domestic 3 Feedlot 6 Oil field water supply 9 Dewatering 12 Other (Specify below)

2 Irrigation 4 Industrial 7 Lawn and garden only 10 Monitoring well \_\_\_\_\_

Was a chemical/bacteriological sample submitted to Department? Yes \_\_\_\_\_ No x \_\_\_\_\_; If yes, mo/day/yr sample was submitted

Water Well Disinfected? Yes \_\_\_\_\_ No x \_\_\_\_\_

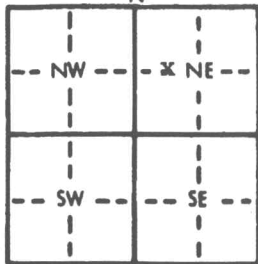

TYPE OF CASING USED:

- 1 Steel
- 2 PVC
- 3 RMP (SR)
- 4 ABS

- 5 Wrought iron
- 6 Asbestos-Cement
- 7 Fiberglass
- 8 Concrete tile
- 9 Other (specify below)

- CASING JOINTS: Glued \_\_\_\_\_ Clamped \_\_\_\_\_  
Welded \_\_\_\_\_  
Threaded \_\_\_\_\_

Casing diameter: 16 in. to 42 ft., Dia \_\_\_\_\_ in. to \_\_\_\_\_ ft., Dia \_\_\_\_\_ in. to \_\_\_\_\_ ft.

Casing height above land surface: 12 in., weight 36.87 lbs./ft. Wall thickness or gauge No. 219

TYPE OF SCREEN OR PERFORATION MATERIAL:

- 1 Steel
- 2 Brass
- 3 Stainless steel
- 4 Galvanized steel

- 5 Fiberglass
- 6 Concrete tile
- 7 PVC
- 8 RMP (SR)
- 9 ABS

- 10 Asbestos-cement
- 11 Other (specify) \_\_\_\_\_
- 12 None used (open hole)

SCREEN OR PERFORATION OPENINGS ARE:

- 1 Continuous slot
- 2 Louvered shutter
- 3 Mill slot
- 4 Key punched

- 5 Gauzed wrapped
- 6 Wire wrapped
- 7 Torch cut

- 8 Saw cut
- 9 Drilled holes
- 10 Other (specify) and Doerr bridge slot
- 11 None (open hole)

SCREEN-PERFORATED INTERVALS: From 42 ft. to 66 ft., From \_\_\_\_\_ ft. to \_\_\_\_\_ ft.

Doerr From 66 ft. to 70 ft., From \_\_\_\_\_ ft. to \_\_\_\_\_ ft.

GRAVEL PACK INTERVALS: From 20 ft. to 70 ft., From \_\_\_\_\_ ft. to \_\_\_\_\_ ft.

From \_\_\_\_\_ ft. to \_\_\_\_\_ ft., From \_\_\_\_\_ ft. to \_\_\_\_\_ ft.

GROUT MATERIAL:

- 1 Neat cement
- 2 Cement grout
- 3 Bentonite
- 4 Other \_\_\_\_\_

Grout intervals: From 0 ft. to 20 ft., From \_\_\_\_\_ ft. to \_\_\_\_\_ ft., From \_\_\_\_\_ ft. to \_\_\_\_\_ ft.

What is the nearest source of possible contamination:

- 1 Septic tank
- 2 Sewer lines
- 3 Watertight sewer lines
- 4 Lateral lines
- 5 Cess pool
- 6 Seepage pit

- 7 Pit privy
- 8 Sewage lagoon
- 9 Feedyard

- 10 Livestock pens
- 11 Fuel storage
- 12 Fertilizer storage
- 13 Insecticide storage
- 14 Abandoned water well
- 15 Oil well/Gas well
- 16 Other (specify below)
- ...none known \_\_\_\_\_

Direction from well?

How many feet?

FROM	TO	LITHOLOGIC LOG	FROM	TO	PLUGGING INTERVALS
0	8	Topsoil, brown clay			
8	33	Clay, brown, soft			
33	37	Sand, fine with clay			
37	64.5	Sand and Gravel, very fine to fine to medium, clay streak 53' and 56' thin			
64.5	69	Sandstone, yellow-brown			
69	70	Clay, Dakota, yellow, gray			

WATER RESOURCES RECEIVED

MAR 04 2024

KS Dept. of Agriculture

CONTRACTOR'S OR LANDOWNER'S CERTIFICATION: This water well was (1) constructed, (2) reconstructed, or (3) plugged under my jurisdiction and was completed on (mo/day/year) 11-3-89 and this record is true to the best of my knowledge and belief. Kansas Water Well Contractor's License No. 185

This Water Well Record was completed on (mo/day/yr) 11-16-89

for the business name of Clarke Well & Equipment, Inc.

by (signature) *[Signature]*





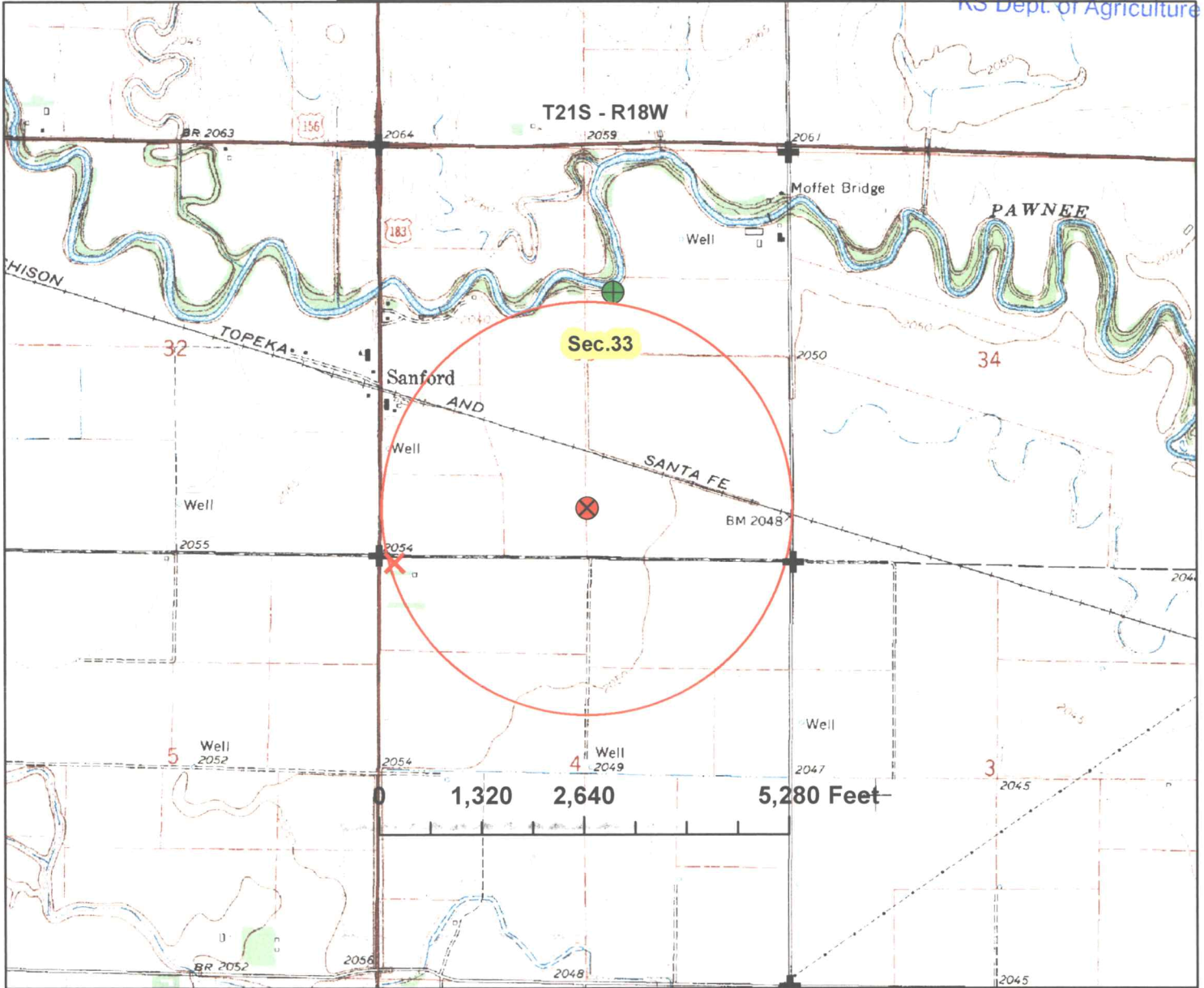

MAR 04 2024

KS Dept. of Agriculture

**Change Application Map**  
**File No. 13010**  
**Section 33-21S-18W in Pawnee County**



-  current well located 3410'N & 2290'W (File No. 13010)
-  proposed well located 655'N & 2620'W (existing File No. 19990)
-  1/2 mile circle around proposed point
-  nearby domestic wells
-  section corners

**NEARBY WELLS:**  
no permitted wells.

**domestic well:**  
**Philip H & Rebecca A Martin**  
1294 US 183 HWY Larned, KS 67550-5358

*By signing I agree that all wells within 1/2 mile of the authorized point of diversion are shown on the map.*

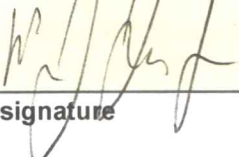
 2-21-24

signature date



1 inch = 2,000 feet

map created on 2/20/24 scale 1:24,000

Any use of water that is not as authorized by the water right or permit to authorize water before the chief engineer approves this application is a violation of the Kansas Water Appropriation Act for which criminal or civil penalties may be assessed. Such violation is a class C misdemeanor, punishable by a fine not to exceed \$500 and/or a term of confinement not to exceed one month in the county jail. K.S.A. 82a-728(b). Civil penalties shall be not less than \$100 nor more than \$1,000 per violation. In the case of a continuing violation, each day such violation continues may be deemed a separate violation. In addition to these penalties the water right may be modified or suspended. K.S.A. 82a-737, as amended.

The application must be signed by all owners of the place of use authorized under the water right and his or her spouse, if married. Please indicate if there is no spouse. If land is being purchased under contract, the seller must sign as landowner until such time as the contract is completed.

In the event that all applicants cannot appear before one notary public, they may as necessary sign separate copies of the application before any notary public conveniently available to them. All copies signed in this manner shall be considered to be valid parts of the application.

If the request is signed on behalf of any Owner by someone with legal authority to do so (for example, an agent, one who has power of attorney, or an executor, executrix, conservator), it will be necessary to attach proper documents showing such authority.

I declare that I am an owner of the currently authorized place of use as identified herein, or that I represent all such owners and am authorized to make this application on their behalf, and declare further that the statements contained herein are true, correct, and complete. By filing this application I authorize the chief engineer to permanently reduce the quantity of water and/or rate of diversion as specified in sections 14 and 15 of this application.

Dated at 2/21/24, Kansas, this 21 day of February, 2024.

[Signature]  
\_\_\_\_\_  
(Owner)  
Mark J. Lamon Jr.  
\_\_\_\_\_  
(Please Print)

[Signature]  
\_\_\_\_\_  
(Spouse)  
Ashley Lamon  
\_\_\_\_\_  
(Please Print)

\_\_\_\_\_  
(Owner)  
\_\_\_\_\_  
(Please Print)

\_\_\_\_\_  
(Spouse)  
\_\_\_\_\_  
(Please Print)

\_\_\_\_\_  
(Owner)  
\_\_\_\_\_  
(Please Print)

\_\_\_\_\_  
(Spouse)  
\_\_\_\_\_  
(Please Print)

State of Kansas )  
County of Pawnee ) SS

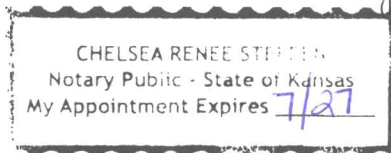

I hereby certify that the foregoing application was signed in my presence and sworn to before me this 21 day of February, 2024.

[Signature]  
\_\_\_\_\_  
Notary Public

My Commission Expires 7/2027

**FEE SCHEDULE**

Each application to change the place of use, the point of diversion or the use made of the water under this section shall be accompanied by the application fee set forth in the schedule below:

- (1) Application to change a point of diversion 300 feet or less ..... \$100
- (2) Application to change a point of diversion more than 300 feet ..... \$200
- (3) Application to change the place of use ..... \$200
- (4) Application to change the use made of the water ..... \$300

Make check payable to **Kansas Department of Agriculture**

WATER RESOURCES  
RECEIVED  
MAR 04 2024  
KS Dept. of Agriculture

1320 Research Park Drive  
Manhattan, KS 66502  
785-564-6700  
www. agriculture.ks.gov



900 SW Jackson, Room 456  
Topeka, KS 66612  
785-296-3556

Mike Beam, Secretary

Laura Kelly, Governor

March 8, 2024

MARK J LR LAMON  
1223 W 8TH FRONTAGE RD  
LARNED KS 67550-3322

RE: File No(s). **13010**

Dear Sir or Madam:

The Division of Water Resources (Division) has received your application(s) to change the place of use, point of diversion or use made of water for the file number(s) referenced above. Please be aware that the Division may have a large number of pending applications on hand at times and makes every attempt to process them in the order in which they are received. You will be contacted if additional information is required.

Please note, this letter only acknowledges receipt of your application(s) and does not guarantee approval. In accordance with the provisions of the Kansas Water Appropriation(s) Act, the use of water as proposed prior to approval of the application(s) is unlawful.

Additional information about the process may be found on our website at [agriculture.ks.gov/divisions-programs/dwr](http://agriculture.ks.gov/divisions-programs/dwr). If you have any other questions, please contact our office at 785-564-6640 or your local Stafford Field Office at 620-234-5311. If you call, please reference the file number so we can help you more efficiently.

Sincerely,

Kristen Baum  
New Applications and Changes Supervisor  
Water Appropriation Program