

NOTICE

This scan only represents the application as filed. The information contained herein meets the requirements of K.A.R. 5-3-1 or K.A.R. 5-5-1, and has been found acceptable for filing in the office of the Chief Engineer. The application should not be considered to be a complete application as per K.A.R. 5-3-1b or K.A.R. 5-5-2a.

MAY 24 2023

13:59

KS DEPT OF AGRICULTURE

Submit To: CHIEF ENGINEER
Division of Water Resources
Kansas Department of Agriculture
1320 Research Park Drive
Manhattan, Kansas 66502
http://agriculture.ks.gov/dwr

**APPLICATION FOR APPROVAL TO
CHANGE THE PLACE OF USE, THE
POINT OF DIVERSION OR THE USE
MADE OF THE WATER UNDER AN
EXISTING WATER RIGHT**



State of Kansas

Filing Fee Must Accompany the Application
(Please refer to Fee Schedule on signature page of application form.)

Paragraph Nos. 1, 2, 3, 4 & 8 must be completed. Complete all other applicable portions. A topographic map or detailed plat showing the authorized and proposed points(s) of diversion and /or place of use must accompany this application.

1. Application is hereby made for approval of the Chief Engineer to change the

Place of Use

(Check one or more) Point of Diversion

Use Made of Water

File No. 13020

2. Name of applicant: John Houghton

Address: 1437 Briarwood Ln

City, State and Zip: McPherson, KS 67460-2101

Phone Number: (620)755-6471 E-mail address: jh@peoples.bank

What is your relationship to the water right; owner tenant agent other? If other, please explain. _____

Name of water use correspondent: Greg & Tammy Goering

Address: 1066 18th Ave

City, State and Zip: McPherson, KS 67460

Phone Number: (620)755-1455 E-mail address: goeringfarms@aol.com

3. The change(s) proposed herein are desired for the following reasons (please be specific): The changes are desired so that the applicant can cover all acres that are being irrigated that are not authorized. The change will enter the file into a GMD 2 place of use monitoring agreement to cover all necessary acres.

The change(s) (was) completed by This is a paper change to cover acres already being irrigated.
(Date)

For Office Use Only:															
F.O. Code	<u>2</u>	GMD	<u>2</u>	Meets K.A.R. 5-5-1	<input checked="" type="checkbox"/> YES <input type="checkbox"/> NO	Use	<u>IRR</u>	Source	<u>G</u>	County	<u>MP</u>	By	<u>ALB</u>	Date	<u>5/30/23</u>
Fee \$	<u>200</u>	TR #		Receipt Date	<u>5/24/23</u>	Check #	<u>678</u>								

4. The presently authorized place of use is:

Owner of Land — NAME: QUADRANGLE CO LLC ETAL KS DEPT OF AGRICULTURE

ADDRESS: 1437 BRIARWOOD LN, MCPHERSON, KS 67460-2101

Sec.	Twp.	Range	NE¼				NW¼				SW¼				SE¼				TOTAL ACRES			
			NE¼	NW¼	SW¼	SE¼	NE¼	NW¼	SW¼	SE¼	NE¼	NW¼	SW¼	SE¼	NE¼	NW¼	SW¼	SE¼				
4	20S	1W									38	36	40									114

List any other water rights that cover this place of use. None

Owner of Land — NAME: _____

ADDRESS: _____

Sec.	Twp.	Range	NE¼				NW¼				SW¼				SE¼				TOTAL ACRES			
			NE¼	NW¼	SW¼	SE¼	NE¼	NW¼	SW¼	SE¼	NE¼	NW¼	SW¼	SE¼	NE¼	NW¼	SW¼	SE¼				

List any other water rights that cover this place of use. _____

(If there are more than two landowners, attach additional sheets as necessary.)

5. It is proposed that the place of use be changed to:

Owner of Land — NAME: QUADRANGLE CO LLC ETAL

ADDRESS: 1437 BRIARWOOD LN, MCPHERSON, KS 67460-2101

Sec.	Twp.	Range	NE¼				NW¼				SW¼				SE¼				TOTAL ACRES				
			NE¼	NW¼	SW¼	SE¼	NE¼	NW¼	SW¼	SE¼	NE¼	NW¼	SW¼	SE¼	NE¼	NW¼	SW¼	SE¼					
4	20S	1W									32	27	27	32									118

List any other water rights that cover this place of use. None

Owner of Land — NAME: _____

ADDRESS: _____

Sec.	Twp.	Range	NE¼				NW¼				SW¼				SE¼				TOTAL ACRES			
			NE¼	NW¼	SW¼	SE¼	NE¼	NW¼	SW¼	SE¼	NE¼	NW¼	SW¼	SE¼	NE¼	NW¼	SW¼	SE¼				

List any other water rights that cover this place of use. _____

IF MORE SPACE IS NEEDED, ATTACH ADDITIONAL SHEETS AS NECESSARY

6. The presently authorized point(s) of diversion is one well and diversion works

7. The proposed point(s) of diversion is one well and diversion works - no change

(Provide description and number of points)
KS DEPT OF AGRICULTURE
(Provide description and number of points)

List all presently authorized point(s) of diversion:

8. **Presently authorized point of diversion:**
 One in the SE Quarter of the NW Quarter of the SW Quarter of Section 4, Township 20 South, Range 1 W, in McPherson County, Kansas, --- feet North --- feet West of Southeast corner of section.
 Authorized Rate 560 gpm Authorized Quantity 121 AF
 (DWR use only: Computer ID No. 1 GPS N/A feet North N/A feet West)
 This point will not be changed This point will be changed as follows:
Proposed point of diversion: (Complete only if change is requested)
 One in the _____ Quarter of the _____ Quarter of the _____ Quarter of Section _____, Township _____ South, Range _____ (E/W), in _____ County, Kansas, _____ feet North _____ feet West of Southeast corner of section.
 Proposed Rate _____ Proposed Quantity _____
 This point is: Additional Well Geo Center List other water rights that will use this point None

9. **Presently authorized point of diversion:**
 One in the _____ Quarter of the _____ Quarter of the _____ Quarter of Section _____, Township _____ South, Range _____ (E/W), in _____ County, Kansas, _____ feet North _____ feet West of Southeast corner of section.
 Authorized Rate _____ Authorized Quantity _____
 (DWR use only: Computer ID No. _____ GPS _____ feet North _____ feet West)
 This point will not be changed This point will be changed as follows:
Proposed point of diversion: (Complete only if change is requested)
 One in the _____ Quarter of the _____ Quarter of the _____ Quarter of Section _____, Township _____ South, Range _____ (E/W), in _____ County, Kansas, _____ feet North _____ feet West of Southeast corner of section.
 Proposed Rate _____ Proposed Quantity _____
 This point is: Additional Well Geo Center List other water rights that will use this point _____

10. **Presently authorized point of diversion:**
 One in the _____ Quarter of the _____ Quarter of the _____ Quarter of Section _____, Township _____ South, Range _____ (E/W), in _____ County, Kansas, _____ feet North _____ feet West of Southeast corner of section.
 Authorized Rate _____ Authorized Quantity _____
 (DWR use only: Computer ID No. _____ GPS _____ feet North _____ feet West)
 This point will not be changed This point will be changed as follows:
Proposed point of diversion: (Complete only if change is requested)
 One in the _____ Quarter of the _____ Quarter of the _____ Quarter of Section _____, Township _____ South, Range _____ (E/W), in _____ County, Kansas, _____ feet North _____ feet West of Southeast corner of section.
 Proposed Rate _____ Proposed Quantity _____
 This point is: Additional Well Geo Center List other water rights that will use this point _____

11. Describe the current condition of and future plans for any point(s) of diversion which will no longer be used. All points of diversion will continue to be in use.

IF MORE SPACE IS NEEDED, ATTACH ADDITIONAL SHEETS AS NECESSARY

MAY 24 2023

File No. 13020

KS DEPT OF AGRICULTURE

12. The presently authorized use of water is for Irrigation purposes.
It is proposed that the use be changed to No change - irrigation purposes.
13. If changing the place of use and/or use made of water, describe how the consumptive use will not be increased.
The file will enter into a place of use monitoring agreement with GMD 2 to account for the jump in additional acres. This will involve a quantity reduction over the 5 years. The calculation to determine the 5 year allocation is as follows:
50% NIR MP County / 0.85 x base acres x 5 so 0.90/0.85 x 80 x 5 = 423.529 AF to be used over 5 years, an average of about 84.7 AF per year. The file will still have a yearly allocation of 121 AF to adhere to as well.

(Please show any calculations here.)
14. It is requested that the maximum annual quantity of water be reduced to No reduction, see 13 (acre-feet or million gallons).
15. It is requested that the maximum rate of diversion of water be reduced to No reduction, see 13 gallons per minute (--- c.f.s.).
16. The application must include either a topographic map or detailed plat. A U.S. Geological Survey Topographic Map, scale 1:24,000, is available through the Kansas Geological Survey, 1930 Constant Avenue, University of Kansas, Lawrence, Kansas 66047-3726 (www.usgs.gov). The map should show the location of the presently authorized point(s) of diversion. Distances North and West of the Southeast corner of the section must be shown. The presently authorized place of use should also be shown. Identify the center of the section, the section lines and the section corners and show the appropriate section, township, and range numbers on the map. In addition the following information must also be shown on the map.
- a. If a change in the location of the point(s) of diversion is proposed, show:
 - 1) The location of the proposed point(s) of diversion. Distances North and West of the Southeast corner of the section must be shown. Please be certain that the information shown on the map agrees with the information shown in Paragraph Nos. 9, 10 and 11 of the application.
 - 2) If the source of supply is groundwater, please show the location of existing water wells of any kind, including domestic wells, within 1/2 mile of the proposed well or wells. Identify each well as to its use and furnish name and mailing address of the property owner or owners. If there are no wells within 1/2 mile, please indicate so on the map.
 - 3) If the source of supply is surface water, the names and mailing addresses of all landowner(s) 1/2 mile downstream and 1/2 mile upstream from your property lines must be shown.
 - b. If a change in the place of use is desired, show the proposed place of use by crosshatching on the map. Please be certain that the information shown on the map agrees with the information shown in Paragraph No. 5 of the application.
17. Attach documentation to show the change(s) proposed herein will not impair existing water rights and relates to the same local source of supply as to which the water right relates. This information may include statements, plats, geology reports, well logs, test hole logs, and other information as necessary information to show the above. Additional comments may be made below.
The change is not anticipated to impair existing water rights. The point of diversion is not changing, so the supply remains the same. No additional water will be withdrawn at this location, rather less will be. Please see item 13 for more information.

18. If the proposed change(s) does not meet all applicable rules and regulations of the Kansas Water Appropriation Act, please identify the rules and regulations for which you request a waiver. State the reason why a waiver is needed and why the request should be granted. Attach documentation showing that granting the request will not impair existing water rights and will not prejudicially and unreasonably affect the public interest.
A waiver is not anticipated for this change application.

IF MORE SPACE IS NEEDED, ATTACH ADDITIONAL SHEETS AS NECESSARY

MAY 24 2023

File No. 13020

KS DEPT OF AGRICULTURE

Any use of water that is not as authorized by the water right or permit to authorize water before the chief engineer approves this application is a violation of the Kansas Water Appropriation Act for which criminal or civil penalties may be assessed.

The application must be signed by all owners of the place of use authorized under the water right and his or her spouse, if married. Please indicate if there is no spouse.

In the event that all applicants cannot appear before one notary public, they may as necessary sign separate copies of the application before any notary public conveniently available to them.

If the request is signed on behalf of any Owner by someone with legal authority to do so (for example, an agent, one who has power of attorney, or an executor, executrix, conservator), it will be necessary to attach proper documents showing such authority.

I declare that I am an owner of the currently authorized place of use as identified herein, or that I represent all such owners and am authorized to make this application on their behalf, and declare further that the statements contained herein are true, correct, and complete.

Dated at McPherson, Kansas, this 17th day of May, 2023.

John C Houghton manager of Quadrangle Co LLC (Owner) (Spouse)

John C Houghton manager of Quadrangle Co LLC (Please Print) (Please Print)

Dennis C Houghton (Owner) Betty L Houghton (Spouse)

DENNIS C HOUGHTON (Please Print) Betty L Houghton (Please Print)

(Owner) (Spouse)

(Please Print) (Please Print)

State of Kansas } County of McPherson }

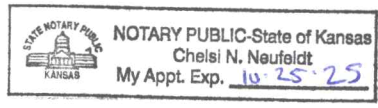

I hereby certify that the foregoing application was signed in my presence and sworn to before me this 17th day of May, 2023.

Chelsi N Neufeldt Notary Public

My Commission Expires 10.25.25

FEE SCHEDULE

Each application to change the place of use, the point of diversion or the use made of the water under this section shall be accompanied by the application fee set forth in the schedule below:

- (1) Application to change a point of diversion 300 feet or less \$100
(2) Application to change a point of diversion more than 300 feet \$200
(3) Application to change the place of use \$200
(4) Application to change the use made of the water \$300

Make check payable to Kansas Department of Agriculture.

MAY 24 2023 File No. 13020

Any use of water that is not as authorized by the water right or permit to authorize water before the chief engineer approves this application is a violation of the Kansas Water Appropriation Act for which criminal or civil penalties may be assessed. Such violation is a class C misdemeanor, punishable by a fine not to exceed \$500 and/or a term of confinement not to exceed one month in the county jail. K.S.A. 82a-728(b). Civil penalties shall be not less than \$100 nor more than \$1,000 per violation. In the case of a continuing violation, each day such violation continues may be deemed a separate violation. In addition to these penalties the water right may be modified or suspended. K.S.A. 82a-737, as amended.

The application must be signed by all owners of the place of use authorized under the water right and his or her spouse, if married. Please indicate if there is no spouse. If land is being purchased under contract, the seller must sign as landowner until such time as the contract is completed.

In the event that all applicants cannot appear before one notary public, they may as necessary sign separate copies of the application before any notary public conveniently available to them. All copies signed in this manner shall be considered to be valid parts of the application.

If the request is signed on behalf of any Owner by someone with legal authority to do so (for example, an agent, one who has power of attorney, or an executor, executrix, conservator), it will be necessary to attach proper documents showing such authority.

I declare that I am an owner of the currently authorized place of use as identified herein, or that I represent all such owners and am authorized to make this application on their behalf, and declare further that the statements contained herein are true, correct, and complete. By filing this application I authorize the chief engineer to permanently reduce the quantity of water and/or rate of diversion as specified in sections 14 and 15 of this application.

Dated at ~~5/23~~ Tulsa, Oklahoma, Kansas, this 17th day of May, 2023.

David Zerger (Owner)
David Zerger (Please Print)
(Owner)
(Please Print)
(Owner)
(Please Print)

Crystal Zerger (Spouse)
Crystal Zerger (Please Print)
(Spouse)
(Please Print)
(Spouse)
(Please Print)

State of Kansas Oklahoma }
County of Tulsa } SS

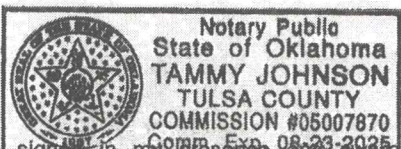

I hereby certify that the foregoing application was signed in my presence and sworn to before me this 17 day of May, 2023.

Tammy Johnson
Notary Public

My Commission Expires 08-23-2025

FEE SCHEDULE

Each application to change the place of use, the point of diversion or the use made of the water under this section shall be accompanied by the application fee set forth in the schedule below:

- (1) Application to change a point of diversion 300 feet or less \$100
(2) Application to change a point of diversion more than 300 feet \$200
(3) Application to change the place of use \$200
(4) Application to change the use made of the water \$300

Make check payable to Kansas Department of Agriculture.

MAY 24 2023

KS DEPT OF AGRICULTURE

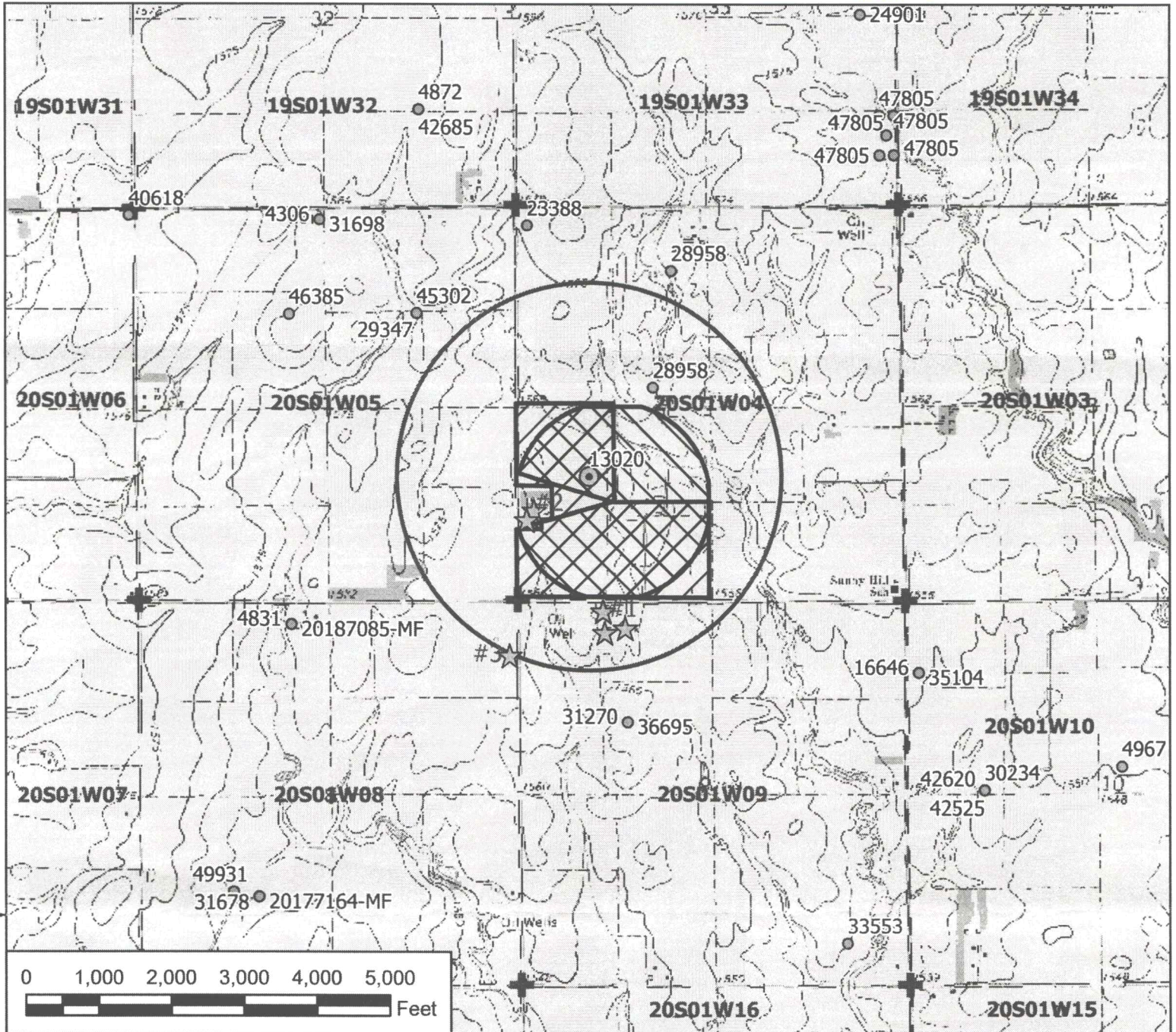

Legend

- Water Appropriation
- ⊙ Authorized Point of Diversion
- ☆ Domestic Well
- ⊕ Section Corner
- ▭ Section Line
- ◯ Half Mile Circle
- ▨ Authorized Place of Use
- ▨ Proposed Place of Use

Water Right, File No. 13020

Change in Place of Use Map 4-20-1W // McPherson County



To the best of my knowledge, all points of diversion within one-half mile of the authorized point of diversion have been shown.

[Handwritten Signature]

5-17-23

Signature / Date

04/20/2023 TMA/SFFO 1:24,000 scale

MAY 24 2023

KS DEPT OF AGRICULTURE



Legend

- Water Appropriation
- ⊙ Authorized Point of Diversion
- ☆ Domestic Well
- ⊕ Section Corner
- ▭ Section Line
- ◻ Half Mile Circle
- ▨ Authorized Place of Use
- ▩ Proposed Place of Use

Water Right, File No. 13020

Change in Place of Use Map 4-20-1W // McPherson County



To the best of my knowledge, all points of diversion within one-half mile of the authorized point of diversion have been shown.

John C. ... 5-17-23
 Signature / Date

MAY 24 2023

KS DEPT OF AGRICULTURE

Nearby Well Owners

Change in Place of Use, Water Right File No. 13020

Potential Domestic wells

#1 (all same owner): Alex & Melanie A Unruh
1705 Sonora Dr
McPherson, KS 67460

#2 (all same owner): David J Skiba
1120 26th Ave
Canton, KS 67428

#3 (on edge of circle, just outside): Melanie Unruh
Po Box 287
Galva, KS 67443

Water Rights (Irrigation wells)

28958: Larry D Becker
325 S Jackson St
Lindsburg, KS 67456