

CHECK SHEET Short Change

(To be completed and attached to each application)

File No. 48,810

Field Office No. 3

GMD No. _____

1. **Plugging agreement obtained for GMD?** Yes No Non Applicable
2. **Is Landowner correct as currently shown in WRIS?** Yes No **Address Change?** NO
If applicable, list Place of Use Overlap File Nos. _____
3. **Is Water Use Correspondent correct as currently shown in WRIS?** Yes No **Address Change?** NO
Name of Former WUC _____ Name of New WUC _____
4. a. **Point of diversion computer ID No(s).** 01,02,03,04,05 for point(s) being changed.

b. **Show feet distances from the** _____ **SE** _____ **corner of the section for the new point(s) of diversion:**

Action	PDIV ID	Geo Ctr?	Sec	Twp	Rng	'N	'W	County	Qualifiers
MOD	82113	YES	08	03S	21W	4703	2937	NT	NE NE NW
MOD	83499	NO	08	03S	21W	4939	3052	NT	NE NE NW
MOD	83500	NO	08	03S	21W	4695	2940	NT	NE NE NW
MOD	83501	NO	08	03S	21W	4473	2822	NT	NE NE NW
DEL	83502	NO	08	03S	21W	4420	2640	NT	SW NW NE

- c. **If multiple points of diversion exist and rates and quantities are individually assigned, show:**
 Old PDIV ID _____ Authorized Rate _____ gpm/cfs Additional Rate _____ gpm/cfs Authorized Quantity _____ af/mgy Additional Quantity _____ af/mgy
- d. **Name of Drainage Basin** PRAIRIE DOG CREEK **Is this correctly shown in WRIS?** Yes No
- e. **Formation Name & No.** OGALLALA FORMATION / 211 **Special Use Area** _____

5. **Distances from the previous/original p/d:** _____ ' N / S _____ ' E / W

6. WATER RIGHT ACTION TRAIL COMMENTS

09/06/16 Change Application Received (date accepted for priority)
09/06/16 Change Approved
 Notice and Proof by 12/31/2016
 _____ / _____ / _____ Completion Requirement Removed (Change No. C _____)

7. METER ACTION TRAIL COMMENTS

_____ / _____ / _____ DWR Meter Required by _____ / _____ / _____

8. Base Acres _____ Year _____ Minimum Reasonable Quantity _____

Date Created **8/26/16** by **M. BILLINGER**
 Date Entered _____ by _____

CHECK SHEET ATTACHMENT

9. Changes to the place of use will be:

File Number 48,810

Action	Owner Person ID	Place Use ID #	Sec.	Twp.	Range	NE¼				NW¼				SW¼				SE¼				TOTAL ACRES
						NE¼	NW¼	SW¼	SE¼	NE¼	NW¼	SW¼	SE¼	NE¼	NW¼	SW¼	SE¼	NE¼	NW¼	SW¼	SE¼	
MOD	63416	65117	08	03S	21W	Acres Authorized	0.5	3.5	27.5	10.5											63	
						New Acres	0.5	3.5	27.5	10.5												
						Acres Authorized																
						New Acres																
						Acres Authorized																
						New Acres																
						Acres Authorized																
						New Acres																

Names and Address:

1. Person ID # <u>63416</u> <u>GENE SCHEMPER</u> <u>18278 RD E 9</u> <u>LENORA, KS 67645</u>	2. Person ID # _____ _____ _____ _____ _____	3. Person ID # _____ _____ _____ _____ _____
---	--	--

GENERAL INSTRUCTIONS

1. Give to Applicant:
 - a. Original application/approval
 - b. Original receipt (one for each application)
 - c. Information packet containing:
 - Notice and Proof form
 - Water Meter Specifications
 - Acceptable Meter list
 - Water level measurement tube specifications
 - Check Valve specifications
 - Pink Sheet - K.S.A. 82a-728 letter
 - Form stating to record in Register of Deeds Office (OPTIONAL AS NEEDED)

2. Send to headquarters:
 - a. Good, scannable copy of application and/or approval and this check sheet
 - b. Original check and copy of receipt
 - c. Test hole log
 - d. GMD recommendation, if any
 - e. Map or aerial photograph, if any
3. Send to KDHE: Letter (KDHE.LT) advising of location of abandoned well.

4. Date stamp received and approved.
5. Complete ownership and WUC change information.

ADDITIONAL PHOTOCOPIES

CONDITIONS

1. Insert notice and proof date.
2. Type or print applicant's/owner's name on line.
3. Complete notary statement.

Kansas
Department of Agriculture
Division of Water Resources

Stockton Field Office
820 S. Walnut
Stockton, Kansas 67669-0192

Jackie McClaskey, Secretary
David W. Barfield, Chief Engineer
Kelly Stewart, Water Commissioner

Phone: (785) 425-6787
Fax: (785) 425-6842
www.agriculture.ks.gov
Sam Brownback, Governor

September 6, 2016

GENE SCHEMPER
18278 RD E 9
LENORA KS 67645

Re: Appropriation of Water, File No. 48,810

Dear Mr. Schemper:

Enclosed is the order executed by David W. Barfield, Chief Engineer, Division of Water Resources, Kansas Department of Agriculture, approving the application for change under the above referenced file number.

Your attention is directed to the terms, conditions, and limitations specified in this approval for change.

Since this order modifies the original certificate, it should be recorded with the Register of Deeds as other instruments affecting real estate.

This document is a summary order by this agency regarding this matter. This order shall become final if a request for a hearing is not filed with the Chief Engineer within 15 days of the date of service of this order.

If you have any questions, please feel free to contact this office. If you wish to refer to a specific file, please reference it when you contact us.

Sincerely,



Mark Billinger
Assistant Water Commissioner

MB:rh
Enclosures

CERTIFICATE OF SERVICE

On this 6th day of September, 2016, I hereby certify that the attached **SUMMARY ORDER APPROVING APPLICATION FOR CHANGE in PLACE OF USE** for appropriation of water, File No. 48,810, dated on the 6th day of September, 2016, was mailed postage prepaid, first class, U.S. mail, to the following:

GENE SCHEMPER
18278 RD E 9
LENORA KS 67645

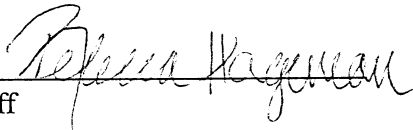
Staff

Submit completed application to:
 Kansas Department of Agriculture
 Division of Water Resources
 Field Office for your area.

Call for address:

Topeka -- (785) 296-5733
 Stafford -- (620) 234-5311
 Stockton -- (785) 425-6787
 Garden City -- (620) 276-2901
<http://agriculture.ks.gov/dwr>

DWR FIELD OFFICE APPLICATION FOR APPROVAL TO CHANGE THE PLACE OF USE AND/OR THE POINT OF DIVERSION



STATE OF KANSAS

9 6 16
 rB

Filing Fee Must Accompany the Application, K.S.A. 82a-708b(b), as amended.
 Fee Schedule is on the third page of this application form.

Paragraph Nos. 1, 2, 3 & 5 must be completed. Complete all other applicable portions. If change in point of diversion is greater than 100 feet, or if place of use will be changed, include a topographic map or detailed plat showing the authorized and proposed point(s) of diversion and/or place of use.

RECEIVED

File No. 48,810

SEP 06 2016
 9:53 am
 Stockton Field Office
 Division of Water Resources

1. Application is hereby made for approval of the Chief Engineer to change the (check one or both):

Place of Use Point of Diversion

under the water right which is the subject of this application in accordance with the conditions described below.

The source of supply is: Groundwater Surface water

2. Name and address of Applicant: Gene Schemper

18278 RD E9 Lenora KS 67645

Phone Number: (785)567-7879 Email address: _____

Name and address of Water Use Correspondent: Same as above

Phone Number: () _____ Email address: _____

3. The presently authorized place of use is:

Owner of Land ---- NAME: Gene L Schemper

ADDRESS: 18278 RD E9 Lenora, KS 67645

(If there is more than one landowner, attach supplemental sheets as necessary.)

Sec.	Twp.	Range	NE¼				NW¼				SW¼				SE¼				TOTAL ACRES
			NE¼	NW¼	SW¼	SE¼	NE¼	NW¼	SW¼	SE¼	NE¼	NW¼	SW¼	SE¼	NE¼	NW¼	SW¼	SE¼	
08	03	21w			40	23													63

4. If this application is for a change in place of use, it is proposed that the place of use be changed to:

Owner of Land ---- NAME: Gene Schemper

ADDRESS: 18278 RD E 9 Lenora KS 67645

(If there is more than one landowner, attach supplemental sheets as necessary.)

Sec.	Twp.	Range	NE¼				NW¼				SW¼				SE¼				TOTAL ACRES
			NE¼	NW¼	SW¼	SE¼	NE¼	NW¼	SW¼	SE¼	NE¼	NW¼	SW¼	SE¼	NE¼	NW¼	SW¼	SE¼	
08	03	21w	.5	3.5	27.5	10.5													63

For Office Use Only: Code _____ Fee \$ _____ TR # _____ Receipt Date _____ Check # _____

5. **Presently authorized point of diversion: Geo Center Battery of 4 wells**
 One in the NW Quarter of the NW Quarter of the NE Quarter of Section 8, Township 3 South, Range 21 WEST, in Norton County, Kansas, 4620 feet North 2640 feet West of Southeast corner of section.
 Authorized Rate 700 gpm Authorized Quantity 75 AF Depth of well _____ (feet)
 (DWR use only: Computer ID No. 01 GPS 4703 feet North 2937 feet West)
 This point will not be changed This point will be changed as follows: Better described by GPS as:
Proposed point of diversion: (Complete only if change is requested) Geo Center Battery of 3 wells
 One in the NE Quarter of the NE Quarter of the NW Quarter of Section 08, Township 03 South, Range 21 WEST, in Norton County, Kansas, 4703 feet North 2937 feet West of Southeast corner of section.
 Proposed Rate 700 gpm Proposed Quantity 75 AF Proposed well depth (feet) _____
 This point is: Additional Well Geo Center List other water rights that will use this point _____

6. **Presently authorized point of diversion:**
 One in the NW Quarter of the NW Quarter of the NE Quarter of Section 8, Township 3 South, Range 21 WEST, in Norton County, Kansas, 4820 feet North 2640 feet West of Southeast corner of section.
 Authorized Rate see geo center Authorized Quantity see geo center Depth of well 180 (feet)
 (DWR use only: Computer ID No. 02 GPS 4939 feet North 3052 feet West)
 This point will not be changed This point will be changed as follows: Better described by GPS as:
Proposed point of diversion: (Complete only if change is requested)
 One in the NE Quarter of the NE Quarter of the NW Quarter of Section 8, Township 3 South, Range 21 WEST, in Norton County, Kansas, 4939 feet North 3052 feet West of Southeast corner of section.
 Proposed Rate see geo center Proposed Quantity see geo center Proposed well depth (feet) _____
 This point is: Additional Well Geo Center List other water rights that will use this point _____

7. Why do you need a new point of diversion? no new p/d:
better describing geo center and battery of 3 wells and
deleting one which will not be completed

8. If a well, is the test hole log attached? Yes No

9. When do you propose to complete the new point of diversion?
n/a

10. If the point of diversion is a well:
 (a) What are you going to do with the old well?
n/a
 (b) When will this be done? _____

11. Groundwater Management District recommendation attached? Yes No

12. Assisted by jkb - Stock FO

13a. If the proposed point of diversion will be relocated within 100 feet of the existing point of diversion, indicate its location on the diagram below in relation to the existing point of diversion. (PLEASE NOTE: The "X" in center of diagram below represents presently authorized point of diversion.)

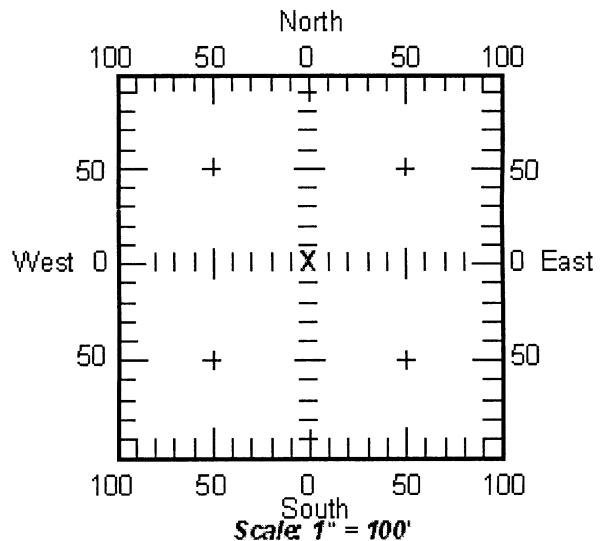

13b. If the proposed point of diversion will be relocated more than 100 feet but within 1320 feet from the existing point of diversion, attach a topographic map or aerial photograph. For groundwater sources, show all wells (including domestic) within one-half mile of the proposed point of diversion and the names and mailing addresses of the owners. For surface water sources, show the names and addresses of the landowner(s) one-half mile downstream and one-half mile upstream from your property lines.

14. If the proposed groundwater point of diversion is 300 or fewer feet from existing point of diversion, complete the following:
- (a) Does the undersigned represent all owners of the currently authorized place(s) of use identified in this application?
 Yes No (If no, all owners must sign this application.)
 - (b) Will the ownership interest of any owner of the currently authorized place(s) of use identified in this application be adversely affected if this application is approved as requested?
 Yes No (If yes, all owners must sign this application.)
 - (c) If this application is not approved expeditiously, will there be substantial damage to property, public health or safety?
 Yes No (If no, all owners must sign this application.)

If the application proposes a surface water change in point of diversion, a groundwater change in point of diversion greater than 300 feet, or a change in place of use, the application must be signed by all owners of the currently authorized place of use, or their duly authorized agent (attach notarized statement authorizing representation).

I hereby verify, being first duly sworn upon my oath or affirmation and under penalty of perjury, that I am of lawful age and the owner, the spouse of the owner, or a duly authorized agent of the owner(s) to make this application on their behalf, in regard to the water right(s) to which this application pertains. I further verify that the statements contained in this application are true, correct and complete.

Dated at 8-23-16, Kansas, this _____ day of _____, 20_____.

David Schaffer
all other wells by my self

 (Please Print)

 (Owner)

 (Please Print)

 (Owner)

 (Please Print)

 (Spouse)

 (Please Print)

 (Spouse)

 (Please Print)

 (Spouse)

 (Please Print)

State of Kansas }
 County of Norton } SS

I hereby certify that the foregoing application was signed in my presence and sworn to before me this 31st day of August, 2016.

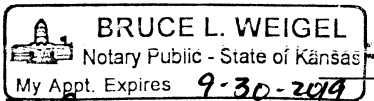

Bruce L. Weigel

 Notary Public

My Commission Expires 9-30-2019

ONLY COMPLETE APPLICATIONS WILL BE PROCESSED. To be complete, all of the applicable portions of the application form must be completed with accurate information; maps, if necessary, must be included; signatures of all the appropriate owners' must be affixed to the application and notarized; and the appropriate fee must be paid.

FEE SCHEDULE

Each application to change the place of use or the point of diversion under this section shall be accompanied by the application fee set forth in the schedule below: Make checks payable to: **Kansas Department of Agriculture**

- (1) Application to change a point of diversion 300 feet or less \$100
- (2) Application to change a point of diversion more than 300 feet \$200
- (3) Application to change the place of use \$200

RECEIVED
 SEP 06 2016

SUMMARY ORDER APPROVING APPLICATION FOR CHANGE AND IMPOSING CONDITIONS

This Summary Order is issued under authority of K.S.A. 82a-708b, as amended, and K.A.R. 5-14-3 and other applicable provisions of the *Kansas Water Appropriation Law*, K.S.A. 82a-701 *et. seq.*, and rules and regulations promulgated thereunder, K.A.R. 5-1-1 *et. seq.* With the exception of those conditions expressly contained herein, this Summary Order does not change the terms, conditions and limitations of File No. 48,810.

1. A change application was received on 9-6-16 requesting that the place of use and / or point of diversion authorized under the above-referenced file number be changed as described in the application.
2. On and after the effective date of this summary order, the authorized place(s) of use shall be located substantially as shown on the topographic map accompanying the application to change the place of use. Applicable Not Applicable
3. The change in point of diversion shall not impair existing rights and shall be limited to the same source or sources of water as previously authorized. The point of diversion authorized by this summary order shall be located within a _____ foot radius of the authorized point(s) of diversion. Applicable Not Applicable
4. The point(s) of diversion authorized herein shall not actually be located more than _____ feet from the previously authorized point(s) of diversion. Applicable Not Applicable
5. As required by K.A.R. 5-3-5d, if the works for diversion is a well with a diversion rate of 100 gallons per minute or more, a tube or other device suitable for making water level measurements shall be installed, operated and maintained in accordance with K.A.R. 5-6-13. Applicable Not Applicable
6. **The owner of the authorized place(s) of use shall properly install an acceptable water flow meter on or before December 31, 20____**, or before the first use of water, whichever occurs first. The water flow meter shall be installed, operated and maintained in accordance with K.A.R. 5-1-4 through 5-1-12. As required by K.S.A. 82a-732, as amended, and K.A.R. 5-3-5e, the owner shall maintain records and report the reading of the water flow meter and the total quantity of water diverted annually to the Chief Engineer by March 1 following the end of each calendar year. Applicable Not Applicable
7. **Installation of the works for diversion of water shall be completed on or before December 31, 20____**, or within any authorized extension of time. By March 1, 20____ the applicant shall notify the Chief Engineer that construction of the works for diversion has been completed, on the form provided by the Chief Engineer, as required by K.A.R. 5-8-4e. Applicable Not Applicable
8. **The completed well log shall be submitted with the required notice.** Applicable Not Applicable
9. All diversion works into which any type of chemical or other foreign substance will be injected into the water shall be equipped with an in-line, automatic, quick-closing check valve capable of preventing pollution of the source of the water supply. The check valve(s) shall be installed, operated and maintained in accordance with K.A.R. 5-3-5c. Applicable Not Applicable
10. Additional Conditions are attached. Yes No
11. In accordance with K.S.A. 82a-708a, as amended, and K.A.R. 5-5-14, all of the owners of the authorized place(s) of use of water appropriated under the above-referenced file number are responsible for compliance with its terms, conditions and limitations, as amended and/or supplemented by this Summary Order, and with applicable provisions of the *Kansas Water Appropriation Law* and the *Rules and Regulations* promulgated thereunder. Failure to comply with these provisions may result in civil penalties pursuant to K.S.A. 82a-737, as amended, and/or the suspension or revocation and dismissal of the water or appropriation right or any other enforcement actions authorized by law.

Administrative Appeal and Effective Date of Order

You have the right to a hearing in accordance with K.A.R. 5-14-3 before this Summary Order becomes final action of the Kansas Department of Agriculture. Any request for a hearing must be filed with the **Chief Engineer, Division of Water Resources, Kansas Department of Agriculture, 1320 Research Park Drive, Manhattan, Kansas 66502**, within 15 days after the date shown on the Certificate of Service attached hereto. If a hearing is not requested in accordance with K.A.R. 5-14-3, this Summary Order will become effective on the 15th day after the date shown on the Certificate of Service.

For Use by Register of Deeds

FOR OFFICE USE ONLY
APPLICATION APPROVED AND SUMMARY ORDER ISSUED

By: Mark Billinger
Jury Authorized Designee of the Chief Engineer

(Print Name): MARK BILLINGER
Division of Water Resources - Kansas Department of Agriculture

Date of Issuance: 9-6-16

State of Kansas)

County of PROOKS) SS

Acknowledged before me on 9-6-16

by Mark Billinger

Signature: Rebecca Hageman
Notary/Public

My commission expires: 6-29-19 (Notary Seal)

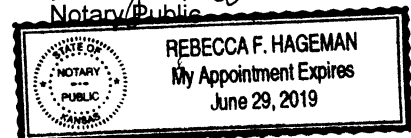

APPLICATION FOR APPROVAL TO CHANGE
THE PLACE OF USE AND/OR POINT OF DIVERSION
SUPPLEMENTAL SHEET

FILE NO. 48,810

MAKE ADDITIONAL COPIES AS NECESSARY

RECEIVED

SEP 06 2016

Stockton Field Office
Division of Water Resources

3. *Continued:* The presently authorized place of use is:

Owner of Land ---- NAME: _____
ADDRESS: _____

Sec.	Twp.	Range	NE¼				NW¼				SW¼				SE¼				TOTAL ACRES	
			NE¼	NW¼	SW¼	SE¼	NE¼	NW¼	SW¼	SE¼	NE¼	NW¼	SW¼	SE¼	NE¼	NW¼	SW¼	SE¼		

Owner of Land ---- NAME: _____
ADDRESS: _____

Sec.	Twp.	Range	NE¼				NW¼				SW¼				SE¼				TOTAL ACRES		
			NE¼	NW¼	SW¼	SE¼	NE¼	NW¼	SW¼	SE¼	NE¼	NW¼	SW¼	SE¼	NE¼	NW¼	SW¼	SE¼			

Owner of Land ---- NAME: _____
ADDRESS: _____

Sec.	Twp.	Range	NE¼				NW¼				SW¼				SE¼				TOTAL ACRES			
			NE¼	NW¼	SW¼	SE¼	NE¼	NW¼	SW¼	SE¼	NE¼	NW¼	SW¼	SE¼	NE¼	NW¼	SW¼	SE¼				

4. *Continued:* If this application is for a change in place of use, it is proposed that the place of use be changed to:

Owner of Land ---- NAME: _____
ADDRESS: _____

Sec.	Twp.	Range	NE¼				NW¼				SW¼				SE¼				TOTAL ACRES				
			NE¼	NW¼	SW¼	SE¼	NE¼	NW¼	SW¼	SE¼	NE¼	NW¼	SW¼	SE¼	NE¼	NW¼	SW¼	SE¼					

Owner of Land ---- NAME: _____
ADDRESS: _____

Sec.	Twp.	Range	NE¼				NW¼				SW¼				SE¼				TOTAL ACRES					
			NE¼	NW¼	SW¼	SE¼	NE¼	NW¼	SW¼	SE¼	NE¼	NW¼	SW¼	SE¼	NE¼	NW¼	SW¼	SE¼						

Owner of Land ---- NAME: _____
ADDRESS: _____

Sec.	Twp.	Range	NE¼				NW¼				SW¼				SE¼				TOTAL ACRES						
			NE¼	NW¼	SW¼	SE¼	NE¼	NW¼	SW¼	SE¼	NE¼	NW¼	SW¼	SE¼	NE¼	NW¼	SW¼	SE¼							

APPLICATION FOR APPROVAL TO CHANGE
THE PLACE OF USE AND/OR POINT OF DIVERSION
SUPPLEMENTAL SHEET
FILE NO. 48,810

Presently authorized point of diversion:

One in the NW Quarter of the NW Quarter of the NE Quarter
of Section 8, Township 3 South, Range 21 (WEST),
in Norton County, Kansas, 4720 feet North 2640 feet West of Southeast corner of section.
Authorized Rate see geo center Authorized Quantity see geo center Depth of well 180 (feet)
(DWR use only: Computer ID No. 03 GPS 4695 feet North 2940 feet West)
 This point will not be changed This point will be changed as follows: Better described by GPS as:

Proposed point of diversion: (Complete only if change is requested)

One in the NE Quarter of the NE Quarter of the NW Quarter
of Section 8, Township 3 South, Range 21 (E/W),
in Norton County, Kansas, 4695 feet North 2940 feet West of Southeast corner of section.
Proposed Rate see geo center Proposed Quantity see geo center Proposed well depth (feet) _____
This point is: Additional Well Geo Center List other water rights that will use this point _____

Presently authorized point of diversion:

One in the SW Quarter of the NW Quarter of the NE Quarter
of Section 8, Township 3 South, Range 21 WEST,
in Norton County, Kansas, 4520 feet North 2640 feet West of Southeast corner of section.
Authorized Rate see geo center Authorized Quantity see geo center Depth of well 180 (feet)
(DWR use only: Computer ID No. 04 GPS 4473 feet North 2822 feet West)
 This point will not be changed This point will be changed as follows: Better described by GPS as:

Proposed point of diversion: (Complete only if change is requested)

One in the NE Quarter of the NE Quarter of the NW Quarter
of Section 8, Township 3 South, Range 21 (WEST),
in Norton County, Kansas, 4473 feet North 2822 feet West of Southeast corner of section.
Proposed Rate see geo center Proposed Quantity see geo center Proposed well depth (feet) _____
This point is: Additional Well Geo Center List other water rights that will use this point _____

Presently authorized point of diversion: This point to be deleted

One in the SW Quarter of the NW Quarter of the NE Quarter
of Section 8, Township 3 South, Range 21 (WEST),
in Norton County, Kansas, 4420 feet North 2640 feet West of Southeast corner of section.
Authorized Rate _____ Authorized Quantity _____ Depth of well _____ (feet)
(DWR use only: Computer ID No. 05 GPS _____ feet North _____ feet West)
 This point will not be changed This point will be changed as follows:

Proposed point of diversion: (Complete only if change is requested)

One in the _____ Quarter of the _____ Quarter of the _____ Quarter
of Section _____, Township _____ South, Range _____ (E/W),
in _____ County, Kansas, _____ feet North _____ feet West of Southeast corner of section.
Proposed Rate _____ Proposed Quantity _____ Proposed well depth (feet) _____
This point is: Additional Well Geo Center List other water rights that will use this point _____

Presently authorized point of diversion:

One in the _____ Quarter of the _____ Quarter of the _____ Quarter
of Section _____, Township _____ South, Range _____ (E/W),
in _____ County, Kansas, _____ feet North _____ feet West of Southeast corner of section.
Authorized Rate _____ Authorized Quantity _____ Depth of well _____ (feet)
(DWR use only: Computer ID No. _____ GPS _____ feet North _____ feet West)
 This point will not be changed This point will be changed as follows:

Proposed point of diversion: (Complete only if change is requested)

One in the _____ Quarter of the _____ Quarter of the _____ Quarter
of Section _____, Township _____ South, Range _____ (E/W),
in _____ County, Kansas, _____ feet North _____ feet West of Southeast corner of section.
Proposed Rate _____ Proposed Quantity _____ Proposed well depth (feet) _____
This point is: Additional Well Geo Center List other water rights that will use this point _____

Application for Change in Place of Use,
 Appropriation of Water, File No. 48,810

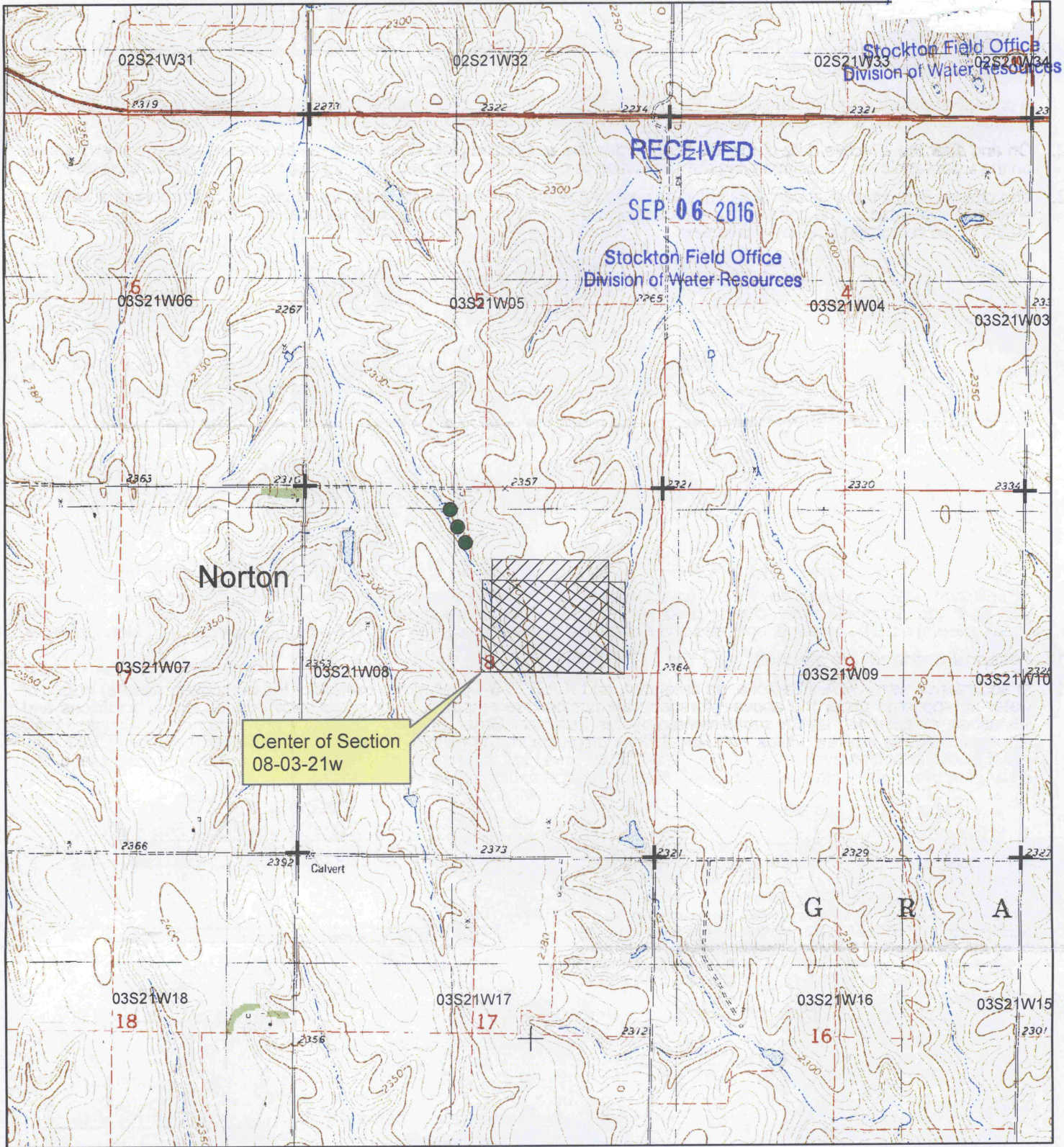

Stockton Field Office
 Division of Water Resources

RECEIVED

SEP 06 2016

Stockton Field Office
 Division of Water Resources

Center of Section
 08-03-21w

⊕ Section Corners

● Point of Diversion

 Currently Authorized Place of Use

 Proposed Place of Use

Map reviewed and approved by:

1:24,000

Hans L. Schemper
 Signature

Date

