

Kansas Department of Agriculture / Division of Water Resources
Stockton Field Office

TO: HEADQUARTERS

RE Vested Right; Water Right; Appropriation of Water; Application

File No(s). 22,253 + 34,512 County NT

Enclosed are the following checked items:

A _____ FIR Full Partial Inspection Return to Field Office

Proposed Certificate to deliver to Certificate Unit

Meter Order: GMD#4

Lower Smoky

Other _____

A Compliance Check Inspection on _____

Meter Install New App Chg App Other _____

In Compliance Not in Compliance, why _____

Modify Point of Diversion No Yes, document attached

Indicate all overlapping p/d files _____

An application and judgment sheet with recommendation.

A memorandum dated _____

A request for an extension of time to perfect or complete.

A verified report.

A closure request.

A field investigation report.

Notice of Non-Compliance _____

Violation

Date

An ownership change (name(s) and address(es) below).

A water use report for _____

A letter dated _____

A copy of an Approval to Change the place of use and/or point of diversion,

Filing Fee attached.

An Advanced copy of a change application and the filing fee, to be processed at the field office. \$400.00

NA (None)

An original field office change application and the filing fee needing headquarters office review and further processing.

ADVANCE COPY

Other: _____

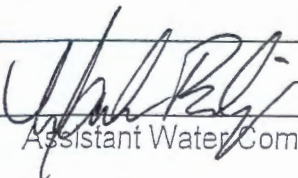
Assistant Water Commissioner

8-14-17
Date

Kansas
Department of Agriculture
Division of Water Resources

Stockton Field Office
820 S. Walnut
Stockton, Kansas 67669-0192

Jackie McClaskey, Secretary
David W. Barfield, Chief Engineer
Kelly Stewart, Water Commissioner

Phone: (785) 425-6787
Fax: (785) 425-6842
www.agriculture.ks.gov

Sam Brownback, Governor

August 14, 2017

DONALD E & MARILYN S LOWRY
21884 STATE HIGHWAY 383
ALMENA, KS 67622-9680

Re: Water Right, File No. 22,253 & 34,512

Dear Mr. & Mrs. Lowry:

This is to advise you that Nelson Farms has filed an application for approval of the Chief Engineer, Division of Water Resources, Kansas Department of Agriculture, to change the point of diversion(s) under the above referenced application.

You are notified on this proposed change in place of use so that you may furnish this office with any comments or other information you may want to submit. Such comments or other information must be received in this office within 15 days from the date of this letter.

You can find the complete application posted by water right file number as referenced above at www.agriculture.ks.gov/divisions-programs/dwr/water-appropriation/notices Should you have any questions, please feel free to call this office. If you would prefer, an appointment could be arranged for additional assistance. Please refer to the file number when you contact us if you wish to discuss a specific file.

Sincerely,



Mark Billinger
Assistant Water Commissioner

MB:rh

Submit completed application to:
 Kansas Department of Agriculture
 Division of Water Resources
 Field Office for your area.

Call for address:

Topeka -- (785) 296-5733
 Stafford -- (620) 234-5311
 Stockton -- (785) 425-6787
 Garden City -- (620) 276-2901
<http://agriculture.ks.gov/dwr>

DWR FIELD OFFICE APPLICATION FOR APPROVAL TO CHANGE THE PLACE OF USE AND/OR THE POINT OF DIVERSION



STATE OF KANSAS

Filing Fee Must Accompany the Application, K.S.A. 82a-708b(b), as amended.
 Fee Schedule is on the third page of this application form.

Paragraph Nos. 1, 2, 3 & 5 must be completed. Complete all other applicable portions. If change in point of diversion is greater than 100 feet, or if place of use will be changed, include a topographic map or detailed plat showing the authorized and proposed point(s) of diversion and/or place of use.

RECEIVED

AUG 11 2017
 12:11 p.m.
 Stockton Field Office
 Division of Water Resources

File No. 34512

1. Application is hereby made for approval of the Chief Engineer to change the (check one or both):

Place of Use Point of Diversion

under the water right which is the subject of this application in accordance with the conditions described below.

The source of supply is: Groundwater Surface water

2. Name and address of Applicant: Nelson Farms Inc.

PO Box 38 Long Island, KS 67647

Phone Number: (785)854-5000 Email address: _____

Name and address of Water Use Correspondent: Same as above

Phone Number: () _____ Email address: _____

3. The presently authorized place of use is:

Owner of Land --- NAME: No change in authorized place of use

ADDRESS: _____

(If there is more than one landowner, attach supplemental sheets as necessary.)

Sec.	Twp.	Range	NE¼				NW¼				SW¼				SE¼				TOTAL ACRES	
			NE¼	NW¼	SW¼	SE¼	NE¼	NW¼	SW¼	SE¼	NE¼	NW¼	SW¼	SE¼	NE¼	NW¼	SW¼	SE¼		

4. If this application is for a change in place of use, it is proposed that the place of use be changed to:

Owner of Land --- NAME: No change in authorized place of use

ADDRESS: _____

(If there is more than one landowner, attach supplemental sheets as necessary.)

Sec.	Twp.	Range	NE¼				NW¼				SW¼				SE¼				TOTAL ACRES		
			NE¼	NW¼	SW¼	SE¼	NE¼	NW¼	SW¼	SE¼	NE¼	NW¼	SW¼	SE¼	NE¼	NW¼	SW¼	SE¼			

For Office Use Only: Code _____ Fee \$ _____ TR # _____ Receipt Date _____ Check # _____

5. **Presently authorized point of diversion:**
 One in the Southwest Quarter of the Northeast Quarter of the Southeast Quarter of Section 27, Township 2 South, Range 22 W, in Norton County, Kansas, 1,380 feet North 736 feet West of Southeast corner of section.
 Authorized Rate 300 gpm Authorized Quantity 53 AF Depth of well _____ (feet)
(DWR use only: Computer ID No. 14 GPS _____ feet North _____ feet West)
 This point will not be changed This point will be changed as follows: No change, point better described with GPS as follows:
Proposed point of diversion: (Complete only if change is requested or if existing point is better described by GPS)
 One in the Northeast Quarter of the Southwest Quarter of the Southeast Quarter of Section 27, Township 2 South, Range 22 W, in Norton County, Kansas, 1,235 feet North 1,562 feet West of Southeast corner of section.
 Proposed Rate 300 gpm Proposed Quantity 53 AF Proposed well depth (feet) _____
 This point is: Additional Well Geo Center List other water rights that will use this point None

6. **Presently authorized point of diversion:**
 One in the _____ Quarter of the _____ Quarter of the _____ Quarter of Section _____, Township _____ South, Range _____ (E/W), in _____ County, Kansas, _____ feet North _____ feet West of Southeast corner of section.
 Authorized Rate _____ Authorized Quantity _____ Depth of well _____ (feet)
(DWR use only: Computer ID No. _____ GPS _____ feet North _____ feet West)
 This point will not be changed This point will be changed as follows: No change, point better described with GPS as follows:
Proposed point of diversion: (Complete only if change is requested or if existing point is better described by GPS)
 One in the _____ Quarter of the _____ Quarter of the _____ Quarter of Section _____, Township _____ South, Range _____ (E/W), in _____ County, Kansas, _____ feet North _____ feet West of Southeast corner of section.
 Proposed Rate _____ Proposed Quantity _____ Proposed well depth (feet) _____
 This point is: Additional Well Geo Center List other water rights that will use this point _____

7. The changes herein are desired for the following reasons?
 (please be specific) Moving this water right to the well
currently covered by file no. 22,253. File No. 22,253 will
be moved to the well currently auth. by 34,512.

8. If a well, is the test hole log attached? Yes No

9. The change(s) (was)(will be) completed by?
Wells already complete, flip-flopping water rights.

10. If the point of diversion is a well:
 (a) What are you going to do with the old well?
n/a

(b) When will this be done? n/a

11. Groundwater Management District recommendation attached? Yes No

12. Assisted by DLM-STKFO

13a. If the proposed point of diversion will be relocated within 100 feet of the existing point of diversion, indicate its location on the diagram below in relation to the existing point of diversion. (PLEASE NOTE: The "X" in center of diagram below represents presently authorized point of diversion.)

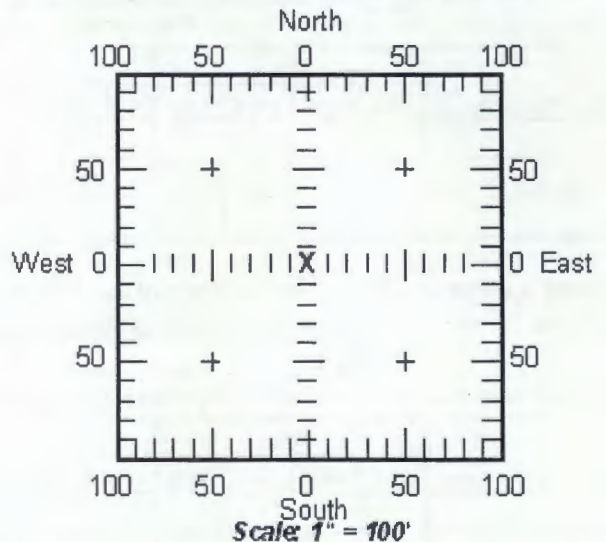

13b. If the proposed point of diversion will be relocated more than 100 feet but within 1320 feet from the existing point of diversion, attach a topographic map or aerial photograph. For groundwater sources, show all wells (including domestic) within one-half mile of the proposed point of diversion and the names and mailing addresses of the owners. For surface water sources, show the names and addresses of the landowner(s) one-half mile downstream and one-half mile upstream from your property lines.

14. If the proposed groundwater point of diversion is 300 or fewer feet from existing point of diversion, complete the following:

- (a) Does the undersigned represent all owners of the currently authorized place(s) of use identified in this application?
 Yes No (If no, all owners must sign this application.)
- (b) Will the ownership interest of any owner of the currently authorized place(s) of use identified in this application be adversely affected if this application is approved as requested?
 Yes No (If yes, all owners must sign this application.)
- (c) If this application is not approved expeditiously, will there be substantial damage to property, public health or safety?
 Yes No (If no, all owners must sign this application.)

If the application proposes a surface water change in point of diversion, a groundwater change in point of diversion greater than 300 feet, or a change in place of use, the application must be signed by all owners of the currently authorized place of use, or their duly authorized agent (attach notarized statement authorizing representation).

I hereby verify, being first duly sworn upon my oath or affirmation and under penalty of perjury, that I am of lawful age and the owner, the spouse of the owner, or a duly authorized agent of the owner(s) to make this application on their behalf, in regards to the water right(s) to which this application pertains. I further verify that the statements contained in this application are true, correct and complete.

Dated at Stockton, Kansas, this 11 day of August, 2017.

Nelson Farms Inc
 (Owner)
N. Terry Nelson
 (Please Print)

Nelson Farms Inc
 (Spouse)
N Terry Nelson
 (Please Print)

 (Owner)

 (Please Print)

 (Owner)

 (Please Print)

 (Spouse)

 (Please Print)

 (Spouse)

 (Please Print)

State of Kansas }
County of Rooks } SS

I hereby certify that the foregoing application was signed in my presence and sworn to before me this 11th day of August, 2017



Rebecca Hageman
 Notary Public

My Commission Expires 6-29-19

ONLY COMPLETE APPLICATIONS WILL BE PROCESSED. To be complete, all of the applicable portions of the application form must be completed with accurate information; maps, if necessary, must be included; signatures of all the appropriate owners' must be affixed to the application and notarized; and the appropriate fee must be paid.

FEE SCHEDULE

Each application to change the place of use or the point of diversion under this section shall be accompanied by the application fee set forth in the schedule below: Make checks payable to: **Kansas Department of Agriculture**

(1) Application to change a point of diversion 300 feet or less	\$100
(2) Application to change a point of diversion more than 300 feet	\$200
(3) Application to change the place of use	\$200

Application to Change the Point of Diversion Water Right File No. 34,512

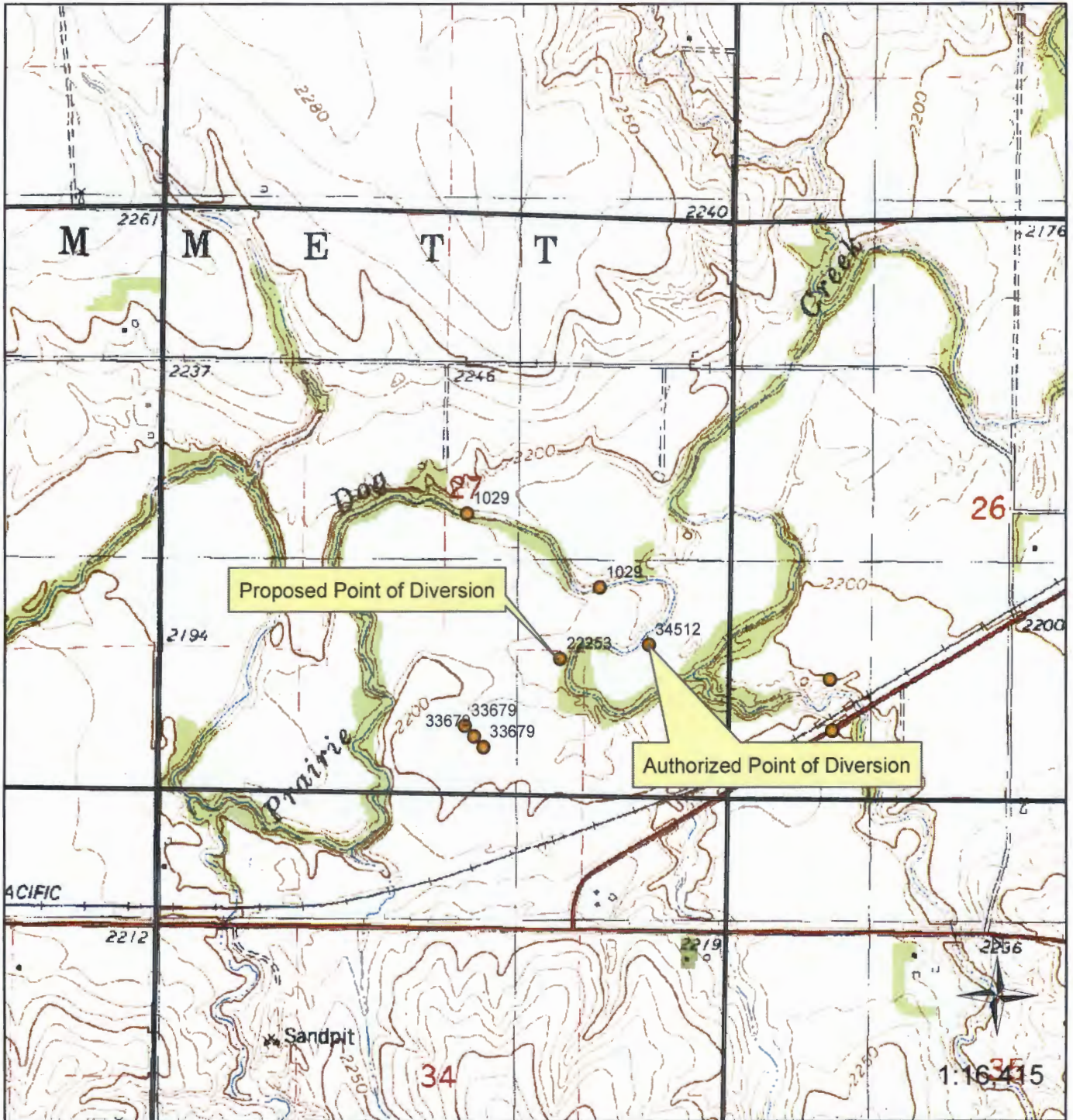

All wells, including domestic, within 1/2 mile of the proposed point of diversion are shown.

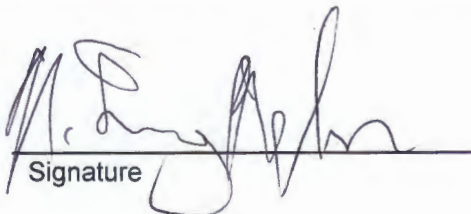
Signature

8-11-2017
Date