

NOTICE

This scan only represents the application as filed. The information contained herein meets the requirements of K.A.R. 5-3-1 or K.A.R. 5-5-1, and has been found acceptable for filing in the office of the Chief Engineer. The application should not be considered to be a complete application as per K.A.R. 5-3-1b or K.A.R. 5-5-2a.

Submit To: CHIEF ENGINEER
 Division of Water Resources
 Kansas Department of Agriculture
 1320 Research Park Drive
 Manhattan, KS 66502
www.ksda.gov/dwr

**APPLICATION FOR APPROVAL TO
 CHANGE THE PLACE OF USE, THE
 POINT OF DIVERSION OR THE USE
 MADE OF THE WATER UNDER AN
 EXISTING WATER RIGHT**



Filing Fee Must Accompany the Application
 (Please refer to Fee Schedule on signature page of application form.)

Paragraph Nos. 1, 2, 3, 4 & 8 must be completed. Complete all other applicable portions. A topographic map or detailed plat showing the authorized and proposed points(s) of diversion and /or place of use must accompany this application.

1. Application is hereby made for approval of the Chief Engineer to change the

- Place of Use
- (Check one or more) Point of Diversion
- Use Made of Water

WATER RESOURCES
 RECEIVED

JUL 21 2017
 9:00

KS DEPT OF AGRICULTURE

File No. 8447

2. Name of applicant: Opal Thompson Family Trust - Opal M. Thompson Trustee

Address: 1068 Xavier Rd

City, State and Zip: Concordia, KS 66901

Phone Number: (785-335-2307) E-mail address: _____

What is your relationship to the water right; owner tenant agent other? If other, please explain. _____

Name of water use correspondent: Karl Jacobson

Address: 260 110 Rd

City, State and Zip: Concordia, KS 66901

Phone Number: 785-335-2657 E-mail address: _____

3. The change(s) proposed herein are desired for the following reasons (please be specific): The proposed changes are to overlap place of use with WR File No. 6420 and flip-flop the water rights of the two files. The proposed changes will allow the owners to convert from flood irrigation to center pivot and allow for the stronger well to have a higher allocation.

The change(s) will be completed by December 31st, 2018 (Date)

For Office Use Only:															
F.O.	<u>3</u>	GMD	<u>0</u>	Meets K.A.R. 5-5-1 (YES/NO)	Use	<u>IRR</u>	Source	<u>G</u>	S	County	<u>FP</u>	By	<u>AW</u>	Date	<u>7/21/17</u>
Code	<u>C-2</u>	Fee \$	<u>400</u>	TR #		Receipt Date	<u>7/24/17</u>	Check #	<u>4324</u>						

7/28/17 AW

Don is the son of Carroll T. Don owns the west 80 acres. On contract of file No. 8447: The question is asked in paragraph No. 2 "What is the relationship of the owner to the other? Don Thompson is a Nephew to Opal's deceased spouse, Floyd Thompson. He "cash rents" as a Tenant. Also the relationship to Karl Jacobson.

WATER RESOURCES
RECEIVED

JUL 21 2017

KS DEPT OF AGRICULTURE

June 22, 2017

Dear Opal & Tom,

The Kansas Water Resources Dept. sent back our applications for use because we signed the wrong contract. Actually, we were sent the wrong contract by the office and we signed them and forwarded them. I should have signed file no. 6420 and you should have signed file no. 8447.

I talked with Mr. Walters at the Stockton office and he emailed me new copies for us to sign so I am mailing your copy along with the check and old signature page.

Please sign the 8447 contract and have it notarized also. Mail it and the check to Mr. Steven Walters at
Kansas Department of Agriculture
Division of Water Resources
Stockton Field Office
820 A. Walnut
Stockton, Kansas 67669-0192

You can keep the old signature page.

Thanks,
Don

4. The presently authorized place of use is:

Owner of Land — NAME: Opal Thompson Family Trust - Opal M. Thompson Trustee
 ADDRESS: 1068 Xavier Rd, Concordia, KS 66901

Sec.	Twp.	Range	NE¼				NW¼				SW¼				SE¼				TOTAL ACRES
			NE¼	NW¼	SW¼	SE¼	NE¼	NW¼	SW¼	SE¼	NE¼	NW¼	SW¼	SE¼	NE¼	NW¼	SW¼	SE¼	
22	04S	04W															26	22	48

List any other water rights that cover this place of use. _____

Owner of Land — NAME: _____
 ADDRESS: _____

Sec.	Twp.	Range	NE¼				NW¼				SW¼				SE¼				TOTAL ACRES
			NE¼	NW¼	SW¼	SE¼	NE¼	NW¼	SW¼	SE¼	NE¼	NW¼	SW¼	SE¼	NE¼	NW¼	SW¼	SE¼	

List any other water rights that cover this place of use. _____

(If there are more than two landowners, attach additional sheets as necessary.)

5. It is proposed that the place of use be changed to:

Owner of Land — NAME: Opal Thompson Family Trust - Opal M. Thompson Trustee
 ADDRESS: 1068 Xavier Rd, Concordia, KS 66901

Sec.	Twp.	Range	NE¼				NW¼				SW¼				SE¼				TOTAL ACRES
			NE¼	NW¼	SW¼	SE¼	NE¼	NW¼	SW¼	SE¼	NE¼	NW¼	SW¼	SE¼	NE¼	NW¼	SW¼	SE¼	
22	04S	04W															26	22	48

List any other water rights that cover this place of use. 6420

Owner of Land — NAME: Don Duane Thompson
 ADDRESS: 18720 Pine Rd, Argos, IN 46501-9745

Sec.	Twp.	Range	NE¼				NW¼				SW¼				SE¼				TOTAL ACRES
			NE¼	NW¼	SW¼	SE¼	NE¼	NW¼	SW¼	SE¼	NE¼	NW¼	SW¼	SE¼	NE¼	NW¼	SW¼	SE¼	
22	04S	04W									40			40					80

List any other water rights that cover this place of use. 6420

IF MORE SPACE IS NEEDED, ATTACH ADDITIONAL SHEETS AS NECESSARY

WATER RESOURCES
RECEIVED

JUL 21 2017

KS DEPT OF AGRICULTURE

6. The presently authorized point(s) of diversion is 1 well
(Provide description and number of points)

7. The proposed point(s) of diversion is 1 well
(Provide description and number of points)

List all presently authorized point(s) of diversion:

8. **Presently authorized point of diversion:**
 One in the SW Quarter of the SW Quarter of the SE Quarter of Section 22, Township 04 South, Range 04 W, in Republic County, Kansas, 565 feet North 2620 feet West of Southeast corner of section.
 Authorized Rate 600 gpm Authorized Quantity 75 AF
 (DWR use only: Computer ID No. 10 GPS 39.6843 feet North 97.75308 feet West)
 This point will not be changed This point will be changed as follows:
Proposed point of diversion: (Complete only if change is requested)
 One in the NW Quarter of the NE Quarter of the SW Quarter of Section 22, Township 04 South, Range 04 W, in Republic County, Kansas, 2620 feet North 3375 feet West of Southeast corner of section.
 Proposed Rate 1070 gpm Proposed Quantity 114 AF
 This point is: Additional Well Geo Center List other water rights that will use this point _____

9. **Presently authorized point of diversion:**
 One in the _____ Quarter of the _____ Quarter of the _____ Quarter of Section _____, Township _____ South, Range _____ W, in _____ County, Kansas, _____ feet North _____ feet West of Southeast corner of section.
 Authorized Rate _____ Authorized Quantity _____
 (DWR use only: Computer ID No. _____ GPS _____ feet North _____ feet West)
 This point will not be changed This point will be changed as follows:
Proposed point of diversion: (Complete only if change is requested)
 One in the _____ Quarter of the _____ Quarter of the _____ Quarter of Section _____, Township _____ South, Range _____ W, in _____ County, Kansas, _____ feet North _____ feet West of Southeast corner of section.
 Proposed Rate _____ Proposed Quantity _____
 This point is: Additional Well Geo Center List other water rights that will use this point _____

10. **Presently authorized point of diversion:**
 One in the _____ Quarter of the _____ Quarter of the _____ Quarter of Section _____, Township _____ South, Range _____ W, in _____ County, Kansas, _____ feet North _____ feet West of Southeast corner of section.
 Authorized Rate _____ Authorized Quantity _____
 (DWR use only: Computer ID No. _____ GPS _____ feet North _____ feet West)
 This point will not be changed This point will be changed as follows:
Proposed point of diversion: (Complete only if change is requested)
 One in the _____ Quarter of the _____ Quarter of the _____ Quarter of Section _____, Township _____ South, Range _____ W, in _____ County, Kansas, _____ feet North _____ feet West of Southeast corner of section.
 Proposed Rate _____ Proposed Quantity _____
 This point is: Additional Well Geo Center List other water rights that will use this point _____

11. Describe the current condition of and future plans for any point(s) of diversion which will no longer be used. _____

IF MORE SPACE IS NEEDED, ATTACH ADDITIONAL SHEETS AS NECESSARY

WATER RESOURCES
RECEIVED

JUL 21 2017

12. The presently authorized use of water is for Irrigation purposes.
It is proposed that the use be changed to Irrigation purposes.
13. If changing the place of use and/or use made of water, describe how the consumptive use will not be increased.
The change is place of use is to facilitate a change from flood irrigation to center pivot which will allow for the more
effeicient use of water.

(Please show any calculations here.)
14. It is requested that the maximum annual quantity of water be reduced to NA (acre-feet or million gallons).
15. It is requested that the maximum rate of diversion of water be reduced to NA gallons per minute (____ c.f.s.).
16. The application must include either a topographic map or detailed plat. A U.S. Geological Survey Topographic Map, scale 1:24,000, is available through the Kansas Geological Survey, 1930 Constant Avenue, University of Kansas, Lawrence, Kansas 66047-3726 (www.usgs.gov). The map should show the location of the presently authorized point(s) of diversion. Distances North and West of the Southeast corner of the section must be shown. The presently authorized place of use should also be shown. Identify the center of the section, the section lines and the section corners and show the appropriate section, township, and range numbers on the map. In addition the following information must also be shown on the map.
- a. If a change in the location of the point(s) of diversion is proposed, show:
 - 1) The location of the proposed point(s) of diversion. Distances North and West of the Southeast corner of the section must be shown. Please be certain that the information shown on the map agrees with the information shown in Paragraph Nos. 9, 10 and 11 of the application.
 - 2) If the source of supply is groundwater, please show the location of existing water wells of any kind, including domestic wells, within ½ mile of the proposed well or wells. Identify each well as to its use and furnish name and mailing address of the property owner or owners. If there are no wells within ½ mile, please indicate so on the map.
 - 3) If the source of supply is surface water, the names and mailing addresses of all landowner(s) ½ mile downstream and ½ mile upstream from your property lines must be shown.
 - b. If a change in the place of use is desired, show the proposed place of use by crosshatching on the map. Please be certain that the information shown on the map agrees with the information shown in Paragraph No. 5 of the application.
17. Attach documentation to show the change(s) proposed herein will not impair existing water rights and relates to the same local source of supply as to which the water right relates. This information may include statements, plats, geology reports, well logs, test hole logs, and other information as necessary information to show the above. Additional comments may be made below.

18. If the proposed change(s) does not meet all applicable rules and regulations of the Kansas Water Appropriation Act, please identify the rules and regulations for which you request a waiver. State the reason why a waiver is needed and why the request should be granted. Attach documentation showing that granting the request will not impair existing water rights and will not prejudicially and unreasonably affect the public interest.

IF MORE SPACE IS NEEDED, ATTACH ADDITIONAL SHEETS AS NECESSARY

WATER RESOURCES
RECEIVED

JUL 21 2017

KS DEPT OF AGRICULTURE

FILED

Any use of water that is not as authorized by the water right or permit to authorize water **before** the chief engineer approves this application is a violation of the Kansas Water Appropriation Act for which criminal or civil penalties may be assessed. Such violation is a class C misdemeanor, punishable by a fine not to exceed \$500 and/or a term of confinement not to exceed one month in the county jail. K.S.A. 82a-728(b). Civil penalties shall be not less than \$100 nor more than \$1,000 per violation. In the case of a continuing violation, each day such violation continues may be deemed a separate violation. In addition to these penalties the water right may be modified or suspended. K.S.A. 82a-737, as amended.

The application must be signed by all owners of the place of use authorized under the water right and his or her spouse, if married. Please indicate if there is no spouse. If land is being purchased under contract, the seller must sign as landowner until such time as the contract is completed.

In the event that all applicants cannot appear before one notary public, they may as necessary sign separate copies of the application before any notary public conveniently available to them. All copies signed in this manner shall be considered to be valid parts of the application.

If the request is signed on behalf of any Owner by someone with legal authority to do so (for example, an agent, one who has power of attorney, or an executor, executrix, conservator), it will be necessary to attach proper documents showing such authority.

I declare that I am an owner of the currently authorized place of use as identified herein, or that I represent all such owners and am authorized to make this application on their behalf, and declare further that the statements contained herein are true, correct, and complete. By filing this application I authorize the chief engineer to permanently reduce the quantity of water and/or rate of diversion as specified in sections 14 and 15 of this application.

Dated at Concordia, Kansas, this 27th day of June, 20 17.

<u>Opal M. Thompson</u> (Owner)	_____	(Spouse)
<u>Opal M. Thompson</u> (Please Print)	_____	(Please Print)
_____	_____	(Spouse)
_____	_____	(Please Print)
_____	_____	(Spouse)
_____	_____	(Please Print)

State of Kansas }
County of Cloud } SS

I hereby certify that the foregoing application was signed in my presence and sworn to before me this 27 day of June, 20 17.



My Commission Expires _____

Notary Public

FEE SCHEDULE

Each application to change the place of use, the point of diversion or the use made of the water under this section shall be accompanied by the application fee set forth in the schedule below:

- (1) Application to change a point of diversion 300 feet or less \$100
- (2) Application to change a point of diversion more than 300 feet \$200
- (3) Application to change the place of use \$200
- (4) Application to change the use made of the water \$300

Make check payable to **Kansas Department of Agriculture.**

WATER RESOURCES
RECEIVED

JUL 21 2017

KS DEPT OF AGRICULTURE

Well owners within ½ Mile of the proposed point of diversion for Water Right File No. 8447

Water Right File No. 6711 and 9343

NORMA M CARLGREN TRUST

KATHLEEN PIERSON

713 E WILSON ST

SALINA KS 67401-5354

WATER RESOURCES
RECEIVED

JUL 21 2017

KS DEPT OF AGRICULTURE

1320 Research Park Drive
Manhattan, Kansas 66502
(785) 564-6700



900 SW Jackson, Room 456
Topeka, Kansas 66612
(785) 296-3556

Jackie McClaskey, Secretary

Governor Sam Brownback
FILE COPY

OPAL THOMPSON, TRUSTEE
OPAL THOMPSON FAMILY TRUST
1068 ZAVIER RD
CONCORDIA, KS 66901

July 25, 2017

RE: File No 8447

Dear Sir or Madam:

An application for approval of the Chief Engineer to change the following condition or conditions of the file number referred to above has been received:

- place of use PU/PD
- point of diversion
- use made of water

As a matter of record, the Division of Water Resources has on hand a large number of applications awaiting processing. Therefore, to be fair to all concerned, and so that we can process those applications on hand in the order they were received, we intend to concentrate on the backlog of applications until the issue is resolved. You will be contacted regarding this application as soon as it has been examined.

In accordance with the provisions of the Kansas Water Appropriation Act, a portion of which is included below, the use of water prior to approval of the application is unlawful. You should not proceed and divert water as indicated by your plans in your application for a change for this file until you receive approval for this change from the Chief Engineer. Once approved, compliance with the terms, conditions and limitations of the permit is necessary. Conservation of the water resources of Kansas is required.

Section 82a-728 of the Kansas Water Appropriation Act, provides (a) except for the appropriation of water for the purpose of domestic use, . . . it shall be unlawful for any person to appropriate or threaten to appropriate water from any source without first applying for and obtaining a permit to appropriate water in accordance with the provisions of the Water Appropriation Act or for any person to violate any condition of a vested right, appropriation right or an approved application for a permit to appropriate water for beneficial use.

(b) (1) The violation of any provision of this section by any person is a class C misdemeanor...

A class C misdemeanor is punishable by a fine not to exceed \$500 and/or a term of confinement not to exceed one month in the county jail. Each day that the violation occurs constitutes a separate offense.

If you have any questions, please contact me at (785) 564-6645. If you wish to discuss a specific file, please have the file number ready so that we may help you more efficiently.

Sincerely,

A handwritten signature in cursive script that reads "Brent A. Tourney".



Brent Tourney, L.G.
Change Applications Unit Supervisor
Water Appropriation Program

BAT: DLW
pc: STOCKTON Field Office GMD

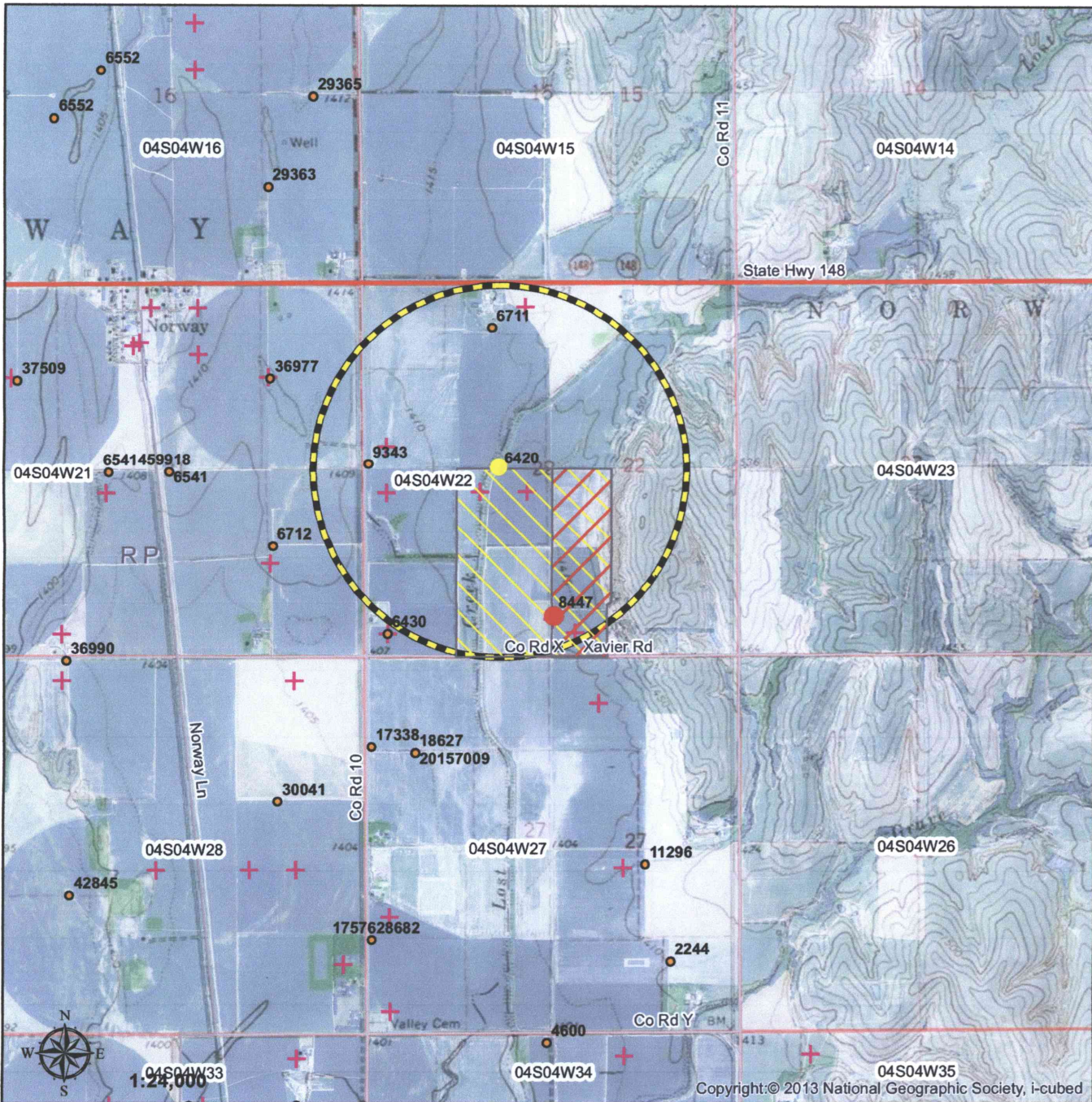

Application for Change in
Place of Use and Point of Diversion
Water Right File No. 8447



-  Authorized Place of Use
-  Proposed Place of Use
-  1/2 mile buffer

-  Current Point of Diversion
-  Proposed Point of Diversion
-  WWC5 records

Opal M. Thompson

-  Surface Water Point of Diversion
-  Groundwater Point of Diversion

All wells owners within 1/2 mile of the proposed point of diversion are identified on the map and addresses included on the attached list.

WATER RESOURCES RECEIVED

JUL 21 2017