

NOTICE

This scan only represents the application as filed. The information contained herein meets the requirements of K.A.R. 5-3-1 or K.A.R. 5-5-1, and has been found acceptable for filing in the office of the Chief Engineer. The application should not be considered to be a complete application as per K.A.R. 5-3-1b or K.A.R. 5-5-2a.

Submit To: CHIEF ENGINEER
Division of Water Resources
Kansas Department of Agriculture
1320 Research Park Drive
Manhattan, KS 66502
www.ksda.gov/dwr

**APPLICATION FOR APPROVAL TO
CHANGE THE PLACE OF USE, THE
POINT OF DIVERSION OR THE USE
MADE OF THE WATER UNDER AN
EXISTING WATER RIGHT**



State of Kansas

Filing Fee Must Accompany the Application
(Please refer to Fee Schedule on signature page of application form.)

Paragraph Nos. 1, 2, 3, 4 & 8 must be completed. Complete all other applicable portions. A topographic map or detailed plat showing the authorized and proposed points(s) of diversion and /or place of use must accompany this application.

1. Application is hereby made for approval of the Chief Engineer to change the

- Place of Use
(Check one or more) Point of Diversion
 Use Made of Water

WATER RESOURCES
RECEIVED

MAR 1 2018

11:55

KS DEPT OF AGRICULTURE

File No. 4.304

2. Name of applicant: Nelson Farms Inc.

Address: PO Box 38

City, State and Zip: Long Island, KS 67647

Phone Number: (785)854-7611

E-mail address: terrynelson@ruraltel.net

What is your relationship to the water right; owner tenant agent other? If other, please explain. _____

Name of water use correspondent: Nelson Farms Inc.

Address: PO Box 38

City, State and Zip: Long Island, KS 67647

Phone Number: (785)854-7611

E-mail address: terrynelson@ruraltel.net

3. The change(s) proposed herein are desired for the following reasons (please be specific): To assign specific quantities to the irrigation wells that are being changed for dual use purposes (STK & IRR).

The change(s) (was) (will be) completed by already complete.

(Date)

For Office Use Only:

F.O. 3 GMD 3 Meets K.A.R. 5-5-1 (YES) NO) Use IRR/STK Source (G)S County PL By AW Date 3/1/18
Code C&T Fee \$ 200 TR # _____ Receipt Date 3/1/18 Check # 24028

4. The presently authorized place of use is:

Owner of Land — NAME: No change requested.

ADDRESS: _____

Sec.	Twp.	Range	NE¼				NW¼				SW¼				SE¼				TOTAL ACRES
			NE¼	NW¼	SW¼	SE¼	NE¼	NW¼	SW¼	SE¼	NE¼	NW¼	SW¼	SE¼	NE¼	NW¼	SW¼	SE¼	

WATER RESOURCES RECEIVED
MAR 1 2018

List any other water rights that cover this place of use. _____

KS DEPT OF AGRICULTURE

Owner of Land — NAME: _____

ADDRESS: _____

Sec.	Twp.	Range	NE¼				NW¼				SW¼				SE¼				TOTAL ACRES
			NE¼	NW¼	SW¼	SE¼	NE¼	NW¼	SW¼	SE¼	NE¼	NW¼	SW¼	SE¼	NE¼	NW¼	SW¼	SE¼	

List any other water rights that cover this place of use. _____

(If there are more than two landowners, attach additional sheets as necessary.)

5. It is proposed that the place of use be changed to:

Owner of Land — NAME: _____

ADDRESS: _____

Sec.	Twp.	Range	NE¼				NW¼				SW¼				SE¼				TOTAL ACRES
			NE¼	NW¼	SW¼	SE¼	NE¼	NW¼	SW¼	SE¼	NE¼	NW¼	SW¼	SE¼	NE¼	NW¼	SW¼	SE¼	

List any other water rights that cover this place of use. _____

Owner of Land — NAME: _____

ADDRESS: _____

Sec.	Twp.	Range	NE¼				NW¼				SW¼				SE¼				TOTAL ACRES
			NE¼	NW¼	SW¼	SE¼	NE¼	NW¼	SW¼	SE¼	NE¼	NW¼	SW¼	SE¼	NE¼	NW¼	SW¼	SE¼	

List any other water rights that cover this place of use. _____

IF MORE SPACE IS NEEDED, ATTACH ADDITIONAL SHEETS AS NECESSARY

- 6. The presently authorized point(s) of diversion (is) (are) 2 wells (IRR) and Batt. of 2 wells, 1 primary and 1 standy well (STK).
(Provide description and number of points)
- 7. The proposed point(s) of diversion (is) (are) 2 wells (STK & IRR) and Batt. of 2 wells 1 primary and 1 standby well (STK)
(Provide description and number of points)

List all presently authorized point(s) of diversion:

8. **Presently authorized point of diversion: IRR**
 One in the Southwest Quarter of the Northwest Quarter of the Southwest Quarter of Section 33, Township 1 South, Range 20 W, in Phillips County, Kansas, 1,519 feet North 4,845 feet West of Southeast corner of section.
 Authorized Rate 290 gpm Authorized Quantity 20 AF
 (DWR use only: Computer ID No. 6 GPS _____ feet North _____ feet West)
 This point will not be changed This point will be changed as follows:
Proposed point of diversion: (Complete only if change is requested)
 One in the Southwest Quarter of the Northwest Quarter of the Southwest Quarter of Section 33, Township 1 South, Range 20 W, in Phillips County, Kansas, 1,519 feet North 4,845 feet West of Southeast corner of section.
 Proposed Rate 290 gpm Proposed Quantity 93 AF
 This point is: Additional Well Geo Center List other water rights that will use this point 37,269.01

9. **Presently authorized point of diversion: IRR**
 One in the CW Quarter of the Northwest Quarter of the Southeast Quarter of Section 33, Township 1 South, Range 20 W, in Phillips County, Kansas, 2,040 feet North 2,605 feet West of Southeast corner of section.
 Authorized Rate 600 gpm Authorized Quantity 103 AF
 (DWR use only: Computer ID No. 5 GPS _____ feet North _____ feet West)
 This point will not be changed This point will be changed as follows:
Proposed point of diversion: (Complete only if change is requested)
 One in the CW Quarter of the Northwest Quarter of the Southeast Quarter of Section 33, Township 1 South, Range 20 W, in Phillips County, Kansas, 2,040 feet North 2,605 feet West of Southeast corner of section.
 Proposed Rate 600 gpm Proposed Quantity 30 AF
 This point is: Additional Well Geo Center List other water rights that will use this point None.

10. **Presently authorized point of diversion: Geo-Center Battery of 2 wells for STK only**
 One in the Southwest Quarter of the Southwest Quarter of the Southwest Quarter of Section 33, Township 1 South, Range 20 W, in Phillips County, Kansas, 226 feet North 5,040 feet West of Southeast corner of section.
 Authorized Rate 10 gpm Authorized Quantity 1.63 mgy
 (DWR use only: Computer ID No. 37 GPS _____ feet North _____ feet West)
 This point will not be changed This point will be changed as follows:
Proposed point of diversion: (Complete only if change is requested)
 One in the _____ Quarter of the _____ Quarter of the _____ Quarter of Section _____, Township _____ South, Range _____ W, in _____ County, Kansas, _____ feet North _____ feet West of Southeast corner of section.
 Proposed Rate _____ Proposed Quantity _____
 This point is: Additional Well Geo Center List other water rights that will use this point _____

- 11. Describe the current condition of and future plans for any point(s) of diversion which will no longer be used. n/a

IF MORE SPACE IS NEEDED, ATTACH ADDITIONAL SHEETS AS NECESSARY

WATER RESOURCES RECEIVED

MAR 1 2018

- The presently authorized point(s) of diversion are 2 wells (IRR) and Batt. of 2 wells, 1 primary and 1 standby well (STK).
(Provide description and number of points)
- The proposed point(s) of diversion are 2 wells (STK & IRR) and Batt. of 2 wells 1 primary and 1 standby well (STK).
(Provide description and number of points)

List all presently authorized point(s) of diversion:

8. **Presently authorized point of diversion: Primary STK**

One in the Southwest Quarter of the Northwest Quarter of the Southwest Quarter of Section 33, Township 1 South, Range 20 W, in Phillips County, Kansas, 1,518 feet North 4,854 feet West of Southeast corner of section.
 Authorized Rate 50 gpm Authorized Quantity 6.52 mgd
 (DWR use only: Computer ID No. 40 GPS _____ feet North _____ feet West)
 This point will not be changed This point will be changed as follows:
Proposed point of diversion: (Complete only if change is requested)
 One in the _____ Quarter of the _____ Quarter of the _____ Quarter of Section _____, Township _____ South, Range _____ W, in _____ County, Kansas, _____ feet North _____ feet West of Southeast corner of section.
 Proposed Rate _____ Proposed Quantity _____
 This point is: Additional Well Geo Center List other water rights that will use this point _____

9. **Presently authorized point of diversion: Standby STK**

One in the Southwest Quarter of the Northwest Quarter of the Southwest Quarter of Section 33, Township 1 South, Range 20 W, in Phillips County, Kansas, 1,519 feet North 4,845 feet West of Southeast corner of section.
 Authorized Rate 0 Authorized Quantity 0
 (DWR use only: Computer ID No. 6 GPS _____ feet North _____ feet West)
 This point will not be changed This point will be changed as follows:
Proposed point of diversion: (Complete only if change is requested)
 One in the _____ Quarter of the _____ Quarter of the _____ Quarter of Section _____, Township _____ South, Range _____ W, in _____ County, Kansas, _____ feet North _____ feet West of Southeast corner of section.
 Proposed Rate _____ Proposed Quantity _____
 This point is: Additional Well Geo Center List other water rights that will use this point _____

10. **Presently authorized point of diversion:**

One in the _____ Quarter of the _____ Quarter of the _____ Quarter of Section _____, Township _____ South, Range _____ W, in _____ County, Kansas, _____ feet North _____ feet West of Southeast corner of section.
 Authorized Rate _____ Authorized Quantity _____
 (DWR use only: Computer ID No. _____ GPS _____ feet North _____ feet West)
 This point will not be changed This point will be changed as follows:
Proposed point of diversion: (Complete only if change is requested)
 One in the _____ Quarter of the _____ Quarter of the _____ Quarter of Section _____, Township _____ South, Range _____ (EW), in _____ County, Kansas, _____ feet North _____ feet West of Southeast corner of section.
 Proposed Rate _____ Proposed Quantity _____
 This point is: Additional Well Geo Center List other water rights that will use this point _____

11. Describe the current condition of and future plans for any point(s) of diversion which will no longer be used. _____

WATER RESOURCES RECEIVED

MAR 1 2018

KS DEPT OF AGRICULTURE

Application to Change the Point of Diversion
For Water Right File # 4304

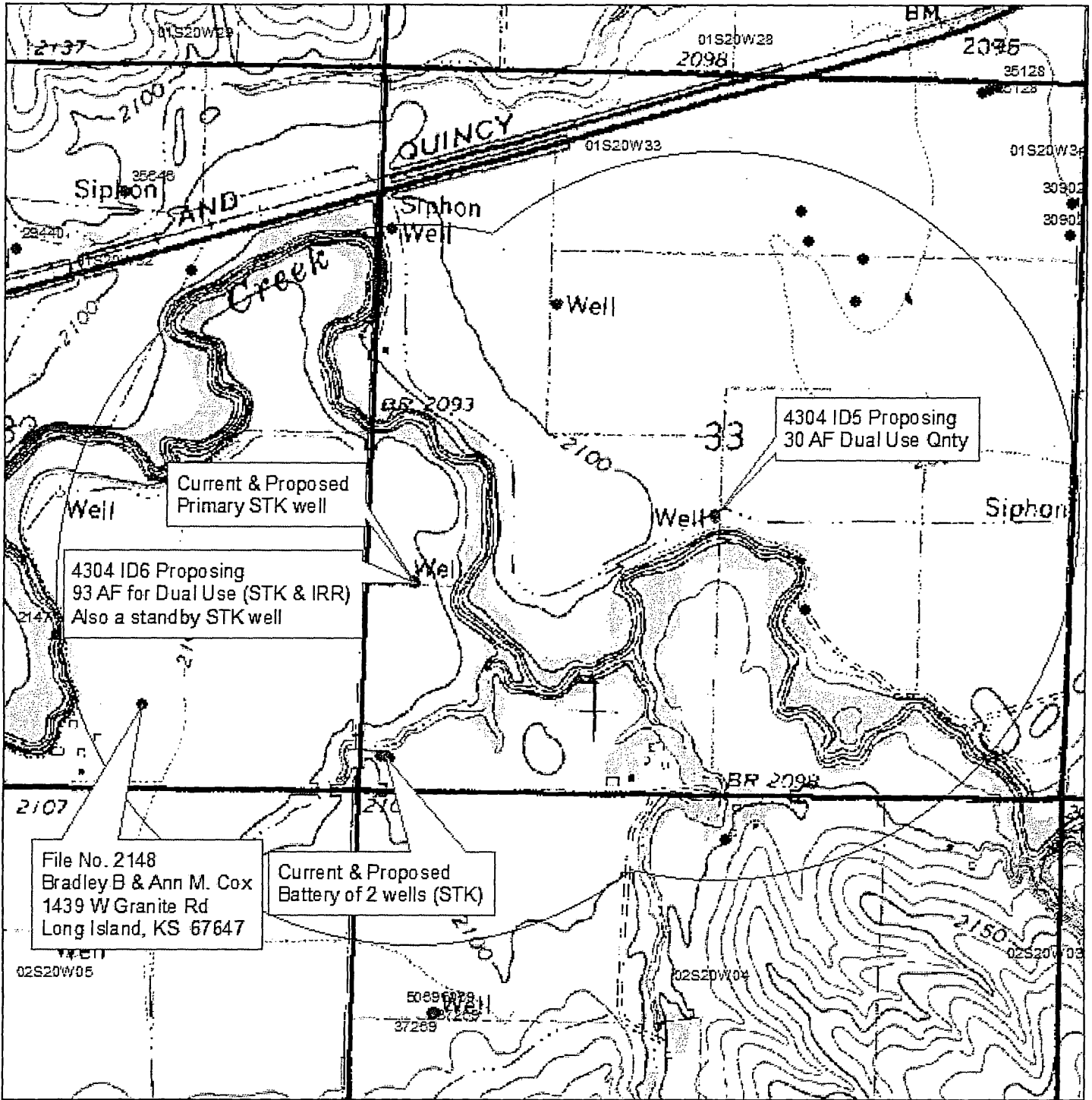

○ 1/2 mile radius

- ▲ Surface Water Point of Diversion
- Groundwater Point of Diversion

1:12,500

Signature Required

By signing this I am stating that to the best of my knowledge that all wells within 1/2 mile of proposed well location are identified on this map.

WATER RESOURCES RECEIVED

MAR 1 2018



12. The presently authorized use of water is for IRR (2 wells) & STK (Batt. 2 wells, 1 primary & 1 standby) purposes.
It is proposed that the use be changed to no change requested purposes.

13. If changing the place of use and/or use made of water, describe how the consumptive use will not be increased.

(Please show any calculations here.)

14. It is requested that the maximum annual quantity of water be reduced to _____ (acre-feet or million gallons).

15. It is requested that the maximum rate of diversion of water be reduced to _____ gallons per minute (_____ c.f.s.).

16. The application must include either a topographic map or detailed plat. A U.S. Geological Survey Topographic Map, scale 1:24,000, is available through the Kansas Geological Survey, 1930 Constant Avenue, University of Kansas, Lawrence, Kansas 66047-3726 (www.usgs.gov). The map should show the location of the presently authorized point(s) of diversion. Distances North and West of the Southeast corner of the section must be shown. The presently authorized place of use should also be shown. Identify the center of the section, the section lines and the section corners and show the appropriate section, township, and range numbers on the map. In addition the following information must also be shown on the map.

a. If a change in the location of the point(s) of diversion is proposed, show:

- 1) The location of the proposed point(s) of diversion. Distances North and West of the Southeast corner of the section must be shown. Please be certain that the information shown on the map agrees with the information shown in Paragraph Nos. 9, 10 and 11 of the application.
- 2) If the source of supply is groundwater, please show the location of existing water wells of any kind, including domestic wells, within 1/2 mile of the proposed well or wells. Identify each well as to its use and furnish name and mailing address of the property owner or owners. If there are no wells within 1/2 mile, please indicate so on the map.
- 3) If the source of supply is surface water, the names and mailing addresses of all landowner(s) 1/2 mile downstream and 1/2 mile upstream from your property lines must be shown.

b. If a change in the place of use is desired, show the proposed place of use by crosshatching on the map. Please be certain that the information shown on the map agrees with the information shown in Paragraph No. 5 of the application.

17. Attach documentation to show the change(s) proposed herein will not impair existing water rights and relates to the same local source of supply as to which the water right relates. This information may include statements, plats, geology reports, well logs, test hole logs, and other information as necessary information to show the above. Additional comments may be made below.

A change for dual use of water (STK & IRR) has been filed and is proposing to authorize the two irrigation wells under this permit to pump for IRR & STK. The total amount of water after the umw change will be limited to 105.7 AF. This change is proposing to assign that quantity between the two IRR wells, as they had been previously assigned rate and quantity through an additional well change.

18. If the proposed change(s) does not meet all applicable rules and regulations of the Kansas Water Appropriation Act, please identify the rules and regulations for which you request a waiver. State the reason why a waiver is needed and why the request should be granted. Attach documentation showing that granting the request will not impair existing water rights and will not prejudicially and unreasonably affect the public interest.

IF MORE SPACE IS NEEDED, ATTACH ADDITIONAL SHEETS AS NECESSARY

WATER RESOURCES
RECEIVED

MAR 1 2018

KS DEPT OF AGRICULTURE

Any use of water that is not as authorized by the water right or permit to authorize water **before** the chief engineer approves this application is a violation of the Kansas Water Appropriation Act for which criminal or civil penalties may be assessed. Such violation is a class C misdemeanor, punishable by a fine not to exceed \$500 and/or a term of confinement not to exceed one month in the county jail. K.S.A. 82a-728(b). Civil penalties shall be not less than \$100 nor more than \$1,000 per violation. In the case of a continuing violation, each day such violation continues may be deemed a separate violation. In addition to these penalties the water right may be modified or suspended. K.S.A. 82a-737, as amended.

The application must be signed by all owners of the place of use authorized under the water right and his or her spouse, if married. Please indicate if there is no spouse. If land is being purchased under contract, the seller must sign as landowner until such time as the contract is completed.

In the event that all applicants cannot appear before one notary public, they may as necessary sign separate copies of the application before any notary public conveniently available to them. All copies signed in this manner shall be considered to be valid parts of the application.

If the request is signed on behalf of any Owner by someone with legal authority to do so (for example, an agent, one who has power of attorney, or an executor, executrix, conservator), it will be necessary to attach proper documents showing such authority.

I declare that I am an owner of the currently authorized place of use as identified herein, or that I represent all such owners and am authorized to make this application on their behalf, and declare further that the statements contained herein are true, correct, and complete. By filing this application I authorize the chief engineer to permanently reduce the quantity of water and/or rate of diversion as specified in sections 14 and 15 of this application.

Dated at Long Island, Kansas, this 26th day of February, 2018.

[Signature]
(Owner)
N Terry NELSON
(Please Print)

(Spouse)

(Please Print)

(Owner)

(Please Print)

(Spouse)

(Please Print)

(Owner)

(Please Print)

(Spouse)

(Please Print)

State of Kansas }
County of Phillips } SS

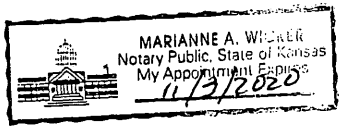

I hereby certify that the foregoing application was signed in my presence and sworn to before me this 26th day of Feb, 2018.

[Signature]
Notary Public

My Commission Expires 11/3/2020.

FEE SCHEDULE

Each application to change the place of use, the point of diversion or the use made of the water under this section shall be accompanied by the application fee set forth in the schedule below:

- (1) Application to change a point of diversion 300 feet or less \$100
- (2) Application to change a point of diversion more than 300 feet \$200
- (3) Application to change the place of use \$200
- (4) Application to change the use made of the water \$300

Make check payable to **Kansas Department of Agriculture.**

WATER RESOURCES
RECEIVED

MAR 1 2018