

Kansas Department of Agriculture
Division of Water Resources
PERMIT OF NEW APPLICATION WORKSHEET

1. File Number: <p style="text-align: center; font-size: 1.2em;">50,042</p>	2. Status Change Date: <p style="text-align: center; font-size: 1.2em;">11/29/2018</p>	3. Field Office: <p style="text-align: center; font-size: 1.2em;">3</p>
4. GMD: <p style="text-align: center; font-size: 1.2em;">0</p>		

5. Status: Approved Denied by DWR/GMD Dismiss by Request/Failure to Return

6. Enclosures: Check Valve N of C Form Water Tube Driller Copy Meter

<p>7a. Applicant(s) New to system <input type="checkbox"/></p> <p>JEFF WEILERT 2195 HYACINTH AVE HAYS KS 67601</p> <p>Person ID 66048 Add Seq# _____</p>	<p>7c. Landowner(s) New to system <input type="checkbox"/></p> <p>Person ID _____ Add Seq# _____</p>
<p>7b. Landowner(s) New to system <input type="checkbox"/></p> <p>VANIER LAND COMPANY LP 834 E PRESCOTT SALINA KS 67401</p> <p>Person ID 65991 Add Seq# _____</p>	<p>7d. Misc. New to system <input type="checkbox"/></p> <p>Person ID _____ Add Seq# _____</p>

<p>8. WUR Correspondent New to system <input type="checkbox"/> Overlap File (s) WUC Agree <input type="checkbox"/> Yes <input type="checkbox"/> No</p> <p>7b.</p> <p>Person ID _____ Add Seq# _____ Notarized WUC Form <input type="checkbox"/></p>	<p>9. Use of Water: Changing? <input type="checkbox"/> Yes <input checked="" type="checkbox"/> No</p> <p style="padding-left: 40px;"><input type="checkbox"/> Groundwater <input checked="" type="checkbox"/> Surface Water</p> <p><input checked="" type="checkbox"/> IRR <input type="checkbox"/> REC <input type="checkbox"/> DEW <input type="checkbox"/> MUN</p> <p><input type="checkbox"/> STK <input type="checkbox"/> SED <input type="checkbox"/> DOM <input type="checkbox"/> CON</p> <p><input type="checkbox"/> HYD DRG <input type="checkbox"/> WTR PWR <input type="checkbox"/> ART RECHRG</p> <p><input type="checkbox"/> IND SIC: _____ <input type="checkbox"/> OTHER: _____</p>
--	---

10. Completion Date: 12/31/2019 11. Perfection Date: 12/31/2023 12. Exp Date: _____

13. Conservation Plan Required? Yes No Date Required: _____ Date Approved: _____ Date to Comply: _____

14. Water Level Measuring Device? Yes No Date to Comply: _____ Date WLMD Installed: _____

Date Prepared: **10/23/2018** By: **AM**
Date Entered: **12/3/2018** By: **UM**

File No. **50,042** 15. Formation Code: Drainage Basin: SALINE RIVER County: EL Special Use: Stream:

16. Points of Diversion										17. Rate and Quantity				
MOD DEL ENT	PDIV	Qualifier	S	T	R	ID	'N	'W		Rate gpm	Quantity af	Rate gpm	Quantity af	Overlap PD Files
										Authorized	Additional			
CHK	86725	SESENW	24	11S	20W	4	2857	3135		1500	155	1500	155	NONE

18. Storage: Rate _____ NF Quantity _____ ac/ft Additional Rate _____ NF Additional Quantity _____ ac/ft

19. Limitation: _____ af/yr at _____ gpm (_____ cfs) when combined with file number(s) _____
 Limitation: _____ af/yr at _____ gpm (_____ cfs) when combined with file number(s) _____

20. Meter Required? Yes No To be installed by **12/31/2019** Date Acceptable Meter Installed _____

21. Place of Use										NE¼				NW¼				SW¼				SE¼				Total	Owner	Chg?	Overlap Files
MOD DEL ENT	PUSE	S	T	R	ID	NE ¼	NW ¼	SW ¼	SE ¼	NE ¼	NW ¼	SW ¼	SE ¼	NE ¼	NW ¼	SW ¼	SE ¼	NE ¼	NW ¼	SW ¼	SE ¼								
CHK	37738	24	11S	20W	1	40		40	40				21	25				6.8	3.4			176.2	7b	NO	17283				

Comments:
special conditions: permission to pump

KANSAS DEPARTMENT OF AGRICULTURE
Division of Water Resources
MEMORANDUM

TO: Files

DATE: November 15, 2018

FROM: Austin McColloch

RE: New Application,
File No. 50,042

Jeff Weilert filed the referenced application to appropriate surface water for irrigation use, located in the Saline River basin. The entire place of use is owned by Vanier Land Company, the applicant has signed the application stating that he has access to the points of diversion. This file will overlap in place of use with Water Right, File No. 17,283 which is currently authorized 92 acre-feet on the 176.2 acre place of use.

This application is requesting 155 acre-feet of water at a diversion rate of 1,500 gallons per minute from one pumpsite located in the Southeast Quarter of the Southeast Quarter of the Northwest Quarter (SE $\frac{1}{4}$ SE $\frac{1}{4}$ NW $\frac{1}{4}$) of Section 24, more particularly described as being near a point 2,857 feet North and 3,135 feet West of the Southeast corner of said section, in Township 11 South, Range 20 West, Ellis County, Kansas. The source of supply is the Saline River. This new appropriation will bring the total quantity supplied to the place of use up to 247 acre-feet on 176.2 acres. This is the maximum reasonable quantity for Ellis county (1.4 acre-foot per acre).

There are four landowners one-half mile up and down stream of the property line of the applicant. There are three other water rights located within two miles of the pump site, the two upstream of the pumpsite are owned by Vanier Land Company. Water Right, File No. 25,566 is located one mile downstream of the pumpsite and is authorized 155 acre-feet of water. The application is subject to safe yield, as required by K.A.R. 5-3-10 and K.A.R. 5-3-15, which includes minimum desirable streamflow (MDS) requirements. The applicant submitted and signed and notarized the MDS form with the application. The permit will also contain conditions related to not stopping stream flow at the first riffle below the point of diversion, senior water rights and permits must be satisfied prior to diverting water, and permission must be obtained from the Chief Engineer, or an authorized representative, prior to diverting water. The overlapping senior file is a groundwater appropriation and can supply water during the irrigation season to the same place of use; therefore the application complies with the requirements in K.A.R. 5-3-15 to show that the direct diversion of surface water will not be necessary during the period of July 1 through September 30.

Nearby notifications of the four landowners one-half mile upstream and downstream of the proposed pumpsite were sent out on September 10, 2018. In a letter dated October 1, 2018, Lewis Rathbun, Manager of Rathbun Holdings LLC, and owner of Water Right, File No. 25,566, stated he was opposed to the referenced new appropriation. His concerns are with the new appropriation effecting his alluvial well that is 40 feet deep and approximately 750 feet from the Saline River along with the low flow rates of the river.

In accordance with K.S.A. 82a-706c, the Chief Engineer retains full authority to require any water user to install meters, gages, or other measuring devices, which devices he or she or his or her agents may read at any time. Water flowmeter requirements are further described in K.A.R. 5-1-4 and K.A.R. 5-1-12. If any chemical or foreign substance is injected into the water pumped under this permit, a check valve will also need to be installed.

In an e-mail message, dated October 22, 2018, Kelly Stewart, Water Commissioner of the Stockton Field Office, indicated he had no objection to the approval of the referenced application.

Based on the above discussion, the area is open to new appropriations, the surface water source is supported by the senior groundwater Water Right, the proposed use of water is reasonable, it is recommended that the referenced application be approved.

Austin McColloch
Environmental Scientist

STATE OF KANSAS



DEPARTMENT OF AGRICULTURE
1320 RESEARCH PARK DRIVE
MANHATTAN, KS 66502
PHONE: (785) 564-6700
FAX: (785) 564-6777

900 SW JACKSON, ROOM 456
TOPEKA, KS 66612
PHONE: (785) 296-3556
www.agriculture.ks.gov

GOVERNOR JEFF COLYER, M.D.
JACKIE McCLASKEY, SECRETARY OF AGRICULTURE **FILE COPY**

December 6, 2018

JEFF WEILERT
2195 HYACINTH AVE
HAYS KS 67601

RE: Appropriation of Water, File No. 50,042

Dear Sir or Madam:

There is enclosed a permit to appropriate water authorizing you to proceed with the construction of the proposed diversion works (except those dams and stream obstructions regulated by K.S.A. 82a-301 through 305a), to divert such unappropriated water as may be available from the source and at the location specified in the permit, and to use it for the purpose and at the location described in the permit.

Your attention is directed to the enclosures and to the terms, conditions, and limitations specified in this permit. Please note Paragraph Nos. 17, 18, 19 and 20, which describe the need for you to obtain permission prior to diverting water. A water meter is required, and you must install it prior to water being put to beneficial use in order for you to maintain accurate records of water use. The meter should be used to provide the information required on the annual water use report.

Failure to notify the Chief Engineer of the Division of Water Resources of the completion of the diversion works within the time allowed, or within any authorized extension of time thereof, will result in the dismissal of this permit. Enclosed is a form which may be used to notify the Chief Engineer that the proposed diversion works have been completed. All requests for extensions of time to complete diversion works, or to perfect appropriations, must be submitted to the Chief Engineer before the expiration of time set forth in the permit to complete diversion works or to perfect an appropriation.

If for any reason, you require an extension of time, you must request it before the expiration of time set forth in this permit. Failure to comply with this regulation will result in the dismissal of your permit or your water right. Any request for extension of time shall be accompanied by the required statutory fee, which is currently \$100.00.

There is also enclosed an information sheet setting forth the procedure to obtain a Certificate of Appropriation which establish the extent of your water right.

If you have any questions, please contact me at (785) 564-6627. If you wish to discuss a specific file, please have the file number ready to that we may help you more efficiently.

Sincerely,

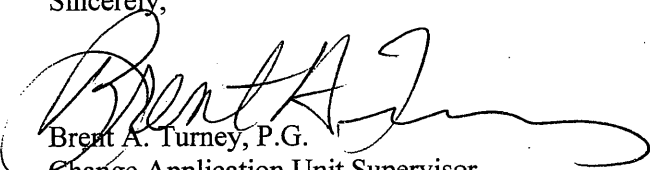
Brent A. Turney, P.G.
Change Application Unit Supervisor
Water Appropriation Program

BT:am

Enclosure(s)

pc: Vanier Land Company LP
Stafford Field Office

THE STATE OF KANSAS



KANSAS DEPARTMENT OF AGRICULTURE
Jackie McClaskey, Secretary of Agriculture

DIVISION OF WATER RESOURCES
David W. Barfield, Chief Engineer

**APPROVAL OF APPLICATION
and
PERMIT TO PROCEED**

(This is not a Certificate of Appropriation)

This is to certify that I have examined Application, **File No. 50,042** of the applicant

**JEFF WEILERT
2195 HYACINTH AVE
HAYS KS 67601**

for a permit to appropriate water for beneficial use, together with the maps, plans and other submitted data, and that the application is hereby approved and the applicant is hereby authorized, subject to vested rights and prior appropriations, to proceed with the construction of the proposed diversion works (except those dams and stream obstructions regulated by K.S.A. 82a-301 through 305a, as amended), and to proceed with all steps necessary for the application of the water to the approved and proposed beneficial use and otherwise perfect the proposed appropriation subject to the following terms, conditions and limitations:

1. That the priority date assigned to such application is **April 20, 2018**.
2. That the water sought to be appropriated shall be used for irrigation use on land described in the application, as follows:

Sec.	Twp.	Range	NE¼				NW¼				SW¼				SE¼				TOTAL
			NE¼	NW¼	SW¼	SE¼	NE¼	NW¼	SW¼	SE¼	NE¼	NW¼	SW¼	SE¼	NE¼	NW¼	SW¼	SE¼	
24	11S	20W	40		40	40				21	25				6.8	3.4			176.2

3. That the authorized source from which the appropriation shall be made is surface water from the Saline River, to be diverted at one (1) pumpsite located in the Southeast Quarter of the Southeast Quarter of the Northwest Quarter (SE¼ SE¼ NW¼) of Section 24, more particularly described as being near a point 2,857 feet North and 3,135 feet West of the Southeast corner of said section, in Township 11 South, Range 20 West, Ellis County, Kansas, located substantially as shown on the topographic map accompanying the application.

4. That the appropriation sought shall be limited to a maximum diversion rate not in excess of **1,500 gallons per minute (3.34 c.f.s.)** and to a total quantity not to exceed **155 acre-feet** of water per calendar year for irrigation.

5. That installation of works for diversion of water shall be completed on or before **December 31, 2019** or within any authorized extension thereof. The applicant shall notify the Chief Engineer and pay the statutorily required field inspection fee of \$400.00 when construction of the works has been completed. Failure to timely submit the notice and the fee will result in revocation of the permit. Any request for an extension of time shall be submitted prior to the expiration of the deadline and shall be accompanied by the required statutory fee of \$100.00.

6. That the proposed appropriation shall be perfected by the actual application of water to the proposed beneficial use on or before **December 31, 2023** or any authorized extension thereof. Any request for an extension of time shall be submitted prior to the expiration of the deadline and shall be accompanied by the required statutory fee of \$100,00.

7. That the applicant shall not be deemed to have acquired a water appropriation for a quantity in excess of the amount approved herein nor in excess of the amount found by the Chief Engineer to have been actually used for the approved purpose during one calendar year subsequent to approval of the application and within the time specified for perfection or any authorized extension thereof.

8. That the use of water herein authorized shall not be made so as to impair any use under existing water rights nor prejudicially and unreasonably affect the public interest.

9. That the right of the appropriator shall relate to a specific quantity of water and such right must allow for a reasonable raising or lowering of the static water level and for the reasonable increase or decrease of the streamflow at the appropriator's point of diversion.

10. That this permit does not constitute authority under K.S.A. 82a-301 through 305a to construct any dam or other obstruction; nor does it grant any right-of-way, or authorize entry upon or injury to, public or private property.

11. That all diversion works constructed under the authority of this permit into which any type of chemical or other foreign substance will be injected into the water pumped from the diversion works shall be equipped with an in-line, automatic quick-closing, checkvalve capable of preventing pollution of the source of the water supply. The type of valve installed shall meet specifications adopted by the Chief Engineer and shall be maintained in an operating condition satisfactory to the Chief Engineer.

12. That an acceptable water flow meter shall be installed and maintained on the diversion works authorized by this permit in accordance with Kansas Administrative Regulations 5-1-4 through 5-1-12 adopted by the Chief Engineer. This water flow meter shall be used to provide an accurate quantity of water diverted as required for the annual water use report (including the meter reading at the beginning and end of the report year).

13. That the applicant shall maintain accurate and complete records from which the quantity of water diverted during each calendar year may be readily determined and the applicant shall file an annual water use report with the Chief Engineer by March 1 following the end of each calendar year. Failure to file the annual water use report by the due date shall cause the applicant to be subject to a civil penalty.

14. That no water user shall engage in nor allow the waste of any water diverted under the authority of this permit.

15. That failure without cause to comply with provisions of the permit and its terms, conditions and limitations will result in the forfeiture of the priority date, revocation of the permit and dismissal of the application.

16. That the right to appropriate water under authority of this permit is subject to any minimum desirable streamflow requirements identified and established pursuant to K.S.A. 82a 703c for the source of supply to which this water right applies.

Ordered this 29th day of November, 2018, in Topeka, Shawnee County, Kansas.

Lane P. Letourneau

Lane P. Letourneau, P.G.
Water Appropriation Program Manager
Division of Water Resources
Kansas Department of Agriculture

State of Kansas)
) SS
County of Riley)

The foregoing instrument was acknowledged before me this 29th day of November, 2018, by Lane P. Letourneau, P.G., Water Appropriation Program Manager, Division of Water Resources, Kansas Department of Agriculture.



Danielle Wilson
Notary Public

CERTIFICATE OF SERVICE

On this 6th day of December, 2018, I hereby certify that the foregoing Approval of Application, File No. 50,042, dated Nov. 29th, 2018, was mailed postage prepaid, first class, US mail to the following:

JEFF WEILERT
2195 HYACINTH AVE
HAYS KS 67601

With photocopies to:

VANIER LAND COMPANY LP
834 E PRESCOTT
SALINA KS 67401

Stockton Field Office

Danielle Wilson

Division of Water Resources

17. That the stream flow shall not be stopped at the first riffle below the point of diversion while diversion is taking place under the authority of this permit.

18. That diversion of natural flow shall not take place unless there is water available to satisfy all demands by senior water rights and permits.

19. That during the period October 1 through June 30, the verbal or written permission of the Chief Engineer, or an authorizing representative of the Chief Engineer, shall be obtained in order to divert water each time the applicant desires to divert water.

20. That during the period July 1 through September 30 each calendar year, no direct diversions of surface water shall be permitted unless written permission is obtained from the Chief Engineer, or the Chief Engineer's authorized representative.

RIGHT TO A HEARING AND TO ADMINISTRATIVE REVIEW

If you are aggrieved by this Order, then pursuant to K.S.A. 82a-1901, you may:

- 1) request an evidentiary hearing before the Chief Engineer, or
- 2) request administrative review by the Secretary of Agriculture.

Failure to request an evidentiary hearing before the Chief Engineer does not preclude your right to administrative review by the Secretary.

To obtain an evidentiary hearing before the Chief Engineer, a written request for hearing must be filed within 15 days after service of this Order as provided in K.S.A. 77-531 (**i.e., within a total of 18 days after this Order was mailed to you**), with: Kansas Department of Agriculture, Attn: Legal Section, 1320 Research Park Drive, Manhattan, KS 66502, FAX (785) 564-6777.

If you do not file a request for an evidentiary hearing before the Chief Engineer, you may petition for administrative review of the Order by the Secretary of Agriculture. A petition for review shall be in writing and state the basis for requesting administrative review. The request for hearing may be denied if the request fails to clearly establish factual or legal issues for review. See K.S.A. 77-527. The petition must be filed within 30 days after service of this Order as provided in K.S.A. 77-531 (**i.e., within a total of 33 days after this Order was mailed to you**), and be filed with: Secretary of Agriculture, Attn: Legal Division, Kansas Department of Agriculture, 1320 Research Park Drive, Manhattan, KS 66502, FAX (785) 564-6777.

If neither a request for an evidentiary hearing nor a petition for administrative review is filed as set forth above, then this Order shall be effective and become a final agency action as defined in K.S.A. 77-607(b). Failure to timely request either an evidentiary hearing or administrative review may preclude further judicial review under the Kansas Judicial Review Act.

Any request for hearing or petition for administrative review shall be in writing and shall be submitted to the attention of: Chief Legal Counsel, Kansas Department of Agriculture, 1320 Research Park Drive, Manhattan, Kansas 66502, Fax: (785) 564 - 6777.

THE STATE OF KANSAS



APPLICATION COMPLETE
11/15/18
Reviewer Am

KANSAS DEPARTMENT OF AGRICULTURE
Jackie McClaskey, Secretary of Agriculture

DIVISION OF WATER RESOURCES
David W. Barfield, Chief Engineer

File Number 50042
This item to be completed by the Division of Water Resources.

WATER RESOURCES
RECEIVED

APPLICATION FOR PERMIT TO
APPROPRIATE WATER FOR BENEFICIAL USE

Filing Fee Must Accompany the Application
(Please refer to Fee Schedule attached to this application form.)

APR 20 2018
11:33
KS DEPT OF AGRICULTURE

To the Chief Engineer of the Division of Water Resources, Kansas Department of Agriculture,
1320 Research Park Drive, Manhattan, KS 66502:

1. Name of Applicant (Please Print): Jeff Weilert
Address: 2195 Hyacinth Ave
City: Hays State KS Zip Code 67601
Telephone Number: (785) 623-0312

2. The source of water is: surface water in Saline River (stream)
OR groundwater in _____ (drainage basin)

Certain streams in Kansas have minimum target flows established by law or may be subject to administration when water is released from storage for use by water assurance district members. If your application is subject to these regulations on the date we receive your application, you will be sent the appropriate form to complete and return to the Division of Water Resources.

3. The maximum quantity of water desired is 155 acre-feet OR _____ gallons per calendar year,
to be diverted at a maximum rate of 1500 gallons per minute OR _____ cubic feet per second.

Once your application has been assigned a priority, the requested maximum rate of diversion and maximum requested quantity of water under that priority number can **NOT** be increased. Please be certain your requested maximum rate of diversion and maximum quantity of water are appropriate and reasonable for your proposed project and are in agreement with the Division of Water Resources' requirements.

4. The water is intended to be appropriated for (Check use intended):
(a) Artificial Recharge (b) Irrigation (c) Recreational (d) Water Power
(e) Industrial (f) Municipal (g) Stockwatering (h) Sediment Control
(i) Domestic (j) Dewatering (k) Hydraulic Dredging (l) Fire Protection
(m) Thermal Exchange (n) Contamination Remediation

YOU **MUST** COMPLETE AND ATTACH ADDITIONAL DIVISION OF WATER RESOURCES FORM(S) PROVIDING INFORMATION TO SUBSTANTIATE YOUR REQUEST FOR THE AMOUNT OF WATER FOR THE INTENDED USE REFERENCED ABOVE.

For Office Use Only:
F.O. 3 GMD 2 Meets K.A.R. 5-3-1 (YES/NO) Use IRR Source G/S County EL By AMW Date 4/20/18
Code 122 Fee \$ 300 TR # _____ Receipt Date 4/20/18 Check # 5571

SCANNED

4/23/18

5. The location of the proposed wells, pump sites or other works for diversion of water is:

Note: For the application to be accepted, the point of diversion location must be described to at least a 10 acre tract, unless you specifically request a 60 day period of time in which to locate the site within a specifically described, minimal legal quarter section of land.

(A) One in the SE quarter of the SE quarter of the NW quarter of Section 24, more particularly described as being near a point 2857 feet North and 3135 feet West of the Southeast corner of said section, in Township 11 South, Range 20 West, Ellis County, Kansas.

(B) One in the _____ quarter of the _____ quarter of the _____ quarter of Section _____, more particularly described as being near a point _____ feet North and _____ feet West of the Southeast corner of said section, in Township _____ South, Range _____ East/West (circle one), _____ County, Kansas.

(C) One in the _____ quarter of the _____ quarter of the _____ quarter of Section _____, more particularly described as being near a point _____ feet North and _____ feet West of the Southeast corner of said section, in Township _____ South, Range _____ East/West (circle one), _____ County, Kansas.

(D) One in the _____ quarter of the _____ quarter of the _____ quarter of Section _____, more particularly described as being near a point _____ feet North and _____ feet West of the Southeast corner of said section, in Township _____ South, Range _____ East/West (circle one), _____ County, Kansas.

If the source of supply is groundwater, a separate application shall be filed for each proposed well or battery of wells, except that a single application may include up to four wells within a circle with a quarter (1/4) mile radius in the same local source of supply which do not exceed a maximum diversion rate of 20 gallons per minute per well.

A battery of wells is defined as two or more wells connected to a common pump by a manifold; or not more than four wells in the same local source of supply within a 300 foot radius circle which are being operated by pumps not to exceed a total maximum diversion rate of 800 gallons per minute and which supply water to a common distribution system.

6. The owner of the point of diversion, if other than the applicant is (please print):

Vanier Land Company PO Box 1393 Salina, KS 67402
(name, address and telephone number)

(name, address and telephone number)

You must provide evidence of legal access to, or control of, the point of diversion from the landowner or the landowner's authorized representative. Provide a copy of a recorded deed, lease, easement or other document with this application. In lieu thereof, you may sign the following sworn statement:

I have legal access to, or control of, the point of diversion described in this application from the landowner or the landowner's authorized representative. I declare under penalty of perjury that the foregoing is true and correct.

Executed on April 2, 2018. Jeff Wadlet
Applicant's Signature

The applicant must provide the required information or signature irrespective of whether they are the landowner. Failure to complete this portion of the application will cause it to be unacceptable for filing and the application will be returned to the applicant.

7. The proposed project for diversion of water will consist of 1 surface water diversion
(number of wells, pumps or dams, etc.)
and (will be) completed (by) 2019
(Month/Day/Year - each was or will be completed)

8. The first actual application of water for the proposed beneficial use was or is estimated to be 09/01/18.

WATER RESOURCES
RECEIVED

APR 20 2018

SCANNED

9. Will pesticide, fertilizer, or other foreign substance be injected into the water pumped from the diversion works?
 Yes No If "yes", a check valve shall be required.

All chemigation safety requirements must be met including a chemigation permit and reporting requirements.

10. If you are planning to impound water, please contact the Division of Water Resources for assistance, prior to submitting the application. Please attach a reservoir area capacity table and inform us of the total acres of surface drainage area above the reservoir.

Have you also made an application for a permit for construction of this dam and reservoir with the Division of Water Resources? Yes No

- If yes, show the Water Structures permit number here _____
- If no, explain here why a Water Structures permit is not required _____

11. The application must be supplemented by a U.S.G.S. topographic map, aerial photograph or a detailed plat showing the following information. On the topographic map, aerial photograph, or plat, identify the center of the section, the section lines or the section corners and show the appropriate section, township and range numbers. Also, please show the following information:

- (a) The location of the proposed point(s) of diversion (wells, stream-bank installations, dams, or other diversion works) should be plotted as described in Paragraph No. 5 of the application, showing the North-South distance and the East-West distance from a section line or southeast corner of section.
- (b) If the application is for groundwater, please show the location of any existing water wells of any kind within 1/2 mile of the proposed well or wells. Identify each existing well as to its use and furnish the name and mailing address of the property owner or owners. If there are no wells within 1/2 mile, please advise us.
- (c) If the application is for surface water, the names and addresses of the landowner(s) 1/2 mile downstream and 1/2 mile upstream from your property lines must be shown.
- (d) The location of the proposed place of use should be shown by crosshatching on the topographic map, aerial photograph or plat.
- (e) Show the location of the pipelines, canals, reservoirs or other facilities for conveying water from the point of diversion to the place of use.

A 7.5 minute U.S.G.S. topographic map may be obtained by providing the section, township and range numbers to: Kansas Geological Survey, 1930 Constant, Campus West, University of Kansas, Lawrence, Kansas 66047.

12. List any application, appropriation of water, water right, or vested right file number that covers the same diversion points or any of the same place of use described in this application. Also list any other recent modifications made to existing permits or water rights in conjunction with the filing of this application.

17,283 is a groundwater right that will be a complete overlap with.
17,283 authorizes 92 AF for 176.20 acres. This application will propose an additional 155 AF to bring the
AF/acre authorized up to 1.4 AF/acre.

WATER RESOURCES
RECEIVED

APR 20 2018

SCANNED
KS DEPT OF AGRICULTURE

13. Furnish the following well information if the proposed appropriation is for the use of groundwater. If the well has not been completed, give information obtained from test holes, if available.

Information below is from: Test holes Well as completed Drillers log attached

Well location as shown in paragraph No.	(A)	(B)	(C)	(D)
Date Drilled	_____	_____	_____	_____
Total depth of well	_____	_____	_____	_____
Depth to water bearing formation	_____	_____	_____	_____
Depth to static water level	_____	_____	_____	_____
Depth to bottom of pump intake pipe	_____	_____	_____	_____

14. The relationship of the applicant to the proposed place where the water will be used is that of tenant
(owner, tenant, agent or otherwise)

15. The owner(s) of the property where the water is used, if other than the applicant, is (please print):
Vanier Land Company PO box 1393 salina kansas 67402 785-823-3794
(name, address and telephone number)

(name, address and telephone number)

16. The undersigned states that the information set forth above is true to the best of his/her knowledge and that this application is submitted in good faith.

Dated at HAYS, Kansas, this 2 day of April, 2018.
(month) (year)

Jeff Walker
(Applicant Signature)

By _____
(Agent or Officer Signature)

(Agent or Officer - Please Print)

Assisted by _____ Date: _____
(office/title)

WATER RESOURCES RECEIVED
APR 20 2018
SCANNED
KS DEPT OF AGRICULTURE

50042

1

Smart, Wanda Trust
202 Sylvan way
Lancaster KY, 40444

2

Rathbun holdings LLC
PO box 18386
Spokane WA 99228

3

Schumacher, Bruce and Brenda
1561 Hilltop Dr.
Hays KS, 67601

WATER RESOURCES
RECEIVED

APR 20 2018
SCANNED
KS DEPT OF AGRICULTURE

4-4-18

(Date)

Kansas Department of Agriculture
Division of Water Resources
David W. Barfield, Chief Engineer
1320 Research Park Drive
Manhattan, Kansas 66502

Re: Application File No. 50042

Minimum Desirable Streamflow

Dear Sir:

I understand that a Minimum Desirable Streamflow requirement has been established by the legislature for the source of supply to which the above referenced application applies.

I understand that diversion of water pursuant to this application will be subject to regulation any time Minimum Desirable Streamflow requirements are not being met.

I also understand that if this application is approved, there could be times, as determined by the Division of Water Resources, when I would not be allowed to divert water. I realize that this could affect the economics of my decision to appropriate water.

I am aware of the above factors, and with the knowledge thereof, request that the Division of Water Resources proceed with processing and approval, if possible, of the above referenced application.

Jeff Weibert
Signature of Applicant

State of Kansas)
County of Ellis) ss

Jeff Weibert
(Print Applicant's Name)

I hereby certify that the foregoing instrument was signed in my presence and sworn to before me this 4th day of April, 2018.

Laurie A Pfannenstiel
Notary Public

My Commission Expires: 3/26/2020

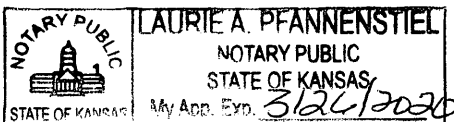

WATER RESOURCES
RECEIVED

APR 20 2018

MINIMUM DESIRABLE STREAMFLOW FORM TO BE USED WHEN
APPLICABLE WHEN FILING AN APPLICATION FOR PERMIT
TO APPROPRIATE WATER FOR BENEFICIAL USE

The Kansas Legislature has established minimum desirable streamflows for the streams listed below. If your proposed diversion of water is going to be from one of these watercourses or adjacent alluvial aquifers, please complete the back side of this page and submit it along with your application for permit to appropriate water.

Arkansas River
Big Blue River
Chapman Creek
Chikaskia River
Cottonwood River
Delaware River
Little Arkansas River
Little Blue River
Marais des Cygnes River
Medicine Lodge River
Mill Creek (Wabaunsee Co. area)
Neosho River

Ninnescah River
North Fork Ninnescah River
Rattlesnake Creek
Republican River
Saline River
Smoky Hill River
Solomon River
South Fork Ninnescah
Spring River
Walnut River
Whitewater River

WATER RESOURCES
RECEIVED

APR 20 2018
SCANNED

IRRIGATION USE SUPPLEMENTAL SHEET

File No. 50040

Name of Applicant (Please Print): Jeff Weilert

1. Please supply the name and address of each landowner, the legal description of the lands to be irrigated, and designate the actual number of acres to be irrigated in each forty acre tract or fractional portion thereof:

Landowner of Record NAME: Vanier Land Company
 ADDRESS: PO Box 1393 Salina, KS 67402

S	T	R	NE¼				NW¼				SW¼				SE¼				TOTAL	
			NE	NW	SW	SE	NE	NW	SW	SE	NE	NW	SW	SE	NE	NW	SW	SE		
24	11S	20W	40		40	40				21	25					6.8	3.4			176.20

Landowner of Record NAME: _____
 ADDRESS: _____

S	T	R	NE¼				NW¼				SW¼				SE¼				TOTAL	
			NE	NW	SW	SE	NE	NW	SW	SE	NE	NW	SW	SE	NE	NW	SW	SE		

Landowner of Record NAME: _____
 ADDRESS: _____

S	T	R	NE¼				NW¼				SW¼				SE¼				TOTAL	
			NE	NW	SW	SE	NE	NW	SW	SE	NE	NW	SW	SE	NE	NW	SW	SE		

2. Please complete the following information for the description of the operation for the irrigation project. Attach supplemental sheets as needed.

a. Indicate the soils in the field(s) and their intake rates:

Soil Name	Percent of field (%)	Intake Rate (in/hr)	Irrigation Design Group
<u>inavale loamy sand</u>	<u>12</u>	<u>6</u>	<u>pivot</u>
<u>mccook fine sandy loam</u>	<u>37</u>	<u>2</u>	<u>pivot</u>
<u>mccook silt loam</u>	<u>26</u>	<u>1</u>	<u>pivot</u>
<u>roxbury ailt loam</u>	<u>20</u>	<u>1</u>	<u>pivot</u>
<u>roxbury ailt loam</u>	<u>5</u>	<u>1</u>	<u>pivot</u>
Total:	100 %		

b. Estimate the average land slope in the field(s): 1 %

Estimate the maximum land slope in the field(s): 3 %

c. Type of irrigation system you propose to use (check one):

Center pivot Center pivot - LEPA "Big gun" sprinkler
 Gravity system (furrows) Gravity system (borders) Sideroll sprinkler

Other, please describe: _____

d. System design features:

i. Describe how you will control tailwater: no tail water

ii. For sprinkler systems:

(1) Estimate the operating pressure at the distribution system: 30 psi

(2) What is the sprinkler package design rate? 450 gpm

(3) What is the wetted diameter (twice the distance the sprinkler throws water) of a sprinkler on the outer 100 feet of the system? 20 feet

(4) Please include a copy of the sprinkler package design information.

e. Crop(s) you intend to irrigate. Please note any planned crop rotations: alfalfa feed

f. Please describe how you will determine when to irrigate and how much water to apply (particularly important if you do not plan a full irrigation). soil probe for moisture, crop condition

You may attach any additional information you believe will assist in informing the Division of the need for your request.

WATER RESOURCES
RECEIVED

Page 2 of 2

APR 20 2018

KS DEPT OF AGRICULTURE **SCANNED**

STATE OF KANSAS

DEPARTMENT OF AGRICULTURE
1320 RESEARCH PARK DRIVE
MANHATTAN, KS 66502
PHONE: (785) 564-6700
FAX: (785) 564-6777



900 SW JACKSON, ROOM 456
TOPEKA, KS 66612
PHONE: (785) 296-3556
www.agriculture.ks.gov

GOVERNOR JEFF COLYER, M.D.
JACKIE McCLASKEY, SECRETARY OF AGRICULTURE

April 23, 2018

JEFF WEILERT
2195 HYTACINTH AVE
HAYS KS 67601

RE: Application
File No. 50042

Dear Sir or Madam:

Your application for permit to appropriate water in 24-11S-20W in Ellis County, was received and has been assigned the file number noted above.

As a matter of record, the Division of Water Resources has on hand a large number of applications awaiting processing. Therefore to be fair to all concerned, and so that we can process those applications on hand in the order they were received, we intend to concentrate on the backlog of applications until the issue is resolved. Once review of your application has begun, we will contact you, if additional information is required.

In accordance with the provisions of the Kansas Water Appropriation Act, a portion of which is included below, the use of water as proposed prior to approval of the application is unlawful. Once approved, compliance with the terms, conditions and limitations of the permit is necessary. Conservation of the water resources of Kansas is required.

Section 82a-728 of the Kansas Water Appropriation Act, provides (a) except for the appropriation of water for the purpose of domestic use, . . . it shall be unlawful for any person to appropriate or threaten to appropriate water from any source without first applying for and obtaining a permit to appropriate water in accordance with the provisions of the Water Appropriation Act or for any person to violate any condition of a vested right, appropriation right or an approved application for a permit to appropriate water for beneficial use.

(b) (1) The violation of any provision of this section by any person is a class C misdemeanor . . .

A class C misdemeanor is punishable by a fine not to exceed \$500 and/or a term of confinement not to exceed one month in the county jail. Each day that the violation occurs constitutes a separate offense.

If you have any questions, please contact me at (785) 564-6637. If you wish to discuss a specific file, please have the file number ready so that we may help you more efficiently.

Sincerely,

A handwritten signature in cursive script that reads "Kristen A. Baum".

Kristen A. Baum
New Applications Unit Supervisor
Water Appropriation Program

BAT: dlw
pc: STOCKTON Field Office
GMD

SCANNED

Milner, Brandon [KDA]

From: Stewart, Kelly [KDA]
Sent: Monday, October 22, 2018 3:22 PM
To: McColloch, Austin
Cc: Billinger, Mark [KDA]; Hageman, Rebecca [KDA]
Subject: RE: Recommendation File No. 50042 - Weilert SW Saline River

Austin,

I have no objection to the approval of this application.

Kelly

From: McColloch, Austin
Sent: Friday, October 19, 2018 10:57 AM
To: Stewart, Kelly [KDA] <Kelly.Stewart@ks.gov>
Cc: Billinger, Mark [KDA] <Mark.Billinger@ks.gov>
Subject: Recommendation File No. 50042 - Weilert SW Saline River

Kelly,

Attached is my draft memo for New Application, File No. 50,042 submitted by Jeff Weilert. This is for surface water from the Saline River to overlap with his senior groundwater WR to bring the AF/acre up to 1.4. Let me know if you need more information or have any questions.

Thanks,

Austin McColloch
Environmental Scientist
Ph: (620) 276-2901

STATE OF KANSAS

DEPARTMENT OF AGRICULTURE
DIVISION OF WATER RESOURCES
GARDEN CITY FIELD OFFICE
2508 JOHNS STREET
GARDEN CITY, KS 67846-2804



PHONE: (620) 276-2901
FAX: (620) 276-9315
www.agriculture.ks.gov

GOVERNOR JEFF COLYER, M.D.
JACKIE MCCLASKEY, SECRETARY OF AGRICULTURE

October 8, 2018

RATHBUN HOLDINGS LLC
PO BOX 18386
SPOKANE WA 99228

RE: Pending New Application, File No. 50,042

Dear Sir or Madam:

This will acknowledge receipt of your letter dated October 1, 2018, in which you expressed comments concerning the proposed appropriation of groundwater submitted by Jeff Weilert under the above referenced application.

Your comments have been considered, and approval of the application, if granted, will authorize diversion of water only when it does not impair existing rights. Should the diversion of water under this application substantially impair your earlier rights, you should notify the field office in your area. The field office in your area is:

Kansas Department of Agriculture
Division of Water Resources - Stockton Field Office
820 S Walnut St.
Stockton, KS 67669

If an applicant without cause fails to comply with the provisions of the permit and its terms, conditions and limitations, it could result in the forfeiture of the priority date, revocation of the permit and dismissal of the application.

If you have any questions, please contact me at (620) 276-2901. If you wish to discuss a specific file, please have the file number ready so that we may help you more efficiently.

Sincerely,

Austin McColloch
Environmental Scientist
Water Appropriation Program

pc: Stockton Field Office

Lewis Rathbun
Rathbun Holdings LLC
P.O. Box 18386
Spokane, Washington 99228

October 1, 2018

Department of Agriculture
Division of Water Resources
2508 Johns St.
Garden City, Ks. 67846

To whom it may concern,

This letter is in response to a letter that Rathbun Holdings LLC received on September 22, 2018 advising us that there is a pending new application submitted by Jeff Weilert (file No. 50,042). This application is for a permit to divert 155 acre feet of water from the Saline river.

Our well is only 40 feet deep, is approximately 750 feet from the Saline river and on an alluvium aquifer. We feel that the proposed diversion of that amount (155 acre feet at 1500 gallons per min.) of water will have an adverse affect on our water rights. As you well know there is a relationship between the surface water and ground it is a dynamic one as well. Depending on the water table and the water flow in the river, you may have either an in flow of water to the ground water table or and out flow of water to the river from the ground water. As we stated earlier it is dynamic, which also means it may have an adverse affect on our water rights.

Looking back at water flow starting in 1987 the flow rates were at an average of about 2 cubic feet/second, well below the minimum flow rates. This is the first year that the river had excessive flow rates for most of the year. We feel that the request to divert 155 acre feet of water at 1500 gallons per min. is excessive, given the flow rates of water in the Saline river in the past three decades.

Sincerely

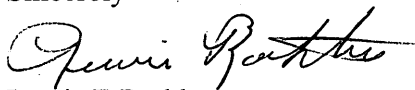

Lewis E Rathbun
Manager Rathbun Holdings LLC

RECEIVED

OCT 8 2018

Garden City Field Office
Division of Water Resources

SCANNED

50049

New Application - Surface Water

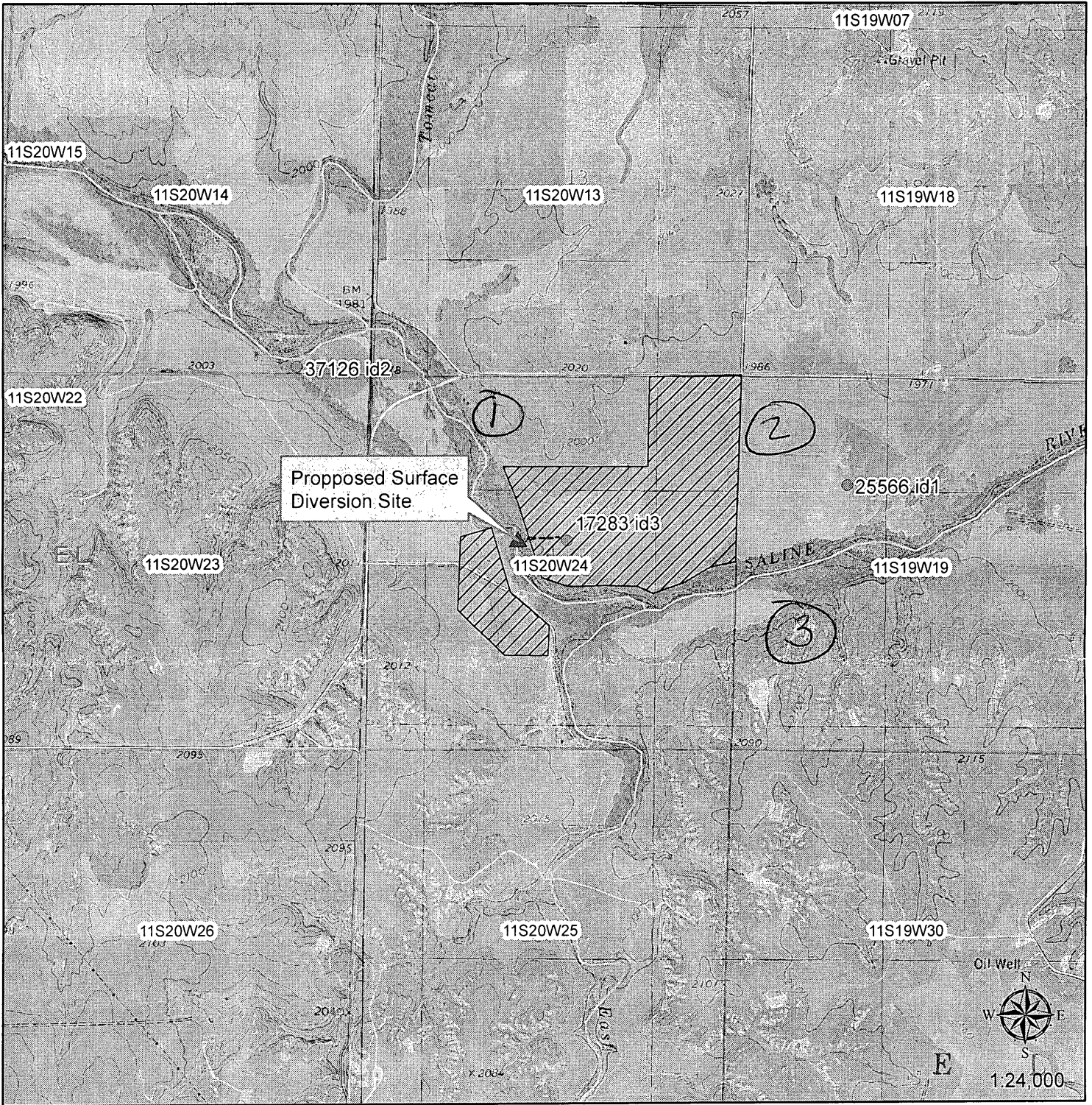

Signature Required

Jeff Waler

By signing this I am stating that to the best of my knowledge that all landowners within 1/2 mile upstream and downstream of my property are identified on this map or listed on an attachment to this map.

▲ Surface Water Point of Diversion

● Groundwater Point of Diversion

▨ Proposed Place of Use
WATER RESOURCES RECEIVED

APR 20 2018
SCANNED