

Submit completed application to:
 Kansas Department of Agriculture
 Division of Water Resources
 Field Office for your area.
 Call for address:

Topeka -- (785) 296-5733
 Stafford -- (620) 234-5311
 Stockton -- (785) 425-6787
 Garden City -- (620) 276-2901
<http://agriculture.ks.gov/dwr>

DWR FIELD OFFICE APPLICATION FOR APPROVAL TO CHANGE THE PLACE OF USE AND/OR THE POINT OF DIVERSION



STATE OF KANSAS

Filing Fee Must Accompany the Application, K.S.A. 82a-708b(b), as amended.
 Fee Schedule is on the third page of this application form.

Paragraph Nos. 1, 2, 3 & 5 must be completed. Complete all other applicable portions. If change in point of diversion is greater than 100 feet, or if place of use will be changed, include a topographic map or detailed plat showing the authorized and proposed point(s) of diversion and/or place of use.

RECEIVED

OCT 11 2019
 2:07 p.m.
 Stockton Field Office
 Division of Water Resources

File No. 21,978

1. Application is hereby made for approval of the Chief Engineer to change the (check one or both):

Place of Use Point of Diversion

under the water right which is the subject of this application in accordance with the conditions described below.

The source of supply is: Groundwater Surface water

2. Name and address of Applicant: Brian & Calli Downing

PO Box 366, Leoti, KS 67861

Phone Number: (620) 214-9319 Email address: brian@promisedlandag.com

Name and address of Water Use Correspondent: _____

Phone Number: () _____ Email address: _____

3. The presently authorized place of use is:

Owner of Land ---- NAME: Brian & Cali Downing

ADDRESS: PO Box 366, Leoti, KS 67861

(If there is more than one landowner, attach supplemental sheets as necessary.)

Sec.	Twp.	Range	NE¼				NW¼				SW¼				SE¼				TOTAL ACRES
			NE¼	NW¼	SW¼	SE¼	NE¼	NW¼	SW¼	SE¼	NE¼	NW¼	SW¼	SE¼	NE¼	NW¼	SW¼	SE¼	
3	6S	34W	18	33.95	36	7													94.95

4. If this application is for a change in place of use, it is proposed that the place of use be changed to:

Owner of Land ---- NAME: Brian & Cali Downing

ADDRESS: PO Box 366, Leoti, KS 67861

(If there is more than one landowner, attach supplemental sheets as necessary.)

Sec.	Twp.	Range	NE¼				NW¼				SW¼				SE¼				TOTAL ACRES
			NE¼	NW¼	SW¼	SE¼	NE¼	NW¼	SW¼	SE¼	NE¼	NW¼	SW¼	SE¼	NE¼	NW¼	SW¼	SE¼	
3	6S	34W	15.5	34	34	10													93.5
			<u>lot 1</u>	<u>lot 2</u>															

For Office Use Only: Code _____ Fee \$ _____ TR # _____ Receipt Date _____ Check # _____

5. **Presently authorized point of diversion:**
 One in the SE Quarter of the SW Quarter of the NE Quarter
 of Section 3, Township 6 South, Range 34 (E/W),
 in THOMAS County, Kansas, 3070 feet North 1880 feet West of Southeast corner of section.
 Authorized Rate 315 Authorized Quantity 124 Depth of well _____ (feet)
 (DWR use only: Computer ID No. 3 GPS 3061 feet North 1756 feet West)
 This point will not be changed This point will be changed as follows: No change, point better described with GPS as follows:
Proposed point of diversion: (Complete only if change is requested or if existing point is better described by GPS)
 One in the SE Quarter of the SW Quarter of the NE Quarter
 of Section 3, Township 6 South, Range 34 (E/W),
 in THOMAS County, Kansas, 3061 feet North 1756 feet West of Southeast corner of section.
 Proposed Rate 315 Proposed Quantity 124 Proposed well depth (feet) _____
 This point is: Additional Well Geo Center List other water rights that will use this point _____

6. **Presently authorized point of diversion:**
 One in the _____ Quarter of the _____ Quarter of the _____ Quarter
 of Section _____, Township _____ South, Range _____ (E/W),
 in _____ County, Kansas, _____ feet North _____ feet West of Southeast corner of section.
 Authorized Rate _____ Authorized Quantity _____ Depth of well _____ (feet)
 (DWR use only: Computer ID No. _____ GPS _____ feet North _____ feet West)
 This point will not be changed This point will be changed as follows: No change, point better described with GPS as follows:
Proposed point of diversion: (Complete only if change is requested or if existing point is better described by GPS)
 One in the _____ Quarter of the _____ Quarter of the _____ Quarter
 of Section _____, Township _____ South, Range _____ (E/W),
 in _____ County, Kansas, _____ feet North _____ feet West of Southeast corner of section.
 Proposed Rate _____ Proposed Quantity _____ Proposed well depth (feet) _____
 This point is: Additional Well Geo Center List other water rights that will use this point _____

7. The changes herein are desired for the following reasons?
 (please be specific) To authorize acres under pivot

8. If a well, is the test hole log attached? Yes No

9. The change(s) (was)(will be) completed by?
N/A

10. If the point of diversion is a well:
 (a) What are you going to do with the old well?

 (b) When will this be done? _____

11. Groundwater Management District recommendation attached?
 Yes No

12. Assisted by Shannon Kenyon - GMD 4

13a. If the proposed point of diversion will be relocated more than 300 feet but within 2,640 feet of the existing point of diversion, attach a topographic map or aerial photograph. For groundwater sources, show all wells (including domestic) within one-half mile of the proposed point of diversion and the names and mailing addresses of the owners. For surface water sources, show the names and addresses of the landowner(s) one-half mile downstream and one-half mile upstream from your property lines

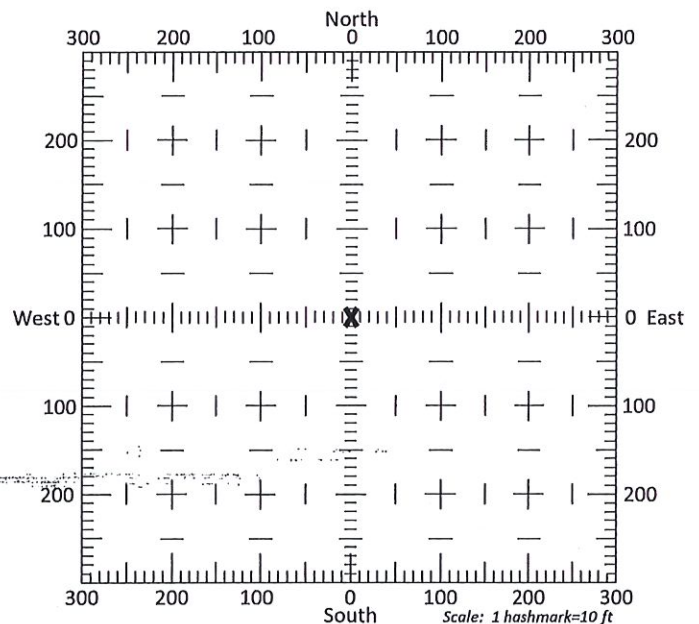

13b. If the proposed point of diversion will be relocated within 300 feet of the existing point of diversion, indicate its location on the diagram shown above in relation to the existing point of diversion. (PLEASE NOTE: The "X" in center of diagram above represents the presently authorized point of diversion.)

14. If the proposed groundwater point of diversion is 300 or fewer feet from the existing point of diversion, complete the following:
- (a) Does the undersigned represent all owners of the currently authorized place(s) of use identified in this application?
 Yes No (If no, all owners must sign this application.)
 - (b) Will the ownership interest of any owner of the currently authorized place(s) of use identified in this application be adversely affected if this application is approved as requested?
 Yes No (If yes, all owners must sign this application.)
 - (c) If this application is not approved expeditiously, will there be substantial damage to property, public health or safety?
 Yes No (If no, all owners must sign this application.)

If the application proposes a surface water change in point of diversion, a groundwater change in point of diversion greater than 300 feet, or a change in place of use, the application must be signed by all owners of the currently authorized place of use, or their duly authorized agent (attach notarized statement authorizing representation).

I hereby verify, being first duly sworn upon my oath or affirmation and under penalty of perjury, that I am of lawful age and the owner, the spouse of the owner, or a duly authorized agent of the owner(s) to make this application on their behalf, in regards to the water right(s) to which this application pertains. I further verify that the statements contained in this application are true, correct and complete.

Dated at Leoti, Kansas, this 4th day of October, 2019.

Brian Downing
 (Owner)
Brian Downing
 (Please Print)

 (Owner)

 (Please Print)

 (Owner)

 (Please Print)

Calli J. Downing
 (Spouse)
Calli J. Downing
 (Please Print)

 (Spouse)

 (Please Print)

 (Spouse)

 (Please Print)

State of Kansas }
 County of Wichita } SS

I hereby certify that the foregoing application was signed in my presence and sworn to before me this 4th day of October, 2019.

My Commission Expires 5-2-21

Lynda Goodrich
 Notary Public

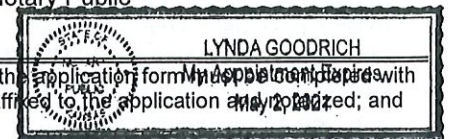

ONLY COMPLETE APPLICATIONS WILL BE PROCESSED. To be complete, all of the applicable portions of the application form must be completed with accurate information; maps, if necessary, must be included; signatures of all the appropriate owners' must be affixed to the application and notarized; and the appropriate fee must be paid.

FEE SCHEDULE

Each application to change the place of use or the point of diversion under this section shall be accompanied by the application fee set forth in the schedule below: Make checks payable to: **Kansas Department of Agriculture**

- (1) Application to change a point of diversion 300 feet or less \$100
- (2) Application to change a point of diversion more than 300 feet \$200
- (3) Application to change the place of use \$200

RECEIVED

OCT 11 2019

Stockton Field Office
 Division of Water Resources

File No. 21,978 _____

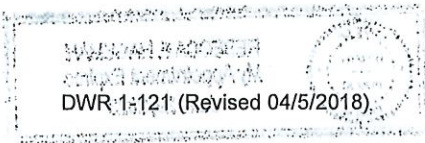

SUMMARY ORDER APPROVING APPLICATION FOR CHANGE AND IMPOSING CONDITIONS

This Summary Order is issued under authority of K.S.A. 82a-708b, as amended, and K.A.R. 5-5-1, *et seq.* and other applicable provisions of the *Kansas Water Appropriation Law, K.S.A. 82a-701 et. seq.*, and rules and regulations promulgated thereunder, With the exception of those conditions expressly contained herein, this Summary Order does not change the terms, conditions and limitations of File No. 21,978.

1. A change application was received on 10-11-19 requesting that the place of use and / or point of diversion authorized under the above-referenced file number be changed as described in the application.
2. On and after the effective date of this summary order, the authorized place(s) of use shall be located substantially as shown on the topographic map accompanying the application to change the place of use. Applicable Not Applicable
3. The change in point of diversion shall not impair existing rights and shall be limited to the same source or sources of water as previously authorized. The point of diversion authorized by this summary order shall be located within a NA foot radius of the authorized point(s) of diversion. Applicable Not Applicable
4. The point(s) of diversion described herein is administratively corrected to be more accurately described using the Global Positioning System (GPS), as described in the application. Applicable Not Applicable
5. The point(s) of diversion authorized herein shall not actually be located more than NA feet from the previously authorized point(s) of diversion. Applicable Not Applicable
6. As required by K.A.R. 5-3-5d, if the works for diversion is a well with a diversion rate of 100 gallons per minute or more, a tube or other device suitable for making water level measurements shall be installed, operated and maintained in accordance with K.A.R. 5-6-13. Applicable Not Applicable
7. **The owner of the authorized place(s) of use shall properly install an acceptable water flow meter on or before December 31, 2020**, or before the first use of water, whichever occurs first. The water flow meter shall be installed, operated and maintained in accordance with K.A.R. 5-1-4 through 5-1-12. As required by K.S.A. 82a-732, as amended, and K.A.R. 5-3-5e, the owner shall maintain records and report the reading of the water flow meter and the total quantity of water diverted annually to the Chief Engineer by March 1 following the end of each calendar year. Applicable Not Applicable
8. **Installation of the works for diversion of water shall be completed on or before December 31, 20NA**, or within any authorized extension of time. By March 1, 20NA the applicant shall notify the Chief Engineer that construction of the works for diversion has been completed, on the form provided by the Chief Engineer, as required by K.A.R. 5-8-4e. Applicable Not Applicable
9. **The completed well log shall be submitted with the required notice.** Applicable Not Applicable
10. All diversion works into which any type of chemical or other foreign substance will be injected into the water shall be equipped with an in-line, automatic, quick-closing check valve capable of preventing pollution of the source of the water supply. The check valve(s) shall be installed, operated and maintained in accordance with K.A.R. 5-3-5c. Applicable Not Applicable
11. Additional Conditions are attached. Yes No
12. In accordance with K.S.A. 82a-708a, as amended, and K.A.R. 5-5-14, all of the owners of the authorized place(s) of use of water appropriated under the above-referenced file number are responsible for compliance with its terms, conditions and limitations, as amended and/or supplemented by this Summary Order, and with applicable provisions of the *Kansas Water Appropriation Law* and the *Rules and Regulations* promulgated thereunder. Failure to comply with these provisions may result in civil penalties pursuant to K.S.A. 82a-737, as amended, and/or the suspension or revocation and dismissal of the water or appropriation right or any other enforcement actions authorized by law.

Administrative Appeal and Effective Date of Order

If you are aggrieved by this order, pursuant to K.S.A. 82a-1901, you may request an evidentiary hearing before the Chief Engineer or request administrative review by the Secretary of Agriculture. A request for hearing by the Chief Engineer must be filed within **15 days** of service of this Order and a request for administrative review by the Secretary must be filed within **30 days** pursuant to K.S.A. 77-531. Any request for administrative review must state a basis for review pursuant to K.S.A. 77-527. File any request with **Kansas Department of Agriculture, Legal Division, 1320 Research Park Drive, Manhattan, KS 66502**. Failure to timely request a hearing or review may preclude review under the Kansas Judicial Review Act.

For Use by Register of Deeds

FOR OFFICE USE ONLY
**APPLICATION APPROVED AND
 SUMMARY ORDER ISSUED**

By: Kelly C. Stewart
 Duly Authorized Designee of the Chief Engineer

(Print Name): KELLY C. STEWART
 Division of Water Resources - Kansas Department of Agriculture

Date of Issuance: 10-15-19

State of Kansas)
) SS
 County of ROOKS)

Acknowledged before me on 10-15-19

by Kelly Stewart

Signature: Rebecca F. Hageman
 Notary Public



My commission expires: 6-29-23

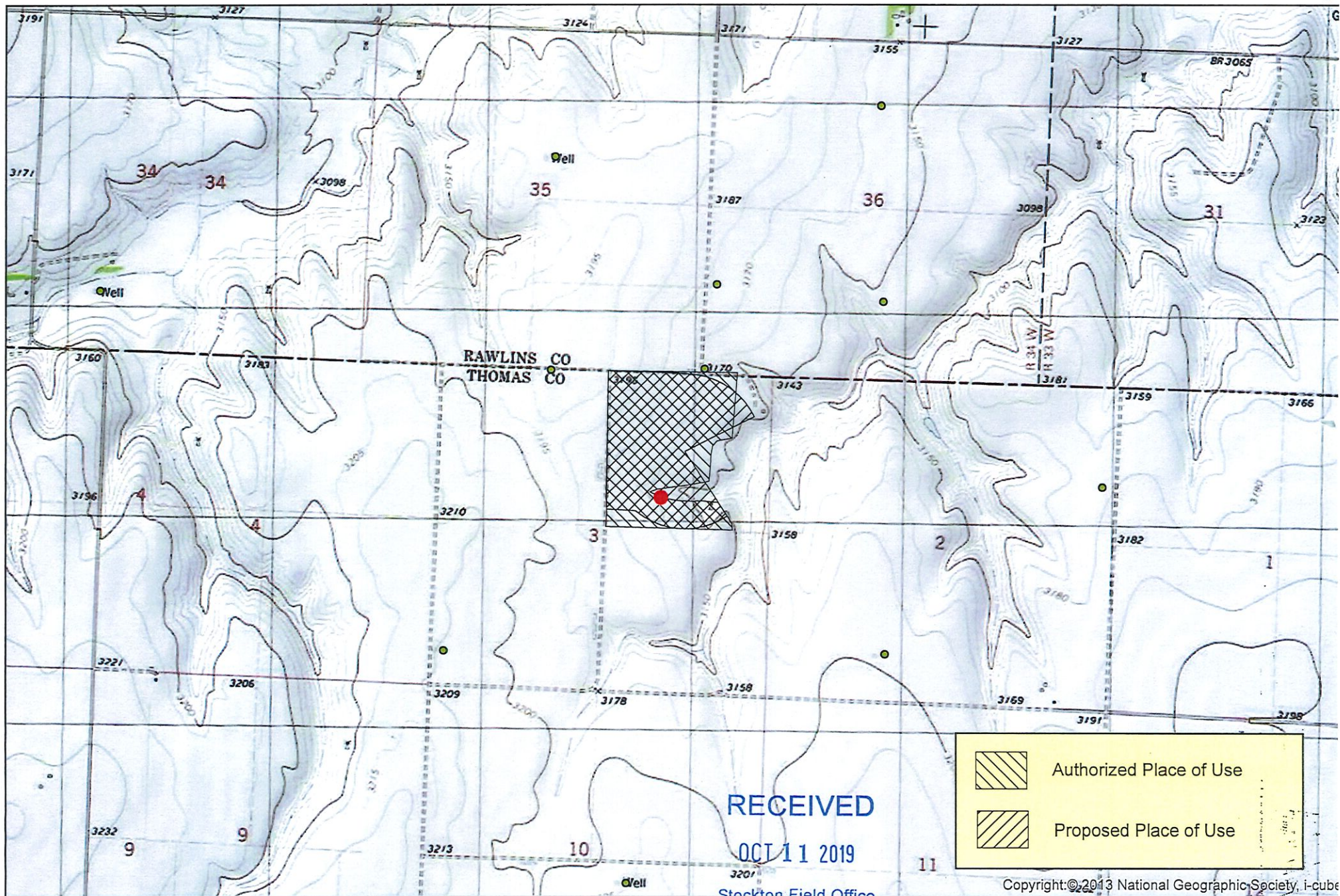

#21,978 - Change in Place of Use



RECEIVED
OCT 11 2019
Stockton Field Office
Division of Water Resources

	Authorized Place of Use
	Proposed Place of Use

Copyright: © 2013 National Geographic Society, i-cube

Prepared by Shannon Kenyon, GMD

LEGAL (OPT)	NE 3-6-34W
PIVOT LENGTH (REQD)	1220
ROTATION DEGREES (REQD)	275
GPM (REQD)	250
NOZZLE SPACING IN FT (OPT)	6.6666
RESIDUE IN LBS/ACR (REQD)	4000
ACRES OF CLASS VI SOIL IN GRASS, ALFALFA, ETC.	0

CROPS ANY IRRIGABLE CROPS MAY
BE PRODUCED

ADDED PROVISIONS/NOTES NONE

RECEIVED

OCT 11 2019

Stockton Field Office
Division of Water Resources

CALCULATIONS FOR AVERAGE FIELD SLOPE

ACRES IN FIELD:

81.99962

MAP UNIT NUMBER	SOIL TYPE		AVERAGE SLOPE		ACRES OF THE SOIL TYPE		WEIGHTE AVERAGE
1620	Keith silt loam, 1 to 3 percent slopes	+	2	+	80.5	+	1.96342
1619	Keith silt loam, 0 to 1 percent slopes	+	0.5	+	1	+	0.0061
1859	Ulysses silt loam, 3 to 6 percent slopes	+	4.5	+	1	+	0.05488
1580	Colby silt loam, 5 to 15 percent slopes	+	10	+	9.6	+	1.17074
		0	0	+	13.1	+	0
		0	0	+	19.3	+	0
		0	0	+		+	0
		0	0	+		+	0
		0	0	+		+	0

AVERAGE WEIGHTED FIELD SLOPE:

3.20 %

ENTER CLASS VI ACRES HERE:
 ENTER STEEPEST SLOPE IF CLASS VI:
 WEIGHTED AVERAGE FIELD SLOPE:
 PER CENT CLASS VI SOIL
 DESIGN SLOPE FOR CENTER PIVOT:

13.1 ACRES
 7 %
 3.195137 %
 15.97568 %
 5.097568 %

RECEIVED

OCT 11 2019

Stockton Field Office
 Division of Water Resources

DESIGN GROUP 5

design slope	5.097568 %	7	1	4.2
residue	4000 lbs/acre	4000	3	2.5
			5	1.5
max all. Appl. Rate	1.32 in/hr		7	1.1

900	0.85
1000	0.9
1500	0.95
2000	1
2500	1.05
3000	1.1
3500	1.15
4000	1.2
4500	1.25

RECEIVED

OCT 11 2019

Stockton Field Office
Division of Water Resources

CALCULATED

MAX ALLOW
APPL RATE
1.32

PIVOT
LENGTH
1220

GPM:WTD DIA
8.37

GPM
250.00

WTD DIA
29.88

GPM = 250

APPL RT= 1.32

RADIUS
1220

GPM
250

NZL SPCNG
6.6666

GPM/AC
2.33

251.36 =SUM NZL GPM
2.73 =GPM END NZL

RECEIVED

OCT 11 2019

Stockton Field Office
Division of Water Resources