

NOTICE

This scan only represents the application as filed. The information contained herein meets the requirements of K.A.R. 5-3-1 or K.A.R. 5-5-1, and has been found acceptable for filing in the office of the Chief Engineer. The application should not be considered to be a complete application as per K.A.R. 5-3-1b or K.A.R. 5-5-2a.

1320 Research Park Drive
Manhattan, KS 66502
785-564-6700
www. agriculture.ks.gov



900 SW Jackson, Room 456
Topeka, KS 66612
785-296-3556

Mike Beam, Secretary

Laura Kelly, Governor

File Number **50483**
This item to be completed by the Division of Water Resources.

WATER RESOURCES
RECEIVED

**APPLICATION FOR PERMIT TO
APPROPRIATE WATER FOR BENEFICIAL USE**

Filing Fee Must Accompany the Application
(Please refer to Fee Schedule attached to this application form.)

DEC 10 2020
3:06
KS DEPT OF AGRICULTURE

To the Chief Engineer of the Division of Water Resources, Kansas Department of Agriculture,
1320 Research Park Drive, Manhattan, Kansas 66502:

1. Name of Applicant (Please Print): KANSAS DEPARTMENT OF WILDLIFE, PARKS & TOURISM
Address: 512 SE 25TH AVE
City: PRATT State KS Zip Code 67124-8147
Telephone Number: (____) _____

2. The source of water is: surface water in _____ (stream)
OR groundwater in PRAIRIE DOG CREEK (drainage basin)

Certain streams in Kansas have minimum target flows established by law or may be subject to administration when water is released from storage for use by water assurance district members. If your application is subject to these regulations on the date we receive your application, you will be sent the appropriate form to complete and return to the Division of Water Resources.

3. The maximum quantity of water desired is 5 acre-feet OR 1.629 MG gallons per calendar year, to be diverted at a maximum rate of 99 gallons per minute OR _____ cubic feet per second.

Once your application has been assigned a priority, the requested maximum rate of diversion and maximum requested quantity of water under that priority number can **NOT** be increased. Please be certain your requested maximum rate of diversion and maximum quantity of water are appropriate and reasonable for your proposed project and are in agreement with the Division of Water Resources' requirements.

4. The water is intended to be appropriated for (Check use intended):
(a) Artificial Recharge (b) Irrigation (c) Recreational (d) Water Power
(e) Industrial (f) Municipal (g) Stockwatering (h) Sediment Control
(i) Domestic (j) Dewatering (k) Hydraulic Dredging (l) Fire Protection
(m) Thermal Exchange (n) Contamination Remediation

YOU **MUST** COMPLETE AND ATTACH ADDITIONAL DIVISION OF WATER RESOURCES FORM(S) PROVIDING INFORMATION TO SUBSTANTIATE YOUR REQUEST FOR THE AMOUNT OF WATER FOR THE INTENDED USE REFERENCED ABOVE.

For Office Use Only:
F.O. 3 GMD _____ Meets K.A.R. 5-3-1 (YES/NO) Use MUN Source G/S County NT By BMM Date 12/14/20
Code REG Fee \$ 200 TR # _____ Receipt Date 12-10-2020 Check # 2029

12/17/2020
LMoody

5. The location of the proposed wells, pump sites or other works for diversion of water is:

Note: For the application to be accepted, the point of diversion location must be described to at least a 10 acre tract, unless you specifically request a 60 day period of time in which to locate the site within a specifically described, minimal legal quarter section of land.

(A) One in the SW quarter of the SE quarter of the SE quarter of Section 12, more particularly described as being near a point 640 feet North and 738 feet West of the Southeast corner of said section, in Township 3 South, Range 24 West, NORTON County, Kansas.

(B) One in the SW quarter of the SE quarter of the SE quarter of Section 12, more particularly described as being near a point 593 feet North and 716 feet West of the Southeast corner of said section, in Township 3 South, Range 24 West, NORTON County, Kansas.

(C) One in the _____ quarter of the _____ quarter of the _____ quarter of Section _____, more particularly described as being near a point _____ feet North and _____ feet West of the Southeast corner of said section, in Township _____ South, Range _____ East/West (circle one), _____ County, Kansas.

(D) One in the _____ quarter of the _____ quarter of the _____ quarter of Section _____, more particularly described as being near a point _____ feet North and _____ feet West of the Southeast corner of said section, in Township _____ South, Range _____ East/West (circle one), _____ County, Kansas.

If the source of supply is groundwater, a separate application shall be filed for each proposed well or battery of wells, except that a single application may include up to four wells within a circle with a quarter (1/4) mile radius in the same local source of supply which do not exceed a maximum diversion rate of 20 gallons per minute per well.

A battery of wells is defined as two or more wells connected to a common pump by a manifold; or not more than four wells in the same local source of supply within a 300 foot radius circle which are being operated by pumps not to exceed a total maximum diversion rate of 800 gallons per minute and which supply water to a common distribution system.

6. The owner of the point of diversion, if other than the applicant is (please print):

Kansas Dept. Wildlife Parks + Tourism
(name, address and telephone number)
13037 Hwy 261 Norton KS
(name, address and telephone number)

You must provide evidence of legal access to, or control of, the point of diversion from the landowner or the landowner's authorized representative. Provide a copy of a recorded deed, lease, easement or other document with this application. In lieu thereof, you may sign the following sworn statement:

I have legal access to, or control of, the point of diversion described in this application from the landowner or the landowner's authorized representative. I declare under penalty of perjury that the foregoing is true and correct.

Executed on _____, 20____. [Signature] 12/1/20
Applicant's Signature

The applicant must provide the required information or signature irrespective of whether they are the landowner. Failure to complete this portion of the application will cause it to be unacceptable for filing and the application will be returned to the applicant.

7. The proposed project for diversion of water will consist of BATT OF 2 WELLS
(number of wells, pumps or dams, etc.)

and (was) completed (by) 1983 (REDRILLED)
(Month/Day/Year - each was or will be completed)

8. The first actual application of water for the proposed beneficial use was or is estimated to be 2020-2021
(Mo/Day/Year)

WATER RESOURCES
RECEIVED

DEC 1 0 2020

9. Will pesticide, fertilizer, or other foreign substance be injected into the water pumped from the diversion works?
~~Yes~~ No If "yes", a check valve shall be required.

All chemigation safety requirements must be met including a chemigation permit and reporting requirements.

10. If you are planning to impound water, please contact the Division of Water Resources for assistance, prior to submitting the application. Please attach a reservoir area capacity table and inform us of the total acres of surface drainage area above the reservoir.

Have you also made an application for a permit for construction of this dam and reservoir with the Division of Water Resources? Yes No

- If yes, show the Water Structures permit number here N/A
- If no, explain here why a Water Structures permit is not required _____

11. The application must be supplemented by a U.S.G.S. topographic map, aerial photograph or a detailed plat showing the following information. On the topographic map, aerial photograph, or plat, identify the center of the section, the section lines or the section corners and show the appropriate section, township and range numbers. Also, please show the following information:

- (a) The location of the proposed point(s) of diversion (wells, stream-bank installations, dams, or other diversion works) should be plotted as described in Paragraph No. 5 of the application, showing the North-South distance and the East-West distance from a section line or southeast corner of section.
- (b) If the application is for groundwater, please show the location of any existing water wells of any kind within 1/2 mile of the proposed well or wells. Identify each existing well as to its use and furnish the name and mailing address of the property owner or owners. If there are no wells within 1/2 mile, please advise us.
- (c) If the application is for surface water, the names and addresses of the landowner(s) 1/2 mile downstream and 1/2 mile upstream from your property lines must be shown.
- (d) The location of the proposed place of use should be shown by crosshatching on the topographic map, aerial photograph or plat.
- (e) Show the location of the pipelines, canals, reservoirs or other facilities for conveying water from the point of diversion to the place of use.

A 7.5 minute U.S.G.S. topographic map may be obtained by providing the section, township and range numbers to: Kansas Geological Survey, 1930 Constant, Campus West, University of Kansas, Lawrence, Kansas 66047.

12. List any application, appropriation of water, water right, or vested right file number that covers the same diversion points or any of the same place of use described in this application. Also list any other recent modifications made to existing permits or water rights in conjunction with the filing of this application.

THESE EXISTING WELLS ARE COVERED BY WATER RIGHTS 31,355 & 36,504. IT IS PROPOSED THAT

THOSE TWO WATER RIGHTS BE DISMISSED CONTINGENT UPON APPROVAL OF THIS WATER

RIGHT THAT WOULD AUTHORIZE A BATTERY OF 2 WELLS FOR 5 AF.

THIS WOULD INCREASE TOTAL AMOUNT AUTHORIZED AND ALLOW FOR ONE WATER METER.

WATER RESOURCES RECEIVED

DEC 10 2020

13. Furnish the following well information if the proposed appropriation is for the use of groundwater. If the well has not been completed, give information obtained from test holes, if available.

Information below is from: Test holes Well as completed Drillers log attached

Well location as shown in paragraph No.	(A)	(B)	(C)	(D)
Date Drilled	<u>06/01/83</u>	<u>06/01/83</u>	_____	_____
Total depth of well	<u>59</u>	<u>59</u>	_____	_____
Depth to water bearing formation	<u>44</u>	<u>44</u>	_____	_____
Depth to static water level	<u>39</u>	<u>39</u>	_____	_____
Depth to bottom of pump intake pipe	_____	_____	_____	_____

14. The relationship of the applicant to the proposed place where the water will be used is that of

AGENT
(owner, tenant, agent or otherwise)

15. The owner(s) of the property where the water is used, if other than the applicant, is (please print):

Kansas Dept Wildlife & Parks
(name, address and telephone number)

13037 Hwy 261 Norton Kansas
(name, address and telephone number)

16. The undersigned states that the information set forth above is true to the best of his/her knowledge and that this application is submitted in good faith.

Dated at Norton County, Kansas, this 1 day of December, 2020.
(month) (year)

[Signature]
(Applicant Signature)

By [Signature]
(Agent or Officer Signature)

(Agent or Officer - Please Print)

Assisted by MB - Stacton _____ Date: _____
(office/title)

WATER RESOURCES
RECEIVED

DEC 10 2020

FEE SCHEDULE

1. The fee for an application for a permit to appropriate water for beneficial use, except for domestic use, shall be (see paragraph No. 2 below if requesting storage):

ACRE-FEET	FEE
0-100	\$200.00
101-320	\$300.00
More than 320	\$300.00 plus \$20.00 for each additional 100 acre-feet or any part thereof.

2. The fee for an application in which storage is requested, except for domestic use, shall be:

ACRE-FEET	FEE
0-250	\$200.00
More than 250	\$200.00 plus \$20.00 for each additional 250 acre-feet of storage or any part thereof.

Note: If an application requests both direct use *and* storage, the fee charged shall be as determined under No. 1 or No. 2 above, whichever is greater, but not both fees.

3. The fee for an application for a permit to appropriate water for water power or dewatering purposes shall be \$100.00 plus \$200.00 for each 100 cubic feet per second, or part thereof, of the diversion rate requested.

Note: The applicant shall notify the Chief Engineer and pay the statutorily required field inspection fee of \$400.00 when construction of the works for diversion has been completed, except that for applications filed on or after July 1, 2009, for works constructed for sediment control use and for evaporation from a groundwater pit for industrial use shall be accompanied by a field inspection fee of \$200.00.

MAKE CHECKS PAYABLE TO THE KANSAS DEPARTMENT OF AGRICULTURE

ATTENTION

A Water Conservation Plan may be required per K.S.A. 82a-733. A statement that your application for permit to appropriate water may be subject to the minimum desirable streamflow requirements per K.S.A. 82a-703a, b, and c may also be required from you. After the Division of Water Resources has had the opportunity to review your application, you will be notified whether or not you will need to submit a Water Conservation Plan. You also may be required to install a water flow meter or water stage measuring device on your diversion works prior to diverting water. There may be other special conditions or Groundwater Management District regulations that you will need to comply with if this application is approved.

CONVERSION FACTORS

1 acre-foot equals 325,851 gallons

1 million gallons equal 3.07 acre-feet

WATER RESOURCES
RECEIVED

DEC 10 2020

KS DEPT OF AGRICULTURE

Applicant's Name KDWP&T PRAIRIE DOG ST PARK
(Please Print)

MUNICIPAL (PUBLIC WATER SUPPLY) APPLICATION SUPPLEMENTAL INFORMATION SHEET

Application File Number

(assigned by DWR)

SECTION 1: PRESENT WATER USE SUMMARY (IF NO PREVIOUS MUNICIPAL WATER USE HAS BEEN UTILIZED, PROCEED TO SECTION 3)

NOTE: WORKSHEET FOR WATER PUMPED, PURCHASED, AND SOLD BY YOUR WATER DISTRIBUTION SYSTEM.

Column 1	Column 2	Column 3	Column 4	Column 5	Column 6	Column 7
Raw Water Diverted Under Your Rights	Water Purchased From All Sources	Water Sold to Other Public Water Suppliers	Water Sold to Your Industrial, Stock, and Bulk Customers	Water Sold to Your Residential and Commercial Customers	Other Metered Water	Remaining Water Used (See Below Explanation)
783,919 GAL	0	0	0	783,919 GAL	0	0
TOTAL WATER = Columns 1 + 2		ACCOUNTED FOR WATER = Columns 3 + 4 + 5 + 6				UNACCOUNTED FOR WATER

UNACCOUNTED FOR WATER = TOTAL WATER - ACCOUNTED FOR WATER

- Column 1: The amount of raw water diverted from all of your points of diversion.
- Column 2: The amount of water purchased wholesale from all other public water supply systems or the Kansas Water Office.
- Column 3: The amount of water sold wholesale to all other public water supply systems.
- Column 4: The amount of water sold retail to all industrial, pasture, stockwater, feedlot, and bulk water service connections. Include the amount of water sold to all farmsteads using at least 200,000 gallons of water per year.
- Column 5: The amount of water sold retail to your residential and commercial customers and to industries and farmsteads using less than 200,000 gallons of water per year.
- Column 6: The amount of water used that is metered at individual service connections and supplied free, such as for public service, treatment processes, and connections receiving free water.
- Column 7: The amount of remaining water used. The gallons reported in this column are found by adding the numbers in Columns 1 and 2 and subtracting the numbers in Columns 3, 4, 5, and 6.

UNACCOUNTED FOR WATER

Use the following to calculate your distribution system's Unaccounted For Water:

Start with the amount in Column 1 and add the amount in Column 2, then subtract the amounts in Columns 3, 4, 5, and 6 leaving an amount of water representing your unaccounted for water to enter in Column 7.

Use the following to calculate the percent Unaccounted For Water versus the Total Water of your system:

$$\text{Percent Unaccounted For Water} = \frac{\text{Unaccounted For Water}}{\text{Total Water (Columns 1,2)}} \times 100$$

If this number exceeds 20%, please explain the large amount of unaccounted for water and describe any steps being taken to reduce it.

SECTION 2: PAST WATER USE

COMPLETE THE FOLLOWING TABLE FROM YOUR PAST WATER USE RECORDS.

	Column 1	Column 2	Column 3	Column 4	Column 5	Column 6	Column 7
	Raw Water Diverted Under Your Rights	Water Purchased From All Sources	Water Sold to Other Public Water Suppliers	Water Sold to Your Industrial, Stock, and Bulk Customers	Water Sold to Your Residential and Commercial Customers	Other Metered Water	Remaining Water Used (See Above Explanation)
20 years ago	1,629,255 GAL	0	0	0	1,629,255 GAL	0	0
15 years ago	651,702 GAL	0	0	0	651,702 GAL	0	0
10 years ago	528,210	0	0	0	528,210	0	0
5 years ago	840,590	0	0	0	840,590	0	0
	TOTAL WATER = Columns 1 + 2		ACCOUNTED FOR WATER = Columns 3 + 4 + 5 + 6				UNACCOUNTED FOR WATER

WATER RESOURCES RECEIVED
DEC 10 2020
KANSAS DEPT OF AGRICULTURE

SECTION 3: PROJECTED FUTURE WATER NEEDS

PLEASE COMPLETE THE FOLLOWING TABLE SHOWING YOUR FUTURE WATER REQUIREMENTS FOR THE NEXT 20 YEARS:

	Column 1 Raw Water Diverted Under Your Rights	Column 2 Water Purchased From All Sources	Column 3 Water Sold to Other Public Water Suppliers	Column 4 Water Sold to Your Industrial, Stock, and Bulk Customers	Column 5 Water Sold to Your Residential and Commercial Customers	Column 6 Other Metered Water	Column 7 Remaining Water Used (See Explanation on other side)
Year 5	1,629,255	0	0	0	1,629,255	0	0
Year 10	1,629,255	0	0	0	1,629,255	0	0
Year 15	1,629,255	0	0	0	1,629,255	0	0
Year 20	1,629,255	0	0	0	1,629,255	0	0
TOTAL WATER = Columns 1 + 2			ACCOUNTED FOR WATER = Columns 3 + 4 + 5 + 6				UNACCOUNTED FOR WATER

SECTION 4: POPULATION AND SERVICE CONNECTIONS

ESTIMATE THE NUMBER OF PERSONS DIRECTLY SERVED BY YOUR WATER DISTRIBUTION SYSTEM

PAST POPULATION - PROVIDE INFORMATION BELOW:
(CENSUS BUREAU INFORMATION)

LAST 20 YEARS	POPULATION
20 years ago	SEASONAL VISITATION
15 years ago	SEASONAL VISITATION
10 years ago	SEASONAL VISITATION
5 years ago	SEASONAL VISITATION
Last Year	SEASONAL VISITATION

PROJECTED FUTURE POPULATION

ESTIMATE FUTURE POPULATION AND SUBSTANTIATE NUMBERS ON SEPARATE ATTACHMENTS

NEXT 20 YEARS	POPULATION
Year 5	SEASONAL VISITATION
Year 10	SEASONAL VISITATION
Year 15	SEASONAL VISITATION
Year 20	SEASONAL VISITATION

Provide number of current active service connections:

_____ Residential _____ Industrial _____ 60 Other (specify) RV CAMPSITES & SUPPORTING FACILITIES
 _____ Commercial _____ Pasture/ Stockwater/ Feedlot _____ **Total**

SECTION 5: PRESENT GALLONS PER PERSON PER DAY

CALCULATE YOUR GALLONS PER PERSON PER DAY

Water in Columns 5, 6, and 7 ÷ Population ÷ 365 Days/Year = Gallons per Person per Day

_____ ÷ _____ ÷ 365 Days/Year = N/A GALLONS PER PERSON PER DAY.
 Amount of water in Columns 5, 6, and 7 of Section 1 Population from Last Year of Section 4

SECTION 6: AREA TO BE SERVED

Describe the area to be served or provide the legal description of the location where the water is to be used including any other city of water supply system (i.e. Rural Water District): _____

PRAIRIE DOG STATE PARK. INCLUDES RV CAMPSITES AND RESTROOM FACILITIES.

You may attach additional information you believe will assist in informing the Division of the need for your request.

WATER RESOURCES RECEIVED
 DEC 10 2020
 DIVISION OF AGRICULTURE

New Application - Groundwater
 Assisted by Division of Water Resources
 Stockton Field Office

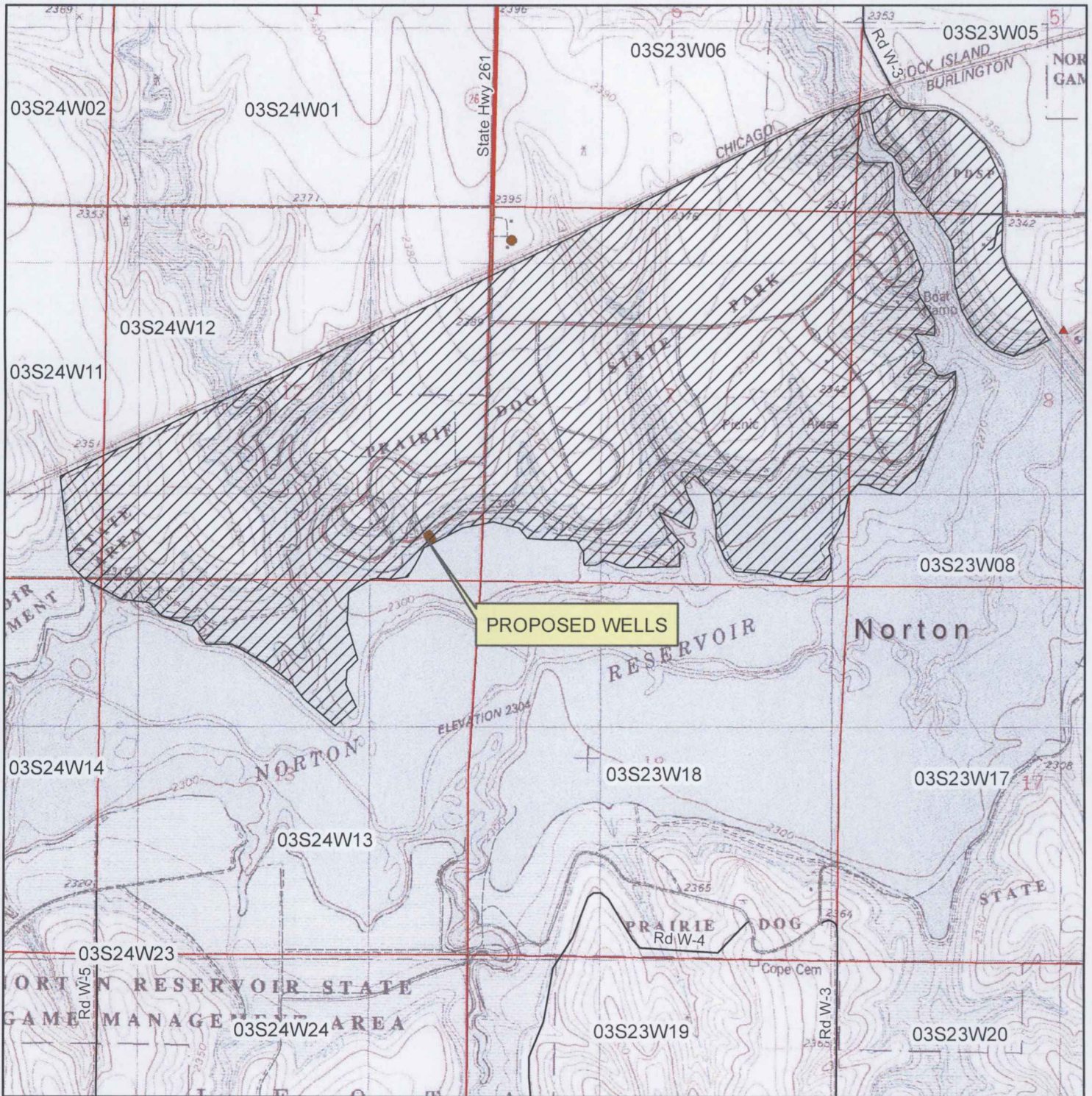

Proposed Place of Use

- ▲ Surface Water Point of Diversion
- Groundwater Point of Diversion

1:24,000

WATER RESOURCES
 RECEIVED

DEC 10 2020

KS DEPT OF AGRICULTURE

Signature Required

By signing this I am stating that to the best of my knowledge
 that all wells within 1/2 mile of proposed well location are
 identified on this map.



**MINIMUM DESIRABLE STREAMFLOW FORM TO BE USED WHEN
APPLICABLE WHEN FILING AN APPLICATION FOR PERMIT
TO APPROPRIATE WATER FOR BENEFICIAL USE**

DEC 10 2020

KS DEPT OF AGRICULTURE

The Kansas Legislature has established minimum desirable streamflows for the streams listed below. If your proposed diversion of water is going to be from one of these watercourses or adjacent alluvial aquifers, please complete the back side of this page and submit it along with your application for permit to appropriate water.

Arkansas River
Big Blue River
Chapman Creek
Chikaskia River
Cottonwood River
Delaware River
Little Arkansas River
Little Blue River
Marais des Cygnes River
Medicine Lodge River
Mill Creek (Wabaunsee Co. area)
Neosho River

Ninnescah River
North Fork Ninnescah River
Rattlesnake Creek
Republican River
Saline River
Smoky Hill River
Solomon River
South Fork Ninnescah
Spring River
Walnut River
Whitewater River

1320 Research Park Drive
Manhattan, KS 66502
785-564-6700
www. agriculture.ks.gov



900 SW Jackson, Room 456
Topeka, KS 66612
785-296-3556

Mike Beam, Secretary

Laura Kelly, Governor

December 15, 2020

KANSAS DEPARTMENT OF WILDLIFE, PARKS & TOURISM
512 SE 25TH AVE
PRATT KS 67124

RE: Application, File No(s). **50483**

Dear Sir or Madam:

The Division of Water Resources (Division) has received your application(s) for a permit to appropriate water for beneficial use. Your application(s) has been assigned the file number(s) referenced above. Please be aware that the Division may have a large number of pending applications on hand at times and makes every attempt to process them in the order in which they are received. You will be contacted if additional information is required.

Please note, this letter only acknowledges receipt of your application(s) and does not guarantee approval. In accordance with the provisions of the Kansas Water Appropriation Act, the use of water as proposed prior to approval of the application(s) is unlawful.

Additional information about the process may be found on our website at agriculture.ks.gov/divisions-programs/dwr. If you have any other questions, please contact our office at 785-564-6640 or your local Stockton Field Office at 785-425-6787. *Stockton Field Office at 785-425-6787*. If you call, please reference the file number so we can help you more efficiently.

Sincerely,

A handwritten signature in black ink that reads "Kris Neuhauser". The signature is written in a cursive, flowing style.

Kris Neuhauser
New Applications Lead
Water Appropriation Program

DATA ENTRY SYSTEM ID NUMBER SHEET

50483

FILE NUMBER _____

APPLICANT PERSON ID & SEQ #	5161	PDIV ID	BATTERY ID
40452 1	47131		

LANDOWNER PERSON ID & SEQ #	24647	PUSE ID
40452 1	26045	
	34254	

WATER USE CORRESPONDENT PERSON ID & SEQ #
40452 3