

Stockton Field Office
820 S. Walnut
Stockton, KS 67669-0192



Phone: 785-425-6787
Fax: 785-425-6842
www.agriculture.ks.gov

Mike Beam, Secretary

Laura Kelly, Governor

April 19, 2021

ROBERT L & SALLY A CLYDESDALE
26148 CENTER RD
EDMOND, KS 67645

Re: Water Rights, File Nos. 25,459; 32,081; 35,123

Dear Mr. & Mrs. Clydesdale:

Enclosed are three (3) orders executed by Earl Lewis, Chief Engineer, Division of Water Resources, Kansas Department of Agriculture, approving the applications for change under the above referenced file numbers.

Your attention is directed to the terms, conditions, and limitations specified in these approvals for change.

Since these orders modify the original certificates, they should be recorded with the Register of Deeds as other instruments affecting real estate.

These documents are summary orders by this agency regarding these matters. These orders shall become final if requests for hearings are not filed with the Chief Engineer within 15 days of the date of service of these orders.

If you have any questions, please feel free to contact this office. If you wish to refer to a specific file, please reference it when you contact us.

Sincerely,

A handwritten signature in black ink, appearing to read "Mark Billinger".

Mark Billinger
Assistant Water Commissioner

MB:rh
Enclosures

CERTIFICATE OF SERVICE

On this 19th day of April, 2021, I hereby certify that the attached **SUMMARY ORDERS APPROVING APPLICATIONS FOR CHANGE in PLACE OF USE** for water rights, File Nos. 25,459; 32,081; 35,123, dated on the 19th day of April, 2021, were mailed postage prepaid, first class, U.S. mail, to the following:

ROBERT L & SALLY A CLYDESDALE
26148 CENTER RD
EDMOND, KS 67645

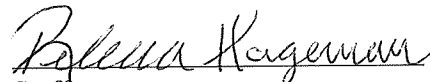
Staff

5. **Presently authorized point of diversion:**
 One in the NW Quarter of the NE Quarter of the NE Quarter of Section 15, Township 5 South, Range 23 W, in NT County, Kansas, 5220 feet North 1127 feet West of Southeast corner of section.
 Authorized Rate 400 GPM Authorized Quantity 149 AF Depth of well _____ (feet)
 (DWR use only: Computer ID No. _____ GPS _____ feet North _____ feet West)
 This point will not be changed This point will be changed as follows: No change, point better described with GPS as follows:
Proposed point of diversion: (Complete only if change is requested or if existing point is better described by GPS)
 One in the _____ Quarter of the _____ Quarter of the _____ Quarter of Section _____, Township _____ South, Range _____ (E/W), in _____ County, Kansas, _____ feet North _____ feet West of Southeast corner of section.
 Proposed Rate _____ Proposed Quantity _____ Proposed well depth (feet) _____
 This point is: Additional Well Geo Center List other water rights that will use this point _____

6. **Presently authorized point of diversion:**
 One in the _____ Quarter of the _____ Quarter of the _____ Quarter of Section _____, Township _____ South, Range _____ (E/W), in _____ County, Kansas, _____ feet North _____ feet West of Southeast corner of section.
 Authorized Rate _____ Authorized Quantity _____ Depth of well _____ (feet)
 (DWR use only: Computer ID No. _____ GPS _____ feet North _____ feet West)
 This point will not be changed This point will be changed as follows: No change, point better described with GPS as follows:
Proposed point of diversion: (Complete only if change is requested or if existing point is better described by GPS)
 One in the _____ Quarter of the _____ Quarter of the _____ Quarter of Section _____, Township _____ South, Range _____ (E/W), in _____ County, Kansas, _____ feet North _____ feet West of Southeast corner of section.
 Proposed Rate _____ Proposed Quantity _____ Proposed well depth (feet) _____
 This point is: Additional Well Geo Center List other water rights that will use this point _____

7. The changes herein are desired for the following reasons?
 (please be specific) UPDATE PLACE OF USE TO
CURRENT PIVOTS

8. If a well, is the test hole log attached? Yes No

9. The change(s) (was)(will be) completed by?
UPON APPROVAL

10. If the point of diversion is a well:
 (a) What are you going to do with the old well?
N/A
 (b) When will this be done? _____

11. Groundwater Management District recommendation attached?
 Yes No

12. Assisted by M BILLINGER

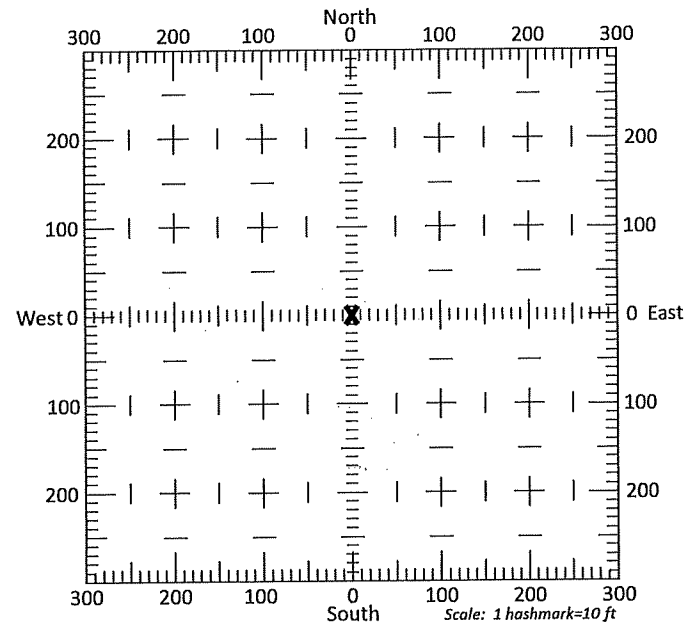

13a. If the proposed point of diversion will be relocated more than 300 feet but within 2,640 feet of the existing point of diversion, attach a topographic map or aerial photograph. For groundwater sources, show all wells (including domestic) within one-half mile of the proposed point of diversion and the names and mailing addresses of the owners. For surface water sources, show the names and addresses of the landowner(s) one-half mile downstream and one-half mile upstream from your property lines

13b. If the proposed point of diversion will be relocated within 300 feet of the existing point of diversion, indicate its location on the diagram shown above in relation to the existing point of diversion. (PLEASE NOTE: The "X" in center of diagram above represents the presently authorized point of diversion.)

14. If the proposed groundwater point of diversion is 300 or fewer feet from the existing point of diversion, complete the following:
- (a) Does the undersigned represent all owners of the currently authorized place(s) of use identified in this application?
 Yes No (If no, all owners must sign this application.)
 - (b) Will the ownership interest of any owner of the currently authorized place(s) of use identified in this application be adversely affected if this application is approved as requested?
 Yes No (If yes, all owners must sign this application.)
 - (c) If this application is not approved expeditiously, will there be substantial damage to property, public health or safety?
 Yes No (If no, all owners must sign this application.)

If the application proposes a surface water change in point of diversion, a groundwater change in point of diversion greater than 300 feet, or a change in place of use, the application must be signed by all owners of the currently authorized place of use, or their duly authorized agent (attach notarized statement authorizing representation).

I hereby verify, being first duly sworn upon my oath or affirmation and under penalty of perjury, that I am of lawful age and the owner, the spouse of the owner, or a duly authorized agent of the owner(s) to make this application on their behalf, in regards to the water right(s) to which this application pertains. I further verify that the statements contained in this application are true, correct and complete.

Dated at 4-15-21 Stockton FO, Kansas, this 15th day of April, 2021.

<u>Robert Clydesdale, Trustee</u>	
(Owner)	(Spouse)
<u>ROBERT CLYDESDALE</u>	
(Please Print)	(Please Print)
(Owner)	(Spouse)
(Please Print)	(Please Print)
(Owner)	(Spouse)
(Please Print)	(Please Print)

State of Kansas }
 County of ROCKS } SS

I hereby certify that the foregoing application was signed in my presence and sworn to before me this 15th day of April, 2021.

My Commission Expires  Rebecca F. Hageman
 Notary Public

ONLY COMPLETE APPLICATIONS WILL BE PROCESSED. To be complete, all of the applicable portions of the application form must be completed with accurate information; maps, if necessary, must be included; signatures of all the appropriate owners' must be affixed to the application and notarized; and the appropriate fee must be paid.

FEE SCHEDULE

Each application to change the place of use or the point of diversion under this section shall be accompanied by the application fee set forth in the schedule below: Make checks payable to: **Kansas Department of Agriculture**

(1) Application to change a point of diversion 300 feet or less	\$100
(2) Application to change a point of diversion more than 300 feet	\$200
(3) Application to change the place of use	\$200

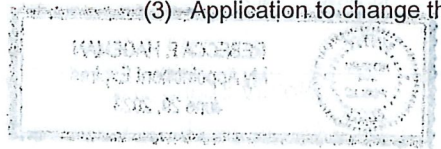

RECEIVED
APR 15 2021

SUMMARY ORDER APPROVING APPLICATION FOR CHANGE AND IMPOSING CONDITIONS

This Summary Order is issued under authority of K.S.A. 82a-708b, as amended, and K.A.R. 5-5-1, *et seq.* and other applicable provisions of the *Kansas Water Appropriation Law, K.S.A. 82a-701 et seq.*, and rules and regulations promulgated thereunder, With the exception of those conditions expressly contained herein, this Summary Order does not change the terms, conditions and limitations of File No. 25,459.

1. A change application was received on 4-15-21 requesting that the place of use and / or point of diversion authorized under the above-referenced file number be changed as described in the application.
2. On and after the effective date of this summary order, the authorized place(s) of use shall be located substantially as shown on the topographic map accompanying the application to change the place of use. Applicable Not Applicable
3. The change in point of diversion shall not impair existing rights and shall be limited to the same source or sources of water as previously authorized. The point of diversion authorized by this summary order shall be located within a _____ foot radius of the authorized point(s) of diversion. Applicable Not Applicable
4. The point(s) of diversion described herein is administratively corrected to be more accurately described using the Global Positioning System (GPS), as described in the application. Applicable Not Applicable
5. The point(s) of diversion authorized herein shall not actually be located more than _____ feet from the previously authorized point(s) of diversion. Applicable Not Applicable
6. As required by K.A.R. 5-3-5d, if the works for diversion is a well with a diversion rate of 100 gallons per minute or more, a tube or other device suitable for making water level measurements shall be installed, operated and maintained in accordance with K.A.R. 5-6-13. Applicable Not Applicable
7. **The owner of the authorized place(s) of use shall properly install an acceptable water flow meter on or before December 31, 20____, or before the first use of water, whichever occurs first.** The water flow meter shall be installed, operated and maintained in accordance with K.A.R. 5-1-4 through 5-1-12. As required by K.S.A. 82a-732, as amended, and K.A.R. 5-3-5e, the owner shall maintain records and report the reading of the water flow meter and the total quantity of water diverted annually to the Chief Engineer by March 1 following the end of each calendar year. Applicable Not Applicable
8. **Installation of the works for diversion of water shall be completed on or before December 31, 20____, or within any authorized extension of time.** By March 1, 20____ the applicant shall notify the Chief Engineer that construction of the works for diversion has been completed, on the form provided by the Chief Engineer, as required by K.A.R. 5-8-4e. Applicable Not Applicable
9. **The completed well log shall be submitted with the required notice.** Applicable Not Applicable
10. All diversion works into which any type of chemical or other foreign substance will be injected into the water shall be equipped with an in-line, automatic, quick-closing check valve capable of preventing pollution of the source of the water supply. The check valve(s) shall be installed, operated and maintained in accordance with K.A.R. 5-3-5c. Applicable Not Applicable
11. Additional Conditions are attached. Yes No
12. In accordance with K.S.A. 82a-708a, as amended, and K.A.R. 5-5-14, all of the owners of the authorized place(s) of use of water appropriated under the above-referenced file number are responsible for compliance with its terms, conditions and limitations, as amended and/or supplemented by this Summary Order, and with applicable provisions of the *Kansas Water Appropriation Law* and the *Rules and Regulations* promulgated thereunder. Failure to comply with these provisions may result in civil penalties pursuant to K.S.A. 82a-737, as amended, and/or the suspension or revocation and dismissal of the water or appropriation right or any other enforcement actions authorized by law.

Administrative Appeal and Effective Date of Order

If you are aggrieved by this order, pursuant to K.S.A. 82a-1901, you may request an evidentiary hearing before the Chief Engineer or request administrative review by the Secretary of Agriculture. A request for hearing by the Chief Engineer must be filed within **15 days** of service of this Order and a request for administrative review by the Secretary must be filed within **30 days** pursuant to K.S.A. 77-531. Any request for administrative review must state a basis for review pursuant to K.S.A. 77-527. File any request with **Kansas Department of Agriculture, Legal Division, 1320 Research Park Drive, Manhattan, KS 66502.** Failure to timely request a hearing or review may preclude review under the Kansas Judicial Review Act.

For Use by Register of Deeds

FOR OFFICE USE ONLY
APPLICATION APPROVED AND SUMMARY ORDER ISSUED

By: _____
Duly Authorized Designee of the Chief Engineer
(Print Name): MARIE BILLINGER
Division of Water Resources - Kansas Department of Agriculture
Date of Issuance: 4-19-21
State of Kansas _____)
County of ROCKS _____) SS.
Acknowledged before me on 4-19-21
by Mark Billinger
Signature: Rebecca F Hageman
Notary Public

My commission expires: 6-29-23

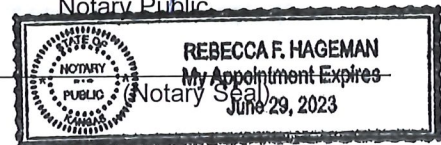

Application to Change the Place of Use
 File number 25459, 32081 & 35123
 Assisted by Division of Water Resources
 Stockton Field Office

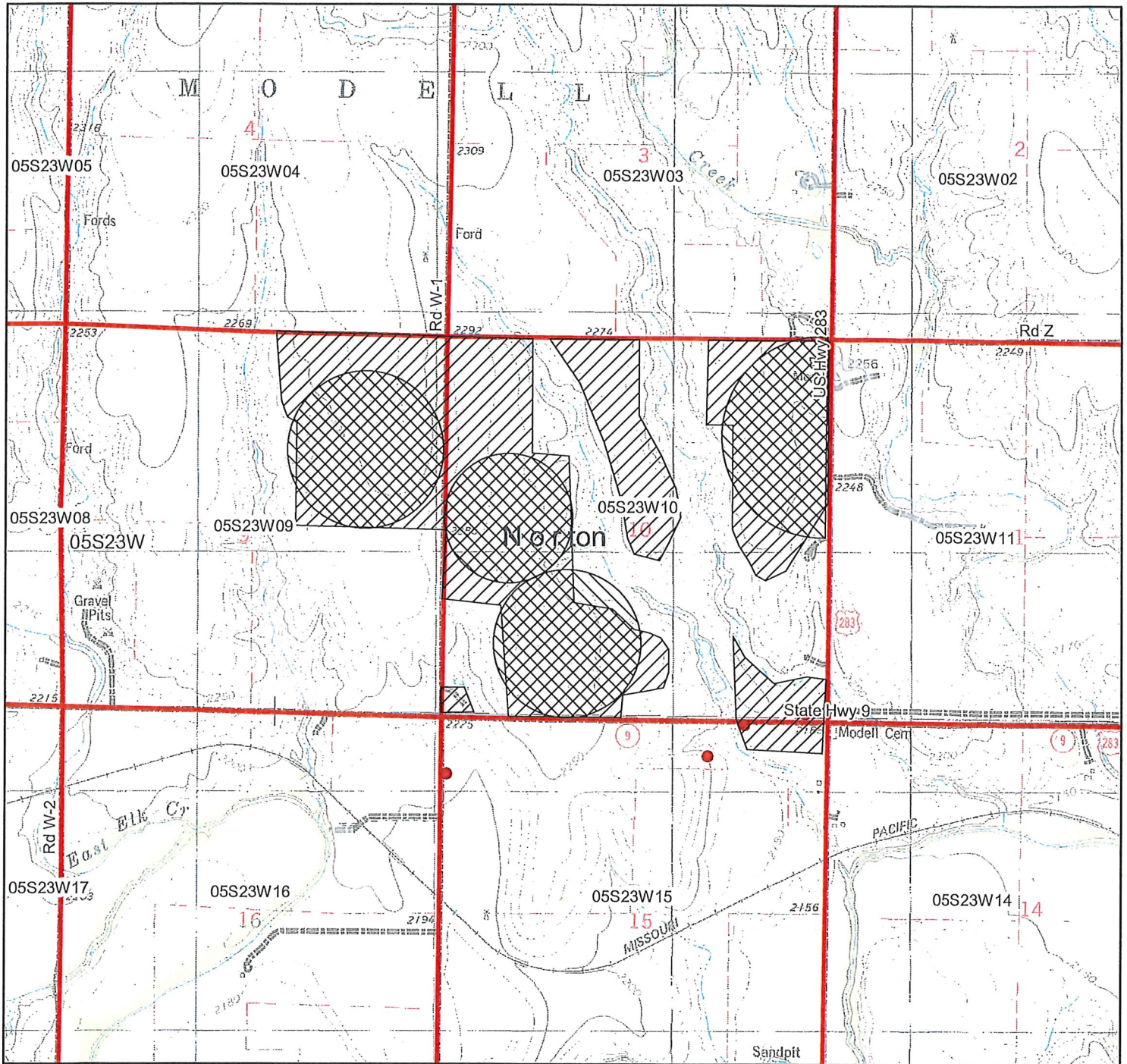

- ▲ Surface Water Point of Diversion
- Groundwater Point of Diversion

1:24,000

	Authorized Place of Use
	Proposed Place of Use



RECEIVED

APR 15 2021

Stockton Field Office
 Division of Water Resources