

NOTICE

This scan only represents the application as filed. The information contained herein meets the requirements of K.A.R. 5-3-1 or K.A.R. 5-5-1, and has been found acceptable for filing in the office of the Chief Engineer. The application should not be considered to be a complete application as per K.A.R. 5-3-1b or K.A.R. 5-5-2a.

1320 Research Park Drive
Manhattan, KS 66502
785-564-6700
www. agriculture.ks.gov



900 SW Jackson, Room 456
Topeka, KS 66612
785-296-3556

Mike Beam, Secretary

Laura Kelly, Governor

File Number **50790**
This item to be completed by the Division of Water Resources.

WATER RESOURCES
RECEIVED

MAY 16 2022

1:10

KS DEPT OF AGRICULTURE

**APPLICATION FOR PERMIT TO
APPROPRIATE WATER FOR BENEFICIAL USE**

Filing Fee Must Accompany the Application
(Please refer to Fee Schedule attached to this application form.)

To the Chief Engineer of the Division of Water Resources, Kansas Department of Agriculture,
1320 Research Park Drive, Manhattan, Kansas 66502:

1. Name of Applicant (Please Print): JEFF ROME
Address: 906 BRAZOS DR
City: SOUTHLAKE State TX Zip Code 76092
Telephone Number: (305) 522-6300

2. The source of water is: surface water in SALINE RIVER (stream)
OR groundwater in SALINE (drainage basin)

Certain streams in Kansas have minimum target flows established by law or may be subject to administration when water is released from storage for use by water assurance district members. If your application is subject to these regulations on the date we receive your application, you will be sent the appropriate form to complete and return to the Division of Water Resources.

3. The maximum quantity of water desired is 425 acre-feet OR _____ gallons per calendar year, to be diverted at a maximum rate of 2000 gallons per minute OR _____ cubic feet per second.

Once your application has been assigned a priority, the requested maximum rate of diversion and maximum requested quantity of water under that priority number can **NOT** be increased. Please be certain your requested maximum rate of diversion and maximum quantity of water are appropriate and reasonable for your proposed project and are in agreement with the Division of Water Resources' requirements.

4. The water is intended to be appropriated for (Check use intended):
(a) Artificial Recharge (b) Irrigation (c) Recreational (d) Water Power
(e) Industrial (f) Municipal (g) Stockwatering (h) Sediment Control
(i) Domestic (j) Dewatering (k) Hydraulic Dredging (l) Fire Protection
(m) Thermal Exchange (n) Contamination Remediation

YOU **MUST** COMPLETE AND ATTACH ADDITIONAL DIVISION OF WATER RESOURCES FORM(S) PROVIDING INFORMATION TO SUBSTANTIATE YOUR REQUEST FOR THE AMOUNT OF WATER FOR THE INTENDED USE REFERENCED ABOVE.

For Office Use Only:
F.O. 3 GMD _____ Meets K.A.R. 5-3-1 (YES) / (NO) Use IRR Source G/S County RS By bMM Date 5/16/22
Code RE3 Fee \$ 340 TR # _____ Receipt Date 5-16-22 Check # 2204

5/18/2022
LMoody

5. The location of the proposed wells, pump sites or other works for diversion of water is:

Note: For the application to be accepted, the point of diversion location must be described to at least a 10 acre tract, unless you specifically request a 60 day period of time in which to locate the site within a specifically described, minimal legal quarter section of land.

(A) One in the SE quarter of the SE quarter of the SW quarter of Section 33, more particularly described as being near a point 411 feet North and 2658 feet West of the Southeast corner of said section, in Township 12 South, Range 14 WEST, RUSSELL County, Kansas.

(B) One in the _____ quarter of the _____ quarter of the _____ quarter of Section _____, more particularly described as being near a point _____ feet North and _____ feet West of the Southeast corner of said section, in Township _____ South, Range _____ East/West (circle one), _____ County, Kansas.

(C) One in the _____ quarter of the _____ quarter of the _____ quarter of Section _____, more particularly described as being near a point _____ feet North and _____ feet West of the Southeast corner of said section, in Township _____ South, Range _____ East/West (circle one), _____ County, Kansas.

(D) One in the _____ quarter of the _____ quarter of the _____ quarter of Section _____, more particularly described as being near a point _____ feet North and _____ feet West of the Southeast corner of said section, in Township _____ South, Range _____ East/West (circle one), _____ County, Kansas.

If the source of supply is groundwater, a separate application shall be filed for each proposed well or battery of wells, except that a single application may include up to four wells within a circle with a quarter (1/4) mile radius in the same local source of supply which do not exceed a maximum diversion rate of 20 gallons per minute per well.

A battery of wells is defined as two or more wells connected to a common pump by a manifold; or not more than four wells in the same local source of supply within a 300 foot radius circle which are being operated by pumps not to exceed a total maximum diversion rate of 800 gallons per minute and which supply water to a common distribution system.

6. The owner of the point of diversion, if other than the applicant is (please print):

(name, address and telephone number)

(name, address and telephone number)

You must provide evidence of legal access to, or control of, the point of diversion from the landowner or the landowner's authorized representative. Provide a copy of a recorded deed, lease, easement or other document with this application. In lieu thereof, you may sign the following sworn statement:

I have legal access to, or control of, the point of diversion described in this application from the landowner or the landowner's authorized representative. I declare under penalty of perjury that the foregoing is true and correct.

Executed on May 13, 2022. _____
Applicant's Signature

The applicant must provide the required information or signature irrespective of whether they are the landowner. Failure to complete this portion of the application will cause it to be unacceptable for filing and the application will be returned to the applicant.

7. The proposed project for diversion of water will consist of ONE SURFACE WATER DIVERSION
(number of wells, pumps or dams, etc.)
and WILL BE completed (by) 12/31/23
(Month/Day/Year - each was or will be completed)

8. The first actual application of water for the proposed beneficial use was or is estimated to be 2023
(Mo/Day/Year)

- 9. Will pesticide, fertilizer, or other foreign substance be injected into the water pumped from the diversion works?
 Yes No If "yes", a check valve shall be required.

All chemigation safety requirements must be met including a chemigation permit and reporting requirements.

- 10. If you are planning to impound water, please contact the Division of Water Resources for assistance, prior to submitting the application. Please attach a reservoir area capacity table and inform us of the total acres of surface drainage area above the reservoir.

Have you also made an application for a permit for construction of this dam and reservoir with the Division of Water Resources? Yes No

- If yes, show the Water Structures permit number here N/A
- If no, explain here why a Water Structures permit is not required _____

- 11. The application must be supplemented by a U.S.G.S. topographic map, aerial photograph or a detailed plat showing the following information. On the topographic map, aerial photograph, or plat, identify the center of the section, the section lines or the section corners and show the appropriate section, township and range numbers. Also, please show the following information:

- (a) The location of the proposed point(s) of diversion (wells, stream-bank installations, dams, or other diversion works) should be plotted as described in Paragraph No. 5 of the application, showing the North-South distance and the East-West distance from a section line or southeast corner of section.
- (b) If the application is for groundwater, please show the location of any existing water wells of any kind within 1/2 mile of the proposed well or wells. Identify each existing well as to its use and furnish the name and mailing address of the property owner or owners. If there are no wells within 1/2 mile, please advise us.
- (c) If the application is for surface water, the names and addresses of the landowner(s) 1/2 mile downstream and 1/2 mile upstream from your property lines must be shown.
- (d) The location of the proposed place of use should be shown by crosshatching on the topographic map, aerial photograph or plat.
- (e) Show the location of the pipelines, canals, reservoirs or other facilities for conveying water from the point of diversion to the place of use.

A 7.5 minute U.S.G.S. topographic map may be obtained by providing the section, township and range numbers to: Kansas Geological Survey, 1930 Constant, Campus West, University of Kansas, Lawrence, Kansas 66047.

- 12. List any application, appropriation of water, water right, or vested right file number that covers the same diversion points or any of the same place of use described in this application. Also list any other recent modifications made to existing permits or water rights in conjunction with the filing of this application.

THIS APPLICATION WITH OVERLAP IN PLACE OF USE WITH THE ACCOMPANYING GROUND
WATER APPLICATION FILED CONCURRENTLY. _____

WATER RESOURCES
RECEIVED

MAY 16 2022

KS DEPT OF AGRICULTURE

13. Furnish the following well information if the proposed appropriation is for the use of groundwater. If the well has not been completed, give information obtained from test holes, if available.

Information below is from: Test holes Well as completed Drillers log attached

Well location as shown in paragraph No.	(A)	(B)	(C)	(D)
Date Drilled	_____	_____	_____	_____
Total depth of well	_____	_____	_____	_____
Depth to water bearing formation	_____	_____	_____	_____
Depth to static water level	_____	_____	_____	_____
Depth to bottom of pump intake pipe	_____	_____	_____	_____

14. The relationship of the applicant to the proposed place where the water will be used is that of

OWNER
(owner, tenant, agent or otherwise)

15. The owner(s) of the property where the water is used, if other than the applicant, is (please print):

(name, address and telephone number)

(name, address and telephone number)

16. The undersigned states that the information set forth above is true to the best of his/her knowledge and that this application is submitted in good faith.

Dated at 906 Brazos Dr, Southlake TX 76092, Kansas, this 13 day of May, 2022.
(month) (year)

[Signature]
(Applicant Signature)

By _____
(Agent or Officer Signature)

(Agent or Officer - Please Print)

Assisted by M. BILLINGER ASST WC Date: 5/6/22
(office/title)

FEE SCHEDULE

1. The fee for an application for a permit to appropriate water for beneficial use, except for domestic use, shall be (see paragraph No. 2 below if requesting storage):

ACRE-FEET	FEE
0-100	\$200.00
101-320	\$300.00
More than 320	\$300.00 plus \$20.00 for each additional 100 acre-feet or any part thereof.

2. The fee for an application in which storage is requested, except for domestic use, shall be:

ACRE-FEET	FEE
0-250	\$200.00
More than 250	\$200.00 plus \$20.00 for each additional 250 acre-feet of storage or any part thereof.

Note: If an application requests both direct use *and* storage, the fee charged shall be as determined under No. 1 or No. 2 above, whichever is greater, but not both fees.

3. The fee for an application for a permit to appropriate water for water power or dewatering purposes shall be \$100.00 plus \$200.00 for each 100 cubic feet per second, or part thereof, of the diversion rate requested.

Note: The applicant shall notify the Chief Engineer and pay the statutorily required field inspection fee of \$400.00 when construction of the works for diversion has been completed, except that for applications filed on or after July 1, 2009, for works constructed for sediment control use and for evaporation from a groundwater pit for industrial use shall be accompanied by a field inspection fee of \$200.00.

MAKE CHECKS PAYABLE TO THE KANSAS DEPARTMENT OF AGRICULTURE

ATTENTION

A Water Conservation Plan may be required per K.S.A. 82a-733. A statement that your application for permit to appropriate water may be subject to the minimum desirable streamflow requirements per K.S.A. 82a-703a, b, and c may also be required from you. After the Division of Water Resources has had the opportunity to review your application, you will be notified whether or not you will need to submit a Water Conservation Plan. You also may be required to install a water flow meter or water stage measuring device on your diversion works prior to diverting water. There may be other special conditions or Groundwater Management District regulations that you will need to comply with if this application is approved.

CONVERSION FACTORS

1 acre-foot equals 325,851 gallons

1 million gallons equal 3.07 acre-feet

**WATER RESOURCES
RECEIVED
MAY 16 2022
KS DEPT OF AGRICULTURE**

IRRIGATION USE SUPPLEMENTAL SHEET

File No. _____

Name of Applicant (Please Print): JEFF ROME

1. Please supply the name and address of each landowner, the legal description of the lands to be irrigated, and designate the actual number of acres to be irrigated in each forty acre tract or fractional portion thereof:

Landowner of Record NAME: JEFFERY L ROME

ADDRESS: 906 BRAZOS DR SOUTHLAKE, TX 76092

S	T	R	NE¼				NW¼				SW¼				SE¼				TOTAL
			NE	NW	SW	SE	NE	NW	SW	SE	NE	NW	SW	SE	NE	NW	SW	SE	
33	12S	14W	4.5	0.5	30.5	34			12	14	40	40	27.5	19	32	40	9	0.5	303.5

Landowner of Record NAME: _____

ADDRESS: _____

S	T	R	NE¼				NW¼				SW¼				SE¼				TOTAL
			NE	NW	SW	SE	NE	NW	SW	SE	NE	NW	SW	SE	NE	NW	SW	SE	

Landowner of Record NAME: _____

ADDRESS: _____

S	T	R	NE¼				NW¼				SW¼				SE¼				TOTAL
			NE	NW	SW	SE	NE	NW	SW	SE	NE	NW	SW	SE	NE	NW	SW	SE	

WATER RESOURCES
RECEIVED

MAY 16 2023
Page 1 of 2

KS DEPT OF AGRICULTURE

2. Please complete the following information for the description of the operation for the irrigation project. Attach supplemental sheets as needed.

a. Indicate the soils in the field(s) and their intake rates:

Soil Name	Percent of field (%)	Intake Rate (in/hr)	Irrigation Design Group
_____	_____	_____	_____
_____	_____	_____	_____
_____	_____	_____	_____
_____	_____	_____	_____
Total:	100 %		

b. Estimate the average land slope in the field(s): _____%

Estimate the maximum land slope in the field(s): _____%

c. Type of irrigation system you propose to use (check one):

- Center pivot _____ Center pivot - LEPA _____ "Big gun" sprinkler
 _____ Gravity system (furrows) _____ Gravity system (borders) _____ Sideroll sprinkler

Other, please describe: _____

d. System design features:

i. Describe how you will control tailwater: IRRIGATION SCHEDULING

ii. For sprinkler systems:

(1) Estimate the operating pressure at the distribution system: 35 _____ psi

(2) What is the sprinkler package design rate? 800 _____ gpm

(3) What is the wetted diameter (twice the distance the sprinkler throws water) of a sprinkler on the outer 100 feet of the system? _____ feet

(4) Please include a copy of the sprinkler package design information.

e. Crop(s) you intend to irrigate. Please note any planned crop rotations: CORN, SOYBEANS, ALFALFA, WHEAT, SORGHUM

f. Please describe how you will determine when to irrigate and how much water to apply (particularly important if you do not plan a full irrigation). SOIL MOISTURE

You may attach any additional information you believe will assist in informing the Division of the need for your request.

Jeff Rome surface water application:

Nearby landowners (within ½ mile upstream & downstream of property)

BIG CANYON RANCH LLC

4769 183RD ST

RUSSELL, KS 67665

DOROTHY HOPPER

535 E 4TH ST

RUSSELL, KS 67665-2201

WILLIAM & DANA L STOUGHTON

4839 184TH ST

RUSSELL, KS 67665-8764

GERALD L MACHIN

4746 184TH BLVD

RUSSELL, KS 67665

WATER RESOURCES
RECEIVED
MAY 16 2022
KS DEPT OF AGRICULTURE

New Application - Surface Water
 Assisted by Division of Water Resources
 Stockton Field Office

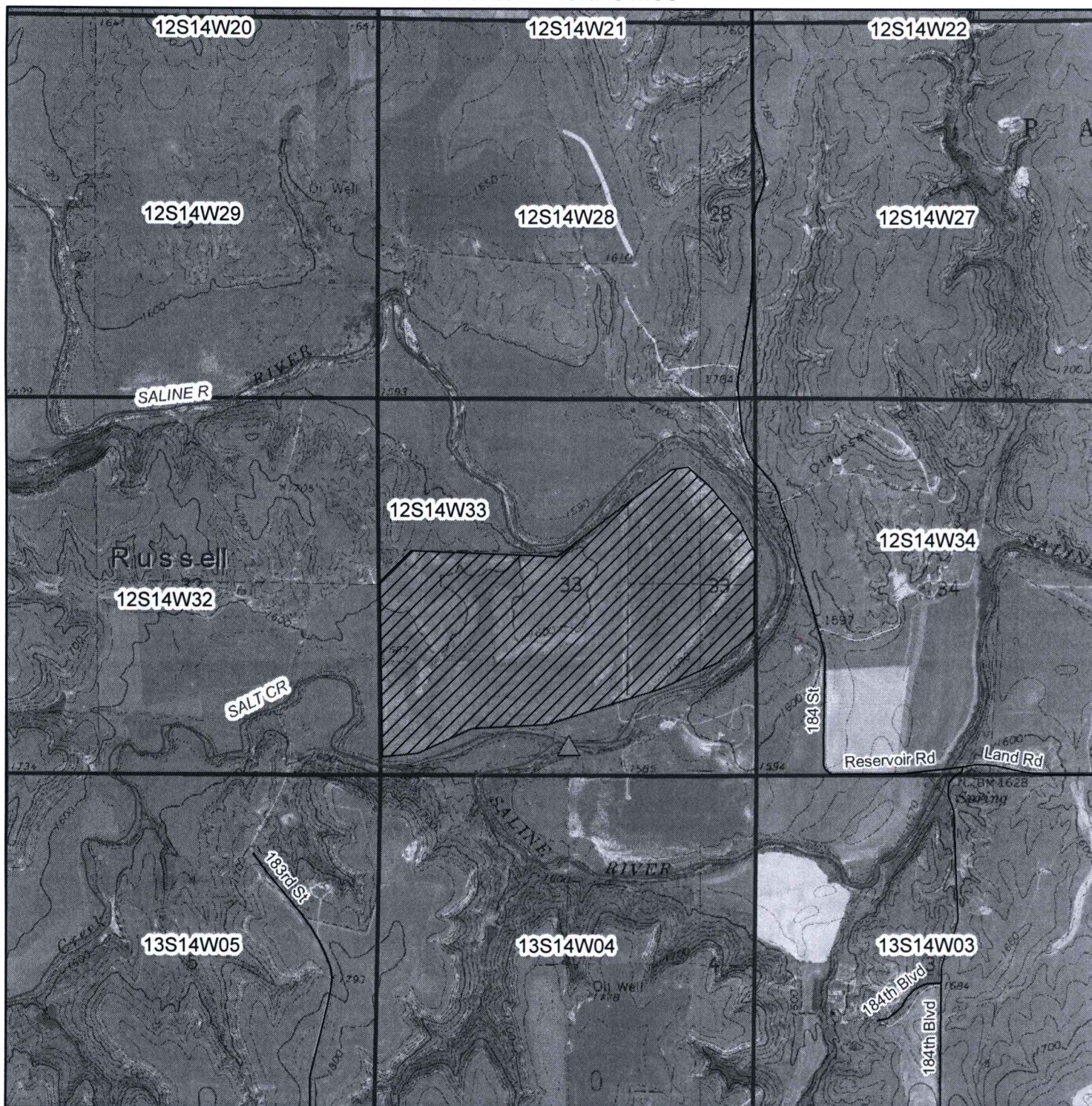

Proposed Place of Use



Surface Water Point of Diversion



Groundwater Point of Diversion



Proposed Point of Diversion

Signature Required

[Handwritten Signature]

By signing this I am stating that to the best of my knowledge that all landowners within 1/2 mile of upstream and downstream of property boundaries are identified on this map (see attached).

WATER RESOURCES RECEIVED

MAY 16 2022

KS DEPT OF AGRICULTURE



(Date)

Kansas Department of Agriculture
Division of Water Resources
Earl D. Lewis, Jr., Chief Engineer
1320 Research Park Drive
Manhattan, Kansas 66502

Re: Application
File No. _____

Minimum Desirable Streamflow

I understand that a Minimum Desirable Streamflow requirement has been established by the legislature for the source of supply to which the above referenced application applies.

I understand that diversion of water pursuant to this application will be subject to regulation any time Minimum Desirable Streamflow requirements are not being met.

I also understand that if this application is approved, there could be times, as determined by the Division of Water Resources, when I would not be allowed to divert water. I realize that this could affect the economics of my decision to appropriate water.

I am aware of the above factors, and with the knowledge thereof, request that the Division of Water Resources proceed with processing and approval, if possible, of the above referenced application.

Jeff Rome

Signature of Applicant

State of Kansas)
County of Ellis) ss

Jeffrey L Rome

(Print Applicant's Name)

I hereby certify that the foregoing instrument was signed in my presence and sworn to before me this 12 day of May, 2022.

Janel Younger

Notary Public

My Commission Expires:



WATER RESOURCES
RECEIVED
MAY 16 2022
KS DEPT OF AGRICULTURE

**MINIMUM DESIRABLE STREAMFLOW FORM TO BE USED WHEN
APPLICABLE WHEN FILING AN APPLICATION FOR PERMIT
TO APPROPRIATE WATER FOR BENEFICIAL USE**

The Kansas Legislature has established minimum desirable streamflows for the streams listed below. If your proposed diversion of water is going to be from one of these watercourses or adjacent alluvial aquifers, please complete the back side of this page and submit it along with your application for permit to appropriate water.

Arkansas River
Big Blue River
Chapman Creek
Chikaskia River
Cottonwood River
Delaware River
Little Arkansas River
Little Blue River
Marais des Cygnes River
Medicine Lodge River
Mill Creek (Wabaunsee Co. area)
Neosho River

Ninnescah River
North Fork Ninnescah River
Rattlesnake Creek
Republican River
Saline River
Smoky Hill River
Solomon River
South Fork Ninnescah
Spring River
Walnut River
Whitewater River

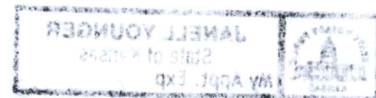



State of Kansas, Russell County
This instrument filed for Record
04/20/2022 at 02:30 PM
Book: 146 Page(s) 915-916
Fees: \$38.00

ELIZABETH GIMORE

JOINT TENANCY GENERAL WARRANTY DEED

THIS DEED, made this 20th day of April, 2022, between **Christopher L. Brungardt and Kathleen A. Brungardt, his wife**, of Hays, Ellis County, Kansas, parties of the first part, and **Jeffery L. Rome, a/k/a Jeffery Lynn Rome, and Maria Del Pilar Pava, as joint tenants with right of survivorship and not as tenants in common**, of Tarrant County, in the State of Texas, parties of the second part:

WITNESSETH, that said parties of the first part, in consideration of One Dollar (\$1) and other good and valuable consideration, the receipt whereof is hereby acknowledged, do by these presents, grant, bargain, sell and convey unto said parties of the second part and the survivor of them all the following described REAL ESTATE, situated in the County of Russell and State of Kansas, to-wit:

All of Section Thirty-three (33), Township Twelve (12) South, Range Fourteen (14) West of the 6th P.M., Russell County, Kansas,
Computer ✓
Numerical 14
Misc. _____

SUBJECT TO the rights of the farm tenant now in possession, easements, rights of way, oil and gas leases, mineral reservations and restrictions as may appear of record;

TO HAVE AND TO HOLD THE SAME, together with all and singular the tenements, hereditaments and appurtenances thereunto belonging or in anywise appertaining, forever, as joint tenants, the survivor to take the whole estate.

And said grantors, for themselves, their heirs, executors and administrators, do hereby covenant, promise and agree, to and with said parties of the second part that at the delivery of these presents they are lawfully seized in their own right of an absolute and indefeasible estate of inheritance, in fee simple, of and in all and singular the above granted and described premises, with the appurtenances; that the same are free, clear, discharged and unencumbered of and from all former and other grants, titles, charges, estates, judgments, taxes, assessments and encumbrances, of what nature or kind soever;

146 915

WATER RESOURCES RECEIVED
MAY 16 2022
KS DEPT OF AGRICULTURE

and that they will WARRANT AND FOREVER DEFEND the same unto said parties of the second part and the survivor of them against said parties of the first part, their heirs, and all and every person or persons whomsoever lawfully claiming or to claim the same.

IN WITNESS WHEREOF, the said parties of the first part have hereunto set their hands the day and year first above written.

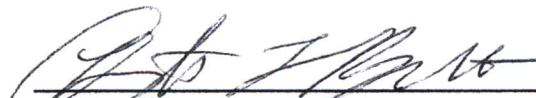

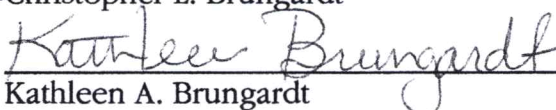
Christopher L. Brungardt

Kathleen A. Brungardt

ACKNOWLEDGMENT

STATE OF KANSAS, COUNTY OF Russell, SS.

The foregoing instrument was acknowledged before me this 20th day of April, 2022, by Christopher L. Brungardt and Kathleen A. Brungardt, his wife.

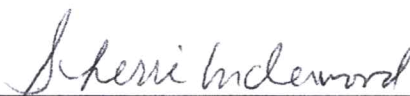
My appointment expires: 10/30/2024 

Notary Public

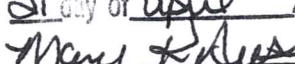

State of Kansas, Russell County, SS
Instrument in Transfer Record this
21 day of April 2022

County Clerk

146 916

WATER RESOURCES
RECEIVED
MAY 16 2022
KS DEPT OF AGRICULTURE

DATA ENTRY SYSTEM ID NUMBER SHEET

FILE NUMBER 50790

APPLICANT PERSON ID & SEQ #	PDIV ID	BATTERY ID
<u>68391</u>	<u>89539</u>	

LANDOWNER PERSON ID & SEQ #	PUSE ID
<u>68391</u>	<u>70861</u>

WATER USE CORRESPONDENT PERSON ID & SEQ #
<u>68391</u>