

NOTICE

This scan only represents the application as filed. The information contained herein meets the requirements of K.A.R. 5-3-1 or K.A.R. 5-5-1, and has been found acceptable for filing in the office of the Chief Engineer. The application should not be considered to be a complete application as per K.A.R. 5-3-1b or K.A.R. 5-5-2a.

1320 Research Park Drive
Manhattan, KS 66502
785-564-6700
www. agriculture.ks.gov

Kansas

Department of Agriculture

Water Resources
Received

900 SW Jackson, Room 456
KS Dept Of Agriculture Topeka, KS 66612
785-296-3556

Mike Beam, Secretary

Laura Kelly, Governor

50934

File Number _____

This item to be completed by the Division of Water Resources.

APPLICATION FOR PERMIT TO APPROPRIATE WATER FOR BENEFICIAL USE

Filing Fee Must Accompany the Application
(Please refer to Fee Schedule attached to this application form.)

To the Chief Engineer of the Division of Water Resources, Kansas Department of Agriculture,
1320 Research Park Drive, Manhattan, Kansas 66502:

1. Name of Applicant (Please Print): Gale A Walz ROBERT WALZ
Address: 445 RS 877
City: St. Francis State KS. Zip Code 67756
Telephone Number: (785) 332-8212

2. The source of water is: surface water in _____ (stream)
OR groundwater in S.F. Republican River (drainage basin)

Certain streams in Kansas have minimum target flows established by law or may be subject to administration when water is released from storage for use by water assurance district members. If your application is subject to these regulations on the date we receive your application, you will be sent the appropriate form to complete and return to the Division of Water Resources.

3. The maximum quantity of water desired is 15 acre-feet OR _____ gallons per calendar year, to be diverted at a maximum rate of N.E. gallons per minute OR _____ cubic feet per second.

Once your application has been assigned a priority, the requested maximum rate of diversion and maximum requested quantity of water under that priority number can **NOT** be increased. Please be certain your requested maximum rate of diversion and maximum quantity of water are appropriate and reasonable for your proposed project and are in agreement with the Division of Water Resources' requirements.

4. The water is intended to be appropriated for (Check use intended):
(a) Artificial Recharge (b) Irrigation (c) Recreational (d) Water Power
(e) Industrial (f) Municipal (g) Stockwatering (h) Sediment Control
(i) Domestic (j) Dewatering (k) Hydraulic Dredging (l) Fire Protection
(m) Thermal Exchange (n) Contamination Remediation

YOU **MUST** COMPLETE AND ATTACH ADDITIONAL DIVISION OF WATER RESOURCES FORM(S) PROVIDING INFORMATION TO SUBSTANTIATE YOUR REQUEST FOR THE AMOUNT OF WATER FOR THE INTENDED USE REFERENCED ABOVE.

For Office Use Only:								
F.O. <u>3</u>	GMD <u>4</u>	Meets K.A.R. 5-3-1 (YES/NO)	Use <u>IND</u>	Source <u>G/S</u>	County <u>CN</u>	By <u>ALB</u>	Date <u>12/30/22</u>	
Code <u>REG</u>	Fee \$ <u>200.00</u>	TR # <u>PY00050730</u>	Receipt Date <u>12/29/2022</u>	Check # _____				

1/4/2023
LMoody

5. The location of the proposed wells, pump sites or other works for diversion of water is:

Note: For the application to be accepted, the point of diversion location must be described to at least a 10 acre tract, unless you specifically request a 60 day period of time in which to locate the site within a specifically described, minimal legal quarter section of land.

(A) One in the SE quarter of the NE quarter of the NW quarter of Section 25, more particularly described as being near a point 4100 feet North and 2980 feet West of the Southeast corner of said section, in Township 4 South, Range 42 WEST, Cheyenne County, Kansas.

(B) One in the _____ quarter of the _____ quarter of the _____ quarter of Section _____, more particularly described as being near a point _____ feet North and _____ feet West of the Southeast corner of said section, in Township _____ South, Range _____ East/West (circle one), _____ County, Kansas.

(C) One in the _____ quarter of the _____ quarter of the _____ quarter of Section _____, more particularly described as being near a point _____ feet North and _____ feet West of the Southeast corner of said section, in Township _____ South, Range _____ East/West (circle one), _____ County, Kansas.

(D) One in the _____ quarter of the _____ quarter of the _____ quarter of Section _____, more particularly described as being near a point _____ feet North and _____ feet West of the Southeast corner of said section, in Township _____ South, Range _____ East/West (circle one), _____ County, Kansas.

If the source of supply is groundwater, a separate application shall be filed for each proposed well or battery of wells, except that a single application may include up to four wells within a circle with a quarter (1/4) mile radius in the same local source of supply which do not exceed a maximum diversion rate of 20 gallons per minute per well.

A battery of wells is defined as two or more wells connected to a common pump by a manifold; or not more than four wells in the same local source of supply within a 300 foot radius circle which are being operated by pumps not to exceed a total maximum diversion rate of 800 gallons per minute and which supply water to a common distribution system.

6. The owner of the point of diversion, if other than the applicant is (please print):

Same as applicant

(name, address and telephone number)

(name, address and telephone number)

You must provide evidence of legal access to, or control of, the point of diversion from the landowner or the landowner's authorized representative. Provide a copy of a recorded deed, lease, easement or other document with this application. In lieu thereof, you may sign the following sworn statement:

I have legal access to, or control of, the point of diversion described in this application from the landowner or the landowner's authorized representative. I declare under penalty of perjury that the foregoing is true and correct.

Executed on Dec 28, 2022 _____
Applicant's Signature

The applicant must provide the required information or signature irrespective of whether they are the landowner.
Failure to complete this portion of the application will cause it to be unacceptable for filing and the application will be returned to the applicant.

7. The proposed project for diversion of water will consist of 1 groundwater pit
(number of wells, pumps or dams, etc.)
and WILL completed (by) pit will be opened up as soon as application is approved.
(Month/Day/Year - each was or will be completed)

8. The first actual application of water for the proposed beneficial use was or is estimated to be 2023
(Mo/Day/Year)

9. Will pesticide, fertilizer, or other foreign substance be injected into the water pumped from the diversion works?
 Yes No If "yes", a check valve shall be required.

All chemigation safety requirements must be met including a chemigation permit and reporting requirements.

10. If you are planning to impound water, please contact the Division of Water Resources for assistance, prior to submitting the application. Please attach a reservoir area capacity table and inform us of the total acres of surface drainage area above the reservoir.

Have you also made an application for a permit for construction of this dam and reservoir with the Division of Water Resources? Yes No

- If yes, show the Water Structures permit number here _____
- If no, explain here why a Water Structures permit is not required _____

11. The application must be supplemented by a U.S.G.S. topographic map, aerial photograph or a detailed plat showing the following information. On the topographic map, aerial photograph, or plat, identify the center of the section, the section lines or the section corners and show the appropriate section, township and range numbers. Also, please show the following information:

- (a) The location of the proposed point(s) of diversion (wells, stream-bank installations, dams, or other diversion works) should be plotted as described in Paragraph No. 5 of the application, showing the North-South distance and the East-West distance from a section line or southeast corner of section.
- (b) If the application is for groundwater, please show the location of any existing water wells of any kind within ½ mile of the proposed well or wells. Identify each existing well as to its use and furnish the name and mailing address of the property owner or owners. If there are no wells within ½ mile, please advise us.
- (c) If the application is for surface water, the names and addresses of the landowner(s) ½ mile downstream and ½ mile upstream from your property lines must be shown.
- (d) The location of the proposed place of use should be shown by crosshatching on the topographic map, aerial photograph or plat.
- (e) Show the location of the pipelines, canals, reservoirs or other facilities for conveying water from the point of diversion to the place of use.

A 7.5 minute U.S.G.S. topographic map may be obtained by providing the section, township and range numbers to: Kansas Geological Survey, 1930 Constant, Campus West, University of Kansas, Lawrence, Kansas 66047.

12. List any application, appropriation of water, water right, or vested right file number that covers the same diversion points or any of the same place of use described in this application. Also list any other recent modifications made to existing permits or water rights in conjunction with the filing of this application.

No other water rights involved with this application. This application is requesting a 15 acre-foot exemption to safe-yield. The proposed 4.7 acre groundwater pit would evaporate 15 acre-feet per calendar year.

Note: this 4.7 acre pit will be located approximately in the East Half of the East Half of the Northwest Quarter. The actual location will be determined as the pit is developed.

13. Furnish the following well information if the proposed appropriation is for the use of groundwater. If the well has not been completed, give information obtained from test holes, if available.

Information below is from: Test holes Well as completed Drillers log attached

Well location as shown in paragraph No.	(A)	(B)	(C)	(D)
Date Drilled	_____	_____	_____	_____
Total depth of well	_____	_____	_____	_____
Depth to water bearing formation	_____	_____	_____	_____
Depth to static water level	_____	_____	_____	_____
Depth to bottom of pump intake pipe	_____	_____	_____	_____

14. The relationship of the applicant to the proposed place where the water will be used is that of

Owner
(owner, tenant, agent or otherwise)

15. The owner(s) of the property where the water is used, if other than the applicant, is (please print):

(name, address and telephone number)

(name, address and telephone number)

16. The undersigned states that the information set forth above is true to the best of his/her knowledge and that this application is submitted in good faith.

Dated at ST. FRANCIS, Kansas, this 28 day of DECEMBER 2022
(month) (year)



(Applicant Signature)

By _____
(Agent or Officer Signature)

(Agent or Officer - Please Print)

FEE SCHEDULE

1. The fee for an application for a permit to appropriate water for beneficial use, except for domestic use, shall be (see paragraph No. 2 below if requesting storage):

ACRE-FEET	FEE
0-100	\$200.00
101-320	\$300.00
More than 320	\$300.00 plus \$20.00 for each additional 100 acre-feet or any part thereof.

2. The fee for an application in which storage is requested, except for domestic use, shall be:

ACRE-FEET	FEE
0-250	\$200.00
More than 250	\$200.00 plus \$20.00 for each additional 250 acre-feet of storage or any part thereof.

Note: If an application requests both direct use *and* storage, the fee charged shall be as determined under No. 1 or No. 2 above, whichever is greater, but not both fees.

3. The fee for an application for a permit to appropriate water for water power or dewatering purposes shall be \$100.00 plus \$200.00 for each 100 cubic feet per second, or part thereof, of the diversion rate requested.

Note: The applicant shall notify the Chief Engineer and pay the statutorily required field inspection fee of \$400.00 when construction of the works for diversion has been completed, except that for applications filed on or after July 1, 2009, for works constructed for sediment control use and for evaporation from a groundwater pit for industrial use shall be accompanied by a field inspection fee of \$200.00.

MAKE CHECKS PAYABLE TO THE KANSAS DEPARTMENT OF AGRICULTURE

ATTENTION

A Water Conservation Plan may be required per K.S.A. 82a-733. A statement that your application for permit to appropriate water may be subject to the minimum desirable streamflow requirements per K.S.A. 82a-703a, b, and c may also be required from you. After the Division of Water Resources has had the opportunity to review your application, you will be notified whether or not you will need to submit a Water Conservation Plan. You also may be required to install a water flow meter or water stage measuring device on your diversion works prior to diverting water. There may be other special conditions or Groundwater Management District regulations that you will need to comply with if this application is approved.

CONVERSION FACTORS

1 acre-foot equals 325,851 gallons

1 million gallons equal 3.07 acre-feet

INDUSTRIAL USE SUPPLEMENTAL SHEET

File No. _____

Name of Applicant (Please Print): ~~Gale A. Walz~~ **ROBERT WALZ**

- Please describe type of industry or product produced: sand & gravel production
 _____ Standard Industrial Classification Code Number: _____
- Please complete the following table to show your past and present water requirements:

PAST PRODUCT PRODUCTION AND WATER DIVERTED, IF APPLICABLE

LAST 5 YEARS	AMOUNT OF PRODUCT	WATER DIVERTED (GALLONS)	GALLONS PER PRODUCT PER DAY
5 years ago			
Last year			
Present year	0		

- Please complete the following table to show your future water requirements:

ESTIMATED FUTURE PRODUCT PRODUCTION AND WATER DIVERTED

NEXT 5 YEARS	AMOUNT OF PRODUCT	WATER TO BE DIVERTED (GALLONS)	GALLONS PER PRODUCT PER DAY
Year 1	0		
Year 2			
Year 3			
Year 4			
Year 5	4.7 acres exposed	4,887,765 gallons	39" evaporation per acre

Number of days of operation of the industry per year is _____ days.

Please attach any tables, curves or additional information showing past, present and estimated future water requirements to substantiate the amount of water requested.

- Please designate the legal description of the location where the water is to be used. Show in the space provided below the Section (S), Township (T), and Range (R), and the number of acres in each forty acre tract or fractional portion thereof.

S	T	R	NE¼				NW¼				SW¼				SE¼				TOTAL
			NE	NW	SW	SE	NE	NW	SW	SE	NE	NW	SW	SE	NE	NW	SW	SE	
25	4	42w																	4.7

You may attach any additional information you believe will assist in informing the Division of the need for your request.

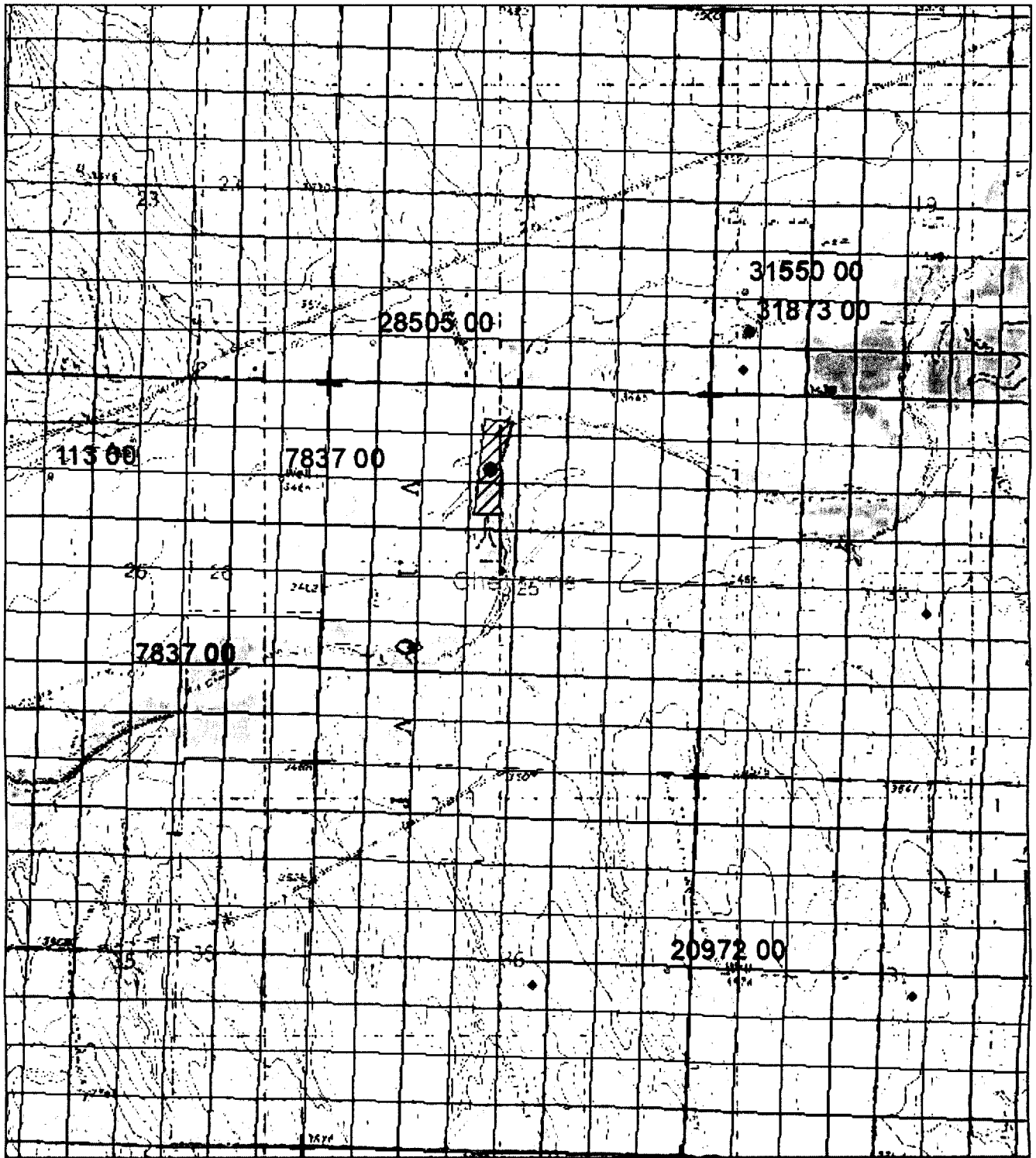

● Proposed Point of Diversion

▨ Proposed Place of Use

1:24,000



Any water wells within 1/2 mile are owned by the applicant.

Signature _____

Date _____

Stockton Field Office
820 S. Walnut
Stockton, KS 67669-0192

Kansas

Department of Agriculture
Division of Water Resources

Phone: 785-425-6787
Fax: 785-425-6842
www.agriculture.ks.gov

Mike Beam, Secretary

December 19, 2022

Laura Kelly, Governor

ROBER WALZ
~~GALE A WALZ~~
445 RD 877
ST FRANCIS KS 67756

Re: New Application

Dear Mr. Walz:

According to our recent conversations, i am enclosing an application form that you can use to apply for a new industiral permit. This application, as we discussed, will be requesting a 15 acre-foot exemption to safe-yield.

To complete the application, you will need to sign and date the application in Paragaraphs 6 and 16. You will also need to sign and date the map on the line provided.

The completed forms will need to be mailed to Manhattan for processing along with a \$200 check made payable to the Kansas Department of Agriculture.

Please let me know if you have any further questions.

Sincerely,



Kelly C. Stewart
Water Commissioner

KCS:ndh
enclosures

DATA ENTRY SYSTEM ID NUMBER SHEET

FILE NUMBER 50934

APPLICANT PERSON ID & SEQ #	PDIV ID	BATTERY ID
<u>67918</u>	<u>89966</u>	

LANDOWNER PERSON ID & SEQ #	PUSE ID
<u>67918</u>	<u>71168</u>

WATER USE CORRESPONDENT
PERSON ID & SEQ #
67918