

Kansas Department of Agriculture
 Division of Water Resources
CHANGE: P/U WORKSHEET

1. File Number: 6,797	2. Status Change Date:	3. Change Num: C1	4. Field Office: 03	5. GMD: 04
---------------------------------	------------------------	-----------------------------	-------------------------------	----------------------

6. Status: <input checked="" type="checkbox"/> Approved <input type="checkbox"/> Denied by DWR/GMD <input type="checkbox"/> Dismiss by Request/Failure to Return	7. Filing Date of Change: 11/2/21
--	---

8a. Applicant(s) Person ID 19891
 New to system Add Seq# _____

DONALD L WOOFER TRUST #1
8 PLYMOUTH DR
COLBY, KS 67701-4400

8c. Landowner(s) Person ID 40986
 New to system Add Seq# _____

VICTOR A & BRENDA S MAZANEC
2561 K-25
COLBY, KS 67701

8b. Landowner(s) Person ID 19891
 New to system Add Seq# _____

DONALD L WOOFER TRUST #1
8 PLYMOUTH DR
COLBY, KS 67701-4400

8d. WUC Person ID 35226
 New to system Add Seq# _____

THOMAS W & SHARON K REDMOND
ATTN: 10714/25537 GROUP
1280 W ELM ST
COLBY, KS 67701

***MODIFY ADDRESS**

9. Documents and Enclosure(s): DWR Meter(s) Date to Comply: _____ N & P Date to Comply: _____

Anti-Reverse Meter Meter Seal Check Valve N & P Form Water Tube Driller Copy H & E Letter

Conservation Plan Date Required: _____ Date Approved: _____ Date to Comply: _____

10. Use Made of Water From: _____ To: _____

Date Prepared: **11/4/21** By: **MAB**
 Date Entered: _____ By: _____

File No. **6,797** 11. County: TH Basin: **SAPPA CREEK** Stream: Formation Code: 211 Special Use:

12. Points of Diversion										Rate and Quantity						
CHK	MOD	DEL	PDIV	Qualifier	S	T	R	ID	'N	'W	Comment (AKA Line)	Authorized		Additional		Overlap PD Files
ENT												Rate gpm	Quantity af	Rate gpm	Quantity af	

NO CHANGE

13. Storage: Rate _____ NF Quantity _____ ac/ft Additional Rate _____ NF Additional Quantity _____ ac/ft

14. Limitation: _____ af/yr at _____ gpm (_____ cfs) when combined with file number(s) _____
 Limitation: _____ af/yr at _____ gpm (_____ cfs) when combined with file number(s) _____

15. 5YR Allocation: Allocation Type _____ Start Year _____ 5 YR Amount _____ Amount Unit _____ Base Acres _____ Comment _____

16. Place of Use																		Total	Owner	Chg?	Overlap Files									
CHK	MOD	DEL	ENT	PUSE	S	T	R	ID		NE¼				NW¼				SW¼				SE¼								
										NE ¼	NW ¼	SW ¼	SE ¼	NE ¼	NW ¼	SW ¼	SE ¼	NE ¼	NW ¼	SW ¼	SE ¼	NE ¼	NW ¼	SW ¼	SE ¼					
DEL				34213	31	6S	33W	2									6							1		7	8c.			
DEL				70144	6	7S	33W	2			17	8		39.9	15	15	35								32	32		193.9	8c.	
MOD				23127	6	7S	33W	1										27	34	28	24						113	8b.	N	10,714
ENT				11977	7	7S	33W	1		30	30	33	29	30.5	30.5	30	30										243	8b.	N	10,714

Base Acres: **423** Year: Minimum Reasonable Quantity:
 Comments: **423 BASE ACRES COMBINED WITH 10,714**

Kansas Department of Agriculture / Division of Water Resources
Stockton Field Office

TO: HEADQUARTERS

RE Vested Right; Water Right; Appropriation of Water; Application

File No(s), 6797 + 10714 County T#

Enclosed are the following checked items:

A FIR Full Partial Inspection Return to Field Office
 Proposed Certificate to deliver to Certificate Unit

Meter Order: GMD#4
 Lower Smoky
 Other

A Compliance Check Inspection on
 Meter Install New App Chg App Other
 In Compliance Not in Compliance, why
Modify Point of Diversion No Yes, document attached
Indicate all overlapping p/d files

- An application and judgment sheet with recommendation.
- A memorandum dated
- A request for an extension of time to perfect or complete.
- A verified report.
- A closure request.
- A field investigation report.
- Notice of Non-Compliance

Violation Date

- An ownership change (name(s) and address(es) below).
- A water use report for
- A letter dated

A copy of an Approval to Change the place of use and/or point of diversion,
 Filing Fee attached.

An Advanced copy of a change application and the filing fee, to be processed at the field office.

An original field office change application and the filing fee needing headquarters office review and further processing.

Other:

Assistant Water Commissioner

11/4/21
Date

Stockton Field Office
820 S. Walnut
Stockton, KS 67669-0192



Phone: 785-425-6787
Fax: 785-425-6842
www.agriculture.ks.gov

Mike Beam, Secretary

Laura Kelly, Governor

November 5, 2021

THOMAS W & SHARON K REDMOND
1280 W ELM ST
COLBY, KS 67701-9166

Re: Water Right, File Nos. 6,797 and 10,714

Dear Mr. Redmond:

Enclosed are two (2) orders executed by Earl Lewis, Chief Engineer, Division of Water Resources, Kansas Department of Agriculture, approving the applications for change under the above referenced file numbers.

Your attention is directed to the terms, conditions, and limitations specified in these approvals for change.

Since these orders modify the original certificates, they should be recorded with the Register of Deeds as other instruments affecting real estate.

These documents are summary orders by this agency regarding these matters. These orders shall become final if requests for hearings are not filed with the Chief Engineer within 15 days of the date of service of these orders.

If you have any questions, please feel free to contact this office. If you wish to refer to a specific file, please reference it when you contact us.

Sincerely,

A handwritten signature in blue ink, appearing to read "Mark Billinger".

Mark Billinger
Assistant Water Commissioner

MB:ndh
Enclosures
pc: G.M.D. No. 4

CERTIFICATE OF SERVICE

On this 5th day of November 2021, I hereby certify that the attached **SUMMARY ORDERS APPROVING APPLICATIONS FOR CHANGE in** Place of Use for water right, File Nos. 6,797 and 10,714, dated on the 5th day of November 2021, were mailed postage prepaid, first class, U.S. mail, to the following:

THOMAS W & SHARON K REDMOND
1280 W ELM ST
COLBY, KS 67701-9166

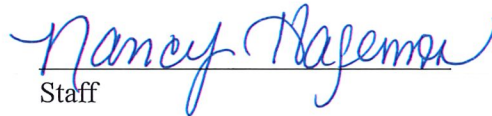
Staff

A copy of this Change Approval was sent to the following:

Groundwater Management District No. 4
P.O. Box 905
Colby, KS 67701

Submit completed application to:
 Kansas Department of Agriculture
 Division of Water Resources
 Field Office for your area.

Call for address:

Topeka -- (785) 296-5733
 Stafford -- (620) 234-5311
 Stockton -- (785) 425-6787
 Garden City -- (620) 276-2901
<http://agriculture.ks.gov/dwr>

DWR FIELD OFFICE APPLICATION FOR APPROVAL TO CHANGE THE PLACE OF USE AND/OR THE POINT OF DIVERSION



STATE OF KANSAS

APPLICATION COMPLETE

11/4/21

Reviewer MS

Filing Fee Must Accompany the Application, K.S.A. 82a-708b(b), as amended.
 Fee Schedule is on the third page of this application form.

Paragraph Nos. 1, 2, 3 & 5 must be completed. Complete all other applicable portions. If change in point of diversion is greater than 100 feet, or if place of use will be changed, include a topographic map or detailed plat showing the authorized and proposed point(s) of diversion and/or place of use.

RECEIVED

File No. 6797

NOV 02 2021

3:23 PM

Stockton Field Office
 Division of Water Resources

1. Application is hereby made for approval of the Chief Engineer to change the (check one or both):

Place of Use Point of Diversion

under the water right which is the subject of this application in accordance with the conditions described below.

The source of supply is: Groundwater Surface water

2. Name and address of Applicant: Don Woofter

8 Plymouth Dr., Colby, KS 67701

Phone Number: (785)462-5793 Email address: dewofter1@gmail.com

Name and address of Water Use Correspondent: Thomas W & Sharon K Redmond

Attn: 10714/25537 Group, 1280 W Elm St., Colby, KS 67701

Phone Number: () Email address: _____

3. The presently authorized place of use is:

Owner of Land ---- NAME: Donald L Woofter Trust #1

ADDRESS: 8 Plymouth Dr., Colby, KS 67701

(If there is more than one landowner, attach supplemental sheets as necessary.)

Sec.	Twp.	Range	NE¼				NW¼				SW¼				SE¼				TOTAL ACRES
			NE¼	NW¼	SW¼	SE¼	NE¼	NW¼	SW¼	SE¼	NE¼	NW¼	SW¼	SE¼	NE¼	NW¼	SW¼	SE¼	
6	7	33									39	35.9	29.3	40					144.2

4. If this application is for a change in place of use, it is proposed that the place of use be changed to:

Owner of Land ---- NAME: Donald L Woofter Trust #1

ADDRESS: 8 Plymouth Dr., Colby, KS 67701

(If there is more than one landowner, attach supplemental sheets as necessary.)

Sec.	Twp.	Range	NE¼				NW¼				SW¼				SE¼				TOTAL ACRES
			NE¼	NW¼	SW¼	SE¼	NE¼	NW¼	SW¼	SE¼	NE¼	NW¼	SW¼	SE¼	NE¼	NW¼	SW¼	SE¼	
7	7	33	30	30	33	29	30.5	30.5	30	30									243
6	7	33									27	34	28	24					113

For Office Use Only: Code _____ Fee \$ _____ TR # _____ Receipt Date _____ Check # _____

5. **Presently authorized point of diversion:**
 One in the _____ Quarter of the _____ Quarter of the _____ Quarter
 of Section _____, Township _____ South, Range _____ (E/W),
 in _____ County, Kansas, _____ feet North _____ feet West of Southeast corner of section.
 Authorized Rate _____ Authorized Quantity _____ Depth of well _____ (feet)
 (DWR use only: Computer ID No. _____ GPS _____ feet North _____ feet West)
 This point will not be changed This point will be changed as follows: No change, point better described with GPS as follows:
Proposed point of diversion: (Complete only if change is requested or if existing point is better described by GPS)
 One in the _____ Quarter of the _____ Quarter of the _____ Quarter
 of Section _____, Township _____ South, Range _____ (E/W),
 in _____ County, Kansas, _____ feet North _____ feet West of Southeast corner of section.
 Proposed Rate _____ Proposed Quantity _____ Proposed well depth (feet) _____
 This point is: Additional Well Geo Center List other water rights that will use this point _____

6. **Presently authorized point of diversion:**
 One in the _____ Quarter of the _____ Quarter of the _____ Quarter
 of Section _____, Township _____ South, Range _____ (E/W),
 in _____ County, Kansas, _____ feet North _____ feet West of Southeast corner of section.
 Authorized Rate _____ Authorized Quantity _____ Depth of well _____ (feet)
 (DWR use only: Computer ID No. _____ GPS _____ feet North _____ feet West)
 This point will not be changed This point will be changed as follows: No change, point better described with GPS as follows:
Proposed point of diversion: (Complete only if change is requested or if existing point is better described by GPS)
 One in the _____ Quarter of the _____ Quarter of the _____ Quarter
 of Section _____, Township _____ South, Range _____ (E/W),
 in _____ County, Kansas, _____ feet North _____ feet West of Southeast corner of section.
 Proposed Rate _____ Proposed Quantity _____ Proposed well depth (feet) _____
 This point is: Additional Well Geo Center List other water rights that will use this point _____

7. The changes herein are desired for the following reasons?
 (please be specific) To create a complete overlap with 10714

8. If a well, is the test hole log attached? Yes No

9. The change(s) (was)(will be) completed by?
Upon approval

10. If the point of diversion is a well:
 (a) What are you going to do with the old well?

 (b) When will this be done? _____

11. Groundwater Management District recommendation
 attached? Yes No

12. Assisted by Shannon Kenyon, GMD 4

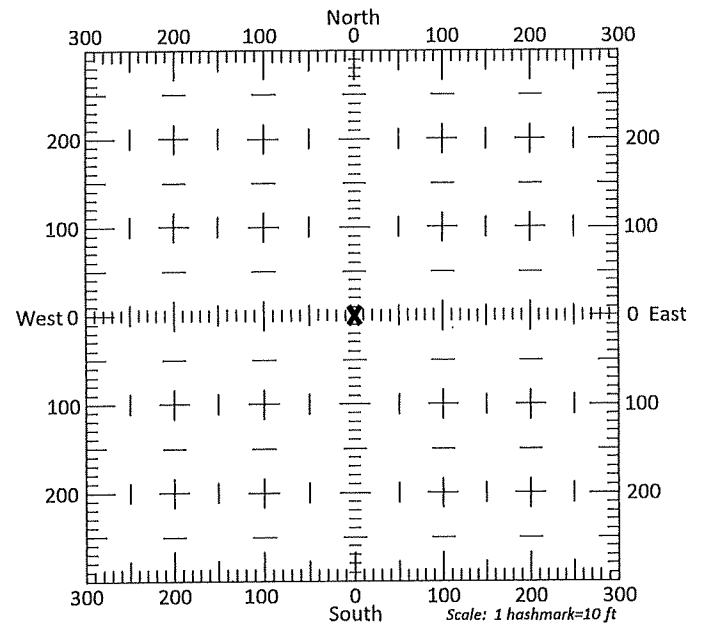

13a. If the proposed point of diversion will be relocated more than 300 feet but within 2,640 feet of the existing point of diversion, attach a topographic map or aerial photograph. For groundwater sources, show all wells (including domestic) within one-half mile of the proposed point of diversion and the names and mailing addresses of the owners. For surface water sources, show the names and addresses of the landowner(s) one-half mile downstream and one-half mile upstream from your property lines

13b. If the proposed point of diversion will be relocated within 300 feet of the existing point of diversion, indicate its location on the diagram shown above in relation to the existing point of diversion. (PLEASE NOTE: The "X" in center of diagram above represents the presently authorized point of diversion.)

APPLICATION FOR APPROVAL TO CHANGE
THE PLACE OF USE AND/OR POINT OF DIVERSION
SUPPLEMENTAL SHEET
FILE NO. ~~10,714~~ 6797
MAKE ADDITIONAL COPIES AS NECESSARY

RECEIVED

NOV 02 2021

Stockton Field Office
Division of Water Resources

3. *Continued:* The presently authorized place of use is:

Owner of Land ---- NAME: Victor A & Brenda S Mazanec

ADDRESS: 2561 K-25 HWY, Colby, KS 67701

Sec.	Twp.	Range	NE¼				NW¼				SW¼				SE¼				TOTAL ACRES
			NE¼	NW¼	SW¼	SE¼	NE¼	NW¼	SW¼	SE¼	NE¼	NW¼	SW¼	SE¼	NE¼	NW¼	SW¼	SE¼	
31	6	33												6			1		7
6	7	33		17	8		39.9	15	15	35						32	32		193.9

Owner of Land ---- NAME: _____

ADDRESS: _____

Sec.	Twp.	Range	NE¼				NW¼				SW¼				SE¼				TOTAL ACRES
			NE¼	NW¼	SW¼	SE¼	NE¼	NW¼	SW¼	SE¼	NE¼	NW¼	SW¼	SE¼	NE¼	NW¼	SW¼	SE¼	

Owner of Land ---- NAME: _____

ADDRESS: _____

Sec.	Twp.	Range	NE¼				NW¼				SW¼				SE¼				TOTAL ACRES
			NE¼	NW¼	SW¼	SE¼	NE¼	NW¼	SW¼	SE¼	NE¼	NW¼	SW¼	SE¼	NE¼	NW¼	SW¼	SE¼	

4. *Continued:* If this application is for a change in place of use, it is proposed that the place of use be changed to:

Owner of Land ---- NAME: _____

ADDRESS: _____

Sec.	Twp.	Range	NE¼				NW¼				SW¼				SE¼				TOTAL ACRES
			NE¼	NW¼	SW¼	SE¼	NE¼	NW¼	SW¼	SE¼	NE¼	NW¼	SW¼	SE¼	NE¼	NW¼	SW¼	SE¼	

Owner of Land ---- NAME: _____

ADDRESS: _____

Sec.	Twp.	Range	NE¼				NW¼				SW¼				SE¼				TOTAL ACRES
			NE¼	NW¼	SW¼	SE¼	NE¼	NW¼	SW¼	SE¼	NE¼	NW¼	SW¼	SE¼	NE¼	NW¼	SW¼	SE¼	

Owner of Land ---- NAME: _____

ADDRESS: _____

Sec.	Twp.	Range	NE¼				NW¼				SW¼				SE¼				TOTAL ACRES
			NE¼	NW¼	SW¼	SE¼	NE¼	NW¼	SW¼	SE¼	NE¼	NW¼	SW¼	SE¼	NE¼	NW¼	SW¼	SE¼	

14. If the proposed groundwater point of diversion is 300 or fewer feet from the existing point of diversion, complete the following:
- (a) Does the undersigned represent all owners of the currently authorized place(s) of use identified in this application?
 Yes No (If no, all owners must sign this application.)
 - (b) Will the ownership interest of any owner of the currently authorized place(s) of use identified in this application be adversely affected if this application is approved as requested?
 Yes No (If yes, all owners must sign this application.)
 - (c) If this application is not approved expeditiously, will there be substantial damage to property, public health or safety?
 Yes No (If no, all owners must sign this application.)

If the application proposes a surface water change in point of diversion, a groundwater change in point of diversion greater than 300 feet, or a change in place of use, the application must be signed by all owners of the currently authorized place of use, or their duly authorized agent (attach notarized statement authorizing representation).

I hereby verify, being first duly sworn upon my oath or affirmation and under penalty of perjury, that I am of lawful age and the owner, the spouse of the owner, or a duly authorized agent of the owner(s) to make this application on their behalf, in regards to the water right(s) to which this application pertains. I further verify that the statements contained in this application are true, correct and complete.

Dated at Colby, Kansas, this 8 day of October, 2024.

<p><u>Donald Woofler, Trustee</u> (Owner)</p> <p><u>DONALD WOOFER, TRUSTEE</u> (Please Print)</p> <p><u>Vita Mazanec</u> (Owner)</p> <p><u>Victor MAZANEC</u> (Please Print)</p> <p>_____ (Owner)</p> <p>_____ (Please Print)</p>	<p>_____ (Spouse)</p> <p>_____ (Please Print)</p> <p><u>X Brenda S Mazanec</u> (Spouse)</p> <p><u>X Brenda S Mazanec</u> (Please Print)</p> <p>_____ (Spouse)</p> <p>_____ (Please Print)</p>
---	---

State of Kansas }
 County of Thomas } SS



I hereby certify that the foregoing application was signed in my presence and sworn to before me this 8 day of October, 2024.

[Signature]
 Notary Public

My Commission Expires Aug 11, 2024

ONLY COMPLETE APPLICATIONS WILL BE PROCESSED. To be complete, all of the applicable portions of the application form must be completed with accurate information; maps, if necessary, must be included; signatures of all the appropriate owners' must be affixed to the application and notarized; and the appropriate fee must be paid.

FEE SCHEDULE

- Each application to change the place of use or the point of diversion under this section shall be accompanied by the application fee set forth in the schedule below: Make checks payable to: **Kansas Department of Agriculture**
- (1) Application to change a point of diversion 300 feet or less \$100
 - (2) Application to change a point of diversion more than 300 feet \$200
 - (3) Application to change the place of use \$200

RECEIVED

NOV 02 2021

SUMMARY ORDER APPROVING APPLICATION FOR CHANGE AND IMPOSING CONDITIONS

This Summary Order is issued under authority of K.S.A. 82a-708b, as amended, and K.A.R. 5-5-1, *et seq.* and other applicable provisions of the *Kansas Water Appropriation Law, K.S.A. 82a-701 et seq.*, and rules and regulations promulgated thereunder, With the exception of those conditions expressly contained herein, this Summary Order does not change the terms, conditions and limitations of File No. 6797.

1. A change application was received on 11-2-21 requesting that the place of use and / or point of diversion authorized under the above-referenced file number be changed as described in the application.
2. On and after the effective date of this summary order, the authorized place(s) of use shall be located substantially as shown on the topographic map accompanying the application to change the place of use. Applicable Not Applicable
3. The change in point of diversion shall not impair existing rights and shall be limited to the same source or sources of water as previously authorized. The point of diversion authorized by this summary order shall be located within a _____ foot radius of the authorized point(s) of diversion. Applicable Not Applicable
4. The point(s) of diversion described herein is administratively corrected to be more accurately described using the Global Positioning System (GPS), as described in the application. Applicable Not Applicable
5. The point(s) of diversion authorized herein shall not actually be located more than _____ feet from the previously authorized point(s) of diversion. Applicable Not Applicable
6. As required by K.A.R. 5-3-5d, if the works for diversion is a well with a diversion rate of 100 gallons per minute or more, a tube or other device suitable for making water level measurements shall be installed, operated and maintained in accordance with K.A.R. 5-6-13. Applicable Not Applicable
7. **The owner of the authorized place(s) of use shall properly install an acceptable water flow meter on or before December 31, 20____**, or before the first use of water, whichever occurs first. The water flow meter shall be installed, operated and maintained in accordance with K.A.R. 5-1-4 through 5-1-12. As required by K.S.A. 82a-732, as amended, and K.A.R. 5-3-5e, the owner shall maintain records and report the reading of the water flow meter and the total quantity of water diverted annually to the Chief Engineer by March 1 following the end of each calendar year.
 Applicable Not Applicable
8. **Installation of the works for diversion of water shall be completed on or before December 31, 20____**, or within any authorized extension of time. By March 1, 20____ the applicant shall notify the Chief Engineer that construction of the works for diversion has been completed, on the form provided by the Chief Engineer, as required by K.A.R. 5-8-4e.
 Applicable Not Applicable
9. **The completed well log shall be submitted with the required notice.** Applicable Not Applicable
10. All diversion works into which any type of chemical or other foreign substance will be injected into the water shall be equipped with an in-line, automatic, quick-closing check valve capable of preventing pollution of the source of the water supply. The check valve(s) shall be installed, operated and maintained in accordance with K.A.R. 5-3-5c. Applicable Not Applicable
11. Additional Conditions are attached. Yes No
12. In accordance with K.S.A. 82a-708a, as amended, and K.A.R. 5-5-14, all of the owners of the authorized place(s) of use of water appropriated under the above-referenced file number are responsible for compliance with its terms, conditions and limitations, as amended and/or supplemented by this Summary Order, and with applicable provisions of the *Kansas Water Appropriation Law* and the *Rules and Regulations* promulgated thereunder. Failure to comply with these provisions may result in civil penalties pursuant to K.S.A. 82a-737, as amended, and/or the suspension or revocation and dismissal of the water or appropriation right or any other enforcement actions authorized by law.

Administrative Appeal and Effective Date of Order

If you are aggrieved by this order, pursuant to K.S.A. 82a-1901, you may request an evidentiary hearing before the Chief Engineer or request administrative review by the Secretary of Agriculture. A request for hearing by the Chief Engineer must be filed within **15 days** of service of this Order and a request for administrative review by the Secretary must be filed within **30 days** pursuant to K.S.A. 77-531. Any request for administrative review must state a basis for review pursuant to K.S.A. 77-527. File any request with **Kansas Department of Agriculture, Legal Division, 1320 Research Park Drive, Manhattan, KS 66502**. Failure to timely request a hearing or review may preclude review under the Kansas Judicial Review Act.

For Use by Register of Deeds

FOR OFFICE USE ONLY

APPLICATION APPROVED AND SUMMARY ORDER ISSUED

By: Mark Brington
Duly Authorized Designee of the Chief Engineer

(Print Name): MARK BRINGTON
Division of Water Resources, Kansas Department of Agriculture

Date of Issuance: 11-4-21

State of Kansas

County of Brooks

Acknowledged before me on 11/4/2021

by Nancy Hageman

Signature: Nancy Hageman
Notary Public

My commission expires: 9/27/2025

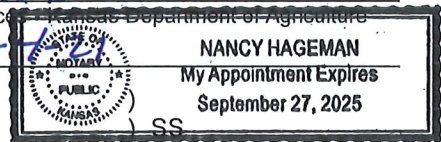

#6797 - Proposed Change in Place of Use

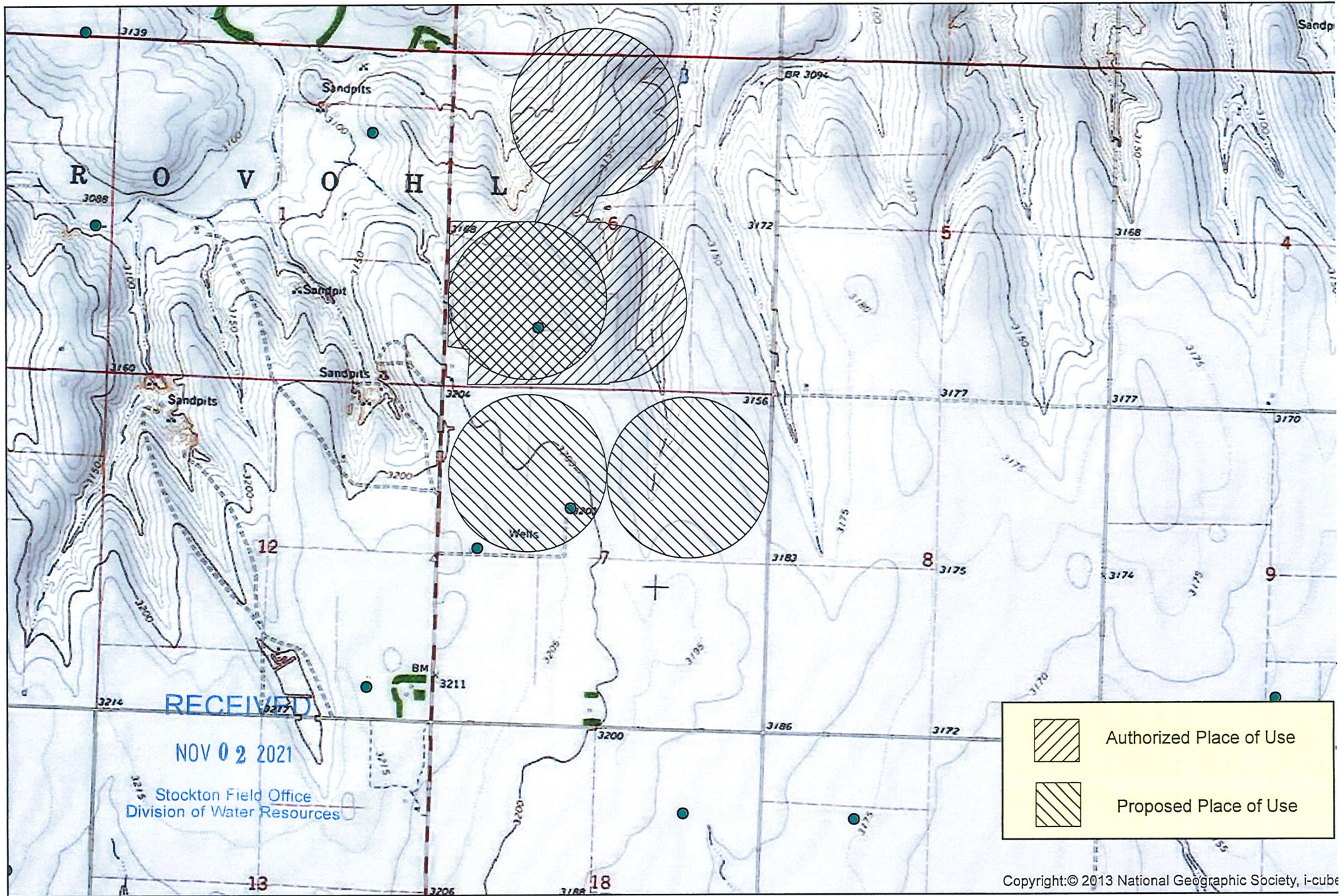

Copyright:© 2013 National Geographic Society, i-cube

Prepared by Shannon Kenyon, GMD 4

Stockton Field Office
820 S. Walnut
Stockton, KS 67669-0192



Phone: 785-425-6787
Fax: 785-425-6842
www.agriculture.ks.gov

Mike Beam, Secretary

Laura Kelly, Governor

November 3, 2021

GROUNDWATER MANAGEMENT DISTRICT NO 4
PO BOX 905
COLBY KS 67701

Re: Water Right, File Nos. 10,714 & 6797

Dear Ladies and Gentlemen:

Reference is made to the applications referred to above which appear to be in proper form.

We are delaying any further action until **November 18, 2021** to allow you time to submit your recommendation concerning these applications.

Please submit your recommendation within the allotted time or any authorized extension of time thereof. If you wish to refer to a specific file, please reference it when you contact us.

Sincerely,

A handwritten signature in blue ink that reads "Kelly C. Stewart". The signature is fluid and cursive, with a long horizontal stroke extending to the right.

Kelly C. Stewart
Water Commissioner

KCS:ndh
Enclosures



**NORTHWEST KANSAS
GROUNDWATER MANAGEMENT
DISTRICT NO. 4**

1290 West 4th Street
P.O. Box 905
Colby, Kansas 67701-0905

RECEIVED

NOV 04 2021

Stockton Field Office
Division of Water Resources

November 3, 2021

Kelly Stewart
Stockton Field Office
820 South Walnut
Stockton, KS 67669

RE: Application(s): #10,714 & #6,797
Don Woofter

Dear Kelly,

The Northwest Kansas Groundwater Management District has reviewed the above referenced applications and based on our records and the information supplied by the applicant, we have determined that the following recommendation be made to the Chief Engineer:

Approve application(s) to change the place of use.

If you have any questions, please contact this office.

Sincerely,

A handwritten signature in black ink, appearing to read "Shannon Kenyon".

Shannon Kenyon
Manager

SK: jem