

Kansas Department of Agriculture
 Division of Water Resources
CHANGE: P/D WORKSHEET

Document Signature DWB

1. File Number: 23,804	2. Status Change Date: 11/1/2014	3. Change Num: C2	4. Field Office: 01	5. GMD:
----------------------------------	--	-----------------------------	-------------------------------	---------

6. Status: <input checked="" type="checkbox"/> Approved <input type="checkbox"/> Denied by DWR/GMD <input type="checkbox"/> Dismiss by Request/Failure to Return	7. Filing Date of Change: 18-MAY-2016
--	---

8a. Applicant(s) New to system <input type="checkbox"/> Person ID 8979 Add Seq# _____ CITY OF JUNCTION CITY ENGINEERING DEPT PO BOX 287 JUNCTION CITY KS 66441-0287	8c. Landowner(s) New to system <input type="checkbox"/> Person ID _____ Add Seq# _____
---	--

8b. Landowner(s) New to system <input type="checkbox"/> Person ID _____ Add Seq# _____ 8A	8d. WUC New to system <input type="checkbox"/> Person ID _____ Add Seq# _____ 8a no change
---	--

9. Documents and Enclosure(s): DWR Meter(s) Date to Comply: **12/31/17** N & P Date to Comply: **12/31/17**

Check Valve N & P Form Water Tube Driller Copy H & E Letter
 Conservation Plan Date Required: _____ Date Approved: _____ Date to Comply: _____

10. Use Made of Water From: _____ To: _____

Date Prepared: **10-24-16** By: **DWS**
 Date Entered: **11/3/2016** By: **LLM**

File No. **23,804** 11. County: **GE** Basin **REPUBLICAN RIVER** Stream: Formation Code: Special Use:
(113) MAIN STEM ALLUVIUM

12. Points of Diversion										Rate and Quantity				
MOD DEL ENT	PDIV * Qualifier	S	T	R	ID	'N	'W	Comment	Authorized		Additional		Overlap PD Files	
									Rate gpm	Quantity af	Rate gpm	Quantity af		
✓	2751	1	12S	5E	1	4873	4564	#6 - Special Sec. 11					GE-002 & 9,658	
✓	41496	SW	SW	SW	36	11S	5E	2	88	5024	#17			GE-002 & 9,658
✓	74345	1	12S	5E	6	5010	4310	#18 - Special Sec. 11					GE-002 & 9,658	
MOD	1350	35	11S	5E	9	515	965	#19 - Special Sec. 12					GE-002 & 9,658	
✓	74346	1	12S	5E	7	5102	4992	#8 - Special Sec. 12					9658	
✓	2908	35	11S	5E	3	229	465	#12 - Special Sec. 12					49,130	
✓	5086	35	11S	5E	4	750	528	#13 - Special Sec. 12					49,126	
✓	40212	35	11S	5E	6	1551	1065	#15 - Special Sec. 12					49,129	
✓	51726	35	11S	5E	2	484	88	#11 - Special Sec. 12					49,127	
✓	54285	35	11S	5E	5	1128	857	#14 - Special Sec. 12					49,128	

13. Storage: Rate _____ NF Quantity _____ ac/ft Additional Rate _____ NF Additional Quantity _____ ac/ft

14. Limitation: _____ when combined with file number(s) _____

15. 5YR Allocation: Allocation Type _____ Start Year _____ 5 YR Amount _____ Amount Unit _____ Base Acres _____ Comment _____

16. Place of Use T MOD DEL ENT	PUSE	S	T	R	ID	NE¼				NW¼				SW¼				SE¼				Total	Owner	Chg?	Overlap Files	
						NE ¼	NW ¼	SW ¼	SE ¼	NE ¼	NW ¼	SW ¼	SE ¼	NE ¼	NW ¼	SW ¼	SE ¼	NE ¼	NW ¼	SW ¼	SE ¼					
NO CHANGES																										

Comments

* BAT 11/2/2016

KANSAS DEPARTMENT OF AGRICULTURE
Division of Water Resources
MEMORANDUM

TO: Files

DATE: October 25, 2016

FROM: Doug Schemm

RE: New Application, File No. 49,638;
Change Applications, Vested Water Right, File No. GE-002;
and Water Right, File Nos. 9,658 and 23,804

The City of Junction City has filed the referenced new application (File No. 49,638) to appropriate 430.123 million gallons (1,320 acre-feet) of groundwater from a proposed new well for municipal use. There are no overlapping files on the proposed point of diversion (which will be designated as City Well No. 20). However, the applicant has multiple water rights that overlap the place of use, including Vested Water Right, File No. GE-02, Water Right, File Nos. 9,658 and 23,804, and Appropriation of Water, File Nos. 49,126; 49,127; 49,128; 49,129; and 49,130. In addition, the City is redrilling one of their municipal supply wells (Well #16) due to a collapsed screen, and has submitted change applications under File Nos. GE-02, 9,658 and 23,804 to change the point of diversion (which will be designated as City Well #19).

The applicant's engineering consultant, (HDR) has provided significant information in support of both the increase in overall quantity of water under the new application, and the change in point of diversion of 125 feet from the existing well.

Vested Water Right, File No. GE-02 is authorized 575 million gallons, and Water Right, File No. 9,658 is authorized 819.019 million gallons limited to 819.019 million gallons when combined with the senior file. Water Right, File No. 23,804 has 10 authorized wells, with a "blanket" rate of diversion and quantity of water, both limited when combined with the senior water rights to 6,925 gpm and 1,529.87 million gallons (4,695 acre-feet) per year. File Nos. 49,126; 49,127; 49,128; 49,129; and 49,130 combined provided an additional 528.73 million gallons for a current authorized total of **2,058.6 million gallons** (6,317.6 acre-feet) per year. Pending Application, File No. 49,638 is requesting 430.123 million gallons at a diversion rate of 1,500 gallons per minute. However, only 32.2 million gallons is additional water, which will increase the City's overall quantity of water from 2,058.6 million gallons to **2,090.8 million gallons** when combined with the senior files. As noted above, this is the City's projected water need in 2056 (see Table 2-4 in supporting data). Their revised engineering report shows that water demands will reach 2,090.8 million gallons by 2056 and population will be 31,718.

The applicant also provided significant supporting information during the processing of senior files, File Nos. 49,126; 49,127; 49,128; 49,129; and 49,130, including an engineering analysis report, to justify the requested increase in both quantity of water and rate of diversion. The information on the municipal use supplemental sheets for these senior files indicated that the City had experienced a significant population growth in the last 20 years from 21,000 to 25,817 in 2013. In both 2011 and 2012, the applicant exceeded both their authorized quantity of water and their authorized rate of diversion under their senior files.

The Kansas Water Office (KWO) has also projected a similar significant expansion with population growth for the City from 21,711 in 2000 to 24,841 in 2040, with a related water demand in 2040 of 1,278 million gallons. The other entities served by the City increases water demand in 2040 to over 1,337 million gallons. The City is likely to surpass the KWO 2040 population estimate in calendar year 2016. The applicant indicates that current water usage is equivalent to 137.9 gallons per capita per day (GPCD). The 2011 Kansas Municipal Water Use publication indicates that the City used an average of 150 GPCD, while the regional average for large public water suppliers in Region 7 was 132 GPCD. Using the City's average value of 150 gpcd, and based on their population projection of 31,718 by 2056 (included in the engineering report), the following estimate for water usage can be determined: $31,718 \times 150 \text{ gallons} \times 365 \text{ days} = 1,736 \text{ million gallons}$. Water sold to other public water suppliers and bulk customers (273.5 million gallons), is also likely to increase substantially. Adding the water sold quantity on to the population projection provides for a projected total of 2,010 million gallons per year. Therefore, based on the City's current usage and projections, the requested quantity of 2,090.8 million gallons per year when all rights are combined appears reasonable.

Based on well information contained in the engineering report, and information from the KGS well completion database, the subsurface lithology is comprised of alternating sand and gravel to depths ranging from 53 feet to 74 feet below ground surface where shale or limestone bedrock is encountered. Static water levels range from 25 feet to 40 feet below ground surface. The engineering report notes that well pumping rates are limited by the relatively thin saturated thickness of the aquifer. The physical location of the wells and the subsurface lithology, indicate that the source of water is the Republican River alluvium.

The area of consideration for the pending new application was based on information from File Nos. 49,126; 49,127; 49,128; 49,129; and 49,130, in order to maintain consistency. This provided a delineation of the extent of the alluvial aquifer (area of consideration) of 6,847 acres, a recharge of 3.2 inches, and with 75% available, a safe yield quantity of 1,369 acre-feet. There are multiple existing water rights in the local area that have appropriated over 7,228 acre-feet (the majority of this quantity is the applicant's senior files). For this pending application, there is no quantity of water available for appropriation. However, per a determination by the Chief Engineer, the applicant's senior water rights are eligible water rights within the Kansas River Water Assurance District No. 1 and they benefit from releases of assurance water. This new well is part of this same well field adjacent to the river. The City has requested a waiver of safe yield. Therefore, because the water requested by this pending application would be supported by Kansas River Water Assurance District No. 1, a **waiver** of safe yield (K.A.R. 5-3-11) is recommended. Releases of storage water from Milford Reservoir will provide adequate recharge to the alluvial source for these wells. A waiver of safe yield for new applications supported by water assurance district releases is consistent with other member applications throughout the state.

As noted above, the proposed point of diversion is a new well, but is part of an existing well field currently authorized under senior water rights (File Nos. GE-02, 9,658 and 23,804). The individual wells were installed to operate as a well field in conjunction with each other, and the individual wells do not meet minimum well spacing criteria to each other per the requirements in K.A.R. 5-4-4, which suggest 1,320 feet well spacing for "all other aquifers". Spacing averages about 500 feet apart for the existing wells. However, K.A.R. 5-4-4 also provides that the spacing guidelines are not applicable if the required minimum well spacing criteria are not necessary to prevent direct impairment. There are several unique circumstances that should be considered in this specific instance.

- The wells in a municipal well field are operated as a system, and are not likely to be separated or divided in any way in the future.
- The wells have historically been operated without evidence of impairing each other.
- In addition, as noted above, these wells are primarily dependent on capturing surface water that infiltrates from the Republican River, especially when water is released by the KRWAD No. 1. The reduced well spacing is a key component to this "hydraulic capture" concept. Typically, well spacing is necessary to prevent overlapping cones of influence, which can lead to impairment concerns. However, based on similar well field designs, these wells are intentionally spaced close together to cause overlapping cones of depression and ultimately create a groundwater trough or sink adjacent to the river. This trough greatly increases the ability to capture surface water. Increasing surface water infiltration to the wells is obviously a benefit to the alluvial aquifer because it will minimize the amount of groundwater directly withdrawn from the aquifer.

Based on the specific design of this well field, the well spacing guidelines in K.A.R. 5-4-4, are clearly not relevant in this instance in regards to the City's municipal well field. The minimum well spacing criteria for the applicant's wells is not necessary to prevent direct impairment since direct interference between well drawdown is the desired outcome of pumping these wells to increase surface water infiltration. The proposed new well and the change in point of diversion complies with well spacing from all other existing wells, which will protect the public interest.

As stated above, the City is re-drilling one of their municipal supply wells (Well #16) due to a collapsed screen, and has submitted change applications under File Nos. GE-02, 9,658 and 23,804 to change the point of diversion (the new well will be designated as City Well #19). Both the existing well #16 and the proposed well #19 are located within Special Section 12. The proposed well will be located approximately 125 feet Southeast of the currently authorized well based on the submitted map and information from the applicant. The well location appears to meet spacing requirements of K.A.R. 5-4-4(d)(2) *Well spacing* in that a move of 125 feet will not decrease the distance to other wells or authorized well locations by more than 300 feet.

The same local source of supply will not change, which has been previously determined to be Main Stem Alluvium (113). The referenced water rights do not appear abandoned as per K.S.A. 82a-718. A Certificate of Appropriation was recently issued for Water Right, File No. 23,804 (June 16, 2014).

The Kansas River Water Assurance District No. 1 was notified of the pending new and change applications on August 9, 2016 via electronic mail. No response was received from the KRWAD. In addition, a copy of the applications was sent to the Kansas Water Office for their review and comment. In a letter dated September 28, 2016, the KWO stated that the results of the OASIS model run indicate that there is sufficient assurance reservoir storage to support the requested additional water. DWR Water Management Services staff also recommended approval of the new application in conjunction with the determination by the KWO.

The applicant has submitted a signed Kansas River Assurance District form for the pending new application, which has been properly notarized. By completing this statement, the applicant affirms his/her knowledge that there could be times when the diversion of water may not be allowed under this permit.

Names and addresses of nearby well owners were provided by the applicant, which complies with K.A.R. 5-3-4. One domestic well was located within one-half mile, and a notification letter was sent on October 11, 2016, regarding both the new and change applications. No response of any kind was received. As noted the proposed new well is part of an existing well field that has been in place for many years. Any adjacent well owners would certainly be aware of the City's municipal well field.

The applications were filed indicating that the place of use is the City of Junction City, Kansas and immediate vicinity, an industrial park in the Northeast Quarter (NE $\frac{1}{4}$) of Section 22, a roadside park on Interstate-70 in Sections 16 and 21, Rural Water District No. 1, Geary County, all in Township 12 South, Range 5 East, Geary County, and the City of Grandview Plaza and immediate vicinity, in Township 12 South, Range 6 East, Geary County, Kansas. This place of use is consistent with senior water rights.

In accordance with K.S.A. 82a-706c, the Chief Engineer retains full authority to require any water user to install meters, gages, or other measuring devices, which devices he or she or his or her agents may read at any time. Water flowmeter requirements are further described in K.A.R. 5-1-4 through K.A.R. 5-1-12. If any chemical or foreign substance is injected into the water pumped under this permit, a check valve will also need to be installed.

Based on the above discussion, that the changes are reasonable, that impairment to existing vested rights is unlikely, and that no change in the local source of supply will occur, it is recommended that the referenced change applications be approved.

City of Junction City - Memorandum
File Nos. 49,638; GE-002; 9,658; and 23,804
Page 4 of 4

Katie Tietsort, Water Commissioner of the Topeka Field Office, recommended approval of the referenced new and change applications in an October 24, 2016 discussion. Based on the above discussion, the applications are supported by the Kansas River Water Assurance District No. 1, the additional quantity of water under File No. 49,638 will help the city meet future water demands and address recent over-pumping, there is sufficient assurance water storage in place for the new application, and approval of the applications will not impair senior water rights nor prejudicially or unreasonably affect the public interest, it is recommended that the referenced new and changes applications be approved. The new application will be approved with a waiver of safe yield and appropriate quantity limitations.

Douglas W. Schemm
Environmental Scientist
Topeka Field Office

1320 Research Park Drive
Manhattan, Kansas 66502
(785) 564-6700



900 SW Jackson, Room 456
Topeka, Kansas 66612
(785) 296-3556

Jackie McClaskey, Secretary

Governor Sam Brownback

November 4, 2016

CITY OF JUNCTION CITY
ENGINEERING DEPT
PO BOX 287
JUNCTION CITY KS 66441-0287

FILE COPY

Re: Appropriation of Water, File No. 49,638; Vested Water Right, File No. GE 002; and
Water Right, File Nos. 9,658 and 23,804

Dear Sir or Madam:

There is enclosed a permit (File No. 49,638) to appropriate water authorizing you to proceed with construction of the proposed diversion works (except those dams and stream obstructions regulated by K.S.A. 82a-301 through 305a), to divert such unappropriated water as may be available from the source and at the location specified in the permit, and to use it for the purpose and at the location described in the permit.

Your attention is directed to the enclosures and to the terms, conditions, and limitations specified in this permit. A water meter is required and you must install it prior to water being put to beneficial use in order for you to maintain accurate records of water use. The meter should be used to provide the information required on the annual water use report. Failure to notify the Chief Engineer of the Division of Water Resources of the completion of the diversion works within the time allowed, or within any authorized extension of time thereof, will result in the dismissal of this permit. Enclosed is a form which may be used to notify the Chief Engineer that the proposed diversion works have been completed.

All requests for extensions of time to complete diversion works, or to perfect appropriations, must be submitted to the Chief Engineer before the expiration of time originally set forth in the permit to complete diversion works or to perfect an appropriation. If for any reason, you require an extension of time, you must request it before the expiration of time set forth in this permit. Failure to comply with this regulation will result in the dismissal of your permit or your water right. Any request for an extension of time shall be accompanied by the required statutory fee, which is currently \$100.00. There is also enclosed an information sheet setting forth the procedure to obtain a Certificate of Appropriation which will establish the extent of your water right.

In addition, enclosed are Orders executed by the Chief Engineer, Division of Water Resources, Kansas Department of Agriculture, approving the Applications for Change in the Point of Diversion under Vested Water Right, File No. GE 002, and Water Right, File Nos. 9,658 and 23,804. Your attention is directed to the enclosures and to the terms, conditions, and limitations specified in these approvals for change.

City of Junction City

File Nos. 49,638; GE-002; 9,658; and 23,804

Page 2

Since these orders modify the original documents referred to above, the approval documents for File Nos. GE 002; 9,658; and 23,804 should be recorded with the Register of Deeds as other instruments affecting real estate. The abandoned well must be plugged in accordance with the requirements of Article 30 of the Rules and Regulations as adopted by the Kansas Department of Health and Environment.

These Orders are final agency actions. If you choose to appeal this decision or any finding or part thereof, you must do so by filing a petition for review in the manner prescribed by the Kansas Act for Judicial Review and Civil Enforcement of Agency Actions (KJRA K.S.A. 77-601 et seq.) within 30 days of service of these Orders. Your appeal must be made with the appropriate district court for the district of Kansas.

The Chief Legal Counsel for the Kansas Department of Agriculture, 1320 Research Park Drive, Manhattan, Kansas 66502, is the agency officer who will receive service of a petition for judicial review on behalf of the Kansas Department of Agriculture, Division of Water Resources. If you have questions or would like clarification concerning these orders, you may contact the Chief Engineer.

If you have any questions, please contact our office. If you wish to discuss a specific file, please have the file number ready so that we may help you more efficiently.

Sincerely,

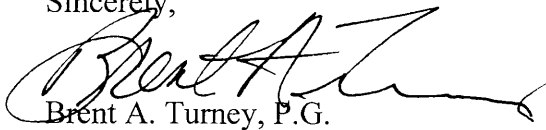

Brent A. Turney, P.G.

Change Application Unit Supervisor
Water Appropriation Program

BAT:dws

Enclosures

pc: Kansas River Water Assurance District No. 1
Kansas Water Office
Topeka Field Office



KANSAS DEPARTMENT OF AGRICULTURE
Jackie McClaskey, Secretary of Agriculture

DIVISION OF WATER RESOURCES
David W. Barfield, Chief Engineer

**APPROVAL OF APPLICATION
FOR
CHANGE IN POINT OF DIVERSION
WATER RIGHT, FILE NO. 23,804**

FILE COPY

The Chief Engineer, Division of Water Resources, Kansas Department of Agriculture, after due consideration of the written application of Allen J. Dinkel, City Manager, on behalf of the City of Junction City, 700 North Jefferson, P.O. Box 287, Junction City, Kansas, 66441, received in this office on May 18, 2016, for approval of a change in the location of the point of diversion under the certificate of appropriation issued pursuant to the application for permit to appropriate water for beneficial use, finds that the change is reasonable and will not impair existing rights, that the change relates to the same local source of supply and that the application should be and is hereby approved.

The effective date of the change shall be the date this order is executed by the Chief Engineer, after which the authorized locations of the points of diversion shall be:

one (1) well, identified by the City of Junction City as Well No. 15, located in Special Section 12, more particularly described as being near a point 1,551 feet North and 1,065 feet West of the Southeast corner of Section 35, in Township 11 South, Range 5 East,

one (1) well, identified by the City of Junction City as Well No. 14, located in Special Section 12, more particularly described as being near a point 1,128 feet North and 857 feet West of the Southeast corner of Section 35, in Township 11 South, Range 5 East,

one (1) well, identified by the City of Junction City as Well No. 13, located in Special Section 12, more particularly described as being near a point 750 feet North and 528 feet West of the Southeast corner of Section 35, in Township 11 South, Range 5 East,

one (1) well, identified by the City of Junction City as Well No. 19, located in Special Section 12, more particularly described as being near a point 515 feet North and 965 feet West of the Southeast corner of Section 35, in Township 11 South, Range 5 East,

one (1) well, identified by the City of Junction City as Well No. 11, located in Special Section 12, more particularly described as being near a point 484 feet North and 88 feet West of the Southeast corner of said section, in Township 11 South, Range 5 East,

one (1) well, identified by the City of Junction City as Well No. 12, located in Special Section 12, more particularly described as being near a point 229 feet North and 465 feet West of the Southeast corner of Section 35, in Township 11 South, Range 5 East,

one (1) well, identified by the City of Junction City as Well No. 17, located in the Southwest Quarter of the Southwest Quarter of the Southwest Quarter (SW $\frac{1}{4}$ SW $\frac{1}{4}$ SW $\frac{1}{4}$) of Section 36, more particularly described as being near a point 88 feet North and 5,024 feet West of the Southeast corner of said section, in Township 11 South, Range 5 East,

one (1) well, identified by the City of Junction City as Well No.18, located in Special Section 11, more particularly described as being near a point 5,010 feet North and 4,310 feet West of the Southeast corner of Section 1, in Township 12 South, Range 5 East,

one (1) well, identified by the City of Junction City as Well No. 6, located in Special Section 11, more particularly described as being near a point 4,873 feet North and 4,564 feet West of the Southeast corner of Section 1, in Township 12 South, Range 5 East, and

one (1) well, identified by the City of Junction City as Well No. 8, located in Special Section 12, more particularly described as being near a point 5,102 feet North and 4,992 feet West of the Southeast corner of Section 1, in Township 12 South, Range 5 East,

all in Geary County, Kansas, located substantially as shown on the map accompanying the application to change the point of diversion.

That the applicant shall submit to the Chief Engineer a copy of the well log required by the Kansas Department of Health and Environment under the authority of K.S.A. 82a-1212, currently form WWC-5, within 30 days following the drilling of the well at the location authorized herein.

Installation of the works for diversion of water shall be completed on or before December 31, 2017, or within any authorized extension of time. The applicant shall notify the Chief Engineer of the Division of Water Resources, Kansas Department of Agriculture, when construction of the works for diversion has been completed.

All wells with a diversion rate of 100 gallons per minute or more drilled under the authority of this order shall have a tube or other device installed in a manner acceptable to, and in accordance with specifications adopted by, the Chief Engineer. This tube or device shall be suitable for making water level measurements and shall be maintained in a condition satisfactory to the Chief Engineer.

All diversion works into which any type of chemical or other foreign substance will be injected into the water pumped from the diversion works shall be equipped with an in-line, automatic, quick-closing check valve capable of preventing pollution of the source of the water supply. The type of valve installed shall meet specifications adopted by the Chief Engineer and shall be maintained in an operating condition satisfactory to the Chief Engineer.

The water right owner shall properly install acceptable water meters on the diversion works authorized under this water right, prior to the use of water, in strict accordance with the Kansas Administrative Regulations 5-1-4 through 5-1-12 adopted by the Chief Engineer. The water right owner shall notify the Chief Engineer when installation of the water meters has been completed. The water right owner shall maintain the water meters in an operating condition satisfactory to the Chief Engineer, at all times during diversion of water and shall maintain records from which the total quantity of water diverted may be determined. The water right owner shall also report the reading of said water meters and the total quantity of water diverted annually to the Chief Engineer. Such records shall be furnished to the Chief Engineer by March 1 following the end of each calendar year.

In all other respects, the Certificate of Appropriation issued pursuant to Approval of Application, File No. 23,804, for permit to appropriate water for beneficial use, is as stated and set forth in the Certificate of Appropriation dated June 16, 2014.

This Order shall become a final agency action, as defined by K.S.A. 77-607(b), without further notice to the parties, if a request for hearing or a petition for administrative review is not filed as set forth below.

Request for Hearing. According to K.A.R. 5-14-3(c), any party who desires a hearing must submit a request within 15 days after the date shown on the Certificate of Service attached to this Order. Filing a request for a hearing will give you the opportunity to submit additional facts for consideration, contest any findings made by the Chief Engineer or present any other information you believe should be considered in this matter. A timely-filed request for hearing will stay the deadline for requesting administrative review of this Order pending the outcome of the hearing.

Petition for Review. Any person aggrieved by this Summary Order may petition for administrative review, pursuant to K.S.A. 82a-708b(a) and K.S.A. 82a-1901(a). The petition must be filed within 30 days after the date shown on the Certificate of Service attached to this Order and must set forth the basis for the review, unless stayed by the timely filing of a request for hearing.

Any request for hearing or petition for administrative review shall be in writing and shall be submitted to the attention of: Chief Legal Counsel, Kansas Department of Agriculture, 1320 Research Park Drive, Manhattan, Kansas 66502, Fax: (785) 564-6777.

Ordered this 1st day of November, 2016, in Topeka, Shawnee County, Kansas.

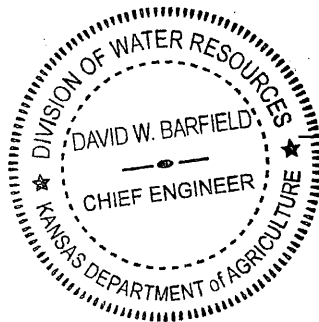

David W. Barfield

David W. Barfield, P.E.
Chief Engineer
Division of Water Resources
Kansas Department of Agriculture

State of Kansas)
) SS
County of Riley)

The foregoing instrument was acknowledged before me this 1st day of November, 2016, by David W. Barfield, P.E., Chief Engineer, Division of Water Resources, Kansas Department of Agriculture.



Karen Hunter

Notary Public

CERTIFICATE OF SERVICE

On this *4th* day of *November*, 2016, I hereby certify that the foregoing Approval of Application for Change in Point of Diversion, Water Right, File No. 23,804, dated *Nov. 1, 2016* was mailed postage prepaid, first class, US mail to the following:

CITY OF JUNCTION CITY
700 NORTH JEFFERSON
PO BOX 287
JUNCTION CITY KS 66441-0287

With photocopies to:

KANSAS RIVER WATER ASSURANCE DISTRICT NO 1
% GALEN BIERY
212 SW 7TH STREET
TOPEKA KS 66603-3717

Topeka Field Office

A handwritten signature in black ink, appearing to read "Daniel R. Wilson", written over a horizontal line.

Division of Water Resources

APPLICATION COMPLETE

8 / 9 / 2016

Reviewer DWS

Submit To: CHIEF ENGINEER
Division of Water Resources
Kansas Department of Agriculture
1320 Research Park Drive
Manhattan, Kansas 66502
http://agriculture.ks.gov/dwr

**APPLICATION FOR APPROVAL TO
CHANGE THE PLACE OF USE, THE
POINT OF DIVERSION OR THE USE
MADE OF THE WATER UNDER AN
EXISTING WATER RIGHT**



State of Kansas

Filing Fee Must Accompany the Application
(Please refer to Fee Schedule on signature page of application form.)

Paragraph Nos. 1, 2, 3, 4 & 8 must be completed. Complete all other applicable portions. A topographic map or detailed plat showing the authorized and proposed points(s) of diversion and /or place of use must accompany this application.

1. Application is hereby made for approval of the Chief Engineer to change the

- Place of Use
- (Check one or more) Point of Diversion
- Use Made of Water

WATER RESOURCES
RECEIVED

MAY 18 2016

11:39

KS DEPT OF AGRICULTURE

File No. 23804

2. Name of applicant: City of Junction City, Kansas

Address: 700 N. Jefferson, P.O. Box 287

City, State and Zip: Junction City, Kansas 66441

Phone Number: (785) 238-3103 E-mail address: allen.dinkel@jcks.com

What is your relationship to the water right; owner tenant agent other? If other, please explain. _____

Name of water use correspondent: Engineering Department, City of Junction City, Kansas

Address: 700 N. Jeffereson, P.O. Box 287

City, State and Zip: Junction City, Kansas 66441

Phone Number: (785) 238-3101 E-mail address: allen.dinkel@jcks.com

3. The change(s) proposed herein are desired for the following reasons (please be specific): Current City Well #16 has a damaged well screen and needs to be replaced. The City proposes to move the point of diversion associated with Well #16 a distance of 125 feet to the southeast of its present location. As per KDHE well naming conventions, the new well will be designated Well #19.

The change(s) (was) (will be) completed by December 31, 2017
(Date)

For Office Use Only:									
F.O. <u>1</u>	GMD <u>0</u>	Meets K.A.R. 5-5-1 (YES/NO) <u>(YES)</u>	Use <u>MUN</u>	Source <u>(G) S</u>	County <u>GE</u>	By <u>AJW</u>	Date <u>5/18/16</u>		
Code <u>CLT</u>	Fee \$ <u>160</u>	TR # _____	Receipt Date <u>5/18/16</u>	Check # <u>10690</u>					

SCANNED

Assisted by: Doug Haney

5/19/2016 UM

4. The presently authorized place of use is: See attached place of use map

Owner of Land — NAME: City of Junction City, Kansas

ADDRESS: City of Junction City and Immediate Vicinity

Sec.	Twp.	Range	NE¼				NW¼				SW¼				SE¼				TOTAL ACRES
			NE¼	NW¼	SW¼	SE¼	NE¼	NW¼	SW¼	SE¼	NE¼	NW¼	SW¼	SE¼	NE¼	NW¼	SW¼	SE¼	
1	12 S	5 E																	

List any other water rights that cover this place of use. #GE 002, #9658, #49126, #49127, #49128, #49129, #49130

Owner of Land — NAME: City of Grandview Plaza, Kansas

ADDRESS: City of Grandview Plaza and Immediate Vicinity

Sec.	Twp.	Range	NE¼				NW¼				SW¼				SE¼				TOTAL ACRES
			NE¼	NW¼	SW¼	SE¼	NE¼	NW¼	SW¼	SE¼	NE¼	NW¼	SW¼	SE¼	NE¼	NW¼	SW¼	SE¼	
5	12 S	6 E																	

List any other water rights that cover this place of use. #GE 002, #9658, #49126, #49127, #49128, #49129, #49130

(If there are more than two landowners, attach additional sheets as necessary.)

5. It is proposed that the place of use be changed to:

Owner of Land — NAME: _____

ADDRESS: _____

Sec.	Twp.	Range	NE¼				NW¼				SW¼				SE¼				TOTAL ACRES
			NE¼	NW¼	SW¼	SE¼	NE¼	NW¼	SW¼	SE¼	NE¼	NW¼	SW¼	SE¼	NE¼	NW¼	SW¼	SE¼	

List any other water rights that cover this place of use. _____

Owner of Land — NAME: _____

ADDRESS: _____

Sec.	Twp.	Range	NE¼				NW¼				SW¼				SE¼				TOTAL ACRES
			NE¼	NW¼	SW¼	SE¼	NE¼	NW¼	SW¼	SE¼	NE¼	NW¼	SW¼	SE¼	NE¼	NW¼	SW¼	SE¼	

List any other water rights that cover this place of use. _____

IF MORE SPACE IS NEEDED, ATTACH ADDITIONAL SHEETS AS NECESSARY. **NECESSARY RESOURCES RECEIVED**

SCANNED MAY 18 2016

4. The presently authorized place of use is:

Owner of Land — NAME: Geary County Rural Water District #1

ADDRESS: Within the boundaries of Geary Co. RWD #1

Sec.	Twp.	Range	NE¼				NW¼				SW¼				SE¼				TOTAL ACRES
			NE¼	NW¼	SW¼	SE¼	NE¼	NW¼	SW¼	SE¼	NE¼	NW¼	SW¼	SE¼	NE¼	NW¼	SW¼	SE¼	
1	12 S	5E																	

List any other water rights that cover this place of use. #GE 002, #9658, #49126, #49127, #49128, #49129, #49130

Owner of Land — NAME: City of Junction City, Kansas

ADDRESS: Industrial Park in SW Corner of Interstate 70 & US Highway 77

Sec.	Twp.	Range	NE¼				NW¼				SW¼				SE¼				TOTAL ACRES
			NE¼	NW¼	SW¼	SE¼	NE¼	NW¼	SW¼	SE¼	NE¼	NW¼	SW¼	SE¼	NE¼	NW¼	SW¼	SE¼	
22	12 S	5 E																	

List any other water rights that cover this place of use. #GE 002, #9658, #49126, #49127, #49128, #49129, #49130

(If there are more than two landowners, attach additional sheets as necessary.)

5. It is proposed that the place of use be changed to:

Owner of Land — NAME: _____

ADDRESS: _____

Sec.	Twp.	Range	NE¼				NW¼				SW¼				SE¼				TOTAL ACRES
			NE¼	NW¼	SW¼	SE¼	NE¼	NW¼	SW¼	SE¼	NE¼	NW¼	SW¼	SE¼	NE¼	NW¼	SW¼	SE¼	

List any other water rights that cover this place of use. _____

Owner of Land — NAME: _____

ADDRESS: _____

Sec.	Twp.	Range	NE¼				NW¼				SW¼				SE¼				TOTAL ACRES
			NE¼	NW¼	SW¼	SE¼	NE¼	NW¼	SW¼	SE¼	NE¼	NW¼	SW¼	SE¼	NE¼	NW¼	SW¼	SE¼	

List any other water rights that cover this place of use. _____

IF MORE SPACE IS NEEDED, ATTACH ADDITIONAL SHEETS AS NECESSARY

WATER RESOURCES RECEIVED

MAY 18 2016

SCANNED

KS DEPT OF AGRICULTURE

4. The presently authorized place of use is:

Owner of Land — NAME: Kansas Department of Transportation

ADDRESS: Roadside Park, I-70 westbound lane

Sec.	Twp.	Range	NE¼				NW¼				SW¼				SE¼				TOTAL ACRES
			NE¼	NW¼	SW¼	SE¼	NE¼	NW¼	SW¼	SE¼	NE¼	NW¼	SW¼	SE¼	NE¼	NW¼	SW¼	SE¼	
16	12 S	5 E																	

List any other water rights that cover this place of use. #GE 002, #9658, #49126, #49127, #49128, #49129, #49130

Owner of Land — NAME: Kansas Department of Transportation

ADDRESS: Roadside Park, I-70 eastbound lane

Sec.	Twp.	Range	NE¼				NW¼				SW¼				SE¼				TOTAL ACRES
			NE¼	NW¼	SW¼	SE¼	NE¼	NW¼	SW¼	SE¼	NE¼	NW¼	SW¼	SE¼	NE¼	NW¼	SW¼	SE¼	
21	12 S	5 E																	

List any other water rights that cover this place of use. #GE 002, #9658, #49126, #49127, #49128, #49129, #49130

(If there are more than two landowners, attach additional sheets as necessary.)

5. It is proposed that the place of use be changed to:

Owner of Land — NAME: _____

ADDRESS: _____

Sec.	Twp.	Range	NE¼				NW¼				SW¼				SE¼				TOTAL ACRES
			NE¼	NW¼	SW¼	SE¼	NE¼	NW¼	SW¼	SE¼	NE¼	NW¼	SW¼	SE¼	NE¼	NW¼	SW¼	SE¼	

List any other water rights that cover this place of use. _____

Owner of Land — NAME: _____

ADDRESS: _____

Sec.	Twp.	Range	NE¼				NW¼				SW¼				SE¼				TOTAL ACRES
			NE¼	NW¼	SW¼	SE¼	NE¼	NW¼	SW¼	SE¼	NE¼	NW¼	SW¼	SE¼	NE¼	NW¼	SW¼	SE¼	

List any other water rights that cover this place of use. _____

IF MORE SPACE IS NEEDED, ATTACH ADDITIONAL SHEETS AS NECESSARY

WATER RESOURCES
DIVISION

MAY 18 2016

SCANNED

KS DEPT OF AGRICULTURE

- 6. The presently authorized point(s) of diversion (is) (are) 10 production wells - Nos 6, 8, 11, 12, 13, 14, 15, 16, 17, & 18
(Provide description and number of points)
- 7. The proposed point(s) of diversion (is) (are) 10 production wells - Nos 6, 8, 11, 12, 13, 14, 15, 17, 18, & 19
(Provide description and number of points)

List all presently authorized point(s) of diversion:

8. **Presently authorized point of diversion:** Well #16 (In Lot 1 in Special Section 12)
 One in the SW Quarter of the SE Quarter of the SE Quarter of Section 35, Township 11 South, Range 5 (E/W), in Geary County, Kansas, 615 feet North 1036 feet West of Southeast corner of section.
 Authorized Rate 6250 gpm Authorized Quantity 4480.575 AF
 (DWR use only: Computer ID No. _____ GPS _____ feet North _____ feet West)
 This point will not be changed This point will be changed as follows:
Proposed point of diversion: (Complete only if change is requested) New Well #19
 One in the SW Quarter of the SE Quarter of the SE Quarter of Section 35, Township 11 South, Range 5 (E/W), in Geary County, Kansas, 515 feet North 965 feet West of Southeast corner of section.
 Proposed Rate 6250 gpm Proposed Quantity 4480.575 AF
 This point is: Additional Well Geo Center List other water rights that will use this point #GE 002, #9658

9. **Presently authorized point of diversion:** Well #17 (125' N & 130' W of Original PD)
 One in the SW Quarter of the SW Quarter of the SW Quarter of Section 36, Township 11 South, Range 5 (E/W), in Geary County, Kansas, 88 feet North 5024 feet West of Southeast corner of section.
 Authorized Rate 6250 gpm Authorized Quantity 4480.575 AF
 (DWR use only: Computer ID No. _____ GPS _____ feet North _____ feet West)
 This point will not be changed This point will be changed as follows:
Proposed point of diversion: (Complete only if change is requested)
 One in the _____ Quarter of the _____ Quarter of the _____ Quarter of Section _____, Township _____ South, Range _____ (E/W), in _____ County, Kansas, _____ feet North _____ feet West of Southeast corner of section.
 Proposed Rate _____ Proposed Quantity _____
 This point is: Additional Well Geo Center List other water rights that will use this point _____

10. **Presently authorized point of diversion:** Well #18 (In Special Section 11)
 One in the NE Quarter of the NW Quarter of the NW Quarter of Section 1, Township 12 South, Range 5 (E/W), in Geary County, Kansas, 5010 feet North 4310 feet West of Southeast corner of section.
 Authorized Rate 6250 gpm Authorized Quantity 4480.575 AF
 (DWR use only: Computer ID No. _____ GPS _____ feet North _____ feet West)
 This point will not be changed This point will be changed as follows:
Proposed point of diversion: (Complete only if change is requested)
 One in the _____ Quarter of the _____ Quarter of the _____ Quarter of Section _____, Township _____ South, Range _____ (E/W), in _____ County, Kansas, _____ feet North _____ feet West of Southeast corner of section.
 Proposed Rate _____ Proposed Quantity _____
 This point is: Additional Well Geo Center List other water rights that will use this point _____

- 11. Describe the current condition of and future plans for any point(s) of diversion which will no longer be used. City Well #16 will be properly abandoned when new City Well #19 is constructed.

IF MORE SPACE IS NEEDED, ATTACH ADDITIONAL SHEETS AS NECESSARY

RECEIVED
MAY 18 2016

SCANNED

- 6. The presently authorized point(s) of diversion (is) (are) _____
(Provide description and number of points)
- 7. The proposed point(s) of diversion (is) (are) _____
(Provide description and number of points)

List all presently authorized point(s) of diversion:

8. **Presently authorized point of diversion:** Well #6 (In Lot 5 of Special Section 11)
 One in the NE Quarter of the NW Quarter of the NW Quarter of Section 1, Township 12 South, Range 5 (E/W),
 in Geary County, Kansas, 4873 feet North 4564 feet West of Southeast corner of section.
 Authorized Rate 6250 gpm Authorized Quantity 4480.575 AF
 (DWR use only: Computer ID No. _____ GPS _____ feet North _____ feet West)
 This point will not be changed This point will be changed as follows:
Proposed point of diversion: (Complete only if change is requested)
 One in the _____ Quarter of the _____ Quarter of the _____ Quarter of Section _____, Township _____ South, Range _____ (E/W),
 in _____ County, Kansas, _____ feet North _____ feet West of Southeast corner of section.
 Proposed Rate _____ Proposed Quantity _____
 This point is: Additional Well Geo Center List other water rights that will use this point _____

9. **Presently authorized point of diversion:** Well #8 (In Special Section 12)
 One in the NW Quarter of the NW Quarter of the NW Quarter of Section 1, Township 12 South, Range 5 (E/W),
 in Geary County, Kansas, 5102 feet North 4992 feet West of Southeast corner of section.
 Authorized Rate 6250 gpm Authorized Quantity 4480.575 AF
 (DWR use only: Computer ID No. _____ GPS _____ feet North _____ feet West)
 This point will not be changed This point will be changed as follows:
Proposed point of diversion: (Complete only if change is requested)
 One in the _____ Quarter of the _____ Quarter of the _____ Quarter of Section _____, Township _____ South, Range _____ (E/W),
 in _____ County, Kansas, _____ feet North _____ feet West of Southeast corner of section.
 Proposed Rate _____ Proposed Quantity _____
 This point is: Additional Well Geo Center List other water rights that will use this point _____

10. **Presently authorized point of diversion:** Well #11 (In Lot 1 of Special Section 12)
 One in the SE Quarter of the SE Quarter of the SE Quarter of Section 35, Township 11 South, Range 5 (E/W),
 in Geary County, Kansas, 484 feet North 88 feet West of Southeast corner of section.
 Authorized Rate 6250 gpm Authorized Quantity 4480.575 AF
 (DWR use only: Computer ID No. _____ GPS _____ feet North _____ feet West)
 This point will not be changed This point will be changed as follows:
Proposed point of diversion: (Complete only if change is requested)
 One in the _____ Quarter of the _____ Quarter of the _____ Quarter of Section _____, Township _____ South, Range _____ (E/W),
 in _____ County, Kansas, _____ feet North _____ feet West of Southeast corner of section.
 Proposed Rate _____ Proposed Quantity _____
 This point is: Additional Well Geo Center List other water rights that will use this point _____

- 11. Describe the current condition of and future plans for any point(s) of diversion which will no longer be used. _____

IF MORE SPACE IS NEEDED, ATTACH ADDITIONAL SHEETS AS NECESSARY

WATER RESOURCES

MAY 18 2016

SCANNED

KS DEPT OF AGRICULTURE

- 6. The presently authorized point(s) of diversion (is) (are) _____
(Provide description and number of points)
- 7. The proposed point(s) of diversion (is) (are) _____
(Provide description and number of points)

List all presently authorized point(s) of diversion:

8. **Presently authorized point of diversion:** Well #12 (In Lot 1 of Special Section 12)
 One in the SE Quarter of the SE Quarter of the SE Quarter of Section 35, Township 11 South, Range 5 (E/W),
 in Geary County, Kansas, 229 feet North 465 feet West of Southeast corner of section.
 Authorized Rate 6250 gpm Authorized Quantity 4480.575 AF
 (DWR use only: Computer ID No. _____ GPS _____ feet North _____ feet West)
 This point will not be changed This point will be changed as follows:
Proposed point of diversion: (Complete only if change is requested)
 One in the _____ Quarter of the _____ Quarter of the _____ Quarter of Section _____, Township _____ South, Range _____ (E/W),
 in _____ County, Kansas, _____ feet North _____ feet West of Southeast corner of section.
 Proposed Rate _____ Proposed Quantity _____
 This point is: Additional Well Geo Center List other water rights that will use this point _____

9. **Presently authorized point of diversion:** Well #13 (In Lot 1 of Special Section 12)
 One in the NE Quarter of the SE Quarter of the SE Quarter of Section 35, Township 11 South, Range 5 (E/W),
 in Geary County, Kansas, 750 feet North 528 feet West of Southeast corner of section.
 Authorized Rate 6250 gpm Authorized Quantity 4480.575 AF
 (DWR use only: Computer ID No. _____ GPS _____ feet North _____ feet West)
 This point will not be changed This point will be changed as follows:
Proposed point of diversion: (Complete only if change is requested)
 One in the _____ Quarter of the _____ Quarter of the _____ Quarter of Section _____, Township _____ South, Range _____ (E/W),
 in _____ County, Kansas, _____ feet North _____ feet West of Southeast corner of section.
 Proposed Rate _____ Proposed Quantity _____
 This point is: Additional Well Geo Center List other water rights that will use this point _____

10. **Presently authorized point of diversion:** Well #14 (In Lot 2 of Special Section 12)
 One in the NW Quarter of the SE Quarter of the SE Quarter of Section 35, Township 11 South, Range 5 (E/W),
 in Geary County, Kansas, 1128 feet North 857 feet West of Southeast corner of section.
 Authorized Rate 6250 gpm Authorized Quantity 4480.575 AF
 (DWR use only: Computer ID No. _____ GPS _____ feet North _____ feet West)
 This point will not be changed This point will be changed as follows:
Proposed point of diversion: (Complete only if change is requested)
 One in the _____ Quarter of the _____ Quarter of the _____ Quarter of Section _____, Township _____ South, Range _____ (E/W),
 in _____ County, Kansas, _____ feet North _____ feet West of Southeast corner of section.
 Proposed Rate _____ Proposed Quantity _____
 This point is: Additional Well Geo Center List other water rights that will use this point _____

- 11. Describe the current condition of and future plans for any point(s) of diversion which will no longer be used. _____

IF MORE SPACE IS NEEDED, ATTACH ADDITIONAL SHEETS AS NECESSARY

WATER RESOURCES DIVISION

MAY 18 2016

SCANNED

KS DEPT OF AGRICULTURE

6. The presently authorized point(s) of diversion (is) (are) _____
(Provide description and number of points)
7. The proposed point(s) of diversion (is) (are) _____
(Provide description and number of points)

List all presently authorized point(s) of diversion:

8. **Presently authorized point of diversion:** Well #15 (In Lot 2 of Special Section 12)
 One in the SW Quarter of the NE Quarter of the SE Quarter
 of Section 35, Township 11 South, Range 5 (E/W),
 in Geary County, Kansas, 1551 feet North 1065 feet West of Southeast corner of section.
 Authorized Rate 6250 gpm Authorized Quantity 4480.575
 (DWR use only: Computer ID No. _____ GPS _____ feet North _____ feet West)
 This point will not be changed This point will be changed as follows:
Proposed point of diversion: (Complete only if change is requested)
 One in the _____ Quarter of the _____ Quarter of the _____ Quarter
 of Section _____, Township _____ South, Range _____ (E/W),
 in _____ County, Kansas, _____ feet North _____ feet West of Southeast corner of section.
 Proposed Rate _____ Proposed Quantity _____
 This point is: Additional Well Geo Center List other water rights that will use this point _____

9. **Presently authorized point of diversion:**
 One in the _____ Quarter of the _____ Quarter of the _____ Quarter
 of Section _____, Township _____ South, Range _____ (E/W),
 in _____ County, Kansas, _____ feet North _____ feet West of Southeast corner of section.
 Authorized Rate _____ Authorized Quantity _____
 (DWR use only: Computer ID No. _____ GPS _____ feet North _____ feet West)
 This point will not be changed This point will be changed as follows:
Proposed point of diversion: (Complete only if change is requested)
 One in the _____ Quarter of the _____ Quarter of the _____ Quarter
 of Section _____, Township _____ South, Range _____ (E/W),
 in _____ County, Kansas, _____ feet North _____ feet West of Southeast corner of section.
 Proposed Rate _____ Proposed Quantity _____
 This point is: Additional Well Geo Center List other water rights that will use this point _____

10. **Presently authorized point of diversion:**
 One in the _____ Quarter of the _____ Quarter of the _____ Quarter
 of Section _____, Township _____ South, Range _____ (E/W),
 in _____ County, Kansas, _____ feet North _____ feet West of Southeast corner of section.
 Authorized Rate _____ Authorized Quantity _____
 (DWR use only: Computer ID No. _____ GPS _____ feet North _____ feet West)
 This point will not be changed This point will be changed as follows:
Proposed point of diversion: (Complete only if change is requested)
 One in the _____ Quarter of the _____ Quarter of the _____ Quarter
 of Section _____, Township _____ South, Range _____ (E/W),
 in _____ County, Kansas, _____ feet North _____ feet West of Southeast corner of section.
 Proposed Rate _____ Proposed Quantity _____
 This point is: Additional Well Geo Center List other water rights that will use this point _____

11. Describe the current condition of and future plans for any point(s) of diversion which will no longer be used. _____

IF MORE SPACE IS NEEDED, ATTACH ADDITIONAL SHEETS AS NECESSARY

WATER RESOURCES RECEIVED

MAY 18 2016

SCANNED

KS DEPT OF AGRICULTURE

12. The presently authorized use of water is for Municipal purposes.
It is proposed that the use be changed to _____ purposes.

13. If changing the place of use and/or use made of water, describe how the consumptive use will not be increased.

(Please show any calculations here.)

14. It is requested that the maximum annual quantity of water be reduced to _____ (acre-feet or million gallons).
15. It is requested that the maximum rate of diversion of water be reduced to _____ gallons per minute (____ c.f.s.).

16. The application must include either a topographic map or detailed plat. A U.S. Geological Survey Topographic Map, scale 1:24,000, is available through the Kansas Geological Survey, 1930 Constant Avenue, University of Kansas, Lawrence, Kansas 66047-3726 (www.usgs.gov). The map should show the location of the presently authorized point(s) of diversion. Distances North and West of the Southeast corner of the section must be shown. The presently authorized place of use should also be shown. Identify the center of the section, the section lines and the section corners and show the appropriate section, township, and range numbers on the map. In addition the following information must also be shown on the map.

- a. If a change in the location of the point(s) of diversion is proposed, show:
 - 1) The location of the proposed point(s) of diversion. Distances North and West of the Southeast corner of the section must be shown. Please be certain that the information shown on the map agrees with the information shown in Paragraph Nos. 9, 10 and 11 of the application.
 - 2) If the source of supply is groundwater, please show the location of existing water wells of any kind, including domestic wells, within 1/2 mile of the proposed well or wells. Identify each well as to its use and furnish name and mailing address of the property owner or owners. If there are no wells within 1/2 mile, please indicate so on the map.
 - 3) If the source of supply is surface water, the names and mailing addresses of all landowner(s) 1/2 mile downstream and 1/2 mile upstream from your property lines must be shown.
- b. If a change in the place of use is desired, show the proposed place of use by crosshatching on the map. Please be certain that the information shown on the map agrees with the information shown in Paragraph No. 5 of the application.

17. Attach documentation to show the change(s) proposed herein will not impair existing water rights and relates to the same local source of supply as to which the water right relates. This information may include statements, plats, geology reports, well logs, test hole logs, and other information as necessary information to show the above. Additional comments may be made below.

See Attached.

18. If the proposed change(s) does not meet all applicable rules and regulations of the Kansas Water Appropriation Act, please identify the rules and regulations for which you request a waiver. State the reason why a waiver is needed and why the request should be granted. Attach documentation showing that granting the request will not impair existing water rights and will not prejudicially and unreasonably affect the public interest.

KAR 5-3-11 Safe Yield - Unconfined Aquifer and KAR 5-4-4 Well Spacing. See Attached

IF MORE SPACE IS NEEDED, ATTACH ADDITIONAL SHEETS AS NEEDED

WATER RESOURCES RECEIVED

MAY 18 2016

SCANNED

KS DEPT OF AGRICULTURE

Any use of water that is not as authorized by the water right or permit to authorize water **before** the chief engineer approves this application is a violation of the Kansas Water Appropriation Act for which criminal or civil penalties may be assessed. Such violation is a class C misdemeanor, punishable by a fine not to exceed \$500 and/or a term of confinement not to exceed one month in the county jail. K.S.A. 82a-728(b). Civil penalties shall be not less than \$100 nor more than \$1,000 per violation. In the case of a continuing violation, each day such violation continues may be deemed a separate violation. In addition to these penalties the water right may be modified or suspended. K.S.A. 82a-737, as amended.

The application must be signed by all owners of the place of use authorized under the water right and his or her spouse, if married. Please indicate if there is no spouse. If land is being purchased under contract, the seller must sign as landowner until such time as the contract is completed.

In the event that all applicants cannot appear before one notary public, they may as necessary sign separate copies of the application before any notary public conveniently available to them. All copies signed in this manner shall be considered to be valid parts of the application.

If the request is signed on behalf of any Owner by someone with legal authority to do so (for example, an agent, one who has power of attorney, or an executor, executrix, conservator), it will be necessary to attach proper documents showing such authority.

I declare that I am an owner of the currently authorized place of use as identified herein, or that I represent all such owners and am authorized to make this application on their behalf, and declare further that the statements contained herein are true, correct, and complete. By filing this application I authorize the chief engineer to permanently reduce the quantity of water and/or rate of diversion as specified in sections 14 and 15 of this application.

Dated at Junction City, Kansas, this 4th day of May, 2016.

<u>[Signature]</u> (Owner)	_____	(Spouse)
<u>Allen J. Dinkel, City Manager</u> (Please Print)	_____	(Please Print)
_____	_____	(Spouse)
_____	_____	(Please Print)
_____	_____	(Spouse)
_____	_____	(Please Print)

State of Kansas }
County of geary } SS



I hereby certify that the foregoing application was signed in my presence and sworn to before me this 4th day of May, 2016.

[Signature]
Notary Public

My Commission Expires 9/1/2019

FEE SCHEDULE

Each application to change the place of use, the point of diversion or the use made of the water under this section shall be accompanied by the application fee set forth in the schedule below:

- (1) Application to change a point of diversion 300 feet or less \$100
- (2) Application to change a point of diversion more than 300 feet \$200
- (3) Application to change the place of use \$200
- (4) Application to change the use made of the water \$300

Make check payable to **Kansas Department of Agriculture.**

**WATER RESOURCES
RECEIVED**

MAY 18 2016

SCANNED

KS DEPT OF AGRICULTURE

Known Wells Located Within 1/2 Mile Radius
Change of Point of Diversion Application for Well #19

WELL DESIGNATION	WELL USE	TWN	RNG	SEC	SPOT	LONGITUDE	LATITUDE	OWNER NAME	OWNER ADDRESS	CITY	STATE	ZIP
Lisle	Domestic	12S	5E	1	NW NW NW	-96.831292	39.043805	Frank Lisle	1830 N Jefferson St	Junction City	KS	66441
Junction City OW1	Obs Well	11S	5E	35	NW SE SE	-96.836721	39.049168	City of Junction City	P.O. Box 287	Junction City	KS	66441
Junction City OW2	Obs Well	11S	5E	35	SW SE SE	-96.838168	39.048687	City of Junction City	P.O. Box 287	Junction City	KS	66441
Junction City OW3	Test Well	11S	5E	35	SE NE SW	-96.842656	39.051399	City of Junction City	P.O. Box 287	Junction City	KS	66441
Junction City OW4	Test Well	11S	5E	35	NE SW SE	-96.838168	39.048687	City of Junction City	P.O. Box 287	Junction City	KS	66441
Junction City OW 150 P 15	Obs Well	11S	5E	35	SW NE SE	-96.836079	39.048358	City of Junction City	P.O. Box 287	Junction City	KS	66441
Junction City OW 95 R 15	Obs Well	11S	5E	35	SW NE SE	-96.836581	39.0484574	City of Junction City	P.O. Box 287	Junction City	KS	66441
Junction City OW 95 P 15	Obs Well	11S	5E	35	SW NE SE	-96.836145	39.048467	City of Junction City	P.O. Box 287	Junction City	KS	66441
Junction City Well #11	Municipal	11S	5E	35	SE SE SE	-96.83284	39.047376	City of Junction City	P.O. Box 287	Junction City	KS	66441
Junction City Well #12	Municipal	11S	5E	35	SE SE SE	-96.834249	39.046946	City of Junction City	P.O. Box 287	Junction City	KS	66441
Junction City Well #13	Municipal	11S	5E	35	NE SE SE	-96.834509	39.04833	City of Junction City	P.O. Box 287	Junction City	KS	66441
Junction City Well #14	Municipal	11S	5E	35	NW SE SE	-96.835702	39.04935	City of Junction City	P.O. Box 287	Junction City	KS	66441
Junction City Well #15	Municipal	11S	5E	35	SW NE SE	-96.836346	39.050549	City of Junction City	P.O. Box 287	Junction City	KS	66441
Junction City Well #16	Municipal	11S	5E	35	SW SE SE	-96.836343	39.047983	City of Junction City	P.O. Box 287	Junction City	KS	66441
Junction City Well #17	Municipal	11S	5E	36	SW SW SW	-96.831483	39.046293	City of Junction City	P.O. Box 287	Junction City	KS	66441
Junction City Well #18	Municipal	12S	5E	1	NE NW NW	-96.831729	39.045604	City of Junction City	P.O. Box 287	Junction City	KS	66441
Junction City Well #6	Municipal	12S	5E	1	NE NW NW	-96.83241	39.045147	City of Junction City	P.O. Box 287	Junction City	KS	66441
Junction City Well #8	Municipal	12S	5E	1	NW NW NW	-96.833893	39.0458	City of Junction City	P.O. Box 287	Junction City	KS	66441

Note: In the Aug 2014 applications submittals for Files Nos. 49126 through 49130, an industrial well had been located from KGS WWC5 records as being located within the 1/2 mile radius. However, this 2007 well for Midwest Concrete Materials was later found to be a driller locating error as this well is actually a DWR point of diversion for File No. 46435 and is located a mile northwest of the Junction City well field.

SCANNED

KS DEPT OF AGRICULTURE

WATER RESOURCES
RECEIVED
MAY 18 2016

LOCATION OF WATER WELL: County: Geary Fraction: SW 1/4 SE 1/4 SE 1/4 Section Number: 35 Township Number: T 11 S Range Number: R 5 E

Distance and direction from nearest town or city street address of well if located within city?

JUNCTION CITY WATER TREATMENT PLANT Well #16

WATER WELL OWNER: City Water Department
 #, St. Address, Box #: P.O. Box 287
 State, ZIP Code: Junction City, Kansas 66441
 Board of Agriculture, Division of Water Resources
 Application Number:

LOCATE WELL'S LOCATION WITH IN "X" IN SECTION BOX: DEPTH OF COMPLETED WELL: 60.5 ft. ELEVATION: BGL

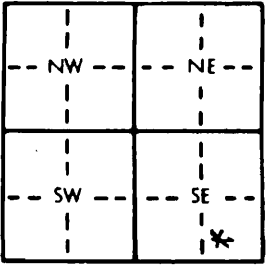

Depth(s) Groundwater Encountered 1. 20 ft. 2. ft. 3. ft.
 WELL'S STATIC WATER LEVEL 20 ft. below land surface measured on mo/day/yr
 Pump test data: Well water was ft. after hours pumping gp
 Est. Yield 1000 gpm: Well water was 35 ft. after 6 hours pumping 1000 gp
 Bore Hole Diameter: 36 in. to ft., and in. to
 WELL WATER TO BE USED AS: 5 Public water supply 8 Air conditioning 11 Injection well
 1 Domestic 3 Feedlot 6 Oil field water supply 9 Dewatering 12 Other (Specify below)
 2 Irrigation 4 Industrial 7 Lawn and garden only 10 Monitoring well
 Was a chemical/bacteriological sample submitted to Department? Yes No ; If yes, mo/day/yr sample was submitted
 Water Well Disinfected? Yes No

TYPE OF BLANK CASING USED: 1 Steel 3 RMP (SR) 5 Wrought iron 8 Concrete tile CASING JOINTS: Glued Clamped
 2 PVC 4 ABS 6 Asbestos-Cement 9 Other (specify below) Welded
 7 Fiberglass Threaded

Blank casing diameter: 16 in. to ft., Dia. in. to ft., Dia. in. to ft.
 Casing height above land surface: 144 in., weight lbs./ft. Wall thickness or gauge No.

TYPE OF SCREEN OR PERFORATION MATERIAL: 1 Steel 3 Stainless steel 5 Fiberglass 7 PVC 10 Asbestos-cement
 2 Brass 4 Galvanized steel 6 Concrete tile 8 RMP (SR) 11 Other (specify)
 12 None used (open hole)

SCREEN OR PERFORATION OPENINGS ARE: 1 Continuous slot 3 Mill slot 5 Gauzed wrapped 8 Saw cut 11 None (open hole)
 2 Louvered shutter 4 Key punched 6 Wire wrapped 9 Drilled holes
 7 Torch cut 10 Other (specify)

SCREEN-PERFORATED INTERVALS: From 40 ft. to 60 ft. From ft. to ft.
 From ft. to ft. From ft. to ft.

GRAVEL PACK INTERVALS: From 20 ft. to 60 ft. From ft. to ft.
 From ft. to ft. From ft. to ft.

GROUT MATERIAL: 1 Neat cement 2 Cement grout 3 Bentonite 4 Other
 Grout Intervals: From 0 ft. to 20 ft. From ft. to ft. From ft. to ft.

What is the nearest source of possible contamination: 1 Septic tank 4 Lateral lines 7 Pit privy 11 Fuel storage 15 Oil well/Gas well
 2 Sewer lines 5 Cess pool 8 Sewage lagoon 12 Fertilizer storage 16 Other (specify below)
 3 Watertight sewer lines 6 Seepage pit 9 Feedyard 13 Insecticide storage REP. RIVER
 How many feet? 700'

FROM	TO	LITHOLOGIC LOG	FROM	TO	PLUGGING INTERVALS
0	2	top soil			
2	7	brown clay			
7	17	fine to coarse sand w/layers flat rock			
17	44	fine to coarse sand w/tan clay layers of flat rock			
44	58	med to coarse sand			
58		limestone shale			

WATER RESOURCES RECEIVED
 MAY 18 2016

SCANNED

KS DEPT OF AGRICULTURE

CONTRACTOR'S OR LANDOWNER'S CERTIFICATION: This water well was (1) constructed, (2) reconstructed, or (3) plugged under my jurisdiction and was completed on (mo/day/year) 8/10/90 and this record is true to the best of my knowledge and belief. Kansas Well Contractor's License No. 102 W This Water Well Record was completed on (mo/day/yr) 9/4/90
 for the business name of Layne Western Co., Wichita, Ks. by (signature) [Signature] B. Meier

9608202058



1320 Research Park Drive
Manhattan, Kansas 66502
Jackie McClaskey, Secretary

Phone: (785) 564-6700
Fax: (785) 564-6777
Email: ksag@kda.ks.gov
www.agriculture.ks.gov
Sam Brownback, Governor

CITY OF JUNCTION CITY
700 N JEFFERSON PO BOX 287
JUNCTION CITY KS 66441

May 18, 2016

RE: File No. 23804

Dear Sir or Madam:

An application for approval of the Chief Engineer to change the following condition or conditions of the file number referred to above has been received:

- place of use
- point of diversion
- use made of water

As a matter of record, the Division of Water Resources has on hand a large number of applications awaiting processing. Therefore to be fair to all concerned, and so that we can process those applications on hand in the order they were received, we intend to concentrate on the backlog of applications until the issue is resolved. You will be contacted regarding this application as soon as it has been examined.

In accordance with the provisions of the Kansas Water Appropriation Act, a portion of which is included below, the use of water prior to approval of the application is unlawful. You should not proceed and divert water as indicated by your plans in your application for a change for this file until you receive approval for this change from the Chief Engineer. Once approved, compliance with the terms, conditions and limitations of the permit is necessary. Conservation of the water resources of Kansas is required.

Section 82a-728 of the Kansas Water Appropriation Act, provides (a) except for the appropriation of water for the purpose of domestic use, . . . it shall be unlawful for any person to appropriate or threaten to appropriate water from any source without first applying for and obtaining a permit to appropriate water in accordance with the provisions of the Water Appropriation Act or for any person to violate any condition of a vested right, appropriation right or an approved application for a permit to appropriate water for beneficial use.

(b) (1) The violation of any provision of this section by any person is a class C misdemeanor...

A class C misdemeanor is punishable by a fine not to exceed \$500 and/or a term of confinement not to exceed one month in the county jail. Each day that the violation occurs constitutes a separate offense.

If you have any questions, please contact me at (785) 564-6645. If you wish to discuss a specific file, please have the file number ready so that we may help you more efficiently.

Sincerely,

Brent A Turney, L.G.
Change Applications Unit Supervisor
Water Appropriation Program

BAT: ALH
pc: TOPEKA Field Office GMD

SCANNED

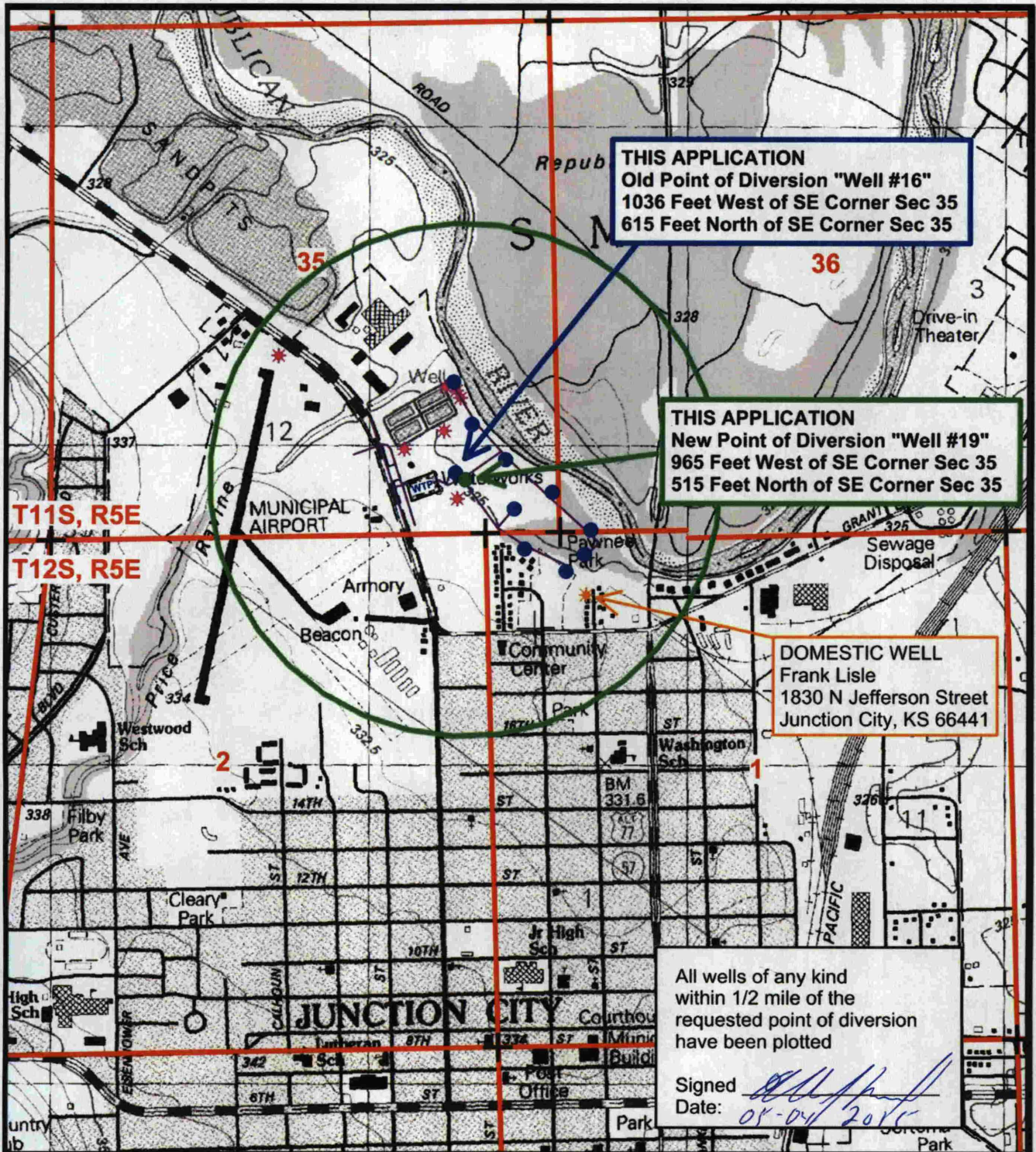

LEGEND

- Well #19 - Proposed New Location
- Junction City Production Well
- * Junction City Observation Well
- * Other Well
- 1/2 Mile Radius
- 35 Section Number
- + Section Corner
- Section Line
- Water Pipeline

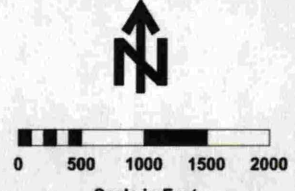

Base map adapted from USGS Topo Quad

WATER RESOURCES RECEIVED

Application to Change the Point of Diversion under File No. 23,804

MAY 18 2016

