

File No. 49,558-A	15. Formation Code: 113	Drainage Basin: Kansas River	County: JF	Special Use:	Stream:																		
16. Points of Diversion					17. Rate and Quantity																		
T MOD DEL ENT	PDIV	Qualifier	S	T	R	ID	'N	'W	Authorized Rate gpm	Quantity AF	Additional Rate gpm	Quantity AF	Overlap PD Files										
MOD	73491	NE NW NE	19	11S	17E	3	5102	1365	1000	72.8	530	24.8	46,657										
18. Storage: Rate _____ NF Quantity _____ ac/ft Additional Rate _____ NF Additional Quantity _____ ac/ft																							
19. Limitation: 72.8 af/yr at 1000 gpm (2.23 cfs) when combined with file number(s) 46,657																							
Limitation: _____ af/yr at _____ gpm (_____ cfs) when combined with file number(s) _____																							
20. Meter Required? <input checked="" type="checkbox"/> Yes <input type="checkbox"/> No To be installed by 12/31/2017 Date Acceptable Meter Installed _____																							
21. Place of Use		NE¼				NW¼				SW¼				SE¼				Total	Owner	Chg? NO	Overlap Files		
T MOD DEL ENT	PUSE	S	T	R	ID	NE ¼	NW ¼	SW ¼	SE ¼	NE ¼	NW ¼	SW ¼	SE ¼	NE ¼	NW ¼	SW ¼	SE ¼						
√	58419					26.5	22.0												48.5	7a.	No	46,657	
Comments: FILE NO. 46,657 CHANGE IN PU WILL CREATE COMPLETE OVERLAP																							

KANSAS DEPARTMENT OF AGRICULTURE
Division of Water Resources

M E M O R A N D U M

TO: Files

DATE: July 13, 2016

FROM: Austin McColloch

RE: New Application, File No. 49,558-A
Change Application, File No. 46,657

Robert W. Shirley has filed the referenced new application, File No. 49,558-A, to appropriate 72.8 acre-feet of groundwater at a rate of diversion of 1,000 gallons per minute for irrigation use on a specialty crop. The existing point of diversion is a well located in the Northeast Quarter, of Section 19, Township 11 South, Range 17 East, Jefferson County, Kansas. The source of water is the alluvial deposits of the Kansas River. At the current time, the proposed place of use partially overlaps Water Right, File No. 46,657. However, a pending Change Application for 46,657 has been filed in conjunction with the new application to create a complete overlap in the place of use. The new application & change application will be processed and signed as a package. The proposed place of use is owned by the Robert W. & Sally D. Shirley.

The quantity of 72.8 acre-feet will provide 1.5 acre-feet per acre which should be reasonable to irrigate a specialty crop, Sod Grass, in the proposed place of use. The requested rate of diversion, 1,000 gpm, appears to be reasonable to operate the proposed irrigation system and cover the place of use. Application, File No. 49,558-A will be limited to 72.8 acre-feet at 1,000 gallons per minute when combined with Water Right, File No. 46,657.

The division identified multiple nearby wells within one-half mile and nearby notification letters were sent on May 11, 2016 & June 8, 2016. No responses of any kind have been received.

Based on a safe yield analysis with a 6,249 acre area, 75% recharge, & 8.52 inches of annual recharge, there are 5,467.85 acre-feet of existing appropriations with 3,327.59 acre-feet allowable for appropriation. However, information from the Topeka Filed Office indicate per multiple senior files in the area, 80% of the quantity of water under File Nos. 7,113 & 32,635 is non-consumptive and is to be deducted from the prior appropriations, a total of 2,317.38 acre-feet. Thus the newly calculated existing appropriations in the area of analysis is 3,150.47 acre-feet, providing a total quantity of water available for appropriation of 177.13 acre-feet. Based off these calculations the application meets the safe yield requirements of K.A.R. 5-3-11. This new application will provide 24.8 acre-feet additional and 520 gallons per minute additional when combined with Water Right, File No. 46,657.

A waiver request has been requested for K.A.R. 5-3-10 with the justification of: Proposed quantity fails to meet safe yield requirements within area of consideration. Approval was based on calculations removing non-consumptive quantity from the appropriated total, consistent with previous files in this immediate area.

The proposed point of diversion meets the minimum well spacing requirements of K.A.R. 5-4-4, 660 feet to existing domestic wells and 1,320 feet to existing non-domestic wells. The nearest domestic well is over 1,500 feet away and no non-domestic wells were identified.

The proposed change under Water Right, File No. 46,657 complies with K.A.R. 5-5-11, as the change is only proposing to create a complete overlap in the place of use with the new application. Application, File No. 49,558-A is sufficient to cover any increase in the consumptive use.

In an email conversation on July 13, 2016, Topeka Field Office Water Commissioner, Katie Tietsort, recommended approval of the applications.

In accordance with K.S.A. 82a-706c, the Chief Engineer retains full authority to require any water user to install meters, gages, or other measuring devices, which devices he or she or his or her agents may read at any time. Water flowmeter requirements are further described in K.A.R. 5-1-4 through K.A.R. 5-1-12. If any chemical or foreign substance is injected into the water pumped under this permit, a check valve will also need to be installed.

Based on the above discussion, the application meets safe yield and well spacing criteria, and approval of the application should not impair senior water rights nor prejudicially or unreasonably affect the public interest, it is recommended that the referenced new application be approved in conjunction with the change in place of use under Water Right, File No. 46,657. The change is reasonable, impairment of existing water rights is unlikely, and the additional quantity requested under New Application, File No. 49,558-A, is sufficient to cover any increase in the consumptive use, it is recommended that the referenced change application in place of use also be approved.

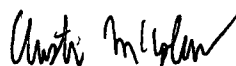

Austin McColloch
Environmental Scientist

THE STATE OF KANSAS



KANSAS DEPARTMENT OF AGRICULTURE
Jackie McClaskey, Secretary of Agriculture

DIVISION OF WATER RESOURCES
David W. Barfield, Chief Engineer

WAIVER OF REGULATION
K.A.R. 5-3-10 - Safe Yield

Date: July 19, 2016

Re: Application, File No. 49,558-A

1. That K.A.R. 5-3-10 states in part, that the approval of any new application to appropriate groundwater for beneficial use, shall not cause the safe yield of the source of water supply to be exceeded. Based on the safe yield evaluation in K.A.R. 5-3-11, the area of consideration is fully appropriated and no additional water is available for this application.
2. That included within this area of consideration are two industrial water rights (File Nos. 7,113 and 32,635), which authorize a total quantity of 2,896.73 acre-feet of groundwater.
3. That an extensive review of Water Right, File Nos. 7,113 and 32,635, documented in memorandums to file (File No. 45,898), dated January 12, 2005 and March 21, 2005 has determined that approximately 80% of the water diverted under these water rights is returned to the Kansas River. It was also determined that the water is discharged in the same local area where it is withdrawn from the aquifer.
4. That by considering 80% of the water usage under these water rights to be non-consumptive (i.e. returned to the source in the local area), the impact of these water rights on the local aquifer is significantly less than what the authorized quantity would indicate.
5. That a re-evaluation of safe yield for Application, File No. 49,558-A by subtracting 80% of the 2,896.73 acre-feet ($2,896.73 \text{ acre-feet} \times 0.8 = 2,317.38 \text{ acre-feet}$) authorized under Water Right, File Nos. 7,113 and 32,635, decreased the quantity of water already appropriated, resulting in an increased quantity of water available for appropriation within the area of consideration. The quantity of water available for appropriation increased from zero to 177.13 acre-feet.
6. That water would be available for pending Application, File No. 49,558-A, which is requesting 72.8 acre-feet of ground water (24.8 acre-feet additional).
7. That this evaluation and calculation of safe yield is consistent with previously approved files in the immediate area.
8. That a waiver of safe yield will not prejudicially or unreasonably affect the public interest and should not impair any existing water rights because of the substantial quantity of water being returned to the local aquifer under Water Right, File Nos. 7,113 and 32,635.

Comments:

A handwritten signature in black ink that reads "David W. Barfield".

David W. Barfield, P.E.
Chief Engineer
Division of Water Resources

Kansas Department of Agriculture
 Division of Water Resources
WAIVER REQUEST & WAIVER RULE WORKSHEET

File Number: 49,558-A

FO: 1 GMD: 0

WAIVER REQUEST:

UMW	Date Requested	Rule ID	Applies	Rule Type	Rule Subtype
IRR	4/26/2016	52	Statewide	Safe Yield	Yield of The Source Area Exceeded
Rule Number	Date Granted	Date Denied	Justification:	Proposed quantity fails to meet safe yield requirements within area of consideration. Approval was based on calculations removing non-consumptive quantity from the appropriated total, consistent with previous files in this immediate area.	
K.A.R. 5-3-10	7/19/2016				

WAIVER RULE:

Rule ID	Applicability	Type	Subtype	Rule Number	Date Active	Date Inactive

Date Prepared 4/26/2016 By DWS

Date Entered 7/20/2016 By UM

1320 Research Park Drive
Manhattan, Kansas 66502
(785) 564-6700



900 SW Jackson, Room 456
Topeka, Kansas 66612
(785) 296-3556

Jackie McClaskey, Secretary

Governor Sam Brownback

July 22, 2016

ROBERT W & SALLY D SHIRLEY
3703 SOUTH ST
GRANTVILLE KS 66429

RE: Appropriation of Water, File No. 49,558-A

Dear Mr. and Mrs. Shirley:

There is enclosed a permit to appropriate water authorizing you to proceed with construction of the proposed diversion works (except those dams and stream obstructions regulated by K.S.A. 82a-301 through 305a), to divert such unappropriated water as may be available from the source and at the location specified in the permit, and to use it for the purpose and at the location described in the permit.

Your attention is directed to the enclosures and to the terms, conditions, and limitations specified in these approval documents, with specific reference to Paragraph No. 18 concerning your quantity of water limitation when combined with your senior Water Right, File No. 46,657 for irrigation use. A water meter is required on the proposed diversion works and you must install it prior to water being put to beneficial use in order for you to maintain accurate records of water use. The meter should be used to provide the information required on the annual water use report.

Failure to notify the Chief Engineer of the Division of Water Resources of the completion of the diversion works within the time allowed, or within any authorized extension of time thereof, will result in the dismissal of this permit. Enclosed is a form which may be used to notify the Chief Engineer that the proposed diversion works have been completed.

All requests for extensions of time to complete diversion works, or to perfect appropriations, must be submitted to the Chief Engineer before the expiration of time originally set forth in the permit to complete diversion works or to perfect an appropriation. If for any reason, you require an extension of time, you must request it before the expiration of time set forth in this permit. Failure to comply with this regulation will result in the dismissal of your permit or your water right. Any request for an extension of time shall be accompanied by the required statutory fee, which is currently \$100.00.

There is also enclosed an information sheet setting forth the procedure to obtain a Certificate of Appropriation which will establish the extent of your water right. If you have any questions, please contact me at (785) 564-6645. If you wish to discuss this specific file, please have the file number ready so that we may help you more efficiently.

Sincerely,

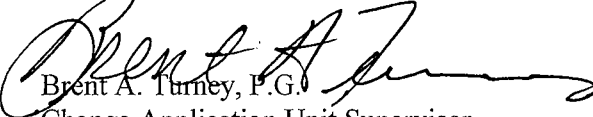
Brent A. Turney, P.G.
Change Application Unit Supervisor
Water Appropriation Program

BAT:dws

Enclosures

pc: Topeka Field Office



KANSAS DEPARTMENT OF AGRICULTURE
 Jackie McClaskey, Secretary of Agriculture

DIVISION OF WATER RESOURCES
 David W. Barfield, Chief Engineer

**APPROVAL OF APPLICATION
 and
 PERMIT TO PROCEED**
 (This Is Not a Certificate of Appropriation)

This is to certify that I have examined Application, **File No. 49,558-A** of the applicant

**ROBERT W SHIRLEY
 3703 SOUTH ST
 GRANTVILLE KS 66429**

for a permit to appropriate water for beneficial use, together with the maps, plans and other submitted data, and that the application is hereby approved and the applicant is hereby authorized, subject to vested rights and prior appropriations, to proceed with the construction of the proposed diversion works (except those dams and stream obstructions regulated by K.S.A. 82a-301 through 305a, as amended), and to proceed with all steps necessary for the application of the water to the approved and proposed beneficial use and otherwise perfect the proposed appropriation subject to the following terms, conditions and limitations:

1. That the priority date assigned to such application is **February 12, 2016**.
2. That the water sought to be appropriated shall be used for irrigation use on land described in the application, as follows:

Sec. Twp. Range	NE¼				NW¼				SW¼				SE¼				TOTAL
	NE¼	NW¼	SW¼	SE¼	NE¼	NW¼	SW¼	SE¼	NE¼	NW¼	SW¼	SE¼	NE¼	NW¼	SW¼	SE¼	
19 11S 17E	26.5	22.0															48.5

3. That the authorized source from which the appropriation shall be made is groundwater, to be withdrawn by means of one (1) well located in the Northeast Quarter of the Northwest Quarter of the Northeast Quarter (NE¼ NW¼ NE¼) of Section 19, more particularly described as being near a point 5,102 feet North and 1,365 feet West of the Southeast corner of said section, in Township 11 South, Range 17 East, Jefferson County, Kansas, located substantially as shown on the topographic map accompanying the application.
4. That the appropriation sought shall be limited to a maximum diversion rate not in excess of **1,000 gallons per minute (2.23 c.f.s.)** and to a quantity not to exceed **72.8 acre-feet** of water for any calendar year.
5. That installation of works for diversion of water shall be completed on or before **December 31, 2017**, or within any authorized extension thereof. The applicant shall notify the Chief Engineer and pay the statutorily required field inspection fee, which is currently \$400.00, when construction of the works has been completed. Failure to timely submit the notice and the fee will result in revocation of the permit. Any request for an extension of time shall be accompanied by the required statutory fee, which is currently \$100.00.

6. That the proposed appropriation shall be perfected by the actual application of water to the proposed beneficial use on or before **December 31, 2021**, or any authorized extension thereof. Any request for an extension of time shall be submitted prior to the expiration of the deadline and shall be accompanied by the required statutory fee, which is currently \$100.00.

7. That the applicant shall not be deemed to have acquired a water appropriation for a quantity in excess of the amount approved herein nor in excess of the amount found by the Chief Engineer to have been actually used for the approved purpose during one calendar year subsequent to approval of the application and within the time specified for perfection or any authorized extension thereof.

8. That the use of water herein authorized shall not be made so as to impair any use under existing water rights nor prejudicially and unreasonably affect the public interest.

9. That the right of the appropriator shall relate to a specific quantity of water and such right must allow for a reasonable raising or lowering of the static water level and for the reasonable increase or decrease of the streamflow at the appropriator's point of diversion.

10. That this permit does not constitute authority under K.S.A. 82a-301 through 305a to construct any dam or other obstruction; nor does it grant any right-of-way, or authorize entry upon or injury to, public or private property.

11. That all diversion works constructed under the authority of this permit into which any type of chemical or other foreign substance will be injected into the water pumped from the diversion works shall be equipped with an in-line, automatic quick-closing, check valve capable of preventing pollution of the source of the water supply. The type of valve installed shall meet specifications adopted by the Chief Engineer and shall be maintained in an operating condition satisfactory to the Chief Engineer.

12. That all wells with a diversion rate of 100 gallons per minute or more drilled under the authority of this permit shall have a tube or other device installed in a manner acceptable to, and in accordance with specifications adopted by, the Chief Engineer. This tube or device shall be suitable for making water level measurements and shall be maintained in a condition satisfactory to the Chief Engineer.

13. That an acceptable water flow meter shall be installed and maintained on the diversion works authorized by this permit in accordance Kansas Administrative Regulations 5-1-4 through 5-1-12 adopted by the Chief Engineer. This water flow meter shall be used to provide an accurate quantity of water diverted as required for the annual water use report (including the meter reading at the beginning and end of the report year).

14. That the applicant shall maintain accurate and complete records from which the quantity of water diverted during each calendar year may be readily determined and the applicant shall file an annual water use report with the Chief Engineer by March 1 following the end of each calendar year. Failure to file the annual water use report by the due date shall cause the applicant to be subject to a civil penalty.

15. That no water user shall engage in nor allow the waste of any water diverted under the authority of this permit.

16. That failure without cause to comply with provisions of the permit and its terms, conditions and limitations will result in the forfeiture of the priority date, revocation of the permit and dismissal of the application.

CERTIFICATE OF SERVICE

On this *22nd* day of *July*, 2016, I hereby certify that the foregoing Approval of Application, File No. 49,558-A, dated *July 19, 2016* was mailed postage prepaid, first class, US mail to the following:

ROBERT W & SALLY D SHIRLEY
3703 SOUTH ST
GRANTVILLE KS 66429

With photocopies to:

Topeka Field Office

Lindsey Erskm

Division of Water Resources

APPLICATION COMPLETE

2/12/2016

Reviewer DWS

THE STATE



OF KANSAS

KANSAS DEPARTMENT OF AGRICULTURE
Jackie McClaskey, Secretary of Agriculture

DIVISION OF WATER RESOURCES
David W. Barfield, Chief Engineer

WATER RESOURCES RECEIVED

File Number 49,558 - A
This item to be completed by the Division of Water Resources.

WATER RESOURCES RECEIVED

MAY 26 2016
11:04
KS DEPT OF AGRICULTURE

APPLICATION FOR PERMIT TO APPROPRIATE WATER FOR BENEFICIAL USE

Filing Fee Must Accompany the Application
(Please refer to Fee Schedule attached to this application form.)

FEB 12 2016
8:25
KS DEPT OF AGRICULTURE

To the Chief Engineer of the Division of Water Resources, Kansas Department of Agriculture,
1320 Research Park Drive, Manhattan, KS 66502:

1. Name of Applicant (Please Print): ROBERT W SHIRLEY
Address: 3703 SOUTH ST
City: GRANTVILLE State KS Zip Code 66429
Telephone Number: (785) 246-3317

2. The source of water is: surface water in _____ (stream)
OR groundwater in KANSAS RIVER Basin (drainage basin)

Certain streams in Kansas have minimum target flows established by law or may be subject to administration when water is released from storage for use by water assurance district members. If your application is subject to these regulations on the date we receive your application, you will be sent the appropriate form to complete and return to the Division of Water Resources.

3. The maximum quantity of water desired is 72.8 acre-feet OR _____ gallons per calendar year, to be diverted at a maximum rate of 1000 gallons per minute OR _____ cubic feet per second.

Once your application has been assigned a priority, the requested maximum rate of diversion and maximum requested quantity of water under that priority number can **NOT** be increased. Please be certain your requested maximum rate of diversion and maximum quantity of water are appropriate and reasonable for your proposed project and are in agreement with the Division of Water Resources' requirements.

4. The water is intended to be appropriated for (Check use intended):
(a) Artificial Recharge (b) Irrigation (c) Recreational (d) Water Power
(e) Industrial (f) Municipal (g) Stockwatering (h) Sediment Control
(i) Domestic (j) Dewatering (k) Hydraulic Dredging (l) Fire Protection
(m) Thermal Exchange (n) Contamination Remediation

YOU **MUST** COMPLETE AND ATTACH ADDITIONAL DIVISION OF WATER RESOURCES FORM(S) PROVIDING INFORMATION TO SUBSTANTIATE YOUR REQUEST FOR THE AMOUNT OF WATER FOR THE INTENDED USE REFERENCED ABOVE.

For Office Use Only:
F.O. 1 GMD 0 Meets K.A.R. 5-3-1 (YES/NO) Use IRR Source GDS County JF By ASW Date 2/15/16
Code _____ REG Fee \$ 200 TR # 16277959 Receipt Date 2/12/16 Check # 11837

DWR 1-100 (Revised 02/16/2011) APPLICATION COMPLETE
7/13/2016 SCANNED
Reviewer AM 2/16/2016 LLM

5. The location of the proposed wells, pump sites or other works for diversion of water is:

Note: For the application to be accepted, the point of diversion location must be described to at least a 10 acre tract, unless you specifically request a 60 day period of time in which to locate the site within a specifically described, minimal legal quarter section of land.

(A) One in the NE quarter of the NW quarter of the NE quarter of Section 19, more particularly described as being near a point 5102 feet North and 1365 feet West of the Southeast corner of said section, in Township 11 South, Range 17 East, JEFFERSON County, Kansas. (pdiv ID: 73491)

(B) One in the _____ quarter of the _____ quarter of the _____ quarter of Section _____, more particularly described as being near a point _____ feet North and _____ feet West of the Southeast corner of said section, in Township _____ South, Range _____ East/West (circle one), _____ County, Kansas:

(C) One in the _____ quarter of the _____ quarter of the _____ quarter of Section _____, more particularly described as being near a point _____ feet North and _____ feet West of the Southeast corner of said section, in Township _____ South, Range _____ East/West (circle one), _____ County, Kansas.

(D) One in the _____ quarter of the _____ quarter of the _____ quarter of Section _____, more particularly described as being near a point _____ feet North and _____ feet West of the Southeast corner of said section, in Township _____ South, Range _____ East/West (circle one), _____ County, Kansas.

If the source of supply is groundwater, a separate application shall be filed for each proposed well or battery of wells, except that a single application may include up to four wells within a circle with a quarter (1/4) mile radius in the same local source of supply which do not exceed a maximum diversion rate of 20 gallons per minute per well.

A battery of wells is defined as two or more wells connected to a common pump by a manifold; or not more than four wells in the same local source of supply within a 300 foot radius circle which are being operated by pumps not to exceed a total maximum diversion rate of 800 gallons per minute and which supply water to a common distribution system.

6. The owner of the point of diversion, if other than the applicant is (please print):

Applicant ROBERT W. SHIRLEY 3703 SO. ST. GRANTVILLE, KS 66429
(name, address and telephone number)

Sally D. Shirley 3703 South St Grantville, Ks. 66429
(name, address and telephone number)

You must provide evidence of legal access to, or control of, the point of diversion from the landowner or the landowner's authorized representative. Provide a copy of a recorded deed, lease, easement or other document with this application. In lieu thereof, you may sign the following sworn statement:

I have legal access to, or control of, the point of diversion described in this application from the landowner or the landowner's authorized representative. I declare under penalty of perjury that the foregoing is true and correct.

Executed on 2-2-16, 2016 Robert W Shirley
Applicant's Signature

7. The proposed project for diversion of water will consist of ONE WELL AND PUMP
(number of wells, pumps or dams, etc.)

and (was)(will be) completed (by) Spring 2010
(Month/Day/Year - each was or will be completed)

8. The first actual application of water for the proposed beneficial use was or is estimated to be Spring 2016
(Mo/Day/Year)

9. Will pesticide, fertilizer, or other foreign substance be injected into the water pumped from the diversion works?

Yes No If "yes", a check valve shall be required.

All chemigation safety requirements must be met including a chemigation permit and reporting requirements.

10. If you are planning to impound water, please contact the Division of Water Resources for assistance, prior to submitting the application. Please attach a reservoir area capacity table and inform us of the total acres of surface drainage area above the reservoir.

Have you also made an application for a permit for construction of this dam and reservoir with the Division of Water Resources? Yes No

- If yes, show the Water Structures permit number here _____
- If no; explain here why a Water Structures permit is not required _____

GROUNDWATER WELL

11. The application must be supplemented by a U.S.G.S. topographic map, aerial photograph or a detailed plat showing the following information. On the topographic map, aerial photograph, or plat, identify the center of the section, the section lines or the section corners and show the appropriate section, township and range numbers. Also, please show the following information:

- (a) The location of the proposed point(s) of diversion (wells, stream-bank installations, dams, or other diversion works) should be plotted as described in Paragraph No. 5 of the application, showing the North-South distance and the East-West distance from a section line or southeast corner of section.
- (b) If the application is for groundwater, please show the location of any existing water wells of any kind within 1/2 mile of the proposed well or wells. Identify each existing well as to its use and furnish the name and mailing address of the property owner or owners. If there are no wells within 1/2 mile, please advise us.
- (c) If the application is for surface water, the names and addresses of the landowner(s) 1/2 mile downstream and 1/2 mile upstream from your property lines must be shown.
- (d) The location of the proposed place of use should be shown by crosshatching on the topographic map, aerial photograph or plat.
- (e) Show the location of the pipelines, canals, reservoirs or other facilities for conveying water from the point of diversion to the place of use.

A 7.5 minute U.S.G.S. topographic map may be obtained by providing the section, township and range numbers to: Kansas Geological Survey, 1930 Constant, Campus West, University of Kansas, Lawrence, Kansas 66047.

12. List any application, appropriation of water, water right, or vested right file number that covers the same diversion points or any of the same place of use described in this application. Also list any other recent modifications made to existing permits or water rights in conjunction with the filing of this application.

46,657 currently overlaps partial place of use. Change in PU on this senior file will create complete overlap in PU.

WATER RESOURCES RECEIVED

MAY 26 2016

KS DEPT OF AGRICULTURE

WATER RESOURCES RECEIVED

FEB 12 2016

KS DEPT OF AGRICULTURE

SCANNED

13. Furnish the following well information if the proposed appropriation is for the use of groundwater. If the well has not been completed, give information obtained from test holes, if available.

Information below is from: Test holes Well as completed Drillers log attached

Well location as shown in paragraph No.	(A)	(B)	(C)	(D)
Date Drilled	<u>4/17/2007</u>	_____	_____	_____
Total depth of well	<u>75'</u>	_____	_____	_____
Depth to water bearing formation	<u>15'</u>	_____	_____	_____
Depth to static water level	<u>15'</u>	_____	_____	_____
Depth to bottom of pump intake pipe	_____	_____	_____	_____

14. The relationship of the applicant to the proposed place where the water will be used is that of OWNER
(owner, tenant, agent or otherwise)

15. The owner(s) of the property where the water is used, if other than the applicant, is (please print):

Applicant

(name, address and telephone number)

(name, address and telephone number)

16. The undersigned states that the information set forth above is true to the best of his/her knowledge and that this application is submitted in good faith.

Dated at ~~_____~~ GRANTVILLE, Kansas, this 2 day of FEB, 2016
(month) (year)

Robert W. Stanley

(Applicant Signature)

505-42-3981

APPLICANT(S) SOCIAL SECURITY IDENTIFICATION NUMBER(S)

By _____
(Agent or Officer Signature)

and/or
APPLICANT(S) TAXPAYER I.D. NO.(S)

(Agent or Officer - Please Print)

Assisted by DWS TOPEKA FO Date: 1/28/2016
(office/title)

RECEIVED
FEB 1 3 2016

RECEIVED
WATER RECORDS
DEPT. OF AGRICULTURE

IRRIGATION USE SUPPLEMENTAL SHEET

File No. 49,558-A

Name of Applicant (Please Print): ROBERT W. SHIRLEY

1. Please supply the name and address of each landowner, the legal description of the lands to be irrigated, and designate the actual number of acres to be irrigated in each forty acre tract or fractional portion thereof:

Landowner of Record NAME: ROBERT W & SALLY D. SHIRLEY

ADDRESS: 3703 SOUTH ST, GRANTVILLE, KS 66429

S	T	R	NE¼				NW¼				SW¼				SE¼				TOTAL
			NE	NW	SW	SE	NE	NW	SW	SE	NE	NW	SW	SE	NE	NW	SW	SE	
19	11	17E	26.5	22.0														48.5	

Landowner of Record NAME: _____

ADDRESS: _____

S	T	R	NE¼				NW¼				SW¼				SE¼				TOTAL
			NE	NW	SW	SE	NE	NW	SW	SE	NE	NW	SW	SE	NE	NW	SW	SE	

Landowner of Record NAME: _____

ADDRESS: _____

S	T	R	NE¼				NW¼				SW¼				SE¼				TOTAL
			NE	NW	SW	SE	NE	NW	SW	SE	NE	NW	SW	SE	NE	NW	SW	SE	

2. Please complete the following information for the description of the operation for the irrigation project. Attach supplemental sheets as needed.

a. Indicate the soils in the field(s) and their intake rates:

Soil Name	Percent of field (%)	Intake Rate (in/hr)	Irrigation Design Group
_____	_____	_____	_____
_____	_____	_____	_____
_____	_____	_____	_____
_____	_____	_____	_____
Total:	100 %		

b. Estimate the average land slope in the field(s): _____%

Estimate the maximum land slope in the field(s): _____%

c. Type of irrigation system you propose to use (check one):

- Center pivot Center pivot - LEPA "Big gun" sprinkler
 Gravity system (furrows) Gravity system (borders) Sideroll sprinkler

Other, please describe: _____

d. System design features:

i. Describe how you will control tailwater:

ii. For sprinkler systems:

(1) Estimate the operating pressure at the distribution system: _____ psi

(2) What is the sprinkler package design rate? _____ gpm

(3) What is the wetted diameter (twice the distance the sprinkler throws water) of a sprinkler on the outer 100 feet of the system? _____ feet

(4) Please include a copy of the sprinkler package design information.

e. Crop(s) you intend to irrigate. Please note any planned crop rotations:

f. Please describe how you will determine when to irrigate and how much water to apply (particularly important if you do not plan a full irrigation).

You may attach any additional information you believe will assist in informing the Division of the need for your request.

WATER RESOURCES DIVISION

AGRICULTURE

WATER RESOURCES RECEIVED

FEB 12 2016

FEB 12 2016

AGRICULTURE

AGRICULTURE



1320 Research Park Drive
Manhattan, Kansas 66502
(785) 564-6700

900 SW Jackson, Room 456
Topeka, Kansas 66612
(785) 296-3556

Jackie McClaskey, Secretary

Governor Sam Brownback

May 18, 2016

ROBERT W & SALLY D SHIRLEY
3703 SOUTH ST
GRANTVILLE KS 66429

FILE COPY

RE: Application, File No. 49,558-A

Dear Mr. or Mrs. Shirley:

Reference is made to the application for approval of the Chief Engineer to appropriate water for beneficial use under the referenced file number which was received in this office on February 12, 2016. Upon review of the application it is found that additional information is needed.

On the enclosed map completed for the application to appropriate water for beneficial use, please show the location of all water wells of every kind within one-half (1/2) mile of the proposed well located in Section 19. Identify each well as to use (i.e., domestic, irrigation, industrial, municipal) and furnish the name and mailing address of each well owner(s). Add a statement declaring all wells within one-half (1/2) mile of the requested point(s) of diversion have been plotted, and add your signature to it. If none exist, so state and add your signature to it.

As it appears that there may be a great number of domestic wells that may be difficult to locate, you may provide the above listed information for all wells of every kind within 1,000 feet of the of the proposed point of diversion and publish for three consecutive weeks, at your expense, a notice of the proposed appropriation of water for beneficial use. Should you choose to do the public notice please contact me so that I can assist you.

Your application is being returned so that you may supply the requested information. In order for the application retain its priority of filing the requested information must be supplied to complete the applications on or before **June 17, 2016**. According to law, default in supplying the requested information as outlined above within the time allowed or any authorized extension of time, shall cause dismissal of the application for change under the above referenced file number.

Should you need additional time in which to review and or provide the information and you want to request additional time, you must do so in writing, before the 15 day period expires. Such a request should state what steps are being taken to obtain the information and the amount of time you will need to supply the information to our office.

SCANNED

ROBERT SHIRLEY, FILE NO. 49,558-A - SITE MAP SEC. 19, T11S, R17E - JEFFERSON CO.

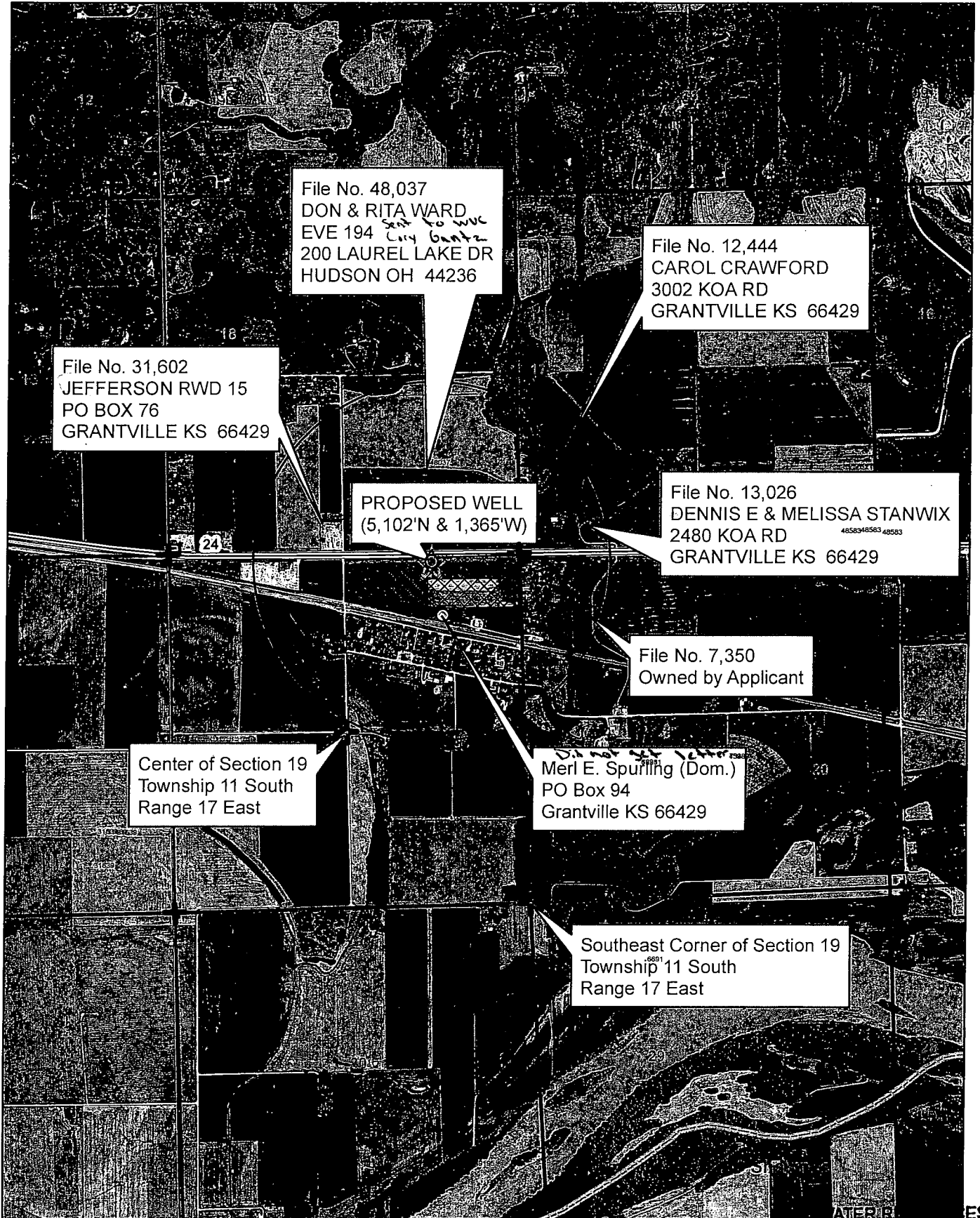

1:24,000

Nearby Well Owners from WRIS Database and Review of Senior File Documentation

All wells of any kind within 1/2 mile of the requested point of diversion have been plotted.

● Proposed Well Location



Proposed Place of Use

RECEIVED

MAY 19 2016

1320 Research Park Drive
Manhattan, Kansas 66502
(785) 564-6700



900 SW Jackson, Room 456
Topeka, Kansas 66612
(785) 296-3556

Jackie McClaskey, Secretary

Governor Sam Brownback

May 18, 2016

ROBERT W & SALLY D SHIRLEY
3703 SOUTH ST
GRANTVILLE KS 66429

RE: Application, File No. 49,558-A

Dear Mr. or Mrs. Shirley:

Reference is made to the application for approval of the Chief Engineer to appropriate water for beneficial use under the referenced file number which was received in this office on February 12, 2016. Upon review of the application it is found that additional information is needed.

On the enclosed map completed for the application to appropriate water for beneficial use, please show the location of all water wells of every kind within one-half (1/2) mile of the proposed well located in Section 19. Identify each well as to use (i.e., domestic, irrigation, industrial, municipal) and furnish the name and mailing address of each well owner(s). Add a statement declaring all wells within one-half (1/2) mile of the requested point(s) of diversion have been plotted, and add your signature to it. If none exist, so state and add your signature to it.

As it appears that there may be a great number of domestic wells that may be difficult to locate, you may provide the above listed information for all wells of every kind within 1,000 feet of the of the proposed point of diversion and publish for three consecutive weeks, at your expense, a notice of the proposed appropriation of water for beneficial use. Should you choose to do the public notice please contact me so that I can assist you.

Your application is being returned so that you may supply the requested information. In order for the application retain its priority of filing the requested information must be supplied to complete the applications on or before **June 17, 2016**. According to law, default in supplying the requested information as outlined above within the time allowed or any authorized extension of time, shall cause dismissal of the application for change under the above referenced file number.

Should you need additional time in which to review and or provide the information and you want to request additional time, you must do so in writing, before the 15 day period expires. Such a request should state what steps are being taken to obtain the information and the amount of time you will need to supply the information to our office.

WATER RESOURCES
RECEIVED

MAY 26 2016

KS DEPT OF AGRICULTURE

If you plan to go to the Division of Water Resources Field Office in your area for assistance please call the Topeka Field Office at (785) 296-5733 to set an appointment time. We appreciate you making an appointment, as it will save your time and allows us to better serve you. If you do go to the field office for assistance, please take this letter, the application, and any attachments.

If you have any questions, please contact me at (785) 564-6645. If you wish to discuss a specific file, please have the file number ready so that I may help you more efficiently.

Sincerely,



Brent A. Turney, P.G.

Change Application Unit Supervisor
Water Appropriation Program

BAT:am

Enclosures

pc: Topeka Field Office

RECEIVED
WATER RESOURCES DIVISION

KS DEPT OF AGRICULTURE

466 57

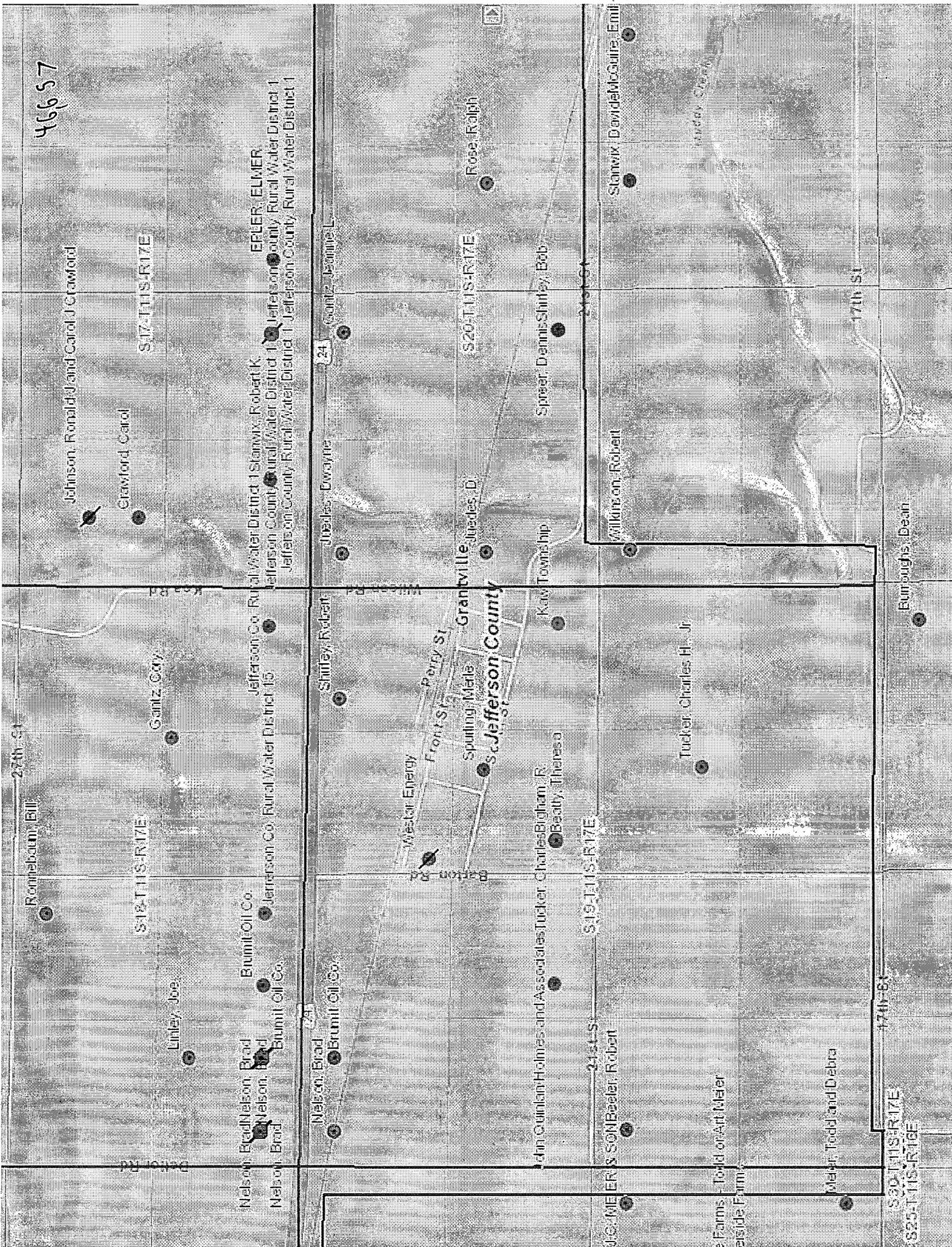

Johnson, Ronald and Carol J Crawford

Grayford, Carol

S17-T11S-R17E

Nelson, Egar Nelson, Brad
Nelson, Brad
Nelson, Brad

Linley, Joe

S18-T11S-R17E

Gantz, Cory

Jefferson Co Rural Water District 15

Jefferson County Rural Water District 1
Jefferson County Rural Water District 1

EPLER, ELMER

Nelson, Brad
Erumit Oil Co.

Shirley, Robert

Gantz, Jeanne L

Weston Energy

Front St
Spurling, Marie
S.C. Jefferson County

Granville

Jinades, D

S20-T11S-R17E

Rose, Ralph

John C. Quinlan, Holmes and Associates
Tucker, Charles Brigham, R

Baathy, Theresa

Spreer, Dennis Shirley, Bob

S19-T11S-R17E

21st St

MEER'S SON Beeler, Robert

Wilkinson, Robert

Stanvix, David & McGuire, Emil

Farms - Todd and Arlene
erside Farm

Tucker, Charles H., Jr.

Melet, Todd and Debra

17th St

S20-T11S-R17E
S25-T11S-R16E

Burnburgh, Dean

4,558-A

Per multiple senior files in this area, 80% of the quantity of water under 7,113 & 32,635 is non-consumptive and is to be deducted from prior appropriations. DWS/DWR 4/18/16

Analysis Results

The selected PD is in an area to new appropriations.
 The safe yield, based on the variables listed below is 3,327.59 AF.
 Total prior appropriation in the circle is 5,540.65 AF.
 Total quantity of water available for appropriation is 0.00 AF.

$-72.8AF = 5,467.85AF - 2,317.38 = 3,150.47AF$
 177.13 AF

Safe Yield Variables

The area used for the analysis is set at 6249 acres.
 Potential annual recharge of the area is estimated to be 8.52 inches.
 The percent of recharge available for appropriation is 75%.

Authorized Quantity values are as of 31-MAR-2016 and are based on Appropriated and Vested ground water right and possible stream nodes for GMD #2. Domestic, Term and Temporary water rights have been excluded.

There are 39 water right(s) and 36 point(s) of diversion within the circle.

File Number	Use	ST	SR	Q4	Q3	Q2	Q1	FeetN	FeetW	Sec	Twp	Rng	ID	Qind	Auth_Quant	Add_Quant	Tacres	Nacres	
A 3189	00	IRR	NK	G		NE	SW	SW	750	4160	13	11	16E	1	WR	49.00	49.00	75.00	75.00
A 6536	00	MUN	NK	G		SW	SW	SW	531	4942	18	11	17E	2	WR	90.00	90.00		
A 6691	00	IRR	NK	G		SW	NE	SW	1888	3703	20	11	17E	4	WR	8.30	8.30	184.00	184.00
A 7076	00	IRR	NK	G		SE	NW	SE	0	0	19	11	17E	1	WR	210.00	210.00	139.00	139.00
A 7113	00	IND	NK	G					2975	1548	29	11	17E	5	WR	2,755.95	2,755.95		
Same		IND	NK	G		SW	SE	NE	2866	1036	29	11	17E	6	WR				
Same		IND	NK	G		SE	SE	NE	2699	562	29	11	17E	7	WR				
Same		IND	NK	G					2975	1833	29	11	17E	8	WR				
A 7349	00	IRR	NK	G		SW	NW	SE	1939	2397	20	11	17E	1	WR	53.00	53.00	184.00	0.00
A 7350	00	IRR	NK	G		SE	NW	NW	0	0	20	11	17E	2	WR	115.00	115.00	71.50	71.50
A 10215	00	IRR	NK	G					4350	3750	28	11	17E	1	WR	145.00	145.00	160.00	160.00
A 12281	00	IRR	NK	G		SW	NE	SW	1888	3703	20	11	17E	4	WR	57.00	57.00	184.00	0.00
A 12444	00	IRR	NK	G		SE	NW	SW	1562	4618	17	11	17E	6	WR	59.00	59.00	74.00	74.00
A 13026	00	IRR	NK	G		SE	SW	SW	0	0	17	11	17E	2	WR	99.00	99.00	70.00	70.00
A 29351	00	IRR	NK	G					2685	3718	20	11	17E	3	WR	34.00	34.00	184.00	0.00
A 29352	00	IRR	NK	G		SE	SW	SW	360	4270	18	11	17E	3	WR	45.00	45.00	51.00	51.00
A 29577	00	MUN	NK	G		SW	SW	SW	531	4942	18	11	17E	2	WR	208.68	118.77		
A 30837	00	IRR	NK	G		NE	SE	NW	3950	3025	25	11	16E	3	WR	152.00	152.00	160.00	160.00
A 31602	00	MUN	NK	G		SE	SE	SW	460	2910	18	11	17E	4	WR	15.77	15.77		
A 31639	00	IRR	NK	G		NW	SE	SE	1159	894	24	11	16E	7	WR	90.00	90.00	99.00	99.00

Safe Yield Report Sheet
Water Right- A49558A
Point of Diversion in NENWNE 19-11S-17E 3 (73491)



Same		IRR NK G	NW SE SE	1181	1180	24	11	16E	8	WR				
Same		IRR NK G	NW SE SE	1170	1037	24	11	16E	9	WR				
A	32635	00	IND NK G	2975	1548	29	11	17E	5	WR	140.78	140.78		
Same			IND NK G	2866	1036	29	11	17E	6	WR				
Same			IND NK G	2699	562	29	11	17E	7	WR				
Same			IND NK G	2975	1833	29	11	17E	8	WR				
A	36770	00	MUN LR G	531	4942	18	11	17E	2	WR	79.79	79.79		
A	37928	00	IRR NK G	4270	1960	20	11	17E	5	WR	45.00	45.00	45.00	45.00
A	39927	00	IRR NK G	3272	606	20	11	17E	6	WR	53.00	53.00	59.40	59.40
A	40532	00	MUN LR G	369	2067	13	11	16E	3	WR	214.82	0.00		
A	40533	00	MUN LR G	227	1227	13	11	16E	4	WR	214.82	0.00		
A	40555	00	IRR NK G	3770	1458	25	11	16E	4	WR	68.00	68.00	74.00	74.00
A	43078	00	IRR NK G	3272	606	20	11	17E	6	WR	53.00	0.00	59.40	0.00
A	43811	00	IRR NK G	34	3145	24	11	16E	4	WR	51.00	51.00	66.00	66.00
A	43987	00	IRR NK G	34	3145	24	11	16E	4	WR	33.00	33.00	43.00	43.00
A	45439	00	MUN LO G	369	2067	13	11	16E	3	WR	99.74	99.74		
A	45440	00	MUN LO G	227	1227	13	11	16E	4	WR	99.74	7.05		
A	45827	00	IRR LR G	3685	4250	19	11	17E	2	WR	116.00	116.00	116.00	116.00
A	45989	00	IRR LR G	1939	2397	20	11	17E	1	WR	184.00	31.70	184.00	0.00
A	46657	00	IRR NK G	5102	1365	19	11	17E	3	WR	48.00	48.00	37.00	37.00
A	48037	00	IRR LO G	1320	1320	18	11	17E	7	WR	160.00	160.00	160.00	160.00
A	48250	00	IRR HK G	3950	4970	30	11	17E	1	WR	121.00	121.00	121.00	121.00
A	48382	00	IRR LO G	4427	4622	25	11	16E	5	WR	70.00	70.00	70.00	70.00
A	48583	00	IRR HK G	110	5240	16	11	17E	3	WR	113.00	113.00	113.00	113.00
Same			IRR HK G	110	550	17	11	17E	4	WR				
Same			IRR HK G	110	255	17	11	17E	5	WR				
A	49252	00	IRR GY G	4990	1720	30	11	17E	3	WR	70.00	70.00	70.00	70.00
A	49363	00	IRR AY G	3680	3830	21	11	17E	4	WR	64.00	64.00	64.00	64.00
A	49558	A	IRR AY G	5102	1365	19	11	17E	3	WR	72.80	72.80	48.50	0.00

49,558-1A



Topeka Field Office
6531 SE Forbes Ave., Suite B
Topeka, Kansas 66619

Jackie McClaskey, Secretary
David W. Barfield, Chief Engineer
Katherine A. Tietsort, Water Commissioner

Phone: (785) 296-5733
Fax: (785) 862-2460
www.agriculture.ks.gov
Sam Brownback, Governor

January 29, 2016

ROBERT W SHIRLEY
3703 SOUTH ST
GRANTVILLE KS 66429

RE: Change Application, File No. 46,657;
and New Application to Appropriate Water

Dear Mr. Shirley:

Enclosed is an application form related to completing a change in place of use under Water Right, File No. 46,657. This change will increase your place of use in the North Half of the Northeast Quarter of Section 19, Township 11 South, Range 17 East in Jefferson County. Please note that the change application form must be **signed by both you and your spouse, and the signatures must be notarized**. For the requested change in place of use, the required filing fee would be \$200.

In addition, enclosed is an "Application For Permit To Appropriate Water For Beneficial Use" form, which **must be signed at both Paragraph Nos. 6 and 16**. This new application would authorize additional diversion of water from your existing well for direct irrigation use. The enclosed Minimum Desirable Streamflow form must also be **signed and notarized**. The new application must be accompanied by the required filing fee, based on the quantity of water requested, which for 72.8 acre-feet the filing fee is \$200. The total fee both the change and new application would be **\$400**.

You may contact the Topeka Field Office at (785) 296-5733, or myself at (785) 296-3495, for any additional assistance in completing this application form.

Sincerely,

Douglas Schemm
Environmental Scientist
Topeka Field Office

Enclosures

WATER RESOURCES
RECEIVED
FEB 12 2016
SCANNED
KS DEPT OF AGRICULTURE



Department of Agriculture
Division of Water Resources

109 SW 9th Street, 2nd Floor
Topeka, Kansas 66612-1280

Jackie McClaskey, Secretary
David W. Barfield, Chief Engineer

Phone: (785) 296-3717

Fax: (785) 296-1176

www.agriculture.ks.gov

Sam Brownback, Governor

June 8, 2016

THERESA BEATTY
10809 W 48TH ST
SHAWNEE KS 66203

Re: Application,
File No. 49,558-A

Dear Mrs. Beatty:

This is to advise you that Robert W. Shirley has filed the application referred to above for a permit to appropriate 72.8 acre-feet of groundwater per calendar year for irrigation use to be diverted at a maximum rate of 1,000 gallons per minute from an existing well. The existing well is located as follows:

In the Northeast Quarter of the Northwest Quarter of the Northeast Quarter (NE $\frac{1}{4}$ NW $\frac{1}{4}$ NE $\frac{1}{4}$), of Section 19, more particularly described as being near a point 5,102 feet North and 1,365 feet West of the Southeast corner of said section, in Township 11 South, Range 17 East, Jefferson County, Kansas.

A map is enclosed indicating the location of the point of diversion. Records in this office indicate that you may have a well or wells in this vicinity and you are notified of receipt of this application in order that you may be fully informed of the location of the applicant's point of diversion and proposed use of water. Consideration will be given to comments or other information which you desire to submit to this office **within 15 days** from the date of this letter.

If you have any questions or comments, you may also contact me at (785) 564-6645. If you call, please reference the file number so I can help you more efficiently.

Sincerely,

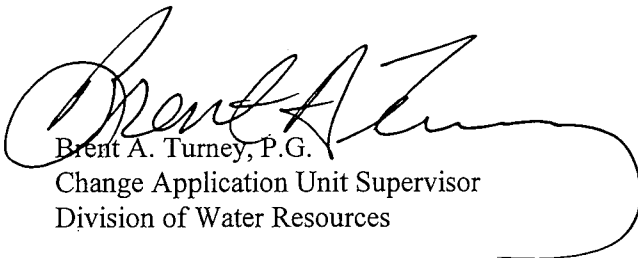

Brent A. Turney, P.G.
Change Application Unit Supervisor
Division of Water Resources

BAT:am

Enclosure

pc: Topeka Field Office



Department of Agriculture
Division of Water Resources

109 SW 9th Street, 2nd Floor
Topeka, Kansas 66612-1280

Jackie McClaskey, Secretary
David W. Barfield, Chief Engineer

Phone: (785) 296-3717
Fax: (785) 296-1176
www.agriculture.ks.gov

Sam Brownback, Governor

June 8, 2016

MERL E. & KARLA SPURLING
PO BOX 94
GRANTVILLE KS 66429

Re: Application,
File No. 49,558-A

Dear Mr. or Mrs. Spurling:

This is to advise you that Robert W. Shirley has filed the application referred to above for a permit to appropriate 72.8 acre-feet of groundwater per calendar year for irrigation use to be diverted at a maximum rate of 1,000 gallons per minute from an existing well. The existing well is located as follows:

In the Northeast Quarter of the Northwest Quarter of the Northeast Quarter (NE $\frac{1}{4}$ NW $\frac{1}{4}$ NE $\frac{1}{4}$), of Section 19, more particularly described as being near a point 5,102 feet North and 1,365 feet West of the Southeast corner of said section, in Township 11 South, Range 17 East, Jefferson County, Kansas.

A map is enclosed indicating the location of the point of diversion. Records in this office indicate that you may have a well or wells in this vicinity and you are notified of receipt of this application in order that you may be fully informed of the location of the applicant's point of diversion and proposed use of water. Consideration will be given to comments or other information which you desire to submit to this office **within 15 days** from the date of this letter.

If you have any questions or comments, you may also contact me at (785) 564-6645. If you call, please reference the file number so I can help you more efficiently.

Sincerely,

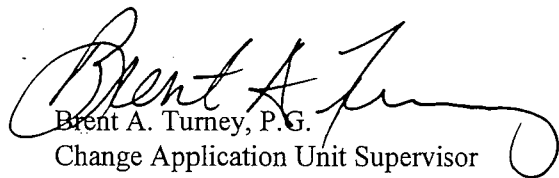
Brent A. Turney, P.G.
Change Application Unit Supervisor
Division of Water Resources

BAT:am

Enclosure

pc: Topeka Field Office

Kansas
Department of Agriculture
Division of Water Resources

109 SW 9th Street, 2nd Floor
Topeka, Kansas 66612-1280

Jackie McClaskey, Secretary
David W. Barfield, Chief Engineer

Phone: (785) 296-3717
Fax: (785) 296-1176
www.agriculture.ks.gov

Sam Brownback, Governor

May 11, 2016

DENNIS E & MELISSA STANWIX
2480 KOA RD
GRANTVILLE KS 66429

Re: Application,
File No. 49,558-A

Dear Mr. or Mrs. Stanwix:

This is to advise you that Robert W. Shirley has filed the application referred to above for a permit to appropriate 72.8 acre-feet of groundwater per calendar year for irrigation use to be diverted at a maximum rate of 1,000 gallons per minute from an existing well. The existing well is located as follows:

In the Northeast Quarter of the Northwest Quarter of the Northeast Quarter (NE $\frac{1}{4}$ NW $\frac{1}{4}$ NE $\frac{1}{4}$), of Section 19, more particularly described as being near a point 5,102 feet North and 1,365 feet West of the Southeast corner of said section, in Township 11 South, Range 17 East, Jefferson County, Kansas.

A map is enclosed indicating the location of the point of diversion. Records in this office indicate that you may have a well or wells in this vicinity and you are notified of receipt of this application in order that you may be fully informed of the location of the applicant's point of diversion and proposed use of water. Consideration will be given to comments or other information which you desire to submit to this office **within 15 days** from the date of this letter.

If you have any questions or comments, you may also contact me at (785) 564-6645. If you call, please reference the file number so I can help you more efficiently.

Sincerely,

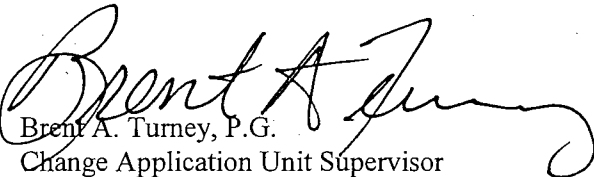
Brent A. Turney, P.G.
Change Application Unit Supervisor
Division of Water Resources

BAT:am

Enclosure

pc: Topeka Field Office

SCANNED

1820
KANSAS
Kansas
Department of Agriculture
Division of Water Resources

109 SW 9th Street, 2nd Floor
Topeka, Kansas 66612-1280

Jackie McClaskey, Secretary
David W. Barfield, Chief Engineer

Phone: (785) 296-3717
Fax: (785) 296-1176
www.agriculture.ks.gov
Sam Brownback, Governor

May 11, 2016

CORY GANTZ
15717 US 24 HWY
PERRY KS 66073

Re: Application,
File No. 49,558-A

Dear Mr. Gantz:

This is to advise you that Robert W. Shirley has filed the application referred to above for a permit to appropriate 72.8 acre-feet of groundwater per calendar year for irrigation use to be diverted at a maximum rate of 1,000 gallons per minute from an existing well. The existing well is located as follows:

In the Northeast Quarter of the Northwest Quarter of the Northeast Quarter (NE $\frac{1}{4}$ NW $\frac{1}{4}$ NE $\frac{1}{4}$), of Section 19, more particularly described as being near a point 5,102 feet North and 1,365 feet West of the Southeast corner of said section, in Township 11 South, Range 17 East, Jefferson County, Kansas.

A map is enclosed indicating the location of the point of diversion. Records in this office indicate that you may have a well or wells in this vicinity and you are notified of receipt of this application in order that you may be fully informed of the location of the applicant's point of diversion and proposed use of water. Consideration will be given to comments or other information which you desire to submit to this office **within 15 days** from the date of this letter.

If you have any questions or comments, you may also contact me at (785) 564-6645. If you call, please reference the file number so I can help you more efficiently.

Sincerely,

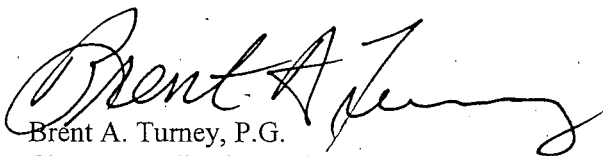

Brent A. Turney, P.G.
Change Application Unit Supervisor
Division of Water Resources

BAT:am

Enclosure

pc: Topeka Field Office
Don & Rita Ward

SCANNED

Kansas
Department of Agriculture
Division of Water Resources

109 SW 9th Street, 2nd Floor
Topeka, Kansas 66612-1280

Jackie McClaskey, Secretary
David W. Barfield, Chief Engineer

Phone: (785) 296-3717
Fax: (785) 296-1176
www.agriculture.ks.gov

Sam Brownback, Governor

May 11, 2016

JEFFERSON RWD 15
PO BOX 76
GRANTVILLE KS 66429

Re: Application,
File No. 49,558-A

Dear Sir or Madam:

This is to advise you that Robert W. Shirley has filed the application referred to above for a permit to appropriate 72.8 acre-feet of groundwater per calendar year for irrigation use to be diverted at a maximum rate of 1,000 gallons per minute from an existing well. The existing well is located as follows:

In the Northeast Quarter of the Northwest Quarter of the Northeast Quarter (NE $\frac{1}{4}$ NW $\frac{1}{4}$ NE $\frac{1}{4}$), of Section 19, more particularly described as being near a point 5,102 feet North and 1,365 feet West of the Southeast corner of said section, in Township 11 South, Range 17 East, Jefferson County, Kansas.

A map is enclosed indicating the location of the point of diversion. Records in this office indicate that you may have a well or wells in this vicinity and you are notified of receipt of this application in order that you may be fully informed of the location of the applicant's point of diversion and proposed use of water. Consideration will be given to comments or other information which you desire to submit to this office **within 15 days** from the date of this letter.

If you have any questions or comments, you may also contact me at (785) 564-6645. If you call, please reference the file number so I can help you more efficiently.

Sincerely,

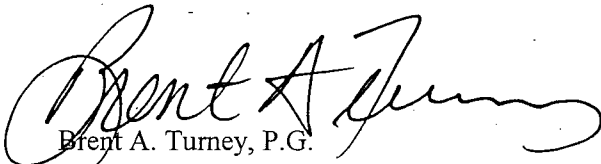

Brent A. Turney, P.G.
Change Application Unit Supervisor
Division of Water Resources

BAT:am

Enclosure

pc: Topeka Field Office

SCANNED

Kansas
Department of Agriculture
Division of Water Resources

109 SW 9th Street, 2nd Floor
Topeka, Kansas 66612-1280

Jackie McClaskey, Secretary
David W. Barfield, Chief Engineer

Phone: (785) 296-3717
Fax: (785) 296-1176
www.agriculture.ks.gov

Sam Brownback, Governor

May 11, 2016

CAROL CRAWFORD
3002 KOA RD
GRANTVILLE KS 66429

Re: Application,
File No. 49,558-A

Dear Mrs. Crawford:

This is to advise you that Robert W. Shirley has filed the application referred to above for a permit to appropriate 72.8 acre-feet of groundwater per calendar year for irrigation use to be diverted at a maximum rate of 1,000 gallons per minute from an existing well. The existing well is located as follows:

In the Northeast Quarter of the Northwest Quarter of the Northeast Quarter (NE $\frac{1}{4}$ NW $\frac{1}{4}$ NE $\frac{1}{4}$), of Section 19, more particularly described as being near a point 5,102 feet North and 1,365 feet West of the Southeast corner of said section, in Township 11 South, Range 17 East, Jefferson County, Kansas.

A map is enclosed indicating the location of the point of diversion. Records in this office indicate that you may have a well or wells in this vicinity and you are notified of receipt of this application in order that you may be fully informed of the location of the applicant's point of diversion and proposed use of water. Consideration will be given to comments or other information which you desire to submit to this office **within 15 days** from the date of this letter.

If you have any questions or comments, you may also contact me at (785) 564-6645. If you call, please reference the file number so I can help you more efficiently.

Sincerely,

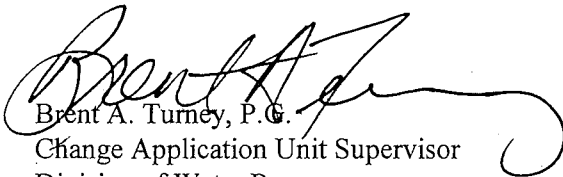

Brent A. Turney, P.G.
Change Application Unit Supervisor
Division of Water Resources

BAT:am

Enclosure

pc: Topeka Field Office
Ron Johnson

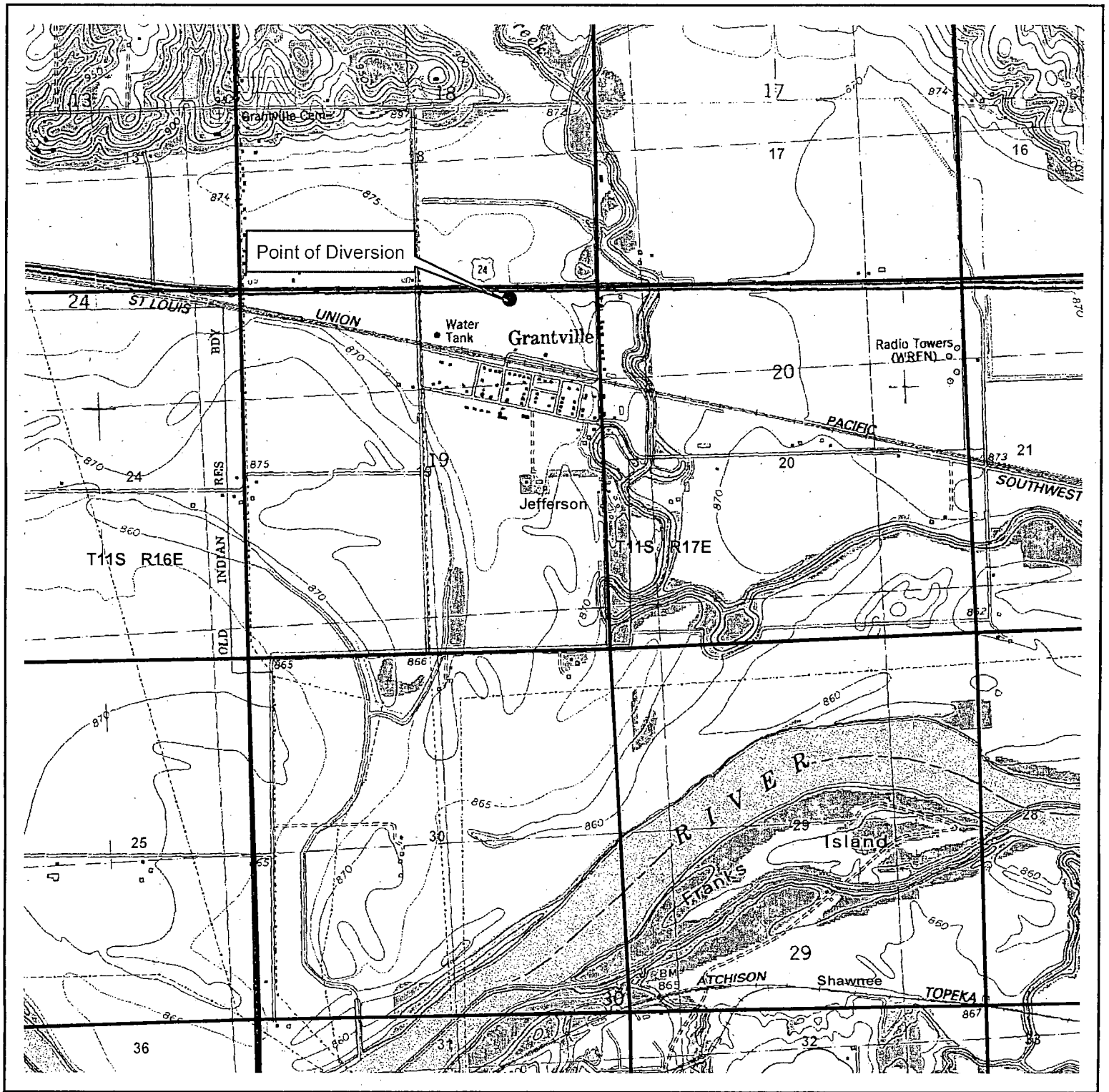
SCANNED



Legend

- Point of Diversion

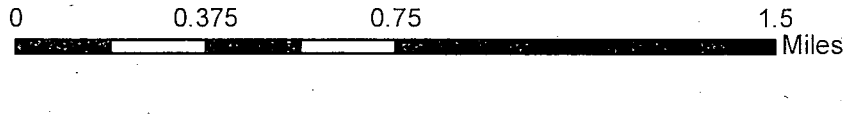

Water Appropriation, File No. 49,558-A

Proposed Point of Diversion

Section 19 - Township 11 South - Range 17 East

Jefferson County



1320 Research Park Drive
Manhattan, Kansas 66502

Jackie McClaskey, Secretary

Phone: (785) 564-6700
Fax: (785) 564-6777
Email: ksag@kda.ks.gov
www.agriculture.ks.gov
Sam Brownback, Governor

February 15, 2016

ROBERT W SHIRLEY
3703 SOUTH ST
GRANTVILLE KS 66429

RE: Application
File No. 49558-A

Dear Sir or Madam:

Your application for permit to appropriate water in 19-11S-17E in Jefferson County, was received and has been assigned the file number noted above.

As a matter of record, the Division of Water Resources has on hand a large number of applications awaiting processing. Therefore to be fair to all concerned, and so that we can process those applications on hand in the order they were received, we intend to concentrate on the backlog of applications until the issue is resolved. Once review of your application has begun, we will contact you, if additional information is required.

In accordance with the provisions of the Kansas Water Appropriation Act, a portion of which is included below, the use of water as proposed prior to approval of the application is unlawful. Once approved, compliance with the terms, conditions and limitations of the permit is necessary. Conservation of the water resources of Kansas is required.

Section 82a-728 of the Kansas Water Appropriation Act, provides (a) except for the appropriation of water for the purpose of domestic use, . . . it shall be unlawful for any person to appropriate or threaten to appropriate water from any source without first applying for and obtaining a permit to appropriate water in accordance with the provisions of the Water Appropriation Act or for any person to violate any condition of a vested right, appropriation right or an approved application for a permit to appropriate water for beneficial use.

(b) (1) The violation of any provision of this section by any person is a class C misdemeanor . . .

A class C misdemeanor is punishable by a fine not to exceed \$500 and/or a term of confinement not to exceed one month in the county jail. Each day that the violation occurs constitutes a separate offense.

If you have any questions, please contact me at (785) 564-6634. If you wish to discuss a specific file, please have the file number ready so that we may help you more efficiently.

Sincerely,

Kenneth A. Kopp, P.G.
New Application Unit Supervisor
Water Appropriation Program

KAK: DLW
pc: TOPEKA Field Office
GMD

SCANNED

ROBERT SHIRLEY, FILE NO. 49,558-A - SITE MAP SEC. 19, T11S, R17E - JEFFERSON CO.



File No. 48,037
DON & RITA WARD
EVE 194
200 LAUREL LAKE DR
HUDSON OH 44236

File No. 12,444
CAROL CRAWFORD
3002 KOA RD
GRANTVILLE KS 66429

File No. 31,602
JEFFERSON RWD 15
PO BOX 76
GRANTVILLE KS 66429

PROPOSED WELL
(5,102'N & 1,365'W)

File No. 13,026
DENNIS E & MELISSA STANWIX
2480 KOA RD
GRANTVILLE KS 66429

File No. 7,350
Owned by Applicant

Center of Section 19
Township 11 South
Range 17 East

Merl E. Spurling (Dom.)
PO Box 94
Grantville KS 66429

Southeast Corner of Section 19
Township 11 South
Range 17 East

1:24,000

Nearby Well Owners from WRIS Database
and Review of Senior File Documentation

All wells of any kind within 1/2 mile of the
requested point of diversion have been plotted.

● Proposed Well Location

▨ Proposed Place of Use

X Robert W. Shirley
KS DEPT OF AGRICULTURE

RECEIVED

MAY 19 2016



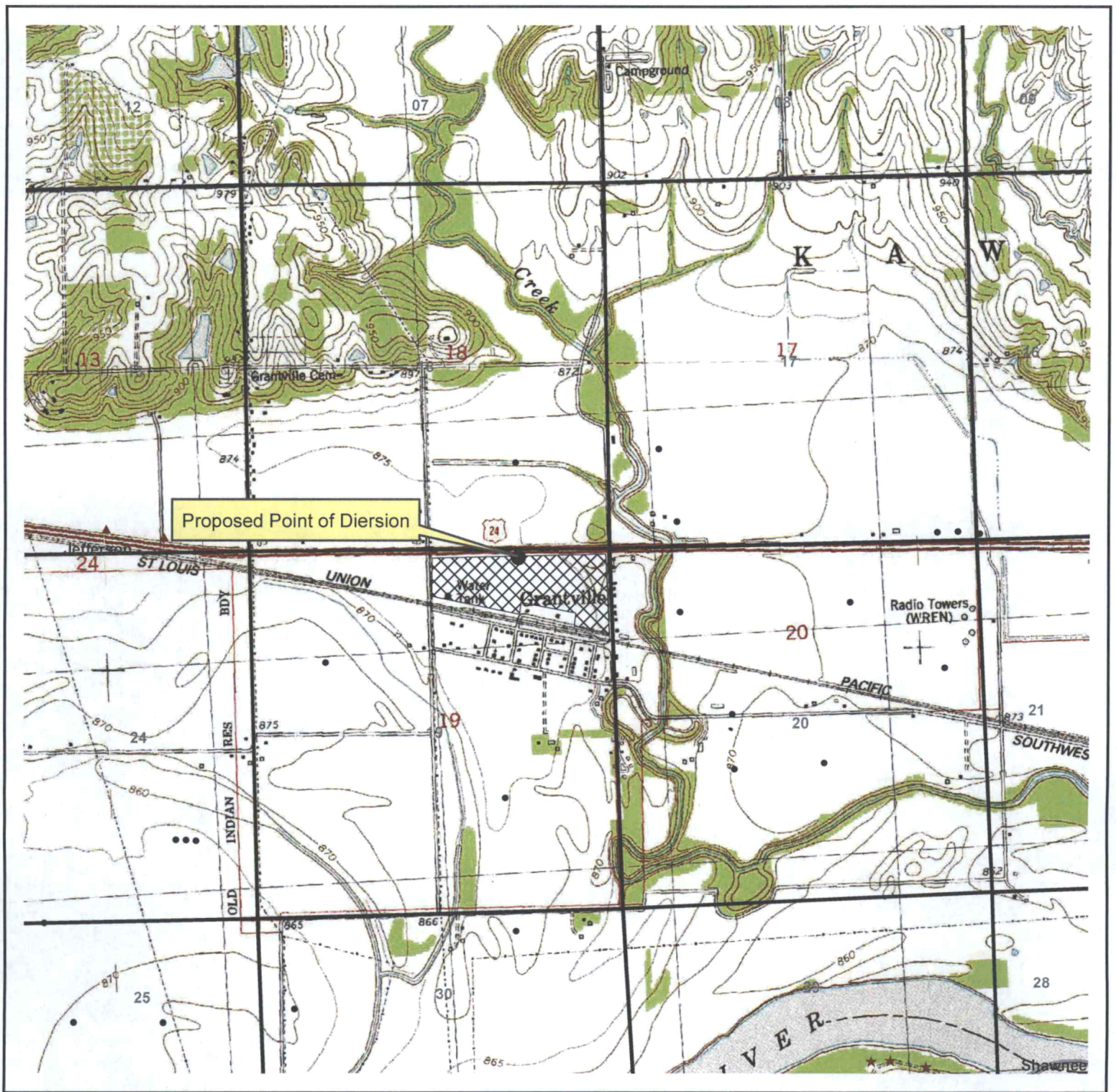

Scale 1:24,000

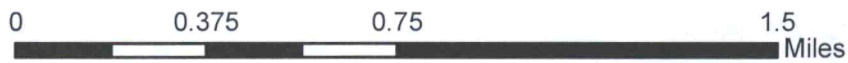

Legend

- Point of Diversion
- ▨ Proposed Place of Use

Water Appropriation, File No. 49,558-A

Proposed Place of Use
 Section 19 - Township 11 South - Range 17 East
 Jefferson County

All wells, domestic and non-domestic, are shown and names are provided: _____

AM/DWR
 Date: 5/11/2016

49,558 -A

NEW APPLICATION - PROPOSED PLACE OF USE

Sec. 19, T11S, R17E



Proposed Place of Use

WATER RESOURCES
RECEIVED

FEB 12 2016

SCANNED

1:12,000

KS DEPT OF AGRICULTURE

