

THE STATE OF KANSAS



KANSAS DEPARTMENT OF AGRICULTURE
Jackie McClaskey, Secretary of Agriculture

DIVISION OF WATER RESOURCES
David W. Barfield, Chief Engineer

File Number 49,665

This item to be completed by the Division of Water Resources.

APPLICATION FOR PERMIT TO APPROPRIATE WATER FOR BENEFICIAL USE

Filing Fee Must Accompany the Application
(Please refer to Fee Schedule attached to this application form.)

WATER RESOURCES RECEIVED

JUL 05 2016 11:27 am

KS DEPT OF AGRICULTURE

To the Chief Engineer of the Division of Water Resources, Kansas Department of Agriculture,
1320 Research Park Drive, Manhattan, KS 66502:

1. Name of Applicant (Please Print): PANHANDLE EASTERN PIPELINE CO LP
Address: 1300 MAIN ST
City: HOUSTON State: TX Zip Code 77002-6803
Telephone Number: (713) 989-7472 email: kerry.asteris@energytransfer.com

2. The source of water is: surface water in COAL CREEK TRIB 1 (NEOSHO)
(stream)
OR groundwater in NEOSHO RIVER
(drainage basin)

Certain streams in Kansas have minimum target flows established by law or may be subject to administration when water is released from storage for use by water assurance district members. If your application is subject to these regulations on the date we receive your application, you will be sent the appropriate form to complete and return to the Division of Water Resources. **REDIVERSION OF 60 AF @ 3,000 GPM**

3. The maximum quantity of water desired is 77 acre-feet OR _____ gallons per calendar year, to be diverted at a maximum rate of NF gallons per minute OR _____ cubic feet per second.

Once your application has been assigned a priority, the requested maximum rate of diversion and maximum requested quantity of water under that priority number can **NOT** be increased. Please be certain your requested maximum rate of diversion and maximum quantity of water are appropriate and reasonable for your proposed project and are in agreement with the Division of Water Resources' requirements.

4. The water is intended to be appropriated for (Check use intended):
(a) Artificial Recharge (b) Irrigation (c) Recreational (d) Water Power
(e) Industrial (f) Municipal (g) Stockwatering (h) Sediment Control
(i) Domestic (j) Dewatering (k) Hydraulic Dredging (l) Fire Protection
(m) Thermal Exchange (n) Contamination Remediation

YOU **MUST** COMPLETE AND ATTACH ADDITIONAL DIVISION OF WATER RESOURCES FORM(S) PROVIDING INFORMATION TO SUBSTANTIATE YOUR REQUEST FOR THE AMOUNT OF WATER FOR THE INTENDED USE REFERENCED ABOVE.

For Office Use Only:							
F.O.	<u>1</u>	GMD	<u>0</u>	Meets K.A.R. 5-3-1	(YES/NO)	Use	<u>IND</u>
Code	<u>REG</u>	Fee \$	<u>200</u>	TR #		Source	<u>G/S</u>
						County	<u>LY</u>
						By	<u>AW</u>
						Date	<u>7/5/16</u>
						Receipt Date	<u>7/5/16</u>
						Check #	<u>3111</u>

7/6/2016 UCM

5. The location of the proposed wells, pump sites or other works for diversion of water is:

Note: For the application to be accepted, the point of diversion location must be described to at least a 10 acre tract, unless you specifically request a 60 day period of time in which to locate the site within a specifically described, minimal legal quarter section of land.

(A) One in the SE quarter of the SE quarter of the SE quarter of Section 21, more particularly described as being near a point 531 feet North and 80 feet West of the Southeast corner of said section, in Township 20 South, Range 11 EAST, LYON County, Kansas.

(B) One in the _____ quarter of the _____ quarter of the _____ quarter of Section _____, more particularly described as being near a point _____ feet North and _____ feet West of the Southeast corner of said section, in Township _____ South, Range _____ East/West (circle one), _____ County, Kansas.

(C) One in the _____ quarter of the _____ quarter of the _____ quarter of Section _____, more particularly described as being near a point _____ feet North and _____ feet West of the Southeast corner of said section, in Township _____ South, Range _____ East/West (circle one), _____ County, Kansas.

(D) One in the _____ quarter of the _____ quarter of the _____ quarter of Section _____, more particularly described as being near a point _____ feet North and _____ feet West of the Southeast corner of said section, in Township _____ South, Range _____ East/West (circle one), _____ County, Kansas.

If the source of supply is groundwater, a separate application shall be filed for each proposed well or battery of wells, except that a single application may include up to four wells within a circle with a quarter (1/4) mile radius in the same local source of supply which do not exceed a maximum diversion rate of 20 gallons per minute per well.

A battery of wells is defined as two or more wells connected to a common pump by a manifold; or not more than four wells in the same local source of supply within a 300 foot radius circle which are being operated by pumps not to exceed a total maximum diversion rate of 800 gallons per minute and which supply water to a common distribution system.

6. The owner of the point of diversion, if other than the applicant is (please print):

APPLICANT

(name, address and telephone number)

(name, address and telephone number)

You must provide evidence of legal access to, or control of, the point of diversion from the landowner or the landowner's authorized representative. Provide a copy of a recorded deed, lease, easement or other document with this application. In lieu thereof, you may sign the following sworn statement:

I have legal access to, or control of, the point of diversion described in this application from the landowner or the landowner's authorized representative. I declare under penalty of perjury that the foregoing is true and correct.

Executed on June 30, 2016. Kerry Asteris
Applicant's Signature

7. The proposed project for diversion of water will consist of ONE DAM AND RESERVOIR
(number of wells, pumps or dams, etc.)
and was completed (by) late 1980's
(Month/Day/Year - each was or will be completed)

8. The first actual application of water for the proposed beneficial use was or is estimated to be SUMMER 2016.
(Mo/Day/Year)

9. Will pesticide, fertilizer, or other foreign substance be injected into the water pumped from the diversion works?

Yes No If "yes", a check valve shall be required.

All chemigation safety requirements must be met including a chemigation permit and reporting requirements.

10. If you are planning to impound water, please contact the Division of Water Resources for assistance, prior to submitting the application. Please attach a reservoir area capacity table and inform us of the total acres of surface drainage area above the reservoir.

Have you also made an application for a permit for construction of this dam and reservoir with the Division of Water Resources? Yes No

- If yes, show the Water Structures permit number here _____
- If no, explain here why a Water Structures permit is not required _____

To be determined by Structures Review

11. The application must be supplemented by a U.S.G.S. topographic map, aerial photograph or a detailed plat showing the following information. On the topographic map, aerial photograph, or plat, identify the center of the section, the section lines or the section corners and show the appropriate section, township and range numbers. Also, please show the following information:

- (a) The location of the proposed point(s) of diversion (wells, stream-bank installations, dams, or other diversion works) should be plotted as described in Paragraph No. 5 of the application, showing the North-South distance and the East-West distance from a section line or southeast corner of section.
- (b) If the application is for groundwater, please show the location of any existing water wells of any kind within 1/2 mile of the proposed well or wells. Identify each existing well as to its use and furnish the name and mailing address of the property owner or owners. If there are no wells within 1/2 mile, please advise us.
- (c) If the application is for surface water, the names and addresses of the landowner(s) 1/2 mile downstream and 1/2 mile upstream from your property lines must be shown.
- (d) The location of the proposed place of use should be shown by crosshatching on the topographic map, aerial photograph or plat.
- (e) Show the location of the pipelines, canals, reservoirs or other facilities for conveying water from the point of diversion to the place of use.

A 7.5 minute U.S.G.S. topographic map may be obtained by providing the section, township and range numbers to: Kansas Geological Survey, 1930 Constant, Campus West, University of Kansas, Lawrence, Kansas 66047.

12. List any application, appropriation of water, water right, or vested right file number that covers the same diversion points or any of the same place of use described in this application. Also list any other recent modifications made to existing permits or water rights in conjunction with the filing of this application.

NONE. The applicant has utilized multiple term and temporary permits for many years to conduct hydrostatic testing of pipe lines. Due to the more permanent nature of this use, it was determined that a regular appropriation of water would be more efficient and justified.

WATER RESOURCES RECEIVED

Storage quantity based on 1 year direct use = 60 AF; capacity = 15 AF; and 1 year of indirect use = 2 AF

JUL 05 2016

13. Furnish the following well information if the proposed appropriation is for the use of groundwater. If the well has not been completed, give information obtained from test holes, if available.

Information below is from: Test holes Well as completed Drillers log attached

Well location as shown in paragraph No.	(A)	(B)	(C)	(D)
Date Drilled	_____	_____	_____	_____
Total depth of well	_____	_____	_____	_____
Depth to water bearing formation	_____	_____	_____	_____
Depth to static water level	_____	_____	_____	_____
Depth to bottom of pump intake pipe	_____	_____	_____	_____

14. The relationship of the applicant to the proposed place where the water will be used is that of owner
(owner, tenant, agent or otherwise)

15. The owner(s) of the property where the water is used, if other than the applicant, is (please print):

(name, address and telephone number)

(name, address and telephone number)

16. The undersigned states that the information set forth above is true to the best of his/her knowledge and that this application is submitted in good faith.

Dated at _____, Kansas, this _____ day of _____, 2016.
(month) (year)

Kerry Asteris

(Applicant Signature)

APPLICANT(S) SOCIAL SECURITY IDENTIFICATION NUMBER(S)

By _____
(Agent or Officer Signature)

and/or
APPLICANT(S) TAXPAYER I.D. NO.(S)

(Agent or Officer - Please Print)

Assisted by DWS TOPEKA FO Date: 5/24/2016
(office/title)

WATER RESOURCES RECEIVED

Panhandle Eastern Pipe Line Company, LP
 Section 21, Township 20 South, Range 11 East
 Lyon County

496005

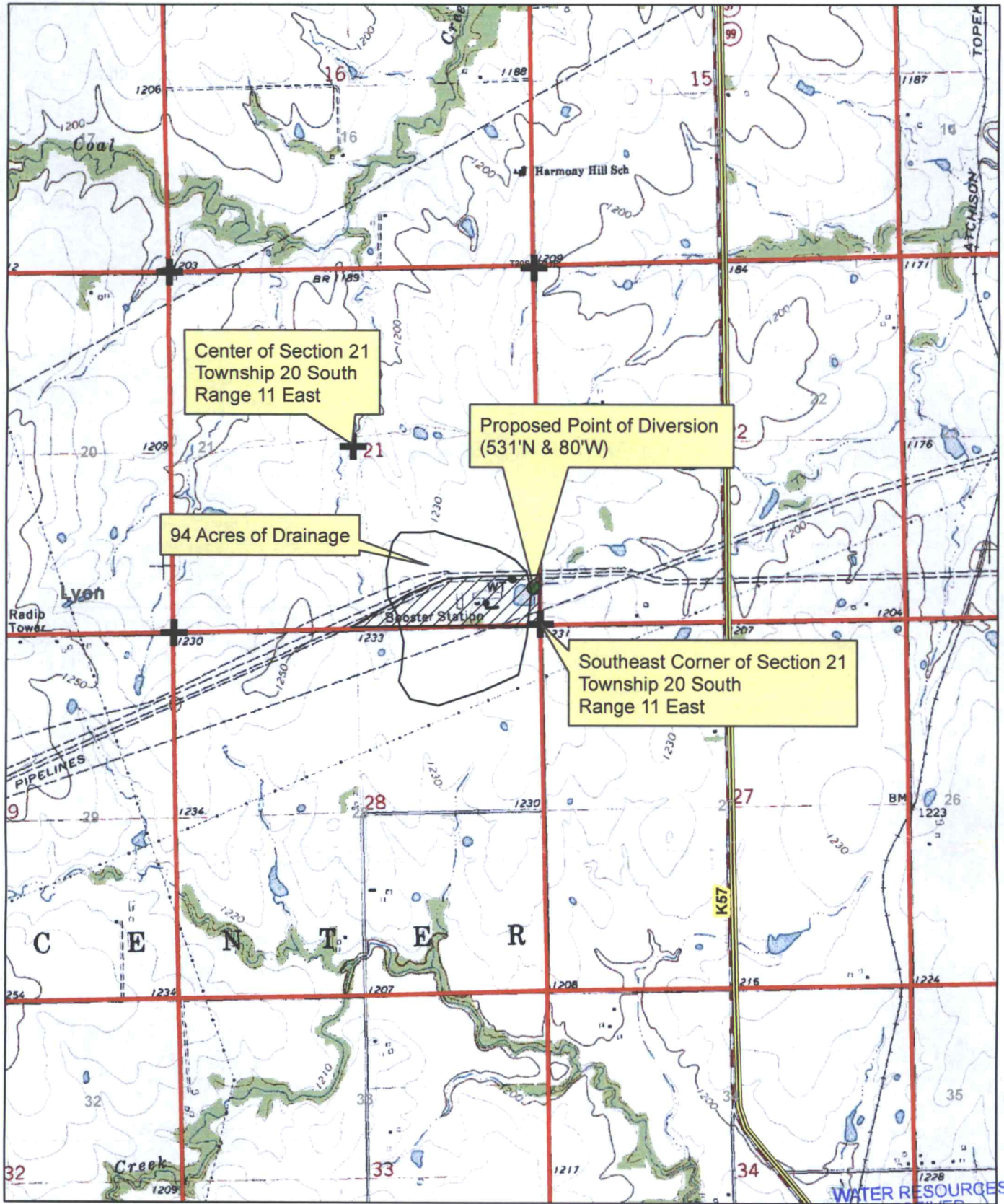



Center of Section 21
 Township 20 South
 Range 11 East

Proposed Point of Diversion
 (531°N & 80°W)

94 Acres of Drainage

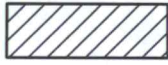
Southeast Corner of Section 21
 Township 20 South
 Range 11 East

-  Proposed Place of Use
-  Proposed Point of Diversion

All known land owners adjacent to the stream
 within one-half mile upstream and downstream
 of the property lines have been shown.

1:24,000

WATER RESOURCES RECEIVED
 JUL 15 2016
 KS DEPT OF AGRICULTURE

INDUSTRIAL USE SUPPLEMENTAL SHEET

File No. 49605

Name of Applicant (Please Print): Panhandle Eastern Pipe Line Co., LP

1. Please describe type of industry or product produced: Hydrostatic Line Testing
 _____ Standard Industrial Classification Code Number: _____

2. Please complete the following table to show your past and present water requirements:

PAST PRODUCT PRODUCTION AND WATER DIVERTED, IF APPLICABLE

LAST 5 YEARS	AMOUNT OF PRODUCT	WATER DIVERTED (GALLONS)	GALLONS PER PRODUCT PER DAY
5 years ago		5 million	
Last year		8 million	
Present year		8 million	

3. Please complete the following table to show your future water requirements:

ESTIMATED FUTURE PRODUCT PRODUCTION AND WATER DIVERTED

NEXT 5 YEARS	AMOUNT OF PRODUCT	WATER TO BE DIVERTED (GALLONS)	GALLONS PER PRODUCT PER DAY
Year 1		8 million	
Year 2		8 million	
Year 3		12 million	
Year 4		15 million	
Year 5		19 million	

Number of days of operation of the industry per year is 365 days.

Please attach any tables, curves or additional information showing past, present and estimated future water requirements to substantiate the amount of water requested.

4. Please designate the legal description of the location where the water is to be used. Show in the space provided below the Section (S), Township (T), and Range (R), and the number of acres in each forty acre tract or fractional portion thereof.

S	T	R	NE¼				NW¼				SW¼				SE¼				TOTAL
			NE	NW	SW	SE	NE	NW	SW	SE	NE	NW	SW	SE	NE	NW	SW	SE	
21	20S	11E	Booster Station in the South Half of the SE ¼.																

WATER RESOURCES
RECEIVED

JUL 05 2016

You may attach any additional information you believe will assist in informing the Division of the need for your request.

KS DEPT OF AGRICULTURE

June 30, 2016

(Date)

Kansas Department of Agriculture
Division of Water Resources
David W. Barfield, Chief Engineer
1320 Research Park Drive
Manhattan, Kansas 66502

Re: Application
File No. 49445

Minimum Desirable Streamflow
Neosho River Basin

Dear Sir:

I understand that a Minimum Desirable Streamflow requirement has been established by the legislature for the source of supply to which the above referenced application applies.

I understand that diversion of water pursuant to this application will be subject to regulation any time Minimum Desirable Streamflow requirements are not being met.

I also understand that if this application is approved, there could be times, as determined by the Division of Water Resources, when I would not be allowed to divert water. I realize that this could affect the economics of my decision to appropriate water.

I am aware of the above factors, and with the knowledge thereof, request that the Division of Water Resources proceed with processing and approval, if possible, of the above referenced application.

State of ^{Texas} ~~Kansas~~)
County of Harris) ss

Kerry Asteris
Signature of Applicant

Kerry Asteris
(Print Applicant's Name)

I hereby certify that the foregoing instrument was signed in my presence and sworn to before me this 30 day of June, 2016.

Brenda E. Pedraza
Notary Public

My Commission Expires: October 09, 2018

WATER RESOURCES
RECEIVED

JUL 05 2016

KS DEPT OF AGRICULTURE



**MINIMUM DESIRABLE STREAMFLOW FORM TO BE USED WHEN
APPLICABLE WHEN FILING AN APPLICATION FOR PERMIT
TO APPROPRIATE WATER FOR BENEFICIAL USE**

The Kansas Legislature has established minimum desirable streamflows for the streams listed below. If your proposed diversion of water is going to be from one of these watercourses or adjacent alluvial aquifers, please complete the back side of this page and submit it along with your application for permit to appropriate water.

Arkansas River
Big Blue River
Chapman Creek
Chikaskia River
Cottonwood River
Delaware River
Little Arkansas River
Little Blue River
Marais des Cygnes River
Medicine Lodge River
Mill Creek (Wabaunsee Co. area)
Neosho River

Ninnescah River
North Fork Ninnescah River
Rattlesnake Creek
Republican River
Saline River
Smoky Hill River
Solomon River
South Fork Ninnescah
Spring River
Walnut River
Whitewater River

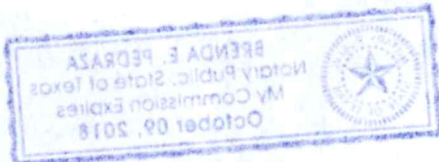

WATER RESOURCES
RECEIVED

KS DEPT OF AGRICULTURE

DATA ENTRY SYSTEM ID NUMBER SHEET

FILE NUMBER 49605

APPLICANT

PDIV ID

BATTERY ID

PERSON ID & SEQ #

85413

36941

2

LANDOWNER

PUSE ID

PERSON ID & SEQ #

64642

36941

1

WATER USE CORRESPONDENT

PERSON ID & SEQ #

36941

2

1320 Research Park Drive
Manhattan, Kansas 66502
Jackie McClaskey, Secretary



Phone: (785) 564-6700
Fax: (785) 564-6777
Email: ksag@kda.ks.gov
www.agriculture.ks.gov
Sam Brownback, Governor

July 5, 2016

PANHANDLE EASTERN PIPELINE CO LP
1300 MAIN ST
HOUSTON TX 77002

RE: Application
File No. 49665

Dear Sir or Madam:

Your application for permit to appropriate water in 21-20S-11E in Lyon County, was received and has been assigned the file number noted above.

As a matter of record, the Division of Water Resources has on hand a large number of applications awaiting processing. Therefore to be fair to all concerned, and so that we can process those applications on hand in the order they were received, we intend to concentrate on the backlog of applications until the issue is resolved. Once review of your application has begun, we will contact you, if additional information is required.

In accordance with the provisions of the Kansas Water Appropriation Act, a portion of which is included below, the use of water as proposed prior to approval of the application is unlawful. Once approved, compliance with the terms, conditions and limitations of the permit is necessary. Conservation of the water resources of Kansas is required.

Section 82a-728 of the Kansas Water Appropriation Act, provides (a) except for the appropriation of water for the purpose of domestic use, . . . it shall be unlawful for any person to appropriate or threaten to appropriate water from any source without first applying for and obtaining a permit to appropriate water in accordance with the provisions of the Water Appropriation Act or for any person to violate any condition of a vested right, appropriation right or an approved application for a permit to appropriate water for beneficial use.

(b) (1) The violation of any provision of this section by any person is a class C misdemeanor . . .

A class C misdemeanor is punishable by a fine not to exceed \$500 and/or a term of confinement not to exceed one month in the county jail. Each day that the violation occurs constitutes a separate offense.

If you have any questions, please contact me at (785) 564-6645. If you wish to discuss a specific file, please have the file number ready so that we may help you more efficiently.

Sincerely,

Brent A Turney, P.G.
Change Application Unit Supervisor
Water Appropriation Program

BAT: ALH
pc: TOPEKA Field Office
GMD