

File No. **49,685** 15. Formation Code: Drainage Basin: County: Special Use: Stream:

16. Points of Diversion										
T	MOD	DEL	PDIV	Qualifier	S	T	R	ID	'N	'W
	DEL		85539	NW NW	7	1	1E	3	3960	3960

17. Rate and Quantity				
Authorized		Additional		
Rate	Quantity	Rate	Quantity	Overlap PD Files
gpm/cfs	af/mgy	gpm/cfs	af/mgy	

18. Storage: Rate _____ NF Quantity _____ ac/ft Additional Rate _____ NF Additional Quantity _____ ac/ft

19. Limitation: _____ af/yr at _____ gpm (_____ cfs) when combined with file number(s) _____
 Limitation: _____ af/yr at _____ gpm (_____ cfs) when combined with file number(s) _____

20. Meter Required? Yes No To be installed by _____ Date Acceptable Meter Installed _____

21. Place of Use							NE¼				NW¼				SW¼				SE¼				Total	Owner	Chg? NO	Overlap Files		
T	MOD	DEL	PUSE	S	T	R	ID	NE ¼	NW ¼	SW ¼	SE ¼	NE ¼	NW ¼	SW ¼	SE ¼	NE ¼	NW ¼	SW ¼	SE ¼	NE ¼	NW ¼	SW ¼	SE ¼					
	DEL		67947	7	1	1E	2																			7a.	NO	NONE

Comments:

KANSAS DEPARTMENT OF AGRICULTURE
Division of Water Resources

M E M O R A N D U M

TO: Files

DATE: October 26, 2016

FROM: Doug Schemm

RE: Application, File No.
49,685

Brian E. Livingston had filed the above referenced application to appropriate groundwater for irrigation use, and requested 60 days to locate the point of diversion. The application was returned to the applicant on August 16, 2016, providing 60 days to locate the point of diversion and provide additional information by an October 10, 2016 deadline. A reminder letter of the upcoming deadline was sent on September 16, 2016. The application has not been returned, and there has been no request for additional time to respond.

The applicant was contacted by telephone on October 26, 2016 to discuss this project, and he stated that water quality analysis indicated the groundwater was "borderline" due to salinity levels. Therefore, the applicant was not going to pursue the project.

Based on the available information, that the application was not returned within the time allowed, it is recommended that the file be dismissed for failure to return, as provided by K.S.A. 82a-710.

Douglas Schemm
Environmental Scientist
Topeka Field Office



1320 Research Park Drive
Manhattan, Kansas 66502
(785) 564-6700

900 SW Jackson, Room 456
Topeka, Kansas 66612
(785) 296-3556

Jackie McClaskey, Secretary

Governor Sam Brownback

December 7, 2016

BRIAN E LIVINGSTON
70663 560 AVE
PO BOX 136
REYNOLDS NE 68429

FILE COPY

Re: Application, File No. 49,685

Dear Mr. Livingston:

Enclosed is the Findings and Order by the Chief Engineer, Division of Water Resources, Kansas Department of Agriculture, dismissing Application, File No. 49,685 for failure to return the original application and provide the requested information, prior to the deadline of October 10, 2016.

This is a final agency action. If you choose to appeal this decision or any finding or part thereof, you must do so by filing a petition for review in the manner prescribed by the Kansas Act for Judicial Review and Civil Enforcement of Agency Actions (KJRA K.S.A. 77-601 et seq.) within 30 days of service of this order. Your appeal must be made with the appropriate district court for the district of Kansas.

The Chief Legal Counsel for the Kansas Department of Agriculture, 1320 Research Park Drive, Manhattan, Kansas 66502, is the agency officer who will receive service of a petition for judicial review on behalf of the Kansas Department of Agriculture, Division of Water Resources. If you have questions or would like clarification concerning this order, you may contact the Chief Engineer.

If you have any questions, please contact our office. If you wish to discuss a specific file, please have the file number ready so that we may help you more efficiently.

Sincerely,

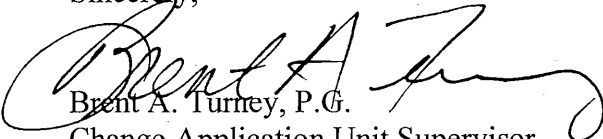

Brent A. Turney, P.G.
Change Application Unit Supervisor
Water Appropriation Program

BAT:dws
Enclosures

pc: Topeka Field Office



KANSAS DEPARTMENT OF AGRICULTURE
Jackie McClaskey, Secretary of Agriculture

DIVISION OF WATER RESOURCES
David W. Barfield, Chief Engineer

**FINDINGS AND ORDER
IN THE MATTER OF THE
DISMISSAL OF APPLICATION
FILE NO. 49,685**

After due consideration, the Chief Engineer, Division of Water Resources, Kansas Department of Agriculture (hereinafter referred to as the "Chief Engineer"), makes the following findings and order:

FINDINGS

1. That on August 10, 2016, the Chief Engineer received an application from Brian E. Livingston for permit to appropriate groundwater for beneficial use, assigned File No. 49,685, proposing the appropriation of 320 acre-feet of water, at a maximum requested diversion rate of 1,600 gallons per minute, for irrigation use. The applicant requested 60 days to locate the specific point of diversion within the Northwest Quarter of the Northwest Quarter of Section 7, Township 1 South, Range 1 East, Washington County, Kansas.
2. That on August 16, 2016, the original application was returned to the applicant, with a cover letter requesting that additional information be submitted in order to complete the application. The applicant was provided a deadline until October 10, 2016, the time in which to provide the requested information and return the application. The applicant was informed that the application would be dismissed if it was not returned by the October 10, 2016 deadline, or within any authorized extension of time.
3. That a reminder letter was sent to the applicant on September 16, 2016, once again stating the October 10, 2016 date that the application was required to be returned.
4. That the application was not returned by the October 10, 2016 deadline, nor did the applicant request any extension of time in which to do so. The applicant verbally informed Division of Water Resources staff that water quality analysis revealed elevated salinity levels in the groundwater.
5. That the application should be dismissed and its priority forfeited as provided by K.S.A. 82a-710, for failure to return the original application.

ORDER

NOW, THEREFORE, It is the decision and order of the Chief Engineer, Division of Water Resources, Kansas Department of Agriculture, that effective the date of this order, in accordance with the law, Application, File No. 49,685, is herewith dismissed and the priority assigned to it is considered to be forfeited.



KANSAS DEPARTMENT OF AGRICULTURE
Dale A. Rodman, Secretary of Agriculture

DIVISION OF WATER RESOURCES
David W. Barfield, Chief Engineer

File Number 491685
This item to be completed by the Division of Water Resources.

WATER RESOURCES
RECEIVED

**APPLICATION FOR PERMIT TO
APPROPRIATE WATER FOR BENEFICIAL USE**

Filing Fee Must Accompany the Application
(Please refer to Fee Schedule attached to this application form.)

AUG 10 2016
11:19
KS DEPT OF AGRICULTURE

To the Chief Engineer of the Division of Water Resources, Kansas Department of Agriculture,
109 SW 9th Street, Second Floor, Topeka, KS 66612-1283:

1. Name of Applicant (Please Print): Brian E. Livingston
Address: 70663 560 AVE PO Box 136
City: Reynolds State NE Zip Code 68429
Telephone Number: (402) 520-2337

2. The source of water is: surface water in _____ (stream)
OR groundwater in mill creek (drainage basin)

Certain streams in Kansas have minimum target flows established by law or may be subject to administration when water is released from storage for use by water assurance district members. If your application is subject to these regulations on the date we receive your application, you will be sent the appropriate form to complete and return to the Division of Water Resources.

3. The maximum quantity of water desired is 320 acre-feet OR _____ gallons per calendar year, to be diverted at a maximum rate of 1600 gallons per minute OR _____ cubic feet per second.

Once your application has been assigned a priority, the requested maximum rate of diversion and maximum requested quantity of water under that priority number can **NOT** be increased. Please be certain your requested maximum rate of diversion and maximum quantity of water are appropriate and reasonable for your proposed project and are in agreement with the Division of Water Resources' requirements.

4. The water is intended to be appropriated for (Check use intended):
(a) Artificial Recharge (b) Irrigation (c) Recreational (d) Water Power
(e) Industrial (f) Municipal (g) Stockwatering (h) Sediment Control
(i) Domestic (j) Dewatering (k) Hydraulic Dredging (l) Fire Protection
(m) Thermal Exchange (n) Contamination Remediation

YOU **MUST** COMPLETE AND ATTACH ADDITIONAL DIVISION OF WATER RESOURCES FORM(S) PROVIDING INFORMATION TO SUBSTANTIATE YOUR REQUEST FOR THE AMOUNT OF WATER FOR THE INTENDED USE REFERENCED ABOVE.

For Office Use Only:
F.O. 1 GMD 0 Meets K.A.R. 5-3-1 (YES/NO) Use ERR Source (G)S County WS By ASW Date 8/10/16
Code REG RR2 Fee \$ 300 TR # _____ Receipt Date 8/10/16 Check # 6470

SCANNED

8/10/2016 LLM

Request 60 days to ~~locate~~ locate

File No. 99,685

5. The location of the proposed wells, pump sites or other works for diversion of water is:

Note: For the application to be accepted, the point of diversion location must be described to at least a 10 acre tract, unless you specifically request a 60 day period of time in which to locate the site within a specifically described, minimal legal quarter section of land.

- (A) One in the NW quarter of the NW quarter of the _____ quarter of Section 7, more particularly described as being near a point _____ feet North and _____ feet West of the Southeast corner of said section, in Township 1 South, Range 1 East/West (circle one), Washington County, Kansas.
- (B) One in the _____ quarter of the _____ quarter of the _____ quarter of Section _____, more particularly described as being near a point _____ feet North and _____ feet West of the Southeast corner of said section, in Township _____ South, Range _____ East/West (circle one), _____ County, Kansas.
- (C) One in the _____ quarter of the _____ quarter of the _____ quarter of Section _____, more particularly described as being near a point _____ feet North and _____ feet West of the Southeast corner of said section, in Township _____ South, Range _____ East/West (circle one), _____ County, Kansas.
- (D) One in the _____ quarter of the _____ quarter of the _____ quarter of Section _____, more particularly described as being near a point _____ feet North and _____ feet West of the Southeast corner of said section, in Township _____ South, Range _____ East/West (circle one), _____ County, Kansas.

If the source of supply is groundwater, a separate application shall be filed for each proposed well or battery of wells, except that a single application may include up to four wells within a circle with a quarter (1/4) mile radius in the same local source of supply which do not exceed a maximum diversion rate of 20 gallons per minute per well.

A battery of wells is defined as two or more wells connected to a common pump by a manifold; or not more than four wells in the same local source of supply within a 300 foot radius circle which are being operated by pumps not to exceed a total maximum diversion rate of 800 gallons per minute and which supply water to a common distribution system.

6. The owner of the point of diversion, if other than the applicant is (please print):

(name, address and telephone number)

(name, address and telephone number)

You must provide evidence of legal access to, or control of, the point of diversion from the landowner or the landowner's authorized representative. Provide a copy of a recorded deed, lease, easement or other document with this application. In lieu thereof, you may sign the following sworn statement:

I have legal access to, or control of, the point of diversion described in this application from the landowner or the landowner's authorized representative. I declare under penalty of perjury that the foregoing is true and correct.

Executed on Aug 3, 2016. [Signature]
Applicant's Signature

7. The proposed project for diversion of water will consist of 1 well or battery
(number of wells, pumps or dams, etc.)
and (was)(will be) completed (by) late winter or early spring of 2016-2017
(Month/Day/Year - each was or will be completed)

8. The first actual application of water for the proposed beneficial use was or is estimated to be _____
(Mo/Day/Year)

WATER RESOURCES
RECEIVED

AUG 10 2016

KS DEPT OF AGRICULTURE

SCANNED

9. Will pesticide, fertilizer, or other foreign substance be injected into the water pumped from the diversion works?
 Yes No If "yes", a check valve shall be required.

All chemigation safety requirements must be met including a chemigation permit and reporting requirements.

10. If you are planning to impound water, please contact the Division of Water Resources for assistance, prior to submitting the application. Please attach a reservoir area capacity table and inform us of the total acres of surface drainage area above the reservoir.

Have you also made an application for a permit for construction of this dam and reservoir with the Division of Water Resources? Yes No

- If yes, show the Water Structures permit number here _____
- If no, explain here why a Water Structures permit is not required _____

11. The application must be supplemented by a U.S.G.S. topographic map, aerial photograph or a detailed plat showing the following information. On the topographic map, aerial photograph, or plat, identify the center of the section, the section lines or the section corners and show the appropriate section, township and range numbers. Also, please show the following information:

(a) The location of the proposed point(s) of diversion (wells, stream-bank installations, dams, or other diversion works) should be plotted as described in Paragraph No. 5 of the application, showing the North-South distance and the East-West distance from a section line or southeast corner of section.

(b) If the application is for groundwater, please show the location of any existing water wells of any kind within 1/2 mile of the proposed well or wells. Identify each existing well as to its use and furnish the name and mailing address of the property owner or owners. If there are no wells within 1/2 mile, please advise us.

(c) If the application is for surface water, the names and addresses of the landowner(s) 1/2 mile downstream and 1/2 mile upstream from your property lines must be shown.

(d) The location of the proposed place of use should be shown by crosshatching on the topographic map, aerial photograph or plat.

(e) Show the location of the pipelines, canals, reservoirs or other facilities for conveying water from the point of diversion to the place of use.

A 7.5 minute U.S.G.S. topographic map may be obtained by providing the section, township and range numbers to: Kansas Geological Survey, 1930 Constant, Campus West, University of Kansas, Lawrence, Kansas 66047.

12. List any application, appropriation of water, water right, or vested right file number that covers the same diversion points or any of the same place of use described in this application. Also list any other recent modifications made to existing permits or water rights in conjunction with the filing of this application.

none

WATER RESOURCES RECEIVED

AUG 10 2016

KS DEPT OF AGRICULTURE

SCANNED

**IRRIGATION USE
SUPPLEMENTAL SHEET**

File No. 491685

Name of Applicant (Please Print): Brian E. Livingston

1. Please supply the name and address of each landowner, the legal description of the lands to be irrigated, and designate the actual number of acres to be irrigated in each forty acre tract or fractional portion thereof:

Landowner of Record NAME: Brian and Traci Livingston Trust
 ADDRESS: 70663 500 AVE PO BOX 136 Reynolds NE 68429

S	T	R	NE¼				NW¼				SW¼				SE¼				TOTAL
			NE	NW	SW	SE	NE	NW	SW	SE	NE	NW	SW	SE	NE	NW	SW	SE	
7	1	1					40	40	40	40									160

Landowner of Record NAME: _____
 ADDRESS: _____

S	T	R	NE¼				NW¼				SW¼				SE¼				TOTAL
			NE	NW	SW	SE	NE	NW	SW	SE	NE	NW	SW	SE	NE	NW	SW	SE	

Landowner of Record NAME: _____
 ADDRESS: _____

S	T	R	NE¼				NW¼				SW¼				SE¼				TOTAL
			NE	NW	SW	SE	NE	NW	SW	SE	NE	NW	SW	SE	NE	NW	SW	SE	

2. Please complete the following information for the description of the operation for the irrigation project. Attach supplemental sheets as needed.

a. Indicate the soils in the field(s) and their intake rates:

Soil Name	Percent of field (%)	Intake Rate (in/hr)	Irrigation Design Group
_____	_____	_____	_____
_____	_____	_____	_____
_____	_____	_____	_____
Total:	100 %	_____	_____

b. Estimate the average land slope in the field(s): _____ %

Estimate the maximum land slope in the field(s): _____ %

c. Type of irrigation system you propose to use (check one):

- Center pivot Center pivot - LEPA "Big gun" sprinkler
 Gravity system (furrows) Gravity system (borders) Sideroll sprinkler

Other, please describe: _____

d. System design features:

i. Describe how you will control tailwater:

ii. For sprinkler systems:

- (1) Estimate the operating pressure at the distribution system: _____ psi
- (2) What is the sprinkler package design rate? _____ gpm
- (3) What is the wetted diameter (twice the distance the sprinkler throws water) of a sprinkler on the outer 100 feet of the system? _____ feet
- (4) Please include a copy of the sprinkler package design information.

e. Crop(s) you intend to irrigate. Please note any planned crop rotations:

f. Please describe how you will determine when to irrigate and how much water to apply (particularly important if you do not plan a full irrigation).

You may attach any additional information you believe will assist in informing the Division of the need for your request.

FEE SCHEDULE

1. The fee for an application for a permit to appropriate water for beneficial use, except for domestic use, shall be (see paragraph No. 2 below if requesting storage):

ACRE-FEET	FEE
0-100	\$200.00
101-320	\$300.00
More than 320	\$300.00 plus \$20.00 for each additional 100 acre-feet or any part thereof.

2. The fee for an application in which storage is requested, except for domestic use, shall be:

ACRE-FEET	FEE
0-250	\$200.00
More than 250	\$200.00 plus \$20.00 for each additional 250 acre-feet of storage or any part thereof.

Note: If an application requests both direct use *and* storage, the fee charged shall be as determined under No. 1 or No. 2 above, whichever is greater, but not both fees.

3. The fee for an application for a permit to appropriate water for water power or dewatering purposes shall be \$100.00 plus \$200.00 for each 100 cubic feet per second, or part thereof, of the diversion rate requested.

Note: The applicant shall notify the Chief Engineer and pay the statutorily required field inspection fee of \$400.00 when construction of the works for diversion has been completed, except that for applications filed on or after July 1, 2009, for works constructed for sediment control use and for evaporation from a groundwater pit for industrial use shall be accompanied by a field inspection fee of \$200.00.

MAKE CHECKS PAYABLE TO THE KANSAS DEPARTMENT OF AGRICULTURE

ATTENTION

A Water Conservation Plan may be required per K.S.A. 82a-733. A statement that your application for permit to appropriate water may be subject to the minimum desirable streamflow requirements per K.S.A. 82a-703a, b, and c may also be required from you. After the Division of Water Resources has had the opportunity to review your application, you will be notified whether or not you will need to submit a Water Conservation Plan. You also may be required to install a water flow meter or water stage measuring device on your diversion works prior to diverting water. There may be other special conditions or Groundwater Management District regulations that you will need to comply with if this application is approved.

CONVERSION FACTORS

1 acre-foot equals 325,851 gallons

1 million gallons equal 3.07 acre-feet

WATER RESOURCES
RECEIVED

AUG 10 2016
SCANNED

KS DEPT OF AGRICULTURE

1320 Research Park Drive
Manhattan, Kansas 66502
(785) 564-6700



900 SW Jackson, Room 456
Topeka, Kansas 66612
(785) 296-3556

Jackie McClaskey, Secretary

Governor Sam Brownback

September 16, 2016

BRIAN E LIVINGSTON
70663 560 AVE PO BOX 136
REYNOLDS NE 68429

FILE COPY

Re: Pending Application,
File No. 49,685

Dear Mr. Livingston:

The Division of Water Resources returned the above referenced application to you for additional information on August 16, 2016, and the current deadline for your response is October 10, 2016. The purpose of this letter is to provide a reminder that in order for you to retain your priority of filing, the original application and requested information needs to be returned to this office on or before **October 10, 2016**, or within any authorized extension of time thereof. According to law, default in refiling of the completed application and attachments within the time allowed shall constitute forfeiture of priority date and dismissal of the application.

If an extension of time is necessary to supply the requested information, please request the extension of time in writing before **October 10, 2016**. Provide information as to why the additional time is needed and how much additional time is requested. Please note that since there are instances when the Chief Engineer may deny your request for an extension of time, there is no guarantee that future requests for more time will be granted.

If you have any questions, please contact me at (785) 564-6631 or by email at alex.whitesell@ks.gov. If you wish to discuss a specific file, please have the file number ready so that I may help you more efficiently.

Sincerely,

Alex Whitesell
Environmental Scientist
Water Appropriation Program

pc: Topeka Field Office

SCANNED

1320 Research Park Drive
Manhattan, Kansas 66502
(785) 564-6700



900 SW Jackson, Room 456
Topeka, Kansas 66612
(785) 296-3556

Jackie McClaskey, Secretary

Governor Sam Brownback

August 16, 2016

BRIAN E LIVINGSTON
70663 560 AVE PO BOX 136
REYNOLDS NE 68429

Re: Pending Application,
File No. 49,685

Dear Mr. Livingston:

The Division of Water Resources returned the above referenced application to you for additional information on August 16, 2016 and gave you a deadline of September 19, 2016. The current, correct deadline for your response is **October 10, 2016**. The purpose of this letter is to provide a correction of your deadline.

If an extension of time is necessary to supply the requested information, please request the extension of time in writing before **October 10, 2016**. I apologize for any confusion this may cause.

If you have any questions, please contact me at (785) 564-6631 or by email at alex.whitesell@ks.gov. If you wish to discuss a specific file, please have the file number ready so that I may help you more efficiently.

Sincerely,



Alex Whitesell
Environmental Scientist
Water Appropriation Program

pc: Topeka Field Office

SCANNED



1320 Research Park Drive
Manhattan, Kansas 66502
(785) 564-6700

900 SW Jackson, Room 456
Topeka, Kansas 66612
(785) 296-3556

Jackie McClaskey, Secretary

Governor Sam Brownback

August 16, 2016

FILE COPY

BRIAN E LIVINGSTON
70663 560 AVE PO BOX 136
REYNOLDS NE 68429

Re: Pending Application,
File No. 49,685

Dear Livingston:

After a preliminary review of your above referenced application for permit to appropriate water received in this office on August 10, 2016, it is being returned to you for additional information. In your original application, you requested a 60-day period of time in which to determine the precise location for your point of diversion within a specified quarter section tract of land described as the Northwest Quarter (NW $\frac{1}{4}$) of Section 7, in Township 1 South, Range 1 East, Washington County, Kansas.

Once you've determined the precise location for your point of diversion, complete the rest of Paragraph No. 5 of your application by providing the description for the 10-acre tract location of the point of diversion as well as the feet distances North and West of the Southeast corner of the Section. The location of the point of diversion must also be plotted on the topographical map included. In the case of a battery of wells, please provide the description of the location of the proposed geographic center of the well battery, as well as **the location for each of the individual wells comprising the battery of wells**.

The locations of all other water wells of every kind within one-half mile ($\frac{1}{2}$) of the point of diversion must be plotted on the topographical map as well. Each well should be identified as to its use (e.g. domestic, irrigation, industrial, etc.) and must **include the name and mailing address of the well owner**. A signed statement should be included on the map declaring that all wells within one-half mile ($\frac{1}{2}$) of the point of diversion have been plotted, or it should declare that none exist. Please provide this information once you have established your point of diversion. Your application currently includes this information; please verify the information is correct once you have established your point of diversion.

Paragraph No. 13 of the application requests well information so the source of supply of the proposed well may be determined. Pursuant to K.A.R. 5-3-4d, this office requires a stratigraphic log of a well or test hole within 300 feet of the proposed point of diversion. Please supply the indicated information and a test hole log or a driller's log with the returned application. Also, the enclosed "Minimum Desirable Streamflow" form must be signed and notarized.

In order to retain its priority of filing, the original application and attachments must be returned to this office with the requested information on or before **September 19, 2016**, or within any authorized extension of time thereof. According to law, default in refileing of the completed application and attachments within the time allowed shall constitute forfeiture of priority date and dismissal of the application.

(over)

SCANNED

Brian Livingston
August 16, 2016
Page 2 of 2

If you have any questions, please contact me at (785) 564-6631 or by email at alex.whitesell@ks.gov.
If you wish to discuss a specific file, please have the file number ready so that I may help you more efficiently.

Sincerely,

A handwritten signature in black ink, appearing to read "Alex Whitesell", with a long horizontal flourish extending to the right.

Alex Whitesell
Environmental Scientist
Water Appropriation Program

enclosures

pc: Topeka Field Office



1320 Research Park Drive
Manhattan, Kansas 66502
Jackie McClaskey, Secretary

Phone: (785) 564-6700
Fax: (785) 564-6777
Email: ksag@kda.ks.gov
www.agriculture.ks.gov
Sam Brownback, Governor

August 10, 2016

FILE COPY

BRIAN E LIVINGSTON
70663 560 AVE PO BOX 136
REYNOLDS KS 68429

RE: Application
File No. 49685 MF

Dear Sir or Madam:

Your application for permit to appropriate water in 7-1S-1E in Washington County, was received and has been assigned the file number noted above.

As a matter of record, the Division of Water Resources has on hand a large number of applications awaiting processing. Therefore to be fair to all concerned, and so that we can process those applications on hand in the order they were received, we intend to concentrate on the backlog of applications until the issue is resolved. Once review of your application has begun, we will contact you, if additional information is required.

In accordance with the provisions of the Kansas Water Appropriation Act, a portion of which is included below, the use of water as proposed prior to approval of the application is unlawful. Once approved, compliance with the terms, conditions and limitations of the permit is necessary. Conservation of the water resources of Kansas is required.

Section 82a-728 of the Kansas Water Appropriation Act, provides (a) except for the appropriation of water for the purpose of domestic use, . . . it shall be unlawful for any person to appropriate or threaten to appropriate water from any source without first applying for and obtaining a permit to appropriate water in accordance with the provisions of the Water Appropriation Act or for any person to violate any condition of a vested right, appropriation right or an approved application for a permit to appropriate water for beneficial use.

(b) (1) The violation of any provision of this section by any person is a class C misdemeanor . . .

A class C misdemeanor is punishable by a fine not to exceed \$500 and/or a term of confinement not to exceed one month in the county jail. Each day that the violation occurs constitutes a separate offense.

If you have any questions, please contact me at (785) 564-6645. If you wish to discuss a specific file, please have the file number ready so that we may help you more efficiently.

Sincerely,

Brent A Turney, P.G.
Change Application Unit Supervisor
Water Appropriation Program

BAT: dlw
pc: TOPEKA Field Office
GMD

SCANNED

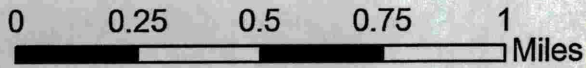

 Place of Use

All wells of any kind within 1/2 mile of the requested point of diversion have been plotted.

Signature: _____

SCANNED

AJW/DWR
Date: 8/16/2016





PLSS: 7_1_1
 Farm: 5363
 Tract: 4472

Alfred [unclear]
Wash [unclear]

49,685

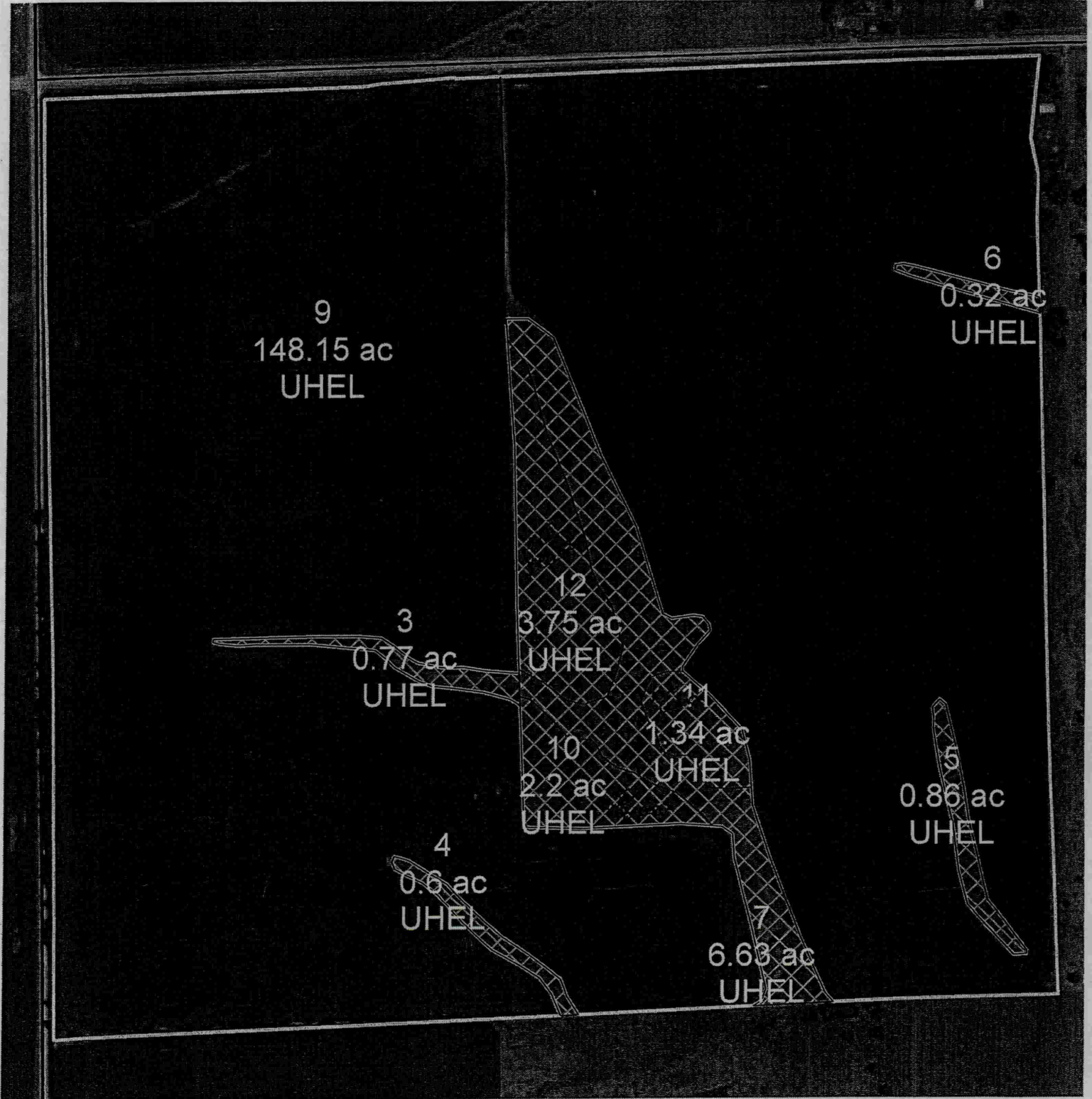

Common Land Unit
 Cropland

Wetland Legend

- Restricted Use
- ▼ Limited Restrictions
- Exempt from Conservation Compliance Provisions

USDA Farm Service Agency
Jefferson County, NE

2016 Program Year

March 14, 2016

2014 NAIP Ortho-Photography

WATER RESOURCES

1 inch = 383.3 feet

USDA FSA maps are for FSA Program administration only. This map does not represent a legal survey or reflect actual ownership; rather it depicts the information provided directly from the producer and/or the NAIP imagery. The producer accepts the data 'as is' and assumes all risks associated with its use. The USDA Farm Service Agency assumes no responsibility for actual or consequential damage incurred as a result of any user's reliance on this data outside of FSA Programs. Wetland identifiers do not represent the size, shape or specific determination of the area. Refer to your original determination (CPA-026 and attached maps) for exact wetland boundaries and determinations, or contact NRCS.