

File No. **50,128** 15. Formation Code: Drainage Basin: **BIG BLUE RIVER** County: **MS** Special Use: Stream: **SPRING CREEK 1 TRIB 1(BIG BLUE)**

16. Points of Diversion										17. Rate and Quantity					
MOD	DEL	ENT	PDIV	Qualifier	S	T	R	ID	'N	'W	MOD ADDL QTY				
										Authorized		Additional			
										Rate	Quantity	Rate	Quantity	Overlap PD Files	
										gpm	af	gpm	af		
√			6550	CS	27	2	7E	2	72	2680	500	64.5	500	0	40,665 & 41,136

18. Storage: Rate **NF** Quantity **114.5** ac/ft Additional Rate **NF** Additional Quantity **114.5** ac/ft

19. Limitation: **64.5** af/yr at _____ gpm (_____ cfs) when combined with file number(s) **35,262; 41,136; 46,322 & 50,127 (Direct IRR Use)**
 Limitation: _____ af/yr at _____ gpm (_____ cfs) when combined with file number(s) _____

20. Meter Required? Yes No To be installed by **12/31/2019** Date Acceptable Meter Installed _____

21. Place of Use							NE¼				NW¼				SW¼				SE¼				Total	Owner	Chg? NO	Overlap Files					
MOD	DEL	ENT	PUSE	S	T	R	ID	NE	NW	SW	SE	NE	NW	SW	SE	NE	NW	SW	SE	NE	NW	SW	SE								
√			17655	27	2	7E	1																						7a.	NO	35,262; 41,136; 46,322 & 50,127

Comments:

KANSAS DEPARTMENT OF AGRICULTURE
Division of Water Resources
MEMORANDUM

TO: Files

DATE: October 22, 2018

FROM: Doug Schemm

RE: Applications, File Nos. 50,127 & 50,128

Marysville Country Club Inc. has filed the referenced new applications. Application, File No. 50,127 is requesting to appropriate 64.5 acre-feet of groundwater from an existing well at a rate of 600 gallons per minute for irrigation use. The well is located in the Southwest Quarter of Section 21, Township 2 South, Range 7 East, Marshall County, within the Big Blue River Drainage Basin. The well is currently authorized under Water Right, File No. 46,322, which is authorized 21 acre-feet at a diversion rate of 105 gallons per minute. The place of use (golf course) is owned by the applicant and a representative has signed the application form stating they has access to the point of diversion. The applicant exceeded their authorized quantity of water in 2017 under File No. 46,322, and this new application is designed to provide additional water and prevent over-pumping in the future.

Application, File No. 50,128 is requesting to appropriate 114.5 acre-feet of surface water storage at the rate of natural flows to be stored in an existing reservoir located near the south side of Section 27, in Township 2 South, Range 7 East, Marshall County. The dam is located on Spring Creek 1 Trib 1 in the Big Blue River basin. The point of diversion is located on property owned by the applicant, and a representative of the applicant has signed the application form stating that they have legal access to the point of diversion. The reservoir is currently authorized for REC use under File No. 40,665, and for IRR use under File No. 41,136. File No. 40,665 is authorized 21 acre-feet of surface water storage (2 years of evaporation), while File No. 41,136 is authorized 20 acre-feet of storage and the re-diversion (direct use) of 4.8 acre-feet at 32 gpm for irrigation use at the golf course.

The requested quantity under File No. 50,128 was based on 1 year of direct use on 43 acres x 1.5 AF/acre = 64.5 AF + capacity of reservoir of 50 AF = 114.5 acre-feet. The 1.5 AF/acre is reasonable for the special grass grown by golf courses, the need to mow frequently, very short grass, and the heavy foot and cart traffic.

Finally, Water Right, File No. 35,262 overlaps in place of use at the golf course. It is authorized 19 acre-feet of direct diversion of surface water from the Big Blue River. However, it has not been pumped in many years (since 2006), and due to a dam collapse on the river, it will likely not be pumped in the future. The three senior IRR files authorize a combined 44.8 acre-feet (21 AF + 4.8 AF + 19 AF) for use at the golf course. In order to ensure adequate water for the golf course, it is proposed that File No. 50,127 be limited to 64.5 acre-feet when combined with the senior files, providing 19.7 acre-feet of additional water. File No. 50,128 will also be limited to 64.5 acre-feet for direct irrigation use, providing 0 additional water.

Two wells were identified within one-half mile of the well under File No. 50,127, and four upstream and downstream landowners were identified for File No. 50,128. Nearby notification letters were sent out for both files on September 26, 2018. No responses of any kind were received. In addition, a representative of the applicant personally visited with the nearby landowners and they expressed no concerns. The proposed point of diversion under File No. 50,127 meets minimum well spacing criteria to all existing wells per the requirements in K.A.R. 5-4-4. It is located over 2,300 feet from the nearest irrigation well, and over 2,000 feet from the nearest domestic well.

Note that Water Right, File No. 41,136 contains a significant amount of information related to discussions between the City of Marysville who own the REC use water right, File No. 40,665, and the Country Club. The City was previously concerned that irrigation use from the lake would lower levels and affect recreational use at the lake. However, the parties reached an agreement. The City was sent a nearby letter regarding this new application on the lake, but they have not responded. The application states that they will not pump water from the lake when it will significantly decrease water level in the lake, and will use the groundwater well if this were to happen.

For File No. 50,127 the point of diversion consists of a single well completed in the Big Blue River alluvium. K.A.R. 5-3-11 states that safe yield is based on the extent of the alluvium (per topographic and LIDAR data) for the area of consideration, which provides a total of 2,535 acres (per Lidar data). Based on a potential recharge of 4.2 inches, with 100% available for appropriation, safe yield was determined to be 887.25 acre-feet. Existing water rights have appropriated 212.83 acre-feet within the area of consideration, leaving 674.42 acre-feet available, and the application requesting 64.5 acre-feet complies with safe yield criteria.

A review of senior File No. 41,136 shows that runoff computations for this reservoir determined that the 631-acre drainage area will yield 480 acre-feet of runoff quantity in 1 out of every five (5) years (a 20% chance), so runoff is NOT the limiting factor. The capacity of the reservoir is 50 acre-feet, and the annual evaporation is approximately 10.4 acre-feet.

The total direct use quantity of 64.5 acre-feet, is equivalent to 1.3 times the capacity (50 AF), which is well within the normal "rule of thumb" of direct use quantity being no more than 5 times capacity for reasonable storage quantity.

The existing dam was previously reviewed by DWR Water Structures Program under File No. DMS-144, and was determined to be non-jurisdictional for structures permitting. In addition, File No. 46,322 was reviewed by Bob Lytle, who determined that it was not subject to any requirements under the Big Blue River Compact with Nebraska.

The applicant has submitted signed Minimum Desirable Streamflow forms, which have been properly notarized. By completing this statement, the applicant affirms his/her knowledge that there could be times when the diversion of water may not be allowed under these permits.

In accordance with K.S.A. 82a-706c, the Chief Engineer retains full authority to require any water user to install meters, gages, or other measuring devices, which devices he or she or his or her agents may read at any time. Water flowmeter requirements are further described in K.A.R. 5-1-4 through K.A.R 5-1-12. If any chemical or foreign substance is injected into the water pumped under these permits, check valves will also need to be installed.

In an October 22, 2018 e-mail, Katie Tietsort, Water Commissioner, Topeka Field Office, recommended approval of the referenced new applications. Based on the above discussion, well spacing and safe yield criteria are met for File No. 50,127, this will address an over pumping issue, and approval of the applications will not impair senior water rights nor prejudicially or unreasonably affect the public interest, it is recommended that the referenced new applications be approved.

Douglas W. Schemm
Environmental Scientist
Topeka Field Office

STATE OF KANSAS

DEPARTMENT OF AGRICULTURE
1320 RESEARCH PARK DRIVE
MANHATTAN, KS 66502
PHONE: (785) 564-6700
FAX: (785) 564-6777



900 SW JACKSON, ROOM 456
TOPEKA, KS 66612
PHONE: (785) 296-3556
www.agriculture.ks.gov

GOVERNOR JEFF COLYER, M.D.
JACKIE McCLASKEY, SECRETARY OF AGRICULTURE

November 5, 2018

MARYSVILLE COUNTRY CLUB INC
% JOE KROGMAN
PO BOX 45
MARYSVILLE KS 66508

Re: Appropriation of Water, File Nos. 50,127 and 50,128

Dear Mr. Krogman:

There are enclosed permits to appropriate water authorizing you to proceed with construction of the proposed diversion works (except those dams and stream obstructions regulated by K.S.A. 82a-301 through 305a), to divert such unappropriated water as may be available from the source and at the locations specified in these permits, and to use it for the purpose and at the location described in these permits.

Your attention is directed to the enclosures and to the terms, conditions, and limitations specified in these approval documents. Water meters are required on the proposed diversion works and you must install them prior to water being put to beneficial use in order for you to maintain accurate records of water use. The meters should be used to provide the information required on the annual water use reports.

Failure to notify the Chief Engineer of the Division of Water Resources of the completion of the diversion works within the time allowed, or within any authorized extension of time thereof, will result in the dismissal of these permits. Enclosed are forms which may be used to notify the Chief Engineer that the proposed diversion works have been completed. All requests for extensions of time to complete diversion works, or to perfect appropriations, must be submitted to the Chief Engineer before the expiration of time originally set forth in these permits to complete diversion works or to perfect an appropriation. If for any reason, you require an extension of time, you must request it before the expiration of time set forth in these permits. Failure to comply with this regulation will result in the dismissal of your permits or your water rights. Any request for an extension of time shall be accompanied by the required statutory fee, which is currently \$100.00 per file number. There is also enclosed an information sheet setting forth the procedure to obtain a Certificate of Appropriation which will establish the extent of your water rights.

Sincerely,

Kristen A. Baum
New Application Unit Supervisor
Water Appropriation Program

KAB:dws
Enclosures

pc: Topeka Field Office

KANSAS DEPARTMENT OF AGRICULTURE
 Jackie McClaskey, Secretary of Agriculture

DIVISION OF WATER RESOURCES
 David W. Barfield, Chief Engineer

APPROVAL OF APPLICATION
and
PERMIT TO PROCEED
 (This is not a Certificate of Appropriation)

This is to certify that I have examined Application, **File No. 50,128** of the applicant

MARYSVILLE COUNTRY CLUB INC
PO BOX 45
MARYSVILLE KS 66508

for a permit to appropriate water for beneficial use, together with the maps, plans and other submitted data, and that the application is hereby approved and the applicant is hereby authorized, subject to vested rights and prior appropriations, to proceed with the construction of the proposed diversion works (except those dams and stream obstructions regulated by K.S.A. 82a-301 through 305a, as amended), and to proceed with all steps necessary for the application of the water to the approved and proposed beneficial use and otherwise perfect the proposed appropriation subject to the following terms, conditions and limitations:

1. That the priority date assigned to such application is **September 10, 2018**.
2. That the water sought to be appropriated shall be used for irrigation use on land described in the application, as follows:

Sec.	Twp.	Range	NE¼				NW¼				SW¼				SE¼				TOTAL		
			NE¼	NW¼	SW¼	SE¼	NE¼	NW¼	SW¼	SE¼	NE¼	NW¼	SW¼	SE¼	NE¼	NW¼	SW¼	SE¼			
27	2S	7E																	22	21	43

3. That the appropriation sought shall be limited to all natural flows of an unnamed tributary to Spring Creek 1, designated in the office of the Chief Engineer as Spring Creek 1 Trib 1 (Big Blue), not needed to satisfy all vested rights and prior appropriation rights to be incrementally accumulated as reservoir storage space becomes available to a maximum extent of **114.5 acre-feet** per calendar year in one (1) reservoir created by a dam located near the center of the South side of Section 27, more particularly described as being near a point 72 feet North and 2,680 feet West of the Southeast corner of said section, in Township 2 South, Range 7 East, Marshall County, Kansas, to provide **64.5 acre-feet** of water as needed for direct irrigation use to be withdrawn, released or otherwise diverted from the reservoir at a re-diversion rate of approximately **500 gallons per minute** (1.11 c.f.s.). A reasonable maximum re-diversion rate will be established during the perfection period and assigned at certification.

4. That installation of works for diversion of water shall be completed on or before **December 31, 2019** or within any authorized extension thereof. The applicant shall notify the Chief Engineer and pay the statutorily required field inspection fee, which is currently \$400.00, when construction of the works has been completed. Failure to timely submit the notice and the fee will result in revocation of the permit. Any request for an extension of time shall be submitted prior to the expiration of the deadline and shall be accompanied by the required statutory fee, which is currently \$100.00.

5. That the proposed appropriation shall be perfected by the actual application of water to the proposed beneficial use on or before **December 31, 2023** or any authorized extension thereof. Any request for an extension of time shall be submitted prior to the expiration of the deadline and shall be accompanied by the required statutory fee, which is currently \$100.00.

6. That the applicant shall not be deemed to have acquired a water appropriation for a quantity in excess of the amount approved herein nor in excess of the amount found by the Chief Engineer to have been actually used for the approved purpose during one calendar year subsequent to approval of the application and within the time specified for perfection or any authorized extension thereof.

7. That the use of water herein authorized shall not be made so as to impair any use under existing water rights nor prejudicially and unreasonably affect the public interest.

8. That the right of the appropriator shall relate to a specific quantity of water and such right must allow for a reasonable raising or lowering of the static water level and for the reasonable increase or decrease of the streamflow at the appropriator's point of diversion.

9. That this permit does not constitute authority under K.S.A. 82a-301 through 305a to construct any dam or other obstruction; nor does it grant any right-of-way, or authorize entry upon or injury to, public or private property.

10. That all re-diversion works constructed under the authority of this permit into which any type of chemical or other foreign substance will be injected into the water pumped from the re-diversion works shall be equipped with an in-line, automatic quick-closing, check valve capable of preventing pollution of the source of the water supply. The type of valve installed shall meet specifications adopted by the Chief Engineer and shall be maintained in an operating condition satisfactory to the Chief Engineer.

11. That an acceptable water flow meter shall be installed and maintained on the re-diversion works authorized by this permit in accordance with the Kansas Administrative Regulations 5-1-4 through 5-1-12 adopted by the Chief Engineer. This water flow meter shall be used to provide an accurate quantity of water diverted as required for the annual water use report (including the meter reading at the beginning and end of the report year).

12. That the applicant shall maintain accurate and complete records from which the quantity of water diverted during each calendar year may be readily determined and the applicant shall file an annual water use report with the Chief Engineer by March 1 following the end of each calendar year. Failure to file the annual water use report by the due date shall cause the applicant to be subject to a civil penalty.

13. That no water user shall engage in nor allow the waste of any water diverted under the authority of this permit.

14. That failure without cause to comply with provisions of the permit and its terms, conditions and limitations will result in the forfeiture of the priority date, revocation of the permit and dismissal of the application.

15. That the right to appropriate water under authority of this permit is subject to any minimum desirable streamflow requirements identified and established pursuant to K.S.A. 82a-703c for the source of supply to which this water right applies.

16. That the quantity of water approved for direct irrigation use under this permit is further limited to the quantity which combined with Water Right, File Nos. 35,262; 41,136; and 46,322, and Appropriation of Water, File No. 50,127, will provide **a total not to exceed 64.5 acre-feet** of water per calendar year for direct irrigation use on the land described herein.

RIGHT TO A HEARING AND TO ADMINISTRATIVE REVIEW

If you are aggrieved by this Order, then pursuant to K.S.A. 82a-1901, you may:

- 1) request an evidentiary hearing before the Chief Engineer, or
- 2) request administrative review by the Secretary of Agriculture.

Failure to request an evidentiary hearing before the Chief Engineer does not preclude your right to administrative review by the Secretary. To obtain an evidentiary hearing before the Chief Engineer, a written request for hearing must be filed within 15 days after service of this Order as provided in K.S.A. 77-531 (i.e., **within a total of 18 days after this Order was mailed to you**), with: Kansas Department of Agriculture, Attn: Legal Section, 1320 Research Park Drive, Manhattan, Kansas 66502, FAX (785) 564-6777.

If you do not file a request for an evidentiary hearing before the Chief Engineer, you may petition for administrative review of the Order by the Secretary of Agriculture. A petition for review shall be in writing and state the basis for requesting administrative review. The request for hearing may be denied if the request fails to clearly establish factual or legal issues for review. See K.S.A. 77-527. The petition must be filed within 30 days after service of this Order as provided in K.S.A. 77-531 (i.e., **within a total of 33 days after this Order was mailed to you**), and be filed with: Secretary of Agriculture, Attn: Legal Division, Kansas Department of Agriculture, 1320 Research Park Drive, Manhattan, Kansas 66502, FAX (785) 564-6777.

If neither a request for an evidentiary hearing nor a petition for administrative review is filed as set forth above, then this Order shall be effective and become a final agency action as defined in K.S.A. 77-607(b). Failure to timely request either an evidentiary hearing or administrative review may preclude further judicial review under the Kansas Judicial Review Act.

Ordered this 2nd day of November, 2018, in Topeka, Shawnee County, Kansas.

Lane P. Letourneau

Lane P. Letourneau, P.G.
Program Manager
Water Appropriation Program
Division of Water Resources
Kansas Department of Agriculture

State of Kansas)
) SS
County of Riley)

The foregoing instrument was acknowledged before me this 2nd day of November, 2018, by Lane P. Letourneau, P.G., Program Manager, Division of Water Resources, Kansas Department of Agriculture.



Danielle Wilson
Notary Public

CERTIFICATE OF SERVICE

On this *5th* day of *November*, 2018, I hereby certify that the foregoing Approval of Application, File No. 50,128, dated *November 2nd, 2018* was mailed postage prepaid, first class, US mail to the following:

MARYSVILLE COUNTRY CLUB INC
PO BOX 45
MARYSVILLE KS 66508

With photocopies to:

Topeka Field Office



Division of Water Resources

[Faint, illegible text, possibly a stamp or additional signature]

THE STATE OF KANSAS



KANSAS DEPARTMENT OF AGRICULTURE
Jackie McClaskey, Secretary of Agriculture

DIVISION OF WATER RESOURCES
David W. Barfield, Chief Engineer

File Number 50128

This item to be completed by the Division of Water Resources.

Water Resources
Received

SEP 10 2018

12:56

KS Dept Of Agriculture

APPLICATION COMPLETE
10/25/18
Reviewer VAB/DWS

**APPLICATION FOR PERMIT TO
APPROPRIATE WATER FOR BENEFICIAL USE**

Filing Fee Must Accompany the Application
(Please refer to Fee Schedule attached to this application form.)

To the Chief Engineer of the Division of Water Resources, Kansas Department of Agriculture,
1320 Research Park Drive, Manhattan, Kansas 66502:

1. Name of Applicant (Please Print): Marysville Country Club Inc
Address: PO BOX 45
City: MARYSVILLE State KS Zip Code 66508
Telephone Number: (785) 562-6779 (Joe Krogman)

2. The source of water is: surface water in Spring Creek 1 Trib 1 (Big Blue)
(stream)
OR groundwater in _____
(drainage basin)

Certain streams in Kansas have minimum target flows established by law or may be subject to administration when water is released from storage for use by water assurance district members. If your application is subject to these regulations on the date we receive your application, you will be sent the appropriate form to complete and return to the Division of Water Resources.

3. The maximum quantity of water desired is 64.5 AF (direct use) and 114.5 AF (storage) OR _____ gallons per calendar year, to be diverted at a maximum rate of natural flows to be re-diverted at 500 gallons per minute.

Once your application has been assigned a priority, the requested maximum rate of diversion and maximum requested quantity of water under that priority number can **NOT** be increased. Please be certain your requested maximum rate of diversion and maximum quantity of water are appropriate and reasonable for your proposed project and are in agreement with the Division of Water Resources' requirements.

4. The water is intended to be appropriated for (Check use intended):
(a) Artificial Recharge (b) Irrigation (c) Recreational (d) Water Power
(e) Industrial (f) Municipal (g) Stockwatering (h) Sediment Control
(i) Domestic (j) Dewatering (k) Hydraulic Dredging (l) Fire Protection
(m) Thermal Exchange (n) Contamination Remediation

YOU **MUST** COMPLETE AND ATTACH ADDITIONAL DIVISION OF WATER RESOURCES FORM(S) PROVIDING INFORMATION TO SUBSTANTIATE YOUR REQUEST FOR THE AMOUNT OF WATER FOR THE INTENDED USE REFERENCED ABOVE.

For Office Use Only:		Meets K.A.R. 5-3-1 (YES/NO)		Use	Source	County	By	Date
F.O.	<u>GMD</u>	<u>YES</u>	<u>NO</u>	<u>IRR</u>	<u>G</u>	<u>S</u>	<u>AW</u>	<u>9/16/18</u>
Code	<u>1019</u>	Fee \$	<u>400</u>	TR #	Receipt Date	<u>9/10/18</u>	Check #	<u>15223</u>

SCANNED
9/17/2018 11:16 AM

5. The location of the proposed wells, pump sites or other works for diversion of water is:

Note: For the application to be accepted, the point of diversion location must be described to at least a 10 acre tract, unless you specifically request a 60 day period of time in which to locate the site within a specifically described, minimal legal quarter section of land.

(A) One near the center of the south side of Section 27, more particularly described as being near a point 72 feet North and 2680 feet West of the Southeast corner of said section, in Township 2 South, Range 7 East, Marshall County, Kansas.

(B) One in the _____ quarter of the _____ quarter of the _____ quarter of Section _____, more particularly described as being near a point _____ feet North and _____ feet West of the Southeast corner of said section, in Township _____ South, Range _____ East/West (circle one), _____ County, Kansas.

(C) One in the _____ quarter of the _____ quarter of the _____ quarter of Section _____, more particularly described as being near a point _____ feet North and _____ feet West of the Southeast corner of said section, in Township _____ South, Range _____ East/West (circle one), _____ County, Kansas.

(D) One in the _____ quarter of the _____ quarter of the _____ quarter of Section _____, more particularly described as being near a point _____ feet North and _____ feet West of the Southeast corner of said section, in Township _____ South, Range _____ East/West (circle one), _____ County, Kansas.

If the source of supply is groundwater, a separate application shall be filed for each proposed well or battery of wells, except that a single application may include up to four wells within a circle with a quarter (1/4) mile radius in the same local source of supply which do not exceed a maximum diversion rate of 20 gallons per minute per well.

A battery of wells is defined as two or more wells connected to a common pump by a manifold; or not more than four wells in the same local source of supply within a 300 foot radius circle which are being operated by pumps not to exceed a total maximum diversion rate of 800 gallons per minute and which supply water to a common distribution system.

6. The owner of the point of diversion, if other than the applicant is (please print):

Applicant _____
(name, address and telephone number)

You must provide evidence of legal access to, or control of, the point of diversion from the landowner or the landowner's authorized representative. Provide a copy of a recorded deed, lease, easement or other document with this application. In lieu thereof, you may sign the following sworn statement:

I have legal access to, or control of, the point of diversion described in this application from the landowner or the landowner's authorized representative. I declare under penalty of perjury that the foregoing is true and correct.

Executed on 9/6, 2018. Margie McCarty Club Joe Rogman
Applicant's Signature

The applicant must provide the required information or signature irrespective of whether they are the landowner. Failure to complete this portion of the application will cause it to be unacceptable for filing and the application will be returned to the applicant.

7. The proposed project for diversion of water will consist of one dam & pump
(number of wells, pumps or dams, etc.)
and was completed on 4-23-1996 Pond built in 1960's. LHM/TEO
(Month/Day/Year - each was or will be completed)

8. The first actual application of water for the proposed beneficial use was or is estimated to be upon approval.

- 9. Will pesticide, fertilizer, or other foreign substance be injected into the water pumped from the diversion works?
 Yes No If "yes", a check valve shall be required.

All chemigation safety requirements must be met including a chemigation permit and reporting requirements.

- 10. If you are planning to impound water, please contact the Division of Water Resources for assistance, prior to submitting the application. Please attach a reservoir area capacity table and inform us of the total acres of surface drainage area above the reservoir.

Have you also made an application for a permit for construction of this dam and reservoir with the Division of Water Resources? Yes No

- If yes, show the Water Structures permit number here _____
- If no, explain here why a Water Structures permit is not required _____

Previously reviewed under WSN: DMS-144 and determined pre-jurisdictional; no modifications are planned

- 11. The application must be supplemented by a U.S.G.S. topographic map, aerial photograph or a detailed plat showing the following information. On the topographic map, aerial photograph, or plat, identify the center of the section, the section lines or the section corners and show the appropriate section, township and range numbers. Also, please show the following information:

- (a) The location of the proposed point(s) of diversion (wells, stream-bank installations, dams, or other diversion works) should be plotted as described in Paragraph No. 5 of the application, showing the North-South distance and the East-West distance from a section line or southeast corner of section.
- (b) ~~If the application is for groundwater, please show the location of any existing water wells of any kind within 1/2 mile of the proposed well or wells. Identify each existing well as to its use and furnish the name and mailing address of the property owner or owners. If there are no wells within 1/2 mile, please advise us.~~
- (c) If the application is for surface water, the names and addresses of the landowner(s) 1/2 mile downstream and 1/2 mile upstream from your property lines must be shown.
- (d) The location of the proposed place of use should be shown by crosshatching on the topographic map, aerial photograph or plat.
- (e) Show the location of the pipelines, canals, reservoirs or other facilities for conveying water from the point of diversion to the place of use.

A 7.5 minute U.S.G.S. topographic map may be obtained by providing the section, township and range numbers to: Kansas Geological Survey, 1930 Constant, Campus West, University of Kansas, Lawrence, Kansas 66047.

- 12. List any application, appropriation of water, water right, or vested right file number that covers the same diversion points or any of the same place of use described in this application. Also list any other recent modifications made to existing permits or water rights in conjunction with the filing of this application.

Point of Diversion overlap - Water Right, File No. 41,136 (IRR) & 40665 (REC)

Place of Use overlap - Water Right, File Nos. 35,262; 41,136; & 46,322

This application is being filed concurrently with a groundwater application at PDIV ID: 72067 that will serve the same place of use.

DIVISION

2018

KANSAS

13. Furnish the following well information if the proposed appropriation is for the use of groundwater. If the well has not been completed, give information obtained from test holes, if available.

Information below is from: Test holes Well as completed Drillers log attached

Well location as shown in paragraph No.	(A)	(B)	(C)	(D)
Date Drilled	_____	_____	_____	_____
Total depth of well	_____	_____	_____	_____
Depth to water bearing formation	_____	_____	_____	_____
Depth to static water level	_____	_____	_____	_____
Depth to bottom of pump intake pipe	_____	_____	_____	_____

14. The relationship of the applicant to the proposed place where the water will be used is that of

Owner
(owner, tenant, agent or otherwise)

15. The owner(s) of the property where the water is used, if other than the applicant, is (please print):

Applicant
(name, address and telephone number)

(name, address and telephone number)

16. The undersigned states that the information set forth above is true to the best of his/her knowledge and that this application is submitted in good faith.

Dated at _____, Kansas, this _____ day of _____
(month) (year)

MABYSVILLE COUNTRY CLUB
(Applicant Signature)

By Joe Brogman GCS
(Agent or Officer Signature)

Joe Brogman
(Agent or Officer - Please Print)

Assisted by Lloyd Hemphill TFO/ESII Date: 8/17/2018
(office/title)

Water Resources
Received
SEP 10 2018
KS Dept Of Agriculture
SCANNED

IRRIGATION USE SUPPLEMENTAL SHEET

File No. 50128

Name of Applicant (Please Print): MARYSVILLE COUNTRY CLUB INC

1. Please supply the name and address of each landowner, the legal description of the lands to be irrigated, and designate the actual number of acres to be irrigated in each forty acre tract or fractional portion thereof:

Landowner of Record NAME: MARYSVILLE COUNTRY CLUB INC

ADDRESS: PO BOX 45 MARYSVILLE KS 66508

S	T	R	NE¼				NW¼				SW¼				SE¼				TOTAL
			NE	NW	SW	SE	NE	NW	SW	SE	NE	NW	SW	SE	NE	NW	SW	SE	
27	2S	7E															22	21	43

Landowner of Record NAME: _____

ADDRESS: _____

S	T	R	NE¼				NW¼				SW¼				SE¼				TOTAL
			NE	NW	SW	SE	NE	NW	SW	SE	NE	NW	SW	SE	NE	NW	SW	SE	

Landowner of Record NAME: _____

ADDRESS: _____

S	T	R	NE¼				NW¼				SW¼				SE¼				TOTAL
			NE	NW	SW	SE	NE	NW	SW	SE	NE	NW	SW	SE	NE	NW	SW	SE	

Water Resources
Received

SEP 10 2018

2. Please complete the following information for the description of the operation for the irrigation project. Attach supplemental sheets as needed.

a. Indicate the soils in the field(s) and their intake rates:

Soil Name	Percent of field (%)	Intake Rate (in/hr)	Irrigation Design Group
<u>Kennebec</u>	<u>40</u>	<u>0.6-2.0</u>	<u>5</u>
<u>Wymore</u>	<u>55</u>	<u>0.2-0.6</u>	<u>1</u>
<u>Jully</u>	<u>5</u>	<u>0.2-2.0</u>	<u>3</u>
Total:	100 %		

b. Estimate the average land slope in the field(s): 3 %

Estimate the maximum land slope in the field(s): 5 %

c. Type of irrigation system you propose to use (check one):

Center pivot Center pivot - LEPA "Big gun" sprinkler

Gravity system (furrows) Gravity system (borders) Sideroll sprinkler

Other, please describe: pop-up-sprinklers

d. System design features:

i. Describe how you will control tailwater:

ii. For sprinkler systems:

(1) Estimate the operating pressure at the distribution system: 120 psi

(2) What is the sprinkler package design rate? 25-30 gpm

(3) What is the wetted diameter (twice the distance the sprinkler throws water) of a sprinkler on the outer 100 feet of the system? N/A feet

(4) Please include a copy of the sprinkler package design information.

e. Crop(s) you intend to irrigate. Please note any planned crop rotations:

TURF GRASS TYPICAL FOR GOLF COURSE GROUNDS

Greens, tees, & fairways

f. Please describe how you will determine when to irrigate and how much water to apply (particularly important if you do not plan a full irrigation).

Soil probe, visual inspection

You may attach any additional information you believe will assist in informing the Division of the need for your request.

AMOUNT STATISTICS REPORT FOR POINTS OF DIVERSION UNDER A 50128 00

#####

AMOUNT STATISTICS REPORT FOR POINTS OF DIVERSION UNDER A 50128 00 IRR

Water Right and Points of Diversion Within 2.00 miles of point defined as:

72 Feet North and 2680 Feet West of the Southeast Corner of Section 27 T 2S R 7E

SURFACE WATER ONLY

```

=====
File Number   Use ST SR Dist (ft) Q4 Q3 Q2 Q1 FeetN FeetW Sec Twp Rng ID Batt Auth_Quan Add_Quan Unit
A__ 35262 00 IRR NK S      10181 -- NE NW SW 2373 4121 21 2 7E 8      19.00 19.00 AF
A__ 40665 00 REC NK S          0 -- -- -- CS 72 2680 27 2 7E 2      21.00 21.00 AF
A__ 41136 00 IRR NK S          0 -- -- -- CS 72 2680 27 2 7E 2         4.80 4.80 AF
A__ 45035 00 REC NK S      8894 -- NE SE SE 1125 50 32 2 7E 11         .00 .00 AF
A__ 50128 00 IRR AY S          0 -- -- -- CS 72 2680 27 2 7E 2      64.50 64.50 AF
=====

```

```

=====
Total Net Quantities Authorized:   Direct      Storage
Total Requested Amount (AF) =      64.50      114.50
Total Permitted Amount (AF) =         .00         .00
Total Inspected Amount (AF) =         .00         .00
Total Pro_Cert Amount (AF) =         .00         .00
Total Certified Amount (AF) =      44.80      235.00
Total Vested Amount (AF) =         .00         .00
TOTAL AMOUNT (AF) =      109.30      349.50
=====

```

An * after the source of supply indicates a pending application for change under the file number.
 An * after the ID indicates a 15 AF exemption was granted under the file number.
 A "G" in the Batt column indicates the GEO CTR of a battery. A "B" indicates a well in the battery.
 The number in the Batt column is the number of wells in the battery.

Water Rights and Points of Diversion Within 2.00 miles of point defined as:

72 Feet North and 2680 Feet West of the Southeast Corner of Section 27 T 2S R 7E

SURFACE WATER ONLY

WATER USE CORRESPONDENTS:

```

=====
File Number   Use ST SR
A__ 35262 00 IRR NK S
> MARYSVILLE COUNTRY CLUB INC
>
> PO BOX 45
> MARYSVILLE KS 66508
-----
A__ 40665 00 REC NK S
> CITY OF MARYSVILLE
> CITY BUILDING
> 209 N 8TH ST
> MARYSVILLE KS 66508
-----
A__ 41136 00 IRR NK S
> MARYSVILLE COUNTRY CLUB INC
>
> PO BOX 45
> MARYSVILLE KS 66508
-----
A__ 45035 00 REC NK S

```

> CITY OF MARYSVILLE
> CITY BUILDING
> 209 N 8TH ST
> MARYSVILLE KS 66508

>-----

A__ 50128 00 IRR AY S
> MARYSVILLE COUNTRY CLUB INC
>
> PO BOX 45
> MARYSVILLE KS 66508

>-----

=====

#####

STATE OF KANSAS

DEPARTMENT OF AGRICULTURE
DIVISION OF WATER RESOURCES
TOPEKA FIELD OFFICE
6531 SE FORBES AVE., SUITE B
TOPEKA, KS 66619



PHONE: (785) 296-5733
FAX: (785) 296-8298
www.agriculture.ks.gov

GOVERNOR JEFF COLYER, M.D.
JACKIE McCLASKEY, SECRETARY OF AGRICULTURE

September 26, 2018

CITY OF MARYSVILLE
209 N 8TH ST
MARYSVILLE KS 66508

Re: Pending New Application, File No. 50,128

Dear Sir or Madam:

This is to advise you that Marysville Country Club Inc. has filed the new application referred to above for a permit to appropriate 114.5 acre-feet of surface water per calendar year to be stored in an existing reservoir and re-divert 64.5 acre-feet of the stored water for irrigation use. Please note that this is an existing reservoir currently authorized under Water Right, File Nos. 40,665 (REC) and 41,136 (IRR). The point of diversion (where the dam crosses the centerline of the stream) is located near the center of the South side of Section 27, Township 2 South, Range 7 East, Marshall County, Kansas.

Records in this office indicate that you own land along the stream in this vicinity and you are being notified of receipt of this application in order that you may be fully informed of the proposed location of the applicant's point of diversion and proposed use of water. Consideration will be given to comments or other information which you desire to submit to this office **within 15 days** from the date of this letter.

You can find the application and site map posted by the file number referenced above at:
<http://agriculture.ks.gov/divisions-programs/dwr/water-appropriation/notices>

If you have any questions or comments, you may also contact me at (785) 296-3495. If you call, please reference the file number so I can help you more efficiently.

Sincerely,

Douglas W. Schemm
Environmental Scientist
Topeka Field Office

pc: Marysville County Club Inc.

STATE OF KANSAS

DEPARTMENT OF AGRICULTURE
DIVISION OF WATER RESOURCES
TOPEKA FIELD OFFICE
6531 SE FORBES AVE., SUITE B
TOPEKA, KS 66619



PHONE: (785) 296-5733
FAX: (785) 296-8298
www.agriculture.ks.gov

GOVERNOR JEFF COLYER, M.D.
JACKIE McCLASKEY, SECRETARY OF AGRICULTURE

September 26, 2018

MARY J WIEGERS
1110 BROADWAY
MARYSVILLE KS 66508

Re: Pending New Application, File No. 50,128

Dear Sir or Madam:

This is to advise you that Marysville Country Club Inc. has filed the new application referred to above for a permit to appropriate 114.5 acre-feet of surface water per calendar year to be stored in an existing reservoir and re-divert 64.5 acre-feet of the stored water for irrigation use. Please note that this is **an existing reservoir** currently authorized under Water Right, File Nos. 40,665 (REC) and 41,136 (IRR). The point of diversion (where the dam crosses the centerline of the stream) is located near the center of the South side of Section 27, Township 2 South, Range 7 East, Marshall County, Kansas.

Records in this office indicate that you own land along the stream in this vicinity and you are being notified of receipt of this application in order that you may be fully informed of the proposed location of the applicant's point of diversion and proposed use of water. Consideration will be given to comments or other information which you desire to submit to this office **within 15 days** from the date of this letter.

You can find the application and site map posted by the file number referenced above at:
<http://agriculture.ks.gov/divisions-programs/dwr/water-appropriation/notices>

If you have any questions or comments, you may also contact me at (785) 296-3495. If you call, please reference the file number so I can help you more efficiently.

Sincerely,

Douglas W. Schemm
Environmental Scientist
Topeka Field Office

pc: Marysville County Club Inc.

STATE OF KANSAS

DEPARTMENT OF AGRICULTURE
DIVISION OF WATER RESOURCES
TOPEKA FIELD OFFICE
6531 SE FORBES AVE., SUITE B
TOPEKA, KS 66619



PHONE: (785) 296-5733
FAX: (785) 296-8298
www.agriculture.ks.gov

GOVERNOR JEFF COLYER, M.D.
JACKIE McCLASKEY, SECRETARY OF AGRICULTURE

September 26, 2018

DON & LYNDA BRUNA
1084 JUNIPER ROAD
MARYSVILLE KS 66508

Re: Pending New Application, File No. 50,128

Dear Sir or Madam:

This is to advise you that Marysville Country Club Inc. has filed the new application referred to above for a permit to appropriate 114.5 acre-feet of surface water per calendar year to be stored in an existing reservoir and re-divert 64.5 acre-feet of the stored water for irrigation use. Please note that this is **an existing reservoir** currently authorized under Water Right, File Nos. 40,665 (REC) and 41,136 (IRR). The point of diversion (where the dam crosses the centerline of the stream) is located near the center of the South side of Section 27, Township 2 South, Range 7 East, Marshall County, Kansas.

Records in this office indicate that you own land along the stream in this vicinity and you are being notified of receipt of this application in order that you may be fully informed of the proposed location of the applicant's point of diversion and proposed use of water. Consideration will be given to comments or other information which you desire to submit to this office **within 15 days** from the date of this letter.

You can find the application and site map posted by the file number referenced above at:
<http://agriculture.ks.gov/divisions-programs/dwr/water-appropriation/notices>

If you have any questions or comments, you may also contact me at (785) 296-3495. If you call, please reference the file number so I can help you more efficiently.

Sincerely,

Douglas W. Schemm
Environmental Scientist
Topeka Field Office

pc: Marysville County Club Inc.

STATE OF KANSAS

DEPARTMENT OF AGRICULTURE
DIVISION OF WATER RESOURCES
TOPEKA FIELD OFFICE
6531 SE FORBES AVE., SUITE B
TOPEKA, KS 66619



PHONE: (785) 296-5733
FAX: (785) 296-8298
www.agriculture.ks.gov

GOVERNOR JEFF COLYER, M.D.
JACKIE McCLASKEY, SECRETARY OF AGRICULTURE

September 26, 2018

GRAUER TRUST
PATRICIA S GRAUER TRUSTEE
1029 KEYSTONE ROAD
MARYSVILLE KS 66508

Re: Pending New Application, File No. 50,128

Dear Sir or Madam:

This is to advise you that Marysville Country Club Inc. has filed the new application referred to above for a permit to appropriate 114.5 acre-feet of surface water per calendar year to be stored in an existing reservoir and re-divert 64.5 acre-feet of the stored water for irrigation use. Please note that this is **an existing reservoir** currently authorized under Water Right, File Nos. 40,665 (REC) and 41,136 (IRR). The point of diversion (where the dam crosses the centerline of the stream) is located near the center of the South side of Section 27, Township 2 South, Range 7 East, Marshall County, Kansas.

Records in this office indicate that you own land along the stream in this vicinity and you are being notified of receipt of this application in order that you may be fully informed of the proposed location of the applicant's point of diversion and proposed use of water. Consideration will be given to comments or other information which you desire to submit to this office **within 15 days** from the date of this letter.

You can find the application and site map posted by the file number referenced above at:
<http://agriculture.ks.gov/divisions-programs/dwr/water-appropriation/notices>

If you have any questions or comments, you may also contact me at (785) 296-3495. If you call, please reference the file number so I can help you more efficiently.

Sincerely,

Douglas W. Schemm
Environmental Scientist
Topeka Field Office

pc: Marysville County Club Inc.

<p>Quick Ref ID = 2037 Tax Year = 2018 LANDOLL CORPORATION Owner Mailing Address: P O BOX 111 MARYSVILLE, KS 66508</p>	<p>ACRES=11.4 Neighborhood=512</p>	<p>BEG 470'S OF NEC SW4 NW4 TH S430' W370' S370' W490' N570' E221.75' N200' E638.25' TO POB</p>		
<p>058-078-27-0-00-00-008.00-0 Quick Ref ID = 2040 Tax Year = 2018 LANDOLL RENTALS, LLC Owner Mailing Address: PO BOX 111 MARYSVILLE, KS 66508</p>	<p>1906 NORTH, Marysville, KS 66508 ACRES=3.1 Neighborhood=512</p>	<p>S27, T02, R07, ACRES 3.1, BEG 30'W & 20'N OF SE COR SW4 NW4 TH W370' N370' E370' S370' TO POB</p>	<p>\$145,330</p>	<p>Commercial & Industrial</p>
<p>058-078-27-0-00-00-010.00-0 Quick Ref ID = 2041 Tax Year = 2018 WIEGERS, MARY J Owner Mailing Address: 1110 BROADWAY MARYSVILLE, KS 66508</p>	<p>2602 NORTH, Marysville, KS 66508 ACRES=35.3 Neighborhood=566</p>	<p>S27, T02, R07, ACRES 35.3, E592' OF W2 NE4 & BEG 670.4'E & 35'N OF SW COR NE4 TH N484.5' E53.5' S484.55' W53.5' TO POB & LESS R/W</p>	<p>\$4,930 A \$167,070 F</p>	<p>Farm Homesite</p>
<p>058-078-27-0-00-00-012.00-0 Quick Ref ID = 2043 Tax Year = 2018 BRUNA, DON & LYNDA Owner Mailing Address: 1084 JUNIPER RD MARYSVILLE, KS 66508</p>	<p>1084 JUNIPER RD, Marysville, KS 66508 ACRES=48.1 Neighborhood=566</p>	<p>S27, T02, R07, ACRES 48.1, BEG 35'S & 530'E NW COR N2 SE4 TH E1450' S702' E630' S220' W249' S165' W592' S35' E352' S165' E1592' N1315' TO POB LESS R/W & ESMT</p>	<p>\$8,360 A \$240,000 F</p>	<p>Farm Homesite</p>
<p>058-078-27-0-00-00-013.00-0 Quick Ref ID = 2046 Tax Year = 2018 CHURCH, ROMAN CATHOLIC ARCHDIOCESE OF K C IN KS Owner Mailing Address: 12615 PARALLEL PARKWAY KANSAS CITY, KS 66109</p>	<p>00000 NORTH, Marysville, KS 66508 ACRES=10.4 Neighborhood=561</p>	<p>S27, T02, R07, ACRES 10.4, BEG 30'W & 35'S OF NE COR SE4 TH S702' W630' N702' E630' TO POB</p>	<p>\$31,760</p>	<p>Exempt</p>
<p>058-078-27-0-30-01-001.00-0 Quick Ref ID = 2052</p>	<p>2103 NORTH, Marysville, KS 66508 ACRES=1.5 Neighborhood=504</p>	<p>OUTLOTS, S27, T02, R07, ACRES 1.5, BEG 679'W NE COR</p>	<p>\$84,060</p>	<p>Residential</p>

<p>JILL Owner Mailing Address: 1051 KEYSTONE RD MARYSVILLE, KS 66508</p>		<p>NE215' W325.79' N548.54' TO POB</p>		
<p>058-078-34-0-00-00-018.00-0 Quick Ref ID = 3745 Tax Year = 2018 GRAUER TRUST Owner Mailing Address: Attn: PATRICIA S. GRAUER, TRUSTEE 1029 KEYSTONE RD MARYSVILLE, KS 66508</p>	<p>1029 KEYSTONE RD, Marysville, KS 66508 ACRES=18.2 Neighborhood=561</p>	<p>S34, T02, R07, ACRES 18.2, BEG 1177.5'S & 1217.5'E NW COR NW4 TH W304.75' S1178.68' E584.23' NE935.75' NW734.25' SW383.54' W260' N500' LESS R/W</p>	<p>\$10,290 A \$92,180 F</p>	<p>Farm Homesite</p>
<p>058-078-34-0-00-00-018.01-0 Quick Ref ID = 3746 Tax Year = 2018 McCOY FAMILY TRUST Owner Mailing Address: 1027 KEYSTONE RD MARYSVILLE, KS 66508</p>	<p>1027 KEYSTONE RD, Marysville, KS 66508 ACRES=2.7 Neighborhood=561</p>	<p>S34, T02, R07, ACRES 2.7, BEG 1177.5'S & 1292.5'E OF NWCOR NW4 TH W75' S500' E260' N383.54' NW262' TO POB LESS R/W</p>	<p>\$151,280</p>	<p>Residential</p>
<p>058-078-34-0-20-03-001.01-0 Quick Ref ID = 3761 Tax Year = 2018 MARYSVILLE, CITY OF Owner Mailing Address: 209 N 8TH ST MARYSVILLE, KS 66508</p>	<p>00000 Landlocked, , KS ACRES=0.06 Neighborhood=543</p>	<p>S34 , T02 , R07 , BEG 455.06'E & 100'S INTER W LINE NW4 & S R/W CO RD TH E100 S25' W100' N25' TO POB</p>	<p>\$70</p>	<p>Exempt</p>
<p>058-078-34-0-20-03-006.00-0 Quick Ref ID = 3766 Tax Year = 2018 HOOYER, DANIEL & JANET Owner Mailing Address: 405 S 7TH ST MARYSVILLE, KS 66508</p>	<p>611 S 17TH ST, Marysville, KS 66508 ACRES=5.3 Neighborhood=512</p>	<p>INDUSTRIAL PARK #1, S34, T02, R07, Lot 5 - 7, ACRES 5.3</p>	<p>\$116,970</p>	<p>Commercial & Industrial</p>
<p>Back to Search Page --- Home</p>				

50,128

Print Page

[Back to Search Page](#) --- [Home](#)

Parcel Search Results (Click on the Parcel ID Number for Detailed Results)

Owner Information	Property Address	Property Description	Apr Amount	Prop Class
<p>058-078-27-0-00-00-001.00-0 Quick Ref ID = 2020 Tax Year = 2018 BGMM, Inc</p> <p>Owner Mailing Address: 1819 MEADOWLARK RD CLAY CENTER, KS 66432</p>	<p>00000 11TH RD, Marysville, KS 66508</p> <p>ACRES=72.4 Neighborhood=561</p>	<p>S27, T02, R07, ACRES 72.4, E2 NE4 LESS BEG 53.31'N SW COR TH N375' E400' S375' W400' TO POB & LESS R/W</p>	\$31,400	Agricultural Use
<p>058-078-27-0-00-00-003.00-0 Quick Ref ID = 2023 Tax Year = 2018 MARYSVILLE, CITY OF</p> <p>Owner Mailing Address: 209 N 8TH ST MARYSVILLE, KS 66508</p>	<p>2500 NORTH, Marysville, KS 66508</p> <p>ACRES=116.5 Neighborhood=561</p>	<p>S27, T02, R07, ACRES 116.5, E2 NW4 & W2 NE4 LESS E592' OF W2 NE4 & LESS BEG 592'W & 35'N OF SE COR W2 NE4 TH W53.5' N484' E53.5' S484' TO POB & less R/W</p>	\$385,780	Exempt
<p>058-078-27-0-00-00-003.02-1 Quick Ref ID = 2025 Tax Year = 2018 DILLEY, ROLAND JR</p> <p>Owner Mailing Address: 859 FAIRVIEW DR HENDERSON, NV 89015</p>	<p>00000 AIRPORT RD, MARYSVILLE, KS 66508</p> <p>ACRES=0 Neighborhood=543</p>	<p>S27, T02, R07, IMPROVEMENTS ONLY ON LEASED LA ND</p>	\$700	Residential
<p>058-078-27-0-00-00-003.04-1 Quick Ref ID = 2026 Tax Year = 2018 LANDOLL, DONALD R</p> <p>Owner Mailing Address: P O BOX 111 MARYSVILLE, KS 66508</p>	<p>00000 AIRPORT RD, MARYSVILLE, KS 66508</p> <p>ACRES=0 Neighborhood=543</p>	<p>S27, T02, R07, IMPROVEMENTS ONLY ON LEASED LA ND</p>	\$1,450	Commercial & Industrial
<p>058-078-27-0-00-00-003.05-1 Quick Ref ID = 2027 Tax Year = 2018 HOWLAND, GARY M</p> <p>Owner Mailing</p>	<p>00000 AIRPORT RD, MARYSVILLE, KS 66508</p> <p>ACRES=0 Neighborhood=543</p>	<p>S27, T02, R07, IMPROVEMENTS ONLY ON LEASED LA ND</p>	\$3,260	Residential

STATE OF KANSAS

DEPARTMENT OF AGRICULTURE
1320 RESEARCH PARK DRIVE
MANHATTAN, KS 66502
PHONE: (785) 564-6700
FAX: (785) 564-6777



900 SW JACKSON, ROOM 456
TOPEKA, KS 66612
PHONE: (785) 296-3556
www.agriculture.ks.gov

GOVERNOR JEFF COLYER, M.D.
JACKIE McCLASKEY, SECRETARY OF AGRICULTURE

9/13/2018

MARYSVILLE COUNTRY CLUB, INC
PO BOX 45
MARYSVILLE, KS 66508

RE: Application, File No. **50128**

Dear Sir or Madam:

The Division of Water Resources (Division) has received your application for a permit to appropriate water for beneficial use. Your application has been assigned the file number referenced above. Please be aware that the Division may have a large number of pending applications on hand at times and makes every attempt to process them in the order in which they are received. You will be contacted if additional information is required.

Please note, this letter only acknowledges receipt of your application and does not guarantee approval. In accordance with the provisions of the Kansas Water Appropriation Act, the use of water as proposed prior to approval of the application is unlawful.

Additional information about the process may be found on our website at agriculture.ks.gov/divisions-programs/dwr. If you have any other questions, please contact our office at 785-564-6640 or your local Topeka Field Office at 785-296-5733. If you call, please reference the file number so we can help you more efficiently.

Sincerely,

A handwritten signature in cursive script that reads "Kristen A. Baum".

Kristen A. Baum
New Application Unit Supervisor
Division of Water Resources

SCANNED

50128

Attachment "A"

Justification of proposed quantities:

Direct Use:

43 acres of golf course grounds

1.5 AF/acre of water needed to support turf grasses (specialty crop)

$$43 \text{ AF} \times 1.5 \text{ AF/ac.} = 64.5 \text{ AF}$$

Storage:

Evaporation - covered under File No. 40,665 (REC)

One year of direct use – 64.5 AF

Estimated capacity of lake – 50 AF

$$64.5 \text{ AF} + 50 \text{ AF} = 114.5 \text{ AF}$$

This application proposes to divert water from the lake when conditions allow without significantly decreasing the water level in the lake. The applicant will utilize their groundwater source of water when this is not possible.

Water Resources
Received

SEP 10 2018

KS Dept Of Agriculture
SCANNED

Submit To:

CHIEF ENGINEER
Division of Water Resources
Kansas Department of Agriculture
1320 Research Park Drive
Manhattan, Kansas 66502
http://agriculture.ks.gov/dwr

APPLICATION FOR
TEMPORARY PERMIT

- GROUNDWATER
 SURFACE WATER
(check one)

Water Resources

Received

OCT 26 2018

10:31

KS Dept Of Agriculture



State of Kansas

STATUTORY FILING FEE OF \$200.00 MUST ACCOMPANY THIS APPLICATION

(Make check payable to the Kansas Department of Agriculture)

20180269

1. Applicant: (Please print or type)

Name Nelson Farms Inc

Mailing Address Box 38

City and State Long Island, KS

Zip Code 67647 Telephone No. (785) 854-7611

E-mail Address terry@valleyfeeds.com

0500
TV

2. Location of Point of Diversion:

Prairie Dog

Sec. 10, Twp. 2, Rng. 21, West,

Norton County, Kansas.

Distance from Southeast Corner of Section:

77 feet North from Southeast Corner (FSL)

546 feet West from Southeast Corner (FEL)

Existing well? Yes No

Existing permit or water right? Yes No

If yes, File No. 49423

3. Water Use Data:

Proposed Max. Pumping Rate (gpm) 90 gpm

Amount Requested (gallons) 1303000
(not to exceed four million gallons unless for dewatering)

Depth of Well (feet) _____, OR

Name of Stream _____

4. Water is to be used for (briefly describe proposed use):

Industrial use at a truckwashing facility

Please note that K.A.R. 5-9-4 limits temporary permits to one (1) project per application.

5. Location of Place of Use:

Sec. 10, Twp. 2, Rng. 21, West,

Project name and description:

Nelson Farms Inc Truck Wash (SE NE) & (NE SE)

[PD & PU overlap w/ #49,423]

6. Period of Use (6 months maximum):

Commencing Date: August 15, 2018

Ending Date: December 31, 2019

7. Location of the proposed point of diversion shall be indicated on the diagram below. Use the center section.

If surface water, indicate on the diagram the course of the stream, and its name.

The scale of the diagram is 2 inches = 1 mile
Each small square represents 10 acres

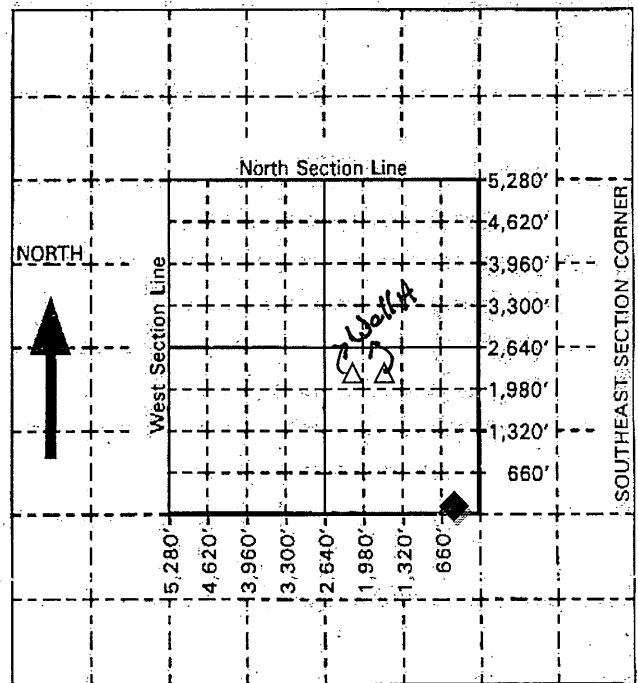

* small Q needed to finish out the year. Nearby IRR well has Q that can then be moved to this PD w/change. KAB/DWR 10-26-18

For Office Use Only:

F.O. S GMD Meets K.A.R. 5-9-1 (YES) NO Use Ind Source G/S County NT By BM Date 10-26-18
Code TMP Fee \$ 200.00 TR # 2000 Receipt Date 10/26/18 Check # 02434

8. For groundwater use, list below all wells within 1/2 mile of the proposed well, and plot locations upon the diagram on reverse side. If additional space is needed, attach sheet.

Other wells -

Well A Owner(s): WR# 18321 / 26193-D1: NTN LP
Address: PO Box 560 Norton, KS 67654-0560

Well B Owner(s):
Address:

9. For surface water use, list below the names and addresses of all landowners from a point 1/2 mile upstream to a point 1/2 mile downstream of the tract of land upon which the point of diversion is located. If additional space is needed, attach sheet.

Tract A Owner(s):
Address:

Tract B Owner(s):
Address:

10. The landowner at the location of the point of diversion and water source is (please print):
NTN LP, PO Box 560 Norton, KS 67654-0560 (785) 854-7611
(name, address and telephone number)

You must provide evidence of legal access to, or control of, the point of diversion from the landowner or the landowner's authorized representative. Provide a copy of a recorded deed, lease, easement or other document with this application. In lieu thereof, you may sign the following sworn statement:

I have legal access to, or control of, the point of diversion described in this application from the landowner or the landowner's authorized representative. I declare under penalty of perjury that the foregoing is true and correct.

Executed on Oct 17, 2016 x [Signature]

Signature of Applicant

11. The applicant states that the information set forth herein is true and accurate to the best of his/her knowledge.

x [Signature] Signature of Applicant or [Signature] Authorized Representative [Signature] Date

[Signature] Applicant's Name Printed [Signature] Title

DO NOT WRITE BELOW THIS LINE

CONDITIONS OF APPROVAL:

The applicant shall maintain records from which the quantity of water actually diverted may be readily determined.

The use of water herein authorized shall not be made so as to impair any use under existing water rights or prejudicially and unreasonably affect the public interest.

K.S.A. 82a-728 states in part "(a) except for the appropriation of water for the purpose of domestic use, . . . it shall be unlawful for any person to appropriate or threaten to appropriate water from any source without first applying for and obtaining a permit to appropriate water . . ."

Water wells must be properly constructed by the well driller to comply with Article 30 of the Rules and Regulations as adopted by the Kansas Department of Health and Environment.

All applications filed after April 12, 1984, are subject to minimum desirable streamflow (MDS) requirements identified and established by the Kansas Legislature pursuant to K.S.A. 82a-703c. There may be times, as determined by the Division of Water Resources, when you would be required to cease diversion of water in order to satisfy MDS requirements.

[Handwritten notes and signatures at the bottom of the page]

New Application - Marysville Country Club Inc



All landowners adjacent to the stream within 1/2 mile upstream or downstream of the property lines are shown on this map.

Signature _____

Date _____



Proposed Place of Use
(43 acre golf course complex)



Map prepared by LHH/TFO 8.24.18

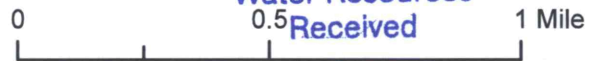

SEP 10 2018

New Application - Marysville Country Club Inc

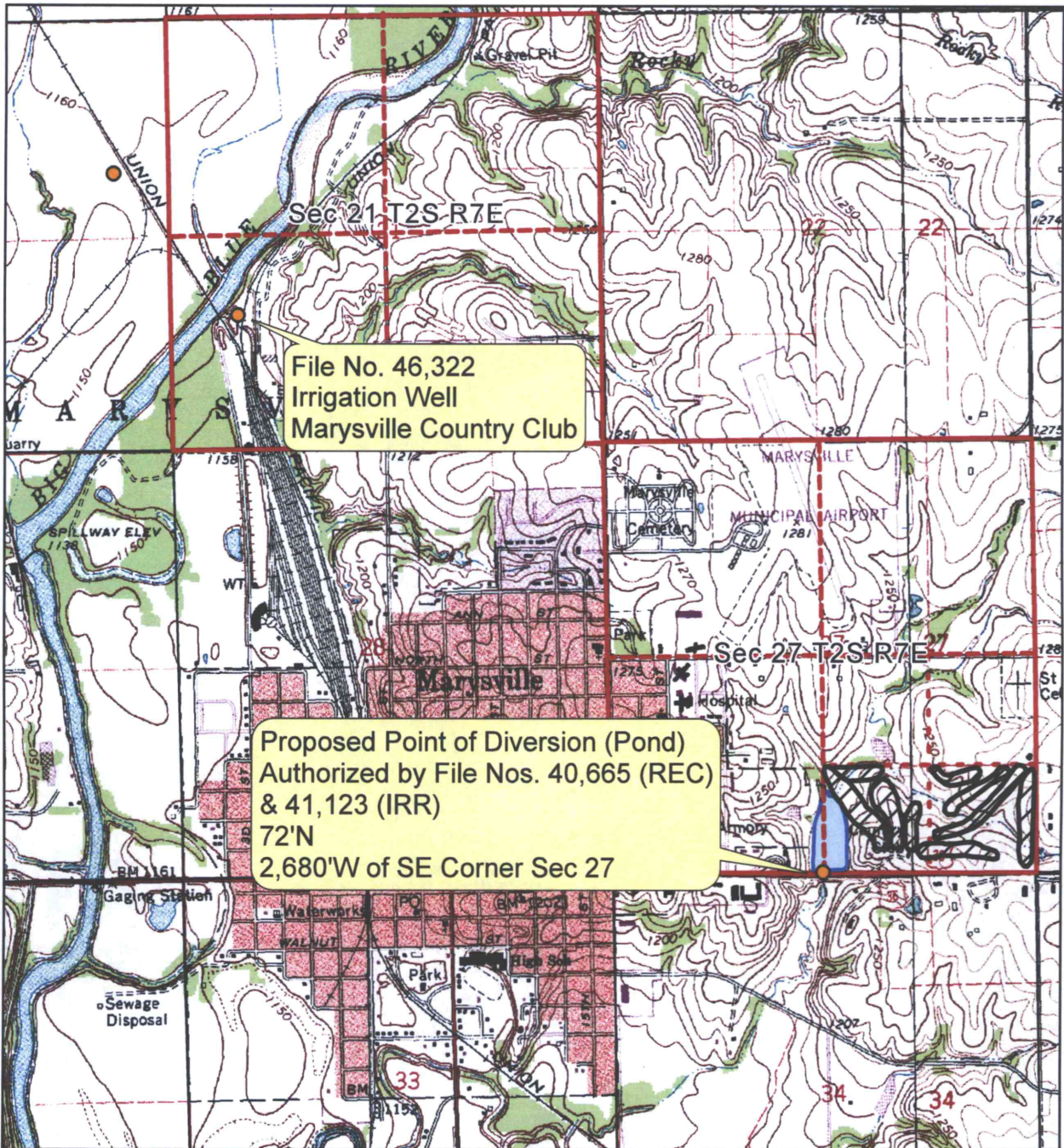

All landowners adjacent to the stream within 1/2 mile upstream or downstream of the property lines are shown on this map.

Joe Wagner *GLS*
Signature

9/6/18
Date



Proposed Place of Use
(43 acre golf course complex)



Water Resources
Received



Map prepared by LHH/TFO 8.24.18

SEP 10 2018