

Kansas Department of Agriculture
Division of Water Resources
PERMIT OF NEW APPLICATION WORKSHEET

1. File Number: <p style="text-align: center;">50,192</p>	2. Status Change Date: <p style="text-align: center;"><i>5/30/2019</i></p>	3. Field Office: <p style="text-align: center;">01</p>	4. GMD: <p style="text-align: center;">0</p>
---	---	--	--

5. Status: Approved Denied by DWR/GMD Dismiss by Request/Failure to Return

6. Enclosures: Check Valve N of C Form Water Tube Driller Copy Meter

<p>7a. Applicant(s) New to system <input type="checkbox"/></p> <p style="text-align: right;">Person ID 13689 Add Seq# _____</p> <p style="text-align: center;">PESSEMIER COMPANY CHRISTIAN A ROYER PO BOX 206 SAINT MARYS KS 66536</p>	<p>7c. Landowner(s) New to system <input type="checkbox"/></p> <p style="text-align: right;">Person ID 31938 Add Seq# _____</p> <p style="text-align: center;">CHRISTIAN A ROYER PO BOX 206 SAINT MARYS KS 66536</p>
<p>7b. Landowner(s) New to system <input type="checkbox"/></p> <p style="text-align: right;">Person ID _____ Add Seq# _____</p> <p>7a.</p>	<p>7d. Misc. New to system <input type="checkbox"/></p> <p style="text-align: right;">Person ID _____ Add Seq# _____</p>

<p>8. WUR Correspondent New to system <input type="checkbox"/></p> <p style="text-align: right;">Person ID _____ Add Seq# _____</p> <p>Overlap File (s) WUC Agree <input type="checkbox"/> Yes <input type="checkbox"/> No</p> <p style="text-align: right;">Notarized WUC Form <input type="checkbox"/></p> <p>7a.</p>	<p>9. Use of Water: Changing? <input type="checkbox"/> Yes <input checked="" type="checkbox"/> No</p> <p style="padding-left: 40px;"><input checked="" type="checkbox"/> Groundwater <input type="checkbox"/> Surface Water</p> <p><input checked="" type="checkbox"/> IRR <input type="checkbox"/> REC <input type="checkbox"/> DEW <input type="checkbox"/> MUN</p> <p><input type="checkbox"/> STK <input type="checkbox"/> SED <input type="checkbox"/> DOM <input type="checkbox"/> CON</p> <p><input type="checkbox"/> HYD DRG <input type="checkbox"/> WTR PWR <input type="checkbox"/> ART RECHRG</p> <p><input type="checkbox"/> IND SIC: _____ <input type="checkbox"/> OTHER: _____</p>
--	---

10. Completion Date: **12/31/2020** 11. Perfection Date: **12/31/2024** 12. Exp Date: _____

13. Conservation Plan Required? Yes No Date Required: _____ Date Approved: _____ Date to Comply: _____

14. Water Level Measuring Device? Yes No Date to Comply: _____ Date WLMD Installed: _____

Date Prepared: **4/4/2019** By: **DWS**
Date Entered: *6/4/2019* By: *WJ*

File No. 50,192	15. Formation Code: 113	Drainage Basin: Kansas River	County: WB	Special Use:	Stream:																																																																																										
<table border="1" style="width:100%; border-collapse: collapse;"> <tr> <td colspan="10" style="width:55%;">16. Points of Diversion</td> <td colspan="5" style="width:45%;">17. Rate and Quantity MOD ADDL RATE AND QTY</td> </tr> <tr> <td colspan="10"></td> <td colspan="2" style="text-align:center;">Authorized</td> <td colspan="3" style="text-align:center;">Additional</td> </tr> <tr> <td style="font-size:small;">T MOD DEL ENT</td> <td style="font-size:small;">PDIV</td> <td style="font-size:small;">Qualifier</td> <td style="font-size:small;">S</td> <td style="font-size:small;">T</td> <td style="font-size:small;">R</td> <td style="font-size:small;">ID</td> <td style="font-size:small;">'N</td> <td style="font-size:small;">'W</td> <td style="font-size:small;">(Batt 1 of 2)</td> <td style="font-size:small;">Rate gpm</td> <td style="font-size:small;">Quantity af</td> <td style="font-size:small;">Rate gpm</td> <td style="font-size:small;">Quantity af</td> <td style="font-size:small;">Overlap PD Files</td> </tr> <tr> <td>MOD</td> <td>12697</td> <td>LOT 5</td> <td>8</td> <td>10</td> <td>12E</td> <td>4</td> <td>2962</td> <td>4492</td> <td>(Batt 1 of 2)</td> <td>800</td> <td>200</td> <td>115</td> <td>49.5</td> <td>39,253 & 43,699*</td> </tr> <tr> <td>√</td> <td>87232</td> <td>LOT 5</td> <td>8</td> <td>10</td> <td>12E</td> <td>10</td> <td>3257</td> <td>4492</td> <td>(Batt 1 of 2)</td> <td></td> <td></td> <td></td> <td></td> <td></td> </tr> <tr> <td>√</td> <td>87233</td> <td>LOT 5</td> <td>8</td> <td>10</td> <td>12E</td> <td>11</td> <td>3110</td> <td>4492</td> <td>(Geo-Ctr)</td> <td></td> <td></td> <td></td> <td></td> <td></td> </tr> </table>						16. Points of Diversion										17. Rate and Quantity MOD ADDL RATE AND QTY															Authorized		Additional			T MOD DEL ENT	PDIV	Qualifier	S	T	R	ID	'N	'W	(Batt 1 of 2)	Rate gpm	Quantity af	Rate gpm	Quantity af	Overlap PD Files	MOD	12697	LOT 5	8	10	12E	4	2962	4492	(Batt 1 of 2)	800	200	115	49.5	39,253 & 43,699*	√	87232	LOT 5	8	10	12E	10	3257	4492	(Batt 1 of 2)						√	87233	LOT 5	8	10	12E	11	3110	4492	(Geo-Ctr)					
16. Points of Diversion										17. Rate and Quantity MOD ADDL RATE AND QTY																																																																																					
										Authorized		Additional																																																																																			
T MOD DEL ENT	PDIV	Qualifier	S	T	R	ID	'N	'W	(Batt 1 of 2)	Rate gpm	Quantity af	Rate gpm	Quantity af	Overlap PD Files																																																																																	
MOD	12697	LOT 5	8	10	12E	4	2962	4492	(Batt 1 of 2)	800	200	115	49.5	39,253 & 43,699*																																																																																	
√	87232	LOT 5	8	10	12E	10	3257	4492	(Batt 1 of 2)																																																																																						
√	87233	LOT 5	8	10	12E	11	3110	4492	(Geo-Ctr)																																																																																						
18. Storage: Rate _____ NF Quantity _____ ac/ft Additional Rate _____ NF Additional Quantity _____ ac/ft																																																																																															
19. Limitation: 200 af/yr at 800 gpm (_____ cfs) when combined with file number(s) 39,253 & 43,699																																																																																															
Limitation: 368.5 af/yr at _____ gpm (_____ cfs) when combined with file number(s) 36,961; 36,962; 39,253; 43,699; 43,700; & 43,701																																																																																															
20. Meter Required? <input checked="" type="checkbox"/> Yes <input type="checkbox"/> No To be installed by 12/31/2020 Date Acceptable Meter Installed _____																																																																																															
21. Place of Use																																																																																															
T MOD DEL ENT	PUSE	S	T	R	ID	NE¼				NW¼				SW¼				SE¼				Total	Owner	Chg? NO	Overlap Files																																																																						
NE ¼	NW ¼	SW ¼	SE ¼	NE ¼	NW ¼	SW ¼	SE ¼	NE ¼	NW ¼	SW ¼	SE ¼	NE ¼	NW ¼	SW ¼	SE ¼	NE ¼	NW ¼	SW ¼	SE ¼																																																																												
√	2321	7	10	12E	2	4		1	36.95							40	3		25	109.95	7a.	NO	see below																																																																								
√	32787	8	10	12E	4					4	6.5	40	27.33	39	40	40	25		3.22		225.05	7c.	NO	see below																																																																							
Comments: *CHANGE IN POINT OF DIVERSION ON SENIOR FILES TO CREATE COMPLETE OVERLAP (Battery of 2 wells). FILE NOS. 36,961; 36,962; 39,253; 43,699; 43,700; 43,701 and 50,192 ALL OVERLAP IN PLACE OF USE. FOR SECTION 7: SEE JKT FOR LOTS & COUNTIES FOR SECTION 8: 38.25 AC L-5 (SW NW), 53.33 AC L-6 (SE NW) & (NE SW), L-7 (NW SE)																																																																																															

KANSAS DEPARTMENT OF AGRICULTURE
Division of Water Resources
MEMORANDUM

TO: Files

DATE: April 4, 2019

FROM: Doug Schemm

RE: Application, File No. 50,192

Pessemier Company (Christian Royer) has filed the referenced new application to appropriate 200 acre-feet of groundwater from a proposed battery of two wells at a rate of 800 gallons per minute for irrigation use on 335 acres. The well battery will be located in Lot 5, of Section 8, Township 10 South, Range 12 East, Wabaunsee County, within the Kansas River Drainage Basin. Note that Water Right, File Nos. 39,253 and 43,699 currently authorize one of the wells in this proposed battery, and a change in point of diversion on these files will create a complete overlap with this new application. These files will all overlap in place of use, in addition to File Nos. 36,961; 36,962; 43,700; and 43,701. A portion of the place of use is owned by Pessemier Company, and a portion is owned by Christian Royer. The application form has been signed stating that the applicant has access to the point of diversion.

Water Right, File No. 36,961 is authorized 111 acre-feet; Water Right, File No. 36,962 is authorized 183 acre-feet (Limited to 290 acre-feet with senior file); Water Right, File No. 39,253 is authorized 114 acre-feet at 600 gpm (Limited to 290 acre-feet with senior files); Water Right, File No. 43,699 is authorized 28 acre-feet; Water Right, File No. 43,700 is authorized 3 acre-feet; and Water Right, File No. 43,701 is authorized 17 acre-feet (Limited to 319 acre-feet with all senior files).

The maximum allowable quantity of water to irrigate the proposed acreage of 335 acres, with 1.1 acre-feet per acre in Wabaunsee County would be 368.5 acre-feet. Therefore, this new application will be limited to 368.5 acre-feet when combined with all senior files, File Nos. 36,961; 36,962; 39,253; 43,699; 43,700; and 43,701, on the place of use. In addition, the new application will be limited to 800 gallons per minute and 200 acre-feet when combined with senior files, File Nos. 39,253 and 43,699. The new application will provide for 49.5 additional acre-feet with all senior files (368.5 AF – 319 AF), and 115 gallons per minute additional rate from this well battery (800 gpm – 685 gpm).

The applicant identified three wells within one-half mile (complying with K.A.R. 5-3-4), two of which are owned by the applicant. A nearby notification letter was sent out on February 20, 2019 to the other well owner, including notification of the proposed change applications. No response of any kind was received. The proposed point of diversion (battery geo-center) is located 1,022 feet from one of the applicant's existing irrigation wells, which is less than the minimum well spacing of 1,320 feet. However, this distance is greater than the current spacing between the applicant's wells, which is just over 800 feet. Adding the additional well to the north of the existing well shifts the point of diversion (geo-center) to the north as well, increasing the spacing between points of diversion.

K.A.R. 5-4-4 provides that the spacing guidelines are not applicable if the required minimum well spacing criteria are not necessary to prevent direct impairment. There are several unique circumstances that should be considered in this specific instance regarding minimum well spacing.

- These wells for irrigation use are operated as a system supplying water to the same acreage, and are not likely to be separated or divided in any way in the future.
- These wells have operated for many years with no known impairment issues, even though they don't meet minimum well spacing to each other. The proposed well battery will actually increase the distance between existing points of diversion.
- The new application will be limited to 800 gallons per minute, which is only 115 gallons per minute greater than the senior files are authorized. This minor increase in rate will not create any significant additional drawdown in the aquifer.
- The wells are producing from the Kansas River alluvium, which is known as a very prolific aquifer. Well logs show significant gravel content, saturated thicknesses of over 30 feet, and test pumping indicates high transmissivity values.

Therefore, per K.A.R. 5-4-4, the required minimum well spacing criteria is not necessary to prevent direct impairment in this specific instance, and the proposed well spacing is sufficient to prevent direct impairment and to protect the public interest. The well battery complies with minimum well spacing criteria to all other wells. The proposed well battery is located over ¼ mile from the Kansas River, so no notification of the KRWAD is required.

The well logs from the senior files show sand and gravel extending from 13 feet to 46 feet below ground surface where shale bedrock was encountered. Static water level is 16 feet below ground surface, providing over 30 feet of saturated thickness. The source of water is the Kansas River alluvium. K.A.R. 5-3-11 states that calculated recharge in the Kansas River alluvium shall be determined by taking 25% of the average annual rainfall in the area of consideration. For this application, the calculated recharge was determined to be 8.5 inches. The extent of the alluvium (per LIDAR data) for the area of consideration provides a total of 6,856 acres. Based on a potential recharge of 8.5 inches, with 75% available for appropriation, safe yield was determined to be 3,642 acre-feet. Existing water rights have appropriated 3,265.81 acre-feet within the area of consideration, leaving 376.19 acre-feet available, and the application complies with safe yield.

The applicant has submitted a signed Kansas River Assurance District form, which has been properly notarized. By completing this statement, the applicant affirms his/her knowledge that there could be times when the diversion of water may not be allowed under this permit. In accordance with K.S.A. 82a-706c, the Chief Engineer retains full authority to require any water user to install meters, gages, or other measuring devices, which devices he or she or his or her agents may read at any time. Water flowmeter requirements are further described in K.A.R. 5-1-4 through K.A.R. 5-1-12. If any chemical or foreign substance is injected into the water pumped under this permit, a check valve will also need to be installed.

In an April 3, 2019 discussion, Katie Tietsort, Water Commissioner, Topeka Field Office, recommended approval of the referenced new application. Based on the above discussion, well spacing and safe yield criteria are met, and approval of the application will not impair senior water rights nor prejudicially or unreasonably affect the public interest, it is recommended that the referenced new application be approved, in conjunction with the changes in point of diversion for File Nos. 39,253 and 43,699.

Douglas W. Schemm
Environmental Scientist
Topeka Field Office

1320 Research Park Drive
Manhattan, KS 66502
785-564-6700
www. agriculture.ks.gov



900 SW Jackson, Room 456
Topeka, KS 66612
785-296-3556

Mike Beam, Secretary

Laura Kelly, Governor

June 7, 2019

FILE COPY

PESSEMIER COMPANY
% CHRISTIAN A ROYER
PO BOX 206
SAINT MARYS KS 66536

RE: Appropriation of Water, File No. 50,192

Dear Mr. Royer:

Enclosed is a permit authorizing you to proceed with construction of the proposed diversion works and to appropriate water for beneficial use as set forth in the permit. Your attention is directed to the enclosures and to the terms, conditions, limitations, and requirements specified in this permit.

Notice must be filed on the enclosed form once the diversion works have been completed. Failure to complete the diversion works within the time allowed, or within any authorized extension of time thereof, will result in dismissal of this permit. If you need an extension of time, you must request it before the deadline for completion set forth in the permit. Any request for an extension of time must be accompanied by the statutorily required fee, which is currently \$100.00.

An acceptable water flowmeter must be installed on the diversion works authorized by this permit prior to using water. An annual water use report must be filed with the Chief Engineer by March 1, following the end of each calendar year. If a complete annual water use report is not received by the deadline, then a fine may be assessed and all water use under such permit or right may be suspended. Reports submitted in paper form will be assessed a \$20 per file number paper filing fee. In order to avoid this filing fee, you may submit your report online at www.kswaterusereport.org.

The approval of your application constitutes a permit to appropriate water. It does not give authority to construct any dam or other stream obstruction regulated by K.S.A. 82a-301 through 305a. It does not give authority to access any right-of-way or authorize trespassing upon or injury to public or private property. It may also be necessary for you to comply with other local, state or federal requirements.

Enclosed is an informational sheet that sets forth the procedure to obtain a Certificate of Appropriation which will establish the extent of your perfected water right. Additional information and applicable forms may be found on our website at agriculture.ks.gov/divisions-programs/dwr. If you have any questions or need assistance with any of these requirements, please contact our office at 785-564-6640 or your local Topeka Field Office. If you call, please reference the file number so we can help you more efficiently.

Sincerely,

Kristen A. Baum
New Application Unit Supervisor
Division of Water Resources

KAB:dws
Enclosure(s)

pc: Topeka Field Office

THE STATE OF KANSAS



KANSAS DEPARTMENT OF AGRICULTURE
Mike Beam, Secretary of Agriculture

DIVISION OF WATER RESOURCES
David W. Barfield, Chief Engineer

APPROVAL OF APPLICATION and PERMIT TO PROCEED

(This Is Not a Certificate of Appropriation)

This is to certify that I have examined Application, **File No. 50,192** of the applicant

**PESSEMIER COMPANY
CHRISTIAN A ROYER
PO BOX 206
SAINT MARYS KS 66536**

for a permit to appropriate water for beneficial use, together with the maps, plans and other submitted data, and that the application is hereby approved and the applicant is hereby authorized, subject to vested rights and prior appropriations, to proceed with the construction of the proposed diversion works (except those dams and stream obstructions regulated by K.S.A. 82a-301 through 305a, as amended), and to proceed with all steps necessary for the application of the water to the approved and proposed beneficial use and otherwise perfect the proposed appropriation subject to the following terms, conditions and limitations:

1. That the priority date assigned to such application is **January 3, 2019**.
2. That the water sought to be appropriated shall be used for irrigation use on land, described in the application, as follows:

Sec.	Twp.	Range	NE¼				NW¼				SW¼				SE¼				TOTAL	
			NE¼	NW¼	SW¼	SE¼	NE¼	NW¼	SW¼	SE¼	NE¼	NW¼	SW¼	SE¼	NE¼	NW¼	SW¼	SE¼		
7	10S	12E				Lot 3 21.95										Lot 4 24.48	Lot 6 1.0		Lot 5 20.0	67.43
7	10S	12E				Lot 1 1.0														1.0
7	10S	12E	4.0		1.0	14.0								15.52	2.0				5.0	41.52
8	10S	12E						Lot 5 38.25	Lot 6 14.33	Lot 6 39.0							Lot 7 3.22			94.8
8	10S	12E					4.0	6.5	1.75	13.0		40.0	40.0	25.0						130.25

3. That the authorized source from which the appropriation shall be made is groundwater, to be withdrawn by means of a battery of two (2) wells with a geographic center located in Lot 5 of Section 8, more particularly described as being near a point 3,110 feet North and 4,492 feet West of the Southeast corner of said section, in Township 10 South, Range 12 East, Wabaunsee County, Kansas, located substantially as shown on the topographic map accompanying the application.

4. That the appropriation sought shall be limited to a maximum diversion rate not in excess of **800 gallons per minute (1.78 c.f.s.)** and to a quantity not to exceed **200 acre-feet** of water for any calendar year.

5. That installation of works for diversion of water shall be completed on or before **December 31, 2020** or within any authorized extension thereof. The applicant shall notify the Chief Engineer and pay the statutorily required field inspection fee of \$400.00 when construction of the works has been completed. Failure to timely submit the notice and the fee will result in revocation of the permit. Any request for an extension of time shall be submitted prior to the expiration of the deadline and shall be accompanied by the required statutory fee of \$100.00.

6. That the proposed appropriation shall be perfected by the actual application of water to the proposed beneficial use on or before **December 31, 2024** or any authorized extension thereof. Any request for an extension of time shall be submitted prior to the expiration of the deadline and shall be accompanied by the required statutory fee of \$100.00.

7. That the applicant shall not be deemed to have acquired a water appropriation for a quantity in excess of the amount approved herein nor in excess of the amount found by the Chief Engineer to have been actually used for the approved purpose during one calendar year subsequent to approval of the application and within the time specified for perfection or any authorized extension thereof.

8. That the use of water herein authorized shall not be made so as to impair any use under existing water rights nor prejudicially and unreasonably affect the public interest.

9. That the right of the appropriator shall relate to a specific quantity of water and such right must allow for a reasonable raising or lowering of the static water level and for the reasonable increase or decrease of the streamflow at the appropriator's point of diversion.

10. That this permit does not constitute authority under K.S.A. 82a-301 through 305a to construct any dam or other obstruction; nor does it grant any right-of-way, or authorize entry upon or injury to, public or private property.

11. That all diversion works constructed under the authority of this permit into which any type of chemical or other foreign substance will be injected into the water pumped from the diversion works shall be equipped with an in-line, automatic quick-closing, check valve capable of preventing pollution of the source of the water supply. The type of valve installed shall meet specifications adopted by the Chief Engineer and shall be maintained in an operating condition satisfactory to the Chief Engineer.

12. That all wells with a diversion rate of 100 gallons per minute or more drilled under the authority of this permit shall have a tube or other device installed in a manner acceptable to, and in accordance with specifications adopted by, the Chief Engineer. This tube or device shall be suitable for making water level measurements and shall be maintained in a condition satisfactory to the Chief Engineer.

13. That an acceptable water flow meter shall be installed and maintained on the diversion works authorized by this permit in accordance with the Kansas Administrative Regulations 5-1-4 through 5-1-12 adopted by the Chief Engineer. This water flow meter shall be used to provide an accurate quantity of water diverted as required for the annual water use report (including the meter reading at the beginning and end of the report year).

14. That the applicant shall maintain accurate and complete records from which the quantity of water diverted during each calendar year may be readily determined and the applicant shall file an annual water use report with the Chief Engineer by March 1 following the end of each calendar year. Failure to file the annual water use report by the due date shall cause the applicant to be subject to a civil penalty.

15. That no water user shall engage in nor allow the waste of any water diverted under the authority of this permit.

16. That failure without cause to comply with provisions of the permit and its terms, conditions and limitations will result in the forfeiture of the priority date, revocation of the permit and dismissal of the application.

17. That the right to appropriate water under authority of this permit is subject to any minimum desirable streamflow requirements identified and established pursuant to K.S.A. 82a-703c for the source of supply to which this water right applies.

18. That this permit is limited such that all wells shall be located within a three hundred (300) foot radius circle, in the same local source of supply, and shall supply water to a common distribution system.

19. That the quantity of water and rate of diversion approved under this permit is further limited to the quantity and rate which combined with Water Right, File Nos. 39,253 and 43,699, will provide a **total not to exceed 200 acre-feet** of water per calendar year to be diverted at a maximum diversion rate not in excess of **800 gallons per minute** (1.78 c.f.s.) for irrigation use from the point of diversion described herein.

20. That the quantity of water approved under this permit is further limited to the quantity which combined with Water Right, File Nos. 36,961; 36,962; 39,253; 43,699; 43,700; and 43,701, will provide a **total not to exceed 368.5 acre-feet** of water per calendar year for irrigation use on the land described herein.

21. That the applicant shall submit to the Chief Engineer a copy of the well log required by the Kansas Department of Health and Environment under the authority of K.S.A. 82a-1212, currently form WWC-5, within 30 days following the drilling of the well at the location authorized herein.

RIGHT TO A HEARING AND TO ADMINISTRATIVE REVIEW

If you are aggrieved by this Order, then pursuant to K.S.A. 82a-1901, you may:

- 1) request an evidentiary hearing before the Chief Engineer, or
- 2) request administrative review by the Secretary of Agriculture.

Failure to request an evidentiary hearing before the Chief Engineer does not preclude your right to administrative review by the Secretary. To obtain an evidentiary hearing before the Chief Engineer, a written request for hearing must be filed within 15 days after service of this Order as provided in K.S.A. 77-531 (i.e., **within a total of 18 days after this Order was mailed to you**), with: Kansas Department of Agriculture, Attn: Legal Section, 1320 Research Park Drive, Manhattan, Kansas 66502, FAX (785) 564-6777.

If you do not file a request for an evidentiary hearing before the Chief Engineer, you may petition for administrative review of the Order by the Secretary of Agriculture. A petition for review shall be in writing and state the basis for requesting administrative review. The request for hearing may be denied if the request fails to clearly establish factual or legal issues for review. See K.S.A. 77-527. The petition must be filed within 30 days after service of this Order as provided in K.S.A. 77-531 (i.e., **within a total of 33 days after this Order was mailed to you**), and be filed with: Secretary of Agriculture, Attn: Legal Division, Kansas Department of Agriculture, 1320 Research Park Drive, Manhattan, Kansas 66502, FAX (785) 564-6777.

#1

THE STATE OF KANSAS



KANSAS DEPARTMENT OF AGRICULTURE
Jackie McClaskey, Secretary of Agriculture

DIVISION OF WATER RESOURCES
David W. Barfield, Chief Engineer

File Number 50192
This item to be completed by the Division of Water Resources.

Water Resources
Received

5-23
APPLICATION COMPLETE
4/3/19
Reviewer: FAB

APPLICATION FOR PERMIT TO
APPROPRIATE WATER FOR BENEFICIAL USE

Filing Fee Must Accompany the Application
(Please refer to Fee Schedule attached to this application form.)

JAN 03 2019

11:45

KS Dept Of Agriculture

To the Chief Engineer of the Division of Water Resources, Kansas Department of Agriculture,
1320 Research Park Drive, Manhattan, KS 66502:

1. Name of Applicant (Please Print): PESSEMIER COMPANY CHRISTIAN A ROYER
Address: PO BOX 206
City: ST MARYS State KS Zip Code 66536
Telephone Number: (785) 456-4655

2. The source of water is: surface water in _____ (stream)
OR groundwater in KANSAS RIVER (drainage basin)

Certain streams in Kansas have minimum target flows established by law or may be subject to administration when water is released from storage for use by water assurance district members. If your application is subject to these regulations on the date we receive your application, you will be sent the appropriate form to complete and return to the Division of Water Resources.

3. The maximum quantity of water desired is 200* acre-feet OR _____ gallons per calendar year, to be diverted at a maximum rate of 800 gallons per minute OR _____ cubic feet per second.

Once your application has been assigned a priority, the requested maximum rate of diversion and maximum requested quantity of water under that priority number can **NOT** be increased. Please be certain your requested maximum rate of diversion and maximum quantity of water are appropriate and reasonable for your proposed project and are in agreement with the Division of Water Resources' requirements.

4. The water is intended to be appropriated for (Check use intended):
(a) Artificial Recharge (b) Irrigation (c) Recreational (d) Water Power
(e) Industrial (f) Municipal (g) Stockwatering (h) Sediment Control
(i) Domestic (j) Dewatering (k) Hydraulic Dredging (l) Fire Protection
(m) Thermal Exchange (n) Contamination Remediation

YOU **MUST** COMPLETE AND ATTACH ADDITIONAL DIVISION OF WATER RESOURCES FORM(S) PROVIDING INFORMATION TO SUBSTANTIATE YOUR REQUEST FOR THE AMOUNT OF WATER FOR THE INTENDED USE REFERENCED ABOVE.

For Office Use Only:

F.O. 1 GMD 0 Meets K.A.R. 5-3-1 (YES/NO) Use IRR Source G/S County WB By KJN Date 1/3/19
Code 162 Fee \$ 300.00 TR # _____ Receipt Date 1/3/18 Check # 21449

DWR 1-100 (Revised 02/12/2014) *Quantity Limited to 200 AF when combined with 39253 + 43699

*Quantity Limited to 368.5 AF when combined with 36961; 36962; 39253; 43699; 43700 + 43701

Rate limited to 800 gpm when combined with 39253 + 43699

SCANNED

1/3/19 11M

5. The location of the proposed wells, pump sites or other works for diversion of water is:

Note: For the application to be accepted, the point of diversion location must be described to at least a 10 acre tract, unless you specifically request a 60 day period of time in which to locate the site within a specifically described, minimal legal quarter section of land.

ONE(1) WELL
EXISTING

(A) One in LOT 5 quarter of the _____ quarter of the _____ quarter of Section 8, more particularly described as being near a point 2962 feet North and 4492 feet West of the Southeast corner of said section, in Township 10 South, Range 12 EAST, WABAUNSEE _____ County, Kansas.

ONE(1) WELL
NEW

(B) One in LOT 5 quarter of the _____ quarter of the _____ quarter of Section 8, more particularly described as being near a point 3257 feet North and 4492 feet West of the Southeast corner of said section, in Township 10 South, Range 12 EAST, WABAUNSEE _____ County, Kansas.

Geographic
Center

(C) One in LOT 5 quarter of the _____ quarter of the _____ quarter of Section 8, more particularly described as being near a point 3110 feet North and 4492 feet West of the Southeast corner of said section, in Township 10 South, Range 12 EAST, WABAUNSEE _____ County, Kansas.

(D) One in the _____ quarter of the _____ quarter of the _____ quarter of Section _____, more particularly described as being near a point _____ feet North and _____ feet West of the Southeast corner of said section, in Township _____ South, Range _____ East/West (circle one), _____ County, Kansas.

If the source of supply is groundwater, a separate application shall be filed for each proposed well or battery of wells, except that a single application may include up to four wells within a circle with a quarter (1/4) mile radius in the same local source of supply which do not exceed a maximum diversion rate of 20 gallons per minute per well.

A battery of wells is defined as two or more wells connected to a common pump by a manifold; or not more than four wells in the same local source of supply within a 300 foot radius circle which are being operated by pumps not to exceed a total maximum diversion rate of 800 gallons per minute and which supply water to a common distribution system.

6. The owner of the point of diversion, if other than the applicant is (please print):

(name, address and telephone number)

(name, address and telephone number)

You must provide evidence of legal access to, or control of, the point of diversion from the landowner or the landowner's authorized representative. Provide a copy of a recorded deed, lease, easement or other document with this application. In lieu thereof, you may sign the following sworn statement:

I have legal access to, or control of, the point of diversion described in this application from the landowner or the landowner's authorized representative. I declare under penalty of perjury that the foregoing is true and correct.

Executed on 1/7, 2019.

[Signature]
Applicant's Signature

The applicant must provide the required information or signature irrespective of whether they are the landowner. Failure to complete this portion of the application will cause it to be unacceptable for filing and the application will be returned to the applicant.

7. The proposed project for diversion of water will consist of A BATTERY OF 2 WELLS
(number of wells, pumps or dams, etc.)
and WILL BE completed (by) JUNE 2019
(Month/Day/Year - each was or will be completed)

8. The first actual application of water for the proposed beneficial use was or is estimated to be JUNE 2019
(Mo/Day/Year)

- 9. Will pesticide, fertilizer, or other foreign substance be injected into the water pumped from the diversion works?
 Yes No If "yes", a check valve shall be required.

All chemigation safety requirements must be met including a chemigation permit and reporting requirements.

- 10. If you are planning to impound water, please contact the Division of Water Resources for assistance, prior to submitting the application. Please attach a reservoir area capacity table and inform us of the total acres of surface drainage area above the reservoir.

Have you also made an application for a permit for construction of this dam and reservoir with the Division of Water Resources? Yes No

- If yes, show the Water Structures permit number here _____
- If no, explain here why a Water Structures permit is not required **N/A** _____

- 11. The application must be supplemented by a U.S.G.S. topographic map, aerial photograph or a detailed plat showing the following information. On the topographic map, aerial photograph, or plat, identify the center of the section, the section lines or the section corners and show the appropriate section, township and range numbers. Also, please show the following information:

- (a) The location of the proposed point(s) of diversion (wells, stream-bank installations, dams, or other diversion works) should be plotted as described in Paragraph No. 5 of the application, showing the North-South distance and the East-West distance from a section line or southeast corner of section.
- (b) If the application is for groundwater, please show the location of any existing water wells of any kind within 1/2 mile of the proposed well or wells. Identify each existing well as to its use and furnish the name and mailing address of the property owner or owners. If there are no wells within 1/2 mile, please advise us.
- (c) If the application is for surface water, the names and addresses of the landowner(s) 1/2 mile downstream and 1/2 mile upstream from your property lines must be shown.
- (d) The location of the proposed place of use should be shown by crosshatching on the topographic map, aerial photograph or plat.
- (e) Show the location of the pipelines, canals, reservoirs or other facilities for conveying water from the point of diversion to the place of use.

A 7.5 minute U.S.G.S. topographic map may be obtained by providing the section, township and range numbers to: Kansas Geological Survey, 1930 Constant, Campus West, University of Kansas, Lawrence, Kansas 66047.

- 12. List any application, appropriation of water, water right, or vested right file number that covers the same diversion points or any of the same place of use described in this application. Also list any other recent modifications made to existing permits or water rights in conjunction with the filing of this application.

P/D – 39253 & 43699 _____

P/U – 36961; 36962; 39253; 43699; 43700 & 43701 _____

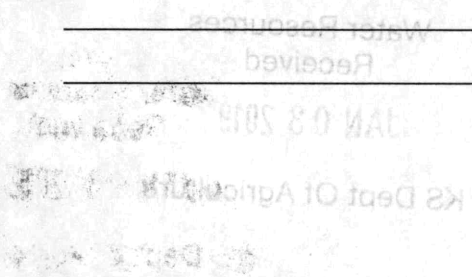

13. Furnish the following well information if the proposed appropriation is for the use of groundwater. If the well has not been completed, give information obtained from test holes, if available.

SOURCE WILL BE KS. RIVER ALLUVIUM
Information below is from: Test holes Well as completed Drillers log attached

Well location as shown in paragraph No.	(A)	(B)	(C)	(D)
Date Drilled	_____	_____	_____	_____
Total depth of well	_____	_____	_____	_____
Depth to water bearing formation	_____	_____	_____	_____
Depth to static water level	_____	_____	_____	_____
Depth to bottom of pump intake pipe	_____	_____	_____	_____

14. The relationship of the applicant to the proposed place where the water will be used is that of

OWNER
(owner, tenant, agent or otherwise)

15. The owner(s) of the property where the water is used, if other than the applicant, is (please print):

(name, address and telephone number)

(name, address and telephone number)

16. The undersigned states that the information set forth above is true to the best of his/her knowledge and that this application is submitted in good faith.

Dated at ST. MARYS, Kansas, this 2 day of JANUARY, 2019.
(month) (year)



(Applicant Signature)

By _____
(Agent or Officer Signature)

(Agent or Officer - Please Print)

Assisted by BRETT BUNGER TFO/ ASST WATER COMM. Date: 12-14-18
(office/title)

Water Resources
Received
JAN 03 2019
KS Dept Of Agriculture
SCANNED

IRRIGATION USE SUPPLEMENTAL SHEET

File No. _____

Name of Applicant (Please Print): PESSEMIER COMPANY

1. Please supply the name and address of each landowner, the legal description of the lands to be irrigated, and designate the actual number of acres to be irrigated in each forty acre tract or fractional portion thereof:

Landowner of Record NAME: PESSEMIER COMPANY CHRISTIAN A ROYER
 ADDRESS: PO BOX 206 ST MARYS KS 66536

S	T	R	NE¼				NW¼				SW¼				SE¼				TOTAL
			NE	NW	SW	SE	NE	NW	SW	SE	NE	NW	SW	SE	NE	NW	SW	SE	
7	10	12c				L-3 21.95									L-4 24.48	L-6 1		L-5 20	67.43
7	10	12E				L-1 1													1
7	10	12E	4		1	14								15.52	2			5	41.52

Landowner of Record NAME: CHRISTIAN A ROYER
 ADDRESS: PO BOX 206 ST MARYS KS 66536

S	T	R	NE¼				NW¼				SW¼				SE¼				TOTAL
			NE	NW	SW	SE	NE	NW	SW	SE	NE	NW	SW	SE	NE	NW	SW	SE	
8	10	12E						L-5 38.25	L-6 14.33	L-6 39						L-7 3.22			94.8
8	10	12E					4	6.5	1.75	13		40	40	* 25				* 25	130.25

** per WRIS & Confirmed per 5/22/19 e-mail Doug Schemm TFO* **TOTAL = 335 ACRES**

Landowner of Record NAME: _____
 ADDRESS: _____

S	T	R	NE¼				NW¼				SW¼				SE¼				TOTAL
			NE	NW	SW	SE	NE	NW	SW	SE	NE	NW	SW	SE	NE	NW	SW	SE	

Water Resources
Received
JAN 03 2019

2. Please complete the following information for the description of the operation for the irrigation project. Attach supplemental sheets as needed.

a. Indicate the soils in the field(s) and their intake rates:

Soil Name	Percent of field (%)	Intake Rate (in/hr)	Irrigation Design Group
_____	_____	_____	_____
_____	_____	_____	_____
_____	_____	_____	_____
_____	_____	_____	_____
_____	_____	_____	_____
Total:	100 %		

b. Estimate the average land slope in the field(s): _____%

Estimate the maximum land slope in the field(s): _____%

c. Type of irrigation system you propose to use (check one):

- Center pivot Center pivot - LEPA "Big gun" sprinkler
 Gravity system (furrows) Gravity system (borders) Sideroll sprinkler

Other, please describe: _____

d. System design features:

i. Describe how you will control tailwater:

ii. For sprinkler systems:

(1) Estimate the operating pressure at the distribution system: _____ psi

(2) What is the sprinkler package design rate? _____ gpm

(3) What is the wetted diameter (twice the distance the sprinkler throws water) of a sprinkler on the outer 100 feet of the system? _____ feet

(4) Please include a copy of the sprinkler package design information.

e. Crop(s) you intend to irrigate. Please note any planned crop rotations:

f. Please describe how you will determine when to irrigate and how much water to apply (particularly important if you do not plan a full irrigation).

You may attach any additional information you believe will assist in informing the Division of the need for your request.

Krueger, Richelle [KDA]

From: Schemm, Doug [KDA]
Sent: Wednesday, May 22, 2019 2:07 PM
To: Krueger, Richelle [KDA]
Cc: Baum, Kristen [KDA]
Subject: RE: PU File No. 50192/39253 and 43699 Pessemier Company/Christian Royer
Attachments: 50192 Approval and Permit to Proceed.docx

Hey Richelle,

Yes, I'm gettin real tired of this rain. You are correct. There is nothing in the SE SE. WRIS is correct. Funny thing is I got my worksheet right, permit wrong!!!

Thanks for catching this.

Kristen, here is corrected permit.

Thanks,

Doug

From: Krueger, Richelle [KDA]
Sent: Wednesday, May 22, 2019 1:58 PM
To: Schemm, Doug [KDA] <Doug.Schemm@ks.gov>
Subject: PU File No. 50192/39253 and 43699 Pessemier Company/Christian Royer

Hi Doug,

Hows it going? Little soggy here, ha! Hey I have the change apps that go with the referenced new app and wanted to check on a discrepancy, WRIS and the existing rights show 25 acres in the SE $\frac{1}{4}$ SW $\frac{1}{4}$ 8- 10S-12E (map appears to show too) but the new app has it as 25 acres in the SE $\frac{1}{4}$ SE $\frac{1}{4}$ $\frac{1}{4}$ 8- 10S-12E. I am thinking WRIS is correct because just pd apps filed not change apps....Can you verify which is correct the New app or WRIS?

Thanks, as always, for your help!

Richelle



Topeka Field Office
6531 SE Forbes Ave., Suite B
Topeka, KS 66619

Phone: 785-296-5733
Fax: 785-296-8298
www.agriculture.ks.gov

Mike Beam, Acting Secretary

Laura Kelly, Governor

February 20, 2019

CHARLES F & MARITA A RONNAU
27155 OREGON TRAIL RD
SAINT MARYS KS 66536-9742

Re: Pending New Application, File No. 50,192, and
Change in Point of Diversion, File Nos. 39,253 and 43,699

Dear Sir or Madam:

This is to advise you that Pessemier Company %Christian A Royer, has filed the new application referred to above for a permit to appropriate 200 acre-feet of groundwater per calendar year for irrigation use to be diverted at a maximum rate of 800 gallons per minute. Please note that application is proposing to add an additional well near the existing well currently authorized under Water Right, File Nos. 39,253 and 43,699. This will create a battery of two wells. The pending change applications for File Nos. 39,253 and 43,699 will also add this additional well to match the new application well battery.

The geographic center of the well battery is located in Lot 5, of Section 8, in Township 10 South, Range 12 East, Wabaunsee County, Kansas.

Records in this office indicate that you may have a well or wells in this vicinity and you are being notified of receipt of these applications in order that you may be fully informed of the proposed locations of the applicant's point of diversion and proposed use of water. Consideration will be given to comments or other information which you desire to submit to this office **within 15 days** from the date of this letter.

You can find the new and change applications and site maps posted by the file numbers referenced above at: <http://agriculture.ks.gov/divisions-programs/dwr/water-appropriation/notices>

If you have any questions or comments, you may also contact me at (785) 296-3495. If you call, please reference the file number so I can help you more efficiently.

Sincerely,

A handwritten signature in cursive script that reads "Doug Schemm".

Douglas W. Schemm
Environmental Scientist
Topeka Field Office

pc: Pessemier Company

File # 50,192
 Meets safe yield

Analysis Results

The selected PD is in an area OPEN to new appropriations.
 The safe yield based on the variables listed below is 3,642.00 AF.
 Total prior appropriations in the circle is 3,463.81 AF. $-200 = 3263.81 \text{ AF} + 2 = 3,265.81 \text{ AF}$
 Total quantity of water available for appropriation is ~~17820~~ AF.
376.19 AF

Safe Yield Variables

The area used for the analysis is set at 6,856 acres.
 The potential annual recharge at the circle center is estimated to be 8.5 inches.
 The percent of recharge available for appropriation is 75%.

Authorized Quantity values are as of 13-MAR-2019 and are based on Appropriated and Vested ground water right and possible stream nodes for GMD #2. Domestic, Term and Temporary water rights have been excluded.
 There are 50 water rights and 44 points of diversion within the circle.

File Number	Use	ST	SR	Q4	Q3	Q2	Q1	FeetN	FeetW	Sec	Twp	Rng	ID	Qind	Auth Quant	Add Quant	Tot Acres	Net Acres
V PT 5 00	MUN	AA	G		SW	NW	SW	1456	5308	10	10	12E	1	WR	147.31	147.31		
A 3752 00	IRR	NK	G		NE	SW	NW	3955	4491	07	10	12E	7	WR	220.00	220.00 ✓	347.09	347.09
A 7027 00	IRR	NK	G		NW	CR	SW	0	0	16	10	12E	1	WR	80.00	80.00 ✓	80.00	80.00
A 7592 00	IRR	NK	G		NW	CR	SW	0	0	16	10	12E	1	WR	131.00	51.00 ✓	80.00	0.00
A 19410 00	IRR	NK	G		NE	SE	NE	3830	460	01	10	11E	1	WR	138.00	138.00	138.00	138.00
A 27513 00	IRR	NK	G		NW	NE	NE	5220	1280	17	10	12E	2	WR	110.00	110.00	270.00	270.00
A 27562 00	IRR	NK	G		SE	SE	SW	200	2800	08	10	12E	1	WR	7.00	7.00	7.00	7.00
A 28009 00	IRR	NK	G		NE	SW	NW	3955	4491	07	10	12E	7	WR	121.00	0.00	347.09	0.00
A 29049 00	IRR	NK	G		SE	NW	SE	1960	1545	16	10	12E	9	WR	100.00	100.00	100.00	100.00
Same	IRR	NK	G		SE	NW	SE	1960	1350	16	10	12E	10	WR				
A 30770 00	IRR	NK	G		SE	NW	NW	4283	4460	07	10	12E	8	WR	135.00	49.00 ✓	347.09	0.00
A 32185 00	IRR	NK	G		SW	NW	SE	1381	2086	01	10	11E	3	WR	96.00	96.00	205.00	205.00
A 34765 00	IRR	NK	G		SE	SW	SW	317	4741	04	10	12E	3	WR	35.00	35.00	148.00	148.00
Same	IRR	NK	G		SE	SW	SW	170	4486	04	10	12E	4	WR				
Same	IRR	NK	G		SE	SW	SW	22	4231	04	10	12E	5	WR				
A 36859 00	IRR	NK	G		NE	SW	NE	3750	1450	13	10	11E	1	WR	99.00	99.00	127.00	127.00
A 36961 00	IRR	NK	G		NC	W2	SW	1240	4540	08	10	12E	6	WR	111.00	111.00	335.00	335.00
A 36962 00	IRR	NK	G		NW	NW	SW	2115	4725	08	10	12E	7	WR	183.00	179.00	335.00	0.00
A 37632 00	IRR	NK	G			NC	NE	3960	1320	19	10	12E	1	WR	86.00	86.00	132.00	132.00
A 37700 00	IRR	NK	G			NC	NW	3980	3960	20	10	12E	4	WR	43.00	43.00	69.00	69.00
A 37701 00	IRR	NK	G			NC	NW	3980	3960	20	10	12E	4	WR	43.00	43.00	69.00	69.00
A 38057 00	IRR	NK	G		SW	SE	NW	2680	3545	06	10	12E	1	WR	143.00	143.00	233.00	233.00
A 38929 00	IRR	NK	G		SW	SE	SE	75	1000	05	10	12E	1	WR	29.00	29.00	42.00	42.00
A 39253 00	IRR	NK	G					2900	4550	08	10	12E	4	WR	114.00	0.00 ✓	335.00	0.00
A 39918 00	IRR	NK	G		SW	SE	NW	2680	3545	06	10	12E	1	WR	44.00	44.00	233.00	0.00

File Number	Use	ST	SR	Q4	Q3	Q2	Q1	FeetN	FeetW	Sec	Twp	Rng	ID	Qind	Auth	Quant	Add Quant	Tot Acres	Net Acres
A 40435 00	IRR	NK	G		NE	NE	SW	2512	2949	07	10	12E	5	WR		85.00	85.00	347.09	0.00
A 40460 00	IRR	NK	G			NC	SE	1293	1326	13	10	11E	2	WR		51.00	51.00	66.00	66.00
A 40461 00	IRR	NK	G			NC	SE	1293	1326	13	10	11E	2	WR		51.00	51.00	66.00	66.00
A 40945 00	IRR	NK	G		SW	NW	NE	4420	2175	12	10	11E	1	WR		58.00	58.00	256.00	256.00
A 41022 00	IRR	NK	G		SW	NW	SE	1381	2086	01	10	11E	3	WR		58.00	58.00	205.00	0.00
A 42814 00	IRR	NK	G		SE	SW	SW	317	4741	04	10	12E	3	WR		59.00	24.00	148.00	0.00
Same	IRR	NK	G		SE	SW	SW	170	4486	04	10	12E	4	WR					
Same	IRR	NK	G		SE	SW	SW	22	4231	04	10	12E	5	WR					
A 43066 00	IRR	NK	G					805	3266	09	10	12E	7	WR		35.00	35.00	35.00	35.00
A 43486 00	IRR	NK	G		NW	SW	SW	1182	5083	18	10	12E	3	WR		60.00	60.00	59.00	59.00
A 43699 00	IRR	NK	G					2900	4550	08	10	12E	4	WR		28.00	26.00 ✓ 28 + 2	335.00	0.00
A 43700 00	IRR	NK	G		NW	NW	SW	2115	4725	08	10	12E	7	WR		3.00	3.00 ✓	335.00	0.00
A 43701 00	IRR	NK	G		NC	W2	SW	1240	4540	08	10	12E	6	WR		17.00	0.00 ✓	335.00	0.00
A 44432 00	IRR	NK	G					3998	1065	16	10	12E	4	WR		119.00	119.00	112.00	112.00
Same	IRR	NK	G					3481	1280	16	10	12E	7	WR					
Same	IRR	NK	G					3740	1173	16	10	12E	8	WR					
A 44435 00	IRR	NK	G			NC	NW	3892	4010	16	10	12E	5	WR		92.00	92.00	128.00	128.00
Same	IRR	NK	G		SE	NW	NW	4492	4010	16	10	12E	11	WR					
Same	IRR	NK	G		SE	NW	NW	4192	4010	16	10	12E	12	WR					
A 44437 00	IRR	NK	G			CS	SW	6	3990	16	10	12E	6	WR		74.00	74.00	67.00	67.00
A 44993 00	IRR	NK	G		SW	NE	NW	4107	3803	17	10	12E	3	WR		75.00	65.30 ✓	68.00	0.00
A 44994 00	IRR	NK	G			NC	NE	3933	1309	17	10	12E	4	WR		88.00	65.30	134.00	68.00
A 45412 00	IRR	NK	G		SE	NW	NW	4074	4018	19	10	12E	4	WR		63.00	63.00	57.00	57.00
A 45688 00	IRR	NK	G		SW	SW	SE	57	2600	18	10	12E	4	WR		41.00	41.00	71.00	71.00
A 45829 00	IRR	NK	G		NE	NW	SW	2596	4391	05	10	12E	2	WR		34.00	34.00	57.00	57.00
A 46101 00	IRR	NK	G		SW	NW	NE	4420	2175	12	10	11E	1	WR		81.00	81.00	256.00	0.00
A 46512 00	IRR	NK	G		NE	NE	SW	2571	2951	13	10	11E	6	WR		71.50	71.50	65.00	65.00
A 48368 00	IRR	KK	G		SW	NW	NE	4346	2613	08	10	12E	9	WR		149.60	149.60	136.00	136.00
A 48410 00	IRR	LO	G			NC	NW	3892	4010	16	10	12E	5	WR		140.80	48.80	128.00	0.00
Same	IRR	LO	G		SE	NW	NW	4492	4010	16	10	12E	11	WR					
Same	IRR	LO	G		SE	NW	NW	4192	4010	16	10	12E	12	WR					
A 48702 00	IRR	LO	G		NC	E2	SW	1330	3241	05	10	12E	3	WR		69.30	69.30	63.00	63.00
A 48792 00	IRR	KE	G		SE	NW	NW	4283	4460	07	10	12E	8	WR		354.00	0.00	347.09	0.00
A 49504 00	IRR	LO	G		NE	NW	SW	2596	4391	05	10	12E	2	WR		62.70	28.70	57.00	0.00
A 50192 00	IRR	AY	G					2900	4550	08	10	12E	4	WR		200.00	0.00 ✓	335.00	0.00
Same	IRR	AY	G					3257	4492	08	10	12E	10	WR					
Same	IRR	AY	G					3110	4492	08	10	12E	11	WR					
A 50211 00	IRR	AY	G		SE	NW	SE	1374	1510	06	10	12E	2	WR		200.00	200.00	279.00	0.00

Limitations

File Number	Seq Num	Limitations
-------------	---------	-------------

File Number	Seq Num	Limitations
A 7592 00	✓	LIMITED TO 131 AF/YR COM/W 7027 ON LAND LISTED IN CERT ✓
A 28009 00	✓	220AF/YR @1255 GPM COM/W #3752 ✓ 220 AF
A 30770 00	✓	269AF/YR COM/W #3752 & 28009 $220 + 0 + 49 = 269$ ✓
A 36962 00	✓	290AF/YR COM/W #36,961 $111 + 179 = 290$ ✓
A 37701 00	1	760 GPM COM/W #37,700
A 39253 00	2	290AF/YR COM/W #36,961 & 36,962 ✓ 290
A 39918 00	1	800 GPM COM/W #38,057
A 40461 00	2	885 GPM COM/W #40460
A 41022 00	2	910 GPM COM/W #32185
A 42814 00	✓	2 59AF/YR @ 350GPM COM/W #34,765 $35 + 24 = 59$ ✓
A 43699 00	3	685 GPM COM/W #39253
A 43700 00	3	915 GPM COM/W #36962
Same	4	319AF/YR COM/W #36961, 36962, 39253 & 43699 $290 + 26 = 316 + 3 = 319$ ✓
A 43701 00	3	665 GPM COM/W #36961
Same	4	319AF/YR COM/W #36961, 36962, 39253, 43699 & 43700 ✓
A 44993 00	2	140.3AF/YR COM/W #27513 $65.3 + 110 = 175.3$
A 44994 00	2	153.3AF/YR COM/W #27513
A 46101 00	3	855 GPM COM/W #40945
A 48410 00	1	140.8AF/YR @ 800GPM COM/W #44435 $92 + 48.8$ ✓
A 48792 00	1	354 AF/YR COM/W #3752, #28009, #30770, & #40435 $269 + 85 = 354$ ✓
Same	2	1325 GPM COM/W #30770
A 49504 00	1	62.7 AF/YR COM/W #45829 $28.7 + 34 = 62.7$ ✓

#50,192

Geo-Center Well Battery

Report Date Thursday, February 28 2019

3110 Feet North and 4492 Feet West of the Southeast Corner of Section 8 T 10S R 12E
GROUNDWATER ONLY

Reduced spacing to
Applicant's own well is
sufficient to
prevent
impairment

File Number	Use	ST	SR	Dist (ft)	Q4	Q3	Q2	Q1	FeetN	FeetW	Sec	Twp	Rng	ID	Batt	Auth_Quan	Add_Quan	Unit
A__ 3752	00	IRR	NK	G	5355	--	NE	SW	NW	3955	4491	7	10	12E	7	220.00	220.00	AF
A__ 7027	00	IRR	NK	G	7292	--	NW	CR	SW	-----	-----	16	10	12E	1	80.00	80.00	AF
A__ 7592	00	IRR	NK	G	7292	--	NW	CR	SW	-----	-----	16	10	12E	1	131.00	51.00	AF
A__ 19410	00	IRR	NK	G	8708	--	NE	SE	NE	3830	460	1	10	11E	1	138.00	138.00	AF
A__ 27513	00	IRR	NK	G	4513	--	NW	NE	NE	5220	1280	17	10	12E	2	110.00	110.00	AF
A__ 27562	00	IRR	NK	G	3370	--	SE	SE	SW	200	2800	8	10	12E	1	7.00	7.00	AF
A__ 28009	00	IRR	NK	G	5355	--	NE	SW	NW	3955	4491	7	10	12E	7	121.00	.00	AF
A__ 29049	00	IRR	NK	G	10470	--	SE	NW	SE	1960	1545	16	10	12E	9 B 2	100.00	100.00	AF
A__ 30770	00	IRR	NK	G	5391	--	SE	NW	NW	4283	4460	7	10	12E	8	135.00	49.00	AF
A__ 32185	00	IRR	NK	G	8688	--	SW	NW	SE	1381	2086	1	10	11E	3	96.00	96.00	AF
A__ 34765	00	IRR	NK	G	5871	--	SE	SW	SW	170	4486	4	10	12E	4 G 2	35.00	35.00	AF
Same					5702	--	SE	SW	SW	317	4741	4	10	12E	3 B 2			
Same					6049	--	SE	SW	SW	22	4231	4	10	12E	5 B 2			
A__ 36859	00	IRR	NK	G	8619	--	NE	SW	NE	3750	1450	13	10	11E	1	99.00	99.00	AF
A__ 36961	00	IRR	NK	G	1871	--	NC	W2	SW	1240	4540	8	10	12E	6	111.00	111.00	AF
A__ 36962	00	IRR	NK	G	1022	--	NW	NW	SW	2115	4725	8	10	12E	7	183.00	179.00	AF
A__ 37632	00	IRR	NK	G	9830	--	NC	NE		3960	1320	19	10	12E	1	86.00	86.00	AF
A__ 37700	00	IRR	NK	G	9623	--	NC	NW		3980	3960	20	10	12E	4	43.00	43.00	AF
A__ 37701	00	IRR	NK	G	9623	--	NC	NW		3980	3960	20	10	12E	4	43.00	43.00	AF
A__ 38057	00	IRR	NK	G*	6495	--	SW	SE	NW	2680	3545	6	10	12E	1	143.00	143.00	AF
A__ 38929	00	IRR	NK	G	4174	--	SW	SE	SE	75	1000	5	10	12E	1	29.00	29.00	AF
A__ 39253	00	IRR	NK	G*	218	--	--	--	--	2900	4550	8	10	12E	4	114.00	.00	AF
A__ 39918	00	IRR	NK	G*	6495	--	SW	SE	NW	2680	3545	6	10	12E	1	44.00	44.00	AF
A__ 40435	00	IRR	NK	G	3769	--	NE	NE	SW	2512	2949	7	10	12E	5	85.00	85.00	AF
A__ 40460	00	IRR	NK	G	10040	--	NC	SE		1293	1326	13	10	11E	2	51.00	51.00	AF
A__ 40461	00	IRR	NK	G	10040	--	NC	SE		1293	1326	13	10	11E	2	51.00	51.00	AF
A__ 40945	00	IRR	NK	G	8172	--	SW	NW	NE	4420	2175	12	10	11E	1	58.00	58.00	AF
A__ 41022	00	IRR	NK	G	8688	--	SW	NW	SE	1381	2086	1	10	11E	3	58.00	58.00	AF
A__ 42814	00	IRR	NK	G	5871	--	SE	SW	SW	170	4486	4	10	12E	4 G 2	59.00	24.00	AF
Same					5702	--	SE	SW	SW	317	4741	4	10	12E	3 B 2			
Same					6049	--	SE	SW	SW	22	4231	4	10	12E	5 B 2			
A__ 43066	00	IRR	NK	G	7007	--	--	--	--	805	3266	9	10	12E	7	35.00	35.00	AF
A__ 43486	00	IRR	NK	G	9231	--	NW	SW	SW	1182	5083	18	10	12E	3	60.00	60.00	AF
A__ 43699	00	IRR	NK	G*	218	--	--	--	--	2900	4550	8	10	12E	4	28.00	26.00	AF
A__ 43700	00	IRR	NK	G	1022	--	NW	NW	SW	2115	4725	8	10	12E	7	3.00	3.00	AF
A__ 43701	00	IRR	NK	G	1871	--	NC	W2	SW	1240	4540	8	10	12E	6	17.00	.00	AF
A__ 44432	00	IRR	NK	G	9817	--	--	--	--	3740	1173	16	10	12E	8 G 2	119.00	119.00	AF
Same					9795	--	--	--	--	3998	1065	16	10	12E	4 B 2			
Same					9848	--	--	--	--	3481	1280	16	10	12E	7 B 2			
A__ 44435	00	IRR	NK	G	7160	--	SE	NW	NW	4192	4010	16	10	12E	12 G 2	92.00	92.00	AF
Same					7339	--	NC	NW		3892	4010	16	10	12E	5 B 2			
Same					6991	--	SE	NW	NW	4492	4010	16	10	12E	11 B 2			
A__ 44437	00	IRR	NK	G	10188	--	CS	SW		6	3990	16	10	12E	6	74.00	74.00	AF
A__ 44993	00	IRR	NK	G	4318	--	SW	NE	NW	4107	3803	17	10	12E	3	75.00	65.30	AF
A__ 44994	00	IRR	NK	G	5466	--	NC	NE		3933	1309	17	10	12E	4	88.00	65.30	AF
A__ 45592	00	IRR	NK	G	10553	--	NE	NW	NW	5191	4450	12	10	11E	2	101.00	101.00	AF
A__ 45688	00	IRR	NK	G	8931	--	SW	SW	SE	57	2600	18	10	12E	4	41.00	41.00	AF
A__ 45829	00	IRR	NK	G	4789	--	NE	NW	SW	2596	4391	5	10	12E	2	34.00	34.00	AF

will o/L in pd

will o/L in pd

A__	46101 00 IRR NK G	8172 -- SW NW NE	4420	2175	12	10	11E	1	81.00	81.00	AF
A__	46512 00 IRR NK G	10517 -- NE NE SW	2571	2951	13	10	11E	6	71.50	71.50	AF
A__	48368 00 IRR KK G	2249 -- SW NW NE	4346	2613	8	10	12E	9	149.60	149.60	AF
A__	48410 00 IRR LO G	7160 -- SE NW NW	4192	4010	16	10	12E	12 G 2	140.80	48.80	AF
Same		7339 -- -- NC NW	3892	4010	16	10	12E	5 B 2			
Same		6991 -- SE NW NW	4492	4010	16	10	12E	11 B 2			
A__	48702 00 IRR LO G	3742 -- NC E2 SW	1330	3241	5	10	12E	3	69.30	69.30	AF
A__	48792 00 IRR KE G	5391 -- SE NW NW	4283	4460	7	10	12E	8	354.00	.00	AF
A__	49504 00 IRR LO G	4789 -- NE NW SW	2596	4391	5	10	12E	2	62.70	28.70	AF
A__	50192 00 IRR AY G	0 -- -- -- --	3110	4492	8	10	12E	11 G 2	200.00	.00	AF
Same		218 -- -- -- --	2900	4550	8	10	12E	4 B 2	<i>existing well</i>		
Same		147 -- -- -- --	3257	4492	8	10	12E	10 B 2			
A__	50211 00 IRR AY G	4210 -- SE NW SE	1374	1510	6	10	12E	2	200.00	200.00	AF
VPT	5 00 MUN AA G	10044 -- SW NW SW	1456	5308	10	10	12E	1	147.31	147.31	AF

Total Net Quantities Authorized:	Direct	Storage
Total Requested Amount (AF) =	200.00	.00
Total Permitted Amount (AF) =	149.60	.00
Total Inspected Amount (AF) =	146.80	.00
Total Pro_Cert Amount (AF) =	.00	.00
Total Certified Amount (AF) =	2858.10	.00
Total Vested Amount (AF) =	147.31	.00
TOTAL AMOUNT (AF) =	3501.81	.00

An * after the source of supply indicates a pending application for change under the file number.

An * after the ID indicates a 15 AF exemption was granted under the file number.

A "G" in the Batt column indicates the GEO CTR of a battery. A "B" indicates a well in the battery.

The number in the Batt column is the number of wells in the battery.

Water Rights and Points of Diversion Within 2.00 miles of point defined as:

3110 Feet North and 4492 Feet West of the Southeast Corner of Section 8 T 10S R 12E

GROUNDWATER ONLY

WATER USE CORRESPONDENTS:

File Number Use ST SR

A__ 3752 00 IRR NK G
 > PESSEMIER COMPANY
 > CHRISTIAN A ROYER
 > PO BOX 206
 > SAINT MARYS KS 66536

A__ 7027 00 IRR NK G
 > FRANCIS A & JANE J KELSEY
 >
 > 9626 NW 21ST ST
 > TOPEKA KS 66618

A__ 7592 00 IRR NK G
 > FRANCIS A & JANE J KELSEY
 >
 > 9626 NW 21ST ST
 > TOPEKA KS 66618

WATER WELL RECORD Form WWC-5 KSA 82a-1212

1 LOCATION OF WATER WELL: Fraction NW 1/4 SE 1/4 SW 1/4 Section Number 8 Township Number T 10 S Range Number R 12 E 100
 County: Wabaunsee
 Distance and direction from nearest town or city street address of well if located within city?
 2 1/2 mi. W of St. Marys and 1000 ft N

2 WATER WELL OWNER: Pessemier Company
 RR#, St. Address, Box #: P.O. Box 206 Board of Agriculture, Division of Water Resources
 City, State, ZIP Code: St. Marys, KS 66536 Application Number: 36,961

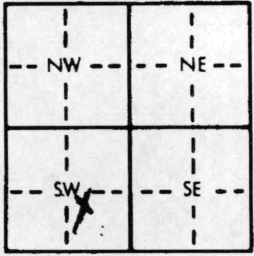
3 LOCATE WELL'S LOCATION WITH AN "X" IN SECTION BOX:  4 DEPTH OF COMPLETED WELL: 49 ft. ELEVATION: 17 ft.
 Depth(s) Groundwater Encountered 1. 17 ft. 2. ft. 3. ft.
 WELL'S STATIC WATER LEVEL: 17 ft. below land surface measured on mo/day/yr
 Pump test data: Well water was 30 ft. after 1 hours pumping 1000 gpm
 Est. Yield: 1500 gpm Well water was 36 ft. after 1 hours pumping 1400 gpm
 Bore Hole Diameter: 32 in. to ft. and in. to ft.
 WELL WATER TO BE USED AS: 5 Public water supply 8 Air conditioning 11 Injection well
 1 Domestic 3 Feedlot 6 Oil field water supply 9 Dewatering 12 Other (Specify below)
 2 Irrigation 4 Industrial 7 Lawn and garden only 10 Observation well
 Was a chemical/bacteriological sample submitted to Department? Yes No X
 Water Well Disinfected? Yes No X

5 TYPE OF BLANK CASING USED: 1 Steel 3 RMP (SR) 5 Wrought iron 8 Concrete tile CASING JOINTS: Glued Clamped X
 2 PVC 4 ABS 6 Asbestos-Cement 9 Other (specify below) Welded
 7 Fiberglass Threaded
 Blank casing diameter 16 in. to 33 ft. Dia in. to ft. Dia in. to ft.
 Casing height above land surface 12 in., weight lbs./ft. Wall thickness or gauge No.
 TYPE OF SCREEN OR PERFORATION MATERIAL: 7 PVC 10 Asbestos-cement
 1 Steel 3 Stainless steel 5 Fiberglass 8 RMP (SR) 11 Other (specify)
 2 Brass 4 Galvanized steel 6 Concrete tile 9 ABS 12 None used (open hole)
 SCREEN OR PERFORATION OPENINGS ARE: 5 Gauzed wrapped 8 Saw cut 11 None (open hole)
 1 Continuous slot 3 Mill slot 6 Wire wrapped 9 Drilled holes
 2 Louvered shutter 4 Key punched 7 Torch cut 10 Other (specify)
 SCREEN-PERFORATED INTERVALS: From 33 ft. to 49 ft. From ft. to ft.
 GRAVEL PACK INTERVALS: From 10 ft. to 49 ft. From ft. to ft.

6 GROUT MATERIAL: 1 Neat cement 2 Cement grout 3 Bentonite 4 Other
 Grout Intervals: From 0 ft. to 10 ft. From ft. to ft. From ft. to ft.
 What is the nearest source of possible contamination:
 1 Septic tank 4 Lateral lines 7 Pit privy 10 Livestock pens 14 Abandoned water well
 2 Sewer lines 5 Cess pool 8 Sewage lagoon 11 Fuel storage 15 Oil well/Gas well
 3 Watertight sewer lines 6 Seepage pit 9 Feedyard 12 Fertilizer storage 16 Other (specify below)
 NONE
 Direction from well? How many feet?

FROM	TO	LITHOLOGIC LOG	FROM	TO	LITHOLOGIC LOG
0	1	Brown silt			
1	6	Fine brown sandy silt			
6	15	Hard brown silt			
15	19	fine brown sand			
19	25	Sm-Md brown gravel			
25	30	Md. gray gravel			32' saturated thickness
30	31	Md-Lg gray gravel & gray clay			lot of gravel
31	33	Md-Lg gray gravel			
33	36	Sm. gray gravel			
36	40	Md. gray gravel			
40	42	Md-Lg gray gravel			
42	49	Md. gray gravel			
49	49'6"	Hard gray shale STOPPED			

7 CONTRACTOR'S OR LANDOWNER'S CERTIFICATION: This water well was (1) constructed, (2) reconstructed, or (3) plugged under my jurisdiction and was completed on (mo/day/year) 3-8-84 and this record is true to the best of my knowledge and belief. Kansas Water Well Contractor's License No. 323 This Water Well Record was completed on (mo/day/yr) 3-24-84 under the business name of Hoobler Drilling Company by (signature)

INSTRUCTIONS: Use typewriter or ball point pen, PLEASE PRESS FIRMLY and PRINT clearly. Please fill in blanks underlined or circle the correct answers. Send top three copies to Kansas Department of Health and Environment, Division of Environment, Environmental Geology Section, Topeka, KS 66620. Send one to WATER WELL OWNER and retain one for your records.

WATER WELL RECORD Form WWC-5 KSA 82a-1212

1 LOCATION OF WATER WELL: Fraction $\frac{1}{4}$ NW $\frac{1}{4}$ SW $\frac{1}{4}$ Section Number 8 Township Number T 10 S Range Number R 12 E

Distance and direction from nearest town or city street address of well if located within city?
 2 1/2 mi. W of St. Marys and 2000 Ft. N

2 WATER WELL OWNER: Pessenier Company
 RR#, St. Address, Box #: P.O. Box 206 Board of Agriculture, Division of Water Resources
 City, State, ZIP Code: St. Marys, KS 66536 Application Number: 36,962

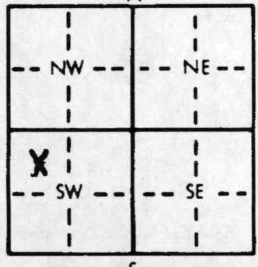
3 LOCATE WELL'S LOCATION WITH AN "X" IN SECTION BOX:  DEPTH OF COMPLETED WELL: 46 ft. ELEVATION: 16 ft. 2. ft. 3. ft.
 Depth(s) Groundwater Encountered: 1. 16 ft. 2. ft. 3. ft.
 WELL'S STATIC WATER LEVEL: 16 ft. below land surface measured on mo/day/yr
 Pump test data: Well water was 25 ft. after 2 hours pumping 1200 gpm
 Est. Yield: 2000 gpm; Well water was 28 ft. after 2 hours pumping 1500 gpm
 Bore Hole Diameter: 40 in. to 46 ft., and in. to ft.
 WELL WATER TO BE USED AS: 5 Public water supply 8 Air conditioning 11 Injection well
 1 Domestic 3 Feedlot 6 Oil field water supply 9 Dewatering 12 Other (Specify below)
 2 Irrigation 4 Industrial 7 Lawn and garden only 10 Observation well
 Was a chemical/bacteriological sample submitted to Department? Yes No X; If yes, mo/day/yr sample was submitted Water Well Disinfected? Yes No X

5 TYPE OF BLANK CASING USED: 5 Wrought iron 8 Concrete tile CASING JOINTS: Glued Clamped X
 1 Steel 3 RMP (SR) 6 Asbestos-Cement 9 Other (specify below) Welded
 2 PVC 4 ABS 7 Fiberglass Threaded
 Blank casing diameter: 16 in. to 26 ft. Dia. in. to ft. Dia. in. to ft.
 Casing height above land surface: 12 in., weight lbs./ft. Wall thickness or gauge No.
 TYPE OF SCREEN OR PERFORATION MATERIAL: 7 PVC 10 Asbestos-cement
 1 Steel 3 Stainless steel 5 Fiberglass 8 RMP (SR) 11 Other (specify)
 2 Brass 4 Galvanized steel 6 Concrete tile 9 ABS 12 None used (open hole)
 SCREEN OR PERFORATION OPENINGS ARE: 5 Gauzed wrapped 8 Saw cut 11 None (open hole)
 1 Continuous slot 3 Mill slot 6 Wire wrapped 9 Drilled holes
 2 Louvered shutter 4 Key punched 7 Torch cut 10 Other (specify)
 SCREEN-PERFORATED INTERVALS: From 26 ft. to 46 ft., From ft. to ft.
 From ft. to ft., From ft. to ft.
 GRAVEL PACK INTERVALS: From 10 ft. to 46 ft., From ft. to ft.
 From ft. to ft., From ft. to ft.

6 GROUT MATERIAL: 1 Neat cement 2 Cement grout 3 Bentonite 4 Other
 Grout Intervals: From 0 ft. to 10 ft., From ft. to ft., From ft. to ft.
 What is the nearest source of possible contamination:
 1 Septic tank 4 Lateral lines 7 Pit privy 10 Livestock pens 14 Abandoned water well
 2 Sewer lines 5 Cess pool 8 Sewage lagoon 11 Fuel storage 15 Oil well/Gas well
 3 Watertight sewer lines 6 Seepage pit 9 Feedyard 12 Fertilizer storage 16 Other (specify below)
 13 Insecticide storage NONE

Direction from well? How many feet?

FROM	TO	LITHOLOGIC LOG	FROM	TO	LITHOLOGIC LOG
0	2	Black silt	38	39	M.-Lg gray gravel clear
2	6	Fine brown sandy silt	39	40	Md. gray gravel
6	13	Hard brown silt	40	42	Small gray gravel
13	17	Med. brown gravel	42	45	Md-Lg gray gravel
17	20	Small brown sand	45	46	Black shale STOPPED
20	22	Md. brown gravel			
22	23	" " " & gray clay			
23	26	Md. gray gravel & gray clay (10%)			
26	30	" " " clear			Saturated thickness 30'
30	32	Small gray sand			
32	33	Sm-Md gray gravel			
33	34	Small gray gravel			
34	37	Md-Lg gray gravel			
37	38	" " " " & gray clay (20%)			

7 CONTRACTOR'S OR LANDOWNER'S CERTIFICATION: This water well was (1) constructed, (2) reconstructed, or (3) plugged under my jurisdiction and was completed on (mo/day/year) 3-1-84 and this record is true to the best of my knowledge and belief. Kansas Water Well Contractor's License No. 323. This Water Well Record was completed on (mo/day/yr) 6-21-84 under the business name of Hoobler Drilling Company by (signature) Dan Hoobler

INSTRUCTIONS: Use typewriter or ball point pen, PLEASE PRESS FIRMLY and PRINT clearly. Please fill in blanks, underline or circle the correct answers. Send top copies to Kansas Department of Health and Environment, Division of Environment, Environmental Geology Section, Topeka, KS 66620. Send one to WATER WELL R and retain one for your records.

(DRL, 7/1/2013)

WATER WELL RECORD

Form WWC-5

Division of Water Resources App. No.

3,752

1 LOCATION OF WATER WELL: County: Pottawatomie Fraction: SE 1/4 SW 1/4 NW 1/4 NW 1/4 Section Number: 7 Township No.: T 10 S Range Number: R 12 [X]E []W

Street/Rural Address of Well Location; if unknown, distance & direction from nearest town or intersection: From Belvue 2 E. 1 S. 1 E. 1/2 S. 1/4 N. in field Global Positioning System (GPS) information: Latitude: 39.19874 Longitude: 096.12639 Elevation: 955

2 WATER WELL OWNER: Pessemier Co. c/o Cristian Rover RR#, Street Address, Box #: P.O. Box 206 City, State, ZIP Code: Saint Mary's, Kansas 66536 Collection Method: [] GPS unit (Make/Model: Garmin Csx) [] Digital Map/Photo, [X] Topographic Map, [] Land Survey Est. Accuracy: [] <3 m, [X] 3-5 m, [] 5-15 m, [] >15 m

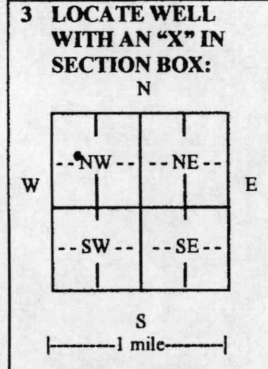

3 LOCATE WELL WITH AN 'X' IN SECTION BOX: N W E S 1 mile 4 DEPTH OF COMPLETED WELL 71 ft. Depth(s) Groundwater Encountered (1)..... ft. (2)..... ft. (3)..... ft. WELL'S STATIC WATER LEVEL 19 ft. below land surface measured on mo/day/yr. 2-4-2013 Pump test data: Well water was..... ft. after..... hours pumping..... gpm EST. YIELD.....gpm. Well water was..... ft. after..... hours pumping..... gpm Bore Hole Diameter.....in. to.....ft., and.....in. to.....ft. WELL WATER TO BE USED AS: [] Public water supply [] Geothermal [] Injection well [] Domestic [] Feedlot [] Oil field water supply [] Dewatering [] Other (Specify below) [X] Irrigation [] Industrial [] Domestic-lawn & garden [] Monitoring well Was a chemical/bacteriological sample submitted to Department? [] Yes [X] No If yes, mo/day/yr sample was submitted..... Water well disinfected? [X] Yes [] No

5 TYPE OF CASING USED: [] Steel [X] PVC [] Other CASING JOINTS: [X] Glued [] Clamped [] Welded [] Threaded Bolted Casing diameter .16 in. to .41 ft., Diameter..... in. to..... ft., Diameter..... in. to..... ft. Casing height above land surface. 24 in., Weight SCH.40 lbs./ft., Wall thickness or gauge No. 500 TYPE OF SCREEN OR PERFORATION MATERIAL: [] Steel [X] Stainless Steel [X] PVC [] Other (Specify) [] Brass [] Galvanized Steel [] None used (open hole) SCREEN OR PERFORATION OPENINGS ARE: [] Continuous slot [] Mill slot [] Gauze wrapped [] Torch cut [] Drilled holes [] None (open hole) [] Louvered shutter [] Key punched [X] Wire wrapped [X] Saw cut [] Other (specify) SCREEN-PERFORATED INTERVALS: From .41 ft. to .61 ft., From .61 ft. to .71 ft. From PVC ft. to ft., From S.S. ft. to ft. GRAVEL PACK INTERVALS: From .71 ft. to .20 ft., From ft. to ft. From ft. to ft., From ft. to ft.

6 GROUT MATERIAL: [] Neat cement [] Cement grout [X] Bentonite [] Other Grout Intervals: From .20 ft. to .0 ft., From ft. to ft., From ft. to ft. What is the nearest source of possible contamination: [] Septic tank [] Lateral lines [] Pit privy [] Livestock pens [] Insecticide storage [X] Other (specify below) [] Sewer lines [] Cesspool [] Sewage lagoon [] Fuel storage [] Abandoned water well [] Watertight sewer lines [] Seepage pit [] Feedyard [] Fertilizer storage [] Oil well/gas well None Direction from well..... Distance from well.....

Table with columns: FROM, TO, LITHOLOGIC LOG, FROM, TO, LITHO. LOG (cont.) or PLUGGING INTERVALS. Row 1: 0, 3, Sandy top. Row 2: 3, 7, Brown clay silty. Row 3: 7, 40, Medium to fine sand. Row 4: 40, 71, Fine to medium sand with streaks of rock. Note: 54' saturated thickness.

7 CONTRACTOR'S OR LANDOWNER'S CERTIFICATION: This water well was [X] constructed, [] reconstructed, or [] plugged under my jurisdiction and was completed on (mo/day/year) 2-4-2013 and this record is true to the best of my knowledge and belief. Kansas Water Well Contractor's License No. 134 This Water Well Record was completed on (mo/day/year) 2-19-2013 under the business name of Rosenkrantz-Bemis Enterprise by (signature) Danielle A. Osborn

INSTRUCTIONS: Use typewriter or ball point pen. PLEASE PRESS FIRMLY and PRINT clearly. Please fill in blanks and check the correct answers. Send three copies (white, blue, pink) to Kansas Department of Health and Environment, Bureau of Water, Geology Section, 1000 SW Jackson St., Suite 420, Topeka, Kansas 66612-1367. Telephone 785-296-5524. Send one copy to WATER WELL OWNER and retain one for your records. Include fee of \$5.00 for each constructed well. Visit us at http://www.kdheks.gov/waterwell/index.html.

STATE OF KANSAS

DEPARTMENT OF AGRICULTURE
1320 RESEARCH PARK DRIVE
MANHATTAN, KS 66502
PHONE: (785) 564-6700
FAX: (785) 564-6777



900 SW JACKSON, ROOM 456
TOPEKA, KS 66612
PHONE: (785) 296-3556
www.agriculture.ks.gov

GOVERNOR JEFF COLYER, M.D.
JACKIE McCLASKEY, SECRETARY OF AGRICULTURE

January 4, 2019

Pessemier Company, Christian A Royer
PO Box 206
St. Marys, KS 66536

RE: Application, File No. **50192**

Dear Sir or Madam:

The Division of Water Resources (Division) has received your application for a permit to appropriate water for beneficial use. Your application has been assigned the file number referenced above. Please be aware that the Division may have a large number of pending applications on hand at times and makes every attempt to process them in the order in which they are received. You will be contacted if additional information is required.

Please note, this letter only acknowledges receipt of your application and does not guarantee approval. In accordance with the provisions of the Kansas Water Appropriation Act, the use of water as proposed prior to approval of the application is unlawful.

Additional information about the process may be found on our website at agriculture.ks.gov/divisions-programs/dwr. If you have any other questions, please contact our office at 785-564-6640 or your local Topeka Field Office at 785-296-5733. If you call, please reference the file number so we can help you more efficiently.

Sincerely,

Brent Tournay, L.G.
Change Applications Unit Supervisor
Water Appropriation Program

SCANNED

(Date)

Kansas Department of Agriculture
Division of Water Resources
David W. Barfield, Chief Engineer
1320 Research Park Drive
Manhattan, Kansas 66502

Re: Application
File No. _____

Minimum Desirable Streamflow
KANSAS River Assurance District
Water Reservation Rights

Dear Sir:

I understand that a Minimum Desirable Streamflow requirement has been established, an Assurance District has been formed and established or a Water Reservation Right is held by the Kansas Water Office (circle the appropriate item) for the source of supply to which the above referenced application applies, namely the KANSAS RIVER.

I understand that diversion of water pursuant to this application will be subject to regulation any time Minimum Desirable Streamflow requirements are not being met, Assurance District or Water Marketing releases are being made from storage in Federal Reservoirs or when a Reservation Right upstream of a Federal Reservoir is being administered.

I also understand that if this application is approved, there could be times, as determined by the Division of Water Resources, when I would not be allowed to divert water. I realize that this could affect the economics of my decision to appropriate water.

I am aware of the above factors, and with the knowledge thereof, request that the Division of Water Resources proceed with processing and approval, if possible, of the above referenced application.

[Signature]
Signature of Applicant

CHRIS ROYER
Print Applicant Name

State of Kansas)
County of Pottawatomie) SS

I hereby certify that the foregoing instrument was signed in my presence and sworn to before me this 2nd day of January, 2019.

Brooke M. Bird
Notary Public

My Commission Expires: 10-30-2022

Water Resources
Received

NOTARY PUBLIC - State of Kansas
BROOKE M. BIRD
My Appt. Expires 10-30-2022

JAN 03 2019

KS Dept Of Agriculture

**FORM TO BE USED WHEN APPLICABLE
WHEN FILING AN APPLICATION FOR PERMIT
TO APPROPRIATE WATER FOR BENEFICIAL USE**

The Kansas Legislature has established minimum desirable streamflows for the streams listed below. If your proposed diversion of water is going to be from one of these watercourses or adjacent alluvial aquifers, please complete the back side of this page and submit it along with your application for permit to appropriate water.

Arkansas River
Big Blue River
Chapman Creek
Chikaskia River
Cottonwood River
Delaware River
Little Arkansas River
Little Blue River
Marais des Cygnes River
Medicine Lodge River
Mill Creek (Wabaunsee Co. area)
Neosho River

Ninnescah River
North Fork Ninnescah River
Rattlesnake Creek
Republican River
Saline River
Smoky Hill River
Solomon River
South Fork Ninnescah
Spring River
Walnut River
Whitewater River

Assurance Districts have been formed on the following rivers:

Kansas River Marias des Cygnes River Neosho River

The Kansas Water Office has Water Reservation Rights for the following reservoirs:

Big Hill	Marion
Clinton	Melvorn
Council Grove	Milford
Elk City	Perry
Hillsdale	Pomona
John Redmond	Tuttle Creek

WELLS WITHIN ONE-HALF MILE

- #1) FILE NO. 48368 (IRR.)
CHARLES F & MARITA RONNAU
27155 OREGON TRAIL RD
ST MARYS KS 66536

- #2) FILE NOS. 36962 & 43700 (IRR.)
OWNER = APPLICANT

- #3) FILE NOS. 36961 & 43701 (IRR.)
OWNER = APPLICANT

Water Resources
Received

JAN 03 2019

KS Dept Of Agriculture
SCANNED

Chris, as per our recent discussions I have prepared the enclosed applications which propose the drilling of a fourth well and create a battery of 2 wells with the existing North well. To finish up the applications, please do the following:

Application for Permit to Appropriate Water – This application has a #1 in the upper left-hand corner of the first page. This will provide an opportunity to develop additional annual quantity from the battery of wells and establish a higher pumping rate at 800 gallons per minute for the battery.

#1) Sign and date the application in Item #'s 6 & 16

#2) There is a form included with the application that references "Minimum Desirable Streamflow". This form will need to be signed and dated in the presence of a notary.

#3) Please sign and date the aerial photo in the spaces provided.

#4) The filing fee for this application is \$300

Application to Change the Point of Diversion – There are two of these applications, one for each of the two water rights that currently reside on the North well. These applications have a #2 in the upper left-hand corner of the first page.

#1) Please sign and date both applications on Page 5.

#2) Please sign and date the aerial photos attached to the applications.

#3) The filing fee for each application is \$100.

You can provide one check for \$500 payable to the Kansas Dept of Agriculture to cover the filing fees.

Please return the applications, attachments and check to:

Division of Water Resources
1320 Research Park Drive
Manhattan KS 66502

Water Resources
Received

JAN 03 2019

KS Dept Of Agriculture

If you have any questions, please call. (785) 296-7064

Brett

SCANNED

1:12,000

New Application

