

NOTICE

This scan only represents the application as filed. The information contained herein meets the requirements of K.A.R. 5-3-1 or K.A.R. 5-5-1, and has been found acceptable for filing in the office of the Chief Engineer. The application should not be considered to be a complete application as per K.A.R. 5-3-1b or K.A.R. 5-5-2a.

Submit To: CHIEF ENGINEER
 Division of Water Resources
 Kansas Department of Agriculture
 1320 Research Park Drive
 Manhattan, Kansas 66502
<http://agriculture.ks.gov/dwr>

APPLICATION FOR TERM PERMIT

- GROUNDWATER
 SURFACE WATER
 (check one)

WATER RESOURCES
 RECEIVED



APR 23 2021
 11:40
 State of Kansas
 KS DEPT OF AGRICULTURE

20219031

STATUTORY FILING FEE MUST ACCOMPANY THIS APPLICATION
 (Make check payable to the Kansas Department of Agriculture)

1. Applicant: (Please print or type)
 Name N R HAMM QUARRY INC Woodbine
 Street P O BOX 17
 City and State PERRY, KANSAS
 Zip Code 66073 Telephone No. (785) 217-5784
 E-Mail Address Mark.Jordan@nrhamm.com
 Social Security I.D. No. _____
 and/or Taxpayer I.D. No. 48-1243726

2. Location of Point of Diversion:
 Sec. 10, Twp. 14 S, Rng. 4, (E),
DICKINSON County, Kansas.
 Distance from Southeast Corner of Section:
1,966 feet North from Southeast Corner
2,167 feet West from Southeast Corner

3. Water Use Data:
 Proposed Max. Pumping Rate (gpm) 500
 Amount Requested (acre-feet) 155 AF
 per calendar year
 Depth of Well (feet) _____
 Date (completed) (will be completed) UPON APPROVAL
 Drainage Basin SMOKY HILL RIVER
 Name of Stream CARRY CREEK

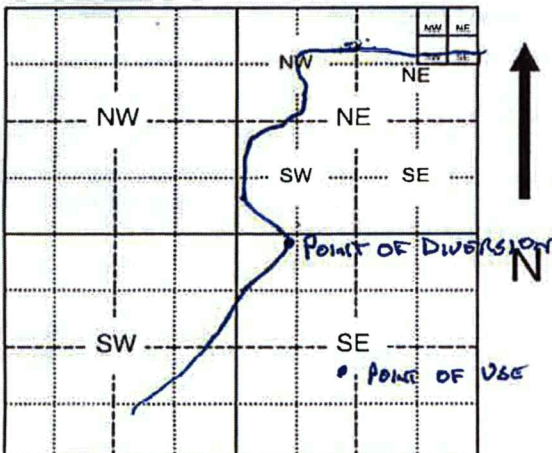

Assisted by Shaun Johnson Topeka Field Office

4. Water is to be used for (briefly describe proposed use and explain the rate and quantity requested):
WASHING AGGREGATES

5. Location of place of use:
SE 1/4 & SW 1/4 OF SEC 10, SW 1/4 OF SEC 11, NE 1/4 & NW 1/4 SEC 15 ALL IN TWN 14 S, RNG 4 EAST

6. Period of use:
 Commencing date: 5/1/2021
 Ending Date: 5/1/2026 Also enter on Item 12

If off-stream pit, check here
 Will pit floor intersect water table? Yes No

7. Location of the proposed point of diversion and those of other water users within 1/2 mile shall be indicated on the diagram to the lower-left, scale 1 inch = 2,000 feet. If surface water, indicate on the diagram the course of the stream, and its name. List other D.W.R. permit numbers that cover the requested point(s) of diversion or place of use here:

FEE SCHEDULE

1. The filing fee for an application is based on the maximum amount of water use proposed within a year. Except for storage, the fee is:
- | Acre-feet | Fee |
|---------------|----------|
| 0-100 | \$200.00 |
| 101-320 | \$300.00 |
| More than 320 | \$300.00 |
- plus \$20 for each additional 100 acre-feet or any part thereof.
2. The fee for an application in which storage is requested, is:
- | Acre-feet | Fee |
|---------------|----------|
| 0-250 | \$200.00 |
| More than 250 | \$200.00 |
- plus \$20.00 for each additional 250 acre-feet of storage or any part thereof.

- NOTE: If an application requests both direct use and storage, the fee charged shall be as determined under No. 1 or No. 2 above, whichever is greater, but not both fees.
3. A request for an extension of time to extend the term of a term permit shall be accompanied by a fee of \$100.00.
4. There is a separate application form for domestic use. Do not use this form for domestic use.

CONVERSION FACTORS

1 acre-foot equals 325,851 gallons
 1 million gallons equal 3.07 acre-feet

For Office Use Only
 F.O. 1 GMD 0 Meets K.A.R. 5-3-1 (YES/NO) Use IND Source G S County DK By LI Date 4.23.21
 Code TR2 Fee \$ 300 TR # _____ Receipt Date 4.23.21 Check # CC

→ PY00025610

5/5/2021
 LMoody

WATER RESOURCES RECEIVED

APR 23 2021

KS DEPT OF AGRICULTURE

8. For groundwater use, list below all wells within 1/2 mile of the proposed well, and plot locations upon the diagram on reverse side. If additional space is needed, attach a map.

Other wells -

Well A Owner(s): _____
Address: _____

Well B Owner(s): _____
Address: _____

9. For surface water use, list below the names and addresses of all landowners from a point 1/2 mile upstream to a point 1/2 mile downstream of the tract of land upon which the point of diversion is located. If additional space is needed, attach sheet.

Tract A Owner(s): DOWNSTREAM OWNER: ROBERT D & LEUITA M MEYER REV LIVING TRUST
Address: 710 FLETCHER ST MOUNT CITY, KANSAS 66056

Tract B Owner(s): UPSTREAM OWNER: ALLEN R KNOPP TRUST
Address: 3100 PAYNE DR MANHATTAN, KANSAS 66503

10. The owner of the point of diversion, if other than the applicant is (please print):

Hamm, Inc. - 609 Perry Place-Perry, KS 66073 785-597-5111
(name, address and telephone number)

You must provide evidence of legal access to, or control of, the point of diversion from the landowner or the landowner's authorized representative. Provide a copy of a recorded deed, lease, easement or other document with this application. In lieu thereof, you may sign the following sworn statement:

I have legal access to, or control of, the point of diversion described in this application from the landowner or the landowner's authorized representative. I declare under penalty of perjury that the foregoing is true and correct.

Executed on APRIL 22, 2021. _____
Applicant's Signature

The applicant must provide the required information or signature irrespective of whether they are the landowner. Failure to complete this portion of the application will cause it to be unacceptable for filing and the application will be returned to the applicant.

11. The applicant states that the information set hereon is true and accurate to the best of his/her knowledge.

12. The applicant agrees to waive any right to a hearing on the matter of abandonment of this appropriation right and further agrees that this appropriation right may be dismissed and terminated upon completion of the proposed project, said dismissal date to be on May 1, 2026 or within any extension of time authorized by the Chief Engineer, Division of Water Resources, Kansas Department of Agriculture.

13. The applicant agrees to provide water to nearby water users, at no charge to said users, should their rights to use water become impaired by the project proposed by this application.

14. Water use contact person (in event emergency contact is needed):

Name: Robert Strome Telephone No. (785-258-0321)

Signature of Applicant or Authorized Representative Date 04/22/2021

Mark Jordan EHS Coordinator
Applicant's Name Printed Title

DO NOT WRITE BELOW THIS LINE

CONDITIONS OF APPROVAL:

The applicant shall maintain accurate and complete records from which the quantity of water diverted during each calendar year may be readily determined. Accurate and complete records shall be furnished to the Chief Engineer by March 1 following the end of each calendar year. Failure to file the annual water use report by the due date, shall cause the applicant to be subject to a civil penalty.

The use of water herein authorized shall not be made so as to impair any use under existing water rights nor prejudicially and unreasonably affect the public interest.

The Chief Engineer specifically retains jurisdiction in this matter with authority to make such reasonable reductions in the approved rate of diversion and quantity authorized, and such changes in other terms, conditions, and limitation set forth in this approval and permit to proceed as may be deemed to be in the public interest.

1320 Research Park Drive
Manhattan, KS 66502
785-564-6700
www. agriculture.ks.gov



900 SW Jackson, Room 456
Topeka, KS 66612
785-296-3556

Mike Beam, Secretary

Laura Kelly, Governor

April 28, 2021

N R HAMM QUARRY INC
P O BOX 17
PERRY KS 66073

RE: Application, File No(s). **20219031**

Dear Sir or Madam:

The Division of Water Resources (Division) has received your application(s) for a permit to appropriate water for beneficial use. Your application(s) has been assigned the file number(s) referenced above. Please be aware that the Division may have a large number of pending applications on hand at times and makes every attempt to process them in the order in which they are received. You will be contacted if additional information is required.

Please note, this letter only acknowledges receipt of your application(s) and does not guarantee approval. In accordance with the provisions of the Kansas Water Appropriation Act, the use of water as proposed prior to approval of the application(s) is unlawful.

Additional information about the process may be found on our website at agriculture.ks.gov/divisions-programs/dwr. If you have any other questions, please contact our office at 785-564-6640 or your local Topeka Field Office at 785-296-5733. *Topeka Field Office at 785-296-5733*. If you call, please reference the file number so we can help you more efficiently.

Sincerely,

A handwritten signature in black ink that reads "Kris Neuhauser". The signature is fluid and cursive, with a long horizontal stroke at the end.

Kris Neuhauser
New Applications Lead
Water Appropriation Program

DATA ENTRY SYSTEM ID NUMBER SHEET

FILE NUMBER 20219031

APPLICANT PERSON ID & SEQ #	PDIV ID	BATTERY ID
6827	88775	

LANDOWNER PERSON ID & SEQ #	PUSE ID
6827	70372
	70373
	70374

WATER USE CORRESPONDENT PERSON ID & SEQ #
6827